

PLANS FOR
BASIN BASED
NEIGHBORHOOD FLOOD MITIGATION AND
STORMWATER QUALITY IMPROVEMENT PROJECT
TOWN OF FORT MYERS BEACH
 SECTION 19, TOWNSHIP 46 SOUTH, RANGE 24 EAST
 LEE COUNTY, FLORIDA

LIST OF UTILITY SERVICE AREAS:

POWER
 FLORIDA POWER AND LIGHT
 15834 WINKLER ROAD
 FORT MYERS, FLORIDA 33908
 (239) 415-1302

WATER
 TOWN OF FORT MYERS BEACH
 2523 ESTERO BOULEVARD
 FORT MYERS BEACH, FLORIDA 33931
 (239) 765-0202

SEWER
 LEE COUNTY UTILITIES
 1500 MONROE STREET
 FORT MYERS, FLORIDA 33906
 (239) 533-8181

NATURAL GAS
 TECO / PEOPLES GAS
 5901 ENTERPRISE PARKWAY
 FORT MYERS, FLORIDA 33905
 (239) 690-5507

TELEPHONE
 EMBARQ / UNITED TELEPHONE-FLORIDA
 P. O. BOX 370
 FORT MYERS, FLORIDA 33901
 (239) 336-2011

CABLE
 COMCAST CABLE
 1418 SE 10TH STREET
 CAPE CORAL, FLORIDA 33990
 (239) 574-2020

INDEX OF DRAWINGS

- C-01 COVER SHEET
- C-02 ABBREVIATIONS, LEGENDS AND STANDARD NOTES
- C-03 DRAINAGE BASIN MAP
- (NOT INCLUDED, TYP.) C-04 & C-05 PLAN, PROFILE AND CROSS SECTIONS - CAROLINA AVENUE
- C-06 & C-07 PLAN, PROFILE AND CROSS SECTIONS - OSTEGO DRIVE
- C-08 & C-09 PLAN, PROFILE AND CROSS SECTIONS - MIRAMAR STREET
- C-10 & C-11 PLAN, PROFILE AND CROSS SECTIONS - OHIO AVENUE
- C-12 PLAN, PROFILE AND CROSS SECTIONS - BAYVIEW DRIVE
- C-13 & C-14 PLAN, PROFILE AND CROSS SECTIONS - VIRGINIA AVENUE
- C-15 & C-16 PLAN, PROFILE AND CROSS SECTIONS - PEARL STREET
- C-17 & C-18 PLAN, PROFILE AND CROSS SECTIONS - DELMAR AVENUE
- C-19 & C-20 PLAN, PROFILE AND CROSS SECTIONS - FAIRWEATHER LANE
- C-21 & C-22 PLAN, PROFILE AND CROSS SECTIONS - MANGO STREET
- C-23 PLAN, PROFILE AND CROSS SECTIONS - CHAPEL STREET
- C-24 & C-25 PLAN, PROFILE AND CROSS SECTIONS - TROPICAL SHORES WAY
- C-26 PLAN, PROFILE AND CROSS SECTIONS - AVENUE E
- C-27 PLAN, PROFILE AND CROSS SECTIONS - MIRAMAR ST. (GULF SIDE)
- C-28 PLAN, PROFILE AND CROSS SECTIONS - PALM AVENUE
- C-29 PLAN, PROFILE AND CROSS SECTIONS - MANGO STREET (GULFSIDE)
- C-30 PLAN, PROFILE AND CROSS SECTIONS - COTTAGE AVENUE
- C-31 PLAN, PROFILE AND CROSS SECTIONS - CHAPEL STREET (GULFSIDE)

- C-40 SOILS MAP
- C-41 FLUCFCS MAP
- C-42 AERIAL MAP

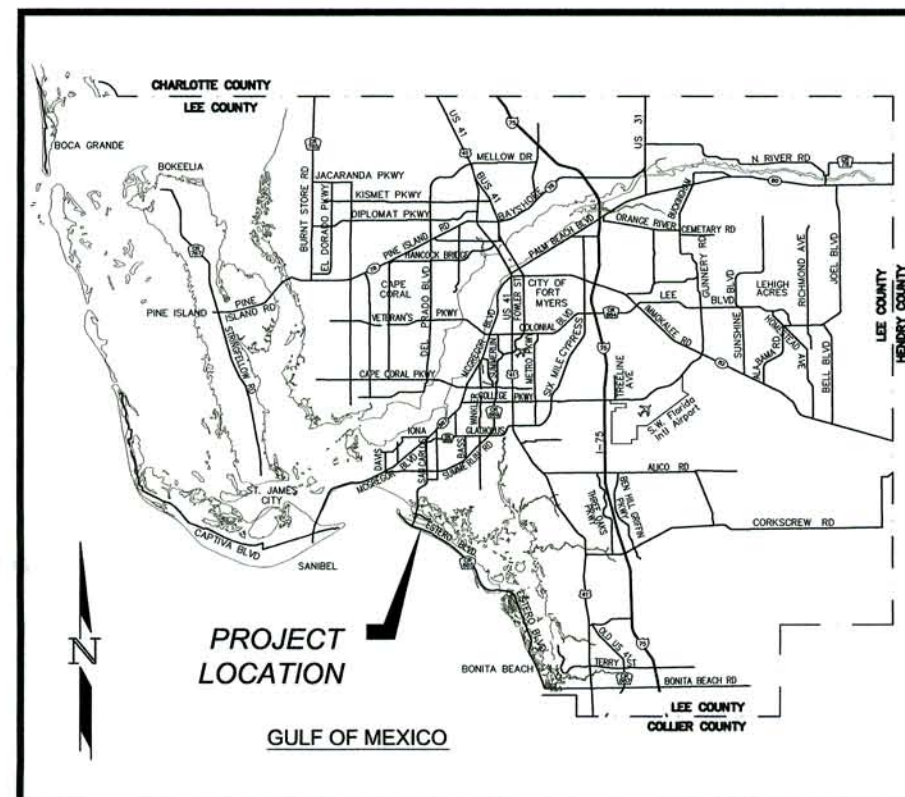

PROJECT LOCATION MAP
 NOT TO SCALE

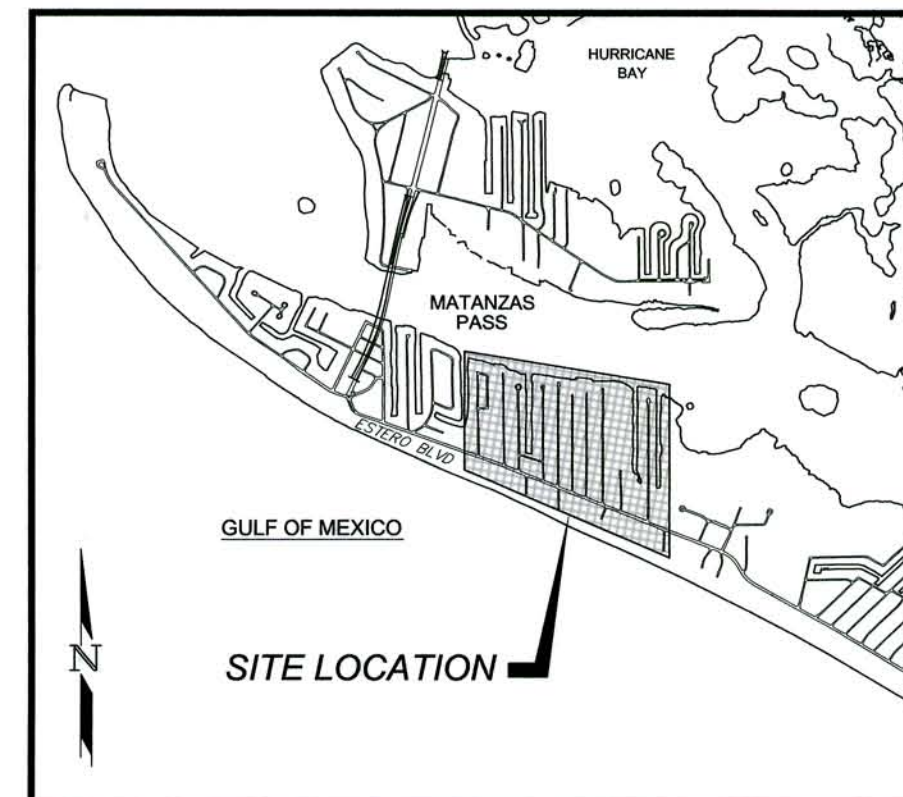

PROJECT SITE MAP
 NOT TO SCALE

ORIGINAL SUBMITTAL
 OCT 19 2009

PREPARED FOR:
FORT MYERS BEACH
TOWN COUNCIL
 APPLICATION NUMBER
 091019-6-3

LARRY KIKER MAYOR
 HERB ACKEN VICE MAYOR
 TOM BABCOCK COUNCILMAN
 JO LIST COUNCILWOMAN
 BOB RAYMOND COUNCILMAN

DEPARTMENT OF PUBLIC WORKS
 JACK GREEN, INTERIM TOWN MANAGER
 CATHIE LEWIS, DEPUTY PUBLIC WORKS DIRECTOR
 2523 ESTERO BOULEVARD
 FORT MYERS BEACH, FLORIDA 33931
 TELEPHONE (239) 765-0202 & FAX (239) 765-0908

PREPARED BY:
ECT
Environmental Consulting & Technology, Inc.
 4100 CENTER POINTE DRIVE, SUITE 112
 FORT MYERS, FLORIDA 33916
 Tel (239) 277-0003 Fax (239) 277-1211
 http://www.ectinc.com
 CA#5520

RECEIVED
 OCT 13 2009
 LWC SERVICE CENTER

FEDERAL COST-SHARE FUNDING SOURCE:

FEMA HMGP 1609 - 48 - R
 DEM ID No.: 09HM-37-09-46-02-017

ALL CONSTRUCTION SHALL BE IN ACCORDANCE WITH THE FLORIDA DEPARTMENT OF TRANSPORTATION (FDOT) "STANDARD SPECIFICATIONS FOR ROAD AND BRIDGE CONSTRUCTION" (LATEST EDITION), UNLESS OTHERWISE SPECIFIED. ALL TYPICAL DETAILS ARE PER FDOT - "DESIGN STANDARDS" (LATEST EDITION), LEE COUNTY UTILITIES (SEWER), AND TOWN OF FORT MYERS BEACH (WATER) - UNLESS OTHERWISE SPECIFIED.

REVISIONS

NO.	DATE	REVISION	BY	APPROVED

ECT PROJECT No.: 08-1063

THESE DRAWINGS ARE FOR REVIEW PURPOSES ONLY
 AND ARE NOT APPROVED FOR CONSTRUCTION.

Bradley S. Vance 10-15-09
 BRADLEY S. VANCE, P.E. DATE
 FLORIDA P.E. No. 43746

SHEET NUMBER
C-01











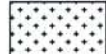

ABBREVIATIONS:

- A ALTERNATE
- ALF APPROX.
- ASB ASBESTOS
- B.M. BENCH MARK
- C.B. CATCH BASIN
- CF CUBIC FEET
- CFM CUBIC FEET PER MINUTE
- CI CAST IRON
- CIP CAST IRON PIPE
- C.J. CONSTRUCTION JOINT
- CMP CORRUGATED METAL PIPE
- C.O. CLEANOUT
- CV CHECK VALVE
- CF CUBIC FOOT
- CFY CUBIC YARD
- CL CENTER LINE
- C.L.F. CHAIN LINK FENCE
- COL COLUMN
- CONC. CONCRETE
- CONST. CONSTRUCT
- CONT. CONTINUOUS
- CONTR. CONTRACTOR
- CU COPPER
- CI CUBIC INCH
- DIAM. DIAMETER
- DIAG. DIAGONAL
- DIM. DIMENSION
- DIST. DISTANCE
- D.I.P. DUCTILE IRON PIPE
- D.E. DRAINAGE EASEMENT
- DRWG. DRAWING
- E. EAST
- E.A. EXISTING GRADE LINE
- E.G.L. EXISTING GRADE LINE
- ELEV. ELEVATION
- EQUIP. EQUIPMENT
- ERCP ELLIPTICAL REINFORCED CONCRETE PIPE
- EX. EXISTING
- F.F.E. FINISHED FLOOR ELEVATION
- FM FORCE MAIN
- FOUND. FOUNDATION
- FIN. FINISH
- FRP FIBERGLASS REINFORCED PLASTIC
- FEET FEET
- N.G. NATURAL GAS
- G.C. GENERAL CONTRACTOR
- G.I. GALVANIZED IRON
- GPM GALLONS PER MINUTE
- G.V. GATE VALVE
- GA. GAUGE
- GR. GRADE
- HDPE HIGH DENSITY POLYETHYLENE
- HOR. HORIZONTAL
- HYD. HYDRANT
- I.D. INSIDE DIAMETER
- IRR. IRRIGATION
- INVER. LAKE ACCESS EASEMENT
- L.A.E. LAKE ACCESS EASEMENT
- MGD MILLION GALLONS PER DAY
- MB. MAILBOX
- M.H. MANHOLE
- M.J. MECHANICAL JOINT
- MAX. MAXIMUM
- M.E.S. MECHANICAL MITERED END SECTION
- MANF. MANUFACTURER
- MIN. MINIMUM
- MISC. MISCELLANEOUS
- N. NORTH
- NE. NORTHEAST
- NW. NORTHWEST
- N.P.W. NON POTABLE WATER
- N.T.S. NOT TO SCALE
- NO. NUMBER
- NOM. NOMINAL
- NG. NATURAL GAS
- O.C. ON CENTER
- O.C.E.W. ON CENTER EACH WAY
- O.D. OUTSIDE DIAMETER
- P.G.L. POUNDS PER SQUARE FOOT
- PSF POUNDS PER SQUARE INCH
- P.V. PLUG VALVE
- PVC POLYVINYL CHLORIDE
- PE POLYETHYLENE
- P.V.M.T. PAVEMENT
- PC POINT OF CURVATURE
- P.P.L. PROPERTY LINE
- PW POTABLE WATER
- PT POINT OF TANGENCY
- P.U.E. PUBLIC UTILITY EASEMENT
- PVI POINT OF VERTICAL INTERSECTION
- QTY. QUANTITY
- R. ROAD
- RCP REINFORCED CONCRETE PIPE
- REQ'D. REQUIRED
- R.O.W. RIGHT OF WAY
- R/W RIGHT OF WAY
- S. SOUTH
- SE. SOUTHWEST
- S.S. STAINLESS STEEL
- SAN. SANITARY
- SCHD. SCHEDULE
- SECT. SECTION
- SEW. SEWER
- SH. SHEET
- SPEC. SPECIFICATION
- SQ. SQUARE
- ST. STREET
- STA. STATION
- ST. STEEL
- STAND. STANDARD
- SYM. SYMMETRICAL
- TOE TOE OF SLOPE
- TOB TOP OF BANK
- THK. THICK
- TEL. TELEPHONE
- TEMP. TEMPERATURE
- TRANS. TRANSFORMER
- TR. TYPICAL
- USPS UNITED STATES POSTAL SERVICE
- U.E. UTILITY EASEMENT
- VERT. VERTICAL
- W. WATER
- WM WATER MAIN
- W. WITH
- W/O WITHOUT
- WD. WOOD
- WT. WEIGHT
- WSWT WET SEASON WATER TABLE
- W.V. WATER VALVE

SYMBOLS

- ▲ GATE VALVE / PLUG VALVE
- ⊥ TEE ASSEMBLY
- REDUCER
- ⊕ FIRE HYDRANT
- ⊕ FIRE HYDRANT ASSEMBLY WITH GATE VALVE
- ⊕ MITERED END SECTION
- ⊕ MANHOLE (EXISTING)
- ⊕ HEADWALL
- ⊕ DRAINAGE INLET
- ⊕ CONCRETE UTILITY POLE
- ⊕ WOOD UTILITY POLE
- ⊕ GUY WIRE ANCHOR
- ⊕ LIGHT POLE
- ⊕ TELEPHONE SERVICE PEDESTAL
- ⊕ SIGN
- ⊕ NATURAL GAS MARKER
- ⊕ CLEAN-OUT
- ⊕ MAILBOX (EXISTING)
- ⊕ PROPERTY CORNER
- ⊕ WATER METER
- ⊕ BACKFLOW PREVENTION DEVICE
- ⊕ WOOD POST
- ⊕ CONCRETE BOLLARD
- ⊕ ELECTRICAL TRANSFORMER
- ⊕ SUPPORT COLUMN

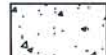
HATCH PATTERNS

-  WETLANDS
-  UPLAND BUFFER
-  UPLAND AREAS
-  LITTORAL SHELF AREA
-  COMPENSATING LITTORAL PLANTING AREA
-  RIP RAP
-  PROPOSED WATER
-  EXISTING WATER
-  INDIGENOUS AREA
-  EARTH
-  CONCRETE
-  BRICK PAVERS
-  GRAVEL BACKFILL

LINETYPES

	EXISTING	PROPOSED
RIGHT OF WAY	---	---
LAKE MAINTENANCE EASEMENT	---	---
PUBLIC UTILITY EASEMENT	---	---
DRAINAGE EASEMENT	---	---
CENTER LINE	---	---
WETLAND BOUNDARY	---	---
FORCE MAIN	FM	FM
SANITARY SEWER	SS	SS
WATER MAIN	WM	WM
STORM WATER PIPE	---	---
PERIMETER BERM		
FENCE LINE	---	---
SILT FENCE	---	---
DITCH	---	---
DRAINAGE BASIN BOUNDARY	---	---
COASTAL CONSTRUCTION CONTROL LINE (MAY 30, 1991)	---	---
10-YEAR STILL WATER ELEVATION (2.5' NAVD88)	~~~~~	~~~~~
MEAN HIGH WATER ELEVATION (0.14' NAVD88)	~~~~~	~~~~~
10-YEAR STILL WATER ELEVATION (4.9' NAVD88) (OPEN COAST)	~~~~~	~~~~~

SPECIFICATIONS, PERMITS, and CONDITIONS

THE WORD "TOWN" SHALL MEAN THE "TOWN OF FORT MYERS BEACH".

ALL CONSTRUCTION SHALL BE IN ACCORDANCE WITH THE FLORIDA DEPARTMENT OF TRANSPORTATION (FDOT) "STANDARD SPECIFICATIONS FOR ROAD AND BRIDGE CONSTRUCTION" (LATEST EDITION), UNLESS OTHERWISE SPECIFIED. ALL TYPICAL DETAILS ARE PER FDOT "DESIGN STANDARDS" (LATEST EDITION), LEE COUNTY UTILITIES (SEWER), AND TOWN OF FORT MYERS BEACH (WATER) - UNLESS OTHERWISE SPECIFIED.

ALL CONSTRUCTION SHALL COMPLY WITH THE APPLICABLE PERMITS FROM THE SOUTH FLORIDA WATER MANAGEMENT DISTRICT (SFWMD) AND U.S. ARMY CORPS OF ENGINEERS (USACE).

THE CONTRACTOR SHALL CONTACT THE PROJECT ENGINEER PRIOR TO THE INITIATION OF ANY DEVIATION FROM THE APPROVED PLANS. NO SUCH DEVIATION(S) SHALL BE AUTHORIZED WITHOUT PRIOR WRITTEN APPROVAL BY THE PROJECT ENGINEER. IF A REQUIRED DIMENSION IS NOT SHOWN OR A DISCREPANCY IS FOUND ON THE PLANS, THE CONTRACTOR SHALL CONTACT THE PROJECT ENGINEER PRIOR TO COMMENCING THAT PART OF THE AFFECTED CONSTRUCTION.

PROVISIONS FOR EXISTING DRAINAGE PATTERNS SHALL BE PROVIDED DURING CONSTRUCTION.

THE CONTRACTOR SHALL BE RESPONSIBLE FOR OBTAINING ANY REQUIRED Dewatering PERMITS.

THE LOCATIONS AND ELEVATIONS OF THE PROPOSED IMPROVEMENTS ARE SUBJECT TO MODIFICATION IN THE FIELD BY TOWN OR PROJECT ENGINEER TO PRESERVE EXISTING FEATURES.

THE CONTRACTOR SHALL RESTORE ALL DISTURBED AREAS OUTSIDE THE CONSTRUCTION AREA (RIGHT OF WAY) TO THEIR ORIGINAL OR BETTER CONDITION AT NO ADDITIONAL PAY.

ALL DAMAGE(S) TO THE EXISTING ROADWAY, DRIVEWAYS, SIDEWALKS, UTILITIES, OR OTHER APPURTENANCES SHALL BE REPLACED BY THE CONTRACTOR AS DIRECTED BY THE TOWN/PROJECT ENGINEER AT NO ADDITIONAL PAY.

THE CONTRACTOR SHALL REMOVE ALL DEBRIS AND REFUSE FROM CONSTRUCTION AREA (RIGHT OF WAY) AND DISPOSE OF ACCORDING TO ALL APPLICABLE REGULATIONS.

DURING CONSTRUCTION, IF ANY FORTUITOUS (HISTORICAL OR ARCHAEOLOGICAL) FINDS ARE DISCOVERED OR OBSERVED, ALL WORK SHALL CEASE IN THE AREA. THE CONTRACTOR SHALL IMMEDIATELY CONTACT THE PROJECT ENGINEER WHO WILL NOTIFY THE TOWN. EXAMPLES MAY INCLUDE FRAGMENTS OF STONE TOOLS, SHELLS, SHELL TOOLS, POTTERY, GLASS, BOTTLES, ANIMAL BONES, BUILDING FOUNDATIONS, SHELL MOUNDS OR SAND MOUNDS. THE TOWN WILL ASSESS THE SIGNIFICANCE OF THE FINDS IN A TIMELY MANNER.

IF ANY HUMAN SKELETAL REMAINS (UNMARKED BURIALS) ARE FOUND, ALL WORK IN THE AREA SHALL STOP AND THE NEAREST (LOCAL) LAW ENFORCEMENT OFFICE SHALL BE IMMEDIATELY NOTIFIED. ACCORDING TO STATE LAW (F.S. 872.05), IT IS UNLAWFUL TO DAMAGE OR DESTROY A HUMAN BURIAL SITE.

ALL EXCAVATION(S) SHALL BE CONSIDERED AS "UNCLASSIFIED".

SURVEYS and MONUMENTATION

THE BASE DRAWING INFORMATION REPRESENTS THE INFORMATION CONTAINED IN THE SPECIFIC PURPOSE SURVEY (RIGHT OF WAY and MUNICIPAL IMPROVEMENTS) PROVIDED BY METRON SURVEYING, INC. DATED 5/29/2009. ALL ELEVATIONS ARE BASED UPON NORTH AMERICAN VERTICAL DATUM OF 1988 (NAVD88) AS ESTABLISHED BY METRON SURVEYING, INC.

THESE DRAWINGS ARE NOT INTENDED TO REPRESENT A BOUNDARY SURVEY AS DEFINED BY FLORIDA STATUTE.

ALL EXISTING MONUMENTATION SHALL BE PROTECTED. IF ANY MONUMENTATION IS DISTURBED OR DESTROYED, IT SHALL BE REPLACED AFTER CONSTRUCTION IS COMPLETE, TO THE REQUIRED ACCURACY, BY A FLORIDA LICENSED PROFESSIONAL SURVEYOR AND MAPPER (PSM) AT THE CONTRACTOR'S EXPENSE.

A PERMANENT BENCHMARK(S) SHALL BE ESTABLISHED WITHIN 100' OF EACH STORM WATER STRUCTURE OR GROUP OF STORM WATER STRUCTURES BY A FLORIDA STATE LICENSED PROFESSIONAL SURVEYOR & MAPPER (PSM).

THE CONTRACTOR SHALL MAINTAIN A CURRENT AND UPDATED SET OF AS-BUILT DRAWINGS AT ALL TIMES AND PROVIDE ONE (1) COPY TO THE PROJECT ENGINEER UPON COMPLETION OF CONSTRUCTION.

PROPRIETARY PRODUCT(S) SUBSTITUTION APPROVAL

THE PRODUCT AND/OR MATERIAL SELECTIONS FOR THE PROPRIETARY COMPONENTS SHOWN ON THESE PLANS WERE DETERMINED BASED ON THEIR APPLICATION(S) TO THIS PROJECT. THE PRODUCT AND/OR MATERIAL SPECIFIED SHALL BE CONSIDERED THE MINIMUM PERFORMANCE ACCEPTABLE IN ACCORDANCE WITH THE ASSOCIATED PRODUCT(S). THE CONTRACTOR HAS THE OPPORTUNITY TO PROPOSE ALTERNATIVE PRODUCTS AND/OR MATERIALS FOR THE PURPOSES OF PROVIDING AN "OR EQUAL" SUBSTITUTION. HOWEVER, THE PROPOSED ALTERNATIVE PRODUCT(S) AND/OR MATERIALS SHALL PROVIDE AT LEAST THE SAME QUALITIES AS THOSE SPECIFIED FOR THE APPLICATION. ALL PRODUCT(S) AND/OR MATERIAL SHALL EQUALLY CONFORM TO THE LATEST ASTM SPECIFICATIONS OR OTHER LISTED COMMERCIAL SPECIFICATIONS (e.g. U.L.) COVERING THE CLASS OR KIND OF PRODUCT(S) AND/OR MATERIAL(S) BEING USED. ALL PRODUCT(S) AND/OR MATERIAL(S) SHALL DEMONSTRATE A MINIMUM OF FIVE (5) SOUTHWEST FLORIDA INSTALLATIONS THAT HAVE A MINIMUM CONTINUOUS IN-SERVICE PERIOD OF FIVE (5) YEARS.

PAVING, GRADING and DRAINAGE

ALL CULVERTS AND STORM SEWER PIPE SHALL BE REINFORCED CONCRETE PIPE (RCP) UNLESS OTHERWISE NOTED ON THE PLANS. ALL CONCRETE PIPE SHALL CONFORM TO CLASS III (ASTM C76) FOR ROUND PIPE AND CONFORM TO TABLE I FOR CLASS HE-III (ASTM C507) FOR ELLIPTICAL PIPE. ALL PIPE JOINTS SHALL USE RUBBER GASKETS (ROUND) OR PREFORMED PLASTIC (ELLIPTICAL), BE WRAPPED PER FDOT SPECIFICATIONS, AND LIFTING HOLES SHALL NOT BE PERMITTED.

THE CONTRACTOR SHALL SUBMIT SHOP DRAWINGS FOR EACH INLET FOR REVIEW AND WRITTEN APPROVAL BY THE PROJECT ENGINEER PRIOR TO FABRICATION. ALL INLETS ARE TO BE PROVIDED WITH PER FDOT STANDARD INDEX (LATEST EDITION).

DURING CONSTRUCTION, GRATE INLET AND JUNCTION BOX OPENINGS SHALL BE APPROPRIATELY COVERED WITH FILTER FABRIC (MIRAFI 140N OR APPROVED EQUAL) TO PREVENT DEBRIS AND SILTATION FROM ENTERING INTO THE STORM SYSTEM.

VERTICAL AND STRAIGHT "SAW CUTS" THROUGH EXISTING PAVEMENT AND BASE MATERIAL ARE REQUIRED WHERE NEW PAVEMENT MATCHES TO EXISTING PAVEMENT.

ALL BACKFILLING SHALL BE PLACED IN MAXIMUM EIGHT INCH (8") LOOSE LIFTS AND COMPACTED TO A MINIMUM OF 95% MAXIMUM DENSITY PER ASTM 1557, EXCEPT AS OTHERWISE PROVIDED OR INDICATED.

ALL SURFACES SHALL VARY EVENLY AND SMOOTHLY BETWEEN THE INDICATED GRADES. A 2-1/2" ALLOWANCE (OVER EXCAVATION) SHALL BE PROVIDED FOR ALL AREAS TO BE SODDED FROM THAT SHOWN AS "FINISHED GRADE" TO THAT OF "TOP OF SOD".

THE CONTRACTOR SHALL PROVIDE COMPLIANT IN-PLACE DENSITY TESTS (1 PER 500 ± SQUARE FEET) TO THE PROJECT ENGINEER FOR THE LIMEROCK BASE AREAS PRIOR TO PLACEMENT OF THE ASPHALT PAVING.

EXISTING UTILITIES

THE WATERMAIN LOCATIONS ARE SHOWN AS WAS GRAPHICALLY DISCERNIBLE FROM THE RECORD DRAWINGS PROVIDED BY THE TOWN OF FORT MYERS BEACH. THE SIZE WAS ASSUMED AS 6" DIAMETER WITH AN AVERAGE DEPTH OF 24"/30" (2.25') TO TOP OF PIPE.

THE ELEVATIONS OF SEWER MAINS AND MANHOLES ARE SHOWN AS WAS GRAPHICALLY DISCERNIBLE FROM THE RECORD DRAWINGS PROVIDED BY THE TOWN OF FORT MYERS BEACH. THESE ELEVATIONS WERE CONVERTED FROM NAVD89 TO NAVD88 BY SUBTRACTING 1.18' FROM THAT INDICATED.

ALL ADJUSTMENTS OR RELOCATIONS OF ANY UTILITY SHALL BE IN ACCORDANCE WITH THE OWNER'S SPECIFICATIONS AND DETAILS.

THE LOCATIONS OF ALL UTILITIES AS INDICATED ARE APPROXIMATE AND MAY VARY. THE CONTRACTOR SHALL BE RESPONSIBLE FOR VERIFICATION AND PROTECTION OF ALL EXISTING UTILITIES PRIOR TO AND DURING CONSTRUCTION.

PROVISIONS FOR PROTECTION AND OPERATION OF THE WATER AND SEWER SERVICES SHALL BE THE CONTRACTOR'S RESPONSIBILITY.

THE CONTRACTOR SHALL BE LIABLE FOR ALL DAMAGES INCURRED TO ANY UTILITIES DURING CONSTRUCTION. THE CONTRACTOR SHALL NOTIFY THE UTILITY OWNER(S) AT LEAST 72 HOURS PRIOR TO BEGINNING WORK AFFECTING ANY UTILITY.

STORM WATER POLLUTION PREVENTION PLAN (SWP3)

THE CONTRACTOR SHALL PROVIDE THE TOWN AND PROJECT ENGINEER WITH A COPY OF THE NOTICE OF INTENT (NOI) AND THE STORM WATER POLLUTION PREVENTION PLAN (SWP3) IN COMPLIANCE WITH THE FLORIDA DEPARTMENT OF ENVIRONMENTAL PROTECTION GUIDELINES AND CRITERIA PRIOR TO THE START OF CONSTRUCTION.

ALL POLLUTION PREVENTION CONTROL MEASURES SHALL BE INSPECTED WEEKLY AND AFTER ANY STORM EVENT(S) GREATER THAN 1/2 INCH IN 24 HOURS.

ALL POLLUTION PREVENTION CONTROL MEASURES SHALL BE MAINTAINED IN PROPER WORKING ORDER. ALL REPAIRS SHALL BE INITIATED IMMEDIATELY, BUT NOT LONGER THAN TWENTY-FOUR (24) HOURS AFTER DISCOVERY.

TRAFFIC CONTROL PLAN

CONTRACTOR SHALL SUBMIT A CONSTRUCTION TRAFFIC CONTROL PLAN TO THE TOWN AND PROJECT ENGINEER FOR REVIEW AND APPROVAL PRIOR TO MOBILIZATION. ALLOW 7 - 10 BUSINESS DAYS FOR THE REVIEW. THE CONTRACTOR SHALL PROVIDE THE PROJECT ENGINEER WITH A COPY OF THE APPROVED CONSTRUCTION TRAFFIC CONTROL PLAN.

THE MAINTENANCE OF TRAFFIC (MOT) SHALL FOLLOW THE MUTCD AND FDOT STANDARD INDEX 600 (LATEST EDITION) PROCEDURES, INCLUDING ANY FLAGGING.

WASTE MANAGEMENT and DISPOSAL

THIS PROJECT SHALL BE SERVED BY PORTABLE SANITARY FACILITIES DURING CONSTRUCTION.

ALL WASTE MATERIAL SHALL BE COLLECTED AND STORED IN A LIDDED METAL CONTAINER AND IN ACCORDANCE WITH THE TOWN'S SOLID WASTE REGULATIONS. THE DUMPSTER SHALL BE EMPTIED A MINIMUM OF ONCE A WEEK OR MORE OFTEN, IF NECESSARY.

ALL HAZARDOUS OR TOXIC MATERIAL SHALL BE PROPERLY CONTAINED AND DISPOSED OF IN ACCORDANCE WITH THE APPROPRIATE STATE AND/OR FEDERAL REGULATIONS.

ANY FUEL OR OTHER PETROLEUM PRODUCTS RELEASED SHALL BE ADDRESSED IMMEDIATELY BY THE CONTRACTOR IN ACCORDANCE WITH CHAPTER 62-770 (FAC).

CONSTRUCTION DOCUMENTATION

THE CONTRACTOR SHALL MAINTAIN, ON THE WORK SITE, A CURRENT COPY OF ANY PERMITS NECESSARY FOR CONSTRUCTION AND AN UPDATED SET OF AS-BUILT DRAWINGS AT ALL TIMES. THE CONTRACTOR SHALL ACCURATELY INDICATE THE LOCATIONS AND DEPTHS OF ALL CONSTRUCTED IMPROVEMENTS AND PROVIDE ONE (1) COPY TO THE PROJECT ENGINEER UPON THE COMPLETION OF CONSTRUCTION.

THE CONTRACTOR SHALL OBTAIN PRE-CONSTRUCTION PHOTOGRAPHS AND VIDEO OF THE PROJECT AREA CLEARLY DEPICTING THE CONDITION OF THE CONSTRUCTION AREA(S) AND ADJACENT PROPERTIES. THE VIDEO SHALL DIRECT SPECIFIC ATTENTION TO ITEMS SUCH AS FENCES, LANDSCAPING, DECORATIVE AMENITIES, PAVEMENT CONDITIONS, AND EXISTING UTILITIES. A COPY OF THE PHOTOGRAPHS SHALL BE PROVIDED TO THE TOWN ON A "CD" IN "JPG" FORMAT AND A COPY OF THE VIDEO SHALL BE PROVIDED TO THE TOWN ON A "DVD" IN "MPG" FORMAT. SUBSEQUENT TO THE COMPLETION OF RESTORATION ACTIVITIES, THE CONTRACTOR SHALL OBTAIN POST-CONSTRUCTION PHOTOGRAPHS AND VIDEO TO DOCUMENT THE SATISFACTORY RESTORATION OF THE CONSTRUCTION AREA(S) IN THE SAME FASHION AS ABOVE AND PROVIDED TO THE TOWN.

REVISIONS

NO.	DESCRIPTION	DATE

BRADLEY S. WANCE
FLORIDA P.E. #0266

10-15-09

Environmental Consulting & Technology, Inc.
4100 Center Pointe Drive, Suite 112
Fort Myers, FL 33916
(239) 277-0003
CA#4550

TOWN OF FORT MYERS BEACH

CLIENT: TOWN OF FORT MYERS BEACH

PROJECT: BASIN BASED NEIGHBORHOOD FLOOD MITIGATION AND STORMWATER QUALITY IMPROVEMENT PROJECT
FEIMA HMGPP 1609-48-R
TOWN OF FORT MYERS BEACH

ABBREVIATIONS, LEGENDS AND STANDARD NOTES

SHEET TITLE: C-02

DATE: SEPTEMBER 2009

PROJECT NO: 08-1063

FILE NO: 19-46-24

SCALE: NONE

SHEET NUMBER

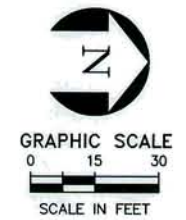
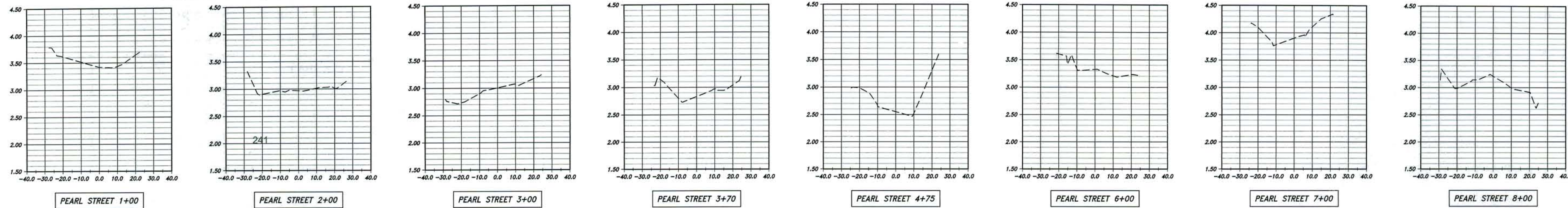

SECTIONS
SCALE: 1"=30' HORIZ.
1"=1' VERT.

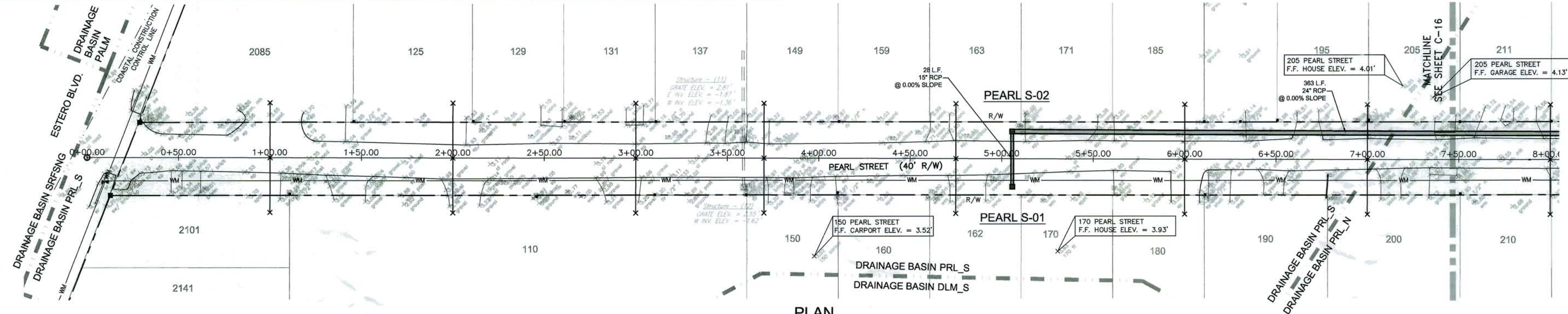

PLAN
SCALE: 1"=30'

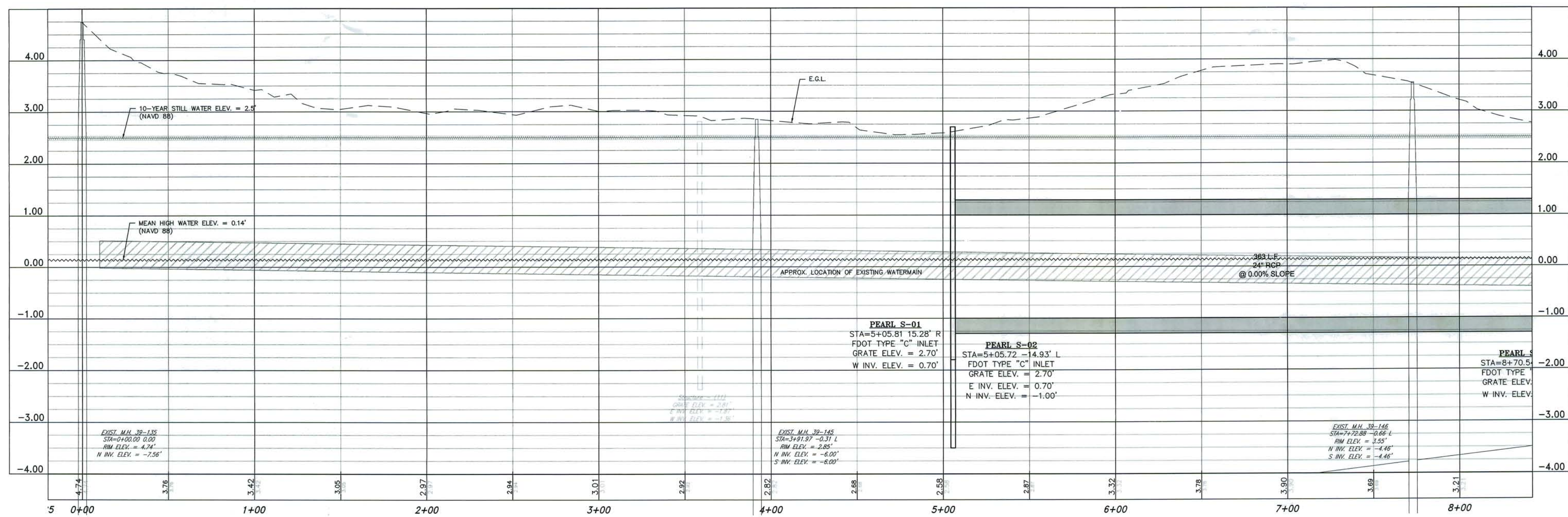

PROFILE
SCALE: 1"=30' HORIZ.
1"=1' VERT.

S. LEONARD PROJECTS (MGP, 1609-46-R) (DIRS) (PERM) (P) - PEARL ST. Oct 15, 2009 - 11:28am Jorman

NO.	REVISIONS	DESCRIPTION	DATE

ECT
Environmental Consulting & Technology, Inc.
4100 Center Pointe Drive, Suite 112
Fort Myers, FL 33916
(239) 277-0003
CAP#5520

TOWN OF FORT MYERS BEACH
2523 ESTERO BLVD.
FORT MYERS BEACH, FL 33931
(239) 765-0202

BASIN BASED NEIGHBORHOOD FLOOD MITIGATION AND STORMWATER QUALITY IMPROVEMENT PROJECT
FEMA HMGP 1609-48-R
TOWN OF FORT MYERS BEACH

PLAN, PROFILE AND CROSS SECTIONS PEARL STREET

DATE: SEPTEMBER 2009
PROJECT NO: 08-1063
FILE NO: 19-46-24
SCALE: AS SHOWN
SHEET NUMBER
C-15

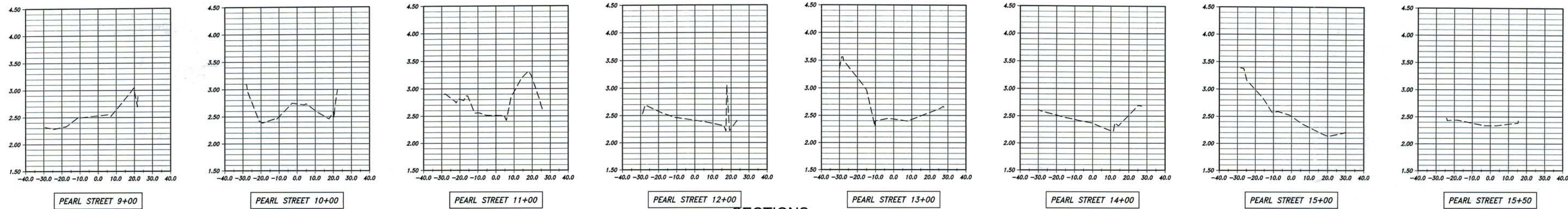

SECTIONS
SCALE: 1"=30' HORIZ.
1"=1' VERT.

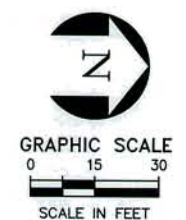

NO.	DESCRIPTION	DATE

ECT
Environmental Consulting & Technology, Inc.
4100 Center Pointe Drive, Suite 112
Fort Myers, FL 33916
(239) 277-0003
CA#5520

TOWN OF FORT MYERS BEACH
2523 ESTERO BLVD.
FORT MYERS BEACH, FL 33931
(239) 765-0202

BASIN BASED NEIGHBORHOOD FLOOD MITIGATION AND STORMWATER QUALITY IMPROVEMENT PROJECT
FEMA HMGP 1609-48-R
TOWN OF FORT MYERS BEACH

PLAN, PROFILE AND CROSS SECTIONS PEARL STREET
DATE: SEPTEMBER 2009
PROJECT NO: 08-1063
FILE NO: 19-46-24
SCALE: AS SHOWN
SHEET NUMBER
C-16

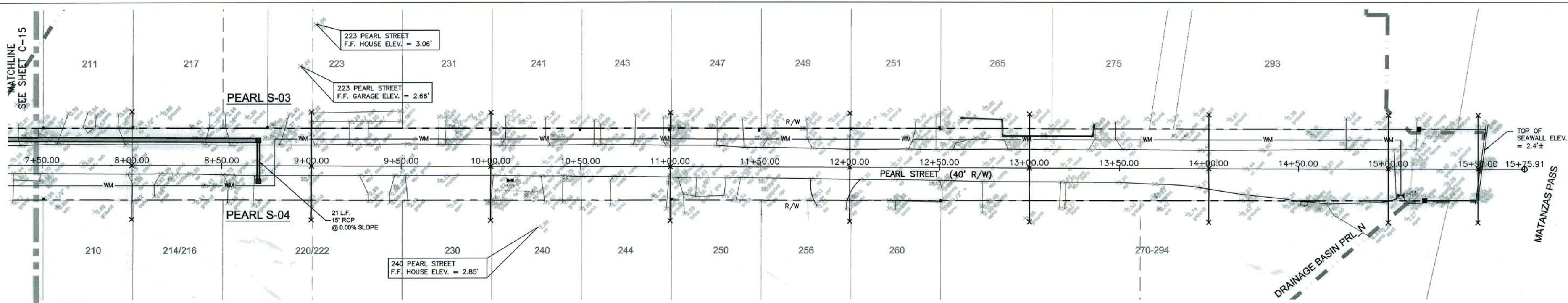

PLAN
SCALE: 1"=30'

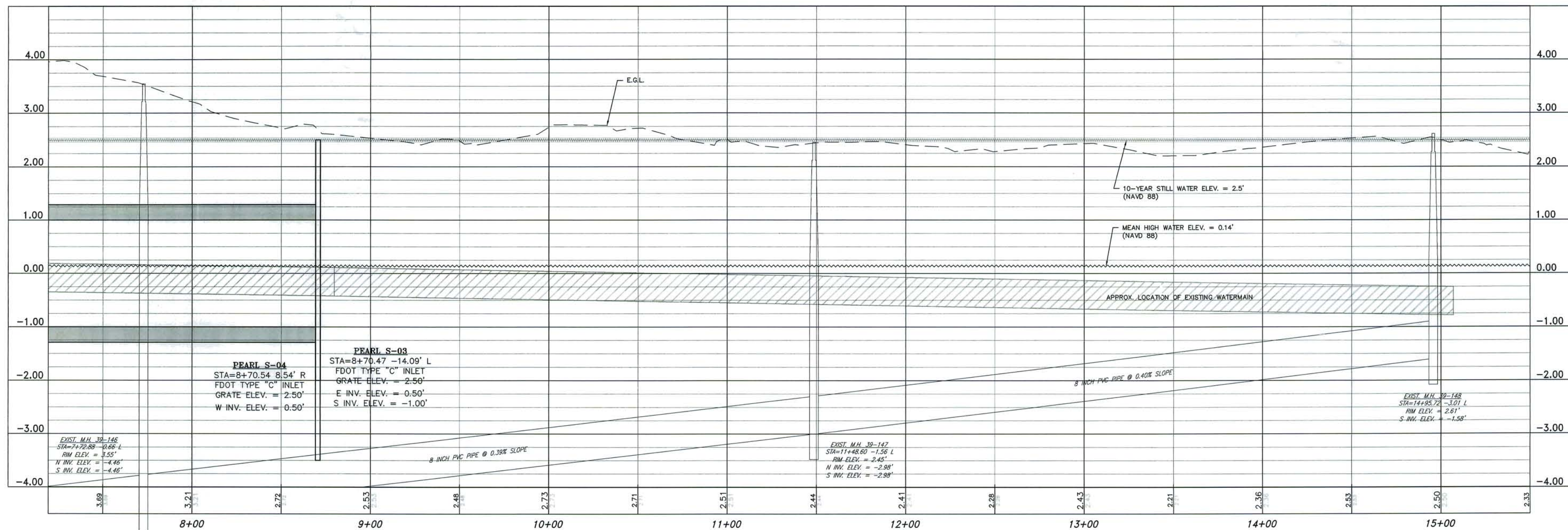

PROFILE
SCALE: 1"=30' HORIZ.
1"=1' VERT.

S:\ENGINEERING\PROJECTS\1609-48-R\1609-48-R\1609-48-R\PEARL.dwg (Layout2) Oct 15, 2009 - 11:20am - Pearson

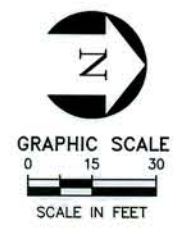
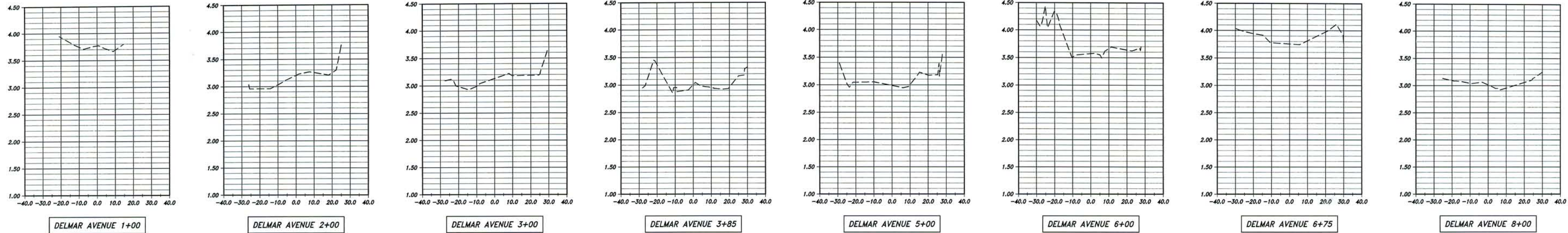

NO.	DESCRIPTION	DATE
1	Initial Design	10-15-09

SECTIONS
SCALE: 1"=30' HORIZ.
1"=1' VERT.

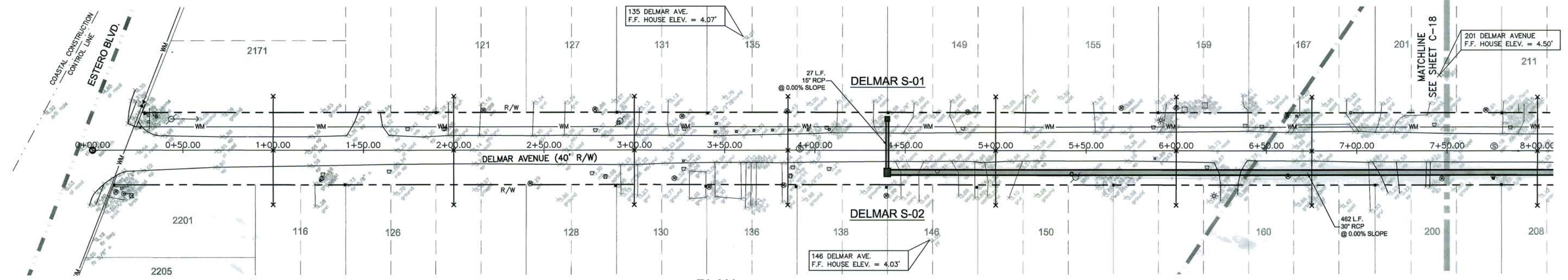

PLAN
SCALE: 1"=30'

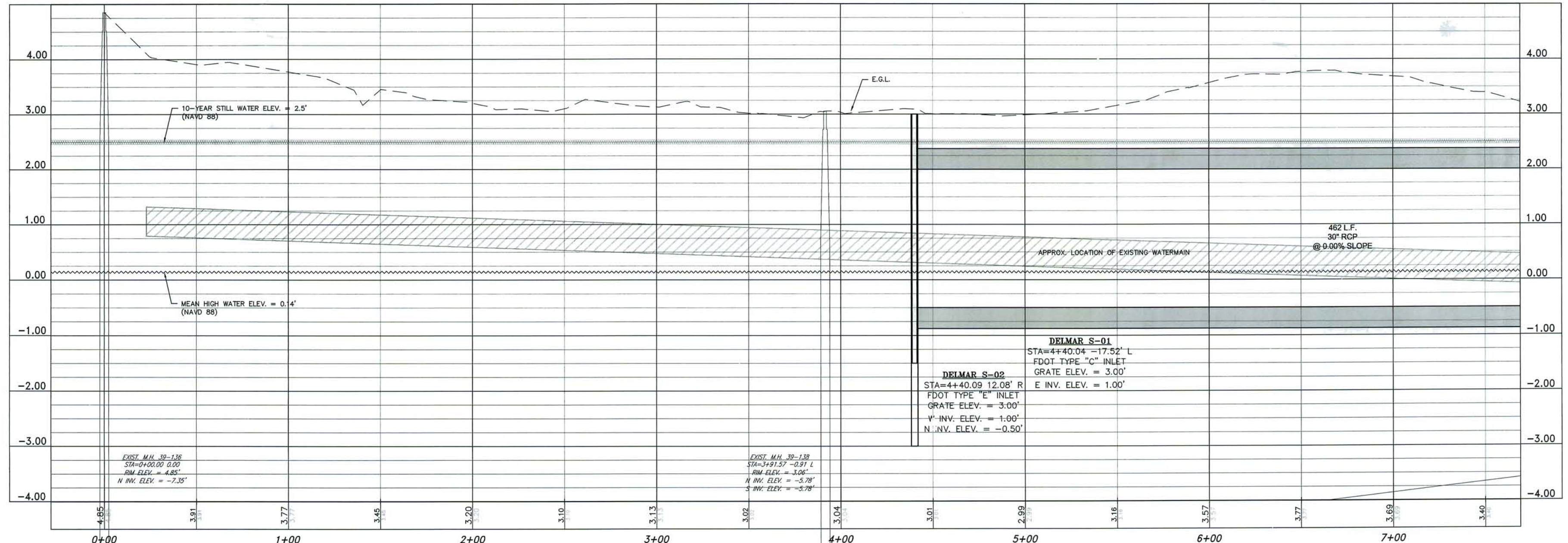

PROFILE
SCALE: 1"=30' HORIZ.
1"=1' VERT.

ECT
Environmental Consulting & Technology, Inc.
4100 Center Points Drive, Suite 112
Fort Myers, FL 33916
(239) 277-0003
CA#5520

TOWN OF FORT MYERS BEACH
2523 ESTERO BLVD.
FORT MYERS BEACH, FL 33931
(239) 765-0202

BASIN BASED NEIGHBORHOOD FLOOD MITIGATION AND STORMWATER QUALITY IMPROVEMENT PROJECT
FEMA #MGP 1609-48-R
TOWN OF FORT MYERS BEACH

PLAN, PROFILE AND CROSS SECTIONS DELMAR AVENUE

DATE: SEPTEMBER 2009
PROJECT NO: 08-1063
FILE NO: 19-46-24
SCALE: AS SHOWN

SHEET NUMBER
C-17

S:\ENGINEERING\PROJECTS\1946-24-F\Drawings\PERM\1946-24-F-DELMAR.dwg (Layout1) Oct 15, 2009 - 12:23pm Jernson

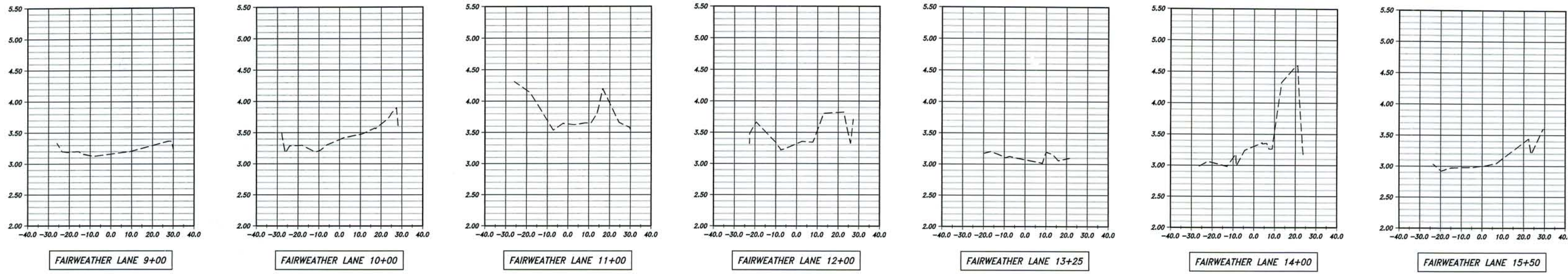

SECTIONS
SCALE: 1"=30' HORIZ.
1"=1' VERT.

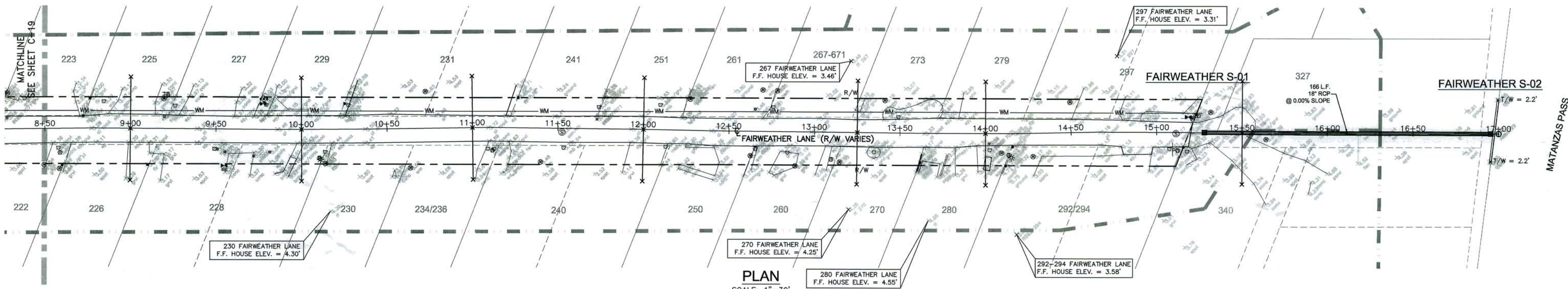

PLAN
SCALE: 1"=30'

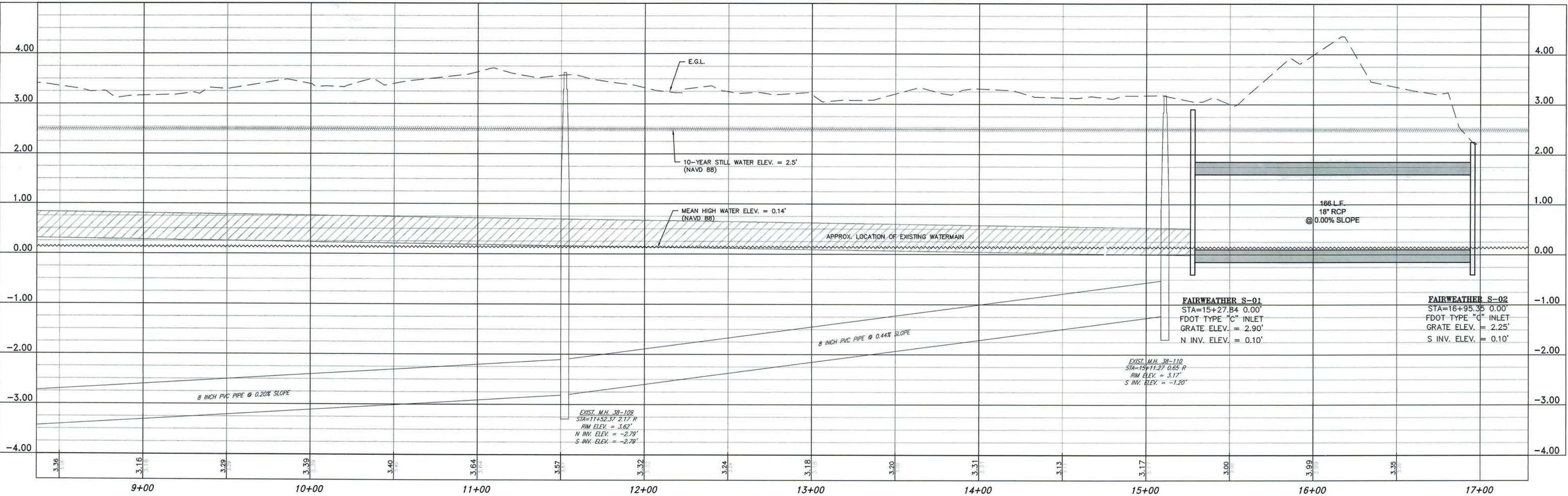

PROFILE
SCALE: 1"=30' HORIZ.
1"=1' VERT.

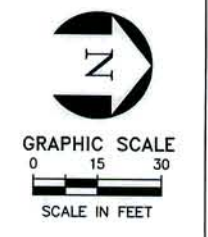

NO.	REVISIONS	DATE

ECT
Environmental Consulting & Technology, Inc.
4100 Center Pointe Drive, Suite 112
Fort Myers, FL 33916
(239) 277-0003
CA#5520

CLIENT:
TOWN OF FORT MYERS BEACH
2523 ESTERO BLVD.
FORT MYERS BEACH, FL 33931
(239) 665-0202

PROJECT:
BASIN BASED NEIGHBORHOOD FLOOD MITIGATION AND STORMWATER QUALITY IMPROVEMENT PROJECT
FEMA HMGP 1609-48-R
TOWN OF FORT MYERS BEACH

SHEET TITLE:
PLAN, PROFILE AND CROSS SECTIONS FAIRWEATHER LANE

DATE: SEPTEMBER 2009
PROJECT NO: 08-1063
FILE NO: 19-46-24
SCALE: AS SHOWN
SHEET NUMBER
C-20

S:\ENGINEERING\PROJECTS\1609-48-R\1609-48-R\DWG\PERMIT\19-FAIRWEATHER.dwg Oct 15, 2009 - 11:20am jharmon

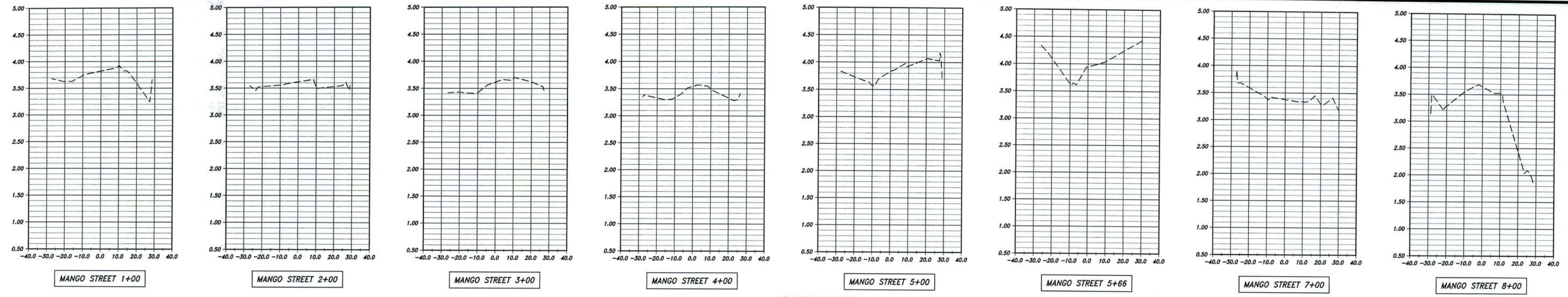

SECTIONS
SCALE: 1"=30' HORIZ.
1"=1' VERT.

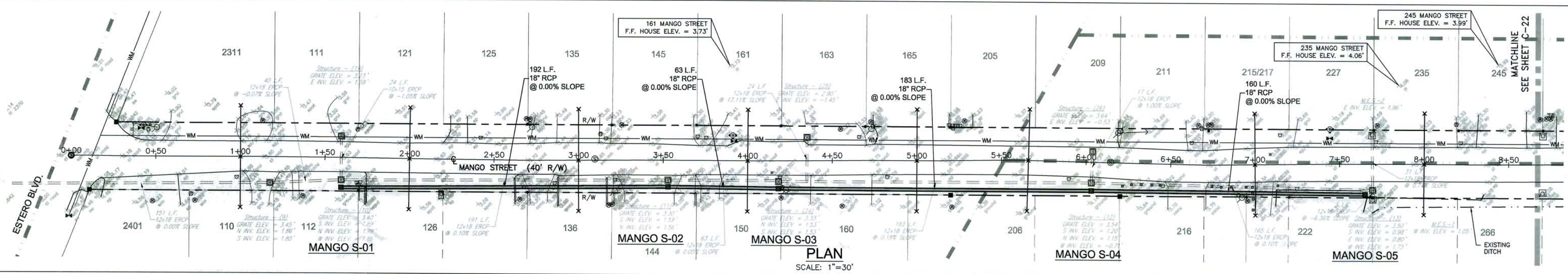

PLAN
SCALE: 1"=30'

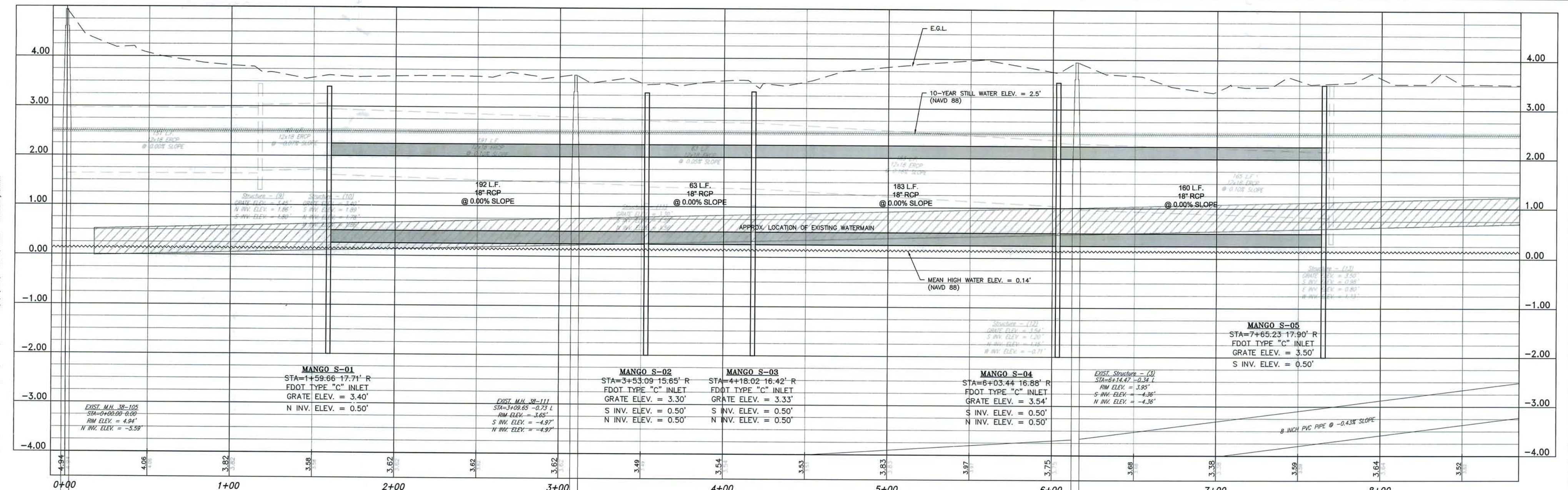

PROFILE
SCALE: 1"=30' HORIZ.
1"=1' VERT.

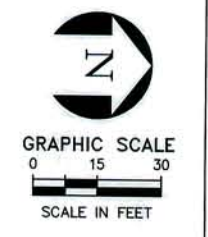

NO.	REVISIONS	DESCRIPTION	DATE
1			
2			
3			
4			
5			
6			
7			
8			
9			
10			

ECT
Environmental Consulting & Technology, Inc.
4100 Center Pointe Drive, Suite 112
Fort Myers, FL 33916
(239) 277-0003
CA#5520

TOWN OF FORT MYERS BEACH
2523 ESTERO BLVD
FORT MYERS BEACH, FL 33931
(239) 765-0202

BASIN BASED NEIGHBORHOOD FLOOD MITIGATION AND STORMWATER QUALITY IMPROVEMENT PROJECT
FEMA HMGP 1609-48-R
TOWN OF FORT MYERS BEACH

PLAN, PROFILE AND CROSS SECTIONS MANGO STREET

DATE: SEPTEMBER 2009
PROJECT NO: 08-1063
FILE NO: 19-46-24
SCALE: AS SHOWN
SHEET NUMBER
C-21

S:\ENGINEERING\PROJECTS\1609-48-R\1609-48-R\DWG\19-46-24\19-46-24-24-C-21.dwg (Lognet) Oct 15, 2009 - T.J. Keen, Norman

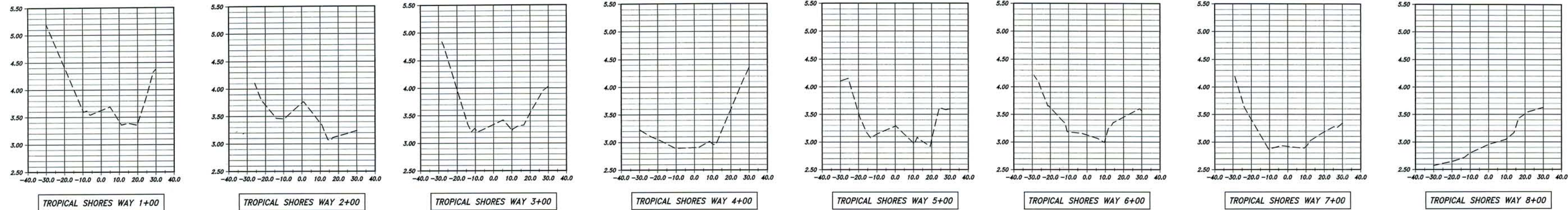

SECTIONS
SCALE: 1"=30' HORIZ.
1"=1' VERT.

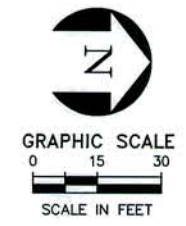

NO.	DESCRIPTION	DATE

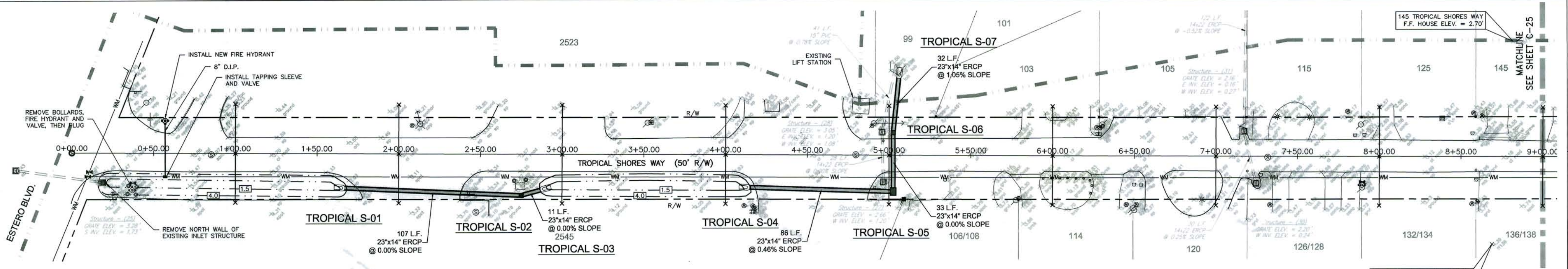

PLAN
SCALE: 1"=30'

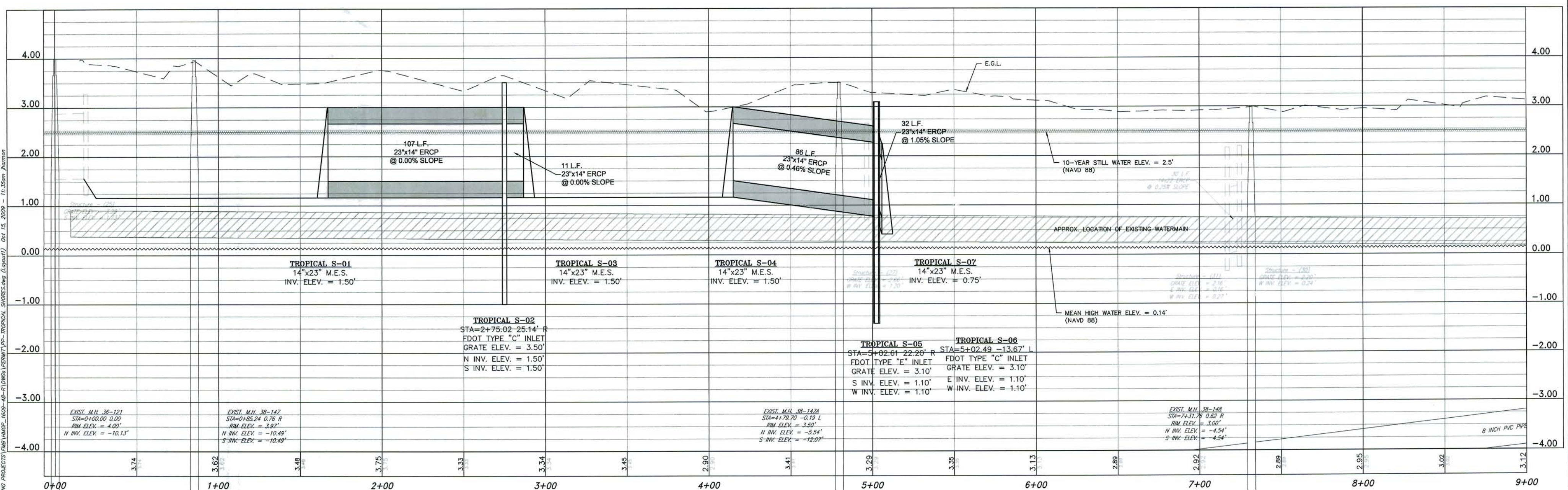

PROFILE
SCALE: 1"=30' HORIZ.
1"=1' VERT.

S:\ENGINEERING\PROJECTS\1609-48-R\1609-48-R-FLOODING\FEMA\FINAL\PH-TROPICAL SHORES WAY.dwg (Lpatt) Rev. 15, 2009 - 11:35am Norman

ECT
Environmental Consulting & Technology, Inc.
4100 Center Pointe Drive, Suite 112
Fort Myers, FL 33916
(239) 277-0003
CA#5560

TOWN OF FORT MYERS BEACH
2523 ESTERO BLVD.
FORT MYERS BEACH, FL 33931
(239) 766-0202

BASIN BASED NEIGHBORHOOD FLOOD MITIGATION AND STORMWATER QUALITY IMPROVEMENT PROJECT
TOWN OF FORT MYERS BEACH

PLAN, PROFILE AND CROSS SECTIONS TROPICAL SHORES WAY

DATE: SEPTEMBER 2009
PROJECT NO: 08-1063
FILE NO: 19-46-24
SCALE: AS SHOWN
SHEET NUMBER
C-24

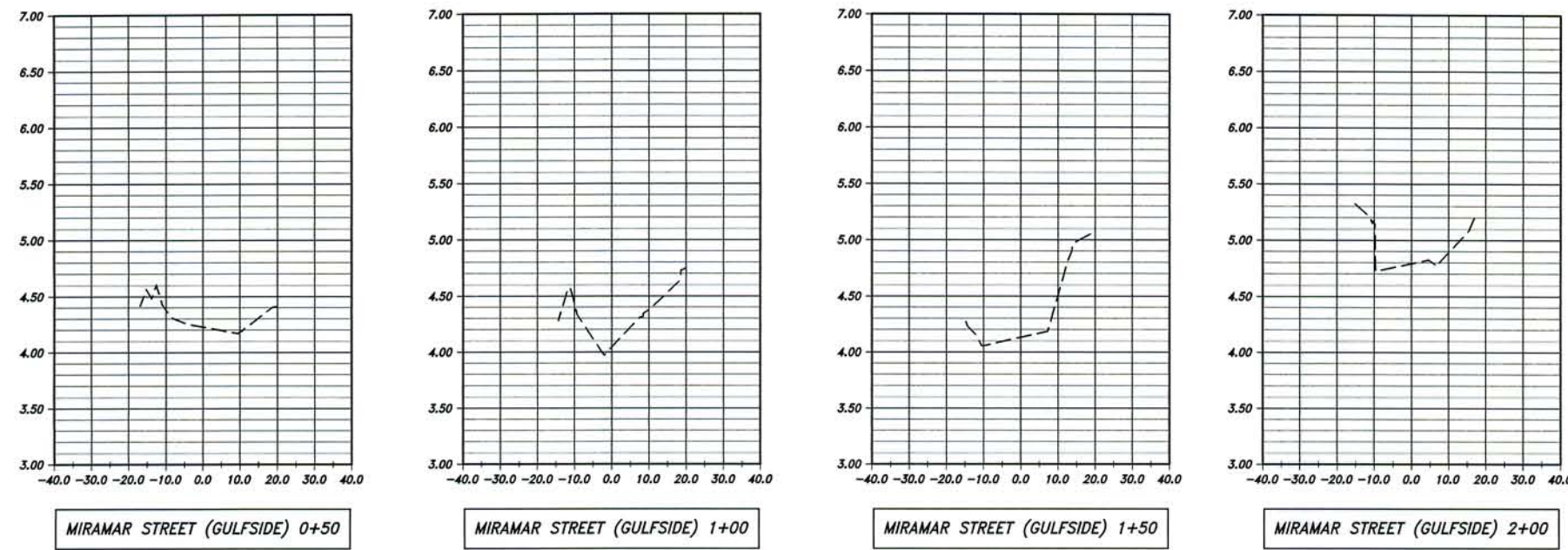

SECTIONS
SCALE: 1"=30' HORIZ.
1"=1' VERT.

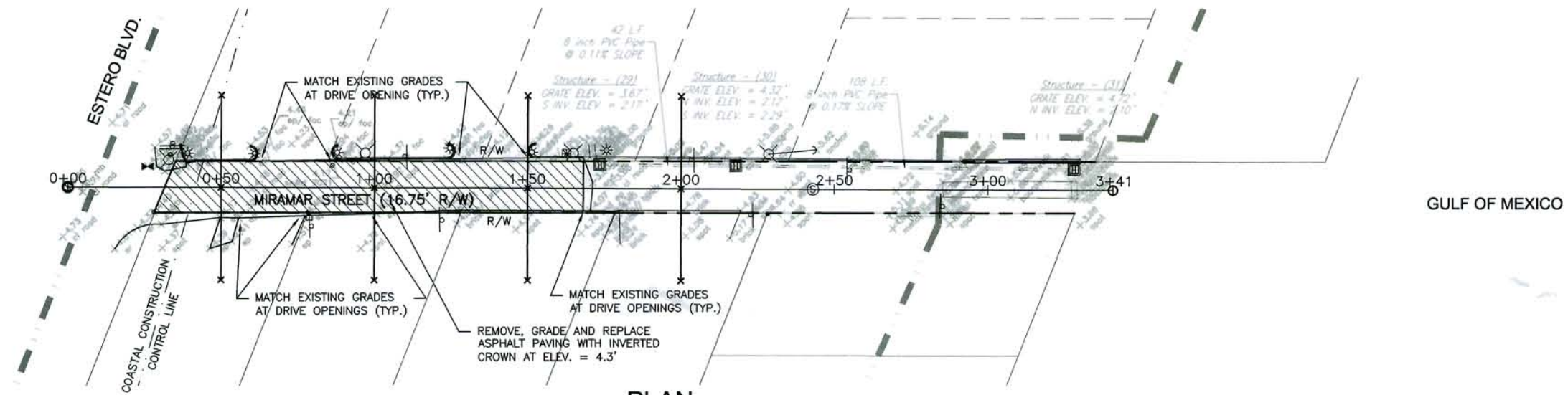

PLAN
SCALE: 1"=30'

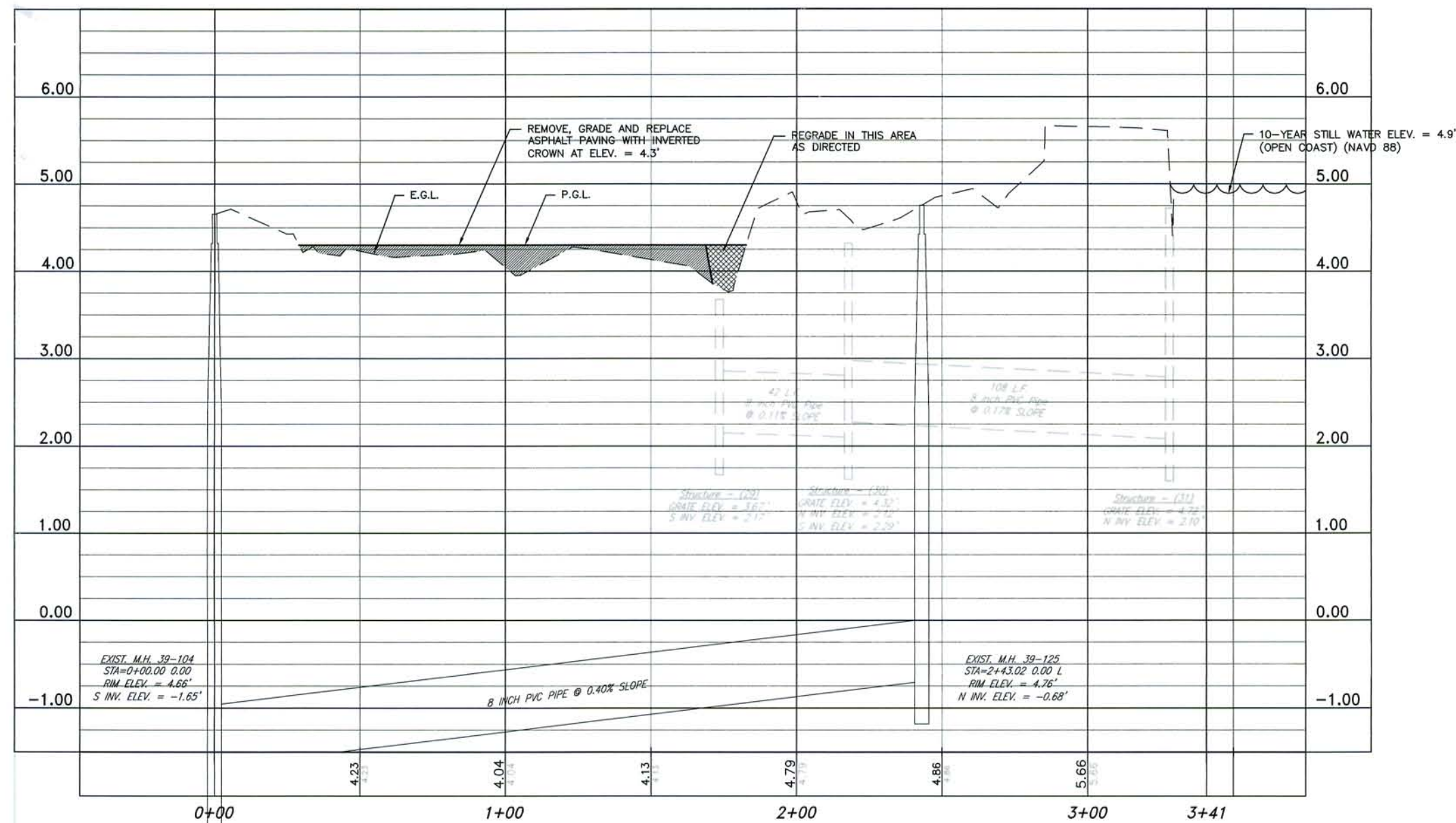

PROFILE
SCALE: 1"=30' HORIZ.
1"=1' VERT.

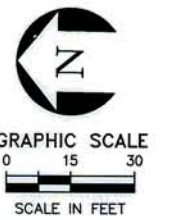

NO.	DESCRIPTION	DATE

ECT
Environmental Consulting & Technology, Inc.
4100 Center Pointe Drive, Suite 112
Fort Myers, FL 33916
(239) 277-0003
CA#5520

TOWN OF FORT MYERS BEACH
2523 ESTERO BLVD.
FORT MYERS BEACH, FL 33931
(239) 765-0202

PROJECT:
BASIN BASED
NEIGHBORHOOD FLOOD MITIGATION AND
STORMWATER QUALITY IMPROVEMENT PROJECT
FEMA HMGP 1609-48-R
TOWN OF FORT MYERS BEACH

SHEET TITLE:
PLAN, PROFILE AND
CROSS SECTIONS
MIRAMAR ST. (GULF SIDE)

DATE: SEPTEMBER 2009
PROJECT NO.: 08-1063
FILE NO.: 19-46-24
SCALE: AS SHOWN

SHEET NUMBER
C-27

S:\ENGINEERING PROJECTS\1609-48-R\DIRS\PERMIT\19-MIRAMAR-GULFSIDE.dwg (Layout) Oct 15, 2009 - 11:36am jamon

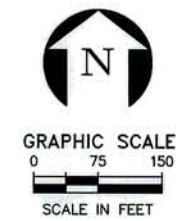

NO.	REVISIONS	DESCRIPTION	DATE

Bridley Vance
10-15-09
BRADLEY S. VANCE
FLORIDA P.E. #6746

ECT
Environmental Consulting & Technology, Inc.
4100 Center Pointe Drive, Suite 112
Fort Myers, FL 33916
(239) 277-0003
CA#55520

CLIENT:
TOWN OF FORT MYERS BEACH
2523 ESTERO BLVD.
FORT MYERS BEACH, FL 33931
(239) 765-0202

PROJECT:
BASIN BASED NEIGHBORHOOD FLOOD MITIGATION AND STORMWATER QUALITY IMPROVEMENT PROJECT
FEMA HMGF 1609-48-R
TOWN OF FORT MYERS BEACH

SHEET TITLE:
SOILS MAP

DATE: SEPTEMBER 2009
PROJECT NO: 08-1063
FILE NO: 19-46-24
SCALE: 1" = 150'
SHEET NUMBER

C-40

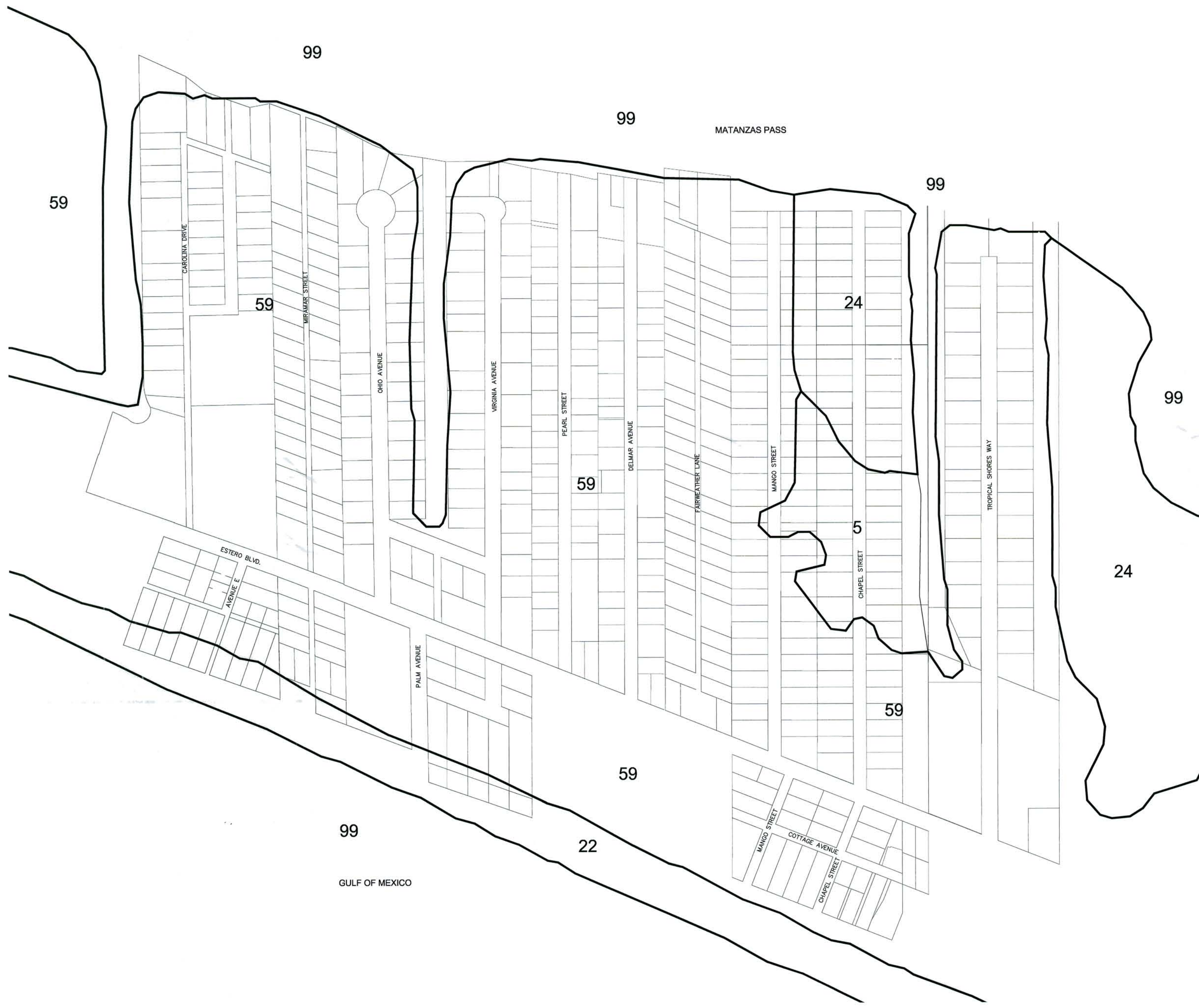

- SOIL TYPE LEGEND:**
- 5 CAPTIVA FINE SAND
 - 22 BEACHES
 - 24 KESSON FINE SAND
 - 59 URBAN LAND
 - 99 WATER

THIS MAPPING REPRESENTS THE INFORMATION PROVIDED WITHIN THE "SOIL SURVEY OF LEE COUNTY, FLORIDA" BY THE U.S.D.A. SOIL CONSERVATION SERVICE (SCS) FOR THE YEAR OF 1981. THE LINEWORK AND DESIGNATIONS PRESENTED ARE BASED UPON THAT CONTAINED WITHIN THE GIS DATABASE FROM THE SOUTH FLORIDA WATER MANAGEMENT DISTRICT (SFWMD).

S:\ENGINEERING\PROJECTS\19-46-24\19-46-24-08-1063-SOILS.MXD (Output) Oct 15, 2009 - 11:46am James

S:\ENGINEERING\PROJECTS\100-1063-FLUCS\100-1063-FLUCS.dwg (copy) Oct 15, 2009 - 11:44am jhorman

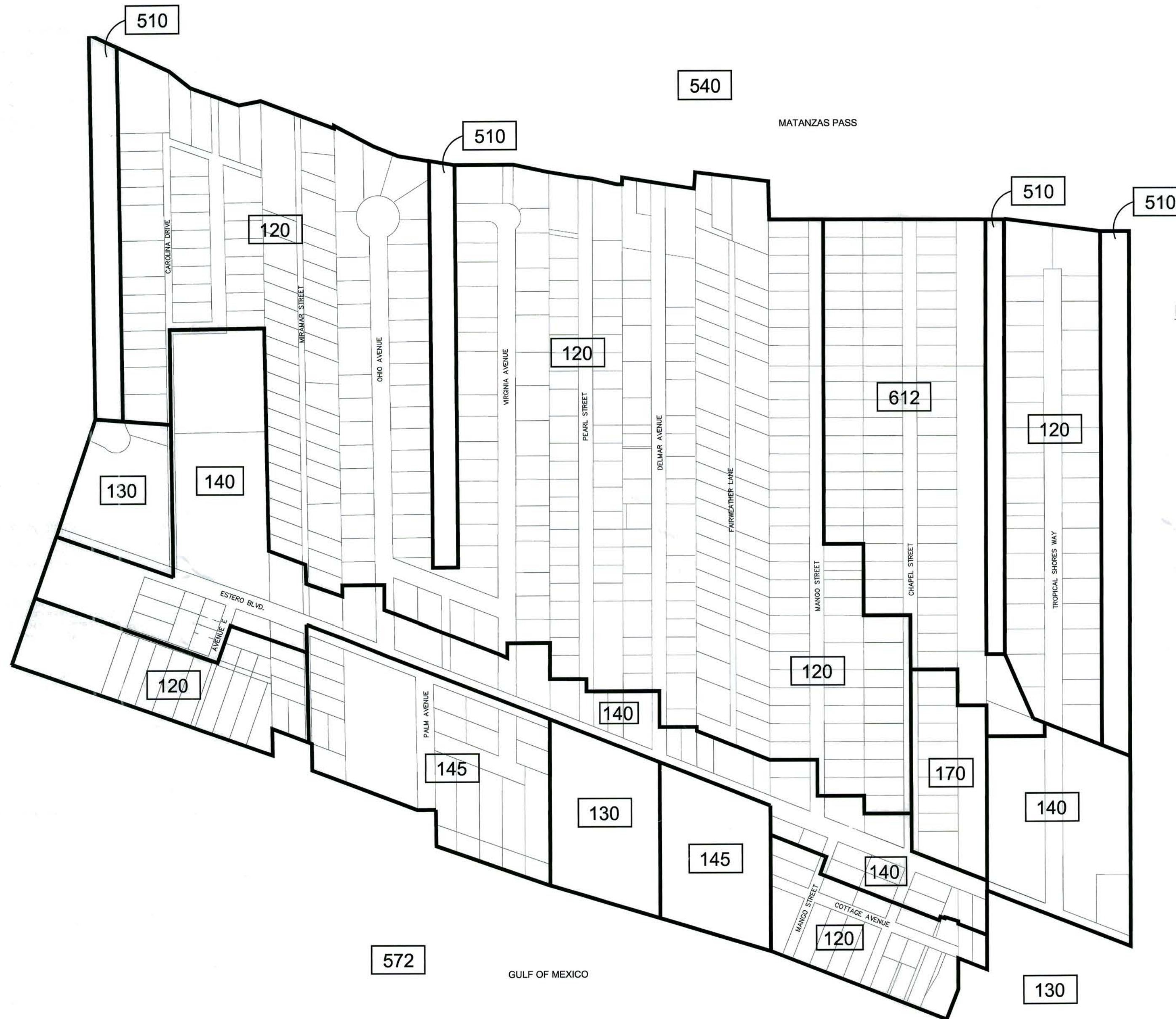

FLUCFCS LEGEND:

- 120 RESIDENTIAL, MEDIUM DENSITY
- 130 RESIDENTIAL, HIGH DENSITY
- 140 COMMERCIAL & SERVICES
- 145 TOURIST SERVICES
- 170 INSTITUTIONAL
- 510 CANAL
- 540 BAYS & ESTUARIES
- 572 GULF OF MEXICO
- 612 MANGROVE SWAMPS

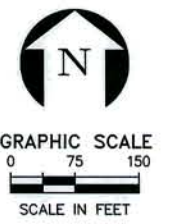

NO.	DESCRIPTION	DATE

Bradley Vance
10-15-09
BRADLEY S. VANCE
FLORIDA P.E. #3746

ECT
Environmental Consulting & Technology, Inc.
4100 Center Pointe Drive, Suite 112
Fort Myers, FL 33916
(239) 277-0003
CA#5520

CLIENT:
TOWN OF FORT MYERS BEACH
2523 ESTERO BLVD.
FORT MYERS BEACH, FL 33931
(239) 785-0202

PROJECT:
BASIN BASED NEIGHBORHOOD FLOOD MITIGATION AND STORMWATER QUALITY IMPROVEMENT PROJECT
FEMA #MGP 1609-48-R
TOWN OF FORT MYERS BEACH

SHEET TITLE:
FLUCFCS MAP

DATE: SEPTEMBER 2009
PROJECT NO: 08-1063
FILE NO: 19-46-24
SCALE: 1" = 150'

THIS MAPPING REPRESENTS THE 2008 AERIAL PHOTO INTERPRETATION WITH LIMITED FIELD CONFIRMATIONS AND IS BASED UPON THE HANDBOOK ENTITLED "FLORIDA LAND USE COVER AND FORMS CLASSIFICATION SYSTEM" DATED JANUARY 1999, THIRD EDITION, PUBLISHED BY THE FLORIDA DEPARTMENT OF TRANSPORTATION (FDOT).

SHEET NUMBER
C-41

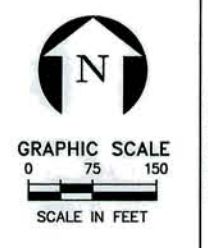

NO.	DESCRIPTION	DATE

Bradley Vance
10-15-09
BRADLEY VANCE
FORT MYERS, FL 33916

ECT
Environmental Consulting & Technology, Inc.
4100 Center Pointe Drive, Suite 112
Fort Myers, FL 33916
(239) 277-0003 CA#5520

CLIENT:
TOWN OF FORT MYERS BEACH
2623 ESTERO BLVD.
FORT MYERS BEACH, FL 33931
(239) 765-0202

PROJECT:
BASIN BASED NEIGHBORHOOD FLOOD MITIGATION AND STORMWATER QUALITY IMPROVEMENT PROJECT
FEMA HMGP 1609-48-R
TOWN OF FORT MYERS BEACH

SHEET TITLE:
AERIAL MAP

DATE: SEPTEMBER 2009
PROJECT NO: 08-1063
FILE NO: 19-46-24
SCALE: 1" = 150'

SHEET NUMBER
C-42

S:\PROJECTS\08-1063-19-46-R\AERIAL\08-1063-19-46-R\AERIAL.dwg (C-42 AERIAL) Oct 15, 2009 - 11:53am jhanna

PHOTOGRAPHY DATE: JANUARY 2008
AERIAL PHOTOGRAPHY FLOWN BY PINNACLE MAPPING TECHNOLOGIES, INC. FOR LEE COUNTY BOCC
IMAGES HAVE A 0.5 FOOT GROUND PIXEL SIZE AND MEET N.M.A.S. FOR 1 INCH = 100 FEET.
HORIZONTAL COORDINATE SYSTEM: FLORIDA STATE PLANE (WEST), NAD83, FEET.