

**LEE COUNTY
DEPARTMENT OF TRANSPORTATION**

CONTRACT PLANS

FINANCIAL PROJECT ID 442000-1-54-01

LITTLETON ROAD WIDENING
FROM CORBETT ROAD TO U.S. 41
LEE COUNTY (12)

SIGNING AND PAVEMENT MARKING PLANS

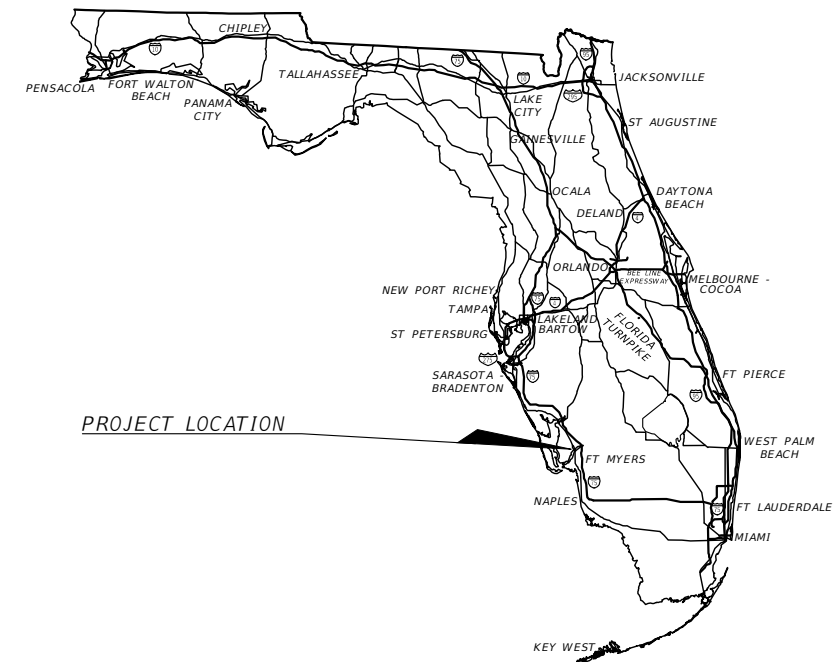

INDEX OF SIGNING AND PAVEMENT MARKING PLANS

SHEET NO.	SHEET DESCRIPTION
S-1	KEY SHEET
	TABULATION OF QUANTITIES
S-4	GENERAL NOTES
	PLAN SHEETS
S-17	GUIDE SIGN WORKSHEET
	RRFB DETAIL

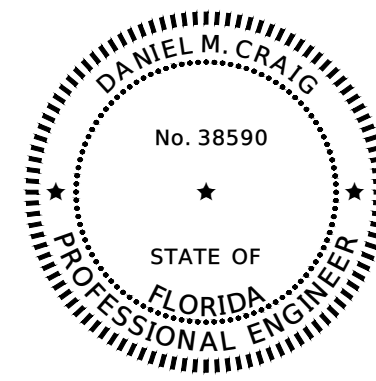

THIS ITEM HAS BEEN DIGITALLY SIGNED AND SEALED BY

ON THE DATE ADJACENT TO THE SEAL
PRINTED COPIES OF THIS DOCUMENT ARE NOT CONSIDERED SIGNED AND SEALED AND THE SIGNATURE MUST BE VERIFIED ON ANY ELECTRONIC COPIES.

SIGNING AND PAVEMENT MARKING PLANS
ENGINEER OF RECORD:

DANIEL M. CRAIG P.E.
P.E. NO.:38590
STANTEC, INC.
1821 VICTORIA AVE.
FORT MYERS, FL. 33901

LCDOT PROJECT MANAGER:
KEITH RIDDLE, C.G.C.

- REVISIONS:**
- SPM Sheets: S-2 thru S-3, S-7 thru S-8 (Rev. 09-22-21)
 - SPM Sheets: S-2 thru S-3, S-9 thru S-10 (Rev. 10-11-21)
 - SPM Sheets: S-2 thru S-3, S-10, S-14 (Rev. 01-07-22)
 - SPM Sheets: S-2 thru S-3, S-5 thru S-9, S-11 thru S-15, S-18 (Rev. 04-28-23)

CIP NO.	CONSTRUCTION CONTRACT NO.	FISCAL YEAR	SHEET NO.
5028	CN190114	2021	S-1

THE OFFICIAL RECORD OF THIS SHEET IS THE ELECTRONIC FILE DIGITALLY SIGNED AND SEALED UNDER RULE 61G15-23.004, F.A.C.

TABULATION OF QUANTITIES

PAY ITEM NO.	DESCRIPTION	UNIT	SHEET NUMBERS														TOTAL THIS SHEET		GRAND TOTAL	
			S-5		S-6		S-7		S-8		S-9		S-10		S-11		PLAN	FINAL	PLAN	FINAL
			PLAN	FINAL	PLAN	FINAL	PLAN	FINAL	PLAN	FINAL	PLAN	FINAL	PLAN	FINAL	PLAN	FINAL				
0654 2 22	Rectangular Rapid Flashing Beacon, F&I, Solar Power, Complete Assembly-Back to Back	AS					0	△									2	△		
0660 4 51	Vehicle Detection System, Video, Adjust/Modify Cabinet Equipment	EA																		
0660 4 52	Vehicle Detection System, Video, Adjust/Modify Above Ground Equipment	EA																		
0670 5 400	Traffic Controller Assembly, Modify	AS																		
0700 1 11	Single Post Sign, F&I Ground Mount, Up To 12 SF	AS	2		1	△	1	△	3	△			5				13	△	4	
0700 1 12	Single Post Sign, F&I Ground Mount, 12-20 SF	AS	1														1			
0700 1 13	Single Post Sign, F&I Ground Mount, 21-30 SF	AS			1		1				1		1		1		5			
0700 1 60	Single Post Sign, Remove	AS	4		4		2		2		4		4		2		22			
0700 2 13	Multi Post Sign, F&I, Ground Mount, 21-30 SF	AS																		
0700 2 60	Multi Post Sign, Remove	AS					1										1			
0705 10 1	Object Marker, Type 1	EA					3		3		3		3		3		15			
0706 1 1	Raised Pavement Marker, Type B Without Final Surface Markings △	EA	37	△	83	△	94	△	146	△	162	△	49	△	46	△	617	△		
*	Painted Pavement Markings, Standard, White, Solid, 6	GM	.220		.223		.236	△	.251		.229		.226	△	.221		1.605	△	△	△
*	Painted Pavement Markings, Standard, White, Solid For Crosswalk And Roundabout, 12	LF			107		104		119		81		291		127		829			
*	Painted Pavement Markings, Standard, White, Solid For Diagonal Or Chevron, 18	LF																		
*	Painted Pavement Markings, Standard, White, Solid For Stop Line Or Crosswalk, 24	LF			17		27		13		18		24		33		133			
*	Painted Pavement Markings, Standard, White, Skip, 10-30 Or 3-9 Skip, 6" Wide	GM	.002														.002			
*	Painted Pavement Markings, Standard, White, 2-4 Dotted Guideline/ 6-10 Dotted Extension, 6"	GM					.062						.032				.093			
*	Painted Pavement Markings, Standard, White, Arrows	EA	4		4		6		4		4		3	△	2		27	△		
*	Painted Pavement Markings, Standard, Yellow, Solid, 6	GM	.231		.246		.232	△	.317		.249		.169	△	.215		1.659	△	△	
*	Painted Pavement Markings, Standard, Yellow, Solid For Diagonal Or Chevron, 18	LF	27		99		101		264		98				25		615			
*	Painted Pavement Markings, Standard, Yellow, Skip, 6"	GM	.054		.069		.088				.064						.276			
*	Painted Pavement Markings, Standard, Yellow, 2-4 Dotted Guideline/6-10 Dotted Extension, 6"	GM			.027		.028		.032		.020		.039		.018		.163			
0710 11290	Painted Pavement Markings, Standard, Yellow, Island Nose △	SF	7	△									15	△	7	△	30	△		
0711 11123	Thermoplastic, Standard, White, Solid, 12 For Crosswalk And Roundabout	LF			107		104	△	119		81		291		127		829	△		
0711 11124	Thermoplastic, Standard, White, Solid, 18 For Diagonals And Chevrons	LF																		
0711 11125	Thermoplastic, Standard, White, Solid, 24 For Stop Line And Crosswalk	LF			17		27		13		18		24		33		133			
0711 11141	Thermoplastic, Standard, White, 2-4 Dotted Guideline/ 6-10 Gap Extension, 6"	GM					.062						.032				.093			
0711 11170	Thermoplastic, Standard, White, Arrow	EA	4		4		6		4		4		3	△	2		27	△		
0711 11224	Thermoplastic, Standard, Yellow, Solid, 18 For Diagonal Or Chevrons	LF	27		99		101		264		98				25		615			
0711 11241	Thermoplastic, Standard, Yellow, 2-4 Dotted Guide Line /6-10 Dotted Extension Line, 6"	GM			.027		.028		.032		.020		.039		.018		.163			
0711 14125	Thermoplastic, Preformed, White, Solid, 24 For Crosswalk	LF											80				80			
0711 14160	Thermoplastic, Preformed, White, Message	EA	5		4		4		5		4		5		4		31			
0711 14170	Thermoplastic, Preformed, White, Arrow	EA	5		4		4		5		4		5		4		31			
0711 16101	Thermoplastic, Standard, Other Surfaces, White, Solid, 6	GM	.220		.223		.236	△	.251		.229		.226	△	.221		1.605	△	△	△
0711 16131	Thermoplastic, Standard-Other Surfaces, White, Skip, 6", 10-30 Skip Or 3-9 Lane Drop	GM	.002														.002			
0711 16201	Thermoplastic, Standard, Other Surfaces, Yellow, Solid, 6	GM	.231		.246		.232	△	.317		.249		.169	△	.215		1.659	△	△	
0711 16231	Thermoplastic, Other Surfaces, Yellow, Skip, 6	GM	.054		.069		.088				.064						.276			

* THESE QUANTITIES ARE PAID FOR UNDER PAINTED PAVEMENT MARKINGS (FINAL SURFACE), LUMP SUM - ITEM NO. 710-90. THE QUANTITIES SHOWN ARE FOR ONE APPLICATION; SEE SPECIFICATION 710 FOR THE NUMBER OF APPLICATIONS REQUIRED.

<p>REVISIONS</p> <table border="1"> <thead> <tr> <th>DATE</th> <th>DESCRIPTION</th> <th>DATE</th> <th>DESCRIPTION</th> </tr> </thead> <tbody> <tr> <td>9-22-21</td> <td>Revised qty for crosswalk marking and sign removal. △</td> <td>4-28-23</td> <td>Revised qty at median openings. Removed bus stop sign. △</td> </tr> <tr> <td>10-11-21</td> <td>Revised qty for pavement arrows. △</td> <td></td> <td></td> </tr> <tr> <td>01-07-22</td> <td>Revised qty for turn lanes. △</td> <td></td> <td></td> </tr> </tbody> </table>				DATE	DESCRIPTION	DATE	DESCRIPTION	9-22-21	Revised qty for crosswalk marking and sign removal. △	4-28-23	Revised qty at median openings. Removed bus stop sign. △	10-11-21	Revised qty for pavement arrows. △			01-07-22	Revised qty for turn lanes. △			<p>DANIEL M. CRAIG, P.E. P.E. LICENSE NUMBER 38590 STANTEC, INC. 1821 VICTORIA AVE FORT MYERS, FL 33901</p>			<p>LEE COUNTY DEPARTMENT OF TRANSPORTATION</p> <table border="1"> <thead> <tr> <th>ROAD NAME</th> <th>COUNTY</th> <th>CONTRACT NO.</th> </tr> </thead> <tbody> <tr> <td>LITTLETON ROAD</td> <td>LEE</td> <td>CN190114</td> </tr> </tbody> </table>			ROAD NAME	COUNTY	CONTRACT NO.	LITTLETON ROAD	LEE	CN190114	<p>TABULATION OF QUANTITIES</p>			<p>SHEET NO. S-2</p>
DATE	DESCRIPTION	DATE	DESCRIPTION																																
9-22-21	Revised qty for crosswalk marking and sign removal. △	4-28-23	Revised qty at median openings. Removed bus stop sign. △																																
10-11-21	Revised qty for pavement arrows. △																																		
01-07-22	Revised qty for turn lanes. △																																		
ROAD NAME	COUNTY	CONTRACT NO.																																	
LITTLETON ROAD	LEE	CN190114																																	

THE OFFICIAL RECORD OF THIS SHEET IS THE ELECTRONIC FILE DIGITALLY SIGNED AND SEALED UNDER RULE 61G15-23.004, F.A.C.

TABULATION OF QUANTITIES

PAY ITEM NO.	DESCRIPTION	UNIT	SHEET NUMBERS														TOTAL THIS SHEET		GRAND TOTAL	
			S-12		S-13		S-14		S-15		S-16		PLAN	FINAL	PLAN	FINAL				
			PLAN	FINAL	PLAN	FINAL	PLAN	FINAL	PLAN	FINAL	PLAN	FINAL	PLAN	FINAL	PLAN	FINAL				
0654 2 22	Rectangular Rapid Flashing Beacon, F&I, Solar Power, Complete Assembly-Back to Back	AS	2				2										4	4	6	6
0660 4 51	Vehicle Detection System, Video, Adjust/Modify Cabinet Equipment	EA										1					1		1	1
0660 4 52	Vehicle Detection System, Video, Adjust/Modify Above Ground Equipment	EA										1					1		1	1
0670 5 400	Traffic Controller Assembly, Modify	AS										1					1		1	1
0700 1 11	Single Post Sign, F&I Ground Mount, Up To 12 SF	AS	1				3		2			1					7	7	20	20
0700 1 12	Single Post Sign, F&I Ground Mount, 12-20 SF	AS										1					1		2	2
0700 1 13	Single Post Sign, F&I Ground Mount, 21-30 SF	AS						2									2		7	7
0700 1 60	Single Post Sign, Remove	AS	3				3		3			3					12		34	34
0700 2 13	Multi Post Sign, F&I, Ground Mount, 21-30 SF	AS										1					1		1	1
0700 2 60	Multi Post Sign, Remove	AS										1					1		2	2
0705 10 1	Object Marker, Type 1	EA															3		18	18
0706 1 1	Raised Pavement Marker, Type B Without Final Surface Markings	EA	108	4	35	4	87	4	65	4	30	4					325	4	942	942
*	Painted Pavement Markings, Standard, White, Solid, 6	GM	.208		.226		.238		.312		.176						1.161	4	2.766	2.766
*	Painted Pavement Markings, Standard, White, Solid For Crosswalk And Roundabout, 12	LF	60				356		64		165						646	4	1475	1475
*	Painted Pavement Markings, Standard, White, Solid For Diagonal Or Chevron, 18	LF							18								18		18	18
*	Painted Pavement Markings, Standard, White, Solid For Stop Line Or Crosswalk, 24	LF					49		12		44						104		237	237
*	Painted Pavement Markings, Standard, White, Skip, 10-30 Or 3-9 Skip, 6" Wide	GM																	.002	.002
*	Painted Pavement Markings, Standard, White, 2-4 Dotted Guideline/ 6-10 Dotted Extension, 6"	GM					.032		.049								.081		.175	.175
*	Painted Pavement Markings, Standard, White, Arrows	EA			1		4		4		4						13		40	40
*	Painted Pavement Markings, Standard, Yellow, Solid, 6	GM	.330		.233		.180		.241		.073						1.057	4	2.716	2.716
*	Painted Pavement Markings, Standard, Yellow, Solid For Diagonal Or Chevron, 18	LF	346		23		25		18								413		1028	1028
*	Painted Pavement Markings, Standard, Yellow, Skip, 6"	GM					.059										.059		.222	.222
0710 11290	Painted Pavement Markings, Standard, Yellow, Island Nose	SF	15	4	7	4	22	4	7	4							52	4	82	82
0711 11123	Thermoplastic, Standard, White, Solid, 12 For Crosswalk And Roundabout	LF	60				356		64		165						646	4	1475	1475
0711 11124	Thermoplastic, Standard, White, Solid, 18 For Diagonals And Chevrons	LF							18								18		18	18
0711 11125	Thermoplastic, Standard, White, Solid, 24 For Stop Line And Crosswalk	LF					49		12		44						104		237	237
0711 11141	Thermoplastic, Standard, White, 2-4 Dotted Guideline/ 6-10 Gap Extension, 6"	GM					.032		.049								.081		.175	.175
0711 11170	Thermoplastic, Standard, White, Arrow	EA			1		4		4		4						13		40	40
0711 11224	Thermoplastic, Standard, Yellow, Solid, 18 For Diagonal Or Chevrons	LF	346		23		25		18								413		1028	1028
0711 11241	Thermoplastic, Standard, Yellow, 2-4 Dotted Guide Line /6-10 Dotted Extension Line, 6"	GM					.059										.059		.222	.222
0711 14125	Thermoplastic, Preformed, White, Solid, 24 For Crosswalk	LF	60				80										140		220	220
0711 14160	Thermoplastic, Preformed, White, Message	EA	4		3		5		4		3						19		50	50
0711 14170	Thermoplastic, Preformed, White, Arrow	EA	4		3		5		4		3						19		50	50
0711 16101	Thermoplastic, Standard, Other Surfaces, White, Solid, 6	GM	.208		.226		.238		.312		.176						1.161	4	2.766	2.766
0711 16131	Thermoplastic, Standard-Other Surfaces, White, Skip, 6", 10-30 Skip Or 3-9 Lane Drop	GM																	.002	.002
0711 16201	Thermoplastic, Standard, Other Surfaces, Yellow, Solid, 6	GM	.330		.233		.180		.241		.073						1.057	4	2.716	2.716
0711 16231	Thermoplastic, Other Surfaces, Yellow, Skip, 6	GM																	.276	.276

* THESE QUANTITIES ARE PAID FOR UNDER PAINTED PAVEMENT MARKINGS (FINAL SURFACE), LUMP SUM - ITEM NO. 710-90. THE QUANTITIES SHOWN ARE FOR ONE APPLICATION; SEE SPECIFICATION 710 FOR THE NUMBER OF APPLICATIONS REQUIRED.

REVISIONS				DANIEL M. CRAIG, P.E. P.E. LICENSE NUMBER 38590 STANTEC, INC. 1821 VICTORIA AVE FORT MYERS, FL 33901	LEE COUNTY DEPARTMENT OF TRANSPORTATION			SHEET NO. S-3
DATE	DESCRIPTION	DATE	DESCRIPTION		ROAD NAME	COUNTY	CONTRACT NO.	
9-22-21	Revised qty for crosswalk marking and sign removal.	4-28-23	Revised qty at median openings. Removed bus stop sign.		LITTLETON ROAD	LEE	CN190114	
10-11-21	Revised qty for pavement arrows.							
01-07-22	Revised qty for turn lanes.							

THE OFFICIAL RECORD OF THIS SHEET IS THE ELECTRONIC FILE DIGITALLY SIGNED AND SEALED UNDER RULE 61G15-23.004, F.A.C.

SIGNING AND PAVEMENT MARKING NOTES

=====

1. CONTRACTOR TO REFER TO CURRENT (JANUARY 2021) LCDOT PLAN SPECIFICATIONS FOR TRAFFIC SIGNAL AND STREET LIGHTING AS WELL AS CURRENT FDOT STANDARD PLANS.
2. PAVEMENT MARKINGS SHOULD BE PLACED AS SHOWN IN THE FDOT STANDARD PLANS INDEX.
3. ALL EXISTING D.O.T. SIGNS THAT CONFLICT WITH CONSTRUCTION OPERATIONS SHALL BE REMOVED, BY THE CONTRACTOR.
4. SIGNING AND PAVEMENT MARKING TO BE DONE IN ACCORDANCE WITH THE CURRENT MANUAL ON UNIFORM TRAFFIC CONTROL DEVICES.
5. CONTRACTOR TO REFER TO CURRENT FDOT STANDARD PLANS INDEX 654-001 FOR RECTANGULAR RAPID FLASHING BEACON ASSEMBLY.
6. CONTRACTOR TO USE LCDOT DESIGN STANDARDS FOR SIGN INSTALLATION FOR ALL SINGLE POST SIGN INSTALLATIONS. SEE FOLLOWING WEB SITE:
<https://www.leegov.com/dot/traffic/trafficsigninstallation>
7. WHERE NON-STANDARD DECORATIVE SIGNS ARE ENCOUNTERED AT NON-COUNTY MAINTAINED STREETS AND NOTED TO BE REMOVED, THE CONTRACTOR SHALL COORDINATE WITH PROPERTY OWNERS AND RETURN DECORATIVE SIGNAGE TO OWNERS.

PAY ITEM NOTES

=====

654-2-22 RECTANGULAR RAPID FLASHING BEACON, COMPLETE ASSEMBLY. INCLUDES ALL SIGN PANELS, POSTS, FOUNDATION, WIRING, DETECTORS, PUSH BUTTONS, SOLAR POWER, AND CONTROLLER EQUIPMENT NECESSARY FOR RRFB INSTALLATION. UNIT SHALL BE SOLAR POWERED AND WIRED TO OPERATE ONE STAGE CROSSING. RRFB MUST BE IN FDOT APPROVED PRODUCTS LIST AND APPROVED BY LEE COUNTY. PEDESTRIAN DETECTORS SHALL BE AN ACCESSIBLE TYPE.

R E V I S I O N S				DANIEL M. CRAIG P.E. P.E. LICENSE NUMBER 38590 STANTEC, INC. 1821 VICTORIA AVE, FORT MYERS, FL 33901	LEE COUNTY DEPARTMENT OF TRANSPORTATION			GENERAL NOTES	SHEET NO.
DATE	DESCRIPTION	DATE	DESCRIPTION		ROAD NO.	COUNTY	CONTRACT NO.		5-4
----					LITTLETON ROAD	LEE	CN190114		

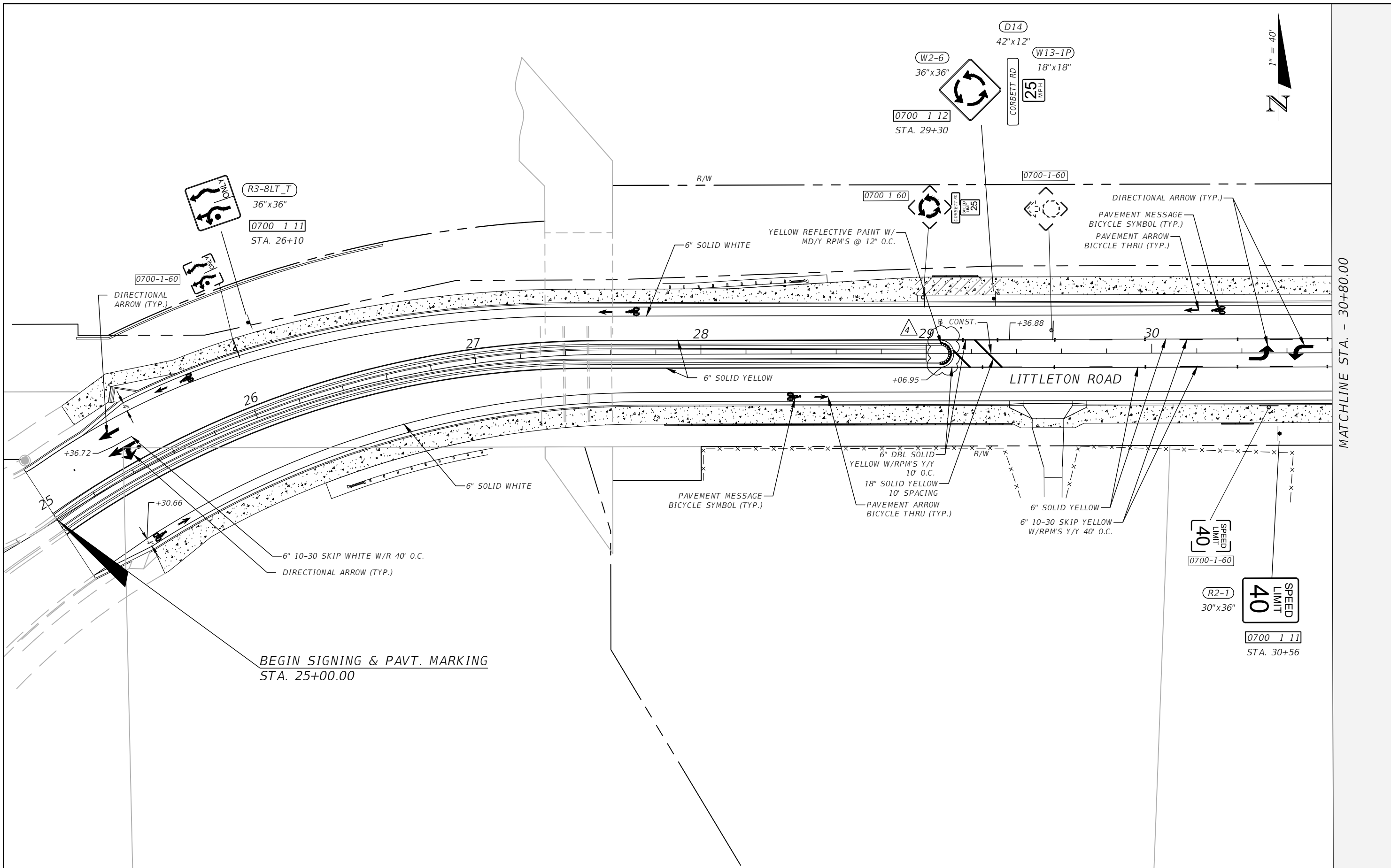

MATCHLINE STA. - 30+80.00

REVISIONS			
DATE	DESCRIPTION	DATE	DESCRIPTION
4-28-23	Added RPM's and Yellow Ref. Paint.		

DANIEL M. CRAIG P.E.
 P.E. LICENSE NUMBER 38590
 STANTEC, INC.
 1821 VICTORIA AVE,
 FORT MYERS, FL 33901

LEE COUNTY DEPARTMENT OF TRANSPORTATION		
ROAD NAME	COUNTY	CONTRACT NO.
LITTLETON ROAD	LEE	CN190114

**SIGNING & PAVEMENT
MARKING PLAN**

SHEET NO.
S-5

THE OFFICIAL RECORD OF THIS SHEET IS THE ELECTRONIC FILE DIGITALLY SIGNED AND SEALED UNDER RULE 61G15-23.004, F.A.C.



MATCHLINE STA. - 30+80.00

MATCHLINE STA. - 36+40.00

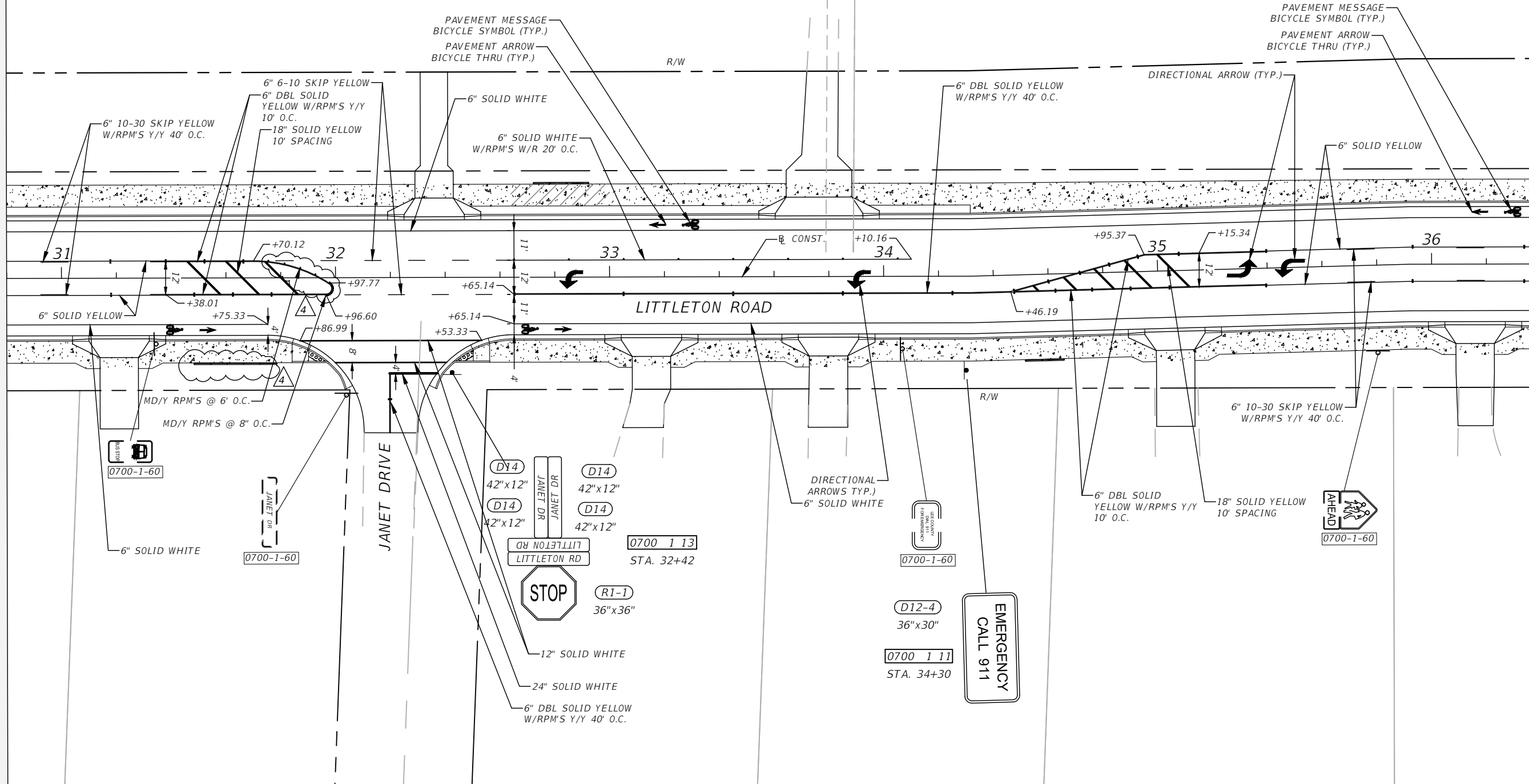

REVISIONS	
DATE	DESCRIPTION
4-28-23	Added RPM's and Yellow Ref. Paint. 4

DANIEL M. CRAIG P.E.
 P.E. LICENSE NUMBER 38590
 STANTEC, INC.
 1821 VICTORIA AVE,
 FORT MYERS, FL 33901

LEE COUNTY DEPARTMENT OF TRANSPORTATION		
ROAD NAME	COUNTY	CONTRACT NO.
LITTLETON ROAD	LEE	CN190114

**SIGNING & PAVEMENT
MARKING PLAN**

SHEET NO.
5-6

THE OFFICIAL RECORD OF THIS SHEET IS THE ELECTRONIC FILE DIGITALLY SIGNED AND SEALED UNDER RULE 61G15-23.004, F.A.C.



MATCHLINE STA. - 36+40.00

MATCHLINE STA. - 42+00.00

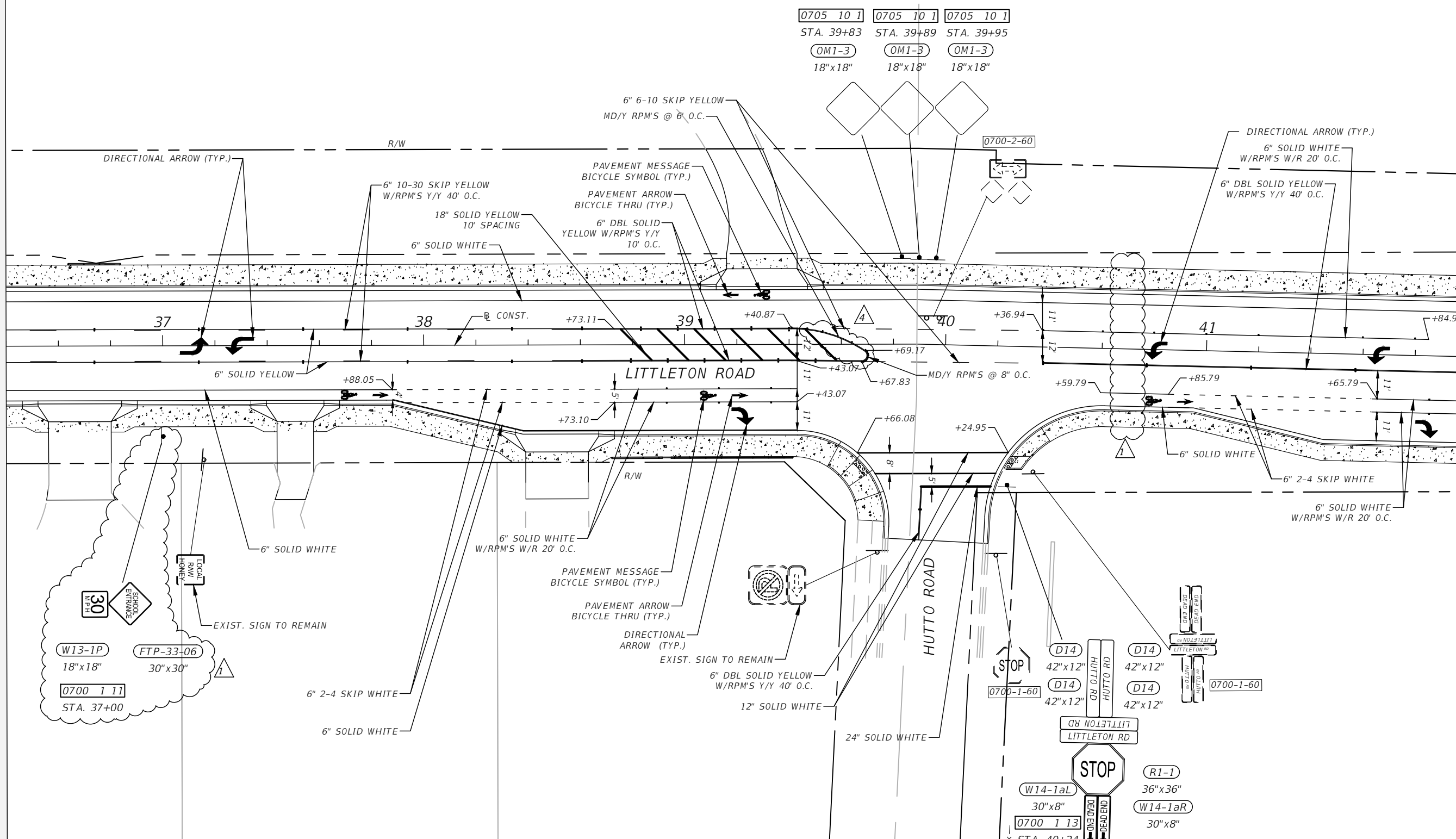

REVISIONS	
DATE	DESCRIPTION
9-22-21	Removed crosswalk striping and signing. Added new signs for school entrance. ▲
4-28-23	Added RPM's and Yellow Ref. Paint. ▲

DANIEL M. CRAIG P.E.
 P.E. LICENSE NUMBER 38590
 STANTEC, INC.
 1821 VICTORIA AVE.
 FORT MYERS, FL 33901

LEE COUNTY DEPARTMENT OF TRANSPORTATION		
ROAD NAME	COUNTY	CONTRACT NO.
LITTLETON ROAD	LEE	CN190114

SIGNING & PAVEMENT MARKING PLAN

SHEET NO.
5-7

THE OFFICIAL RECORD OF THIS SHEET IS THE ELECTRONIC FILE DIGITALLY SIGNED AND SEALED UNDER RULE 61G15-23.004, F.A.C.



MATCHLINE STA. - 42+00.00

MATCHLINE STA. - 47+60.00

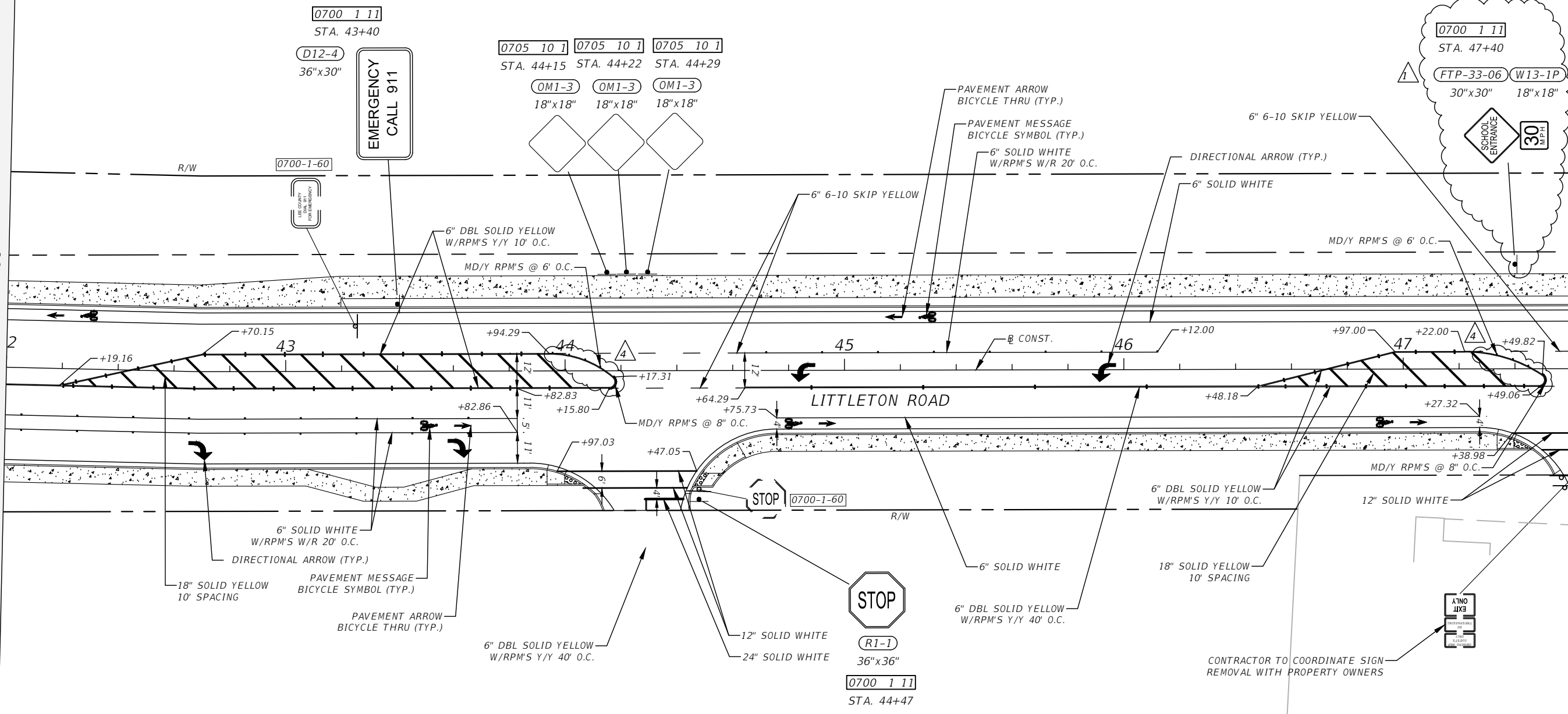

REVISIONS			
DATE	DESCRIPTION	DATE	DESCRIPTION
9-22-21	Added new signs for school entrance.		
4-28-23	Added RPM's and Yellow Ref. Paint.		

DANIEL M. CRAIG P.E.
 P.E. LICENSE NUMBER 38590
 STANTEC, INC.
 1821 VICTORIA AVE,
 FORT MYERS, FL 33901

LEE COUNTY DEPARTMENT OF TRANSPORTATION		
ROAD NAME	COUNTY	CONTRACT NO.
LITTLETON ROAD	LEE	CN190114

**SIGNING & PAVEMENT
MARKING PLAN**

SHEET NO.
5-8

THE OFFICIAL RECORD OF THIS SHEET IS THE ELECTRONIC FILE DIGITALLY SIGNED AND SEALED UNDER RULE 61G15-23.004, F.A.C.



0705 10 1 0705 10 1 0705 10 1
 STA. 47+66 STA. 47+72 STA. 47+80
 OM1-3 OM1-3 OM1-3
 18"x18" 18"x18" 18"x18"

MATCHLINE STA. - 47+60.00

MATCHLINE STA. - 53+20.00

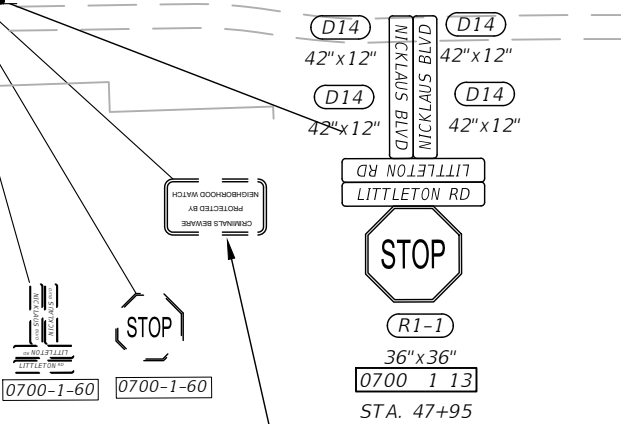
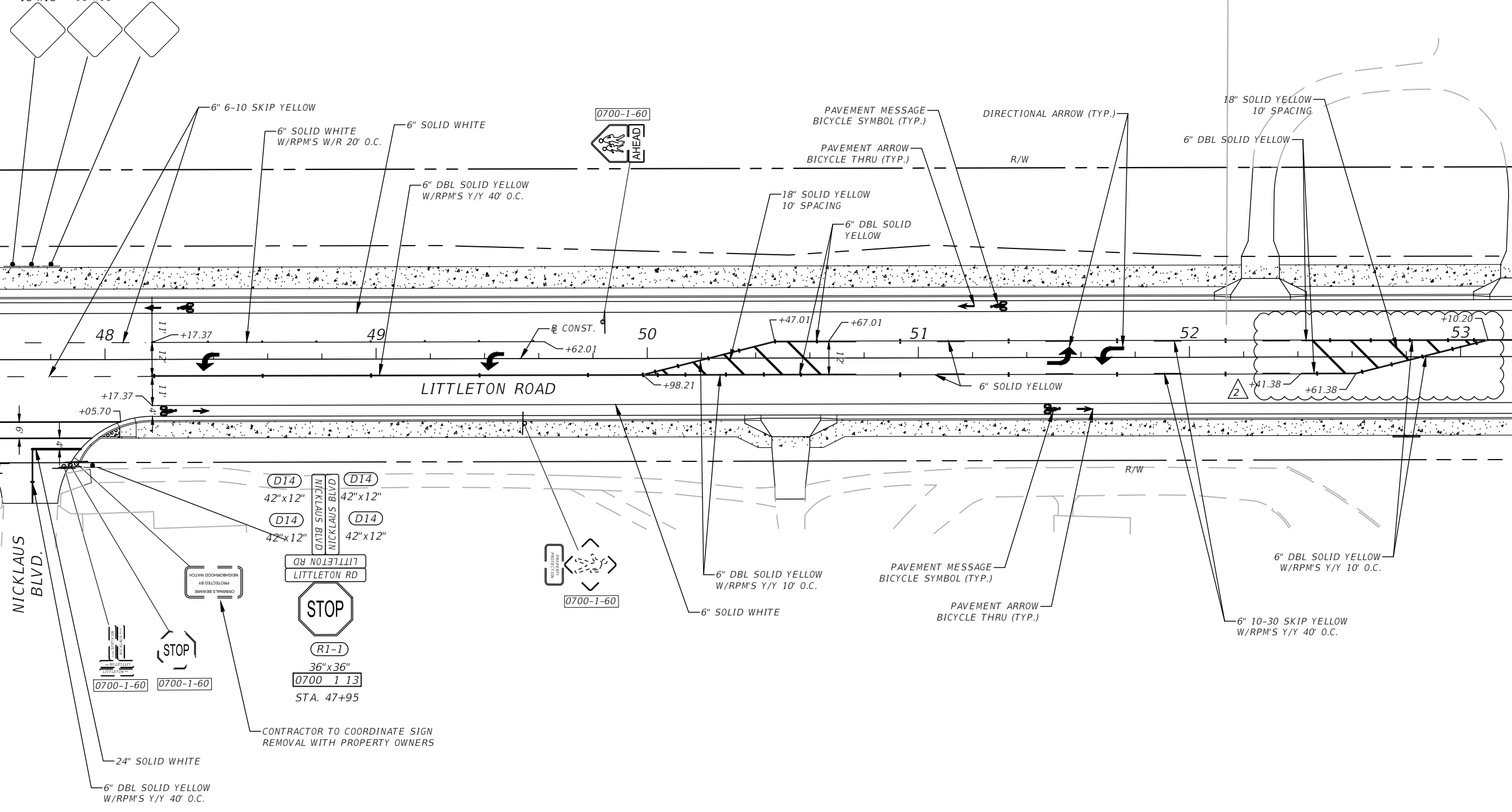

REVISIONS			
DATE	DESCRIPTION	DATE	DESCRIPTION
10-11-21	Revised turn lane length.		

DANIEL M. CRAIG P.E.
 P.E. LICENSE NUMBER 38590
 STANTEC, INC.
 1821 VICTORIA AVE,
 FORT MYERS, FL 33901

LEE COUNTY DEPARTMENT OF TRANSPORTATION		
ROAD NAME	COUNTY	CONTRACT NO.
LITTLETON ROAD	LEE	CN190114

**SIGNING & PAVEMENT
MARKING PLAN**

SHEET NO.
5-9

THE OFFICIAL RECORD OF THIS SHEET IS THE ELECTRONIC FILE DIGITALLY SIGNED AND SEALED UNDER RULE 61G15-23.004, F.A.C.



MATCHLINE STA. - 53+20.00

MATCHLINE STA. - 58+80.00

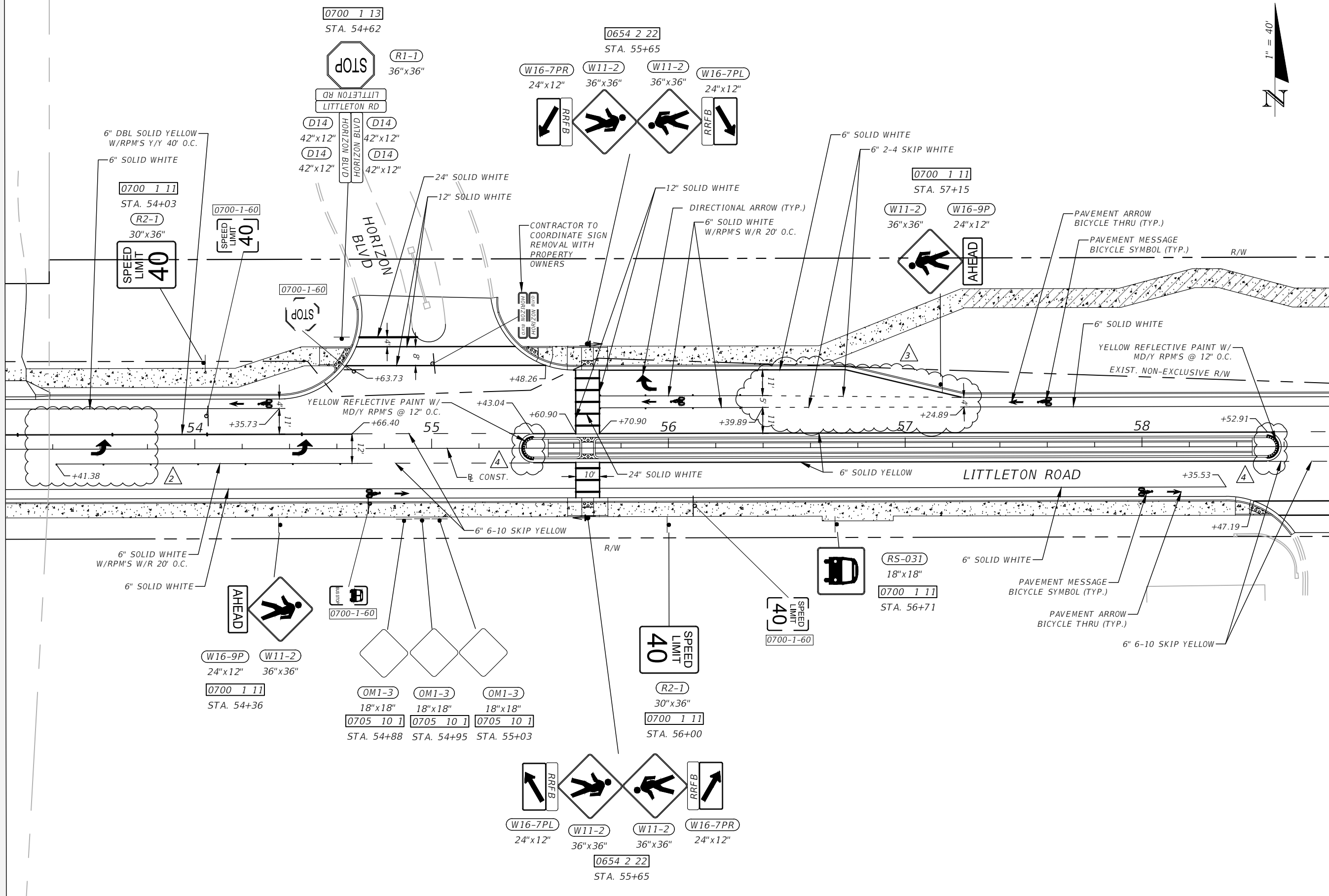

REVISIONS		DATE	DESCRIPTION	DATE	DESCRIPTION
DATE	DESCRIPTION				
10-11-21	Revised turn lane length.	2			
01-07-22	Revised turn lane length.	3			
4-28-23	Added RPM's and Yellow Ref. Paint.	4			

DANIEL M. CRAIG P.E. P.E. LICENSE NUMBER 38590 STANTEC, INC. 1821 VICTORIA AVE, FORT MYERS, FL 33901			LEE COUNTY DEPARTMENT OF TRANSPORTATION ROAD NAME: LITTLETON ROAD COUNTY: LEE CONTRACT NO.: CN190114			SIGNING & PAVEMENT MARKING PLAN		SHEET NO. 5-10
--	--	--	--	--	--	--	--	-------------------

THE OFFICIAL RECORD OF THIS SHEET IS THE ELECTRONIC FILE DIGITALLY SIGNED AND SEALED UNDER RULE 61G15-23.004, F.A.C.



0705 10 1 0705 10 1 0705 10 1
 STA. 58+94 STA. 59+01 STA. 59+08
 OM1-3 OM1-3 OM1-3
 18"x18" 18"x18" 18"x18"

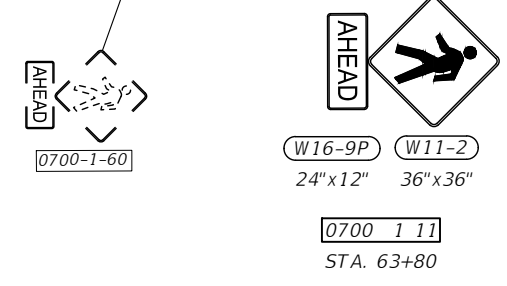
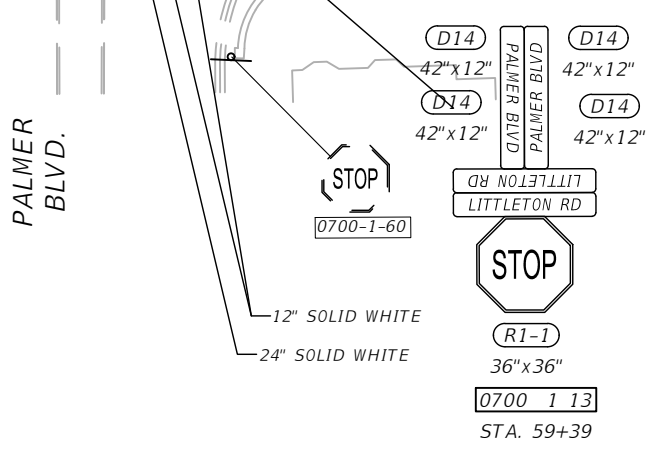
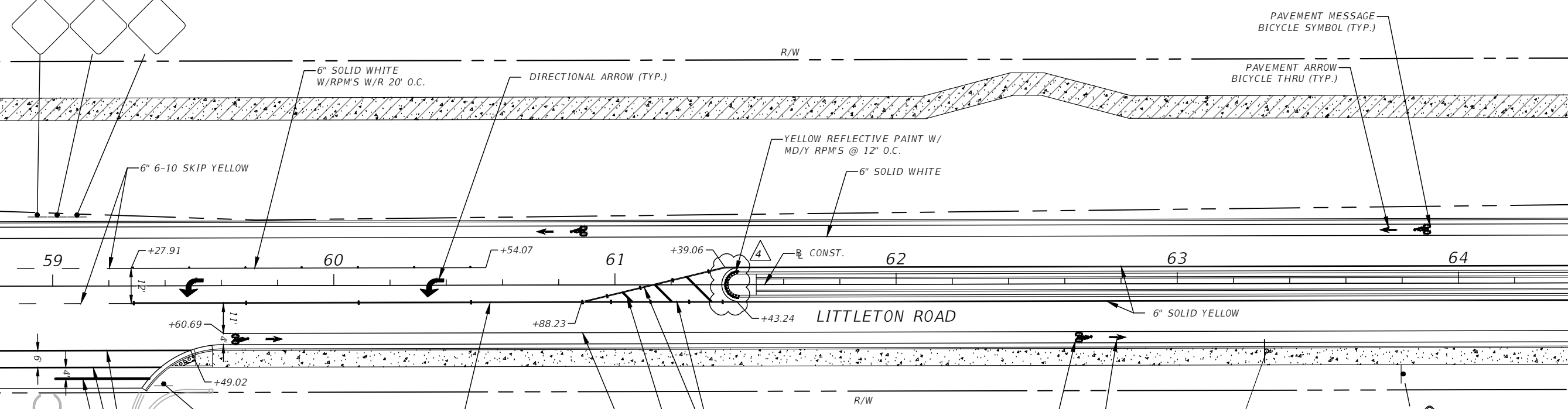

MATCHLINE STA. - 58+80.00

MATCHLINE STA. - 64+40.00

REVISIONS			
DATE	DESCRIPTION	DATE	DESCRIPTION
4-28-23	Added RPM's and Yellow Ref. Paint.		

DANIEL M. CRAIG P.E.
 P.E. LICENSE NUMBER 38590
 STANTEC, INC.
 1821 VICTORIA AVE,
 FORT MYERS, FL 33901

LEE COUNTY DEPARTMENT OF TRANSPORTATION		
ROAD NAME	COUNTY	CONTRACT NO.
LITTLETON ROAD	LEE	CN190114

**SIGNING & PAVEMENT
MARKING PLAN**

SHEET NO.
5-11

THE OFFICIAL RECORD OF THIS SHEET IS THE ELECTRONIC FILE DIGITALLY SIGNED AND SEALED UNDER RULE 61G15-23.004, F.A.C.



MATCHLINE STA. - 64+40.00

MATCHLINE STA. - 70+00.00

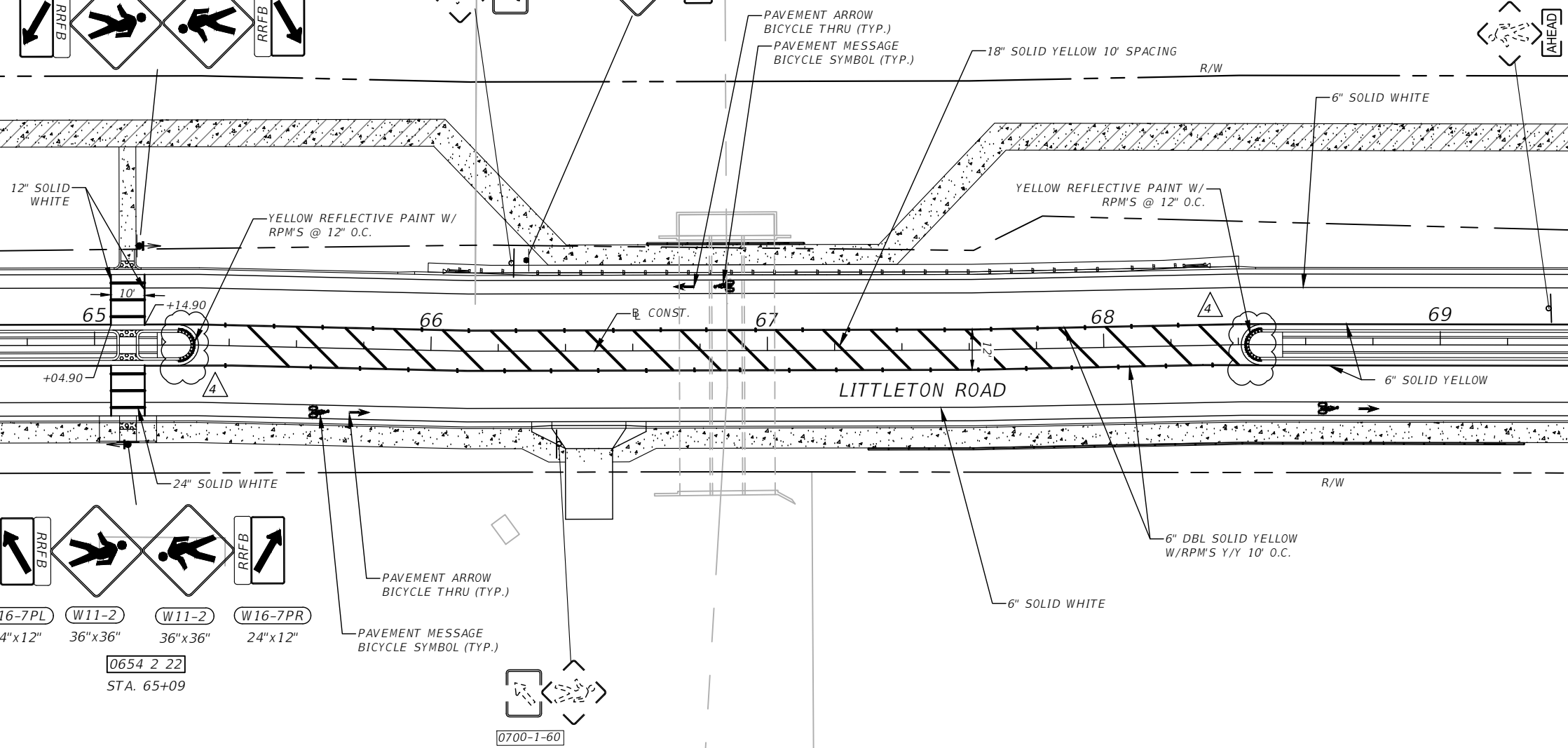
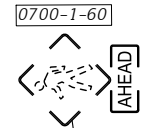
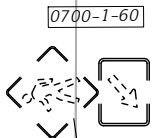
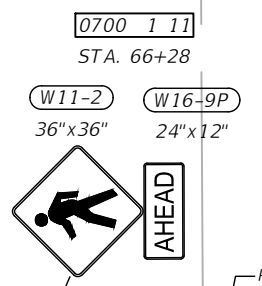
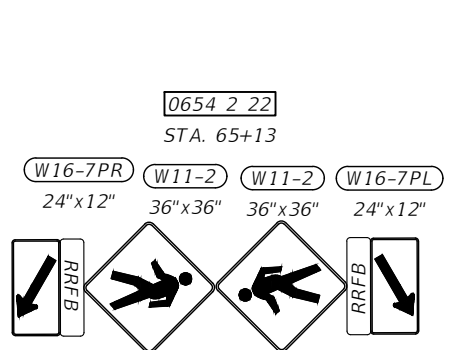

REVISIONS			
DATE	DESCRIPTION	DATE	DESCRIPTION
4-28-23	Added RPM's and Yellow Ref. Paint. 4		

DANIEL M. CRAIG P.E.
P.E. LICENSE NUMBER 38590
STANTEC, INC.
1821 VICTORIA AVE,
FORT MYERS, FL 33901

LEE COUNTY DEPARTMENT OF TRANSPORTATION		
ROAD NAME	COUNTY	CONTRACT NO.
LITTLETON ROAD	LEE	CN190114

**SIGNING & PAVEMENT
MARKING PLAN**

SHEET NO.
5-12

THE OFFICIAL RECORD OF THIS SHEET IS THE ELECTRONIC FILE DIGITALLY SIGNED AND SEALED UNDER RULE 61G15-23.004, F.A.C.

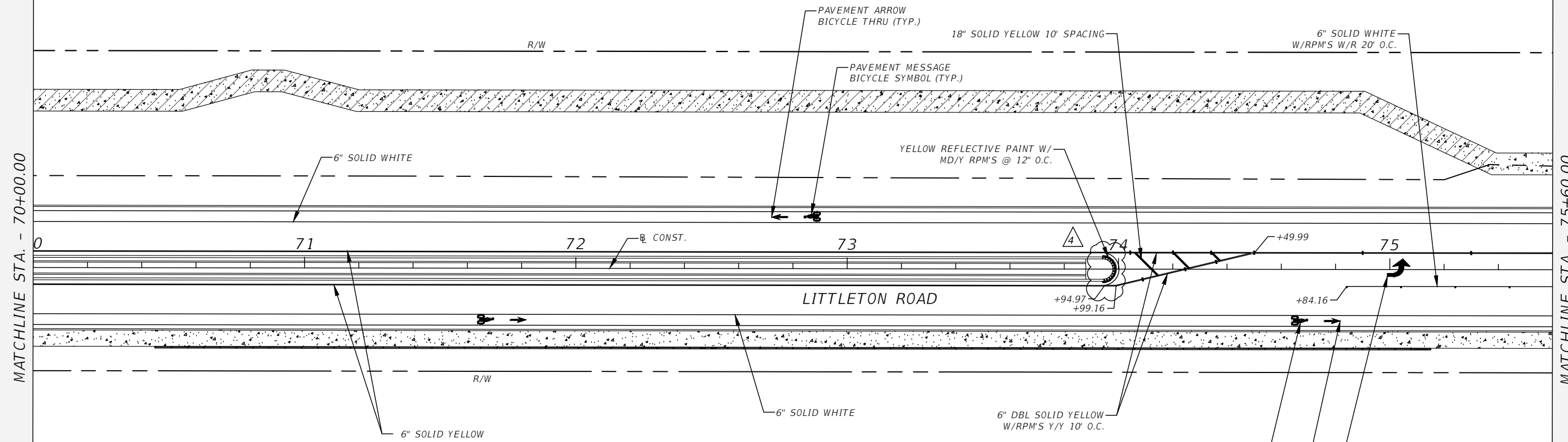

MATCHLINE STA. - 70+00.00

MATCHLINE STA. - 75+60.00

REVISIONS			
DATE	DESCRIPTION	DATE	DESCRIPTION
4-28-23	Added RPM's and Yellow Ref. Paint. 4		

DANIEL M. CRAIG P.E.
 P.E. LICENSE NUMBER 38590
 STANTEC, INC.
 1821 VICTORIA AVE,
 FORT MYERS, FL 33901

LEE COUNTY DEPARTMENT OF TRANSPORTATION		
ROAD NAME	COUNTY	CONTRACT NO.
LITTLETON ROAD	LEE	CN190114

**SIGNING & PAVEMENT
MARKING PLAN**

SHEET NO.
5-13

THE OFFICIAL RECORD OF THIS SHEET IS THE ELECTRONIC FILE DIGITALLY SIGNED AND SEALED UNDER RULE 61G15-23.004, F.A.C.

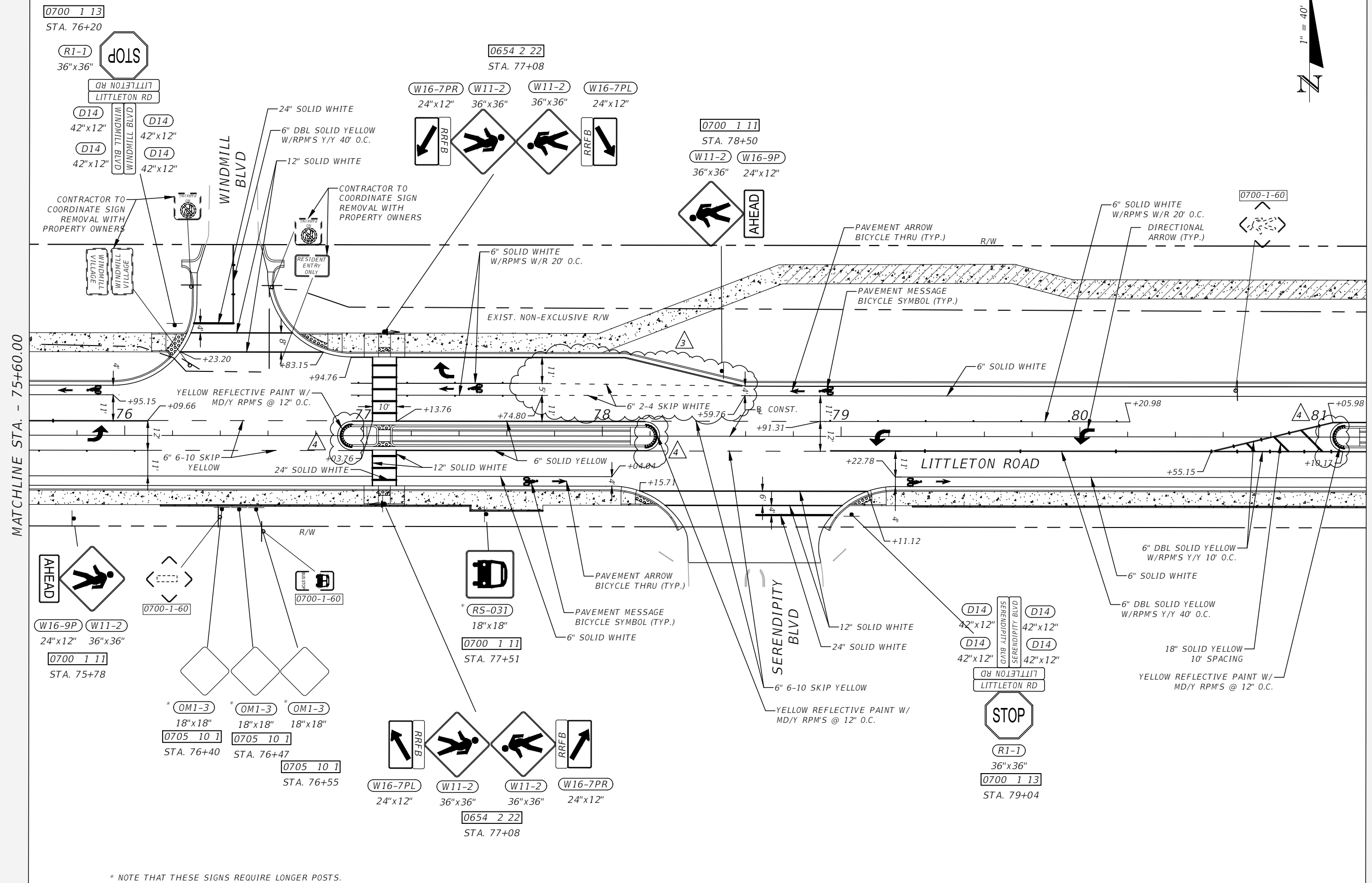

MATCHLINE STA. - 75+60.00

MATCHLINE STA. - 81+20.00

* NOTE THAT THESE SIGNS REQUIRE LONGER POSTS.

REVISIONS	
DATE	DESCRIPTION
01-07-22	Revised turn lane length.
4-28-23	Added RPM's and Yellow Ref. Paint.

DANIEL M. CRAIG P.E.
P.E. LICENSE NUMBER 38590
STANTEC, INC.
1821 VICTORIA AVE,
FORT MYERS, FL 33901

LEE COUNTY DEPARTMENT OF TRANSPORTATION		
ROAD NAME	COUNTY	CONTRACT NO.
LITTLETON ROAD	LEE	CN190114

**SIGNING & PAVEMENT
MARKING PLAN**

SHEET NO.
5-14

THE OFFICIAL RECORD OF THIS SHEET IS THE ELECTRONIC FILE DIGITALLY SIGNED AND SEALED UNDER RULE 61G15-23.004, F.A.C.

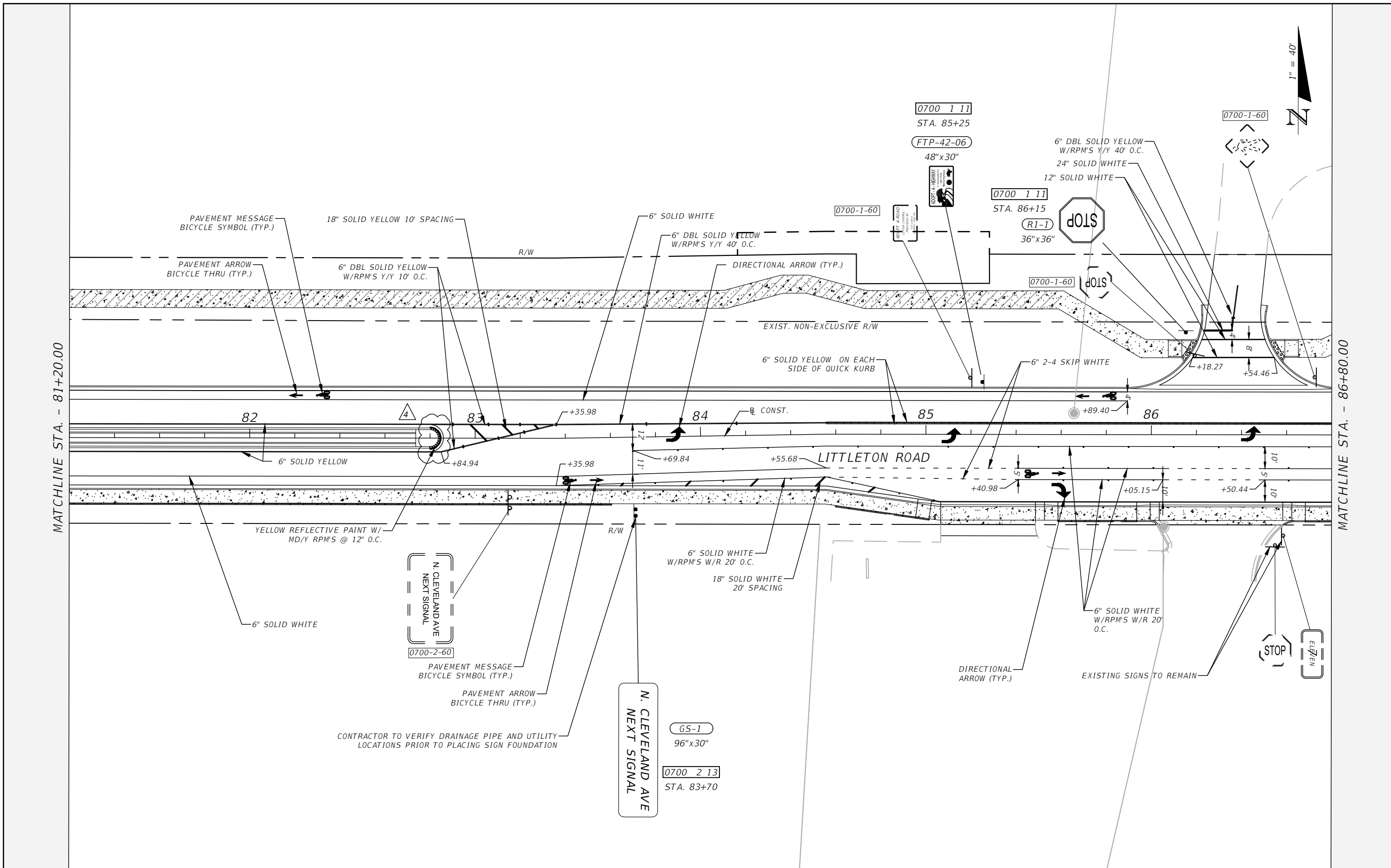

MATCHLINE STA. - 81+20.00

MATCHLINE STA. - 86+80.00



REVISIONS		DATE	DESCRIPTION
4-28-23	Added RPM's and Yellow Ref. Paint.	4	

DANIEL M. CRAIG P.E.
 P.E. LICENSE NUMBER 38590
 STANTEC, INC.
 1821 VICTORIA AVE,
 FORT MYERS, FL 33901

LEE COUNTY DEPARTMENT OF TRANSPORTATION		
ROAD NAME	COUNTY	CONTRACT NO.
LITTLETON ROAD	LEE	CN190114

**SIGNING & PAVEMENT
MARKING PLAN**

SHEET NO.
5-15

THE OFFICIAL RECORD OF THIS SHEET IS THE ELECTRONIC FILE DIGITALLY SIGNED AND SEALED UNDER RULE 61G15-23.004, F.A.C.



NOTES

- ADJUST VIDEO DETECTION CAMERA CD-3 AND SETTINGS FOR THE ADJUSTED DETECTION ZONE LOCATIONS. THIS WORK IS TO BE UNDER PAY ITEM 0660 4 51 AND 0660 4 52. ALL OTHER DETECTION ZONES FOR THE OTHER CAMERAS SHALL REMAIN AS EXISTING. THE CONTRACTOR SHALL VERIFY CAMERA ID PRIOR TO MAKING ADJUSTMENTS.
- CONTRACTOR SHALL REQUEST UPDATED SIGNAL TIMINGS FROM LEE COUNTY WHEN ALL LANES, STRIPING, SIGNALS AND PEDESTRIAN FACILITIES ARE IN THEIR FINAL CONFIGURATION AND THE SIGNAL IS OPERATING AS DESIGNED. PROVIDE LEE COUNTY WITH ALL 'AS-BUILT' INFORMATION NECESSARY TO DEVELOP THE BASIC SIGNAL TIMING PARAMETERS AND ALLOW THREE (3) WEEKS FOLLOWING THE REQUEST FOR LEE COUNTY TO DEVELOP THE UPDATED TIMINGS. PROGRAM THE CONTROLLER PER THE TIMINGS PROVIDED BY LEE COUNTY.

VIDEO VEHICLE DETECTION ASSIGNMENTS			
CAMERA DETECTOR NO.	DETECTION ZONE	CONNECT TO MOVEMENT	DELAY TIME (SEC)
CD-1	DZ-1	1	
CD-1	DZ-6A B	6	
CD-2	DZ-5	5	
CD-2	DZ-2A B	2	
CD-3	DZ-3	3	
CD-3	DZ-8	8	
CD-3	DZ-8R	8	
CD-4	DZ-4	4	
CD-4	DZ-7	7	

CONTROLLER TIMINGS								
MOVEMENT #	1	2	3	4	5	6	7	8
DIRECTION	NBL	SB	EBL	WB	SBL	NB	WBL	EB
TURN TYPE	PROT		PP		PROT		PP	
MINIMUM GREEN	5	20	5	10	5	20	5	10
EXTENSION	2.0	5.0	2.0	3.0	2.0	5.0	2.0	3.0
YELLOW CLEARANCE	5.6	5.6	4.8	4.8	5.6	5.6	4.8	4.8
ALL RED	3.3	2.0	2.3	2.3	3.0	2.0	2.3	2.3
MAXIMUM GREEN 1	15	60	25	50	15	60	25	50
MAXIMUM GREEN 2								
WALK		7		7		7		7
FLASHING DON'T WALK		25		31		17		36
DET. CROSS SWITCH								
DUAL ENTRY		ON		ON		ON		ON
RECALL		MIN				MIN		

TIMINGS ARE INITIAL AND MAY REQUIRE FIELD ADJUSTING AS DIRECTED BY PROJECT ENGINEER.

END SIGNING & PAVT. MARKING
STA. 88+95.16

MATCHLINE STA. - 86+80.00

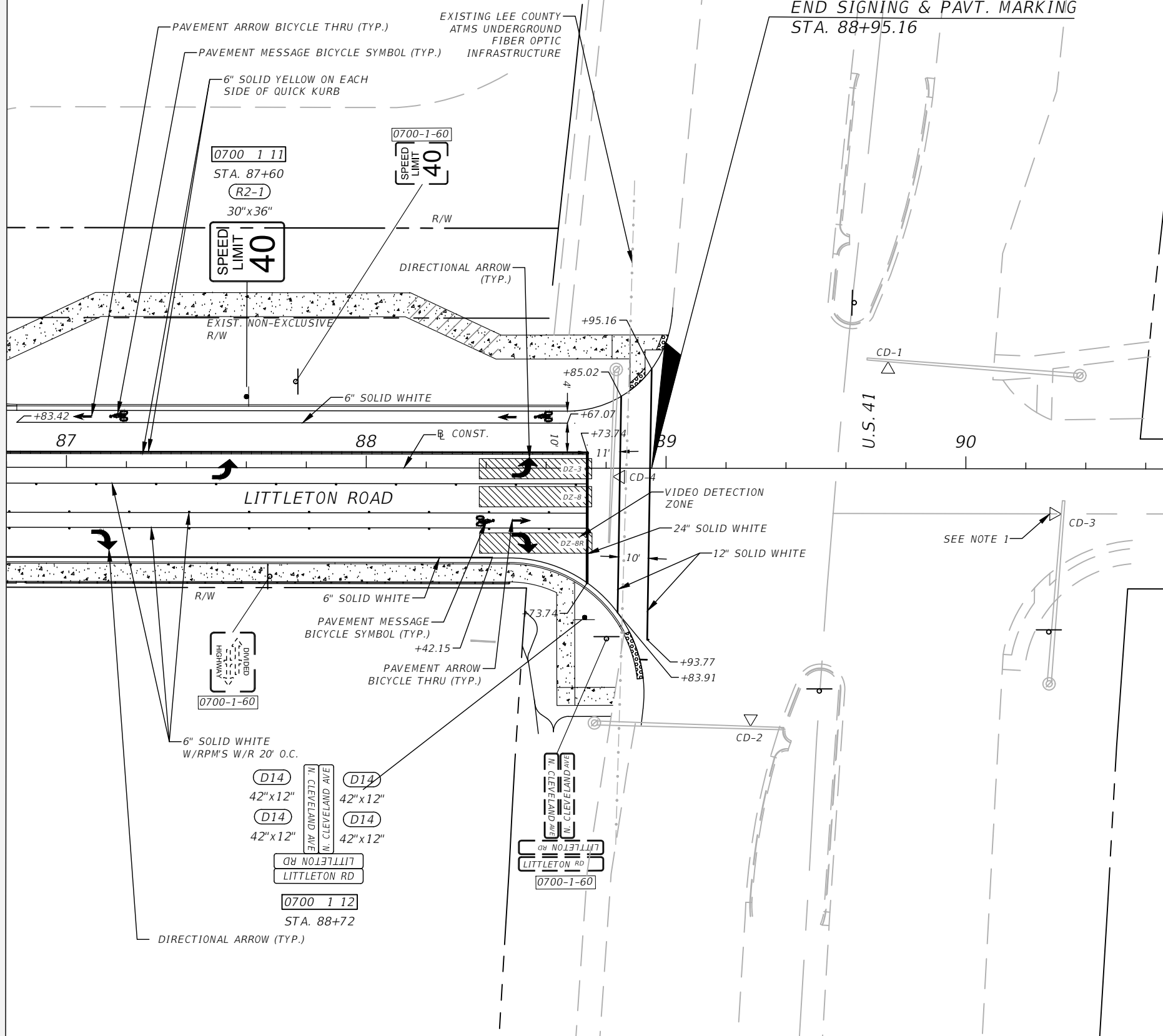

REVISIONS			
DATE	DESCRIPTION	DATE	DESCRIPTION

DANIEL M. CRAIG P.E.
P.E. LICENSE NUMBER 38590
STANTEC, INC.
1821 VICTORIA AVE,
FORT MYERS, FL 33901

LEE COUNTY DEPARTMENT OF TRANSPORTATION		
ROAD NAME	COUNTY	CONTRACT NO.
LITTLETON ROAD	LEE	CN190114

**SIGNING & PAVEMENT
MARKING PLAN**

SHEET NO.
5-16

THE OFFICIAL RECORD OF THIS SHEET IS THE ELECTRONIC FILE DIGITALLY SIGNED AND SEALED UNDER RULE 61G15-23.004, F.A.C.

SIGN NAME	D3-2		QTY	1	SIGN NUMBER	83+70	STATION(S)
PANEL	BORDER						
WIDTH	8'-0"	WIDTH	0.9"				
HEIGHT	2'-6"	RADII	2.15"				
LEGEND	White	COLOR	White				
COLOR	Green						
SYMBOL(S)	ANGLE	X	Y	WID	HT		
SIGN NUMBER	NUMBER OF POSTS	CLEARANCE Edge Of Land	COLUMN SIZE	AVERAGE LENGTH			
GS-1	2	7.5	W6X12	11.81			

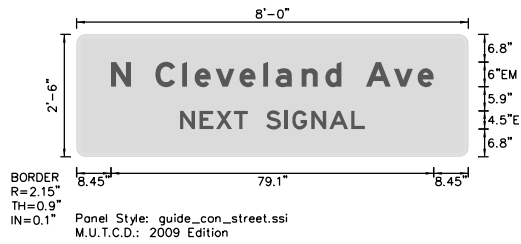

NO. OF LIGHT FIXTURES	FIXTURE SPACING	PHOTOMETRIC CURVE	WATT	VOLTAGE
-----------------------	-----------------	-------------------	------	---------

COPY	N	C	I	e	v	e	I	a	n	d	A	v	e	L	
SPACE	8.5	13.3	19.3	25.9	34.1	39.9	45.7	48.8	55.1	61	64.9	70.9	77.8	83.6	79.1
COPY	N	E	X	T	S	I	G	N	A	L	L				
SPACE	25.3	30.2	34.2	38.6	41.9	46.4	51	52.8	57.5	61.9	67.3	45.3			
COPY															
SPACE															
COPY															
SPACE															
COPY															
SPACE															
COPY															
SPACE															

SIGN NAME			QTY		SIGN NUMBER		STATION(S)
PANEL	BORDER						
WIDTH	WIDTH						
HEIGHT	RADII						
LEGEND	COLOR						
COLOR							
SYMBOL(S)	ANGLE	X	Y	WID	HT		
SIGN NUMBER	NUMBER OF POSTS	CLEARANCE Edge Of Land	COLUMN SIZE	AVERAGE LENGTH			

NO. OF LIGHT FIXTURES	FIXTURE SPACING	PHOTOMETRIC CURVE	WATT	VOLTAGE
-----------------------	-----------------	-------------------	------	---------

COPY															
SPACE															
COPY															
SPACE															
COPY															
SPACE															
COPY															
SPACE															
COPY															
SPACE															
COPY															
SPACE															

SIGN NAME			QTY		SIGN NUMBER		STATION(S)
PANEL	BORDER						
WIDTH	WIDTH						
HEIGHT	RADII						
LEGEND	COLOR						
COLOR							
SYMBOL(S)	ANGLE	X	Y	WID	HT		
SIGN NUMBER	NUMBER OF POSTS	CLEARANCE Edge Of Land	COLUMN SIZE	AVERAGE LENGTH			

NO. OF LIGHT FIXTURES	FIXTURE SPACING	PHOTOMETRIC CURVE	WATT	VOLTAGE
-----------------------	-----------------	-------------------	------	---------

COPY															
SPACE															
COPY															
SPACE															
COPY															
SPACE															
COPY															
SPACE															
COPY															
SPACE															

SIGN NAME			QTY		SIGN NUMBER		STATION(S)
PANEL	BORDER						
WIDTH	WIDTH						
HEIGHT	RADII						
LEGEND	COLOR						
COLOR							
SYMBOL(S)	ANGLE	X	Y	WID	HT		
SIGN NUMBER	NUMBER OF POSTS	CLEARANCE Edge Of Land	COLUMN SIZE	AVERAGE LENGTH			

NO. OF LIGHT FIXTURES	FIXTURE SPACING	PHOTOMETRIC CURVE	WATT	VOLTAGE
-----------------------	-----------------	-------------------	------	---------

COPY															
SPACE															
COPY															
SPACE															
COPY															
SPACE															
COPY															
SPACE															
COPY															
SPACE															

REVISIONS			
DATE	DESCRIPTION	DATE	DESCRIPTION

DANIEL M. CRAIG, P.E.
P.E. LICENSE NUMBER 38590
STANTEC, INC.
1821 VICTORIA AVE.
FORT MYERS, FL 33901

LEE COUNTY DEPARTMENT OF TRANSPORTATION		
ROAD NAME	COUNTY	CONTRACT NO.
LITTLETON RD.	LEE	CN190114

**GUIDE SIGN
WORKSHEET**

SHEET NO.
S-17

THE OFFICIAL RECORD OF THIS SHEET IS THE ELECTRONIC FILE DIGITALLY SIGNED AND SEALED UNDER RULE 61G15-23.004, F.A.C.

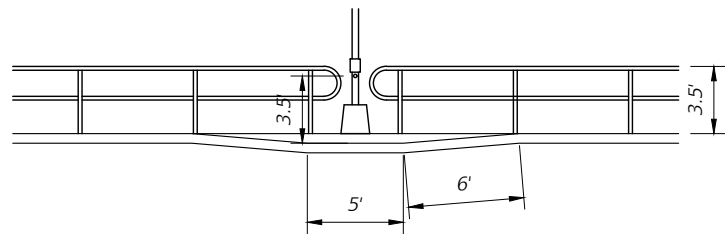
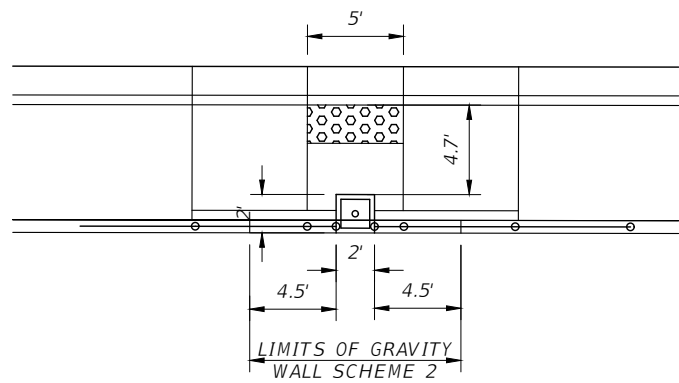

PLAN VIEW OF RRFB AT STA. 77+08.76

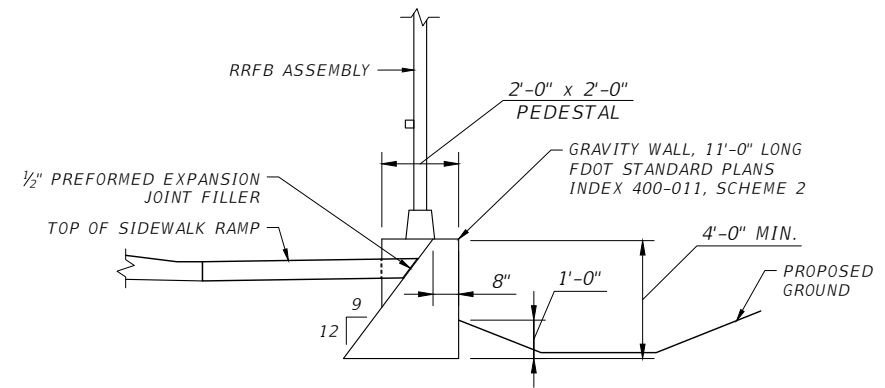

NOTE: JOINTS SHALL NOT BE PERMITTED WITHIN THE 11'-0" LONG SCHEME 2 GRAVITY WALL. REFER TO FDOT STANDARD PLANS INDEX 654-001 FOR REINFORCING DETAILS.

FOUNDATION DETAIL OF RRFB AT STA. 77+08.76

THE OFFICIAL RECORD OF THIS SHEET IS THE ELECTRONIC FILE DIGITALLY SIGNED AND SEALED UNDER RULE 61G15-23.004, F.A.C.

REVISIONS				DANIEL M. CRAIG, P.E. P.E. LICENSE NUMBER 38590 STANTEC, INC. 1821 VICTORIA AVE FORT MYERS, FL 33901	LEE COUNTY DEPARTMENT OF TRANSPORTATION			SHEET NO. 5-18
DATE	DESCRIPTION	DATE	ROAD NAME		COUNTY	CONTRACT NO.		
4-28-23	Corrected misspelled word. Added note. 4		LITTLETON ROAD		LEE	CN190114		