

CL ACCESS POINT STA 598+14.34
PINE ISLAND RD

CL ACCESS POINT STA 605+90.41
WEST SIDE

CL ACCESS POINT STA 604+90.41
EAST SIDE

CL ACCESS POINT STA 613+00
WEST SIDE

CL ACCESS POINT STA 611+22.83
EAST SIDE

CL ACCESS POINT STA 623+37
WEST SIDE

PROPOSED
CL ACCESS POINT STA 643+50
EAST SIDE

CL ACCESS POINT STA 635+31
WEST SIDE

VETERANS PARKWAY
CONTROLLED ACCESS PLAN
From Burnt Store Rd/Pine Island Rd (SR 78)
to the Caloosahatchee River

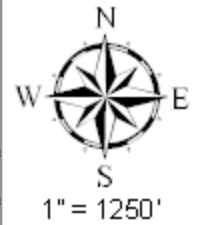

CL ACCESS POINT STA 667+90
WEST SIDE

CL ACCESS POINT STA 685+00
EAST SIDE

CL ACCESS POINT STA 718+50
NO RTH SIDE

CL ACCESS POINT STA 734+00
NO RTH SIDE

STATION EQUATIO N 772+43.64 BACK
STATION EQUATIO N 772+44.37 A HEAD

CL ACCESS POINT STA 774+70.77
SW 20TH AVE - NORTH & SOUTH SIDES

CL ACCESS POINT STA 801+09.19
CHICOUITA BLVD - NORTH & SOUTH SIDES

CL ACCESS POINT STA 748+04.02
SURFSIDE BLVD - NO RTH & SOUTH SIDES

CL ACCESS POINT STA 751+27.40
SW 22ND PL - SOUTH SIDE

CL ACCESS POINT STA 789+45.65
SW 17TH AVE - NORTH SIDE

VETERANS PARKWAY
CONTROLLED ACCESS PLAN
From Burnt Store Rd/Pine Island Rd (SR 78)
to the Caloosahatchee River

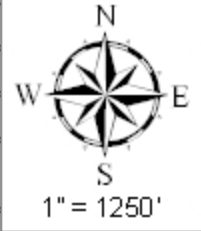

CL ACCESS POINT STA 834+67.57
SW 11TH AVE - NORTH SIDE

CL CLOSURE INSTRUCTION STA 854+07.68
SKYLINE BLVD - NORTH & SOUTH SIDE

CL ACCESS POINT STA 937+78.31
KAMAL PKWY - SOUTH SIDE

CL ACCESS POINT STA 821+67.50
SW 12TH PL - SOUTH SIDE

CL ACCESS POINT STA 890+27
SW 2ND CT - NORTH SIDE
(RELOCATED FROM STA 891+68.28)

CL ACCESS POINT STA 894+61.47
SW 2ND PL - SOUTH SIDE

CL ACCESS POINT STA 910+07.33
SANTA BARBARA BLVD - NORTH & SOUTH SIDE

VETERANS PARKWAY
CONTROLLED ACCESS PLAN
From Burnt Store Rd/Pine Island Rd (SR 78)
to the Caloosahatchee River

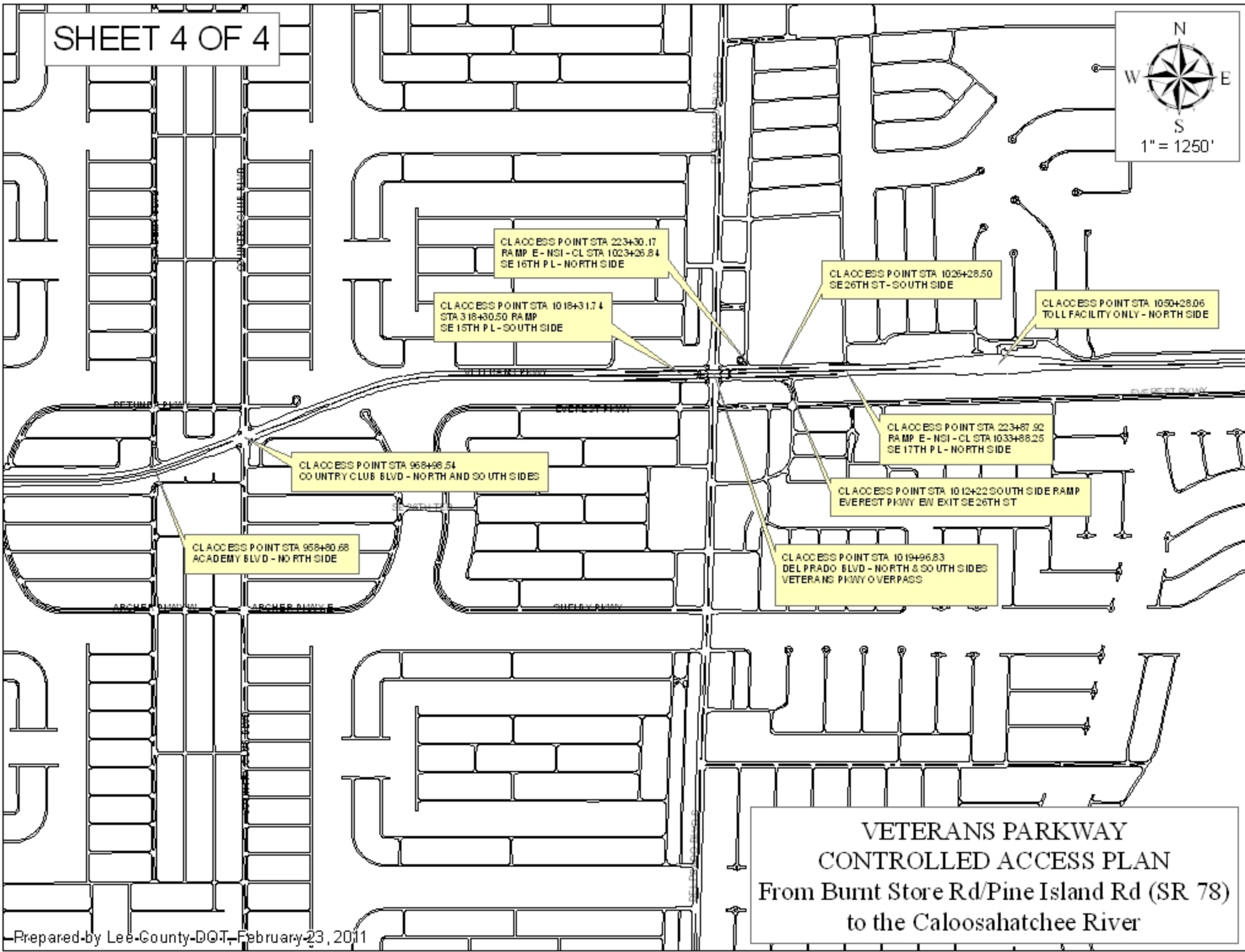

CL ACCESS POINT STA 223+30.17
RAMP E- NSI - CL STA 1023+25.84
SE 16TH PL - NORTH SIDE

CL ACCESS POINT STA 1018+31.74
STA 318+30.50 RAMP
SE 15TH PL - SOUTH SIDE

CL ACCESS POINT STA 1025+28.50
SE 26TH ST - SOUTH SIDE

CL ACCESS POINT STA 1050+28.06
TOLL FACILITY ONLY - NORTH SIDE

CL ACCESS POINT STA 968+96.54
COUNTRY CLUB BLVD - NORTH AND SOUTH SIDES

CL ACCESS POINT STA 968+90.68
ACADEMY BLVD - NORTH SIDE

CL ACCESS POINT STA 223+87.92
RAMP E- NSI - CL STA 1033+88.25
SE 17TH PL - NORTH SIDE

CL ACCESS POINT STA 1012+22 SOUTH SIDE RAMP
EVEREST HWY BN EXIT SE 26TH ST

CL ACCESS POINT STA 1019+96.83
DEL PRADO BLVD - NORTH & SOUTH SIDES
VETERANS PKWY OVERPASS

VETERANS PARKWAY
CONTROLLED ACCESS PLAN
From Burnt Store Rd/Pine Island Rd (SR 78)
to the Caloosahatchee River