

**Lee County Board Of County Commissioners
Agenda Item Summary**

Blue Sheet No. 20061470

1. ACTION REQUESTED/PURPOSE: Conduct first public hearing on the proposed designation of Treeline Boulevard/Ben Hill Griffin Parkway as a controlled access facility between Daniels Parkway and Alico Road.

2. WHAT ACTION ACCOMPLISHES: The Land Development Code requires that the Board adopt resolutions that designate roadways as controlled access facilities utilizing the same process applicable to the adopting of ordinances affecting the use of land.

3. MANAGEMENT RECOMMENDATION: Direct to second public hearing on November 28, 2006, at 5:05 p.m.

4. Departmental Category: 09 **S:05PM PH 3** **5. Meeting Date:** 11-14-06

6. Agenda:		7. Requirement/Purpose: (specify)		8. Request Initiated:	
<input type="checkbox"/> Consent	<input type="checkbox"/> Statute	<input type="checkbox"/> Commissioner		<input type="checkbox"/> Department DOT	
<input type="checkbox"/> Administrative	<input type="checkbox"/> Ordinance	<input type="checkbox"/> Department		<input type="checkbox"/> Division	
<input type="checkbox"/> Appeals	<input type="checkbox"/> Admin. Code	<input type="checkbox"/> By:		<input type="checkbox"/>	
<input checked="" type="checkbox"/> Public 5:05	<input checked="" type="checkbox"/> Other Resolution pursuant to LDC-10-298	<input type="checkbox"/>		<input type="checkbox"/>	
<input type="checkbox"/> Walk-On		<input type="checkbox"/>		<input type="checkbox"/>	
				Scott Gilbertson Director, DOT	

9. Background:
A controlled access roadway/facility is a roadway that is the subject of a Board resolution, designating the road as a controlled access facility and specifying the access points along the roadway corridor. The Board may only designate roadways as controlled access facilities by adopting a resolution through the public hearing process.

The purpose of designating a roadway as a controlled access facility is to preserve safety and optimize the roadway's traffic capacity. The intent of the resolution is to set access points at specific locations and restrict access along the designated corridor to those locations. The Board's adoption of a controlled access road resolution does not guarantee, create, or vest in any property owner a right or property interest with respect to the designated access point, median opening, or turning movement. Approval for construction of new or use of an existing access point, median opening, or turning movement is reserved to the County. The County's approval will be based upon facts and circumstances applicable to the request at the time of the application for development order or permit submittal.

DOT staff recommends the designation of the Treeline Boulevard/Ben Hill Griffin Parkway corridor from Daniels Parkway to Alico Road as a controlled access facility. The attached resolution and sketch depict the recommended access points along the roadway corridor. Staff recommends direction to the second public hearing on November 28, 2006.

10. Review for Scheduling:

Department Director	Purchasing or Contracts	Human Resources	Other	County Attorney	Budget Services				County Manager/P.W. Director
<i>11/7/06</i>	N/A	N/A	N/A	<i>DNC 11/1/06</i>	Analyst	Risk	Grants	Mgr.	<i>11-1-06</i>
<i>[Signature]</i>					<i>RK 11/1</i>	<i>[Signature]</i>	<i>[Signature]</i>	<i>[Signature]</i>	

11. Commission Action:

- Approved
- Deferred
- Denied
- Other

RECEIVED BY COUNTY ADMIN:
11/1/06 2:10

COUNTY ADMIN FORWARDED TO:
11/1/06 2:15 R.K.
11/2/06 R. Law 9:00

FORWARDED TO:
COUNTY ADMIN

RECEIVED BY
COUNTY ADMIN

Rec. by CoAtty
Date: *11/1/06*
Time: *1:00 pm*
Forwarded To: *[Signature]*
11/1/06 2:00 PM

LEE COUNTY RESOLUTION NO. 06-11-_____

A RESOLUTION OF THE BOARD OF COUNTY COMMISSIONERS OF LEE COUNTY FLORIDA DESIGNATING BEN HILL GRIFFIN PARKWAY AND TREELINE AVENUE BETWEEN ALICO ROAD AND DANIELS PARKWAY AS A CONTROLLED ACCESS FACILITY IN ACCORDANCE WITH CHAPTER 10 OF THE LEE COUNTY LAND DEVELOPMENT CODE, AND ESTABLISHING PERMANENT ACCESS POINTS.

WHEREAS, the Board of County Commissioners (Board) is considered the transportation authority in Lee County by virtue of the authority granted in Florida Statutes, Section 125.01(m), to provide and regulate roads; and,

WHEREAS, the Board, as transportation authority, has the power to establish, designate, and regulate controlled access facilities in accordance with Chapter 10 of the Land Development Code (LDC); and,

WHEREAS, the Board desires to designate and establish Ben Hill Griffin Parkway and Treeline Boulevard, between Alico Road and Daniels Parkway, as a controlled access facility with fixed access points; and,

WHEREAS, the Board designates roadways as controlled access facilities in order to allow for the safe and relatively unimpeded movement of large volumes of traffic; and,

WHEREAS, the Board finds that the designation of this roadway corridor as a controlled access facility will preserve safety and traffic capacity and, therefore, is in the best interest of the public.

NOW, THEREFORE, be it resolved by the Board of County Commissioners that:

1. Ben Hill Griffin Parkway and Treeline Avenue, between Alico Road and Daniels Parkway, is hereby designated as a controlled access facility with fixed access points in accordance with Chapter 10 of the LDC.
2. The fixed access points along this roadway corridor are set forth in detail in the attached exhibit and map/sketch.
3. The Board's adoption of this resolution does not guarantee, create, or vest in any property owner a right or property interest with respect to a designated access point, median opening, or turning movement.
4. Approval for the construction of a new, or use of an existing access point, median

opening, or turning movement is reserved to the County. Approval of such requests will be based upon facts and circumstances applicable to the request at the time of application for development order or permit submittal.

5. This resolution was adopted by an affirmative vote of a super majority of the Board of County Commissioners.

Commissioner _____ made a motion to adopt the foregoing resolution, seconded by Commissioner _____. The vote was as follows:

Robert P. Janes
Douglas R. St. Cerny
Ray Judah
Tammara Hall
John Albion

Duly passed and adopted this ____ day of November 2006.

ATTEST:
CHARLIE GREEN, CLERK

BOARD OF COUNTY COMMISSIONERS
OF LEE COUNTY, FLORIDA

BY: _____
Deputy Clerk

BY: _____
Tammara Hall, Chairwoman

Approved as to form by:

Donna Marie Collins
County Attorney's Office

Exhibit 1: Ben Hill Griffin Parway/Treeline Avenue Access Map

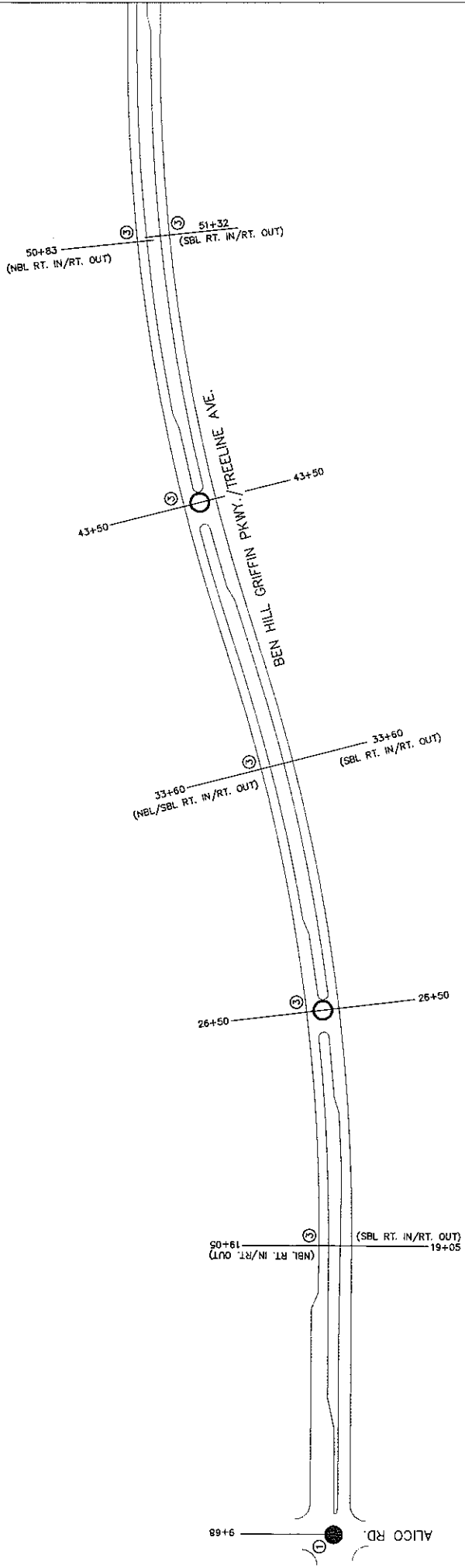

LEB COUNTY
 SOUTH WEST
 FLORIDA
 DEPARTMENT
 of
 TRANSPORTATION
 PUBLIC WORKS ADMINISTRATION

**BEN HILL GRIFFIN PKWY./
 TREELINE AVE.
 DESIGNATED ACCESS POINTS**
 ADOPTED _____ PER RESOLUTION # _____

- ① EXISTING SIGNAL
- ALL MOVEMENTS DESIGNATED

LEGEND

- ① ORIGINAL PLAN
- ② DEVELOPMENT ACCESS
- ③ OCTOBER 19, 1999 MEMORANDUM OF UNDERSTANDING

BEN HILL GRIFFIN PKWY./TREELINE AVE.

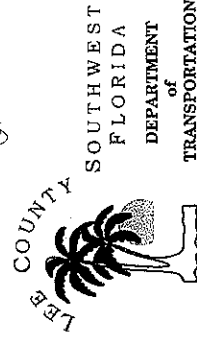
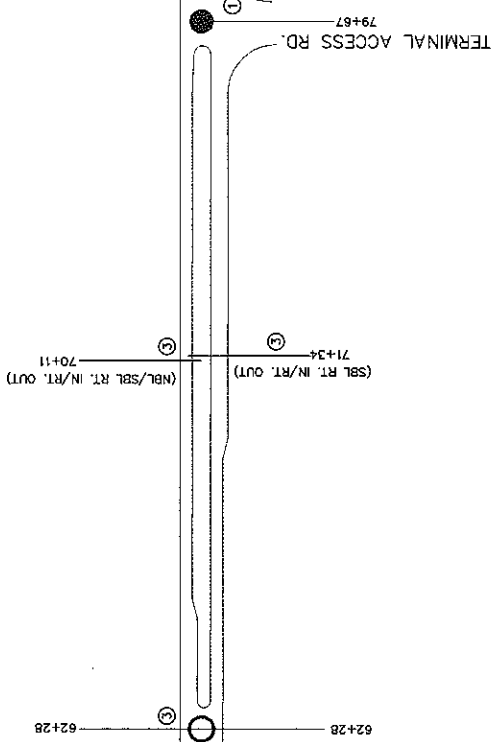

PUBLIC WORKS ADMINISTRATION

**BEN HILL GRIFFIN PKWY./
TREELINE AVE.
DESIGNATED ACCESS POINTS**

LEGEND

- ① ORIGINAL PLAN
- ② DEVELOPMENT ACCESS
- ③ OCTOBER 19, 1999 MEMORANDUM OF UNDERSTANDING

- EXISTING SIGNAL
- ALL MOVEMENTS DESIGNATED

ADOPTED _____ PER RESOLUTION # _____

BEN HILL GRIFFIN PKWY./TREELINE AVE.



LEB COUNTY SOUTHWEST
FLORIDA
DEPARTMENT
of
TRANSPORTATION
PUBLIC WORKS ADMINISTRATION

BEN HILL GRIFFIN PKWY./
TREELINE AVE.
DESIGNATED ACCESS POINTS

ADOPTED _____ PER RESOLUTION # _____

LEGEND

- ① ORIGINAL PLAN
- ② DEVELOPMENT ACCESS
- ③ OCTOBER 19, 1999 MEMORANDUM OF UNDERSTANDING

- EXISTING SIGNAL
- ALL MOVEMENTS DESIGNATED

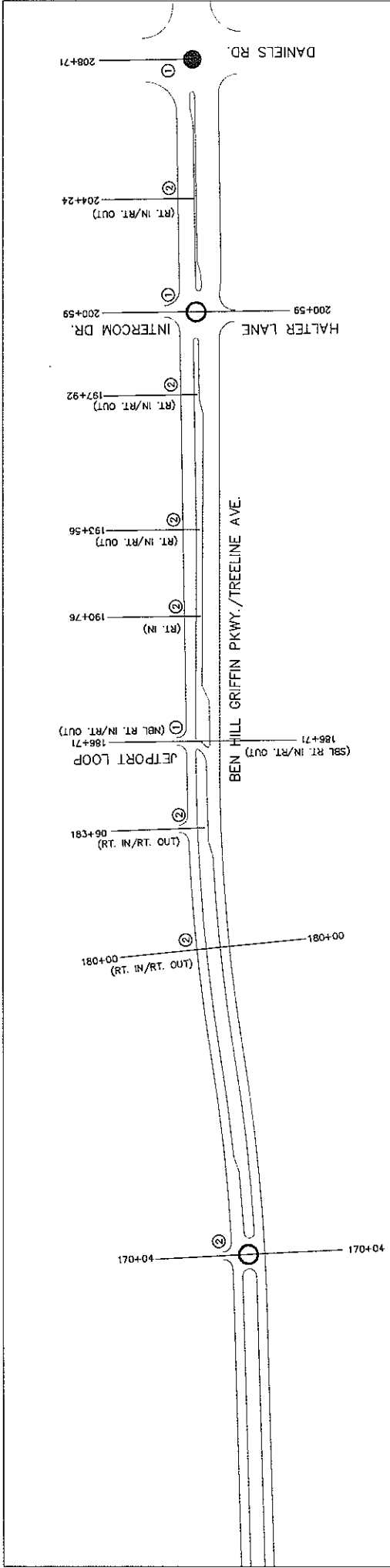

LEB COUNTY
 SOUTHWEST
 FLORIDA
 DEPARTMENT
 of
 TRANSPORTATION
 PUBLIC WORKS ADMINISTRATION

**BEN HILL GRIFFIN PKWY./
 TREELINE AVE.
 DESIGNATED ACCESS POINTS**

ADOPTED _____ PER RESOLUTION # _____

- LEGEND**
- ① ORIGINAL PLAN
 - ② DEVELOPMENT ACCESS
 - ③ OCTOBER 19, 1999 MEMORANDUM OF UNDERSTANDING
 - EXISTING SIGNAL
 - ALL MOVEMENTS DESIGNATED

DRAFT 10/31/06 EXHIBIT A
BEN HILL GRIFFIN PARKWAY/TREELINE AVENUE
DESIGNATED ACCESS POINTS

STATION	DISTANCE (FEET)		ORIGIN	MEDIAN OPENING	MOVEMENTS	CONNECTION	REMARKS
	North	South					
9+68+/-50	n/a	n/a	1	YES	ALL	Alico Road	Existing signalized connection
19+05+/-50	937	937	3	YES	NBL/SBL RT.IN/RT.OUT	E & W	Existing NBL, SBL & east connection does not exist
26+50+/-50	745	745	3	YES	ALL	E & W	Existing connection
33+60+/-50	710	710	3	YES	NBL/SBL RT.IN/RT.OUT	E & W	Existing NBL, SBL & east connection does not exist
43+50+/-50	990	990	3	YES	ALL	Airport Technology Pkwy (E) & W	Existing connection
50+83+/-50	n/a	733	3	YES	NBL RT.IN/RT.OUT	W	Existing connection
51+32+/-50	782	n/a	3	YES	SBL RT.IN/RT.OUT	E	Existing connection
62+28+/-50	1096	1145	3	YES	ALL	E & W	Existing connection
70+11+/-50	n/a	783	3	YES	NBL RT.IN/RT.OUT	W	Existing connection
71+34+/-50	906	n/a	3	YES	SBL RT.IN/RT.OUT	E	Existing connection - SBL does not exist
79+67+/-50	833	956	1	YES	ALL	Terminal Access Road	Existing signalized connection, future overpass and western extension to I-75
170+04+/-50	9037	9037	2	YES	ALL	E & W	Existing connection
180+00+/-50	996	996	2	NO	RT.IN/RT.OUT	E & W	New - Does not exist, can shift south (east side) up to 330 ft, west side retention area
183+90+/-50	n/a	390	2	NO	RT.IN/RT.OUT	W	Existing connection
190+76+/-50	671	281	1	YES	NBL/SBL RT.IN/RT.OUT	Lippizan Road (E) & Jetport Loop (W)	Existing connection, OR 3332 PG 1458, dirt road to east
193+56+/-50	n/a	405	2	NO	RT.IN	W	Existing connection
197+92+/-50	n/a	280	2	NO	RT.IN/RT.OUT	W	Existing connection
200+59+/-50	1388	436	2	NO	RT.IN/RT.OUT	Jetport Lane? (W)	Platted lot - Connection does not exist
204+24+/-50	n/a	267	1	YES	ALL	Halter Lane (E) & Intercom Drive (W)	Existing connection, signalized median opening constructed with roadway
208+71+/-50	812	365	2	NO	RT.IN/RT.OUT	W	New - Does not exist
		447	1	YES	ALL	Daniels Parkway	Existing signalized median opening

Thirty permanent access points
 No temporary access points
 No pending access points
 Length 3.77 miles
 Avg spacing 1318 feet
 Spacing excluding airport property and entrance = 772 feet

WBL = Westbound left
 EBL = Eastbound left
 NBL = Northbound left
 SBL = Southbound left

- Notes
- Original plan
 - Development access
 - October 19, 1999 Memorandum of Understanding