

**Lee County Board Of County Commissioners
Agenda Item Summary**

Blue Sheet No. 20031292

1. REQUESTED MOTION:

ACTION REQUESTED:

Approve the Roadway Lighting System Agreement with the Florida Department of Transportation for roadway lighting on SR 93 (I-75) @ Alico Road. Also, approve the Resolution authorizing the Chairman to execute this Agreement

WHY ACTION IS NECESSARY:

Requires Board of County Commissioner approval for agreements.

WHAT ACTION ACCOMPLISHES:

By agreeing to the installation of the lighting, at no cost to the County, Florida Department of Transportation will proceed to replace the existing lighting system with a new system meeting today's current standards. Lee County will only be responsible for the lights not within limited access right-of-way.

**2. DEPARTMENTAL CATEGORY:
COMMISSION DISTRICT #**

C9A

3. MEETING DATE:

12-02-2003

4. AGENDA:

- CONSENT
- ADMINISTRATIVE
- APPEALS
- PUBLIC
- WALK ON
- TIME REQUIRED:

**5. REQUIREMENT/PURPOSE:
(Specify)**

- STATUTE
- ORDINANCE
- ADMIN.
- CODE
- OTHER

6. REQUESTOR OF INFORMATION:

- A. COMMISSIONER _____
- B. DEPARTMENT Transportation
- C. DIVISION _____

BY: Scott M. Gilbertson, P. E.
Director

7. BACKGROUND:

The Florida Department of Transportation (FDOT) has agreed to replace the existing lighting system for the project identified as SR 93 (I-75) @ Alico Road, which covers the unincorporated area of Lee County from Three Oaks Parkway to Ben Hill Griffin Road, with a new system to meet today's current standards. The cost of this new system will be at the expense of FDOT. Lee County Department of Transportation's responsibility will be to maintain and pay the monthly power bill..

This Agreement establishes the commitment of Lee County to serve as the maintaining local agency for these roadway lights.

8. MANAGEMENT RECOMMENDATIONS:

9. RECOMMENDED APPROVAL:

A Department Director	B Purchasing or Contracts	C Human Resources	D Other	E County Attorney	F Budget Services				G County Manager
<i>11/12/03</i>	<i>11/13</i> <i>No contract # needed</i>	<i>N/A</i>		<i>Debra</i>	<i>OA</i>	<i>OM</i>	<i>Risk</i>	<i>GC</i>	<i>11-13-03</i>
					<i>11/17</i>	<i>11/20/03</i>	<i>11/17/03</i>	<i>11-17-03</i>	

10. COMMISSION ACTION:

- APPROVED
- DENIED
- DEFERRED
- OTHER

Rec. by CoAtty
Date: *11/13/03*
Time: *2:55*
Forwarded to:
Budget
11/14/03 9:35am

RECEIVED BY
COUNTY ADMIN: *AM*
11/14/03
9:50 AM SET
COUNTY ADMIN
FORWARDED TO:
11/20/03

LEE COUNTY RESOLUTION NO. _____

**A RESOLUTION AUTHORIZING LEE COUNTY TO
ENTER INTO A ROADWAY LIGHTING SYSTEM MAINTENANCE AGREEMENT
WITH THE FLORIDA DEPARTMENT OF TRANSPORTATION
FOR SR 93 (I-75) @ ALICO ROAD**

THIS IS A RESOLUTION to the Board of County Commissioners, Lee County, Florida, a political subdivision of the State, authorizing the execution of a Roadway Lighting System Agreement with the Florida Department of Transportation (FDOT) for SR 93 (I-75) @ Alico Road.

WHEREAS, Lee County, Florida, has the statutory authority to enter into an Agreement with the Florida Department of Transportation in accordance with Section 334.044, Florida Statutes.

NOW, THEREFORE, BE IT RESOLVED BY THE BOARD OF COUNTY COMMISSIONERS, LEE COUNTY, FLORIDA, that:

- 1. Roadway Lighting System Agreement for SR 93 (I-75) @ Alico Road, which covers the unincorporated area of Lee County from Three Oaks Parkway to Ben Hill Griffin Road, is hereby approved.
- 2. In return for the installation of the Lighting System by Florida Department of Transportation the Roadway, and as provided for in this Agreement, the County agrees to maintain the Lighting System.
- 3. The Chairman of, and the Clerk to the Board of Lee County Commissioners are hereby authorized to execute said Agreement.
- 4. The Clerk of the Circuit Court is hereby authorized and directed to transmit one (1) certified copy of this Resolution to the Florida Department of Transportation along with the executed Agreements.

DONE AND ADOPTED with a quorum present and voting on this _____ day of _____, 2002.

ATTEST: CHARLIE GREEN
CLERK OF COURTS

BOARD OF COUNTY COMMISSIONERS
OF LEE COUNTY, FLORIDA

By: _____
Deputy Clerk

By: _____
Chairman

APPROVED AS TO FORM:

By: _____
Office of the County Attorney

LEE COUNTY RESOLUTION NO. _____

**A RESOLUTION AUTHORIZING LEE COUNTY TO
ENTER INTO A ROADWAY LIGHTING SYSTEM MAINTENANCE AGREEMENT
WITH THE FLORIDA DEPARTMENT OF TRANSPORTATION
FOR SR 93 (I-75) @ ALICO ROAD**

THIS IS A RESOLUTION to the Board of County Commissioners, Lee County, Florida, a political subdivision of the State, authorizing the execution of a Roadway Lighting System Agreement with the Florida Department of Transportation (FDOT) for SR 93 (I-75) @ Alico Road.

WHEREAS, Lee County, Florida, has the statutory authority to enter into an Agreement with the Florida Department of Transportation in accordance with Section 334.044, Florida Statutes.

NOW, THEREFORE, BE IT RESOLVED BY THE BOARD OF COUNTY COMMISSIONERS, LEE COUNTY, FLORIDA, that:

1. Roadway Lighting System Agreement for SR 93 (I-75) @ Alico Road, which covers the unincorporated area of Lee County from Three Oaks Parkway to Ben Hill Griffin Road, is hereby approved.
2. In return for the installation of the Lighting System by Florida Department of Transportation the Roadway, and as provided for in this Agreement, the County agrees to maintain the Lighting System.
3. The Chairman of, and the Clerk to the Board of Lee County Commissioners are hereby authorized to execute said Agreement.
4. The Clerk of the Circuit Court is hereby authorized and directed to transmit one (1) certified copy of this Resolution to the Florida Department of Transportation along with the executed Agreements.

DONE AND ADOPTED with a quorum present and voting on this _____ day of _____, 2002.

ATTEST: CHARLIE GREEN
CLERK OF COURTS

BOARD OF COUNTY COMMISSIONERS
OF LEE COUNTY, FLORIDA

By: _____
Deputy Clerk

By: _____
Chairman

APPROVED AS TO FORM:

By: _____
Office of the County Attorney



380 Park Place Blvd. • Suite 300 • Clearwater, FL 33759

Main: 727.531.3505
800.861.8314
Fax: 727.539.1294
www.tbegroup.com

October 13, 2003

Mr. Richard Epps
Traffic Engineer
Lee County DOT Traffic Division
5650 Enterprise Parkway
Fort Myers, FL 33905

Re: FPID: 200966-1-52-01; SR: 93 (I-75)
County: Lee
Description: SR-93 (I-75) @ Alico Road
Subject: Lighting Plans and Agreement

Dear Mr. Epps:

As we have discussed, please find the lighting plans and agreement for the above referenced subject project.

The Department of Transportation has determined that highway lighting has been justified for the above referenced project. The Department is committed to arrange for the installation of the lighting, at no cost to the County, should your agency agree to execute a Roadway Lighting System Maintenance Agreement for Highway Lighting. The County currently maintains an existing decorative lighting system within the project limits. The Department intent is to replace the existing lighting system with a new system meeting today's current standards. The County will only be responsible for the lights not within limited access right of way. The cost of this new system will be at the Departments expense.

Historically, local agencies have accepted the responsibility to maintain and pay the monthly bill as the majority of the users are local to the area and lighting has proven to reduce accidents and crime occurrences. The County costs for maintenance and power service is outweighed by these benefits provided to the users.

Some agencies have budget categories established for this type of expenditure already. If the County does not, then two suggestions are offered. One is to establish a countywide tax levy and the other is a strip-taxing district, usually defined as the adjacent property owners.

I-75 @ Alico Road
October 13, 2003
Page 2

Should you accept to maintain the Department's lighting system, timing is important to the Department so that we can continue to utilize our prime consultant's contract option to complete the design of the lighting system.

If the Lee County accepts the Department's design for the lighting system, the County will have sole responsibility of maintaining this system and is required to sign the Department's Roadway Lighting System Maintenance Agreement.

I have attached four Roadway Lighting System Maintenance Agreements for your review and execution. Please complete all agreements and Resolutions and return to my office no later than **November 14, 2003**.

Your cooperation in completing the above request by the required return date is greatly appreciated. If you are in need of additional information or assistance in completing your Utility Work Schedules, please contact me at (727) 431-1683.

Sincerely,
TBE Group, Inc.

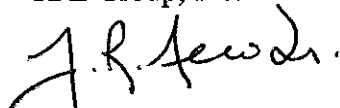

Joseph R. Nero, Sr.
Senior Utility Coordinator

cc: Abe Neemeh, PBQ&D, EOR
Jerrold Whitt, FDOT/D-1, District Utilities
Nicloe Mills, FDPT-Project Manager.
William Allison, FDOT D-1 / Construction

Attachments: Roadway Lighting System Maintenance Agreement
Resolution & Appendix

ROADWAY LIGHTING SYSTEM MAINTENANCE AGREEMENT

Financial Project ID:	200966-1-52-01	Federal Project ID:	N/A
Work Program Item No. (old):	N/A	County/Section No:	Lee/ 12075
State Job No. (old):	N/A	District Document No:	3

THIS AGREEMENT, made and entered into this _____ day of _____, year of _____, by and between the **STATE OF FLORIDA DEPARTMENT OF TRANSPORTATION**, hereinafter referred to as the "**FDOT**", and Lee County DOT Traffic Division, hereinafter referred to as the "**MAINTAINING AGENCY**";

WITNESSETH

WHEREAS, there exists or is about to be installed on the state highway system a lighting system more particularly described in Exhibit A attached hereto, and by this reference made a part hereof, hereinafter referred to as the "Roadway Lighting System"; and;

WHEREAS, the **FDOT** and the **MAINTAINING AGENCY** desire to enter into an agreement pursuant to the provisions of Rule Chapter 14-46 of the Florida Administrative Code providing for the maintenance of the Roadway Lighting System;

NOW, THEREFORE, in consideration of the premises and the mutual covenants contained herein, the **FDOT** and the **MAINTAINING AGENCY** hereby agree as follows:

1. Maintenance of the Roadway Lighting System

- a. The **MAINTAINING AGENCY** shall, at its sole cost and expense, maintain the roadway Lighting System throughout its expected useful life.
- b. In maintaining the Roadway Lighting System, the **MAINTAINING AGENCY** shall perform all activities necessary to keep the Roadway Lighting System fully and properly functioning at all times for its normal expected useful life in accordance with the original design thereof, whether necessitated by normal wear and tear, accidental or intentional damage, or acts of nature. Said maintenance shall include, but shall not be limited to, routine inspection and testing, preventative maintenance, emergency maintenance, replacement of any component parts of the Roadway Lighting System (including the poles and any and all other component parts installed as part of the Roadway Lighting System), and the locating of facilities as may be necessary.
- c. All maintenance shall be in accordance with the provisions of the following:
 - (1) Roadway and Roadside Maintenance Procedure, Topic No. 850-000-015;
 - (2) Manual of Uniform Traffic Control Devices and Safe Procedures for Streets and Highway Construction; and
 - (3) All other applicable local, state or Federal laws, rules resolution, or ordinances and FDOT procedures.

2. Operating Costs

In addition to the costs of maintaining the Roadway Lighting System, the **MAINTAINING AGENCY** shall be responsible for all costs of operating the Roadway Lighting System, including, but not limited to, all costs of electrical power consumed by the Roadway Lighting System and all other electrical charges.

3. Record Keeping

The **MAINTAINING AGENCY** shall keep records of all activities performed and costs expended pursuant to this Agreement. The records shall be kept in such format as is approved by the **FDOT**. All such records shall be deemed to be public records subject to the provisions of Chapter 119, Florida Statutes.

4. **Default**

In the event that the **MAINTAINING AGENCY** breaches any provision of this Agreement, then in addition to any other remedies which are otherwise provided for in this Agreement, the **FDOT** may exercise one or more of the following options, provided that at no time shall the **FDOT** be entitled to receive double recovery of damages:

- a. Pursue a claim for damages suffered by the **FDOT** or the public.
- b. Suspend the issuance of further permits to the **MAINTAINING AGENCY** for the placement of Facilities on **FDOT** property if the breach is material and has not been cured within 60 days from written notice thereof from **FDOT** until such time as the breach is cured.
- c. Pursue any other remedies legally available.
- d. Perform any work with its own forces or through contractors and seek repayment for the cost thereof from the **MAINTAINING AGENCY**.
- e. Require the **MAINTAINING AGENCY** to remove the Roadway Lighting System at the **MAINTAINING AGENCY's** sole cost and expense.

5. **Indemnification**

FOR GOVERNMENT MAINTAINING AGENCY:

To the extent provided by law, the **MAINTAINING AGENCY** shall indemnify, defend, and hold harmless the **FDOT** and all of its officers, agents, and employees from any claim, loss, damage, cost, charge, or expense arising out of any acts, action, error, neglect, or omission by the **MAINTAINING AGENCY**, its agents, employees, or contractors during the performance of the Agreement, whether direct or indirect, and whether to any person or property to which **FDOT** or said parties may be subject, except that neither the **MAINTAINING AGENCY**, its agents, employees, or contractors will be liable under this section for damages arising out of the injury or damage to persons or property directly caused by or resulting from the negligence of the **FDOT** or any of its officers, agents, or employees during the performance of this Agreement.

When the **FDOT** receives a notice of claim for damages that may have been caused by the **MAINTAINING AGENCY** in the performance of services required under this Agreement, the **FDOT** will immediately forward the claim to the **MAINTAINING AGENCY**. The **MAINTAINING AGENCY** and the **FDOT** will evaluate the claim and report their findings to each other within fourteen (14) working days and will jointly discuss options in defending the claim. After reviewing the claim, the **FDOT** will determine whether to require the participation of the **MAINTAINING AGENCY** in the defense of the claim or to require the **MAINTAINING AGENCY** to defend the **FDOT** in such claim as described in this section. The **FDOT's** failure to notify the **MAINTAINING AGENCY** of a claim shall not release the **MAINTAINING AGENCY** from any of the requirements of this section. The **FDOT** and the **MAINTAINING AGENCY** will pay their own costs for the evaluation, settlement negotiations, and trial, if any. However, if only one party participates in the defense of the claim at trial, that party is responsible for all costs.

FOR NON-GOVERNMENT MAINTAINING AGENCY:

The **MAINTAINING AGENCY** shall indemnify, defend, and hold harmless the **FDOT** and all of its officers, agents, and employees from any claim, loss, damage, cost, charge, or expense arising out of any acts, action, error, neglect, or omission by the **MAINTAINING AGENCY**, its agents, employees, or contractors during the performance of the Agreement, whether direct or indirect, and whether to any person or property to which **FDOT** or said parties may be subject, except that neither the **MAINTAINING AGENCY**, its agents, employees, or contractors will be liable under this section for damages arising out of the injury or damage to persons or property directly caused by or resulting from the negligence of the **FDOT** or any of its officers, agents, or employees during the performance of this Agreement.

The **MAINTAINING AGENCY's** obligation to indemnify, defend, and pay for the defense or at the **FDOT's** option, to participate and associate with the **FDOT** in the defense and trial of any damage claim or suit and any related settlement negotiations, shall arise within fourteen (14) days of receipt by the **MAINTAINING AGENCY** of the **FDOT's** notice of claim for indemnification to the **MAINTAINING AGENCY**. The notice of claim for indemnification shall be served by certified mail. The **MAINTAINING AGENCY's** obligation to defend and indemnify within fourteen (14) days of such notice shall not be excused because of the **MAINTAINING AGENCY's** inability to evaluate liability or because the **MAINTAINING AGENCY** evaluates liability and determines the **MAINTAINING AGENCY** is not liable or determines the **FDOT** is solely negligent. Only a final adjudication or judgment finding the **FDOT** solely negligent shall excuse performance of this provision by the **MAINTAINING AGENCY**. The **MAINTAINING AGENCY** shall pay all costs and fees related to this obligation and its enforcement by the **FDOT**. The **FDOT's** delay in notifying the **MAINTAINING AGENCY** of a claim shall not release the **MAINTAINING AGENCY** of the above duty to defend.

6. **Force Majeure**

Neither the **MAINTAINING AGENCY** nor the **FDOT** shall be liable to the other for any failure to perform under this Agreement to the extent such performance is prevented by an act of God, war, riots, natural catastrophe, or other event beyond the control of the non-performing party and which could not have been avoided or overcome by the exercise of due diligence; provided that the party claiming the excuse from performance has (a) promptly notified the other party of the occurrence and its estimate duration, (b) promptly remedied or mitigated the effect of the occurrence to the extent possible, and (c) resumed performance as soon as possible.

7. **Miscellaneous**

- a. This Agreement constitutes the complete and final expression of the parties with respect to the subject matter hereof and supersedes all prior agreements, understandings, or negotiations with respect thereto, except that the parties understand and agree that the **FDOT** has manuals and written policies and procedures which shall be applicable at the time of the Project and the relocation of the Facilities and except that the **MAINTAINING AGENCY** and the **FDOT** may have entered into joint agreements for Utility Work to be performed by **FDOT's** highway contractor. To the extent that such a joint agreement exists, this Agreement shall not apply to Facilities covered by the joint agreement. Copies of **FDOT** manuals, policies, and procedures will be provided to the **MAINTAINING AGENCY** upon request.
- b. This Agreement shall be governed by the laws of the State of Florida. Any provision hereof found to be unlawful or unenforceable shall be severable and shall not affect the validity of the remaining provisions hereof.
- c. Time is of the essence in the performance of all obligations under this Agreement.
- d. All notices required pursuant to the terms hereof may be sent by first class United States Mail, facsimile transmission, hand delivery, or express mail and shall be deemed to have been received by the end of five business days from the proper sending thereof unless proof of prior actual receipt is provided. The **MAINTAINING AGENCY** shall have a continuing obligation to notify each District of the **FDOT** of the appropriate persons for notices to be sent pursuant to this Agreement. Unless otherwise notified in writing, notices shall be sent to the following addresses:

If to the **MAINTAINING AGENCY**:

If to the **FDOT**:

FDOT District Maintenance Engineer
801 N. Broadway Ave.
Bartow, FL 33830

- e. **PUBLIC ENTITY CRIME INFORMATION STATEMENT:** A person or affiliate who has been placed on the convicted vendor list following a conviction for a public entity crime may not submit a bid on a contract to provide any goods or services to a public entity, may not submit a bid on a contract with a public entity for the construction or repair of a public building or public work, may not submit bids on leases of real property to a public entity, may not be awarded or perform work as a contractor, supplier, subcontractor, or consultant under a contract with any public entity, and may not transact business with any public entity in excess of the threshold amount provided in Section 287.017, Florida Statutes, for **CATEGORY TWO** for a period of 36 months from the date of being placed on the convicted vendor list.
- f. An entity or affiliate who has been placed on the discriminatory vendor list may not submit a bid on a contract to provide any goods or services to a public entity, may not submit a bid on a contract with a public entity for the construction or repair of a public building or public work, may not submit bids on leases of real property to a public entity, may not be awarded or perform work as a contractor, supplier, subcontractor, or consultant under a contract with any public entity, and may not transact business with any public entity.

8. Certification

This document is a printout of an **FDOT** form maintained in an electronic format and all revisions thereto by the **MAINTAINING AGENCY** in the form of additions, deletions, or substitutions are reflected only in an Appendix entitled "Changes To Form Document" and no change is made in the text of the document itself. Hand notations on affected portions of this document may refer to changes reflected in the above-named Appendix but are for reference purposes only and do not change the terms of the document. By signing this document, the **MAINTAINING AGENCY** hereby represents that no change has been made to the text of this document except through the terms of the Appendix entitled "Changes To Form Document."

You **MUST** signify by selecting or checking which of the following applies:

- No changes have been made to this Forms Document and no Appendix entitled "Changes To Form Document" is attached.
- No changes have been made to this Form Document, but changes are included on the attached Appendix entitled "Changes to Forms Document."

IN WITNESS WHEREOF, the parties hereto have executed this Agreement effective the day and year first written.

MAINTAINING AGENCY

BY: (Signature) _____ DATE: _____
(Typed Name: _____)

Recommend Approval by the District Utility Office

BY: (Signature) _____ DATE: _____
(Typed Name: Walter L. Childs / District Utility Administrator)

FDOT Legal Review

BY: (Signature) _____ DATE: _____
District Counsel

**STATE OF FLORIDA
DEPARTMENT OF TRANSPORTATION**

BY: (Signature) _____ DATE: _____
(Typed Name: _____)
(Typed Title: _____)

FEDERAL HIGHWAY ADMINISTRATION (if applicable)

BY: (Signature) _____ DATE: _____
(Typed Name: _____)

STATE OF FLORIDA DEPARTMENT OF TRANSPORTATION
ROADWAY LIGHTING SYSTEM MAINTENANCE AGREEMENT

APPENDIX: "CHANGES TO FORM DOCUMENT"

The following changes are hereby made to the Roadway Lighting System Maintenance Agreement between the **State of Florida Department of Transportation** (the "FDOT") and Lee County DOT Traffic Division (the "UAO") dated the _____ day of _____, 200____, for the project identified as SR 93 (I-75) & Alico Road _____:

1. At such time as Rule Chapter 14-64 of the Florida Administrative Code is amended to deal with the issue of the **FDOT** paying for the cost of maintenance of roadway lighting systems beyond what the rule currently authorizes, this Agreement will be modified to conform to the new rule.
2. In the event that any portion of the lighting system to be maintained under this Agreement subsequently falls within an area which is annexed into another local government's jurisdiction, the **MAINTAINING AGENCY** will be released from liability for maintaining that portion of the system under this Agreement upon the **MAINTAINING AGENCY** providing to the **FDOT** a substitute Roadway Lighting System Maintenance Agreement which has been properly approved and executed by the local government having jurisdiction over that portion of the system.
3. This Agreement covers the unincorporated area of Lee County from Three Oaks Parkway to Ben Hill Griffin Road.

RESOLUTION
UTILITY AGREEMENT

FPN#				COUNTY	STATE ROAD	DOC #	FAP #
200966	1	52	01	Lee	93 (I-75) @ Alico Rd	3	N/A

WHEREAS, the **State of Florida Department of Transportation**, hereinafter referred to as the **FDOT**, proposes to construct or reconstruct a transportation facility identified above, hereinafter referred to as the **Project**; and

WHEREAS, in order for the **FDOT** to proceed with the Project, it is necessary for Lee County DOT Traffic Division, hereinafter referred to as the **UAO**, to execute and deliver to the **FDOT** the agreement identified as Roadway Lighting System Maintenance Agreement, hereinafter referred to as the **Agreement**;

NOW, THEREFORE, BE IT RESOLVED BY THE UAO:

That **(Name)** _____, **(Title)** _____ be hereby authorized and directed to execute and deliver the Agreement to the FDOT.

A certified copy of this Resolution be forwarded to the **FDOT** along with the executed Agreement.

ON MOTION of _____, seconded by _____, the above resolution was introduced and passed by the UAO on the ____ day of _____, 200__.

NAME: _____

Title: _____

ATTEST: _____

Title: _____

STATE OF FLORIDA
DEPARTMENT OF TRANSPORTATION

CONTRACT PLANS

FINANCIAL PROJECT ID 200966-1-52-01
(FEDERAL FUNDS)
LEE COUNTY (12075)
STATE ROAD NO. 93 (I-75) AT ALICO ROAD

LIGHTING PLANS

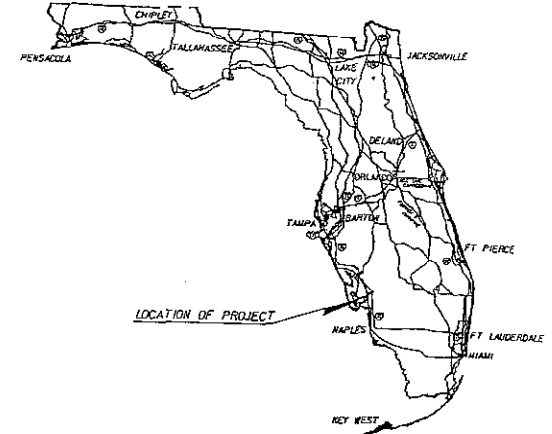

INDEX OF LIGHTING PLANS

SHEET NO.	SHEET DESCRIPTION
L-1	KEY SHEET
L-2 THRU L-3	TABULATION OF QUANTITIES
L-4	GENERAL NOTES
L-5 THRU L-6	POLE DATA & LEGEND SHEET
L-7 THRU L-24	LIGHTING PLAN SHEETS
L-25	HIGH MAST POLE FOUNDATION
L-26 THRU L-29	REPORT OF CORE BORINGS

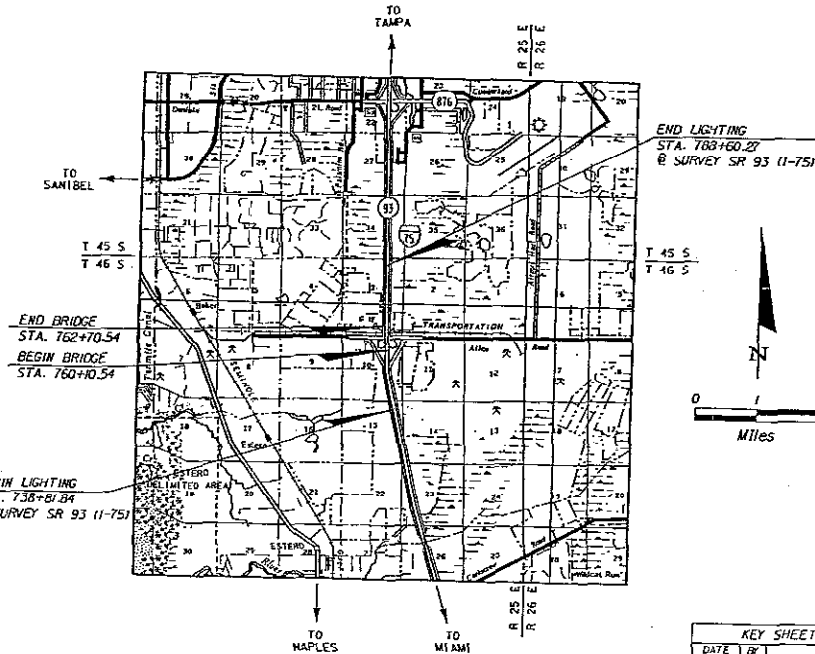

END LIGHTING
STA. 783+60.27
@ SURVEY SR 93 (I-75)

END BRIDGE
STA. 762+70.54
BEGIN BRIDGE
STA. 760+10.54

BEGIN LIGHTING
STA. 738+01.84
@ SURVEY SR 93 (I-75)

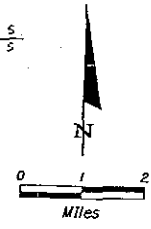

LIGHTING SHOP DRAWINGS
TO BE SUBMITTED TO:
DEBRA KENNAUGH, P.E.
5405 W. CYPRESS ST., SUITE 300
TAMPA, FL. 33607
10:31 289-5300

PLANS PREPARED BY:



PARSONS, BRINCKERHOFF, QUADE & DOUGLAS, INC.
5405 W. CYPRESS ST., SUITE 300
TAMPA, FL. 33607
10:31 289-5300
VENDOR NUMBER: 11531569
CONTRACT NUMBER: C7816

NOTE:
THE SCALE OF THESE PLANS MAY
HAVE CHANGED DUE TO REPRODUCTION.

20-02

GOVERNING STANDARDS AND SPECIFICATIONS:
FLORIDA DEPARTMENT OF TRANSPORTATION,
DESIGN STANDARDS,
DATED JANUARY 2004, AND
STANDARD SPECIFICATIONS FOR ROAD AND BRIDGE
CONSTRUCTION DATED 2000,
AS AMENDED BY CONTRACT DOCUMENTS.

KEY SHEET REVISIONS	
DATE	DESCRIPTION

LIGHTING PLANS
ENGINEER OF RECORD: DEBRA KENNAUGH

P.E. NO.: 55325

FISCAL YEAR	SHEET NO.
05	L-1

FDOT PROJECT MANAGER: NICOLE MILLS, P.E.

TABULATION OF QUANTITIES

PAY ITEM NO.	DESCRIPTION	UNIT	L-7		L-8		L-9		L-10		L-11		L-12		L-13		L-14		L-15		L-16		
			PLAN	FINAL	PLAN	FINAL	PLAN	FINAL	PLAN	FINAL	PLAN	FINAL	PLAN	FINAL	PLAN	FINAL	PLAN	FINAL	PLAN	FINAL	PLAN	FINAL	PLAN
400-1-15	CLASS 1 CONCRETE (MISC.)	CF	11.6		5.5		6.7		12.9		0.9		6.2		6.2		5.8		1.8		7.0		62.6
555-1-2	DIRECTIONAL BORE (6" TO < 12")	LF	70		35		85		35				35								70		430
715-1-113	CONDUCTOR, INSULATED NO. 6 (FR)	LF																			3740		4820
715-1-115	CONDUCTOR, INSULATED NO. 2 (FR)	LF																			2100		19190
715-1-119	CONDUCTOR, INSULATED NO. 1/0 (FR)	LF	2400		8045		18,770		4650		8950		4560		8950						4350		45025
715-2-115	CONDUIT, SIZE 2", SCH. 40, UNDERGROUND (FR)	LF	1920		550		1635		1550		2720		1910		1945						360		19,080
715-7-11	LOAD CENTER (FR) (SECONDARY VOLTAGE)	EA																			1		1
715-14-11	PULL BOX (FR) (ROADSIDE)	EA	14		5		9		11		2		8		8		7		3		11		84
715-191-120	HIGH MAST LIGHTING POLE COMP (FR) (120' WH)	EA	4		1		2		4		2		2		2		2				11		11
715-195-120	HIGH MAST LIGHTING POLE COMP (REMOVED) (20' WH)	EA	1		3		1		1		1		1		1						5		5
715-500-1	POLE (CABLE DISTRIBUTION SYSTEM (CONVENTIONAL))	EA	4		1		2		4		2		2		2		2		2		11		11
715-500-2	POLE (CABLE DISTRIBUTION SYSTEM (HIGH MAST))	EA	4		1		2		4		2		2		2		2		2		11		11
715-61-20X	LIGHT POLE COMP (AL STAY) (FR) (40' WH) (10' ARM)	EA																			8		8
715-61-40X	LIGHT POLE COMP (AL STAY) (FR) (50' WH) (10' ARM)	EA																			2		2

DATE	BR	DESCRIPTION	DATE	BR	DESCRIPTION	DATE	BR	DESCRIPTION	DATE	BR	DESCRIPTION
REVISIONS											

PERSONS BLACKBURN	100 YEARS	EMERGING BUSINESS	MEMBER COMPANY	3405 WEST BAYVIEW ST. SUITE 200 MIAMI, FL 33134 (305) 551-1100
DB				
Dodge & Cougle, Inc.				
STATE OF FLORIDA DEPARTMENT OF TRANSPORTATION				
ROAD NO.		COUNTY		FISCAL YEAR PROJECT NO.
SR 93		LEE		200966-1-52-01

SHEET NO. L-2

TABULATION OF QUANTITIES

TABULATION OF QUANTITIES

PAY ITEM NO.	DESCRIPTION	UNIT	SHEET NUMBERS																								TOTAL THIS SHEET	GRAND TOTAL	REF. SHEET					
			L-17		L-18		L-19		L-20		L-21		L-22		L-23		L-24																	
			PLAN	FINAL	PLAN	FINAL	PLAN	FINAL	PLAN	FINAL	PLAN	FINAL	PLAN	FINAL	PLAN	FINAL	PLAN	FINAL	PLAN	FINAL														
400-1-15	CLASS 1 CONCRETE (MISC.)	CU	6.3	2.2	6.7	7.8	7.9	7.9	7.9	7.9	7.5	9.7	1.4	1.4	49.5	12.1																		
555-1-2	DIRECTIONAL BORE (6" TO 12")	LF	145		180	170									320	1175																		
715-1-13	CONDUCTOR, INSULATED NO. 6 (F&H)	LF	755			2850									4200	25,745																		
715-1-15	CONDUCTOR, INSULATED NO. 2 (F&H)	LF	2765		525	575										12,680	31,870																	
715-1-19	CONDUCTOR, INSULATED NO. 1/0 (F&H)	LF	2915		1825	3500										7940	52,965																	
715-2-15	CONDUIT, SIZE 2", SCH. 40, UNDERGROUND (F&H)	LF	2075		175	3085										1400	11,245																	
715-7-11	LOAD CENTER (F&H) (SECONDARY VOLTAGE)	EA				1											1																	
715-14-1	PULL BOX (F&H) (PROSIDERE)	EA	10	2	9	13										16	75																	
715-18-120	HIGH MAST LIGHTING POLE COMP (F&H) (220' MH)	EA	1		2												4																	
715-185-120	HIGH MAST LIGHTING POLE COMP (REMOVED) (220' MH)	EA																																
715-500-1	POLE CABLE DISTRIBUTION SYSTEM CONVENTIONAL	EA	2			8										42	52																	
715-500-2	POLE CABLE DISTRIBUTION SYSTEM (HIGH MAST)	EA	1		2											4	21																	
715-64-20	LIGHT POLE COMP (AL STAIN) (F&H) (40' MH) (60' ARM)	EA	2			8										40	40																	
715-63-40	LIGHT POLE COMP (AL STAIN) (F&H) (50' MH) (15' ARM)	EA	2													2	12																	

		STATE OF FLORIDA DEPARTMENT OF TRANSPORTATION		FINANCIAL PROJECT ID 200966-1-52-01
Parsons Brinckerhoff Davis & Douglas, Inc. 5400 Chrysalis Lane Jacksonville, FL 32217 SPECIALTY BUSINESS FINANCIAL SERVICES		ROAD NO. SR 93	COUNTY LEE	SHEET NO. L-3
TABULATION OF QUANTITIES				

DATE	BY	DESCRIPTION	REVISIONS	
			DATE	BY

GENERAL NOTES

1. SEE FDOT STANDARD INDEX 17501 FOR ADDITIONAL NOTES.
2. PRIOR TO ANY EQUIPMENT ORDER, THE CONTRACTOR SHALL SUBMIT FOR APPROVAL EQUIPMENT SPECIFICATION OR DESIGN DATA FOR ALL MATERIAL PROPOSED FOR THE PROJECT. THESE MUST SPECIFICALLY INCLUDE:
 - A) LUMINAIRES AND CORRESPONDING PHOTOMETRICS
 - B) LOAD CENTER ELECTRICAL EQUIPMENT
3. UTILITY OWNERS: (INFORMATION PROVIDED FOR CONTRACTOR CONVENIENCE ONLY).
- ✓ 4. THE LOCATIONS OF ALL EXISTING UTILITIES, AS SHOWN ON THESE PLANS, ARE APPROXIMATE AND BASED ON THE INFORMATION FURNISHED TO THE ENGINEER BY THE UTILITY OWNER(S) AND ARE SHOWN AS NOTICE TO THE CONTRACTOR THAT UNDERGROUND UTILITIES EXIST. THE CONTRACTOR SHALL NOTIFY THE UTILITY COMPANY OWNER(S) FOR LOCATIONS AND SLAKING OF UNDERGROUND FACILITIES BEFORE EXCAVATING.
- ✓ 5. FLORIDA STATUTE 553.851 (1993) REQUIRES THAT BEFORE EXCAVATING, NOTICE BE GIVEN TO THE UTILITY OWNER A MINIMUM OF TWO (2) DAYS AND A MAXIMUM OF FIVE (5) DAYS, EXCLUDING SATURDAY, SUNDAY AND LEGAL HOLIDAYS. NOT ALL UTILITY COMPANIES ARE MEMBERS OF "SUNSHINE" 1-800-432-4770.
- ✓ 6. THE LOCATION OF THE POLES, CONDUCTORS, CONDUITS, JUNCTION BOXES AND SERVICE POLES ARE DIAGRAMMATIC ONLY. IF CONFLICT ARISES WITH EXISTING UTILITY LOCATIONS, THESE ITEMS MAY BE SHIFTED WITH PRIOR APPROVAL BY THE ENGINEER.
7. SUBMITTAL DATA SHALL INCLUDE COMPUTER PRINTOUT SHOWING HORIZONTAL FOOTCANDLE LEVELS TO BE OBTAINED USING THE SUBMITTED LUMINAIRES ON THIS PROJECT. AT FINAL INSPECTION THE CONTRACTOR SHALL VERIFY THE HORIZONTAL FOOTCANDLE LEVELS ON THE ROADWAY WITH AN APPROVED CURRENTLY CALIBRATED LIGHT METER.
8. ALL ELECTRICAL WORK SHALL MEET ALL REQUIREMENTS OF THE LATEST EDITIONS OF THE NATIONAL ELECTRICAL CODE, THE NATIONAL ELECTRICAL SAFETY CODE AND THE STATE OF FLORIDA D.O.T. STANDARD SPECIFICATIONS FOR ROAD AND BRIDGE CONSTRUCTION. ALL COMPONENTS SHALL BE PROPERLY GROUNDED AND BONDED PER N.E.C. REQUIREMENTS.
9. INSTALL LIGHTNING ARRESTORS, PROPERLY GROUNDED, IN POWER (SECONDARY) ENTRANCES.
10. IN ACCORDANCE WITH N.E.C. IDENTIFY ALL CIRCUITS AND EQUIPMENT WITH "LAMACOID TAGS". INSTALL SIMILAR TAGS OF STAINLESS STEEL IDENTIFYING CIRCUIT FOR EACH LUMINAIRE AT ACCESS HANDHOLE FOR EACH POLE.
- ✓ 11. THE CONTRACTOR SHALL NOTIFY FP&L AT LEAST 48 HOURS PRIOR TO ANY INSTALLATION WITHIN TEN FEET OF ENERGIZED ELECTRICAL CIRCUITS. THE UTILITY OWNER, AT IT'S OPTION, MAY ASSIST THE CONTRACTOR. COVER UP ENERGIZED CIRCUITS AT INSTALLATION SITE. OR TAKE OTHER SAFETY PRECAUTIONS AS NECESSARY. EXTREME CAUTION SHALL BE EXERCISED AT ALL TIMES IN PERFORMANCE OF WORK AROUND PRIMARY HIGH VOLTAGE COMPONENTS.
12. PULLING INSTRUCTIONS: CONNECT PULLING DEVICES TO COPPER WIRE AND NOT TO JACKET AND MEET MANUFACTURER'S REQUIREMENTS. USE PULLING COMPOUND PER MANUFACTURER'S REQUIREMENTS. ALL BENDS SHALL NOT BE LESS THAN * RECOMMENDED BY N.E.C. OR N.E.S.C. FOR CABLE USED.
- ✓ 13. CONTRACTOR SHALL TAKE ALL POLE LOCATIONS AND REQUEST UTILITY COMPANIES TO LOCATE AND STAKE UNDERGROUND UTILITIES PRIOR TO EXCAVATING.
14. FURNISH AND INSTALL AN ALUMINUM IDENTIFICATION ON EACH ROADWAY LIGHTING STANDARD. TAGS SHALL BE 1'-6" WIDE IN SIZE WITH BLACK LETTERS AND YELLOW BACKGROUND, ATTACHED WITH RIVETS (NO SCREWS). NUMBERS SHALL BE AS SHOWN ON THE POLE DATA SHEET. SEE POLE IDENTIFICATION TAG DETAIL ON THIS SHEET.
15. THE LIGHT POLE CONCRETE FOUNDATION SHALL BE IN ACCORDANCE WITH F.D.O.T. STANDARD INDEX 17503. THE EXISTING NEAR SURFACE SANDY SOILS HAVE THE FOLLOWING DESIGN PARAMETERS: MOIST UNIT WEIGHT - 115 PCD, ANGLE OF INTERNAL FRICTION: (PHI)-32 DEGREES, COHESION (C)-0 PSF.
16. PROVIDE CONCRETE SLAB IN ACCORDANCE WITH FDOT STANDARD INDEX 17500 & 17502.
17. LIGHT POLES LOCATED ON SLOPES GREATER THAN 1:1, BUT NOT GREATER THAN 2:1 WILL REQUIRE THE FOLLOWING FOUNDATION DEPTHS FOR A 4" DIAMETER DRILLED SHAFT:
 - 2:1 SLOPE WITH AN EMBANKMENT HEIGHT UP TO 10' - SHAFT DEPTH EQUALS 13'.
 - 2:1 SLOPE WITH EMBANKMENT HEIGHT FROM 10' TO 20' - SHAFT DEPTH EQUALS 19'.
 - 3:1 SLOPE WITH AN EMBANKMENT HEIGHT UP TO 10' - SHAFT DEPTH EQUALS 13'.
 - 3:1 SLOPE WITH AN EMBANKMENT HEIGHT FROM 10' TO 20' - SHAFT DEPTH EQUALS 19'.
 THIS APPLIES TO LIGHT POLE FOUNDATIONS WITH A MOUNTING HEIGHT LESS THAN 49 FEET ABOVE SURROUNDING TERRAIN.
18. IF THE MOUNTING HEIGHT AT A LIGHT POLE LOCATION IS GREATER THAN 49 FEET ABOVE SURROUNDING TERRAIN, THE CONTRACTOR (AND/OR SPECIALTY ENGINEER) MUST CONSIDER THE MOUNTING HEIGHT OF THE POLES RELATIVE TO THE SURROUNDING TERRAIN WHEN DESIGNING THE LIGHT POLE FOUNDATION.
19. ALL ELECTRICAL CONNECTIONS SHALL BE MADE ABOVE MEAN HIGH WATER.

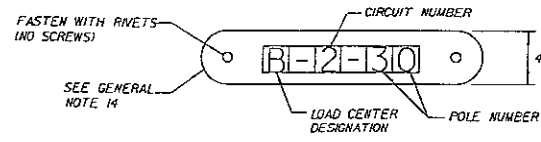

POLE IDENTIFICATION TAG DETAIL

REVISIONS							STATE OF FLORIDA DEPARTMENT OF TRANSPORTATION			GENERAL NOTES	SHEET NO. L-4
DATE	BY	DESCRIPTION	DATE	BY	DESCRIPTION		ROAD NO.	COUNTY	FINANCIAL PROJECT ID		
						SR 93	LEE	200966-1-52-01			

POLE SETBACK AND NOTES LEGEND

CONVENTIONAL LIGHTING DESIGN CRITERIA
 Average Initial Intensity 1.5 Foot - Candelas
 Uniformity Ratio to Avg./Min. 4:1 Or Less
 Wind Speed Max./Min. 10:1 Or Less
 100 MPH

* A SPECIAL CONCRETE FOUNDATION IS REQUIRED FOR SHOULDER MOUNTED POLES ON SLOPES STEEPER THAN 4:1. THE LENGTH OF THE STANDARD FOUNDATION SHALL BE INCREASED TO 12 FEET.

HIGH MAST POLE DATA

POLE NO.	CIRCUIT	STATION	ARM	LUMINAIRE WATTAGE	M.H.	POLE SETBACK AND NOTES	FINAL
1	A-5	247+50 E ALICD	N/A	4-4000	120'	155' LT	
2	A-3	357+60 E RAMP SW	N/A	4-4000	120'	125' RT	
3	B-9	756+90 E SR 93 (1-75)	N/A	4-4000	120'	215' RT	
4	B-0	138+37 E RAMP NE	N/A	4-4000	120'	77' RT	
5	B-0	154+00 E RAMP NE	N/A	4-4000	120'	130' LT	
6	A-5	242+50 E ALICD	N/A	4-4000	120'	80' LT	
7	A-5	242+50 E ALICD	N/A	4-4000	120'	130' LT	
8	A-7	541+40 E RAMP ES	N/A	4-4000	120'	45' LT	
9	A-3	779+15 E SR 93 (1-75)	N/A	4-4000	120'	125' LT	
10	A-7	755+00 E SR 93 (1-75)	N/A	4-4000	120'	164' LT	
11	B-9	146+68 E RAMP NE	N/A	4-4000	120'	110' LT	
12	A-6	748+50 E SR 93 (1-75)	N/A	4-4000	120'	210' LT	
13	B-5	253+00 E ALICD RD.	N/A	4-4000	120'	184' LT	
14	B-8	160+40 E RAMP NE	N/A	4-4000	120'	90' LT	
15	B-6	768+40 E SR 93 (1-75)	N/A	4-4000	120'	184' RT	
16	B-7	775+50 E SR 93 (1-75)	N/A	4-4000	120'	200' RT	
17	A-4	773+50 E SR 93 (1-75)	N/A	4-4000	120'	130' LT	
18	B-6	782+20 E SR 93 (1-75)	N/A	4-4000	120'	133' RT	
19	B-5	658+22 E RAMP WN	N/A	4-4000	120'	80' RT	
20	B-7	768+00 E SR 93 (1-75)	N/A	4-4000	120'	162' RT	
20A	A-4	790+10 E SR 93 (1-75)	N/A	4-4000	120'	125' LT	

CONVENTIONAL POLE DATA

POLE NO.	CIRCUIT	STATION	ARM	LUMINAIRE WATTAGE	M.H.	POLE SETBACK AND NOTES	FINAL
21	A-2	230+20 E ALICD RD.	5'	400	50'		
22	A-1	230+20 E ALICD RD.	5'	400	50'		
23	A-2	232+40 E ALICD RD.	5'	400	50'		
24	A-1	232+40 E ALICD RD.	5'	400	50'		
25	A-2	234+60 E ALICD RD.	5'	400	50'		
26	A-1	234+60 E ALICD RD.	5'	400	50'		
27	A-2	236+60 E ALICD RD.	5'	400	50'		
28	A-1	236+60 E ALICD RD.	5'	400	50'		
29	A-2	238+60 E ALICD RD.	5'	400	50'		
30	A-1	238+60 E ALICD RD.	5'	400	50'		
31	A-2	240+60 E ALICD RD.	5'	400	50'		
32	A-1	240+60 E ALICD RD.	5'	400	50'		

DECORATIVE POLE DATA

POLE NO.	CIRCUIT	STATION	ARM	LUMINAIRE WATTAGE	M.H.	POLE SETBACK AND NOTES	FINAL
33	B-3	261+10 E ALICD RD.	0'	400	40'		
34	B-1	261+10 E ALICD RD.	0'	400	40'		
35	B-3	264+30 E ALICD RD.	0'	400	40'		
36	B-1	264+30 E ALICD RD.	0'	400	40'		
37	B-3	265+50 E ALICD RD.	0'	400	40'		
38	B-1	265+50 E ALICD RD.	0'	400	40'		
39	B-3	266+70 E ALICD RD.	0'	400	40'		
40	B-1	266+70 E ALICD RD.	0'	400	40'		
41	B-3	267+90 E ALICD RD.	0'	400	40'		
42	B-1	267+90 E ALICD RD.	0'	400	40'		
43	B-3	269+10 E ALICD RD.	0'	400	40'		
44	B-1	269+10 E ALICD RD.	0'	400	40'		
45	B-3	270+30 E ALICD RD.	0'	400	40'		
46	B-1	270+30 E ALICD RD.	0'	400	40'		
47	B-3	271+70 E ALICD RD.	0'	400	40'		
48	B-1	271+70 E ALICD RD.	0'	400	40'		
49	B-3	273+20 E ALICD RD.	0'	400	40'		
50	B-1	273+20 E ALICD RD.	0'	400	40'		
51	B-3	274+70 E ALICD RD.	0'	400	40'		
52	B-1	274+70 E ALICD RD.	0'	400	40'		
53	B-3	276+20 E ALICD RD.	0'	400	40'		
54	B-1	276+20 E ALICD RD.	0'	400	40'		
55	B-3	277+70 E ALICD RD.	0'	400	40'		
56	B-1	277+70 E ALICD RD.	0'	400	40'		
57	B-3	279+10 E ALICD RD.	0'	400	40'		
58	B-1	279+10 E ALICD RD.	0'	400	40'		
59	B-3	280+40 E ALICD RD.	0'	400	40'		
60	B-1	280+40 E ALICD RD.	0'	400	40'		
61	B-3	281+70 E ALICD RD.	0'	400	40'		
62	B-1	281+70 E ALICD RD.	0'	400	40'		
63	B-3	283+00 E ALICD RD.	0'	400	40'		
64	B-1	283+00 E ALICD RD.	0'	400	40'		
65	B-3	284+30 E ALICD RD.	0'	400	40'		
66	B-1	284+30 E ALICD RD.	0'	400	40'		
67	B-3	286+20 E ALICD RD.	0'	400	40'		
68	B-1	286+20 E ALICD RD.	0'	400	40'		
69	B-3	287+60 E ALICD RD.	0'	400	40'		
70	B-1	287+60 E ALICD RD.	0'	400	40'		
71	B-3	289+40 E ALICD RD.	0'	400	40'		
72	B-1	289+40 E ALICD RD.	0'	400	40'		

DATE: _____ BY: _____

REVISIONS: _____

DESCRIPTION: _____

STATE OF FLORIDA
 DEPARTMENT OF TRANSPORTATION
 COUNTY: LEE
 PROJECT ID: 200965-1-52-01

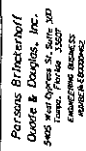

POLE DATA & LEGEND

SHEET NO. L-5

OVERHEAD SIGN LIGHTING DATA

LIGHTED SIGN NO.	CIRCUIT	STATION	LUMINAIRE WATTAGE	NUMBER OF LUMINAIRES *	NOTES	FINAL
01	A-1	231+74.00 & CONST. ALCO ROAD	75	2	BOTTOM MTD	
01	B-3	270+52.00 & CONST. ALCO ROAD	75	2	BOTTOM MTD	
03/03B	A-1	56+82.00 & CONST. RAMP ES	75	2/2	BOTTOM MTD	
08/08B	B-3	853+68.00 & CONST. RAMP WY	75	2/2	BOTTOM MTD	
10	A-3	389+75.00 & CONST. J-75	75	5	3 BOTTOM MTD/2 TOP MTD	
02	A-3	826+50.00 & CONST. J-75	75	5	3 BOTTOM MTD/2 TOP MTD	

* THE NUMBER OF LUMINAIRES INDICATED ON INDEX IT5005 IS SUPERCEDED BY THE NUMBER OF LUMINAIRES INDICATED IN THIS DATA SCHEDULE.

LEGEND



400 WATT HIGH PRESSURE SODIUM LUMINAIRE WITH POWER DOOR DESIGNED FOR MEDIUM CUTOFF TYPE BALLAST WIRE FOR 480 VOLT OPERATION. SINGLE ARM SHOULDER MOUNT, MOUNTING HEIGHT 50 FEET. SHOULDER MOUNT INCLUDES CONCRETE SLAB AND ADJACENT PULL BOX. PAID FOR SEPARATELY. MODULAR PILE CABLE DISTRIBUTION SYSTEM (MCS) TO BE INSTALLED AT ALL PROPOSED LIGHT POLE LOCATIONS, PER STANDARD INDEX IT500.



400 WATT HIGH PRESSURE SODIUM LUMINAIRE WITH POWER DOOR DESIGNED FOR MEDIUM CUTOFF TYPE BALLAST WIRE FOR 480 VOLT OPERATION. SINGLE ARM SHOULDER MOUNT, MOUNTING HEIGHT 50 FEET. SHOULDER MOUNT INCLUDES CONCRETE SLAB AND ADJACENT PULL BOX. PAID FOR SEPARATELY. MODULAR PILE CABLE DISTRIBUTION SYSTEM (MCS) TO BE INSTALLED AT ALL PROPOSED LIGHT POLE LOCATIONS, PER STANDARD INDEX IT500.



400 WATT HIGH PRESSURE SODIUM LUMINAIRE WITH POWER DOOR DESIGNED FOR MEDIUM CUTOFF TYPE BALLAST WIRE FOR 480 VOLT OPERATION. SINGLE ARM SHOULDER MOUNT, MOUNTING HEIGHT 50 FEET. SHOULDER MOUNT INCLUDES CONCRETE SLAB AND ADJACENT PULL BOX. PAID FOR SEPARATELY. MODULAR PILE CABLE DISTRIBUTION SYSTEM (MCS) TO BE INSTALLED AT ALL PROPOSED LIGHT POLE LOCATIONS, PER STANDARD INDEX IT500.



LIGHTED SIGN PROVIDED BY SIGN CONTRACTOR. PROVIDE PULL BOX WITHIN 6 FEET OF SIGN BASE FOR SERVICE TO SIGN.

UNDERGROUND CONDUIT, IEC SIZE - 2" SCHEDULE 40 P.V.C. CONDUIT WITH 2 #6 AWG THW CONDUCTORS INSIDE UNLESS OTHERWISE NOTED AND 1 #6 AWG THW GREEN INSULATED GROUND CONDUCTOR RUN INSIDE CONDUIT UNLESS OTHERWISE NOTED ON PLANS.

EMBEDDED CONDUIT, PAYMENT IS INCIDENTAL TO THE BRIDGE-WALL STRUCTURE. IEC SIZE - 2" SCHEDULE 40 P.V.C. CONDUIT WITH 2 #6 AWG THW CONDUCTORS INSIDE UNLESS OTHERWISE NOTED AND 1 #6 AWG THW GREEN INSULATED GROUND CONDUCTOR RUN INSIDE CONDUIT UNLESS OTHERWISE NOTED ON PLANS.

IEC SIZE - 2 INCH HDPE CONDUIT AT ROADWAY CROSSINGS BY DIRECTIONAL BORE. EXTEND CONDUIT BEYOND EDGE OF PROPOSED PAVEMENT TO PULL BOXES. RUN 2#6 AWG THW AND 1 #6 AWG THW GREEN INSULATED GROUND IN CONDUIT EXCEPT WHERE MARKED "SPACE UNLESS NOTED ON THE PLANS."

LOAD CENTER FOR DISTRIBUTION POINT. SEE FOOT INDEX IT504 OF DESIGN STANDARDS BOOKLET DATED JANUARY 2002L. 480 VOLT, 2 WIRE.

CONCRETE PULL BOX. SEE FOOT INDEX IT503 OF DESIGN STANDARDS BOOKLET DATED JANUARY 2002L. PULL BOXES ARE REQUIRED AT BOTH ENDS OF CONDUIT AT ROADWAY CROSSINGS, AT ALL NEW LIGHT POLES, AND AS NECESSARY FOR COMPLETION OF THE PROJECT. SYMBOL INCLUDES CONCRETE SLAB TO BE PAID FOR SEPARATELY.

STA. 15+00
POLE NO. 1 EXT. A-1

EXISTING LIGHT POLE COMPLETE TO REMAIN.

EXISTING LIGHT POLE COMPLETE TO BE REMOVED.

EXISTING LOAD CENTER FOR DISTRIBUTION POINT TO BE REMOVED.

EXISTING HIGH MAST LIGHT POLE TO BE REMOVED.

REVISIONS	
DATE	DESCRIPTION

Persons Brinkerhoff
Gard & Douglas, Inc.
540 West Orange St., Suite 300
Buckeye, AZ 85206-5555
PH: 602.933.0000

STATE OF FLORIDA	FINANCIAL PROJECT ID
DEPARTMENT OF TRANSPORTATION	2009366-1-52-01
ROAD NO.	
COUNTY	LEE
SR 93	

SHEET NO.
L-6

POLE DATA & LEGEND

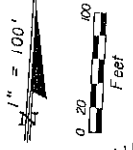

MATCHLINE STA. 549+50
SEE LIGHTING (5A)

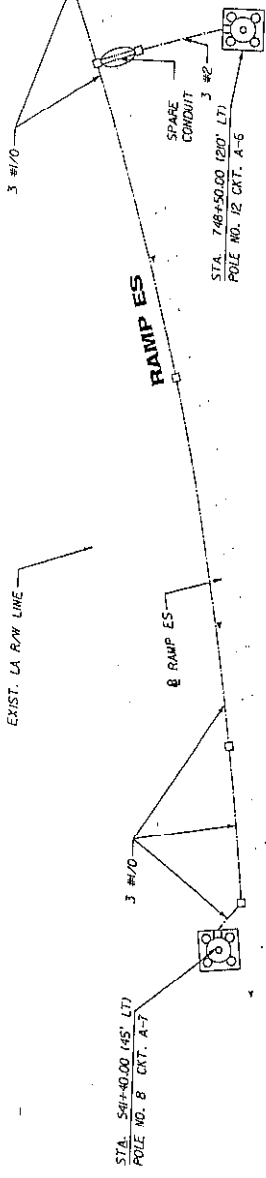

BEGIN HIGH MAST LIGHTING
STA. 737+40.00 @ SURVEY SR 93 (I-75)

MATCHLINE STA. 750+00

I-75 SB

I-75 NB

@ SURVEY SR 93 (I-75)

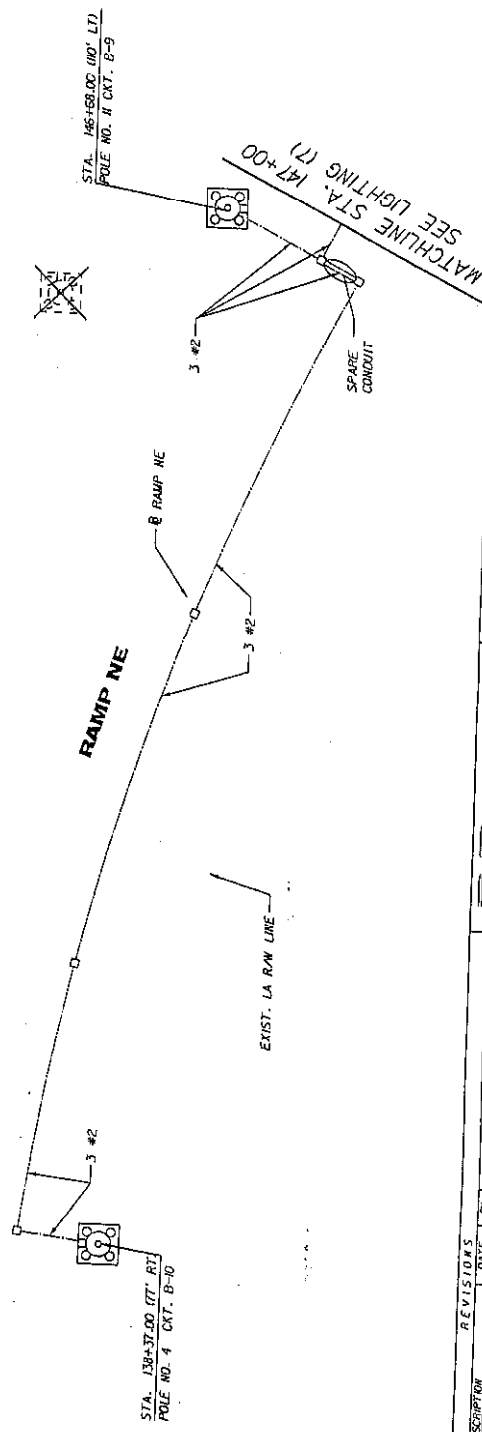

EXIST. LA R/W LINE

MATCHLINE STA. 147+00
SEE LIGHTING (7)

SHEET NO.

LIGHTING (U)
SR 02 11 741

STATE OF FLORIDA	PROJECT NO.	200444-1-59-01
DEPARTMENT OF TRANSPORTATION	ROAD NO.	SR 93
COUNTY	LEE	
FINANCIAL PROJECT ID		

Pysons Brindorff
David & Douglas, Inc.
505 West Cypress St, Suite 300
Gainesville, Florida 32609
GAINESVILLE, FL 32609
AEC #00001468



DATE	BY	REVISION	DESCRIPTION

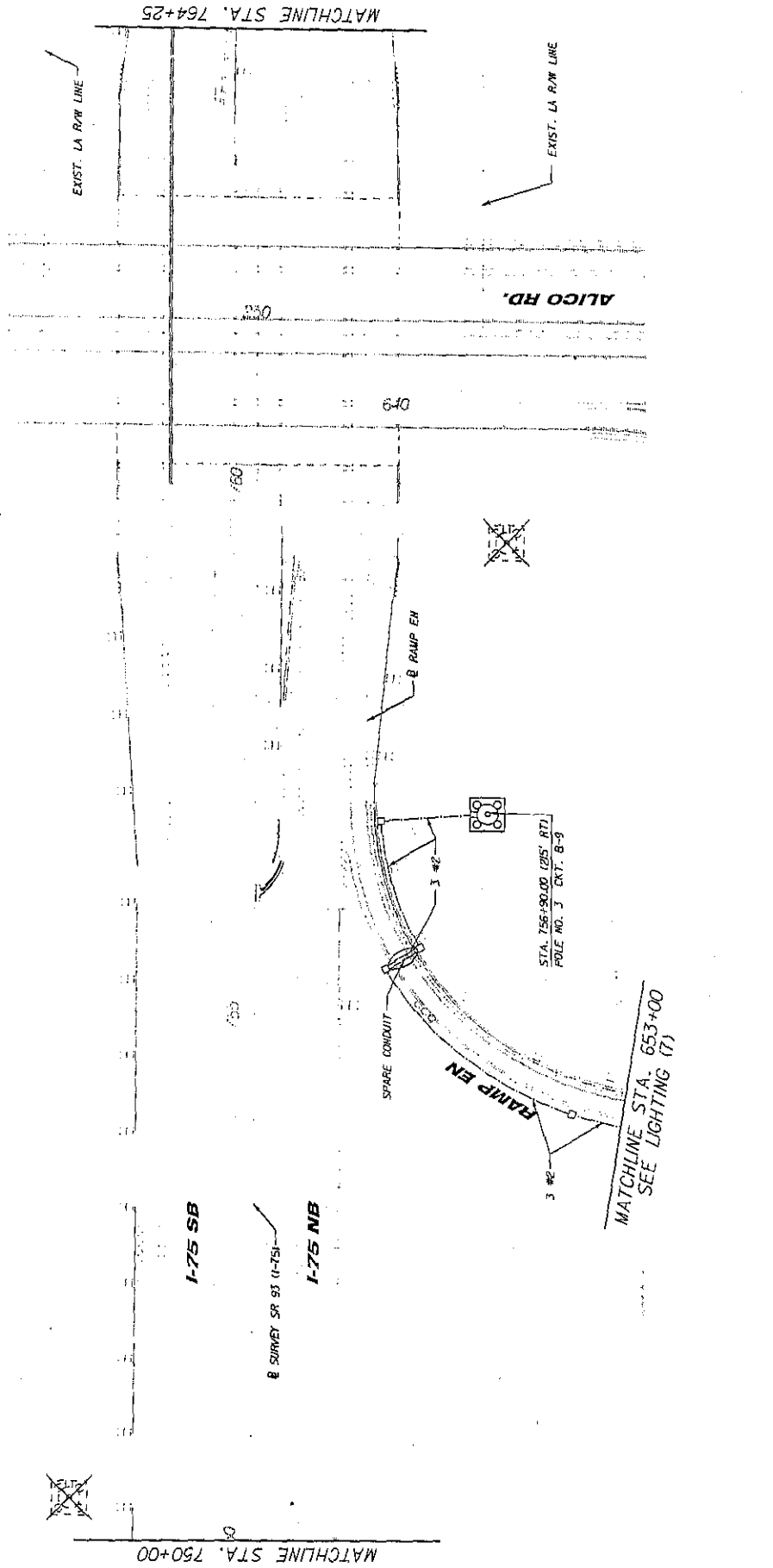
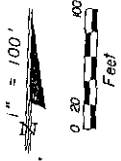

SHEET NO.

LIGHTING (2)

STATE OF FLORIDA
DEPARTMENT OF TRANSPORTATION
ROAD NO. COUNTY FINANCIAL PROJECT ID
SR 04

Parsons Brinckerhoff
Guede & Dierkes, Inc.
4605 West Orange St. Suite 300
Tampa, Florida 33607
PROJECT NO. 1387
INTERCHANGE



REVISIONS		DESCRIPTION	DATE	BY

MATCHLINE STA. 653+00
SEE LIGHTING (7)

STA. 756+90.00 (21ST RT)
POLE NO. 3 EXT. 8-9

I-75 SB

I-75 NB

8 SURVEY SP 93 (I-75)

MATCHLINE STA. 750+00

MATCHLINE STA. 764+25

EXIST. LA R/W LINE

EXIST. LA R/W LINE

0+9

750

750

3 #2

SPARE CONDUIT

RAMP EN

RAMP EN

ALICO RD.



MATCHLINE STA. 877+00

I-75 SB

I-75 NB

SR 93 (I-75)

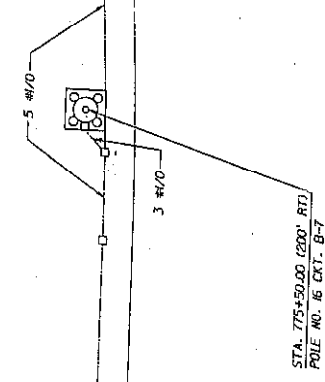

STA. 775+50.00 (200' RT)
POLE NO. 16 CKT. B-7

5 4 1/2

RAMP W/W

PROPOSED LA R/W LINE

STA. 769+40.00 (164' LT)
POLE NO. 15 CKT. B-5

EXIST. LA R/W LINE

3 4 1/2

5 4 1/2

SPARE CONDUIT

MATCHLINE STA. 467+00
SEE LIGHTING (6)

RAMP W/W

MATCHLINE STA. 764+25

5 4 1/2

MATCHLINE STA. 864+40
SEE LIGHTING (12)

LIGHTING (3)

SHEET NO.

STATE OF FLORIDA
DEPARTMENT OF TRANSPORTATION
ROAD NO. SR 93
COUNTY
FINANCIAL PROJECT ID

Pursons Brinkerhoff
Dodge & Douglas, Inc.
1000
1000
1000



DATE	DESCRIPTION	REVISIONS	DATE	DESCRIPTION

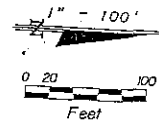

END HIGH MAST LIGHTING
 STA. 788+60.27 @ SURVEY SR 93 (1-75)

MATCHLINE STA. 376+60
 SEE LIGHTING (6)

STA. 779+15.00 (125' RT)
 POLE NO. 9 CKT. A-3

STA. 790+10.00 (125' RT)
 POLE NO. 20A CKT. A-4

LIGHTED SIGN 110
 STA. 389+75.00 CKT. A-3

SPARE CONDUIT

I-75 SB

@ SURVEY SR 93 (1-75)

I-75 NB

STA. 782+20.00 (133' RT)
 POLE NO. 18 CKT. B-6

STA. 788+60.00 (162' RT)
 POLE NO. 20 CKT. B-7

EXIST. LA R/W LINE

MATCHLINE STA. 877+00

RAMP WN

RAMP WN

PROP. LA R/W LINE

RAMP SW

PROP. LA R/W LINE

EXIST. LA R/W LINE

DATE		BY		DESCRIPTION		REVISIONS	
DATE	BY	DESCRIPTION	DATE	BY	DESCRIPTION	DATE	BY



Parsons Brinckerhoff
 Quade & Douglas, Inc.
 5405 West Cypress St., Suite 300
 Tampa, FL 33607
 ENGINEERING BUSINESS
 NUMBER 1042
 ABC REGISTRATION NO. 1042

STATE OF FLORIDA DEPARTMENT OF TRANSPORTATION		
ROAD NO.	COUNTY	FINANCIAL PROJECT ID
SR 93	LEE	200966-1-52-01

LIGHTING (4)
 SR 93 (L72)

SHEET NO.

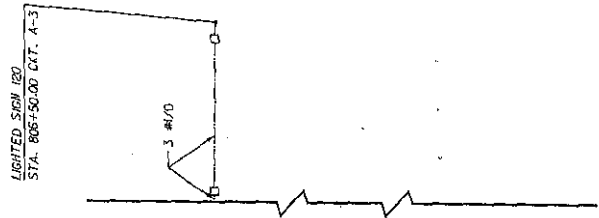
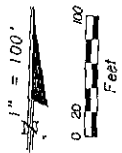

EXIST. LA RAW LINE

I-75 SB

I-75 NB

8 SURVEY SR 93 11-751

EXIST. LA RAW LINE

SHEET NO.

LIGHTING (3)

STATE OF FLORIDA
DEPARTMENT OF TRANSPORTATION
ROAD NO. COUNTY FINANCIAL PROJECT ID
SR 93

Peterson Br. Interhoff
Osie & Douglas, Inc.
5405 West Orange St., Suite 300
Tampa, Florida 33609
PH: 813-973-1111
FAX: 813-973-1112



REVISIONS	
DATE	DESCRIPTION

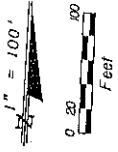

MATCHLINE STA. 551+00
SEE LIGHTING (10)

STA. 555+60.00 (180' LT)
POLE NO. 6 CXT. A-6

EXIST. LN. R/W LINE

SPARE CONDUIT

RAMP ES

RAMP ES

3 #1/0
2 #2

3 #1/0
2 #2

3 #2

3 #1/0
2 #2

STA. 755+00.00 (184' LT)
POLE NO. 10 CXT. A-7



MATCHLINE STA. 549+50
SEE LIGHTING (1)

REVISIONS		DESCRIPTION
DATE	BY	

PD
100

Parsons Brinckerhoff
Owens & Douglas, Inc.
540
100
100
ENGINEERING BUSINESS
ADMINISTRATIVE

STATE OF FLORIDA DEPARTMENT OF TRANSPORTATION	ROAD NO.	SR 93	CRUIT	1 E F
FINANCIAL PROJECT ID				

LIGHTING (6A)
CD 07 11 11

SHEET NO.

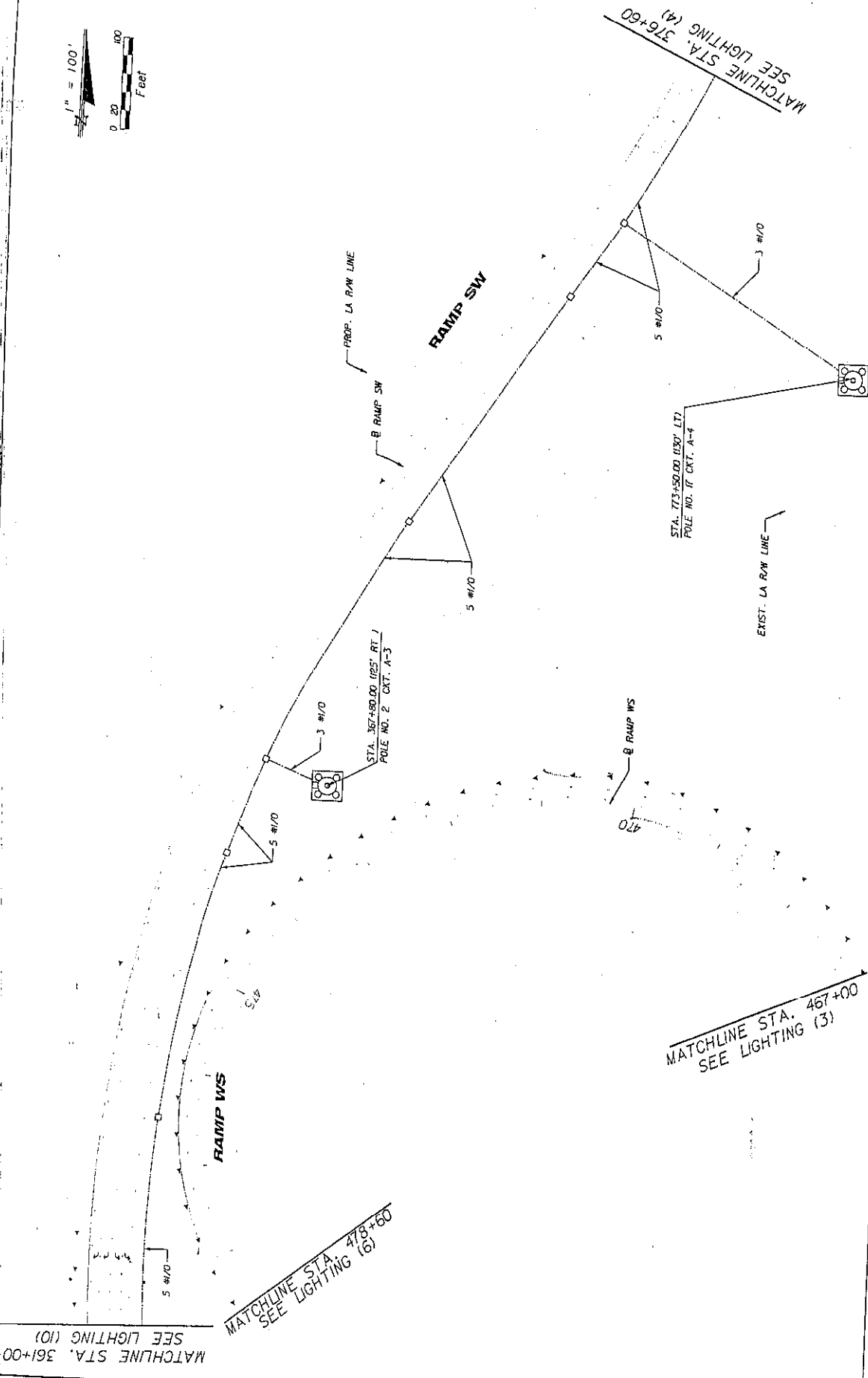
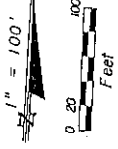

SHEET NO.

LIGHTING (6)
SEP 07 (7 73)

STATE OF FLORIDA
DEPARTMENT OF TRANSPORTATION
ROAD NO. SR 93
COUNTY IFF
FINANCIAL PROJECT ID 990000100000

Parsons Brinckerhoff
Dunde & Douglas, Inc.
540 West Orange St. Suite 300
Orlando, Florida 32809
TEL: 407.241.1100
WWW.PBS&D.COM



DATE	BY	DESCRIPTION	REVISIONS

MATCHLINE STA. 361+00
SEE LIGHTING (10)

MATCHLINE STA. 473+60
SEE LIGHTING (6)

MATCHLINE STA. 487+00
SEE LIGHTING (3)

MATCHLINE STA. 376+60
SEE LIGHTING (4)

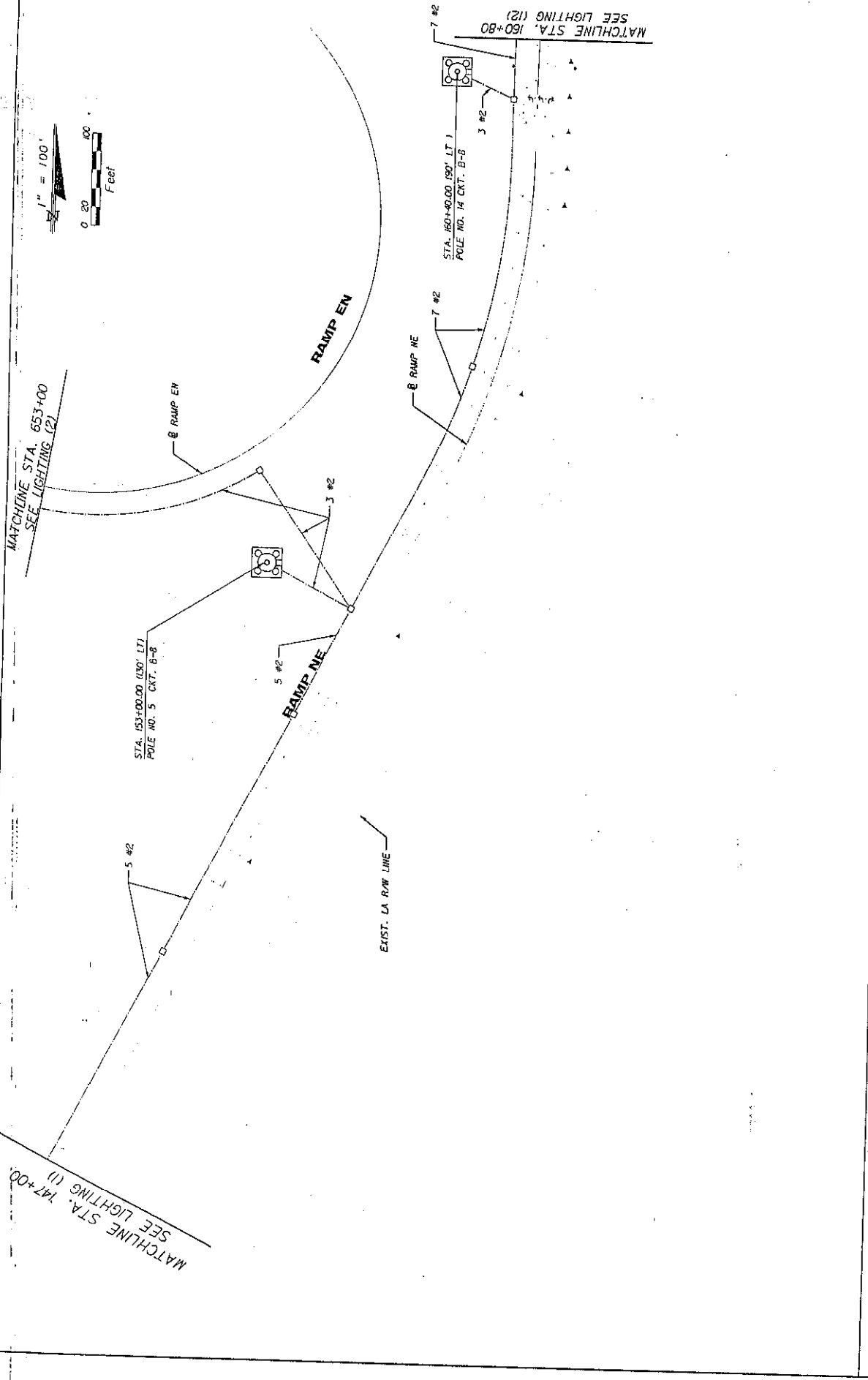
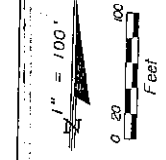

REVISIONS		DATE		DESCRIPTION
NO.	BY	DATE	BY	DESCRIPTION

Parsons Brinckerhoff Good & Douglas, Inc. 545 West Central St., Suite 300 Fort Lauderdale, Florida 33301 ENGINEERING BUSINESS PROFESSIONAL SERVICE INCORPORATED JAN. 1982		STATE OF FLORIDA DEPARTMENT OF TRANSPORTATION ROAD NO. SR 93 COUNTY LEE GRANTY FINANCIAL PROJECT ID 2000566-1-52-01	LIGHTING (7) SR 93 Q-75	SHEET NO. L-14
--	--	--	----------------------------	----------------

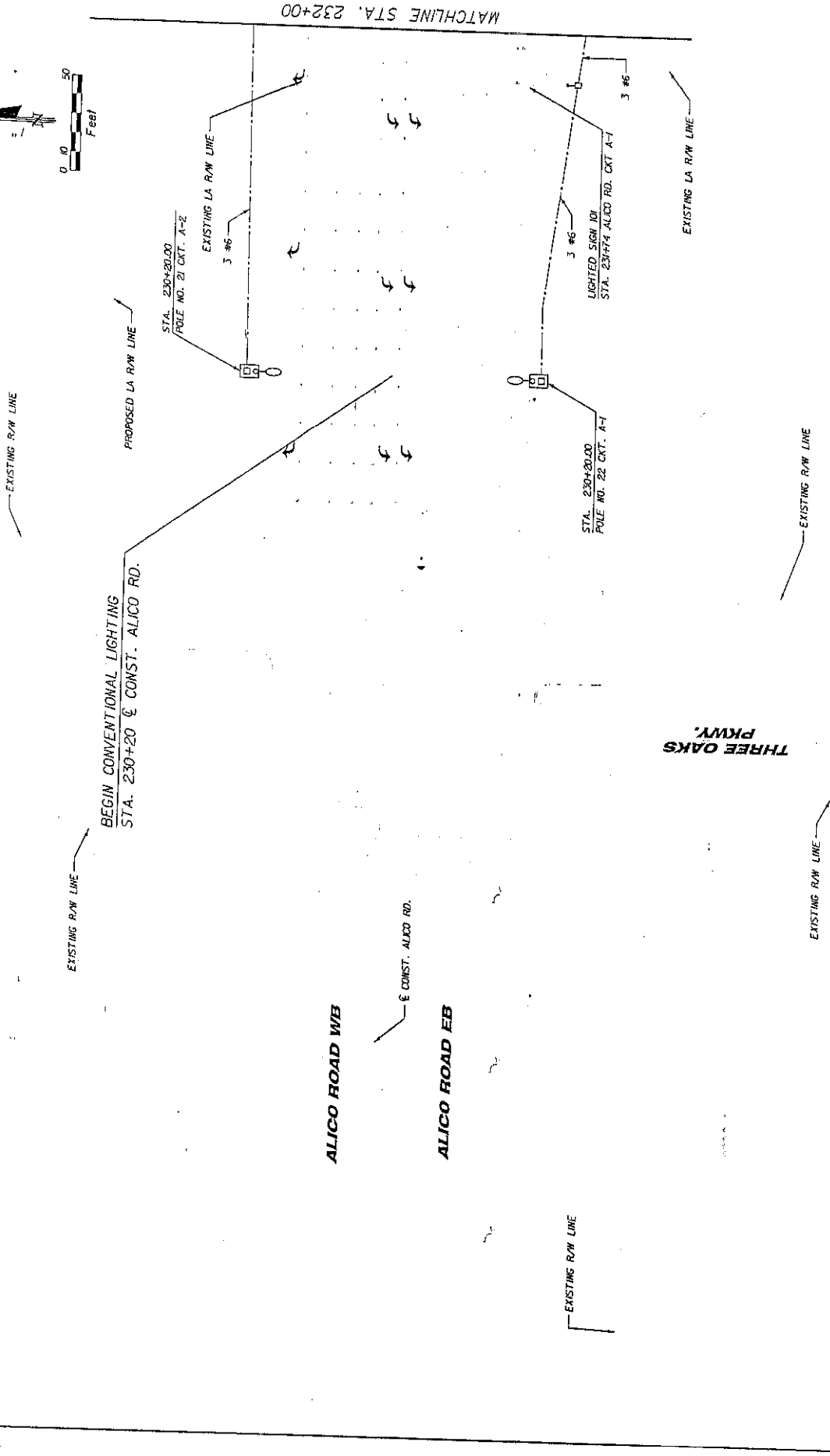
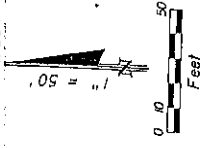

DATE	BY	DESCRIPTION	REVISIONS	DATE	BY	DESCRIPTION

100 FEET



Parson Brinckerhoff
 Onda & Duggins, Inc.
 5400 Westchase Lane, Suite 300
 Tampa, Florida 33607
 ENGINEERING BUSINESS
 ARE REGISTERED IN FLORIDA

STATE OF FLORIDA	DEPARTMENT OF TRANSPORTATION
ROAD NO. SR 93	COUNTY LEE
FINANCIAL PROJECT ID 200966-1-52-01	

LIGHTING (B)
ALICO ROAD

SHEET NO. 1-15

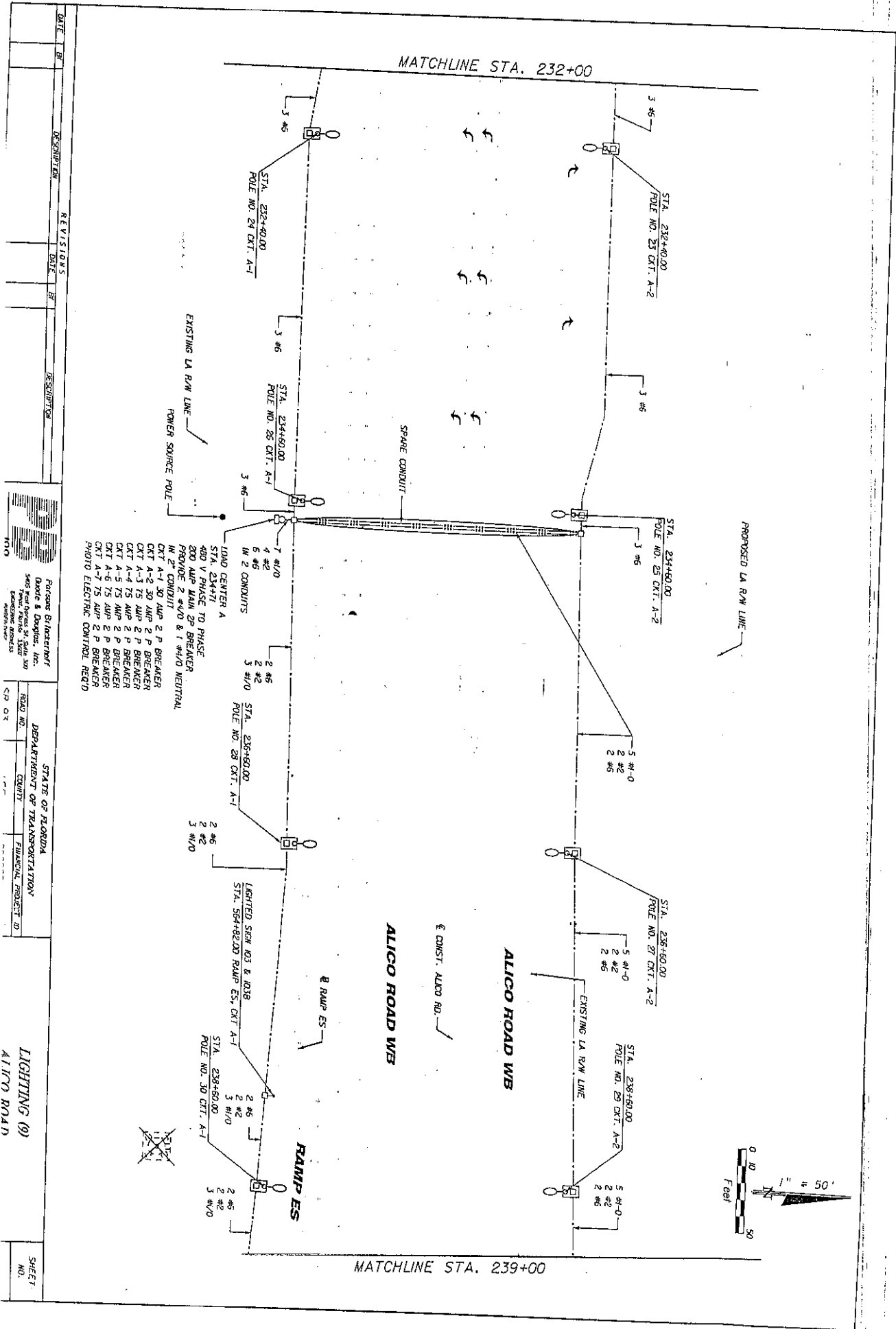

DATE	BY	DESCRIPTION	REVISIONS	DATE	BY	DESCRIPTION

Parsons Brinckerhoff Date: 8/1/2008 5600 Towne Centre Blvd Suite 1000 Jacksonville, FL 32217 PROJECT NO. 08-00000000	STATE OF FLORIDA DEPARTMENT OF TRANSPORTATION COUNTY: _____ FINANCIAL PROJECT NO. _____ ROAD NO. _____ CP OR _____	LIGHTING (9) ALICO ROAD	SHEET NO. _____
---	---	----------------------------	-----------------

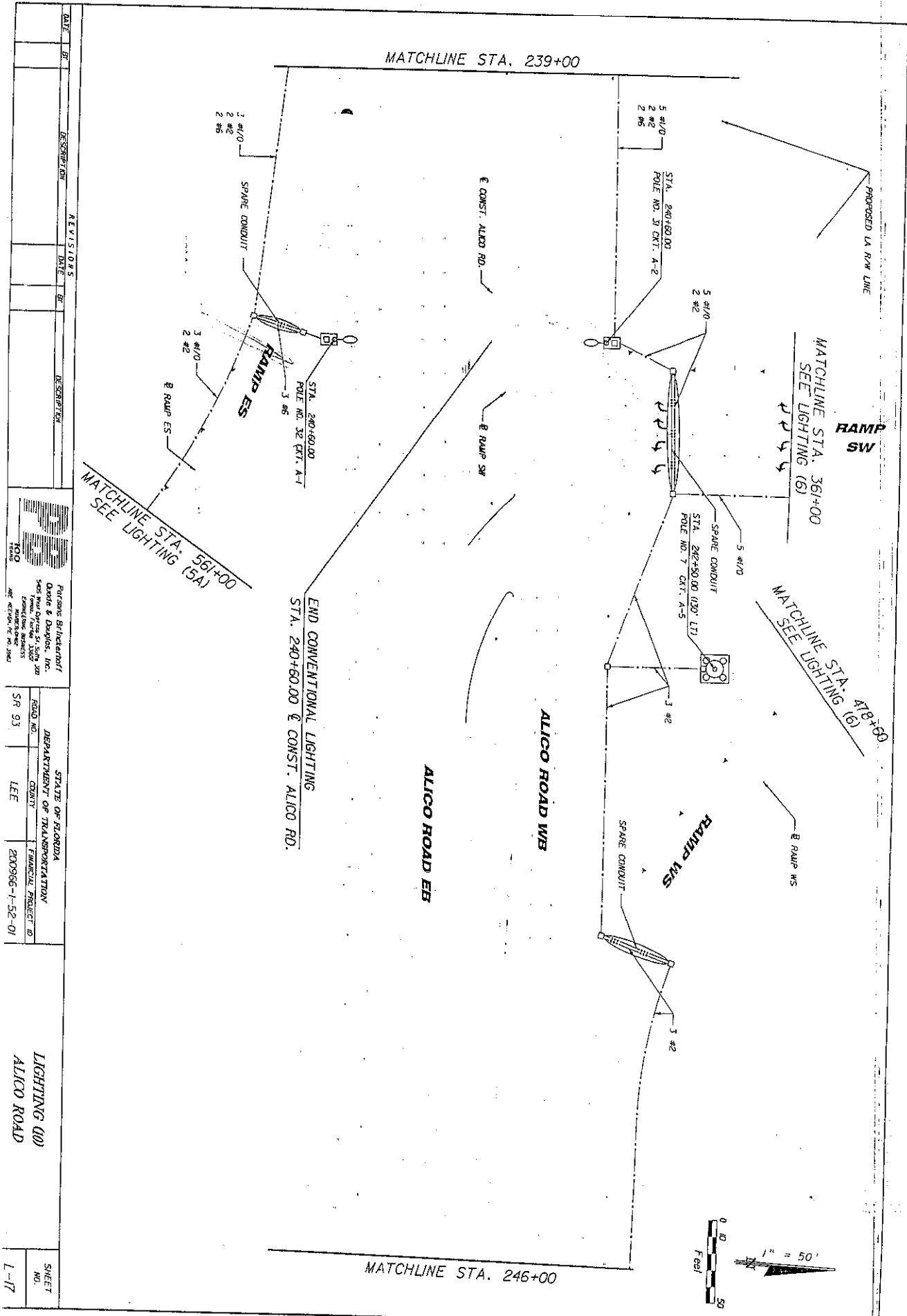

DATE	BY	DESCRIPTION	REVISIONS	DATE	BY	DESCRIPTION

Pursons Brinkmann O'Neil & Davalos, Inc. 5405 West Orange Ave., Suite 200 Fort Lauderdale, Florida 33309 Phone: (954) 571-2800 Fax: (954) 571-2801		STATE OF FLORIDA DEPARTMENT OF TRANSPORTATION COUNTY: LEE FINANCIAL PROJECT ID: SR 93 LEE 200956-1-52-01
---	--	---

LIGHTING (00) ALICO ROAD	SHEET NO. L-17
-----------------------------	-------------------

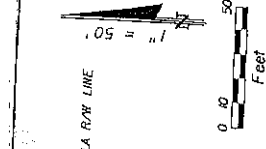

EXISTING LA ROW LINE

MATCHLINE STA. 246+00

MATCHLINE STA. 253+00

STA. 247+50.00 (65' LT)
POLE NO. 10 CKT. A-1



3 #2

ALICO ROAD WB

± CONST. ALICO RD.

ALICO ROAD EB

± SURVEY ALICO RD.

I-75 NB

I-75 SB

REVISIONS		DESCRIPTION	
DATE	BY	DATE	BY



Parsons Brinckerhoff
Quinn & Douglas, Inc.
5405 West Orange St., Suite 300
Tampa, Florida 33607
TEL: 813/288-8800
WWW.PBQ.COM

STATE OF FLORIDA
DEPARTMENT OF TRANSPORTATION
ROAD NO. SR 93 COUNTY LEE
FINANCIAL PROJECT ID 200906-1-50-01

LIGHTING (I)
ALICO ROAD

SHEET NO. 1 OF 1

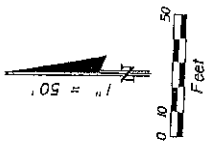

STA. 253+80.00 (866' 17")
POLE NO. 13 CRT. B-5



3 #2

MATCHLINE STA. 861+40
SEE LIGHTING (3)

5 #1/0

B RAMP WN

RAMP WN

STA. 658+22.00 (807' 8")
POLE NO. 19 CRT. B-5



3 #2

SPARE CONDUIT

5 #1/0

2 #2

MATCHLINE STA. 260+00

MATCHLINE STA. 253+00

ALICO ROAD WB

ALICO ROAD EB

CONST. ALICO RD.

SURVEY ALICO RD.

RAMP EN

RAMP EN

SPARE CONDUIT

7 #2

RAMP NE

7 #2

MATCHLINE STA. 160+80
SEE LIGHTING (7)



Perkins Brinckerhoff
Quate & Douglas, Inc.
565 West Orange St. Suite 300
Tampa, Florida 33606
ENGINEERS
MEMBER AASCE

STATE OF FLORIDA
DEPARTMENT OF TRANSPORTATION
ROAD NO. SR 93
COUNTY IFF
FINANCIAL PROJECT ID APPROVED - L.E.O. - 01

DATE	BY	DESCRIPTION	REVISIONS	DATE	BY	DESCRIPTION

SHEET NO.

LIGHTING (02)
ALICO ROAD

MATCHLINE STA. 267+00

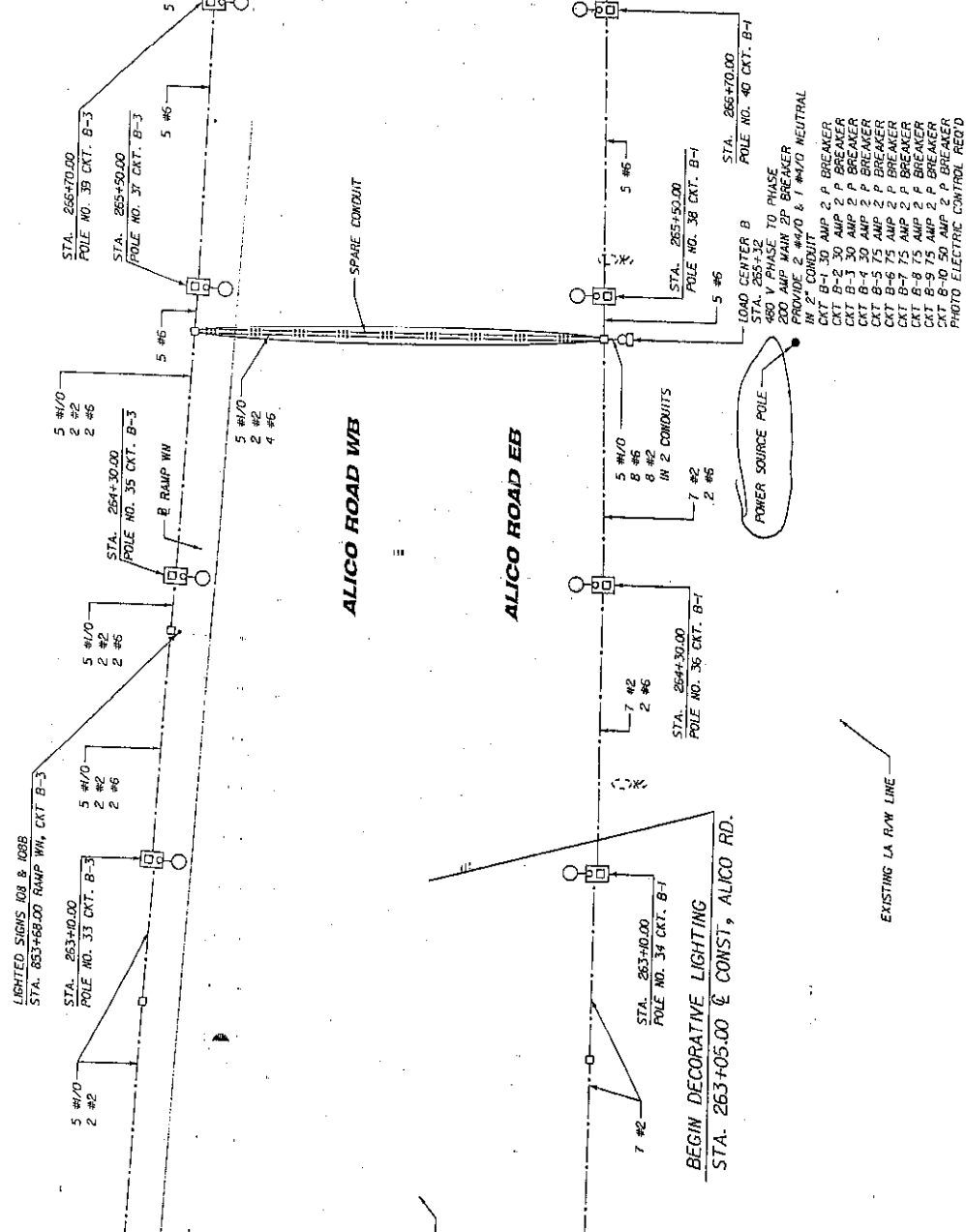
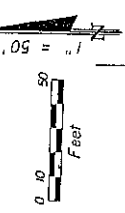

- LOAD CENTER B
- STA. 265+12
- 480 V PHASE TO PHASE
- 200 AMP MAIN 2P BREAKER
- PROVIDE 2 #4/0 & 1 #1/0 NEUTRAL IN 2" CONDUIT
- CKT B-1 30 AMP 2 P BREAKER
- CKT B-2 30 AMP 2 P BREAKER
- CKT B-3 30 AMP 2 P BREAKER
- CKT B-4 30 AMP 2 P BREAKER
- CKT B-5 75 AMP 2 P BREAKER
- CKT B-6 75 AMP 2 P BREAKER
- CKT B-7 75 AMP 2 P BREAKER
- CKT B-8 75 AMP 2 P BREAKER
- CKT B-9 75 AMP 2 P BREAKER
- CKT B-10 50 AMP 2 P BREAKER
- PHOTO ELECTRIC CONTROL RECD

LIGHTING 03
ALICO ROAD

STATE OF FLORIDA
DEPARTMENT OF TRANSPORTATION
ROAD NO. SR 93 COUNTY IFF PROJECT ID 2009RS-1-59-01

Parsons Brinckerhoff
Quate & Douglas, Inc.
1405 West Orange St. Suite 200
Orange, FL 32809
DATE: 10/09

DATE	BY	DESCRIPTION	REVISIONS	DATE	BY

PROPOSED LA R.W. LINE

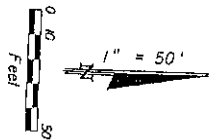

PROPOSED R.W. LINE

EXIST. R.W. LINE

MATCHLINE STA. 267+00

MATCHLINE STA. 274+00

CONST. ALICO RD.

ALICO ROAD EB

ALICO ROAD WB

EXISTING LA R.W. LINE

EXISTING R.W. LINE

STA. 267+90.00
POLE NO. 41 CRT. B-3

STA. 269+00.00
POLE NO. 43 CRT. B-3

STA. 270+30.00
POLE NO. 45 CRT. B-3

LIGHTED SIGN JOI
STA. 270+52.00 E CONST. ALICO RD., CRT. B-3

STA. 273+80.00
POLE NO. 49 CRT. B-3

STA. 267+90.00
POLE NO. 42 CRT. B-1

STA. 269+00.00
POLE NO. 44 CRT. B-1

STA. 270+30.00
POLE NO. 46 CRT. B-1

STA. 271+70.00
POLE NO. 48 CRT. B-1

STA. 273+80.00
POLE NO. 50 CRT. B-1

DATE	BY	DESCRIPTION	DATE	BY	DESCRIPTION
		REVISIONS			
		DESIGN			

DATE	BY	DESCRIPTION
		DESIGN

Pursons Engineering
Dunde & Douglas, Inc.
5465 West Orange St., Suite 200
Tampa, Florida 33609
Tel: 813-971-1100
Fax: 813-971-1101

STATE OF FLORIDA	DEPARTMENT OF TRANSPORTATION
COUNTY	FINANCIAL PROJECT NO.
SR 95	1FF
	PROJECT-1-59-11

LIGHTING (LD)
ALICO ROAD

SHEET NO.	1
-----------	---

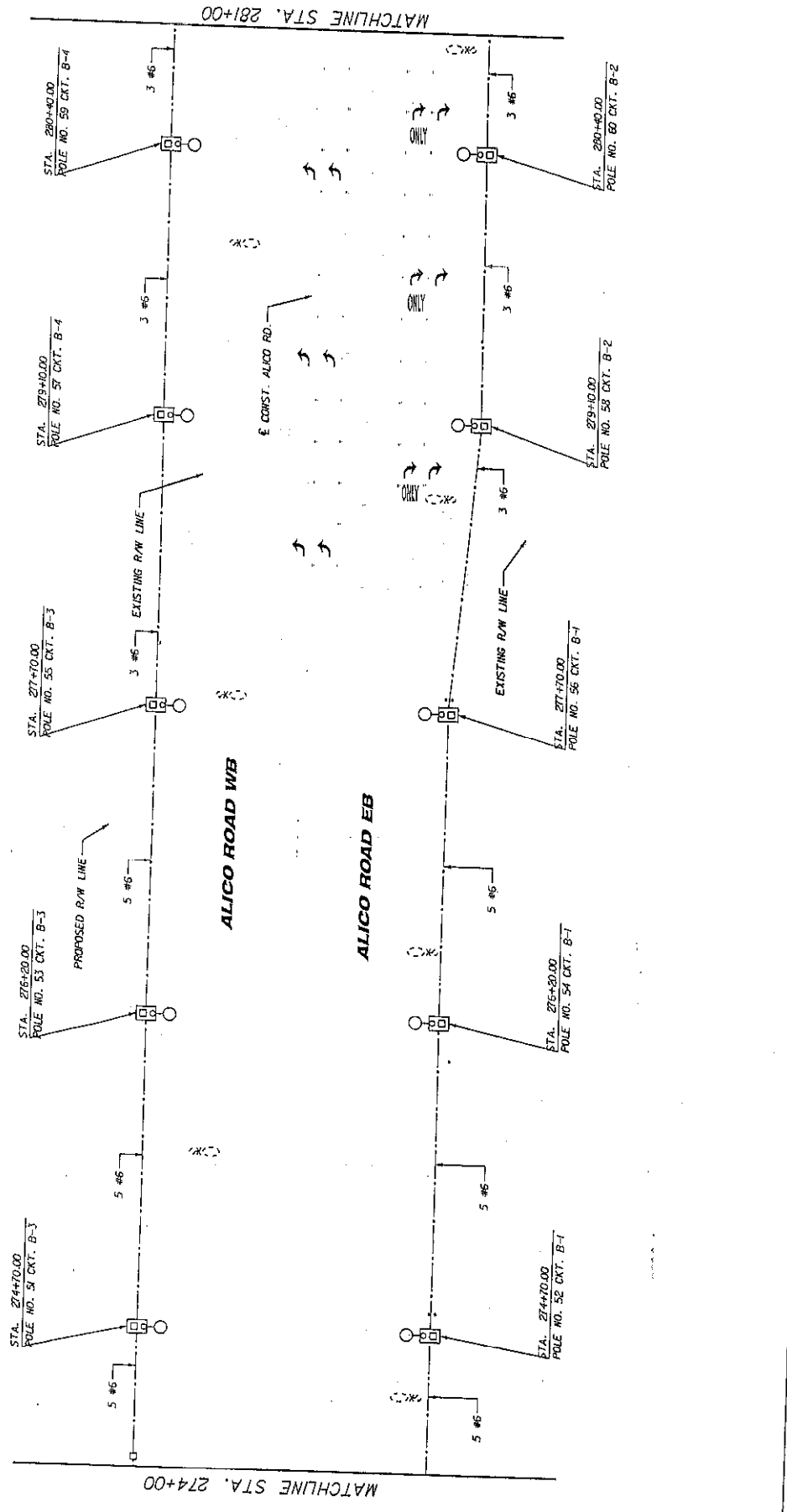
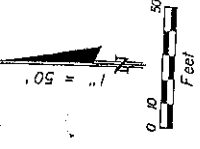

DATE	BY	DESCRIPTION	REVISIONS	DATE	BY	DESCRIPTION

PERSONS BRITTERNIFF QUINN & COMPANY, INC. 545 West 10th Street, Suite 300 Fort Lauderdale, Florida 33304 Telephone: 561-551-1111 Facsimile: 561-551-1112		STATE OF FLORIDA DEPARTMENT OF TRANSPORTATION ROAD NO. _____ COUNTY _____ FINANCIAL PROJECT ID _____ SR 93 IFF
100	100	

LIGHTING (15)
ALICO ROAD

SHEET NO.

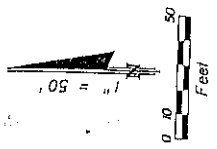

EXISTING R/W LINE

EXISTING R/W LINE

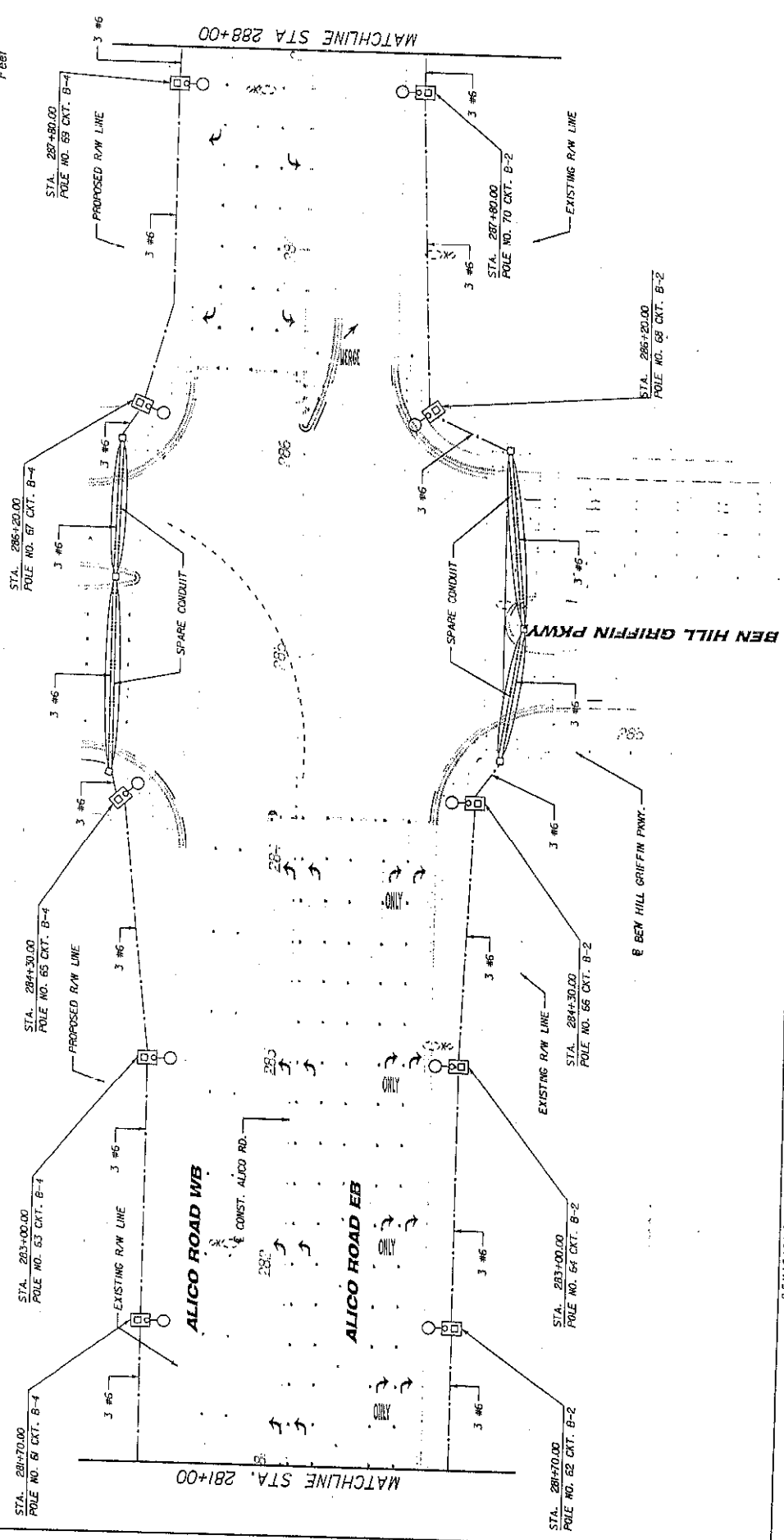

SHEET NO. 1-23

LIGHTING (16)
ALCICO ROAD

STATE OF FLORIDA
DEPARTMENT OF TRANSPORTATION
ROAD NO. SR 93
COUNTY LEE
FINANCIAL PROJECT ID 200966-1-52-01

Parsons Brinckerhoff
Doyle & Douglas, Inc.
540 West Palm Beach Blvd
Palm Beach, FL 33461
TELEPHONE BUSINESS
408-462-6100 FAX 408-394-3103



DATE	BY	DESCRIPTION	REVISION'S	DATE	BY	DESCRIPTION

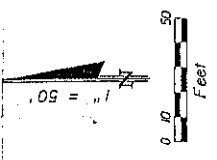

END DECORATIVE LIGHTING
STA. 289+40.00 @ SURVEY ALICO RD.

STA. 289+40.00
POLE NO. 71 CKT. B-4

3 #6



MATCHLINE STA. 288+00

STA. 289+40.00
POLE NO. 72 CKT. B-2

3 #6



PROPOSED R/W LINE

EXISTING R/W LINE

ALICO ROAD WB

EXIST. ALICO RD.

ALICO ROAD EB

EXISTING R/W LINE

REVISIONS		DESCRIPTION	
DATE	BY	DATE	BY

PERCIVAL BRIDGEMAN QUOTE & DESIGN, INC. 5405 WEST OAKES ST., SUITE 300 TAMPA, FLORIDA 33607 (813) 988-1100 AND MEMBER, P.E. NO. 10611		STATE OF FLORIDA DEPARTMENT OF TRANSPORTATION ROAD NO. SR 93 COUNTY LEE FINANCIAL PROJECT ID 200966-1-52-01	SHEET NO. L-24
--	--	---	----------------

MATCHLINE STA. 295+00

EXISTING R/W LINE

PROPOSED R/W LINE

END LIGHTING
STA. 298+49.20 @ SURVEY ALICO RD.

EXISTING R/W LINE

± CONST. ALICO RD.

ALICO ROAD WB
ALICO ROAD EB

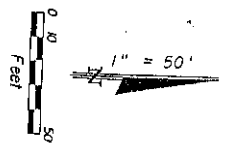

REVISIONS		REVISIONS		REVISIONS	
DATE	BY	DATE	BY	DATE	BY

		Parsons Brinckerhoff O'Quinn & Douglas, Inc. 5405 West Orange St., Suite 200 Fort Lauderdale, Florida 33309 A/E/C CONTRACT NO. 100
STATE OF FLORIDA DEPARTMENT OF TRANSPORTATION		SR 83 COUNTY: LEE TRAVEL PROJECT # 200966-1-52-01
LIGHTING (08) ALICO ROAD		SHEET NO. 1-25

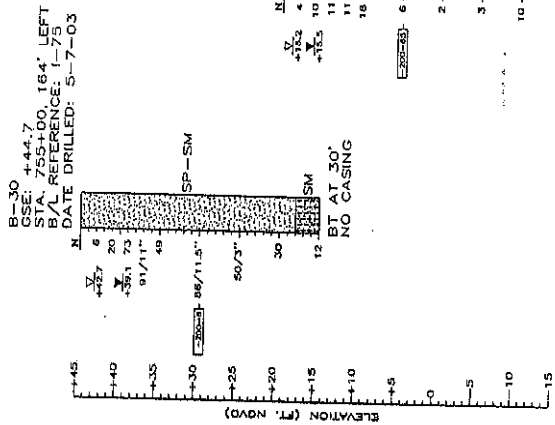
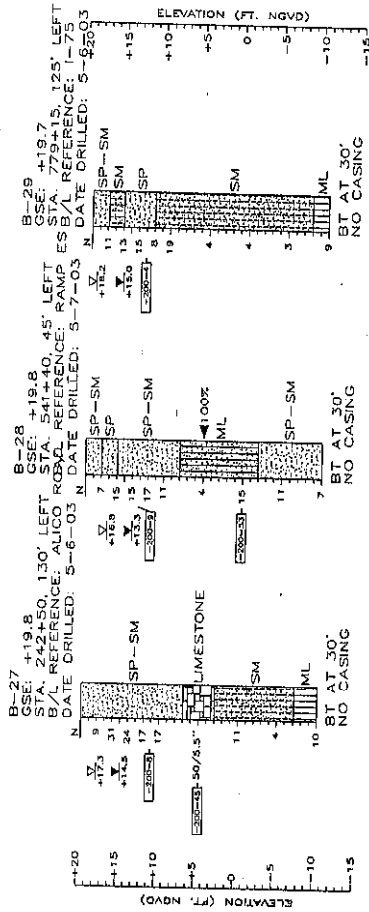

LEGEND:

- GSE APPROXIMATE GROUND SURFACE ELEVATION (FT. NGVD)
- ▽ SEASONAL HIGH GROUNDWATER ELEVATION (FT. NGVD)
- ▽ ESTIMATED SEASONAL HIGH GROUNDWATER ELEVATION (FT. NGVD)
- ▽ ENCOUNTERED GROUNDWATER ELEVATION (FT. NGVD)
- BT BORING TERMINATED
- N STANDARD PENETRATION RESISTANCE, BLOWS PER FOOT
- 50/75" NUMBER OF BLOWS FOR 5 INCHES OF PENETRATION
- 100% UNDISTURBED SAMPLE (SHELBY TUBE)
- SP UNIFIED SOIL CLASSIFICATION SYMBOL
- 200 PERCENT PASSING NO. 200 U.S. STANDARD SIEVE (PM 1-T 028)

SOIL LEGEND:

- SP-SM - FINE SAND WITH SILT, TRACE CALCAREOUS LAMINAE
- SM - CALCAREOUS SILTY FINE SAND, TRACE FOSSILS & SHELL
- ML - CALCAREOUS SANDY SILT
- ML - SILT, TRACE SHELL
- LIMESTONE HIGHLY WEATHERED LIMESTONE

NOTES:

STANDARD PENETRATION TEST BORINGS WERE PERFORMED IN ACCORDANCE WITH ASTM D-1586. STANDARD PENETRATION RESISTANCES ARE SHOWN ON THE BORINGS AT THE TEST DEPTHS IN BLOWS PER FOOT UNLESS OTHERWISE NOTED. SUBSURFACE CONDITIONS SHOWN ON THE BORINGS REPRESENT THE CONDITIONS ENCOUNTERED AT THE BORING LOCATIONS. ACTUAL CONDITIONS ON THE BORINGS REPRESENTED BY THE SYMBOLS SHOWN UNLESS SHOWN UNLESS OTHERWISE NOTED. LOCATIONS ON THE BORINGS ARE BASED ON VISUAL EXAMINATION AND LABORATORY TESTING PERFORMED AT THE DEPTHS INDICATED ON EACH BORING.

BORING ELEVATIONS WERE PROVIDED BY PROAD. THE STATIONS AND OFFSETS OF THE BORING LOCATIONS ARE REFERENCED FROM THE MAINLINE (I-75 & ALICO ROAD) AND RAMP BASELINES.

THE CONTRACTOR SHALL USE SPECIAL EQUIPMENT AND/OR METHODS (I.E. CORE BARRELS, ROCK AUGERS, PUNCHES, DRILL BITS, ETC.) AS NEEDED TO FACILITATE PENETRATING THE LIMESTONE.

ENVIRONMENTAL CLASSIFICATION SUBSTRUCTURE: CONCRETE SLIGHTLY AGGRESSIVE STEEL: SLIGHTLY AGGRESSIVE

SPLIT SPOON SAMPLER: AVERAGE HAMMER DROP: 30 IN. DIAMETER: 1.375 IN. HAMMER WEIGHT: 140 LBS. OUTSIDE DIAMETER: 2.0 IN. HAMMER TYPE: SAFETY (MANUAL)

CORRELATION OF STANDARD PENETRATION RESISTANCE WITH RELATIVE DENSITY AND CONSISTENCY OF SOIL

GRANULAR SOILS	N VALUE (blows per foot)	RELATIVE DENSITY	NON-GRANULAR SOILS	N VALUE (blows per foot)	CONSISTENCY
SANDS	0-4	VERY LOOSE	SILTS, CLAYS, MUCK, PEAT	0-2	VERY SOFT
	4-10	MEDIUM DENSE		2-4	SOFT
	10-30	DENSE		4-15	STIFF
	30-50	VERY DENSE		15-30	VERY STIFF
	OVER 50			OVER 30	HAIRD

FLORIDA DEPARTMENT OF TRANSPORTATION
GEOTECHNICAL DESIGN OFFICE

REPORT OF SPT BORINGS FOR HIGH MAST LIGHT POLES

PROJECT NO. 200966-1-52-01

COUNTY: LEE

DATE: 1-75 / ALICO ROAD INTERCHANGE

SCALE: 1" = 20'

FIGURE 7

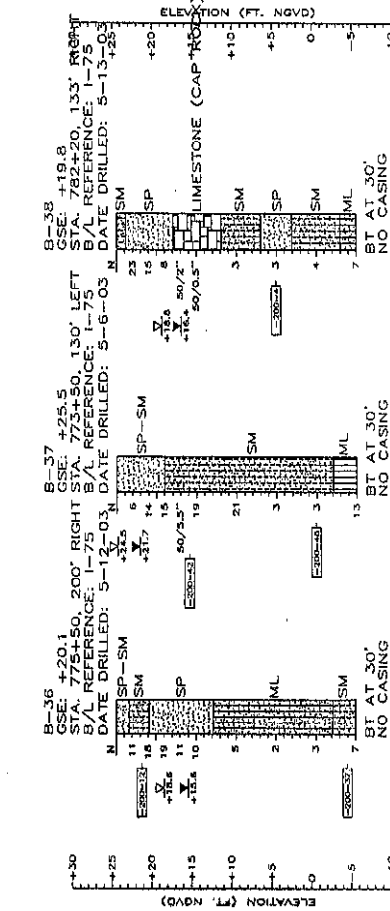
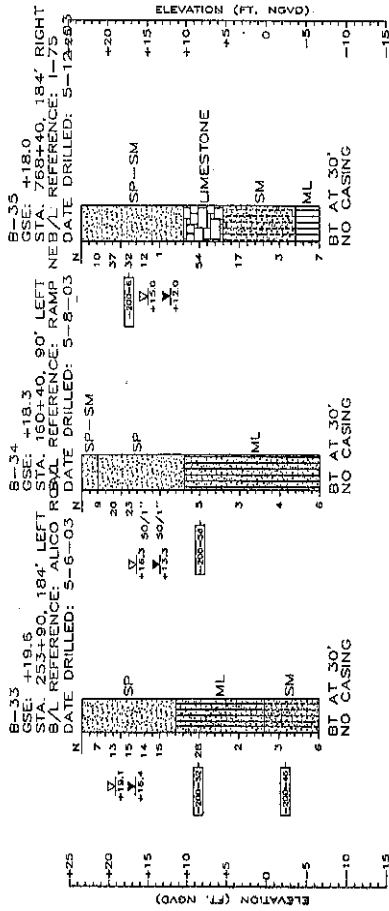

SOIL LEGEND

- SP - FINE SAND
- SM - FINE SAND WITH SILT
- ML - CALCAREOUS SILTY FINE SAND, TRACE PHOSPHATE & SHELL
- SM - CALCAREOUS SANDY SILT, ABUNDANT PHOSPHATE
- ML - SILT, TRACE PHOSPHATE & SHELL
- ML - LIMESTONE (CAP ROCK)
- ML - LIMESTONE: HIGHLY WEATHERED

- LEGEND:**
- GSE APPROXIMATE GROUND SURFACE ELEVATION (FT. NGVD)
 - ESTIMATED SEASONAL HIGH GROUNDWATER ELEVATION (FT. NGVD)
 - ENCOUNTERED GROUNDWATER ELEVATION (FT. NGVD)
 - BT BORING TERMINATED
 - N STANDARD PENETRATION RESISTANCE, BLOWS PER FOOT
 - 50/2" NUMBER OF BLOWS FOR 2 INCHES OF PENETRATION
 - SP UNIFIED SOIL CLASSIFICATION SYMBOL
 - 200 PERCENT PASSING NO. 200 U.S. STANDARD SIEVE (FM 1-T 088)

NOTES:

STANDARD PENETRATION TEST BORINGS WERE PERFORMED IN ACCORDANCE WITH ASTM D-1585. STANDARD PENETRATION RESISTANCES ARE SHOWN ON THE BORINGS AT THE TEST DEPTHS IN BLOWS PER FOOT UNLESS OTHERWISE NOTED. SUBSURFACE CONDITIONS SHOWN ON THE BORINGS REPRESENT THE CONDITIONS ENCOUNTERED AT THE BORING LOCATIONS. THE BORING CONDITIONS BETWEEN THE BORING TERMINATION AND LABORATORY TESTING PERFORMED AT THE DEPTH INDICATED ON EACH BORING.

BORING ELEVATIONS WERE PROVIDED BY 890640. THE STATIONS AND OFFSETS OF THE BORING LOCATIONS ARE REFERENCED FROM THE MAINLINE (I-75 & ALICO ROAD) AND RAMP BASELINES.

THE CONTRACTOR SHALL USE SPECIAL EQUIPMENT AND/OR METHODS (I.E. CORE BARRELS, ROCK AUGERS, PUNCHES, DRILL BITS, ETC.) AS NEEDED TO FACILITATE PENETRATING THE LIMESTONE.

SPLIT SPONS SAMPLERS: 3/4 IN. INSIDE DIAMETER, 375 IN. HAMMER WEIGHT, 140 LBS. INSIDE DIAMETER, 3/4 IN. HAMMER WEIGHT, 140 LBS. HAMMER TYPE: "SAFETY (MANUAL)"

CORRELATION OF STANDARD PENETRATION RESISTANCE WITH RELATIVE DENSITY AND CONSISTENCY OF SOIL

CONSOLIDATED SANDS	NON-COAGULATED SANDS (SANDS, SILTS, CLAYS, MUCK, PEAT)	RELATIVE DENSITY	CONSISTENCY
4-10	VERY LOOSE	VERY SOFT	VERY SOFT
10-20	MEDIUM LOOSE	MEDIUM SOFT	MEDIUM SOFT
20-30	COMPACT	STIFF	STIFF
OVER 30	VERY DENSE	VERY STIFF	VERY STIFF

FIGURE B

REPORT OF SPT BORINGS FOR HIGH MAST LIGHT POLES

PROJECT NAME: I-75 / ALICO ROAD INTERCHANGE

DATE: 5-13-03

PROJECT NO: 20029168-1-52-01

DATE: 5-13-03

PROJECT NO: 20029168-1-52-01

DATE: 5-13-03

PROJECT NO: 20029168-1-52-01

DATE: 5-13-03