

LEE COUNTY BOARD OF COUNTY COMMISSIONERS
AGENDA ITEM SUMMARY **BLUE SHEET NO: 20020386-UTL**

1. REQUESTED MOTION:

ACTION REQUESTED:

Approve construction of a gravity main extension serving the **Pine Island Elks Lodge**. This is considered a Developer contributed asset and the project is located at the intersection of Pine Island Road and Park Lane.

WHY ACTION IS NECESSARY:

To provide sanitary sewer service to the existing social club.

WHAT ACTION ACCOMPLISHES:

Complies with the Lee County Utilities Line Extension Policy and provides adequate utility infrastructure to allow the Lodge to abate their existing septic system.

2. DEPARTMENTAL CATEGORY: 10 - UTILITIES
COMMISSION DISTRICT #: 1

C10C

3. MEETING DATE: 05-07-2002

4. AGENDA:

- CONSENT
- ADMINISTRATIVE
- APPEALS
- PUBLIC
- WALK ON
- TIME REQUIRED: _____

5. REQUIREMENT/PURPOSE:

- (Specify)
- STATUTE _____
 - ORDINANCE _____
 - ADMIN. CODE _____
 - OTHER Approval to Construct

6. REQUESTOR OF INFORMATION:

- A. COMMISSIONER: _____
- B. DEPARTMENT: Lee County Public Works
- C. DIVISION/SECTION: Utilities Division
- BY: Rick Diaz, Utilities Director

DATE: 4/18/02

7. BACKGROUND:

The letter of intent has been received.
 The review fee has been paid.
 The plans have been reviewed for conformance to the Lee County Utilities Operations Manual.
 The project is to construct 120' ± of 8" diameter gravity main and two manholes.
 Project location map—copy attached.
 50% of the sewer connection fees have been paid.
 No funds required.

SECTION 28 TOWNSHIP 44S RANGE 22E DISTRICT 1 COMMISSIONER JANES

8. MANAGEMENT RECOMMENDATIONS:

9. RECOMMENDED APPROVAL

(A) DEPARTMENT DIRECTOR	(B) PURCH. OR CONTRACTS	(C) HUMAN RESOURCES	(D) OTHER	(E) COUNTY ATTORNEY	(F) BUDGET SERVICES				(G) COUNTY MANAGER
					QA	PM	Risk	GC	
<i>J. Lavender</i> Date: 4-19-02	N/A Date:	N/A Date:	T. Osterhout Date: 4-18	<i>[Signature]</i> Date: 4/22/02	<i>[Signature]</i> 4/22/02	<i>[Signature]</i> 4/23	4/23	<i>[Signature]</i> 4-22-02	<i>J. Lavender</i> Date: 4-19-02

10. COMMISSION ACTION:

- APPROVED
- DENIED
- DEFERRED
- OTHER

Rec. by CoAtty
 Date: 4/19/02
 Time: 4:00pm

RECEIVED BY
 COUNTY ADMIN.
 4/22/02 9:45am
 COUNTY ADMIN.
 4/23 3:00

Forwarded To:
 Budget
 4/30/02

GREATER PINE ISLAND ELKS CLUB
 28-44-22-03-0000 F.0030
 COMMISSION DISTRICT #1 - JANES

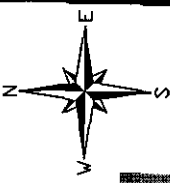

PROJECT LOCATION

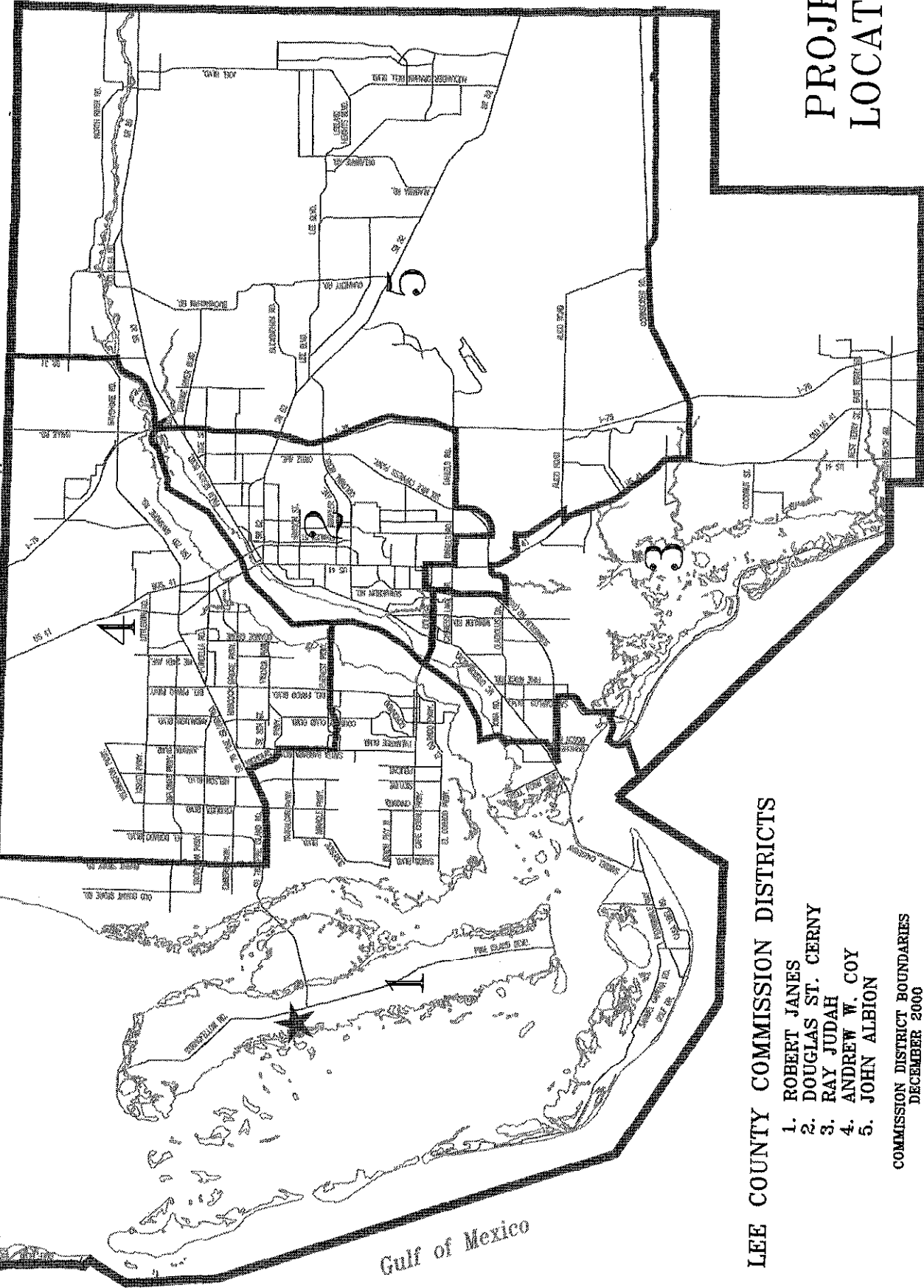

LEE COUNTY COMMISSION DISTRICTS

1. ROBERT JANES
2. DOUGLAS ST. CERNY
3. RAY JUDAH
4. ANDREW W. COY
5. JOHN ALBION

COMMISSION DISTRICT BOUNDARIES
 DECEMBER 2000

Gulf of Mexico

GREATER PINE ISLAND ELKS CLUB

COMMISSION DISTRICT #1 - JANES

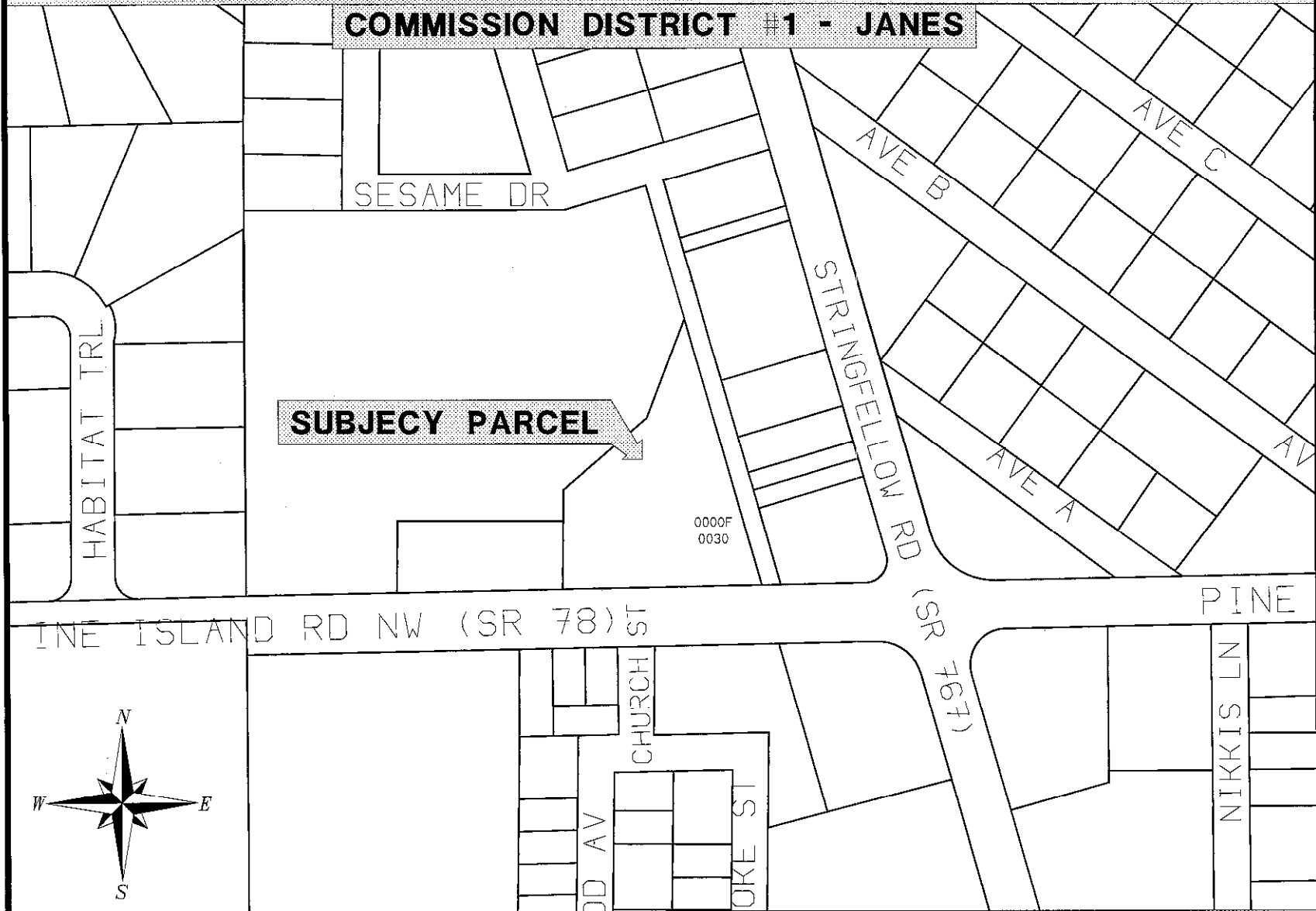

28-44-22-03-0000F.0030

5630 PINE ISLAND RD NW