

ORANGE RIVER BLVD. AT S.R. 80  
PEDESTRIAN IMPROVEMENTS

JEI PROJECT ID: 20214267-000

INDEX OF SIGNALIZATION PLANS

| SHEET NO. | SHEET DESCRIPTION        |
|-----------|--------------------------|
| T-1       | KEY SHEET                |
| T-2       | TABULATION OF QUANTITIES |
| T-3 - T-4 | GENERAL NOTES            |
| T-5       | PEDESTRIAN IMPROVEMENTS  |
| T-6       | PEDESTRIAN SIGNAL DETAIL |

SIGNALIZATION PLANS

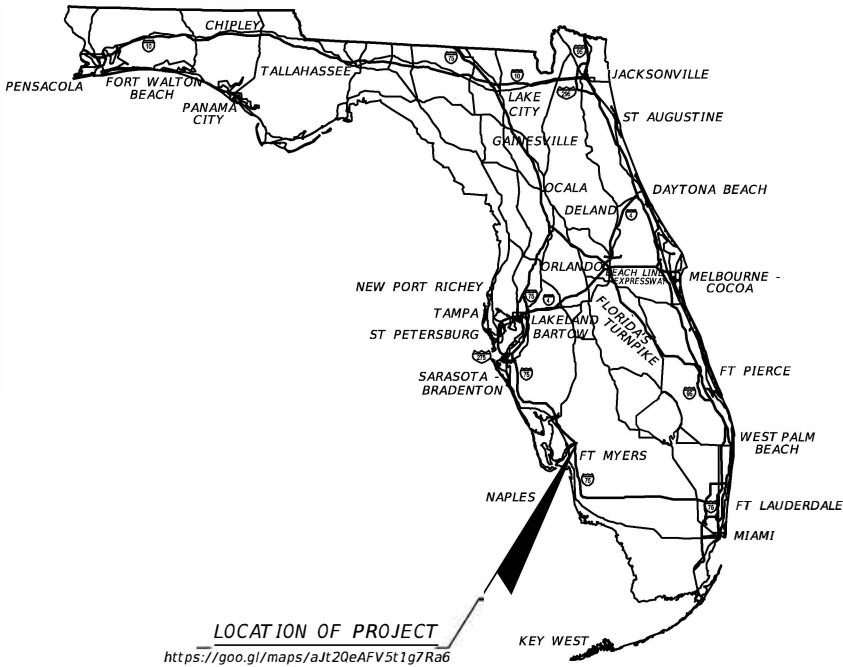

SIGNALIZATION SHOP DRAWINGS  
TO BE SUBMITTED TO:

LEAH M. HOLMES, P.E.

SIGNALIZATION PLANS  
ENGINEER OF RECORD:

JOHNSON  
ENGINEERING

LEAH M. HOLMES, P.E.  
P.E. LICENSE NUMBER 85359  
JOHNSON ENGINEERING, INC.  
2122 JOHNSON STREET  
FORT MYERS, FLORIDA 33901  
CONTRACT NO.:  
VENDOR NO.:  
CERTIFICATE OF AUTHORIZATION NO.: 642

NOTE: THE SCALE OF THESE PLANS MAY  
HAVE CHANGED DUE TO REPRODUCTION.

Digitally  
signed by  
Leah M.  
Holmes, P.E.  
Date:  
2024.12.11  
13:09:34  
-05'00'



GOVERNING STANDARD PLANS:

Florida Department of Transportation, FY2024-25 Standard Plans for Road and Bridge Construction and applicable Interim Revisions (IRs).

Standard Plans for Road Construction and associated IRs are available at the following website: <http://www.fdot.gov/design/standardplans>

Standard Plans for Bridge Construction are included in the Structures Plans Component

GOVERNING STANDARD SPECIFICATIONS:

Florida Department of Transportation, FY2024-25 Standard Specifications for Road and Bridge Construction at the following website: <http://www.fdot.gov/programmanagement/Implemented/SpecBooks>

48 HOURS BEFORE DIGGING  
"CALL SUNSHINE"  
1-800-432-4770



| CONSTRUCTION<br>CONTRACT NO. | FISCAL<br>YEAR | SHEET<br>NO. |
|------------------------------|----------------|--------------|
|                              | 24             | T-1          |

THE OFFICIAL RECORD OF THIS SHEET IS THE ELECTRONIC FILE DIGITALLY SIGNED AND SEALED UNDER RULE 61G15-23.004, F.A.C.

# TABULATION OF QUANTITIES

[illegible]

| REVISIONS |             |      |             |  <p>LEAH M. HOLMES • P.E. LICENSE NO. 85359<br/>JOHNSON ENGINEERING, INC.<br/>2122 JOHNSON STREET • FORT MYERS, FL 33901<br/>CERTIFICATE OF AUTHORIZATION NO. 642</p> | LEE COUNTY PUBLIC WORKS<br>DEPARTMENT OF TRANSPORTATION |        |                | <p><i>TABULATION OF QUANTITIES</i></p> | SHEET NO. |
|-----------|-------------|------|-------------|--|---|--------|----------------|--|-----------|
| DATE      | DESCRIPTION | DATE | DESCRIPTION |  | ROAD NO.  | COUNTY | JEI PROJECT ID |  | T-2       |
|           |             |      |             |  |   | LEE    | 20214267-000   |  |           |
|           |             |      |             |  |   |        |                |  |           |

THE OFFICIAL RECORD OF THIS SHEET IS THE ELECTRONIC FILE DIGITALLY SIGNED AND SEALED UNDER RULE 61G15-23.004, F.A.C.

GENERAL NOTES:

1. SPECIFICATIONS: ADHERE TO REQUIREMENTS IN "LEE COUNTY DEPARTMENT OF TRANSPORTATION PLAN SPECIFICATIONS FOR SIGNAL & STREET LIGHTING", JANUARY 2023. CONTACT LEE COUNTY DEPARTMENT OF TRANSPORTATION (LCDOT) FOR ANY QUESTIONS REGARDING EQUIPMENT OR INSTALLATION REQUIREMENTS. FOLLOW THE FDOT GOVERNING STANDARDS AND SPECIFICATIONS FOR ALL ITEMS NOT COVERED BY LEE COUNTY SPECIFICATIONS.
2. NOTIFICATIONS: PRIOR TO THE START OF ANY CONSTRUCTION OF TRAFFIC SIGNALS, STREET LIGHTING, RRFBS, FLASHERS, SCHOOL FLASHERS, AND ITS DEVICES, LEE COUNTY DOT TRAFFIC SHALL BE NOTIFIED VIA EMAIL LCDOTPROJECTS@LEEGOV.COM AT LEAST TEN (10) BUSINESS DAYS PRIOR.
3. PRELIMINARY PRODUCT AND EQUIPMENT DATA SUBMITTALS: PRIOR TO INSTALLATION OR WITHIN THIRTY (30) DAYS AFTER THE PRECONSTRUCTION MEETING, WHICHEVER COMES FIRST, SUBMIT TO LEE COUNTY DOT TRAFFIC FOR APPROVAL, A COMPLETED SUBMITTAL PACKAGE THAT INCLUDES THE FOLLOWING. ALL TRAFFIC CONTROL SIGNALS, DEVICES, AND HARDWARE THAT WILL BE USED ON THE PROJECT. SHOP DRAWINGS FOR STRUCTURAL SUPPORT MATERIAL AND OTHER SPECIAL DESIGNS, SUCH AS NON-ELECTRICAL, NON-MECHANICAL, OR OTHER FABRICATED ITEMS WHICH MAY NOT BE SPECIFICALLY DETAILED IN THE PLANS VIA EMAIL
4. QUALIFICATIONS: MINIMUM QUALIFICATIONS FOR PERSONNEL SUPERVISING OR PERFORMING WORK INVOLVING ELECTRICAL OR SOLAR POWER TRAFFIC CONTROL DEVICES, STREET LIGHTING AND RELATED COMPONENTS.

A. TRAFFIC SIGNAL CABINET WIRING: WORK MUST BE PERFORMED BY AN EMPLOYEE OF THE CONTRACTOR THAT HOLDS A CURRENT IMSA TRAFFIC SIGNAL FIELD TECHNICIAN LEVEL II CERTIFICATION OR HIGHER; AND MUST BE PRESENT AT THE FINAL INSPECTION OF THE PROJECT.

B. TRAFFIC SIGNAL ELECTRICAL SERVICE: WORK MUST BE PERFORMED BY OR IN THE PRESENCE OF AND UNDER THE RESPONSIBLE CHARGE OF AN EMPLOYEE OF THE LICENSED ELECTRICAL CONTRACTOR AND THAT HOLDS A CURRENT IMSA TRAFFIC SIGNAL FIELD TECHNICIAN LEVEL II CERTIFICATION OR HIGHER.

C. RRFB, FLASHERS, AND SCHOOL FLASHERS: WORK MUST BE PERFORMED BY AN EMPLOYEE OF THE CONTRACTOR THAT HOLDS A CURRENT IMSA TRAFFIC SIGNAL FIELD TECHNICIAN LEVEL II CERTIFICATION OR HIGHER; AND MUST BE PRESENT AT THE FINAL INSPECTION OF THE PROJECT.

D. ITS DEVICES: WORK MUST BE PERFORMED BY AN EMPLOYEE OF THE CONTRACTOR THAT HOLDS A CURRENT IMSA TRAFFIC SIGNAL FIELD TECHNICIAN LEVEL II CERTIFICATION OR HIGHER; AND MUST BE PRESENT AT THE FINAL INSPECTION OF THE PROJECT.

E. STREET LIGHTING: WORK MUST BE PERFORMED BY OR IN THE PRESENCE OF AND UNDER THE RESPONSIBLE CHARGE OF AN EMPLOYEE OF THE LICENSED ELECTRICAL CONTRACTOR AND THAT HOLDS A CURRENT IMSA ROADWAY LIGHTING TECHNICIAN LEVEL I CERTIFICATION OR HIGHER.
5. CONTRACTOR TRANSFER OF MAINTENANCE RESPONSIBILITIES:

A. FULLY MAINTAIN ALL TRAFFIC CONTROL DEVICES LOCATED WITHIN THE PROJECT LIMITS, INCLUDING ANY INTERCONNECT, PREEMPTION, SYSTEM/ADVANCED LOOPS, AND ITS DEVICES, BEGINNING ON THE DATE OF NOTICE TO PROCEED OR THE DATE CONTRACTOR HAS BEGUN ANY WORK ON ANY PORTION OF THE PROJECT, WHICHEVER IS SOONER, THROUGH AND INCLUDING THE DATE OF FINAL ACCEPTANCE BY THE COUNTY SUBJECT TO ANY ADDITIONAL CONTRACTOR WARRANTY AND BURN-IN PERIOD REQUIREMENTS. INVESTIGATE ALL INQUIRIES, COMPLAINTS OR REQUESTS MADE BY THE COUNTY OR THE PUBLIC AND IMMEDIATELY INITIATE ALL REQUIRED REPAIRS.

B. NOTIFY LEE COUNTY DOT TRAFFIC OF INTENT TO BEGIN ANY PHYSICAL CONSTRUCTION WORK ON THE PROJECT OR ANY PORTION THEREOF. THIS NOTIFICATION MUST BE A MINIMUM OF SEVEN (7) WORKING DAYS PRIOR TO THE START OF CONSTRUCTION TO ALLOW SUFFICIENT TIME FOR CONTRACTOR TO CONDUCT AN INSPECTION OF THE EXISTING TRAFFIC CONTROL DEVICE INSTALLATION(S). IN THE EVENT ANY DEFICIENCIES ARE NOTED BY CONTRACTOR, AT THE COUNTY'S OPTION, THEY ARE TO BE REPAIRED BY LEE COUNTY DOT TRAFFIC OR DOCUMENTED ON THE "TRANSFER OF MAINTENANCE" FORM. IF WORK IS STARTED PRIOR TO THE INSPECTION, MAINTENANCE OF THE TRAFFIC CONTROL DEVICE(S) WILL IMMEDIATELY BE TRANSFERRED TO CONTRACTOR WITHOUT AN INSPECTION. CONTRACTOR IS THEN RESPONSIBLE FOR REPAIRING OR REPLACING ALL EQUIPMENT THAT IS NOT OPERATING PROPERLY OR IS DAMAGED AT NO COST TO THE OWNER OF THE TRAFFIC CONTROL DEVICE.
6. EMERGENCY AND NON-EMERGENCY REPAIRS:

A. PROVIDE LEE COUNTY DOT TRAFFIC MINIMUM TWO (2) CONTACT NAMES AND (24-HOUR) TELEPHONE NUMBERS. CONTRACTOR MUST PROVIDE SUFFICIENT QUALIFIED PERSONNEL TO RESPOND TO ALL NOTIFICATIONS OF MALFUNCTIONS ON A ROUND-THE-CLOCK BASIS (24 HOURS A DAY, 7 DAYS A WEEK).

B. MAINTAIN AND MAKE AVAILABLE TO LEE COUNTY DOT TRAFFIC A TIME AND DATE LOG OF EACH RESPONSE FROM THE TIME OF THE INITIAL REPORT TO THE TIME OF FINAL PERMANENT REPAIR.

C. WHEN A SIGNAL MALFUNCTION OCCURS, CONTRACTOR MUST RESPOND WITHIN TWO (2) HOURS OF NOTIFICATION AND REPAIR THE TRAFFIC SIGNAL SO THAT IT IS OPERATING IN A SAFE MANNER WITHIN FOUR (4) HOURS OF INITIAL NOTIFICATION. CONTRACTOR IS RESPONSIBLE FOR THE PERMANENT REPAIR WITHIN 24 HOURS, AND MUST NOTIFY THE COUNTY IMMEDIATELY UPON COMPLETION OF THE REPAIRS. IF CONTRACTOR FAILS TO RESPOND WITHIN TWO (2) HOURS, THE COUNTY RESERVES THE RIGHT TO EITHER REPAIR THE MALFUNCTION OR EMPLOY ALTERNATE PERSONNEL AND CHARGE ALL COSTS INCURRED BY THE COUNTY TO THE CONTRACTOR.

D. AUTHORIZED COUNTY PERSONNEL MAY, AT ANY TIME, ENTER THE CONTROLLER CABINET IN ORDER TO MODIFY TIMING OR RESTORE ANY AND ALL SIGNAL EQUIPMENT TO PROPER OPERATION IF THE MALFUNCTION OR NON-FUNCTION OF SUCH EQUIPMENT POSES A HAZARD OR INCONVENIENCE TO MOTORISTS OR PEDESTRIANS. SUCH AUTHORIZED ENTRY MAY OCCUR AT ANY TIME WITHIN THE PERIOD OF THE CONTRACT, AND SUCH AUTHORIZED ENTRY WILL IN NO WAY RELIEVE THE CONTRACTOR OR MANUFACTURER OF THEIR RESPECTIVE WARRANTIES.

7. EMERGENCY REPAIRS:

A. DURING THE TRANSFER OF MAINTENANCE PERIOD, THE FOLLOWING WILL BE CONSIDERED AN EMERGENCY UNLESS OTHERWISE IDENTIFIED BY LEE COUNTY DOT TRAFFIC:

i. ANY HAZARDOUS CONDITION;

ii. ANY MALFUNCTION OF A CONTROLLER AND ITS ACCESSORY EQUIPMENT; OR

iii. ANY SITE CONDITION, EQUIPMENT MALFUNCTIONS OR DAMAGE, WHICH IN THE OPINION OF LEE COUNTY DOT TRAFFIC CONSTITUTES A SERIOUS HAZARD OR INCONVENIENCE TO THE PUBLIC.

B. CONTRACTOR MUST DISPATCH PERSONNEL TO UNDERTAKE EACH SUCH REPAIR NO LATER THAN THIRTY (30) MINUTES AFTER THE COUNTY NOTIFIES CONTRACTOR OF THE EMERGENCY. PERSONNEL RESPONDING MUST ARRIVE WITHIN ONE (1) HOUR AFTER NOTIFICATION AND IMMEDIATELY PROCEED TO MAKE THE SITE SAFE.
8. LOCATES: ONE (1) COURTESY LOCATE SHALL BE PERFORMED BY LEE COUNTY SIGNALS AT THE START OF THE PROJECT AT THE CONTRACTOR'S REQUEST. THE CONTRACTOR SHALL DOCUMENT THE LOCATION OF THE EXISTING UNDERGROUND AND ABOVE GROUND FACILITIES. AFTER THE COURTESY LOCATE, ALL LOCATES WITHIN THE PROJECT LIMITS ARE THE RESPONSIBILITY OF THE CONTRACTOR AND SHALL BE PERFORMED IN A TIMELY MANNER. TIMELY MANNER IN RESPONSE TO LOCATES IS DEFINED AS, LOCATE SHALL BE PERFORMED NO LATER THAN TWENTY-FOUR (24) HOURS AFTER NOTIFICATION OR AS REQUIRED BY FLORIDA STATUTE. LEE COUNTY SIGNALS WILL ADVISE THE CONTRACTOR VIA E-MAIL OR FAX OF SUNSHINE LOCATE REQUESTS WITHIN THE WORK ZONE. ANY DAMAGE INCURRED DUE TO CONTRACTOR FAILURE TO LOCATE SHALL BE REPAIRED BY THE CONTRACTOR. SHOULD LEE COUNTY FORCES BE CALLED OUT TO MAKE REPAIRS DUE TO CONTRACTOR REFUSAL OR INABILITY TO MAKE REPAIRS, THE CONTRACTOR WILL BE BILLED THE ENTIRE COST AS A "DEDUCT" ON THE NEXT PAYMENT REQUEST AND WILL TRIGGER A "VENDOR/CONTRACTOR COMPLAINT" NOTICE TO BE FILED WITH LEE COUNTY CONTRACTS AS WELL AS FDOT. BEING AN "OUT OF TOWN" CONTRACTOR DOES NOT RELIEVE THIS RESPONSIBILITY.
9. DAMAGE TO EXISTING FACILITIES: ANY DAMAGE TO LEE COUNTY FACILITIES SHALL BE REPAIRED BY THE CONTRACTOR. REPAIRS SHALL BE MADE TO ENSURE FACILITIES ARE LIKE OR BETTER. ANY DAMAGE TO EXISTING COMMUNICATION LINES SHALL NECESSITATE THE REMOVAL OF ALL DAMAGED LINES AND THE RE-PULLING OF NEW CABLE. SPLICING OF COMMUNICATION LINES WILL NOT BE ALLOWED. CAUTION SHALL BE EXERCISED DURING EXCAVATION NEAR EXISTING LEE COUNTY FIBER OPTIC LINES, SINCE MANY ENTITIES USE THESE FACILITIES. SHOULD DAMAGE OCCUR TO FIBER OPTIC LINES, LEE COUNTY WILL DECIDE WHICH QUALIFIED FIBER OPTIC SPLICING COMPANY WILL BE USED TO MAKE REPAIRS. THE CONTRACTOR WILL BE RESPONSIBLE FOR ALL REPAIR COSTS INCURRED, WHETHER REPAIRS ARE MADE BY LEE COUNTY OR A THIRD PARTY.
10. EXISTING EQUIPMENT: EQUIPMENT SHALL BE RETURNED TO LEE COUNTY DOT/TRAFFIC IN GOOD OPERATING CONDITION AND IN THE SAME CONDITION AS ON THE DAY OF THE MAINTENANCE TRANSFER AT 5650 ENTERPRISE PARKWAY, FORT MYERS, FL 33905 AND IN A TIMELY MANNER. TIMELY MANNER FOR EXISTING EQUIPMENT IS DEFINED AS NO LATER THAN 72 HOURS AFTER DISCONNECTION. THE CONTRACTOR SHALL NOTIFY LEE COUNTY OF THE DISCONNECTION 24 HOURS IN ADVANCE TO SCHEDULE THE DELIVERY OF THE EQUIPMENT SO THAT DELIVERY TAKES PLACE DURING A REGULAR BUSINESS DAY AND HOURS. FAILURE TO PERFORM AS OUTLINED IN THIS PARAGRAPH WILL RESULT IN NO INSPECTION AT COMPLETION UNTIL CONTRACTOR IS IN COMPLIANCE WITH THIS REQUIREMENT. LEE COUNTY SIGNALS WILL WITHHOLD PAYMENT REQUESTS UNTIL LEE COUNTY PROPERTY IS DELIVERED TO 5650 ENTERPRISE PARKWAY, FORT MYERS, FL 33905.
11. CABINET/CONTROLLER/VIDEO DETECTION PREP: LEE COUNTY SIGNALS WILL ASSIST THE CONTRACTOR IN THE SETUP OF NEW SIGNAL CABINET/CONTROLLERS/CAMERAS WHEN THE FOLLOWING CONDITIONS ARE MET: DELIVERY OF EQUIPMENT TO 5650 ENTERPRISE PARKWAY, FORT MYERS, FL 33905 BY CONTRACTOR OF SHIPPER. THE CONTRACTOR SHALL SEND A QUALIFIED TECHNICIAN TO THE SIGNAL SHOP TO SETUP THE EQUIPMENT WITH THE AID OF A SENIOR SIGNAL TECHNICIAN, GIVING A MINIMUM OF 48 HOURS' NOTICE. AFTER SETUP, THE CONTRACTOR SHALL ARRANGE TO PICK UP THE EQUIPMENT WITHIN ONE WEEK. AT TIME OF REMOVAL FROM THE LEE COUNTY SIGNAL SHOP, THE EQUIPMENT SHALL BE SIGNED OUT BY THE CONTRACTOR REPRESENTATIVE AS COMPLETE. LEE COUNTY WILL NOT STORE CONTRACTOR EQUIPMENT. UNDER THESE CONDITIONS, LEE COUNTY SIGNALS WILL ASSIST THE CONTRACTOR ON "TURN ON" DAY IN THE FIELD. SHOULD THE CONTRACTOR ELECT TO SETUP, BURN IN, AND TEST THE EQUIPMENT WITHOUT LEE COUNTY ASSISTANCE, A MANUFACTURER'S REPRESENTATIVE SHALL BE ONSITE AT THE CONTRACTOR'S EXPENSE, ON THE DAY OF TURN ON TO ASSIST THE CONTRACTOR AND TO VERIFY PROPER OPERATION.
12. SPECIAL NOTE REGARDING NEW CONTROLLERS: LEE COUNTY RESERVES THE RIGHT TO SUBSTITUTE DIFFERENT CONTROL EQUIPMENT IN THE EVENT THAT DELIVERED EQUIPMENT IS NOT COMPATIBLE WITH THE EXISTING SYSTEM. SINCE SYSTEM UPGRADES MAY BE BEHIND CONTROLLER TECHNOLOGY, AS THE MAINTAINING AGENCY, LEE COUNTY SIGNALS WILL DECIDE EQUIPMENT PLACEMENT, TIMING AND MAY PROVIDE AN ALTERNATE CONTROLLER TEMPORARILY UNTIL FUTURE UPGRADES ARE MADE. IF THERE IS A COST DIFFERENTIAL, PAYMENT WILL BE MADE TO THE CONTRACTOR PER PLAN QUANTITY AND SPECIFICATION.
13. TEMPORARY DETECTION AND MAINTENANCE: CONTRACTOR SHALL PROVIDE AND MAINTAIN FULLY ACTUATED VEHICLE DETECTION AT EXISTING, TEMPORARY, AND NEW SIGNALIZED INTERSECTION FOR THE DURATION OF THE ENTIRE PROJECT. SEVERAL OPTIONS ARE AVAILABLE TO THE CONTRACTOR FOR TEMPORARY VEHICLE DETECTION:

A. MAINTAIN AND/OR RECUT LOOPS AS NECESSARY.

B. INSTALL CONTRACTOR OWNED TEMPORARY VIDEO DETECTION.

C. INSTALL THE PERMANENT CAMERAS THAT MAY BE CALLED OUT ON THE PLANS FOR TEMPORARY USE DURING CONSTRUCTION. THE CONTRACTOR CAN RELOCATE THESE CAMERAS TO THEIR PERMANENT LOCATION AT THE APPROPRIATE TIME. SHOULD THE CONTRACTOR CHOOSE OPTION 3, LEE COUNTY WILL NOT BE RESPONSIBLE FOR ANY DAMAGE TO THE VIDEO CAMERAS DURING THE PROJECT. THE CAMERAS SHALL BE SUBJECT TO FINAL INSPECTION AND SHALL BE IN GOOD WORKING ORDER.

| REVISIONS |             |      |             | <div>JOHNSON<br/>ENGINEERING</div> <div>LEAH M. HOLMES • P.E. LICENSE NO. 85359<br/>JOHNSON ENGINEERING, INC.<br/>2122 JOHNSON STREET • FORT MYERS, FL 33901<br/>CERTIFICATE OF AUTHORIZATION NO. 642</div> | LEE COUNTY PUBLIC WORKS<br>DEPARTMENT OF TRANSPORTATION |        |                | GENERAL NOTES | SHEET NO. |
|-----------|-------------|------|-------------|---|---|--------|----------------|---------------|-----------|
| DATE      | DESCRIPTION | DATE | DESCRIPTION |   | ROAD NO.  | COUNTY | JEI PROJECT ID |               | T-3       |
|           |             |      |             |   |   | LEE    | 20214267-000   |               |           |
|           |             |      |             |   |   |        |                |               |           |

ADDITIONALLY, ALL EXISTING SIGNAL PHASES, ANY PHASES ACTIVE DURING CONSTRUCTION, AND ALL NEW OR MODIFIED PHASES RESULTING FROM NEW CONSTRUCTION SHALL HAVE DETECTION FULLY MAINTAINED AND OPERATIONAL DURING THE DURATION OF THE PROJECT. ONLY DETECTION APPROVED BY LEE COUNTY DOT TRAFFIC AND OPERATES PROPERLY IN THE "PRESENCE" MODE MAY BE USED. MOTION DETECTION SUCH AS MICROWAVE PULSE DETECTION IS PROHIBITED.

NO ADDITIONAL COMPENSATION WILL BE ALLOWED, UNLESS SPECIFICALLY CALLED OUT IN THE PLANS FOR ANY OF THE ABOVE OPTIONS. MICROWAVE DETECTION OR PULSE DETECTION SHALL NOT BE USED IN LEE COUNTY FOR PRESENCE DETECTION DUE TO OPERATIONAL PROBLEMS AND FAILURE TO DETECT STOPPED VEHICLES.

14. NEW SIGNALS OR SOP: ALL NEW SIGNALS OR EXISTING SIGNALS WITH A NEW SOP SHALL HAVE VMS BOARDS ON ALL APPROACHES 48 HOURS PRIOR TO PRE FLASH, FULL OPERATION, OR NEW SOP. LEE COUNTY DOT TRAFFIC REPRESENTATIVE SHALL BE PRESENT FOR: FLASH MODE ACTIVATION, FULL OPERATION, OR NEW SOP.

15. PRE FLASH: PRIOR TO ACTIVATING FLASH MODE AT NEW SIGNALS, INSPECTION WILL BE REQUIRED TO ENSURE THE INTERSECTION IS READY TO BE ENERGIZED. ACTIVATION OF FLASH MODE SHALL BE DONE ON MONDAY, TUESDAY, WEDNESDAY, OR THURSDAY BETWEEN THE HOURS OF 9:00 AM - 11:00 AM. PLACE ALL NEW SIGNAL INSTALLATIONS (NO EXISTING SIGNALS) IN FLASH FOR A MINIMUM OF 72 HOURS NOT TO EXCEED 168 HOURS UNLESS EOR OR LEE COUNTY DOT TRAFFIC APPROVES IN WRITING. IF SIGNAL CANNOT GO INTO FULL OPERATION AFTER 168 HOURS THE SIGNAL MUST BE TURNED BACK OFF AND SIGNAL INDICATIONS COVERED.

16. FULL OPERATION: ONCE THE PRE FLASH REQUIREMENT HAS BEEN SATISFIED, THE INTERSECTION CAN BE PLACED INTO FULL OPERATION UNLESS PRIME CONTRACTOR OR LEE COUNTY DOT TRAFFIC STATES OTHERWISE IN WRITING. FULL OPERATION SHALL BE DONE ON TUESDAY, WEDNESDAY, OR THURSDAY BETWEEN THE HOURS OF 9:00 AM - 11:00 AM UNLESS FALLS ON A HOLIDAY OR SPECIAL EVENTS.

17. TRAFFIC SIGNAL & STREET LIGHTING INSPECTIONS:

A. ALL TRAFFIC SIGNAL & STREET LIGHTING INSPECTIONS MUST BE SCHEDULED VIA EMAIL AT LCDOTPROJECTS@LEEGOV.COM TWO WEEKS IN ADVANCE OF SCHEDULED PRE-FLASH ACTIVATION, FULL OPERATION, SOP CHANGE, FINAL INSPECTION, PUNCH LIST INSPECTIONS.

B. THE VENDOR SHALL CONFIGURE ALL VIDEO/RADAR DETECTION BEFORE THE FINAL INSPECTION TAKES PLACE, FAILURE TO DO SO WILL RESULT IN RESCHEDULING OF THE INSPECTION.

C. INTERSECTION SHALL BE TO FINAL CONFIGURATION PRIOR TO SCHEDULING FINAL INSPECTION.

D. CONTRACTOR IS REQUIRED TO BE PRESENT AND/OR HAVE AN AUTHORIZED REPRESENTATIVE ON ALL FORMAL INSPECTIONS. CONTRACTOR SHALL HAVE ALL NECESSARY EQUIPMENT TO COMPLETE THE INSPECTIONS ONSITE AT ALL SIGNAL AND LIGHTING INSPECTIONS. FAILURE TO HAVE A REPRESENTATIVE ONSITE WILL RESULT IN THE CANCELLATION OF THE INSPECTION AND THE WITHHOLDING OF FINAL PAYMENT. AUTHORIZED REPRESENTATIVE IS A PERSON WITH KNOWLEDGE AND ABILITY TO MAKE CORRECTIONS AS NEEDED. THIS IS A REQUIREMENT AND IS NECESSARY TO ELIMINATE COSTLY RE-INSPECTIONS AND TO SPEED UP THE CLOSE OUT OF THE PROJECT.

18. AS-BUILT DRAWINGS: WHEN CONSTRUCTION IS COMPLETE, AS A CONDITION PRECEDENT TO FINAL ACCEPTANCE, PROVIDE SIGNED AND SEALED AS-BUILT DRAWINGS, EITHER BY A STATE OF FLORIDA LICENSED PROFESSIONAL ENGINEER OR A PROFESSIONAL SURVEYOR AND MAPPER CONTRACTOR SHALL PROVIDE A SET OF "AS-BUILT" PLANS IN ELECTRONIC FORM (PDF) TO: LCDOTPROJECTS@LEEGOV.COM

19. WARRANTY: CONTRACTOR'S RESPONSIBILITY FOR WARRANTY REPAIRS, WARRANTY REPLACEMENT, TROUBLESHOOTING, OR OTHER COSTS ASSOCIATED WITH REPAIR OR REPLACEMENT OF TRAFFIC CONTROL SIGNALS AND DEVICES WITHIN THE CONTRACT'S PROJECT LIMITS WILL TERMINATE 90 DAYS AFTER FINAL ACCEPTANCE.

20. DRILL SHAFT: MAST ARM DRILL SHAFT INSPECTIONS ARE REQUIRED BEFORE CONCRETE PLACEMENT. PLEASE REFER TO THE MOST CURRENT FDOT STANDARD SPECIFICATIONS FOR DRILLED SHAFT INSTALLATION, WHICH REQUIRE AN FDOT CERTIFIED DRILLED INSPECTOR TO BE ONSITE DURING THE ENTIRE PROCESS. USE CASING WHEN NECESSARY TO ENSURE SHAFT INTEGRITY. CONCRETE STRAIN POLE EXCAVATIONS WILL ALSO REQUIRE INSPECTION. WHEN USING THE "WETHOLE" METHOD, THE CONCRETE SHALL BE PLACED FROM THE BOTTOM UP, USING EITHER A CONCRETE PUMP OR TREMIE TUBE METHOD OR AS SPECIFIED IN THE PLANS BY THE EOR. NO FREE FALLING CONCRETE SHALL BE ALLOWED. ALL FDOT GUIDELINES FOR CONCRETE QA/QL SHALL BE ADHERED TO. TWENTY-FOUR (24) HOURS' NOTICE IS REQUIRED TO THE INSPECTOR SHOWN IN THE PLAN SET GENERAL NOTES. SHOULD THE INFORMATION BE MISSING, THE CONTRACTOR IS HEREBY DIRECTED TO CALL LEE COUNTY SIGNALS AT 239-533-9500 AND ASK FOR THE SIGNAL INSPECTION DEPARTMENT.

21. WHERE MAST ARM, STRAIN POLES, OR ANY OTHER SIGNAL EQUIPMENT REQUIRING FOUNDATIONS ARE PROPOSED WITHIN 4 FEET OF ANY UNDERGROUND UTILITY, THE UTILITY SHALL BE LOCATED AND PROTECTED. THE INITIAL 5 FEET OF THE SHAFT INSTALLATION SHALL BE EXPOSED USING NON MECHANIZED EQUIPMENT.

22. COAT ALL THREADED HARDWARE AND MECHANICAL/ELECTRICAL CONNECTION TERMINATIONS WITH AN OXIDE INHIBITOR.

23. WEATHERPROOF IRREGULAR MATTING SURFACES SUCH AS AREAS INCLUDING SEPARATED SIGNAL COUPLINGS, CONTROLLER CABINET FOUNDATION, PEDESTRIAN PUSH BUTTONS, AND ANY OTHER AREAS TYPICALLY PRONE TO MOISTURE INFILTRATION BY APPLYING A BEAD OF SILICONE CAULK.

24. WHEREVER A CABLE ENTERS OR EXITS A FIELD-DRILLER HOLE, THE HOLE SHALL BE PROTECTED BY A PERMANENTLY INSTALLED RUBBER GROMMET.

25. PAVEMENT MARKINGS ARE SHOWN FOR REFERENCE PURPOSES ONLY. FOR PAVEMENT MARKING DESIGN INFORMATION, SEE PAVEMENT MARKING PLANS.

26. AT LEAST TWO (2) FULL BUSINESS DAYS PRIOR TO BEGINNING THE TRAFFIC SIGNAL INSTALLATION, CONTACT THE TRAFFIC SIGNAL INSPECTOR/LIAISON:

DAVID AYERS

FLORIDA DEPARTMENT OF TRANSPORTATION

FORT MYERS OPERATIONS CENTER

2981 N. E. PINE ISLAND ROAD

CAPE CORAL, FLORIDA 33909

(239) 985-7858

27. AT THE COMPLETION OF THE PROJECT, PROVIDE "AS-BUILT" PLANS IN ELECTRONIC FORM (PDF) TO:

FDOT TRAFFIC OPERATIONS

NEAL TURNER, P.E., TSM&O ENGINEER - ARTERIALS

801 N. BROADWAY AVE

P.O. BOX 1249

BARTOW, FL 33830-1249

EMAIL: NEAL.TURNER@DOT.STATE.FL.US

PHONE: 863-519-2216

28. THE LOCATION(S) OF THE UTILITIES SHOWN IN THE PLANS (INCLUDING THOSE DESIGNATED Vv Vh AND Vvh) ARE BASED ON LIMITED INVESTIGATION TECHNIQUES AND SHOULD BE CONSIDERED APPROXIMATE ONLY. THE VERIFIED LOCATION/ELEVATIONS APPLY ONLY AT THE POINTS SHOWN. INTERPOLATIONS BETWEEN POINTS HAVE NOT BEEN VERIFIED.

29. THE MAST ARM HARDWARE SHALL BE HOT DIP GALVANIZED. HARDWARE SUCH AS HANDHOLE COVERS SHALL BE STAINLESS STEEL. THE HAND HOLE AT THE BASE OF THE POLE SHALL BE 5" X 24".

30. SIGNALS SHALL FLASH A MINIMUM OF 48 HOURS BEFORE BEING PLACED IN FULL OPERATION ON A MONDAY, TUESDAY, OR WEDNESDAY. HOWEVER, THE FLASHING OPERATION SHALL NOT START ON THE DAY PRECEDING OR SUCCEEDING A HOLIDAY.

31. THE CONTRACTOR SHALL BE AWARE THAT NO TEST BORINGS WERE MADE WHERE CONDUIT IS TO BE INSTALLED. THE CONTRACTOR SHALL BE RESPONSIBLE FOR EXAMINING THE JOB SITE CONDITIONS BEFORE SUBMITTING BID PROPOSALS IN ACCORDANCE WITH SECTION 2-4 OF THE STANDARD SPECIFICATIONS.

32. INSURANCE, AS REFERENCED IN SECTIONS 7-13.3 IN THE FDOT STANDARD SPECIFICATIONS FOR ROADWAY AND BRIDGE CONSTRUCTION (2018), SHALL BE PROVIDED BY THE CONTRACTOR WHEN INSTALLING OR WHEN WORKING ON OR IN THE VICINITY OF JOINT-USE POLES OR WHEN WORKING IN THE VICINITY OF POWER LINES.

33. WHEN PERFORMING NECESSARY WORK UNDER POWER LINE SUCH AS THE INSTALLATION OF SIGNAL CABLE, AND SIGNAL POLES, THE CONTRACTOR SHALL NOTIFY THE POWER COMPANY AT LEAST 72 HOURS PRIOR TO INSTALLATION OF THIS EQUIPMENT.

34. THE CONTRACTOR SHALL NOTIFY ALL UTILITIES AT LEAST 48 HOURS IN ADVANCE OF THE ACTUAL BEGINNING OF UNDERGROUND CONSTRUCTION. ALL UTILITY CONFLICTS SHALL BE RESOLVED PRIOR TO THE SETTING OF THE SIGNAL POLES OR THE LAYING OF CONDUIT. THE CONTRACTOR SHALL BE RESPONSIBLE FOR LAYING NEW FOUNDATION WITHOUT OBSTRUCTING THE EXISTING UTILITIES. IF ANY UTILITIES ARE ENCOUNTERED, THE CONTRACTOR SHALL PROVIDE WORKABLE UTILITY ALTERNATIVES AT LOCATIONS WHERE UNDERGROUND UTILITIES ARE IN CLOSE PROXIMITY TO THE SIGNAL POLE FOUNDATION OR CONDUIT RUN, AS DETERMINED BY THE ENGINEER. THE CONTRACTOR SHALL HAND DIG THE FIRST 48 INCHES OF THE HOLE FOR THE POLE FOUNDATION OR CONDUIT RUN.

35. WHEN A CONTRACTOR IS WORKING ON SIGNAL (AT AN INTERSECTION) TURNING ON/OFF TEMPORARY SIGNALIZATION EQUIPMENT, INSTALLING CONDUIT IN THE STREET, INSTALLING NEW SIGNAL EQUIPMENT, AND NEW TURNING ON/OFF SIGNAL, WHERE A LANE IS CLOSED, AN OFF-DUTY LAW ENFORCEMENT OFFICER SHALL BE UTILIZED TO DIRECT TRAFFIC. THE PAYMENT FOR AN OFF-DUTY LAW ENFORCEMENT OFFICER SHALL BE INCLUDED IN THE CONTRACT LUMP SUM PRICE FOR SIGNAL INSTALLATION.

36. THE CONTRACTOR SHALL NOT ORDER THE MAST ARM POLES UNTIL FIELD VERIFICATION OF EACH FOUNDATION HAS BEEN PERFORMED. THE CONTRACTOR SHALL INCLUDE WITHIN THE PRICE OF THE MAST ARM ASSEMBLY THE COST TO HAND DIG THE DIAMETER OF EACH FOUNDATION LOCATIONS TO A DEPTH OF 48" BELOW EXISTING GRADE TO FIELD VERIFY NO UNDERGROUND UTILITY CONFLICTS EXIST.

37. DO NOT REMOVE EXISTING STOP SIGNS UNTIL SIGNAL IS FULLY OPERATIONAL.

| REVISIONS |             |      |             | <div><div>JOHNSON</div><div>ENGINEERING</div><div>LEAH M. HOLMES • P.E. LICENSE NO. 85359</div><div>JOHNSON ENGINEERING, INC.</div><div>2122 JOHNSON STREET • FORT MYERS, FL 33901</div><div>CERTIFICATE OF AUTHORIZATION NO. 642</div></div> | LEE COUNTY PUBLIC WORKS<br>DEPARTMENT OF TRANSPORTATION |        |                | GENERAL NOTES | SHEET NO. |
|-----------|-------------|------|-------------|---|---|--------|----------------|---------------|-----------|
| DATE      | DESCRIPTION | DATE | DESCRIPTION |   | ROAD NO.  | COUNTY | JEI PROJECT ID |               | T-4       |
|           |             |      |             |   |   | LEE    | 20214267-000   |               |           |
|           |             |      |             |   |   |        |                |               |           |

THE OFFICIAL RECORD OF THIS SHEET IS THE ELECTRONIC FILE DIGITALLY SIGNED AND SEALED UNDER RULE 61G15-23.004, F.A.C.

9/5/2024 9:44:12 AM U:\Projects\20214267-000\signals\GNNTSG01.DGN

jaw

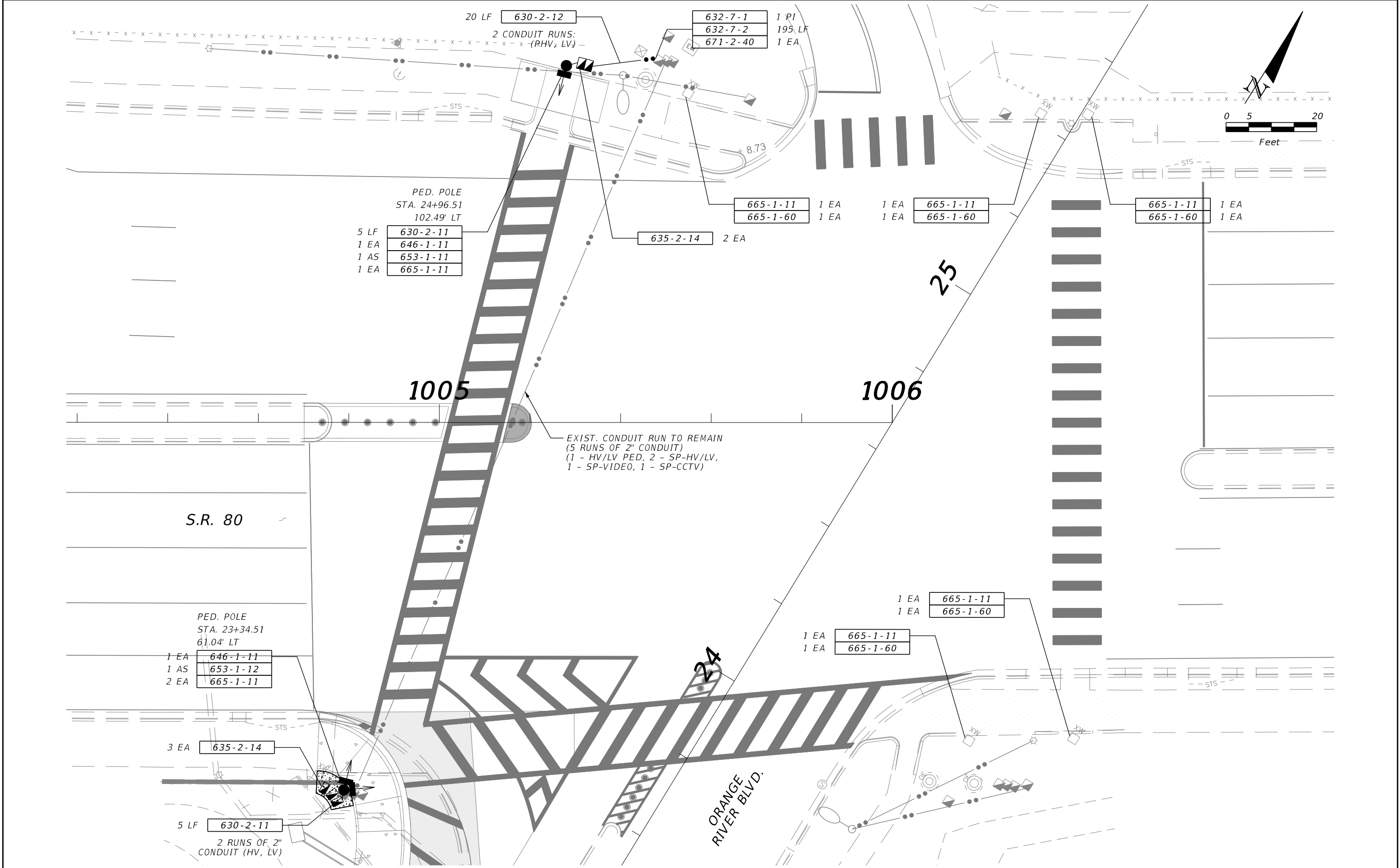

| REVISIONS |             |      |             | <div>JOHNSON<br/>ENGINEERING<br/><small>LEAH M. HOLMES • P.E. LICENSE NO. 85359<br/>JOHNSON ENGINEERING, INC.<br/>2122 JOHNSON STREET • FORT MYERS, FL 33901<br/>CERTIFICATE OF AUTHORIZATION NO. 642</small></div> | LEE COUNTY PUBLIC WORKS<br>DEPARTMENT OF TRANSPORTATION |        |                | ORANGE RIVER BLVD. & S.R. 80<br>PEDESTRIAN IMPROVEMENTS |  | SHEET NO. |  |
|-----------|-------------|------|-------------|---|---|--------|----------------|---|--|-----------|--|
| DATE      | DESCRIPTION | DATE | DESCRIPTION |   | ROAD NO.  | COUNTY | JEI PROJECT ID |   |  | T-5       |  |
|           |             |      |             |   |   | LEE    | 20214267-000   |   |  |           |  |

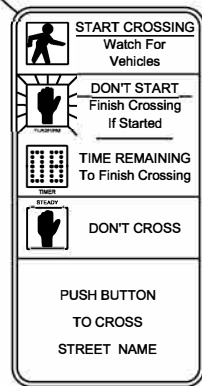

FTP-68B-06

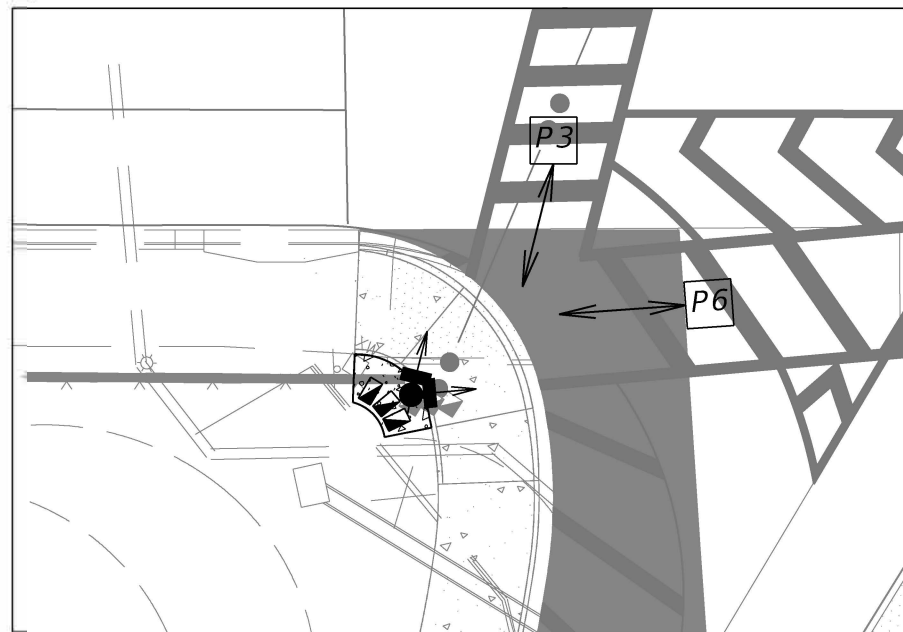

SOUTH WEST QUADRANT  
ORANGE RIVER BLVD. AT S.R. 80  
PEDESTRIAN SIGNAL DETAIL

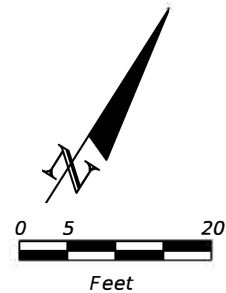

SCALE AND ORIENTATION "NORTH"  
CONSISTENT FOR ALL DETAILS.

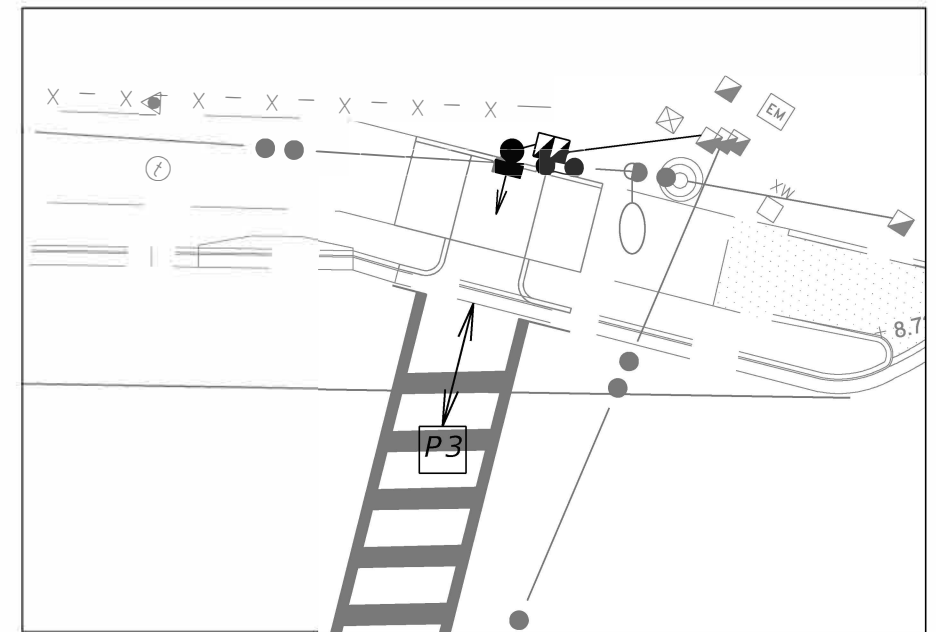

NORTH WEST QUADRANT  
ORANGE RIVER BLVD. AT S.R. 80  
PEDESTRIAN SIGNAL DETAIL

## PEDESTRIAN SYMBOLS



PEDESTRIAN SIGNAL ON  
PEDESTAL WITH BUTTON

\* DENOTES NEW CONTROLLER TIMINGS PROVIDED BY LEE COUNTY. OTHER TIMINGS ARE EXISTING.

| CONTROLLER TIMINGS (SECONDS) |      |      |      |      |      |      |   |   |
|------------------------------|------|------|------|------|------|------|---|---|
| MOVEMENT #                   | 1    | 2    | 3    | 4    | 5    | 6    | 7 | 8 |
| DIRECTION                    | EBLT | WB   | SB   | NB   | WBLT | EB   |   |   |
| TURN TYPE                    |      |      |      |      |      |      |   |   |
| MIN GREEN                    | 5    | 15   | 5    | 7    | 5    | 15   |   |   |
| EXT                          | 3.0  | 5.0  | 3.0  | 3.0  | 3.0  | 5.0  |   |   |
| YELLOW                       | 4.9  | 4.9  | 4.0  | 4.9  | 4.9  | 4.9  |   |   |
| ALL RED                      | 4.7  | 2.0  | 2.9  | 3.1  | 2.1  | 2.0  |   |   |
| MAX I                        | 15.0 | 50.0 | 10.0 | 15.0 | 15.0 | 50.0 |   |   |
| MAX II                       |      |      |      |      |      |      |   |   |
| WALK                         |      | 7    | 10*  | 7    |      | 7*   |   |   |
| FLASHING DON'T WALK          |      | 13   | 37*  | 32   |      | 33*  |   |   |
| DETECTOR MEMORY              |      |      |      |      |      |      |   |   |
| DET. CROSS SWITCH            |      |      |      |      |      |      |   |   |
| DUAL ENTRY                   |      |      |      |      |      |      |   |   |
| VEHICLE RECALL               |      |      |      |      |      |      |   |   |

## CONTROLLER OPERATION

MAJOR STREET IS S.R. 80  
MINOR STREET IS ORANGE RIVER BLVD.

CONTROLLER TO OPERATE AS INDICATED IN THE FLASH MODE:  
S.R. 80 (2 & 6) SHALL FLASH YELLOW AND ALL OTHER  
MOVEMENTS SHALL FLASH RED

S.R. 80 POSTED SPEED = 45 MPH  
ORANGE RIVER BLVD. SPEED = 35 MPH

NOTES:

REQUEST UPDATED SIGNAL TIMINGS FROM LEE COUNTY WHEN ALL LANES, STRIPING, SIGNALS AND PEDESTRIAN FACILITIES ARE IN THEIR FINAL CONFIGURATION AND THE SIGNAL IS OPERATING AS DESIGNED. PROVIDE LEE COUNTY WITH ALL 'AS-BUILT' INFORMATION NECESSARY TO DEVELOP THE BASIC SIGNAL TIMING PARAMETERS AND ALLOW THREE (3) WEEKS FOLLOWING THE REQUEST FOR LEE COUNTY TO DEVELOP THE UPDATED TIMINGS. PROGRAM THE CONTROLLER PER THE TIMINGS PROVIDED BY LEE COUNTY.

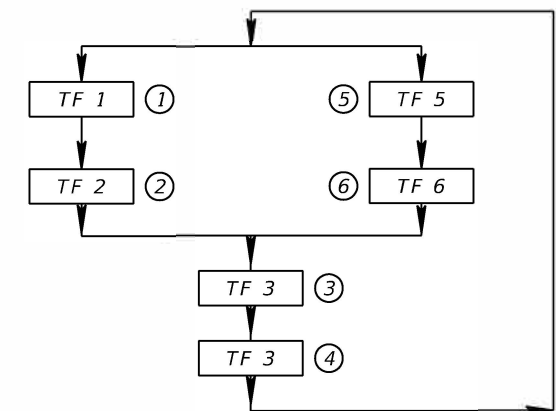
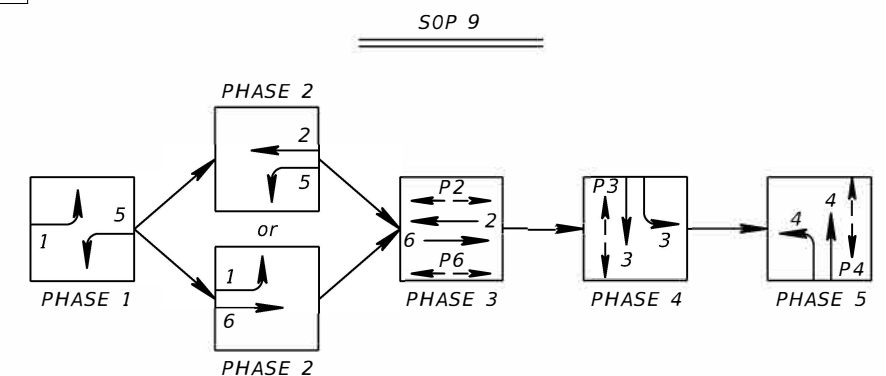

| REVISIONS |             |      |             | <div><div><div>JOHNSON</div><div>ENGINEERING</div></div><div>LEAH M. HOLMES • P.E. LICENSE NO. 85359<br/>JOHNSON ENGINEERING, INC.<br/>2122 JOHNSON STREET • FORT MYERS, FL 33901<br/>CERTIFICATE OF AUTHORIZATION NO. 642</div></div> | <div>LEE COUNTY PUBLIC WORKS<br/>DEPARTMENT OF TRANSPORTATION</div> |        |                | <div>PEDESTRIAN SIGNAL</div> |     | SHEET NO. |
|-----------|-------------|------|-------------|--|---|--------|----------------|------------------------------|-----|-----------|
| DATE      | DESCRIPTION | DATE | DESCRIPTION |  | ROAD NO.  | COUNTY | JEI PROJECT ID | <div>DETAIL</div>            | T-6 |           |
|           |             |      |             |  |   | LEE    | 20214267-000   |                              |     |           |
|           |             |      |             |  |   |        |                |                              |     |           |

THE OFFICIAL RECORD OF THIS SHEET IS THE ELECTRONIC FILE DIGITALLY SIGNED AND SEALED UNDER RULE 61G15-23.004, F.A.C.