

LEE COUNTY BOARD OF COUNTY COMMISSIONERS

Public Works Administration Department of Transportation Map Locations of Proposed **LEHIGH ACRES RESURFACING ROADWAY IMPROVEMENT**

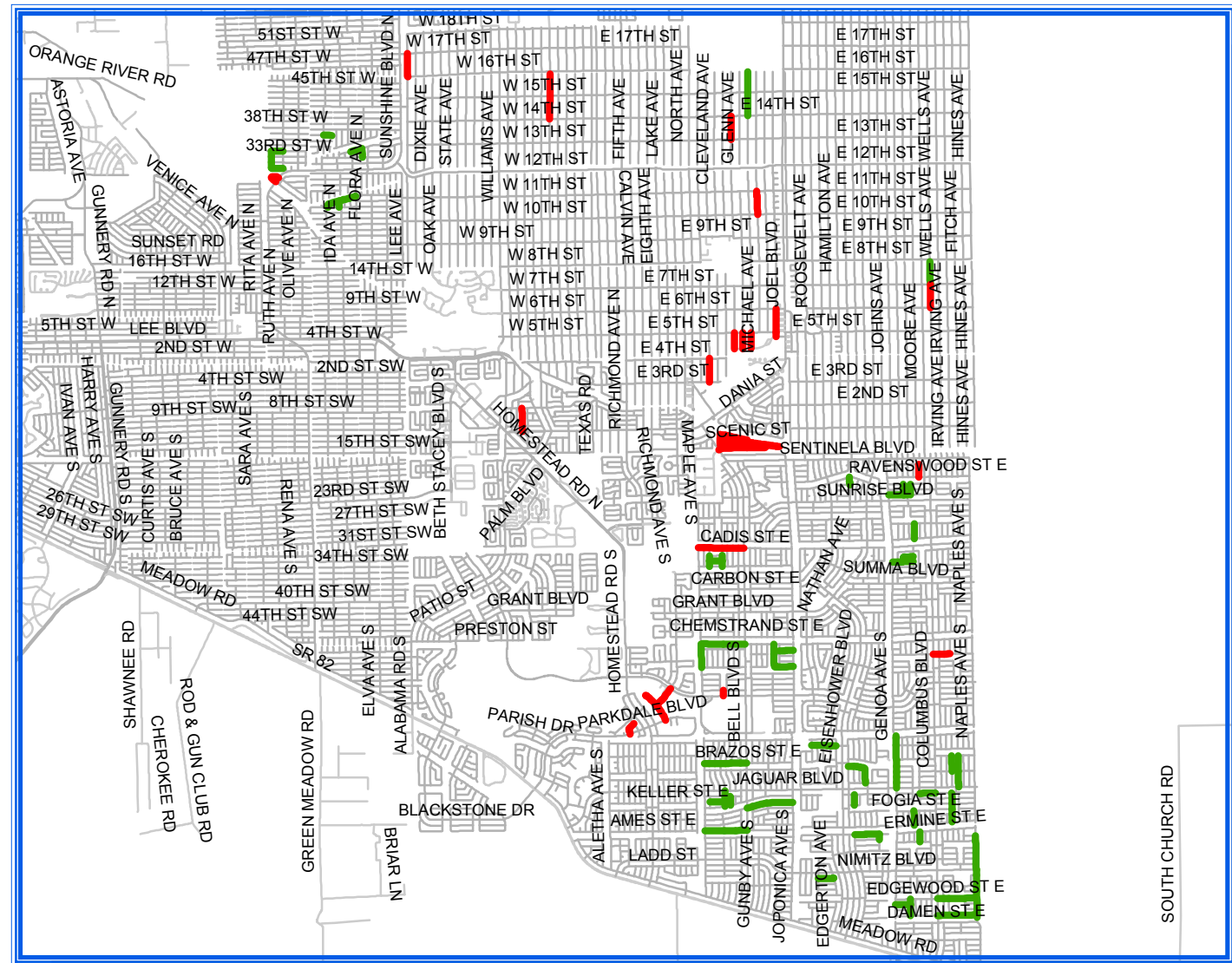

MILL AND OVERLAY

#	STREET	FROM	TO	LENGTH	WIDTH
1	NANCY CT	SUNSHINE BLVD N	SUNSHINE BLVD N	782	18
2	LEE AVE	W 16TH ST	W 17TH ST	1290	20
3	PROSPECT AVE	EOP	W 14TH ST	2540	18
4	DAYTON AVE	GOLFSIDE VILLAGE DR	E 5TH ST	891	18
5	MICHAEL AVE	E 11TH ST	E 10TH ST	1303	18
6	GERALD AVE	E 6TH ST	E 5TH ST	1570	18
7	DAYTON AVE	E 14TH ST	E 13TH ST	1303	18
8	GLENN AVE	GOLFSIDE VILLAGE DR	E 5TH ST	889	18
9	SHELDON AVE	GOLFSIDE VILLAGE DR	E 5TH ST	891	18
10	LOUIS AVE	E 7TH ST	E 6TH ST	1302	18
11	WASHINGTON AVE	E 4TH ST	E 3RD ST	1321	18
12	IDAHO RD	COOLIDGE AV	LEELAND HGTS BLVD W	1300	18
13	FORD CT	FORD CIR	EOP	119	18
14	FORD CIR	SCENIC ST	SCENIC ST	2340	18
15	SCENIC ST	BELL BLVD N	EOP	3500	20
16	GRAHAM CIR	SCENIC ST	SCENIC ST	2550	18
17	KINGSTON ST	GRAHAM CIR	FORD CIR	302	18
18	HAMPTON AVE	FORD CIR	SCENIC ST	563	18
19	IRWIN AVE	FORD CIR	SCENIC ST	356	18
20	JONQUIL AVE	FORD CIR	SCENIC ST	279	18
21	CADIS ST E	LABREE AV S	BELL BLVD S	2540	18
22	NAVARRA AVE S	RACHEL ST E	RAVENSWOOD ST E	710	18
23	AMHERST ST E	COLUMBUS BLVD	ENSLEY AV S	930	18
24	DAVID LAIRD LN	LONG LINES LN	MILWAUKEE BLVD	315	18
25	CHARWOOD AVE S	MILWAUKEE BLVD	MIRROR LAKES CT	1220	18
26	MIRROR LAKES CT	EOP	PARKDALE BLVD	1820	18
27	DURION DR	PARKDALE BLVD	DUBARRY AV S	686	18

OVERLAY

#	STREET	FROM	TO	LENGTH	WIDTH
1	31ST ST W	TERRY AVE N	RUTH AV N	651	18
2	TERRY AVE N	31ST ST W	34TH ST W	939	18
3	34TH ST W	TERRY AVE N	RUTH AV N	648	18
4	37TH ST W	EOP	JOAN AV N	467	18
5	HELEN PL	HANNA AV N	IDA AV N	335	18
6	GENE AVE N	HELEN PL	34TH ST W	505	18
7	28TH ST W	26TH ST W	HANNA AV N	1776	20
8	IDA CT	28TH ST W	26TH ST W	331	18
9	SHELDON AVE	E 14TH ST	EOP	2438	18
10	LOUIS AVE	E 7TH ST	EOP	1244	18
11	CLEMSON AVE S	BABE ST E	ANDERSON ST E	430	18
12	NAOMI AVE S	RAMBLER ST E	RADIANCE ST E	583	18
13	NAGEL AVE S	RAMBLER ST E	RADIANCE ST E	592	18
14	RAMBLER ST E	GENOA AV S	NARD AV S	1070	18
15	NAPPER AVE S	RANDLETREE ST E	RANDOLPH ST E	841	18
16	CORA CIR E	CORAL BELLS ST E	LOWNDE AV S	796	18
17	CORAL BELLS ST E	GENOA AV S	LOWNDE AV S	1171	18
18	LAROSE AVE	CALUMET ST E	CAHN ST E	602	18
19	CAIRO ST	LARUA AV S	LAROSE AV S	709	18
20	LARUA AVE S	CALUMET ST E	CAHN ST E	600	18
21	EMPIRE AVE S	MANHATTAN ST E	THEODORE VAIL ST E	1326	18
22	THEODORE VAIL ST E	EMPIRE AV S	BELL BLVD S	2457	18
23	LONE STAR LN	THEODORE VAIL ST E	HAWTHORNE AV S	2322	18
24	JASPER KELLER ST E	CABLE AV S	HAWTHORNE AV S	775	18
25	BRAZOS ST E	ANACONDA AV S	BELL BLVD S	900	18
26	LOPEZ ST E	BAJO AV S	BAHAMA AV S	824	18
27	BAHAMA AVE S	LAMAR ST E	JAGUAR BLVD	887	18
28	BOYD AVE S	MANUEL ST E	LAMAR ST E	508	18
29	NEWELL ST E	BELL BLVD S	JOPONICA AV S	2593	18
30	FOXTAIL ST E	ANACONDA AV S	BELL BLVD S	2348	18
31	ALCUTT ST	BEDFORD POINT AV	BEDFORD DR	1354	18
32	LANGFORD ST	AINSWORTH ST E	HOLMES AV	1749	18
33	AIKEN AVE	APPLETON AV	DANFORTH ST	588	18
34	PLANTATION RD	CAPTOWN AV	SUMAC AV	1367	18
35	SUMAC AVE	PLANTATION RD	CRESTHAVEN ST	309	18
36	FILBERT ST	CHADWICK ST	ELGIN ST	875	18
37	GENOA AVE S	JAGUAR BLVD	EOP	2932	18
38	MILANO AVE S	JAGUAR BLVD	BARI ST E	1754	18
39	APRILE AVE S	BARI ST E	VENETIA ST E	871	18
40	APRILE AVE S	FONTANA ST E	CELLINI ST E	1636	18
41	CELLINI ST E	SANTA LUCIA AV S	COLUMBUS BLVD	897	18
42	PUCCINI AVE S	FOGIA ST E	FONTANA ST E	781	18
43	MARGARET AVE S	ERMINE ST E	ESTATE ST E	565	18
44	NAPLES AVE S	EOP	ELLIPSE ST E	4561	18
45	ELEGANS ST E	GENOA AV S	MARINE AV S	824	18
46	MARINE AVE S	EDELWEISS ST E	EDGEWOOD ST E	932	18
47	EDELWEISS ST E	COLUMBUS BLVD	NAPLES AV S	2188	18
48	EDGEWOOD ST E	COLUMBUS BLVD	NAPLES AV S	2185	18

Location Map

LEE COUNTY, FLORIDA

March 17, 2023



INDEX

- 1..... Coversheet
- 2..... Typical & Notes
- 3-7 Lehigh Acres

1FY2023A

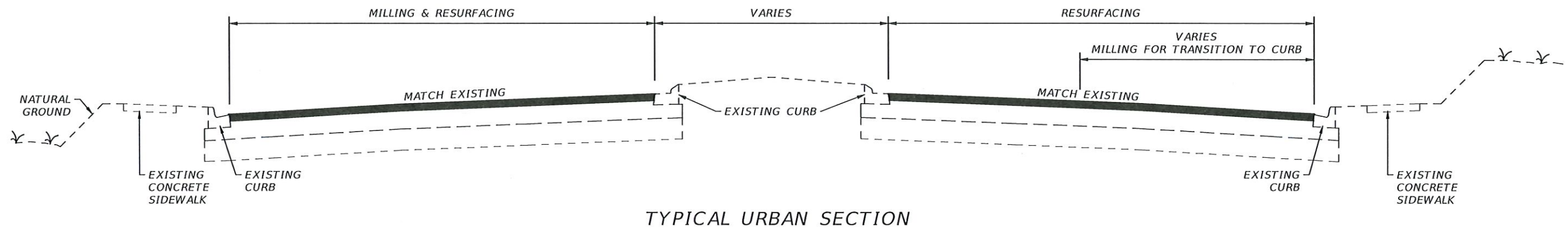
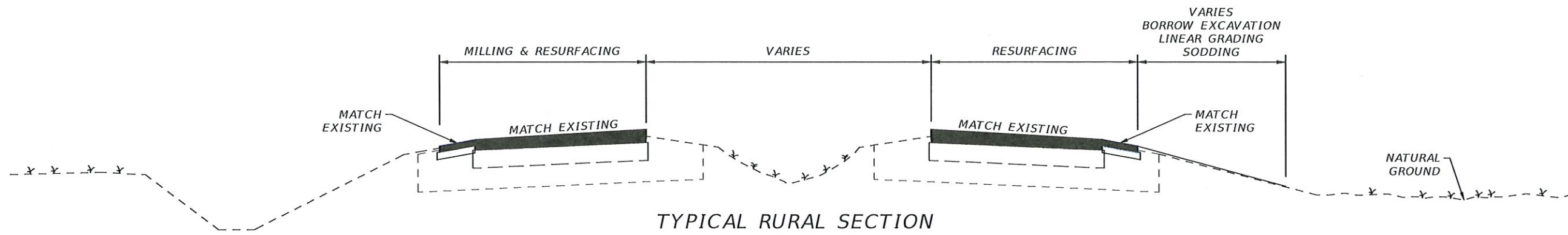

MILLING & RESURFACING NOTES

1. Scheduling of all work is subject to the prior approval of the Engineer, The Contractor's attention is directed to the highly seasonal nature of traffic volumes and the Engineer's application of discretion to minimize disruption during high volume times.
2. Where connecting to an existing driveway is necessary, a smooth transition to edge of pavement shall be established to the satisfaction of the Engineer. No feathered joints.
3. The Contractor shall protect private property. Any damage caused by the Contractor in the performance of this work shall be corrected to the satisfaction of the Engineer and property owner at the Contractor's expense. No direct payment will be made.
4. Any damage to state, county, or local roads caused by the Contractor's hauling activities shall be repaired by The Contractor to the satisfaction of the Engineer at the Contractor's expense, no direct payment will be made.
5. Texas swale locations and elevations will be established and laid out by the County. The Contractor is responsible for all other stakeout of the project and establishment of any necessary lines, grades, slope stakes, utility locations or any other stakeout necessary to complete the work. The cost of staking shall be subsidiary to other items of work, no direct payment will be made.
6. The State of Florida does not require a project specific National Pollutant Discharge Elimination System (NPDES) permit for construction activities that disturb less than one acre of land. However, the Contractor is responsible for installation, maintenance, and removal of any necessary best management practices devices necessary to prevent sediment from leaving the project site. The cost of this work is subsidiary to other items, no direct payment will be made.
7. Exact limits of milling and resurfacing work within each specific segment will be established by the Engineer prior to commencement of work. No payment will be made for work outside the authorized limits of resurfacing.
8. Milling and/or resurfacing shall be performed such that the original cross-slopes of the roadway are maintained to the extent practical. Any deviations shall be subject to prior authorization of the Engineer.
9. Shoulders shall be restored to the satisfaction of the Engineer prior to Final Acceptance of the work.
10. Clean-up of the project shall be accomplished by the Contractor to the Satisfaction of the Engineer. Cleanup shall be subsidiary to other items of work, no direct payment will be made.
11. MOT to be in compliance with FDOT 102-600 series.

REVISIONS			
DATE	DESCRIPTION	DATE	DESCRIPTION



LEE COUNTY		
DEPARTMENT OF TRANSPORTATION		
ROAD NAME	COUNTY	PROJECT ID
	LEE	

TYPICAL SECTION

SHEET NO.
2

THE OFFICIAL RECORD OF THIS SHEET IS THE ELECTRONIC FILE DIGITALLY SIGNED AND SEALED UNDER RULE 61G15-23.004, F.A.C.

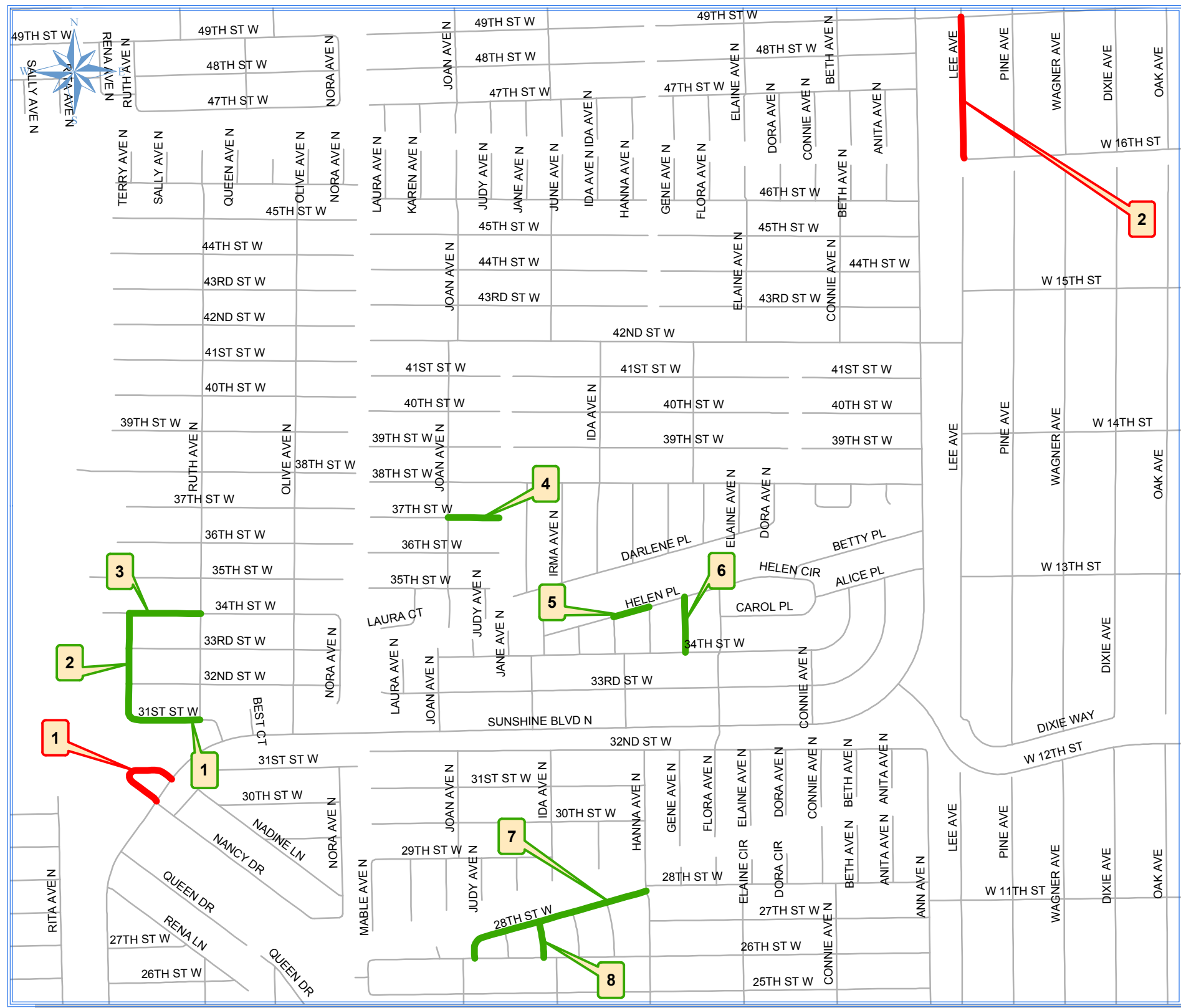

RESURFACING PROJECT LOCATION MAP

1 F Y 2 023A

LEHIGH ACRES LOCAL ROADS

MILL AND OVERLAY

#	STREET	FROM	TO	LENGTH	WIDTH
1	NANCY CT	SUNSHINE BLVD N	SUNSHINE BLVD N	782	18
2	LEE AVE	W 16TH ST	W 17TH ST	1290	20

OVERLAY

#	STREET	FROM	TO	LENGTH	WIDTH
1	31ST ST W	TERRY AVE N	RUTH AV N	651	18
2	TERRY AVE N	31ST ST W	34TH ST W	939	18
3	34TH ST W	TERRY AVE N	RUTH AV N	648	18
4	37TH ST W	EOP	JOAN AV N	467	18
5	HELEN PL	HANNA AV N	IDA AV N	335	18
6	GENE AVE N	HELEN PL	34TH ST W	505	18
7	28TH ST W	26TH ST W	HANNA AV N	1776	20
8	IDA CT	28TH ST W	26TH ST W	331	18

**Resurfacing Project
Location Map
Lehigh Acres Local Roads**



Lehigh Acres
Local Roads
1 F Y 2 023A

Public Works
Southwest
Florida
(239) 533-8900

Dept of Transportation
1500 Monroe St
Ft Myers, Florida, 33901

Drawn By: DRW

Checked By: FJL

Date: 3/17/2023

LEHIGH ACRES

Sheet 3 of 7

RESURFACING PROJECT LOCATION MAP 1 F Y 2 023A LEHIGH ACRES LOCAL ROADS

MILL AND OVERLAY

#	STREET	FROM	TO	LENGTH	WIDTH
3	PROSPECT AVE	EOP	W 14TH ST	2540	18
4	DAYTON AVE	GOLFSIDE VILLAGE DR	E 5TH ST	891	18
5	MICHAEL AVE	E 11TH ST	E 10TH ST	1303	18
6	GERALD AVE	E 6TH ST	E 5TH ST	1570	18
7	DAYTON AVE	E 14TH ST	E 13TH ST	1303	18
8	GLENN AVE	GOLFSIDE VILLAGE DR	E 5TH ST	889	18
9	SHELDON AVE	GOLFSIDE VILLAGE DR	E 5TH ST	891	18
10	LOUIS AVE	E 7TH ST	E 6TH ST	1302	18
11	WASHINGTON AVE	E 4TH ST	E 3RD ST	1321	18
12	IDAHO RD	COOLIDGE AV	LEELAND HGTS BLVD W	1300	18

OVERLAY

#	STREET	FROM	TO	LENGTH	WIDTH
9	SHELDON AVE	E 14TH ST	EOP	2438	18
10	LOUIS AVE	E 7TH ST	EOP	1244	18

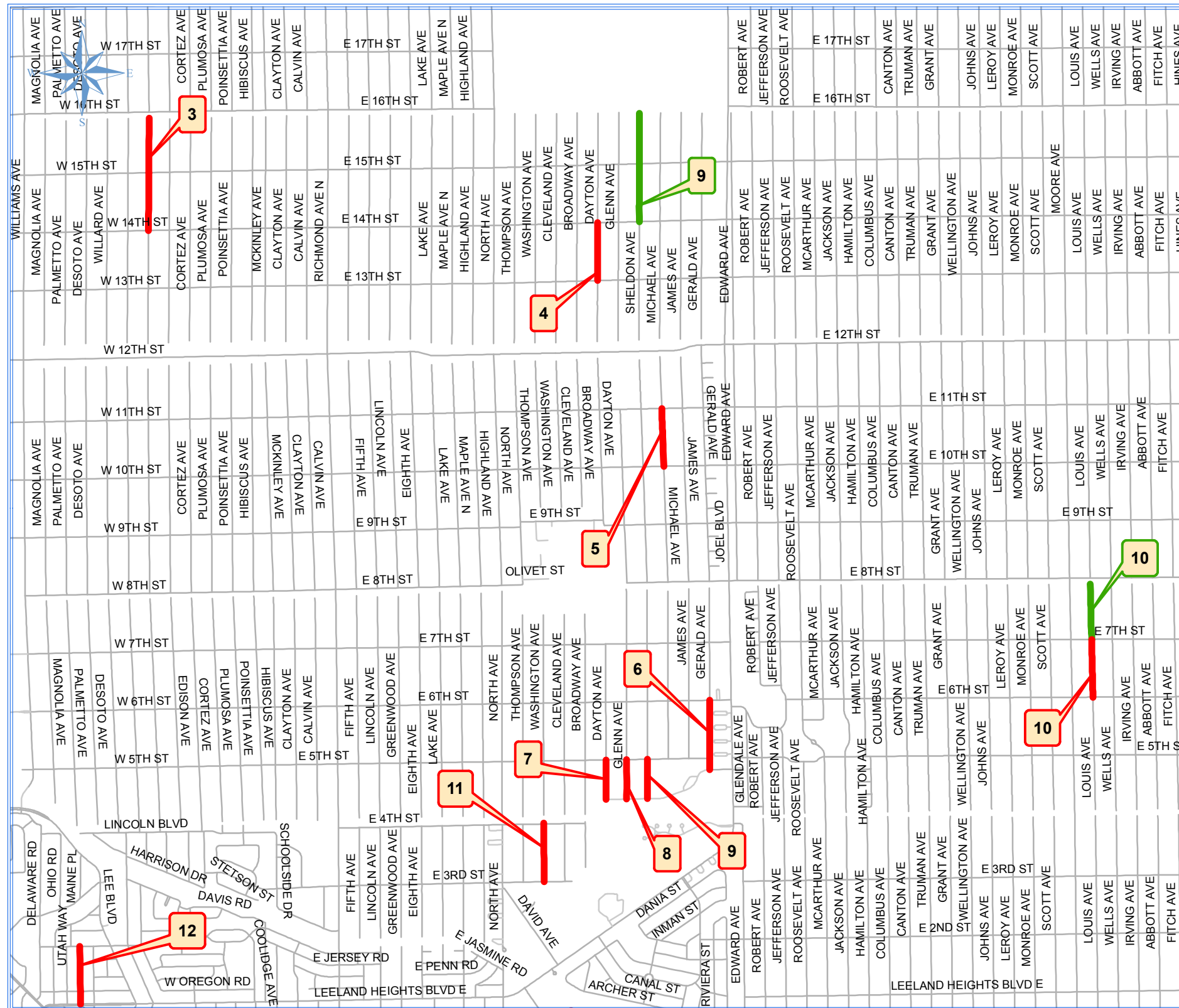

Resurfacing Project Location Map Lehigh Acres Local Roads



Lehigh Acres
Local Roads
1 F Y 2 023A

Public Works
Southwest
Florida
(239) 533-8900

Dept of Transportation
1500 Monroe St
Ft Myers, Florida, 33901

Drawn By: DRW

Checked By: FJL

Date: 3/17/2023

LEHIGH ACRES

Sheet 4 of 7

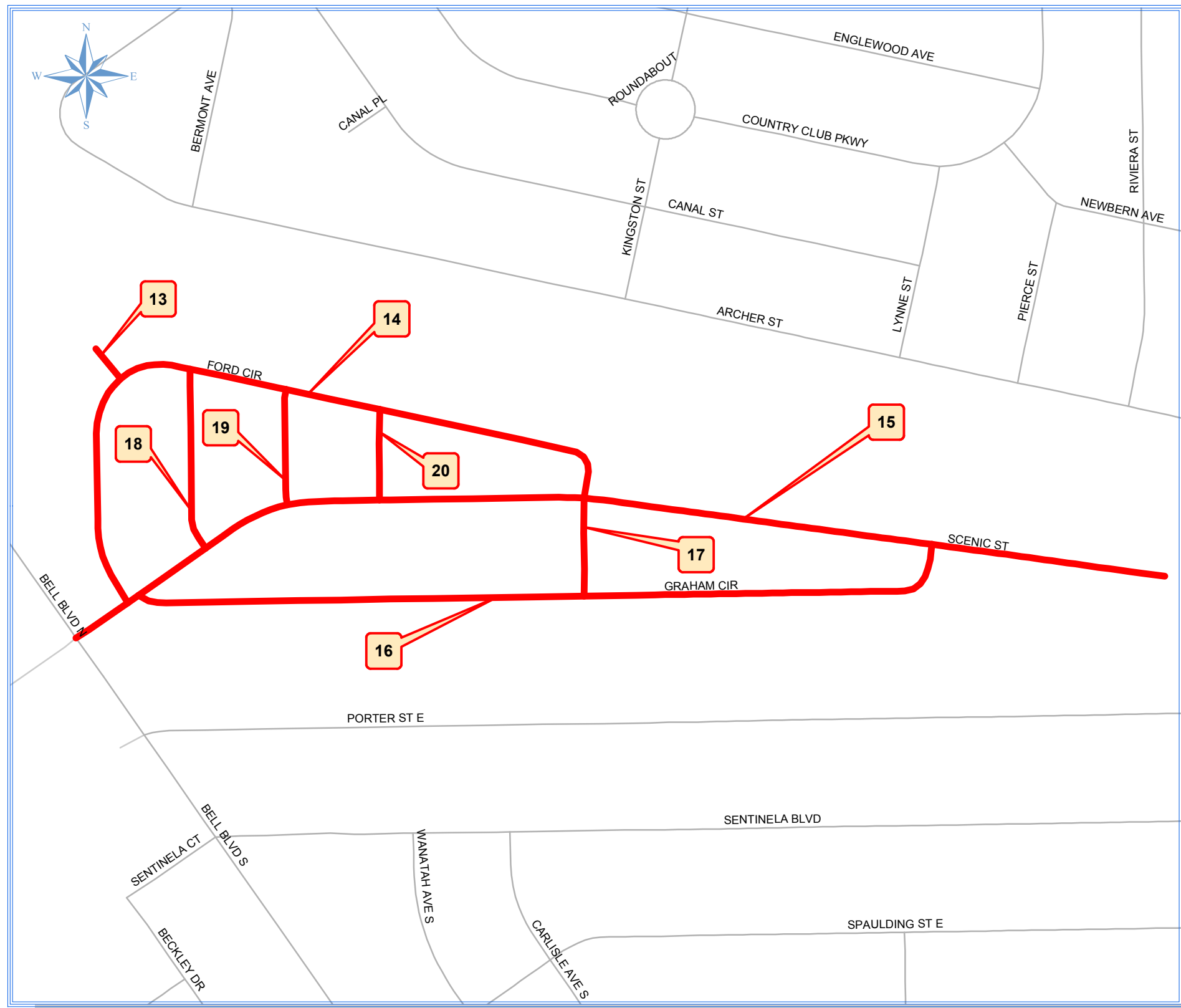

RESURFACING PROJECT LOCATION MAP

1 F Y 2 023A

LEHIGH ACRES LOCAL ROADS

MILL AND OVERLAY

#	STREET	FROM	TO	LENGTH	WIDTH
13	FORD CT	FORD CIR	EOP	119	18
14	FORD CIR	SCENIC ST	SCENIC ST	2340	18
15	SCENIC ST	BELL BLVD N	EOP	3500	20
16	GRAHAM CIR	SCENIC ST	SCENIC ST	2550	18
17	KINGSTON ST	GRAHAM CIR	FORD CIR	302	18
18	HAMPTON AVE	FORD CIR	SCENIC ST	563	18
19	IRWIN AVE	FORD CIR	SCENIC ST	356	18
20	JONQUIL AVE	FORD CIR	SCENIC ST	279	18

**Resurfacing Project
Location Map
Lehigh Acres Local Roads**



Lehigh Acres
Local Roads
1 F Y 2 023A

Public Works
Southwest
Florida
(239) 533-8900

Dept of Transportation
1500 Monroe St
Ft Myers, Florida, 33901

Drawn By: DRW

Checked By: FJL

Date: 3/17/2023

LEHIGH ACRES

Sheet 5 of 7

RESURFACING PROJECT LOCATION MAP 1 F Y 2 023A LEHIGH ACRES LOCAL ROADS

MILL AND OVERLAY

#	STREET	FROM	TO	LENGTH	WIDTH
21	CADIS ST E	LABREE AV S	BELL BLVD S	2540	18
22	NAVARRA AVE S	RACHEL ST E	RAVENSWOOD ST E	710	18
23	AMHERST ST E	COLUMBUS BLVD	ENSLEY AV S	930	18
24	DAVID LAIRD LN	LONG LINES LN	MILWAUKEE BLVD	315	18
25	CHARWOOD AVE S	MILWAUKEE BLVD	MIRROR LAKES CT	1220	18
26	MIRROR LAKES CT	EOP	PARKDALE BLVD	1820	18

OVERLAY

#	STREET	FROM	TO	LENGTH	WIDTH
11	CLEMSON AVE S	BABE ST E	ANDERSON ST E	430	18
12	NAOMI AVE S	RAMBLER ST E	RADIANCE ST E	583	18
13	NAGEL AVE S	RAMBLER ST E	RADIANCE ST E	592	18
14	RAMBLER ST E	GENOA AV S	NARD AV S	1070	18
15	NAPPER AVE S	RANDLETREE ST E	RANDOLPH ST E	841	18
16	CORA CIR E	CORAL BELLS ST E	LOWNDE AV S	796	18
17	CORAL BELLS ST E	GENOA AV S	LOWNDE AV S	1171	18
18	LAROSE AVE	CALUMET ST E	CAHN ST E	602	18
19	CAIRO ST	LARUA AV S	LAROSE AV S	709	18
20	LARUA AVE S	CALUMET ST E	CAHN ST E	600	18
21	EMPIRE AVE S	MANHATTAN ST E	THEODORE VAIL ST E	1326	18
22	THEODORE VAIL ST E	EMPIRE AV S	BELL BLVD S	2457	18
23	LONE STAR LN	THEODORE VAIL ST E	HAWTHORNE AV S	2322	18
24	JASPER KELLER ST E	CABLE AV S	HAWTHORNE AV S	775	18

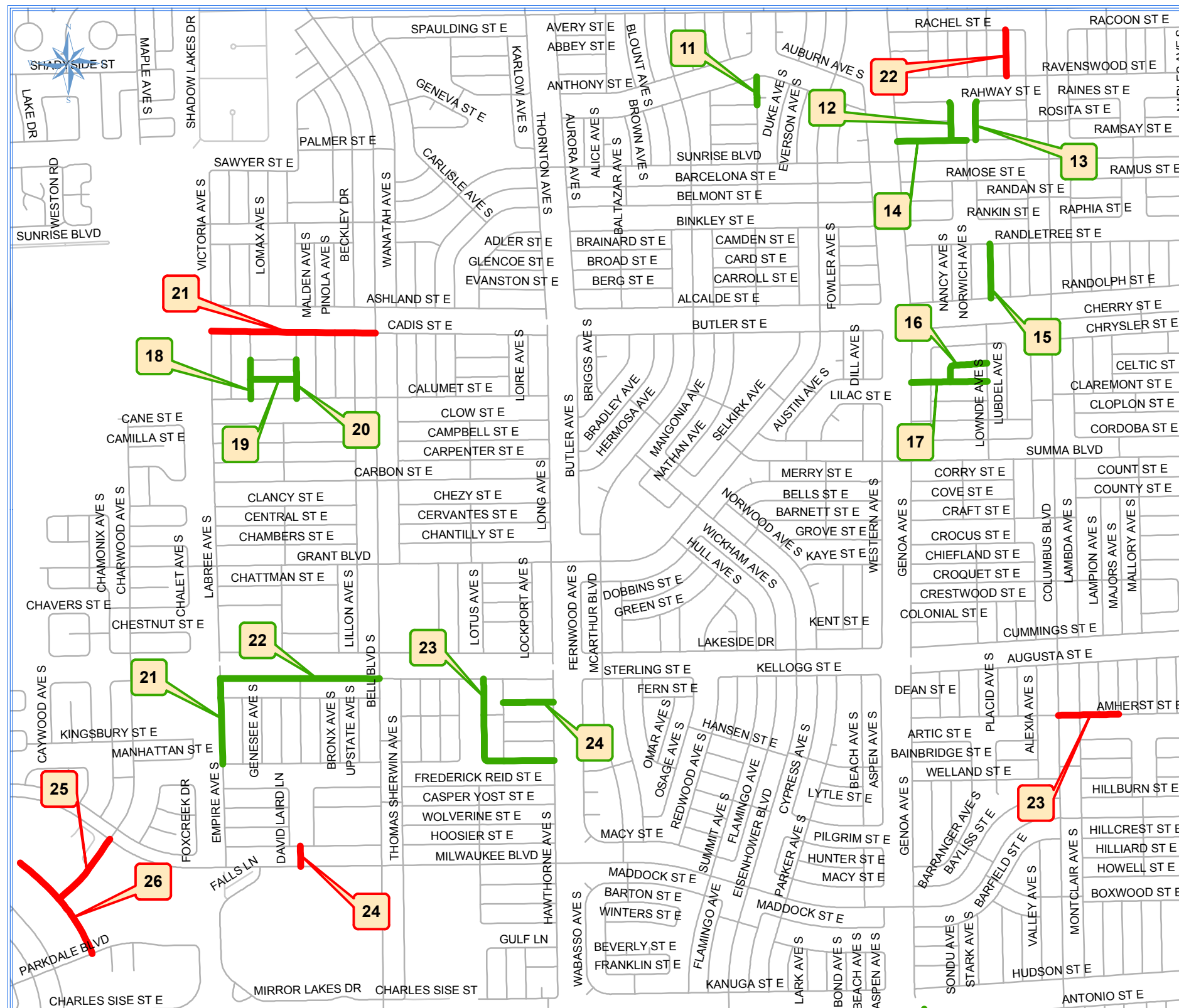

Resurfacing Project Location Map Lehigh Acres Local Roads



Lehigh Acres
Local Roads
1 F Y 2 023A

Public Works
Southwest
Florida
(239) 533-8900

Dept of Transportation
1500 Monroe St
Ft Myers, Florida, 33901

Drawn By: DRW

Checked By: FJL

Date: 3/17/2023

LEHIGH ACRES

Sheet 6 of 7

RESURFACING PROJECT LOCATION MAP

1 FY 2 023A

LEHIGH ACRES LOCAL ROADS

MILL AND OVERLAY

#	STREET	FROM	TO	LENGTH	WIDTH
27	DURION DR	PARKDALE BLVD	DUBARRY AV S	686	18

OVERLAY

#	STREET	FROM	TO	LENGTH	WIDTH
25	BRAZOS ST E	ANACONDA AV S	BELL BLVD S	900	18
26	LOPEZ ST E	BAJO AV S	BAHAMA AV S	824	18
27	BAHAMA AVE S	LAMAR ST E	JAGUAR BLVD	887	18
28	BOYD AVE S	MANUEL ST E	LAMAR ST E	508	18
29	NEWELL ST E	BELL BLVD S	JOPONICA AV S	2593	18
30	FOXTAIL ST E	ANACONDA AV S	BELL BLVD S	2348	18
31	ALCUTT ST	BEDFORD POINT AV	BEDFORD DR	1354	18
32	LANGFORD ST	AINSWORTH ST E	HOLMES AV	1749	18
33	AIKEN AVE	APPLETON AV	DANFORTH ST	588	18
34	PLANTATION RD	CAPETOWN AV	SUMAC AV	1367	18
35	SUMAC AVE	PLANTATION RD	CRESTHAVEN ST	309	18
36	FILBERT ST	CHADWICK ST	ELGIN ST	875	18
37	GENOA AVE S	JAGUAR BLVD	EOP	2932	18
38	MILANO AVE S	JAGUAR BLVD	BARI ST E	1754	18
39	APRILE AVE S	BARI ST E	VENETIA ST E	871	18
40	APRILE AVE S	FONTANA ST E	CELLINI ST E	1636	18
41	CELLINI ST E	SANTA LUCIA AV S	COLUMBUS BLVD	897	18
42	PUCCINI AVE S	FOGIA ST E	FONTANA ST E	781	18
43	MARGARET AVE S	ERMINE ST E	ESTATE ST E	565	18
44	NAPLES AVE S	EOP	ELLIPSE ST E	4561	18
45	ELEGANS ST E	GENOA AV S	MARINE AV S	824	18
46	MARINE AVE S	EDELWEISS ST E	EDGEWOOD ST E	932	18
47	EDELWEISS ST E	COLUMBUS BLVD	NAPLES AV S	2188	18
48	EDGEWOOD ST E	COLUMBUS BLVD	NAPLES AV S	2185	18

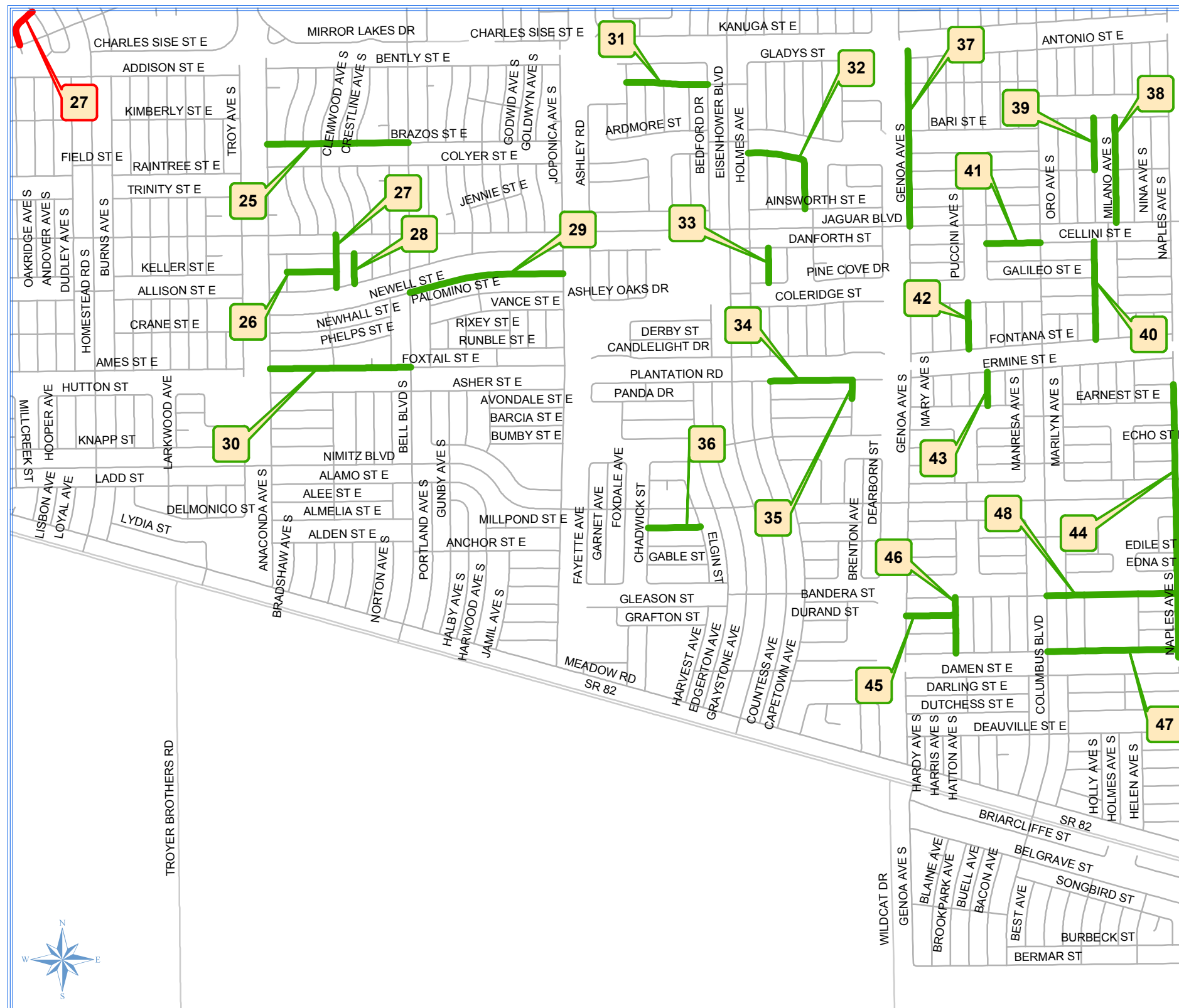

Resurfacing Project Location Map Lehigh Acres Local Roads



Lehigh Acres
Local Roads
1 FY 2 023A

Public Works
Southwest
Florida
(239) 533-8900

Dept of Transportation
1500 Monroe St
Ft Myers, Florida, 33901

Drawn By: DRW

Checked By: FJL

Date: 3/17/2023

LEHIGH ACRES

Sheet 7 of 7