

# SIGNING AND PAVEMENT MARKING PLANS

## THREE OAKS PARKWAY EXTENSION PHASE 1: FIDDLESTICKS CANAL TO STA 288+36.50

LEE COUNTY PROJECT NO. CN160642/ANB

**BOARD OF LEE COUNTY COMMISSIONERS**

|                                    |  |                                       |                                      |                                    |
|------------------------------------|--|---------------------------------------|--------------------------------------|------------------------------------|
| District ONE<br><i>Kevin Ruane</i> | District TWO<br><i>Cecil Pendergrass</i> | District THREE<br><i>Ray Sandelli</i> | District FOUR<br><i>Brian Hamman</i> | District FIVE<br><i>Frank Mann</i> |
|------------------------------------|--|---------------------------------------|--------------------------------------|------------------------------------|

**LEE COUNTY MANAGER**

*Roger Desjarlais*

**LEE COUNTY DEPARTMENT OF TRANSPORTATION**

*Randy Cerchie, Director  
Vincent Miller, Project Manager*

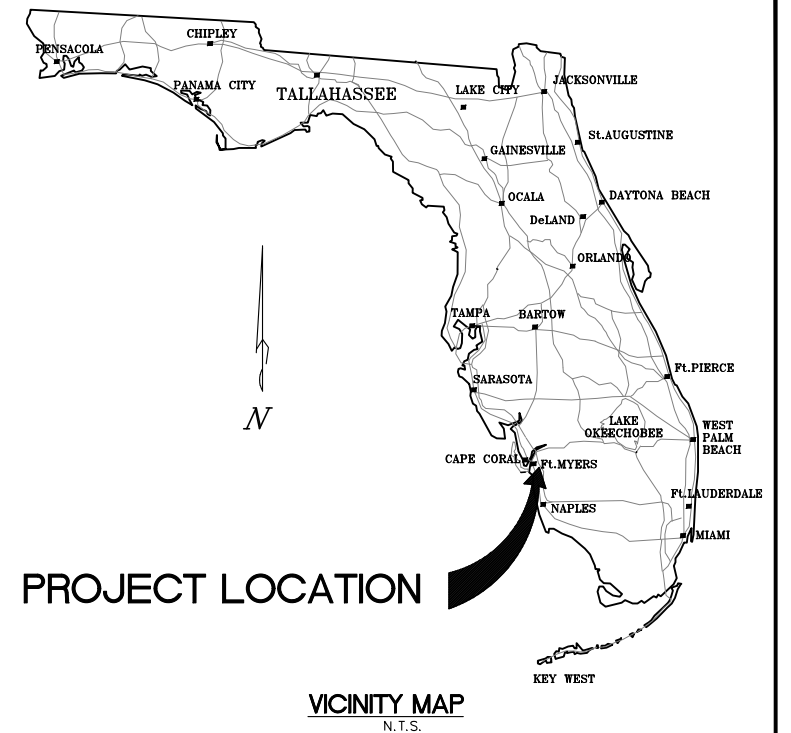

**PROJECT LOCATION**

**VICINITY MAP**  
N.T.S.

### INDEX OF SIGNING AND PAVEMENT MARKING PLANS

|           |  |
|-----------|--|
| S1        | KEY SHEET  |
| S2        | TABULATION OF QUANTITIES                                   |
| S3        | GENERAL NOTES  |
| S4 TO S5  | PROJECT LAYOUT   |
| S6 TO S15 | SIGNNG AND PAVEMENT MARKING PLANS                          |
| S16       | SIGNNG AND PAVEMENT MARKING PLANS<br>(TURN LANE ALTERNATE) |

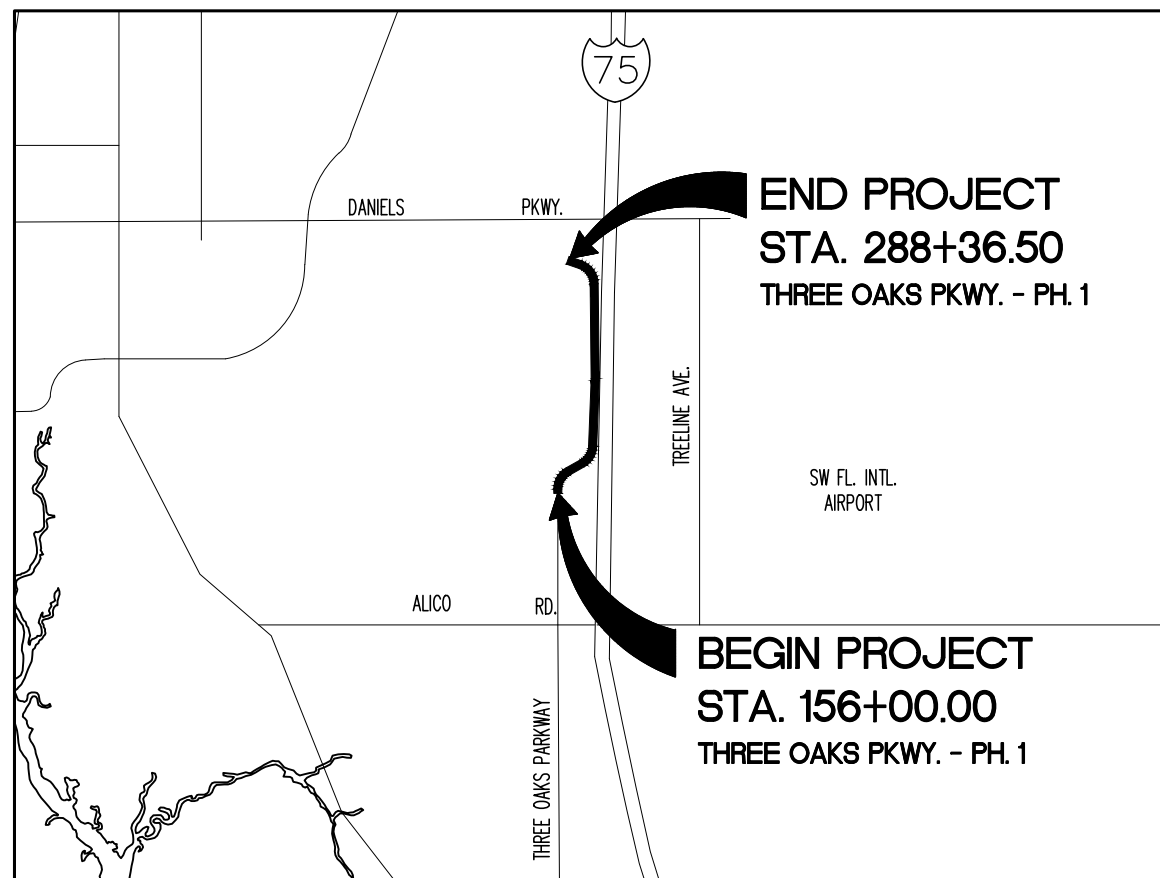

**LOCATION MAP**

N.T.S.

**PLANS REVISIONS**

01/26/23 1 SHEETS 2

ATTENTION IS DIRECTED TO THE FACT THAT THESE PLANS MAY HAVE BEEN REDUCED IN SIZE BY REPRODUCTION. THIS MUST BE CONSIDERED WHEN OBTAINING SCALED DATA.

EXCEPT WHERE OTHERWISE INDICATED BY SPECIAL PROVISION, THE GOVERNING SPECIFICATIONS SHALL BE: STATE OF FLORIDA, DEPARTMENT OF TRANSPORTATION, STANDARD SPECIFICATIONS, DATED JULY 2020, DESIGN STANDARDS FY 2020-21 AND SUPPLEMENTS THERETO IF NOTED IN THE SPECIAL PROVISIONS FOR THIS PROJECT.

SIGNING AND PAVEMENT MARKING PLANS  
ENGINEER OF RECORD: NOELLE M. VILIM, P.E.  
FL. LICENSE NO. \_\_\_\_\_90931\_\_\_\_\_

P:\CAD\2017\17-372\3-Oaks-Ph1\PILOT\_PHASE1\SPM\_PHASE1\SPM\_PHASE1\COVER\_SPM-3-OAKS.dwg, S1 KEY SHEET, 1/26/2023 1:43:24 PM, Avalon Engineering, Inc.

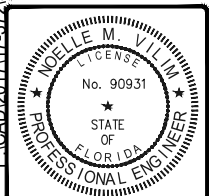

THIS ITEM HAS BEEN DIGITALLY SIGNED AND SEALED BY JACOB SCHRAGER, PE, ON THE DATE BELOW. PRINTED COPIES OF THIS DOCUMENT ARE NOT CONSIDERED SIGNED AND SEALED AND THE SIGNATURE MUST BE VERIFIED ON ANY ELECTRONIC COPIES.

| DATE | BY | REVISION DESCRIPTION |
|------|----|----------------------|
|      |    |                      |
|      |    |                      |

**BID SET PLANS**

AVALON PROJECT: 17-372  
PROJ. MGR. Noelle M. Vilim, P.E.  
LEE COUNTY DOT PROJECT: CN160642/ANB  
LDOT PROJ. MGR. VINCENT MILLER

**AVALON ENGINEERING, INC.**  
2503 DEL PRADO BLVD, SUITE 200  
CAPE CORAL, FLORIDA 33904  
FBPE#3128 (239) 573-2077

**LEE COUNTY DEPARTMENT OF TRANSPORTATION**  
(239) 533-8580

**THREE OAKS PARKWAY EXTENSION**  
PHASE 1: FIDDLESTICKS CANAL TO STA 288+36.50  
LEE COUNTY, FLORIDA

**KEY SHEET**  
**THREE OAKS PKWY EXT.**

SHEET  
S1 of 16

P:\CAD\2017\17-372\3-Oaks-Plan\PLOT\_PHASE\SPM\_PHASE\TABOSP\_3-OAKS.dwg S2 TABULATION OF QUANTITIES - 1/26/2023 4:49:39 PM Avalon Engineering, Inc.

| PAY ITEM NO. | DESCRIPTION   | UNIT | SHEET NUMBERS |       |       |       |       |       |       |       |       |       |       |       |       |       |       |       |       |       |       |       | TOTAL ALL SHEETS |       |
|--------------|---|------|---------------|-------|-------|-------|-------|-------|-------|-------|-------|-------|-------|-------|-------|-------|-------|-------|-------|-------|-------|-------|------------------|-------|
|              |   |      | S-6           |       | S-7   |       | S-8   |       | S-9   |       | S-10  |       | S-11  |       | S-12  |       | S-13  |       | S-14  |       | S-15  |       | PLAN             | FINAL |
|              |   |      | PLAN          | FINAL | PLAN  | FINAL | PLAN  | FINAL | PLAN  | FINAL | PLAN  | FINAL | PLAN  | FINAL | PLAN  | FINAL | PLAN  | FINAL | PLAN  | FINAL | PLAN  | FINAL |                  |       |
| 700-1-11     | SINGLE POST SIGN, F&I, LESS THAN 12 SF  | AS   | 8             |       | 0     |       | 2     |       | 0     |       | 4     |       | 0     |       | 2     |       | 0     |       | 3     |       | 14    |       | 33               |       |
| 705-10-3     | OBJECT MARKER, TYPE 3   | EA   | 2             |       | 0     |       | 0     |       | 2     |       | 0     |       | 2     |       | 0     |       | 0     |       | 0     |       | 0     |       | 6                |       |
| 706-1-1      | RETRO-REFLECTIVE/RAISED PAVEMENT MARKERS<br>(ALL COLORS, INCLUDES MD/Y RPMS FOR THE ISLAND END) | EA   | 88            |       | 71    |       | 72    |       | 72    |       | 72    |       | 72    |       | 72    |       | 72    |       | 72    |       | 17    |       | 680              |       |
| 710-11-101   | PAINTED PAVEMENT MARKINGS, STANDARD, WHITE, SOLID, 6"   | GM   | 0.506         |       | 0.523 |       | 0.530 |       | 0.530 |       | 0.530 |       | 0.530 |       | 0.530 |       | 0.530 |       | 0.530 |       | 0.246 |       | 4.862            |       |
| 710-11-131   | PAINTED PAVEMENT MARKINGS, STANDARD, WHITE,<br>10-30 SKIP, 6" WIDE                              | GM   | 0.506         |       | 0.523 |       | 0.530 |       | 0.530 |       | 0.530 |       | 0.530 |       | 0.530 |       | 0.530 |       | 0.530 |       | 0.246 |       | 4.862            |       |
| 710-11-160   | PAINTED PAVEMENT MARKING, STANDARD, WHITE, MESSAGE,<br>(INCLUDES BIKE SYM)                      | EA   | 4             |       | 2     |       | 2     |       | 2     |       | 4     |       | 2     |       | 2     |       | 4     |       | 2     |       | 0     |       | 24               |       |
| 710-11-201   | PAINTED PAVEMENT MARKINGS, STANDARD, YELLOW,<br>SOLID, 6"                                       | GM   | 0.509         |       | 0.523 |       | 0.530 |       | 0.530 |       | 0.530 |       | 0.530 |       | 0.530 |       | 0.530 |       | 0.530 |       | 0.246 |       | 4.865            |       |
| 710-11-290   | PAINTED PAVEMENT MARKINGS, STANDARD, YELLOW<br>(ISLAND NOSE)                                    | SF   | 12            |       | 0     |       | 0     |       | 0     |       | 0     |       | 0     |       | 0     |       | 0     |       | 23    |       | 21    |       | 56               |       |
|              |   |      |               |       |       |       |       |       |       |       |       |       |       |       |       |       |       |       |       |       |       |       |                  |       |

NOTE: ALL PAVEMENT MARKINGS FOR PHASE I CONSTRUCTION SHALL BE PAINTED (FINAL LIFT OF ASPHALT TO BE PLACED AT LATER DATE)

1  
ALTERNATE "CATEGORY 1 - SIGNING AND PAVEMENT MARKINGS"

| PAY ITEM NO. | DESCRIPTION   | UNIT | SHEET NUMBERS |       |          |       |       |       | TOTAL NET CHANGE |       |
|--------------|---|------|---------------|-------|----------|-------|-------|-------|------------------|-------|
|              |   |      | S-14          |       | S-15     |       | S-16  |       | PLAN             | FINAL |
|              |   |      | PLAN          | FINAL | PLAN     | FINAL | PLAN  | FINAL |                  |       |
| A700-1-11    | SINGLE POST SIGN, F&I, LESS THAN 12 SF  | AS   | (-)3          |       | (-)14    |       | 23    |       | 6                |       |
| A706-1-1     | RETRO-REFLECTIVE/RAISED PAVEMENT MARKERS<br>(ALL COLORS, INCLUDES MD/Y RPMS FOR THE ISLAND END) | EA   | (-)36         |       | (-)17    |       | 139   |       | 86               |       |
| A710-11-101  | PAINTED PAVEMENT MARKINGS, STANDARD, WHITE, SOLID, 6"   | GM   | (-)0.265      |       | (-)0.246 |       | 0.649 |       | 0.157            |       |
| A710-11-123  | PAINTED PAVEMENT MARKINGS, STANDARD, WHITE, SOLID, 12"  | LF   |               |       |          |       | 186   |       | 186              |       |
| A710-11-141  | PAINTED PAVEMENT MARKINGS, STANDARD, WHITE, SKIP,<br>2-4 SKIP, 6" WIDE                          | GM   |               |       |          |       | 0.044 |       | 0.044            |       |
| A710-11-160  | PAINTED PAVEMENT MARKING, STANDARD, WHITE, MESSAGE,<br>(INCLUDES BIKE SYM)                      | EA   | (-)2          |       |          |       | 13    |       | 11               |       |
| A710-11-201  | PAINTED PAVEMENT MARKINGS, STANDARD, YELLOW,<br>SOLID, 6"                                       | GM   | (-)0.265      |       | (-)0.246 |       | 0.468 |       | (-)0.043         |       |
| A710-11-290  | PAINTED PAVEMENT MARKINGS, STANDARD, YELLOW<br>(ISLAND NOSE)                                    | SF   | (-)23         |       | (-)21    |       | 29    |       | (-)15            |       |

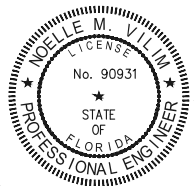

THE OFFICIAL RECORD OF THIS SHEET IS THE ELECTRONIC FILE DIGITALLY SIGNED AND SEALED UNDER RULE 61G15-23.004 FAC. ON 01/26/2023

PRINTED COPIES OF THIS DOCUMENT ARE NOT CONSIDERED SIGNED AND SEALED AND THE SIGNATURE MUST BE VERIFIED ON ANY ELECTRONIC COPIES

| DATE     | BY | REVISION DESCRIPTION |
|----------|----|----------------------|
| 01/26/23 | NV | ADDENDUM #1          |

BID SET PLANS

AVALON PROJECT: 17-372  
PROJ. MGR. Noelle M. Vilim, P.E.  
LEE COUNTY DOT PROJECT: CN160642/ANB  
LDOT PROJ. MGR. VINCENT MILLER

**AVALON ENGINEERING, INC.**  
2503 DEL PRADO BLVD, SUITE 200  
CAPE CORAL, FLORIDA 33904  
FBPE #3128 (239) 573-2077

**LEE COUNTY DEPARTMENT OF TRANSPORTATION**  
(239) 633-8580

**THREE OAKS PARKWAY EXTENSION**  
PHASE I: FIDDLESTICKS CANAL TO STA 288+36.50  
LEE COUNTY, FLORIDA

TABULATION OF QUANTITIES  
THREE OAKS PKWY EXT.

SHEET  
S2 of 16

**SIGNING AND PAVEMENT MARKING GENERAL NOTES:**

1. THE IMPLEMENTATION OF THE SIGNING AND PAVEMENT MARKING PLANS SHALL BE IN ACCORDANCE WITH THE CURRENT EDITION OF THE MANUAL OF UNIFORM TRAFFIC CONTROL DEVICES (MUTCD), THE 2020 EDITION OF THE FDOT STANDARD SPECIFICATIONS FOR ROAD AND BRIDGE CONSTRUCTION AND THE 2020/2021 EDITION OF THE FDOT DESIGN STANDARDS.
2. TEMPORARY PAVEMENT MARKINGS SHALL CONFORM TO TECHNICAL PROVISION 710 – PAINTED TRAFFIC STRIPES AND MARKINGS.
3. ALL STRIPING SHALL BE APPLIED BEFORE RAISED REFLECTIVE PAVEMENT MARKERS (RPMS) ARE INSTALLED.
4. ALL PAVEMENT MARKINGS SHALL BE PAINTED UNLESS OTHERWISE NOTED.
5. ALL PAVEMENT MARKINGS SHALL BE IN ACCORDANCE WITH INDEX NO. 710 ALL.
6. PLACEMENT OF RPMS SHALL BE IN ACCORDANCE WITH INDEX NO. 706.
7. ALL SIGNS SHALL BE PLACED IN ACCORDANCE WITH INDEX NO. 700 AND LEE COUNTY SIGN AND INSTALLATION STANDARDS.
8. SIGN ASSEMBLY LOCATIONS WHICH ARE IN CONFLICT WITH LIGHTING, UTILITIES, DRIVEWAYS, CURB CUTS, ETC. MAY BE ADJUSTED BY THE ENGINEER IN ACCORDANCE WITH THE MUTCD.
9. ALL SIGNS SHALL BE NEW, UNLESS OTHERWISE NOTED. THE EXISTING SIGNS SHALL BE SALVAGED, DISMANTLED AND DELIVERED TO LEE COUNTY.
10. OFFSETS SHOWN ON THE PLANS ARE FROM THE CENTERLINE OF CONSTRUCTION.
11. MATCH EXISTING PAVEMENT MARKINGS AT THE BEGINNING AND END OF THE PROJECT, AT INTERSECTIONS, AND AT ALL SIDE STREETS.
12. ANY EXISTING PAVEMENT MARKINGS TO REMAIN, WHICH ARE DAMAGED DURING CONSTRUCTION, SHALL BE REFURBISHED BY THE CONTRACTOR TO THE SATISFACTION OF THE ENGINEER.
13. THE FOLLOWING ABBREVIATIONS ARE USED ON THESE PLANS:  
 RPMS – RAISED REFLECTIVE PAVEMENT MARKERS  
 W/R – BI-DIRECTIONAL WHITE/RED  
 MD/Y – MONO-DIRECTIONAL YELLOW

**LEE COUNTY DOT SIGNAGE NOTES:**

1. ALL SIGN PANELS INSTALLED ON LEE COUNTY ROADWAYS TO BE OF GRADE 5052 H38 ALUMINUM MATERIAL WITH A THICKNESS OF .080 INCHES (2.0 MM) OR GREATER.
2. ALL SIGNS SHALL HAVE THE SHAPE AND SIZE AS SPECIFIED IN THE LATEST VERSION OF THE MANUAL ON UNIFORM TRAFFIC CONTROL DEVICES.
3. ANY BORDER OR FRAME AROUND A SIGN SHALL MAINTAIN THE SAME SHAPE AS THE SIGN.
4. SIGN POSTS, FOUNDATIONS, AND MOUNTINGS SHALL BE SO CONSTRUCTED AS TO HOLD SIGNS IN A PROPER AND PERMANENT POSITION, AND TO RESIST SWAYING IN THE WIND OR DISPLACEMENT BY VANDALISM.
5. SIGN POST SHALL BE A MINIMUM OF 14 GAUGE STEEL, 2" SQUARE WITH A GALVANIZED COATING.
6. EXTENSION SLEEVES, IF USED, SHALL BE A MINIMUM OF 12 GAUGE STEEL, 2.25" SQUARE WITH A GALVANIZED COATING.
7. THE SIGN POST OR SLEEVE SHALL BE INSTALLED A MINIMUM OF 30" BELOW THE FINISHED GRADE.
8. SLEEVES, IF USED, MAY NOT PROTRUDE MORE THAN 3" ABOVE THE FINISHED GRADE.
9. SLEEVES AND SIGN POST SHOULD BE POUNDED FIRMLY, EITHER MANUALLY OR MECHANICALLY INTO THE GROUND.
10. IF HOLES ARE HAND DUG, AN 8" X 3/8" DIAMETER GALVANIZED STEEL SPIKE OR APPROVED OTHER MECHANISM SHALL BE PLACED THROUGH OR AROUND THE POST SECURELY APPROXIMATELY 1' UP FROM BOTTOM OF HOLE TO PROVIDE UPLIFT RESISTANCE.
11. HOLES DUG FOR ALL POSTS OR SLEEVES SHALL BE COMPACTED IN 6 INCH LIFTS.
12. BOLTS, WASHERS, AND NUTS SHALL BE 5/16 INCH STAINLESS STEEL, GRADE 5 OR GREATER.
13. LOCK NUTS WITH NYLON INSERT SHALL BE USED ON ALL INSTALLATIONS.
14. STAINLESS STEEL WASHERS .080 INCH (2.0 MM) OR GREATER THICKNESS TO BE INSTALLED ON FACE OF SIGN AT EACH FASTENING POINT. WASHERS SHALL HAVE NOMINAL SAE DIMENSIONS.
15. FASTENER POINTS ARE TO BE 3" FROM TOP AND BOTTOM OF SIGN PANEL WITH NO DISTANCE GREATER THAN 30 INCHES UNFASTENED TO SIGN POST WHETHER SINGLE OR MULTI-POST INSTALLATION.
16. ALL FASTENING HARDWARE SHALL BE SECURELY FASTENED WITHOUT RESULTING IN DAMAGE TO SIGN SHEETING.
17. REGULATORY, WARNING, AND GUIDE SIGNS SHALL BE RETRO REFLECTIVE TO SHOW THE SAME SHAPE AND SIMILAR COLOR BY BOTH DAY AND NIGHT. SIGN SHEETING WITH AN ASTM D4956-01 TYPE IV (EQUIVALENT TO 3M HI-INTENSITY OR AVERY DENNISON PRISMATIC) OR BETTER RETRO REFLECTIVITY SHALL BE USED. A SIGN'S RETRO REFLECTIVITY SHALL MEET OR EXCEED STANDARDS SET FORTH IN THE LATEST VERSION OF THE MANUAL ON UNIFORM TRAFFIC CONTROL DEVICES. PARKING, STANDING, AND STOPPING SIGNS R7 AND R8 SERIES, WALKING, HITCHHIKING, CROSSING SIGNS R9 SERIES R10-1 THROUGH R10-4, ACKNOWLEDGEMENT SIGNS AND CERTAIN BIKEWAY SIGNS THAT ARE INTENDED FOR EXCLUSIVE USE BY BICYCLIST OR PEDESTRIANS MAY USE LOWER SHEETING GRADES.
18. SIGN ILLUMINATION SHALL NOT BE CONSIDERED AS A SATISFACTORY ALTERNATIVE TO RETRO REFLECTIVITY.
19. REQUIREMENTS FOR SIGN ILLUMINATION SHALL NOT BE CONSIDERED TO BE SATISFIED BY STREET OR HIGHWAY LIGHTING.
20. ONLY SYMBOLS RECOGNIZED BY THE LATEST VERSION OF THE MANUAL ON UNIFORM TRAFFIC CONTROL DEVICES MAY BE USED ON SIGNS.
21. UNLESS SPECIFICALLY STATED OTHERWISE, EACH SIGN ILLUSTRATED HEREIN SHALL HAVE A BORDER OF THE SAME COLOR AS THE LEGEND, AT OR JUST INSIDE THE EDGE. THE WIDTH OF THE BORDER SHALL BE AS DESCRIBED IN THE STANDARD HIGHWAY SIGNS MANUAL PUBLISHED BY FHWA.
22. THE CORNERS OF ALL SIGN BORDERS SHALL BE ROUNDED WITH A THREE (3) INCH RADIUS, EXCEPT FOR STOP SIGNS.
23. SIGNS INSTALLED AT THE SIDE OF THE ROAD IN RURAL DISTRICTS SHALL BE AT LEAST 1.5 M (5 FT) HIGH, MEASURED FROM THE BOTTOM OF THE SIGN TO THE NEAR EDGE OF THE PAVEMENT.
24. WHERE PARKING OR PEDESTRIAN MOVEMENTS OCCUR, THE CLEARANCE TO THE BOTTOM OF THE SIGN SHALL BE AT LAST 2.1 M (7 FT) HIGH.
25. THE BOTTOM OF A SIGN SHALL BE A MAXIMUM OF 8 FEET HIGH MEASURED FROM THE BOTTOM OF THE SIGN TO THE NEAR EDGE OF THE PAVEMENT.
26. DIRECTIONAL SIGNS, ROUTE SIGNS, WARNING SIGNS, AND REGULATORY SIGNS ON FREEWAYS AND EXPRESSWAYS SHALL BE INSTALLED WITH A MINIMUM HEIGHT OF 2.1 M (7 FT).
27. IF A SECONDARY SIGN IS MOUNTED BELOW ANOTHER SIGN, THE MAJOR SIGN SHALL BE INSTALLED AT LEAST 2.4 M (8 FT) AND THE SECONDARY SIGN AT LEAST 1.5 M (5 FT) ABOVE THE LEVEL OF THE PAVEMENT EDGE.
28. GROUND-MOUNTED SIGN SUPPORTS SHALL BE BREAKAWAY, YIELDING, OR SHIELDED WITH A LONGITUDINAL BARRIER OR CRASH CUSHION IF WITHIN THE CLEAR ZONE.

P:\CAD\2017\17-9728-Oaks-Ph1\PILOT\_PHASE\ISPM-NOTES\_3-OAKS.dwg, S3 GENERAL NOTES, 1/26/2023 1:43:33 PM, Avalon Engineering, Inc.

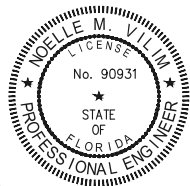

THE OFFICIAL RECORD OF THIS SHEET IS THE ELECTRONIC FILE DIGITALLY SIGNED AND SEALED UNDER RULE 61G15-23.004FAC, ON 01/26/2023

PRINTED COPIES OF THIS DOCUMENT ARE NOT CONSIDERED SIGNED AND SEALED AND THE SIGNATURE MUST BE VERIFIED ON ANY ELECTRONIC COPIES

| DATE     | BY | REVISION DESCRIPTION |
|----------|----|----------------------|
| 01/26/23 | NV | ADDENDUM #1          |

*BID SET PLANS*

AVALON PROJECT: 17-372  
 PROJ. MGR. Noelle M. Vilim, P.E.  
 LEE COUNTY DOT PROJECT: CN160642/ANB  
 LDOT PROJ. MGR. VINCENT MILLER

**AVALON ENGINEERING, INC.**  
 2503 DEL PRADO BLVD, SUITE 200  
 CAPE CORAL, FLORIDA 33904  
 FBPE#3128 (239) 573-2077

**LEE COUNTY DEPARTMENT OF TRANSPORTATION**  
 (239) 533-8580

**THREE OAKS PARKWAY EXTENSION**  
 PHASE 1: FIDDLESTICKS CANAL TO STA 288+36.50  
 LEE COUNTY, FLORIDA

**GENERAL NOTES**  
**THREE OAKS PKWY EXT.**

SHEET  
 S3 of 16

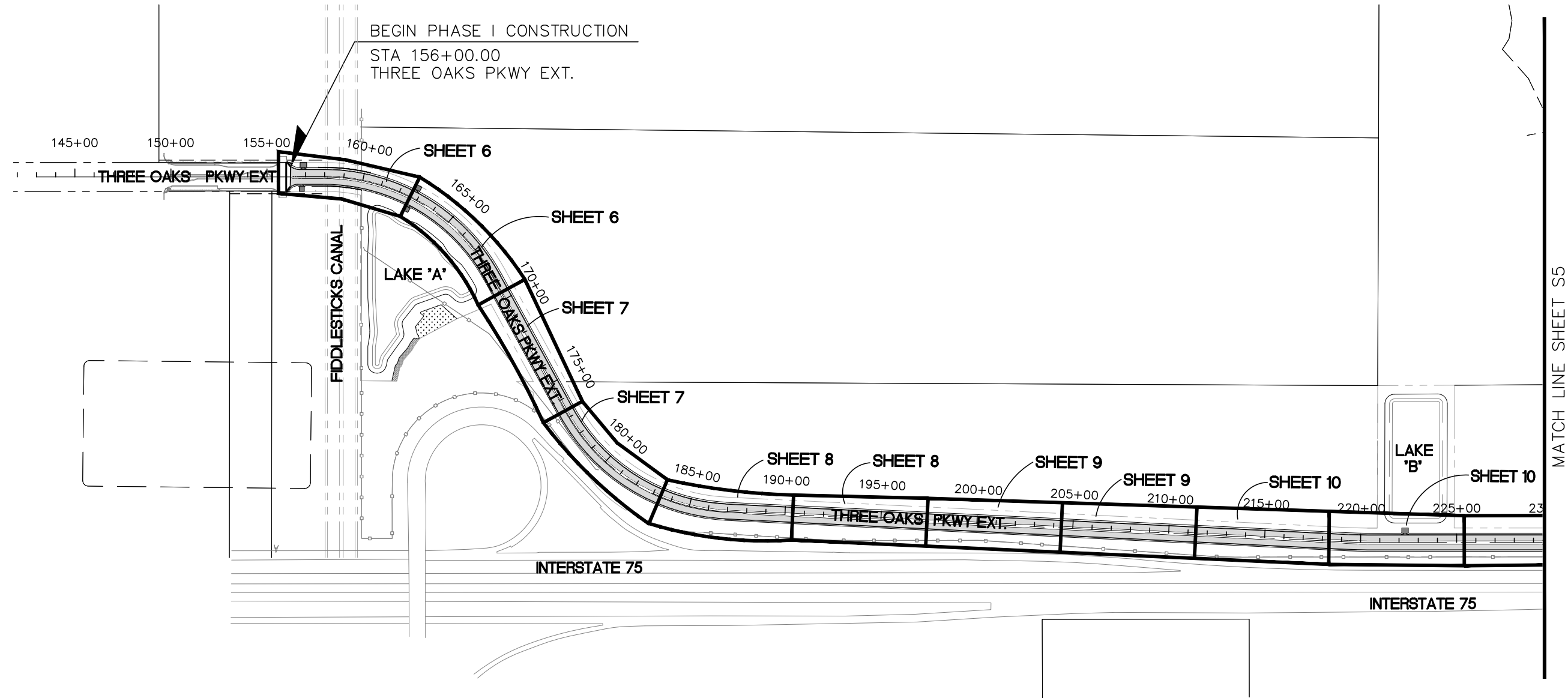
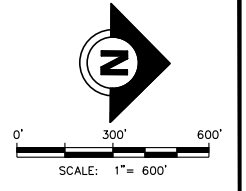

P:\CAD\2017\17-372\8-Oaks-Ph1\PILOT\_PHASE1\SPM\_PHASE1\LAYOUT\_PHASE1\_SEM.dwg, S4 PROJECT LAYOUT, 1/26/2023 1:43:40 PM, Avalon Engineering, Inc.

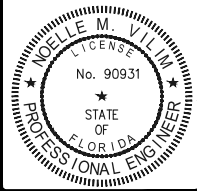

THE OFFICIAL RECORD OF THIS SHEET IS THE ELECTRONIC FILE DIGITALLY SIGNED AND SEALED UNDER RULE 61G15-23.004FAC, ON 01/26/2023

PRINTED COPIES OF THIS DOCUMENT ARE NOT CONSIDERED SIGNED AND SEALED AND THE SIGNATURE MUST BE VERIFIED ON ANY ELECTRONIC COPIES

| DATE     | BY | REVISION DESCRIPTION |
|----------|----|----------------------|
| 01/26/23 | NV | ADDENDUM #1          |

*BID SET PLANS*

AVALON PROJECT: 17-372  
 PROJ. MGR. Noelle M. Vilim, P.E.  
 LEE COUNTY DOT PROJECT: CN160642/ANB  
 LDOT PROJ. MGR. VINCENT MILLER

**AVALON ENGINEERING, INC.**  
 2503 DEL PRADO BLVD, SUITE 200  
 CAPE CORAL, FLORIDA 33904  
 FBPE #3128 (239) 573-2077

**LEE COUNTY DEPARTMENT OF TRANSPORTATION**  
 (239) 633-8580

**THREE OAKS PARKWAY EXTENSION**  
 PHASE 1: FIDDLESTICKS CANAL TO STA 288+36.50  
 LEE COUNTY, FLORIDA

**PROJECT LAYOUT**  
**THREE OAKS PKWY EXT.**

SHEET  
 S4 of 16

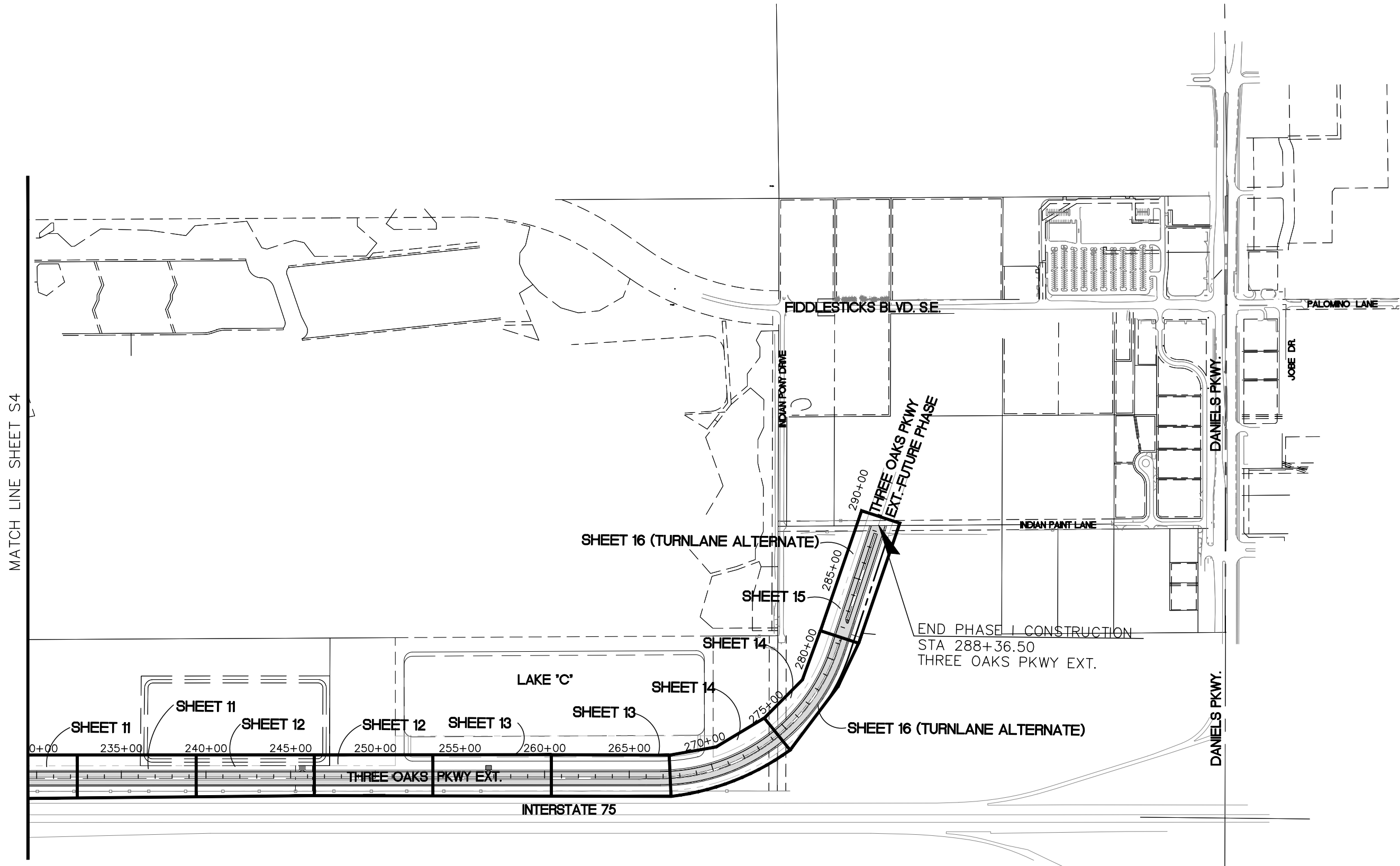
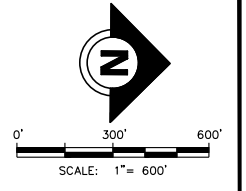

P:\CAD\2017\17-372\8-Oaks-Ph1\PILOT\_PHASE1\SPM\_PHASE1\LAYOUT\_PHASE1\_SEM.dwg\_S5 PROJECT LAYOUT\_1/26/2023 1:43:41 PM Avalon Engineering, Inc.

MATCH LINE SHEET S4

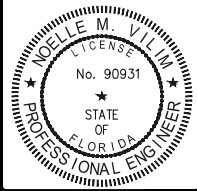

THE OFFICIAL RECORD OF THIS SHEET IS THE ELECTRONIC FILE DIGITALLY SIGNED AND SEALED UNDER RULE 61G15-23.004 FAC. ON 01/26/2023

PRINTED COPIES OF THIS DOCUMENT ARE NOT CONSIDERED SIGNED AND SEALED AND THE SIGNATURE MUST BE VERIFIED ON ANY ELECTRONIC COPIES

| DATE     | BY | REVISION DESCRIPTION |
|----------|----|----------------------|
| 01/26/23 | NV | ADDENDUM #1          |

*BID SET PLANS*

AVALON PROJECT: 17-372  
 PROJ. MGR. Noelle M. Vilim, P.E.  
 LEE COUNTY DOT PROJECT: CN160642/ANB  
 LDOT PROJ. MGR. VINCENT MILLER

**AVALON ENGINEERING, INC.**  
 2503 DEL PRADO BLVD, SUITE 200  
 CAPE CORAL, FLORIDA 33904  
 FBPE #3128 (239) 573-2077

**LEE COUNTY DEPARTMENT OF TRANSPORTATION**  
 (239) 533-8580

**THREE OAKS PARKWAY EXTENSION**  
 PHASE 1: FIDDLESTICKS CANAL TO STA 288+36.50  
 LEE COUNTY, FLORIDA

**PROJECT LAYOUT**  
**THREE OAKS PKWY EXT.**

SHEET  
S5 of 16

P:\CAD\2017\17-372\3-Oaks-Plan\PILOT PHASE\ISPM PHASE\ISPM\_3-Oaks\_1.dwg, S6 SIGNING AND PAVEMENT MARKING PLANS, 1/26/2023 1:43:51 PM, Avalon Engineering, Inc.

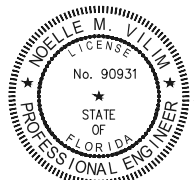
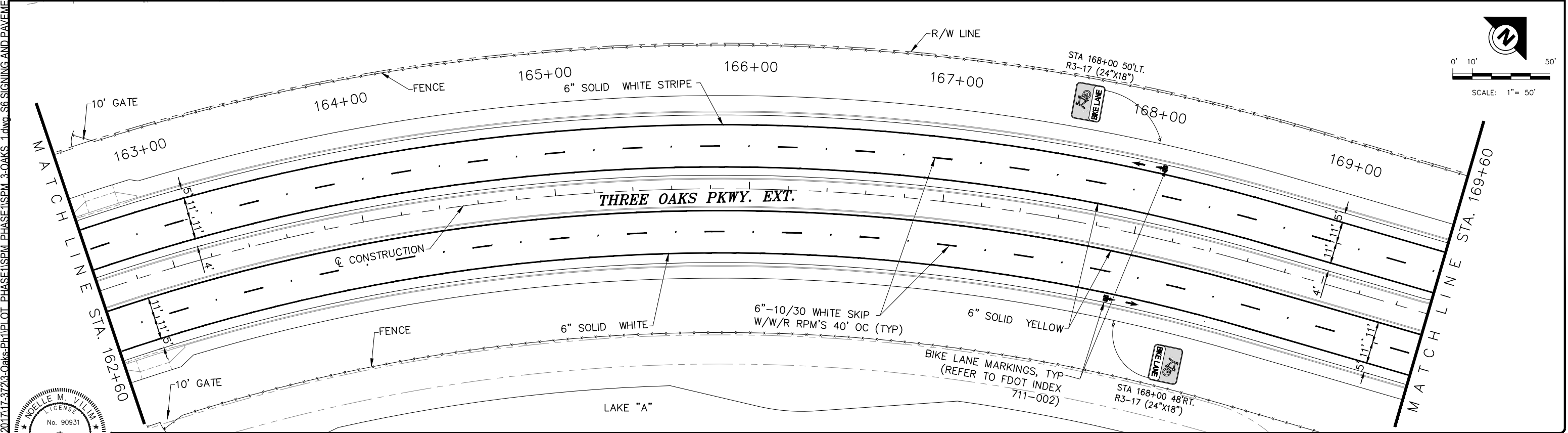
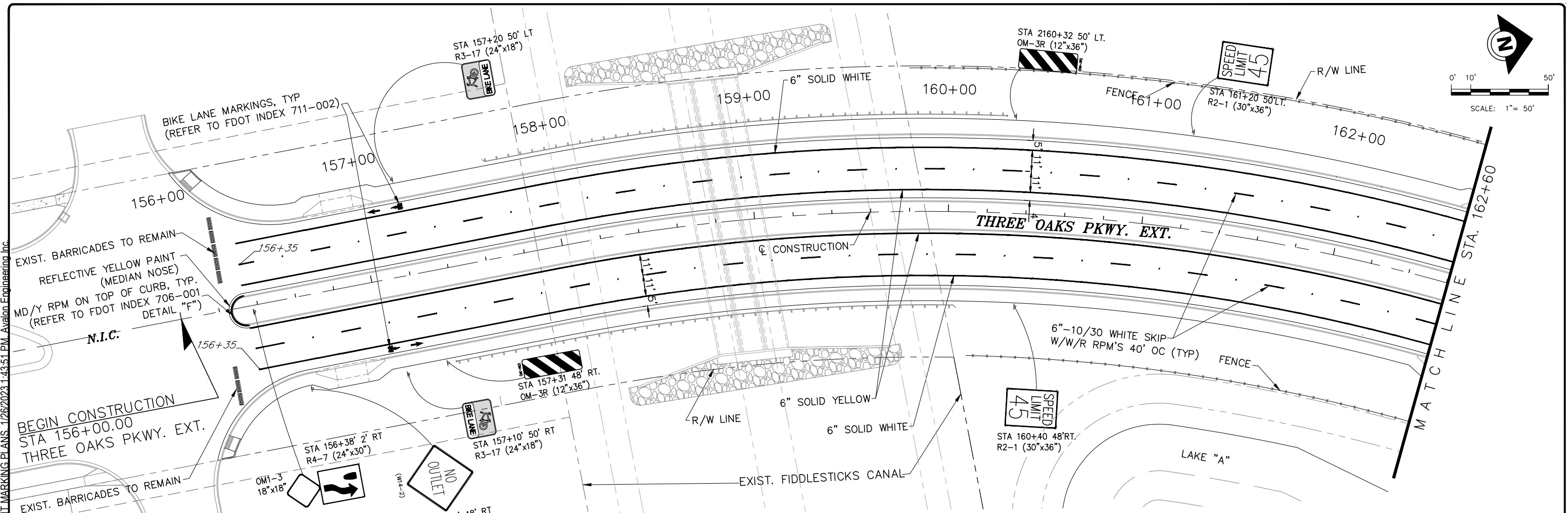

THE OFFICIAL RECORD OF THIS SHEET IS THE ELECTRONIC FILE DIGITALLY SIGNED AND SEALED UNDER RULE 61G15-23.004 FAC, ON 01/26/2023

PRINTED COPIES OF THIS DOCUMENT ARE NOT CONSIDERED SIGNED AND SEALED AND THE SIGNATURE MUST BE VERIFIED ON ANY ELECTRONIC COPIES

| DATE     | BY | REVISION DESCRIPTION |
|----------|----|----------------------|
| 01/26/23 | NV | ADDENDUM #1          |

**BID SET PLANS**

AVALON PROJECT: 17-372  
 PROJ. MGR. Noelle M. Vilim, P.E.  
 LEE COUNTY DOT PROJECT: CN160642/ANB  
 LDOT PROJ. MGR. VINCENT MILLER

**AVALON ENGINEERING, INC.**  
 2503 DEL PRADO BLVD, SUITE 200  
 CAPE CORAL, FLORIDA 33904  
 FBPE#3128 (239) 573-2077

**LEE COUNTY DEPARTMENT OF TRANSPORTATION**  
 (239) 533-8580

**THREE OAKS PARKWAY EXTENSION**  
 PHASE 1: FIDDLESTICKS CANAL TO STA 288+36.50  
 LEE COUNTY, FLORIDA

**SIGNING AND PAVEMENT MARKING PLANS**  
 THREE OAKS PKWY EXT.

SHEET  
 S6 of 16

P:\CAD\2017\17-372\3-Oaks\PH1\PILOT\_PHASE\ISPM\_PHASE1\SPM\_3-OAKS\_1.dwg, SZ SIGNING AND PAVEMENT MARKING PLANS, 1/26/2023 1:43:57 PM, Avalon Engineering, Inc.

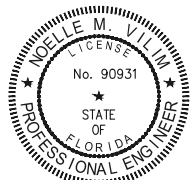
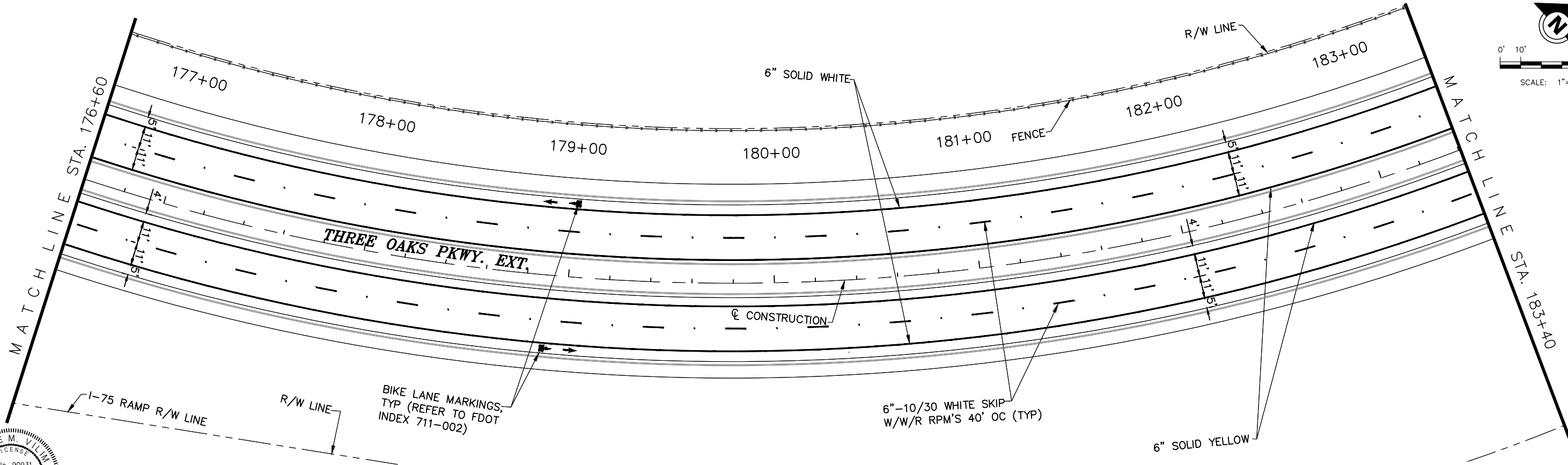
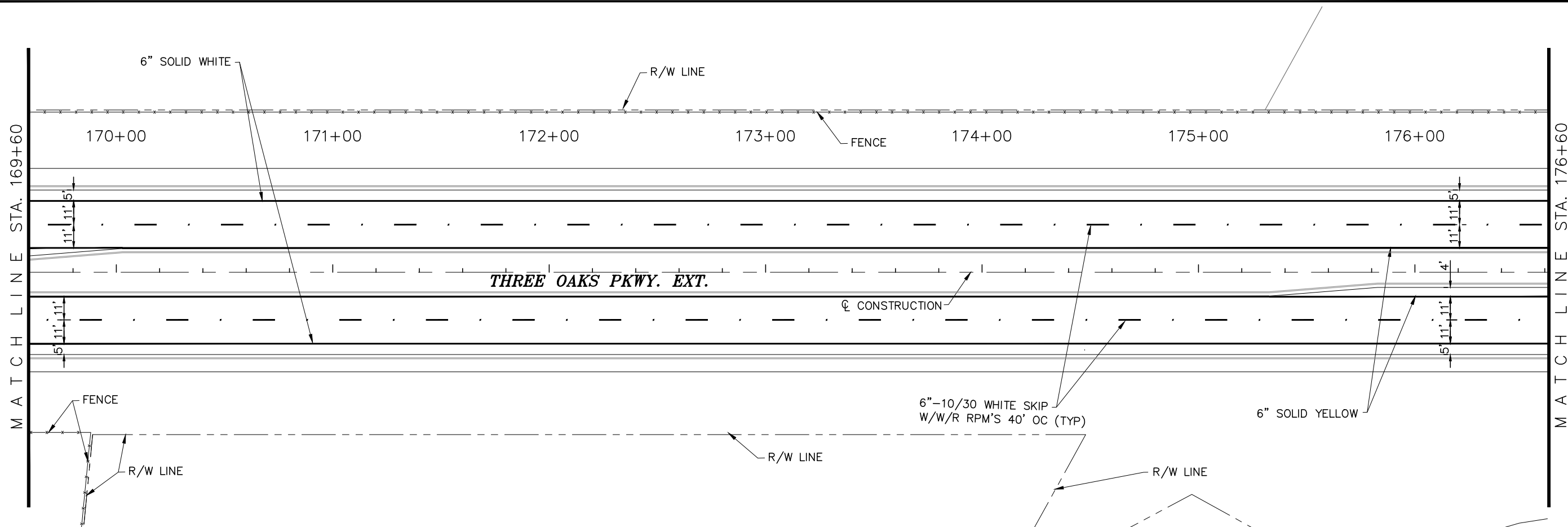

THE OFFICIAL RECORD OF THIS SHEET IS THE ELECTRONIC FILE DIGITALLY SIGNED AND SEALED UNDER RULE 61G15-23.004FAC, ON 01/26/2023

PRINTED COPIES OF THIS DOCUMENT ARE NOT CONSIDERED SIGNED AND SEALED AND THE SIGNATURE MUST BE VERIFIED ON ANY ELECTRONIC COPIES

| DATE     | BY | REVISION DESCRIPTION |
|----------|----|----------------------|
| 01/26/23 | NV | ADDENDUM #1          |

**BID SET PLANS**

AVALON PROJECT: 17-372  
 PROJ. MGR. Noelle M. Vilim, P.E.  
 LEE COUNTY DOT PROJECT: CN160642/ANB  
 LDOT PROJ. MGR. VINCENT MILLER

**AVALON ENGINEERING, INC.**  
 2503 DEL PRADO BLVD, SUITE 200  
 CAPE CORAL, FLORIDA 33904  
 FBPE#3128 (239) 573-2077

**LEE COUNTY DEPARTMENT OF TRANSPORTATION**  
 (239) 533-8580

**THREE OAKS PARKWAY EXTENSION**  
 PHASE 1: FIDDLESTICKS CANAL TO STA 288+36.50  
 LEE COUNTY, FLORIDA

**SIGNING AND PAVEMENT MARKING PLANS**  
 THREE OAKS PKWY EXT.

SHEET  
 S7 of 16

P:\CAD\2017\17-372\3-Oaks-Pkwy\PILOT\_PHASE\ISPM\_PHASE\ISPM\_3-OAKS\_1.dwg - S8 SIGNING AND PAVEMENT MARKING PLANS - 1/26/2023 1:44:02 PM - Avalon Engineering, Inc.

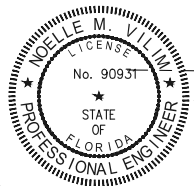
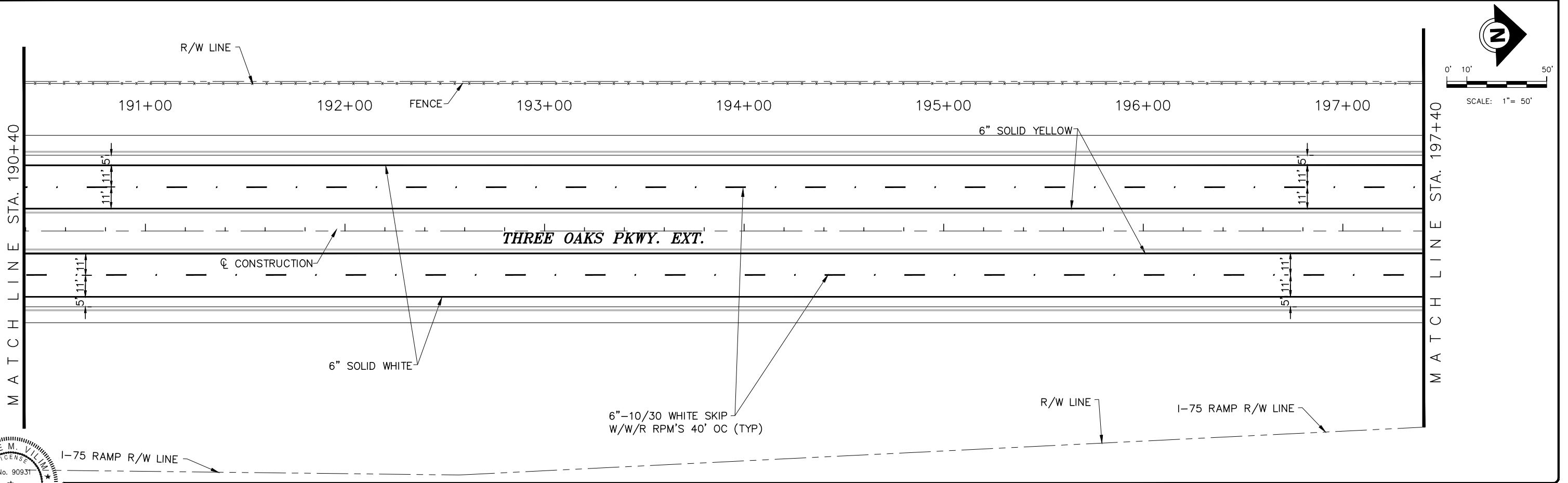
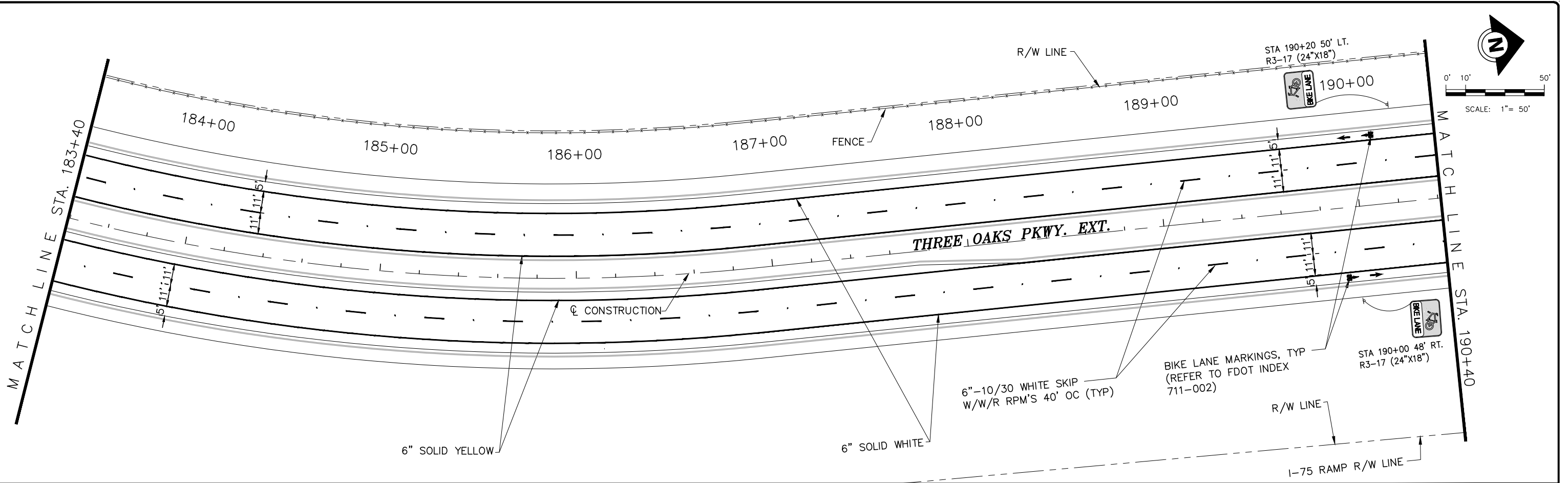

THE OFFICIAL RECORD OF THIS SHEET IS THE ELECTRONIC FILE DIGITALLY SIGNED AND SEALED UNDER RULE 61G15-23.004 FAC. ON 01/26/2023

PRINTED COPIES OF THIS DOCUMENT ARE NOT CONSIDERED SIGNED AND SEALED AND THE SIGNATURE MUST BE VERIFIED ON ANY ELECTRONIC COPIES

| DATE     | BY | REVISION DESCRIPTION |
|----------|----|----------------------|
| 01/26/23 | NV | ADDENDUM #1          |

**BID SET PLANS**

AVALON PROJECT: 17-372  
 PROJ. MGR. Noelle M. Vilim, P.E.  
 LEE COUNTY DOT PROJECT: CN160642/ANB  
 LDOT PROJ. MGR. VINCENT MILLER

**AVALON ENGINEERING, INC.**  
 2503 DEL PRADO BLVD, SUITE 200  
 CAPE CORAL, FLORIDA 33904  
 FBPE#3128 (239) 573-2077

**LEE COUNTY DEPARTMENT OF TRANSPORTATION**  
 (239) 533-8580

**THREE OAKS PARKWAY EXTENSION**  
 PHASE 1: FIDDLESTICKS CANAL TO STA 288+36.50  
 LEE COUNTY, FLORIDA

**SIGNING AND PAVEMENT MARKING PLANS**  
 THREE OAKS PKWY EXT.

SHEET  
 S8 of 16



P:\CAD\2017\17-372\3-Oaks-Pilot\PHASE1\SPM\_3-OAKS\_1.dwg\_S9 SIGNING AND PAVEMENT MARKING PLANS\_1/26/2023 1:44:07 PM\_Avalon Engineering, Inc.

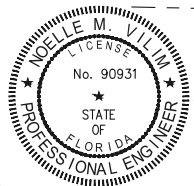
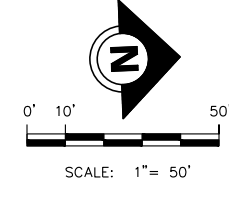
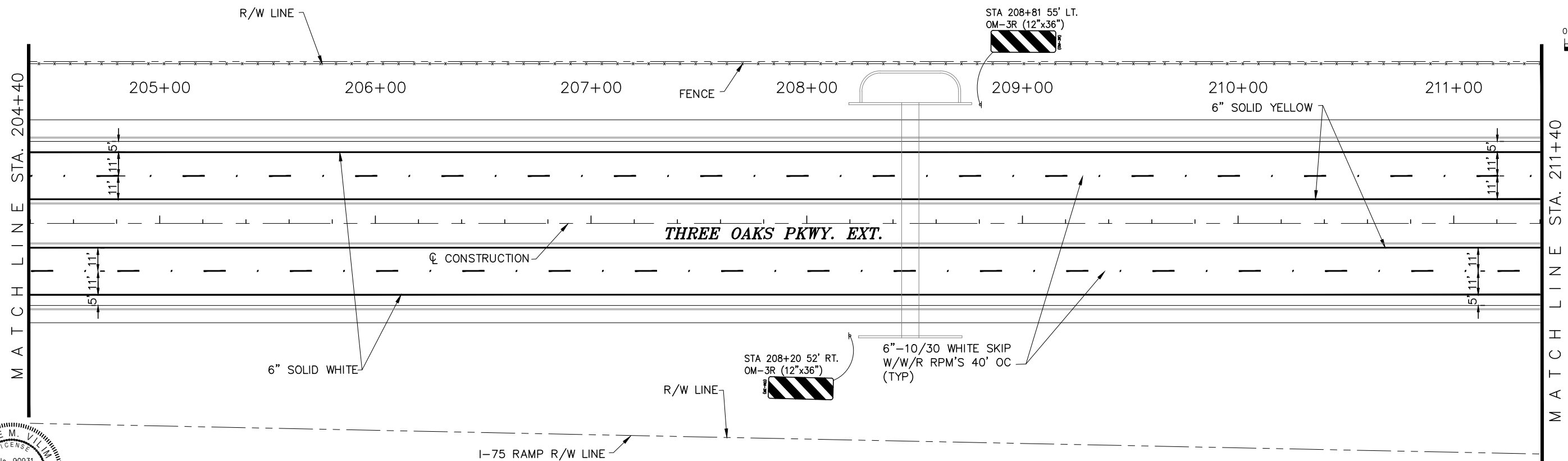
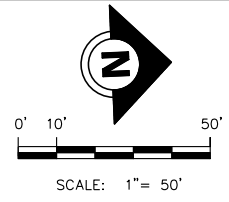
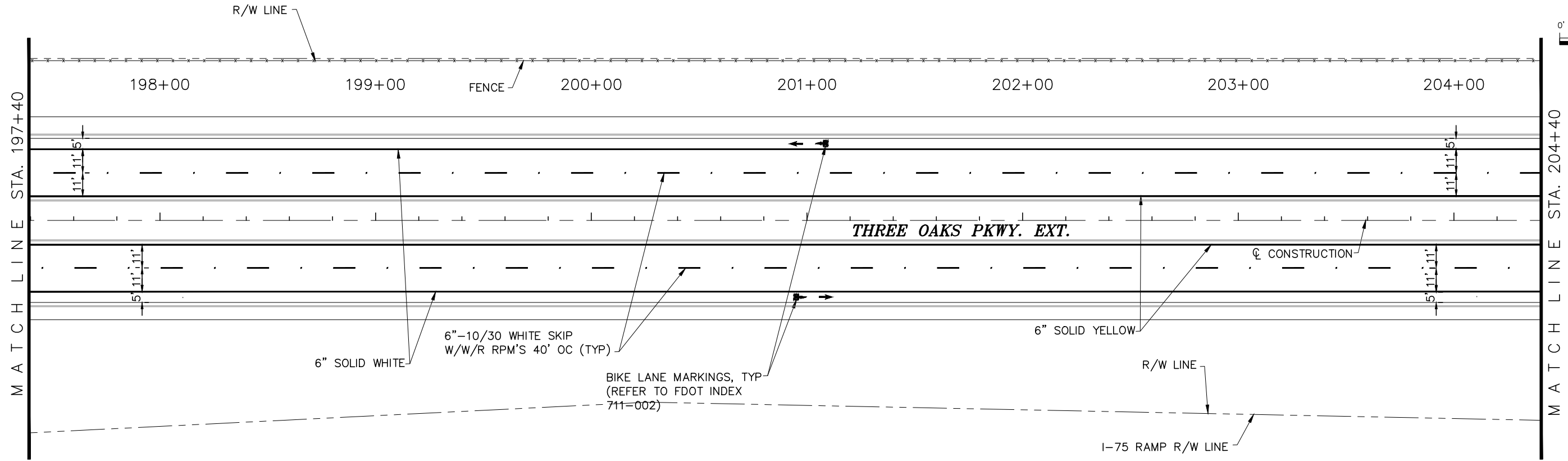

THE OFFICIAL RECORD OF THIS SHEET IS THE ELECTRONIC FILE DIGITALLY SIGNED AND SEALED UNDER RULE 61G15-23.004FAC, ON 01/26/2023

PRINTED COPIES OF THIS DOCUMENT ARE NOT CONSIDERED SIGNED AND SEALED AND THE SIGNATURE MUST BE VERIFIED ON ANY ELECTRONIC COPIES

| DATE     | BY | REVISION DESCRIPTION |
|----------|----|----------------------|
| 01/26/23 | NV | ADDENDUM #1          |

BID SET PLANS

AVALON PROJECT: 17-372  
 PROJ. MGR. Noelle M. Vilim, P.E.  
 LEE COUNTY DOT PROJECT: CN160642/ANB  
 LDOT PROJ. MGR. VINCENT MILLER

**AVALON ENGINEERING, INC.**  
 2503 DEL PRADO BLVD, SUITE 200  
 CAPE CORAL, FLORIDA 33904  
 FBPE#3128 (239) 573-2077

**LEE COUNTY DEPARTMENT OF TRANSPORTATION**  
 (239) 533-8580

**THREE OAKS PARKWAY EXTENSION**  
 PHASE 1: FIDDLESTICKS CANAL TO STA 288+36.50  
 LEE COUNTY, FLORIDA

SIGNING AND PAVEMENT MARKING PLANS  
 THREE OAKS PKWY. EXT.

SHEET  
 S9 of 16

P:\CAD\2017\17-372\3-Oaks-Pkwy\PILOT\_PHASE\ISPM\_PHASE1\SPM\_3-OAKS\_1.dwg, S10 SIGNING AND PAVEMENT MARKING PLANS - 1/26/2023 1:44:12 PM, Avalon Engineering, Inc.

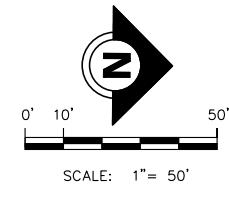
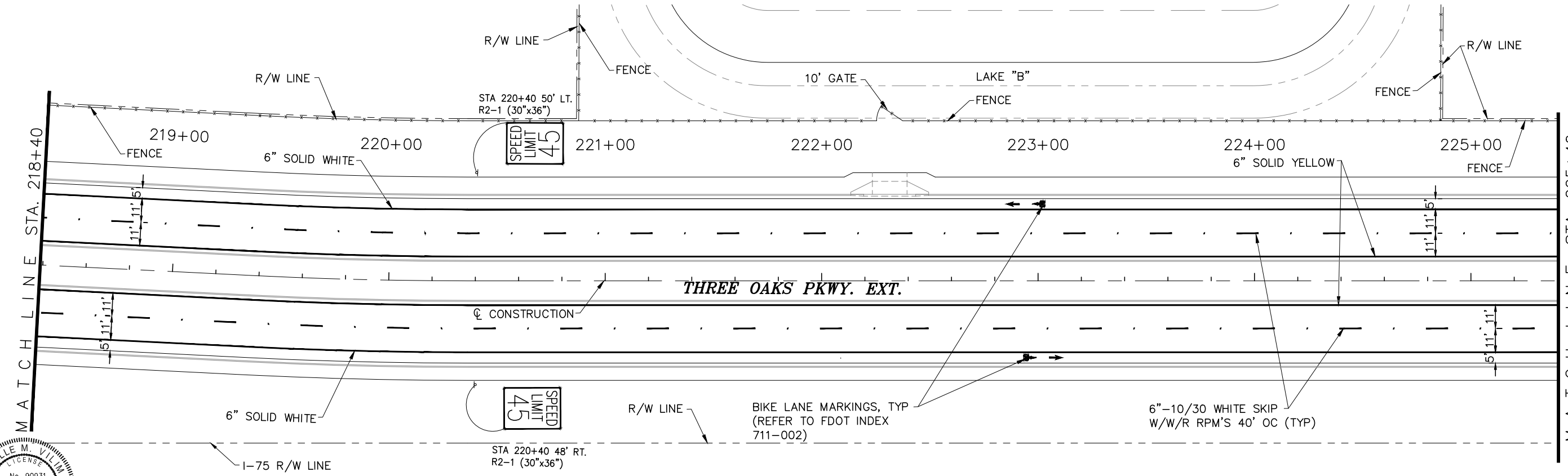
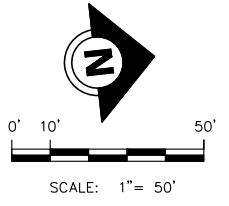
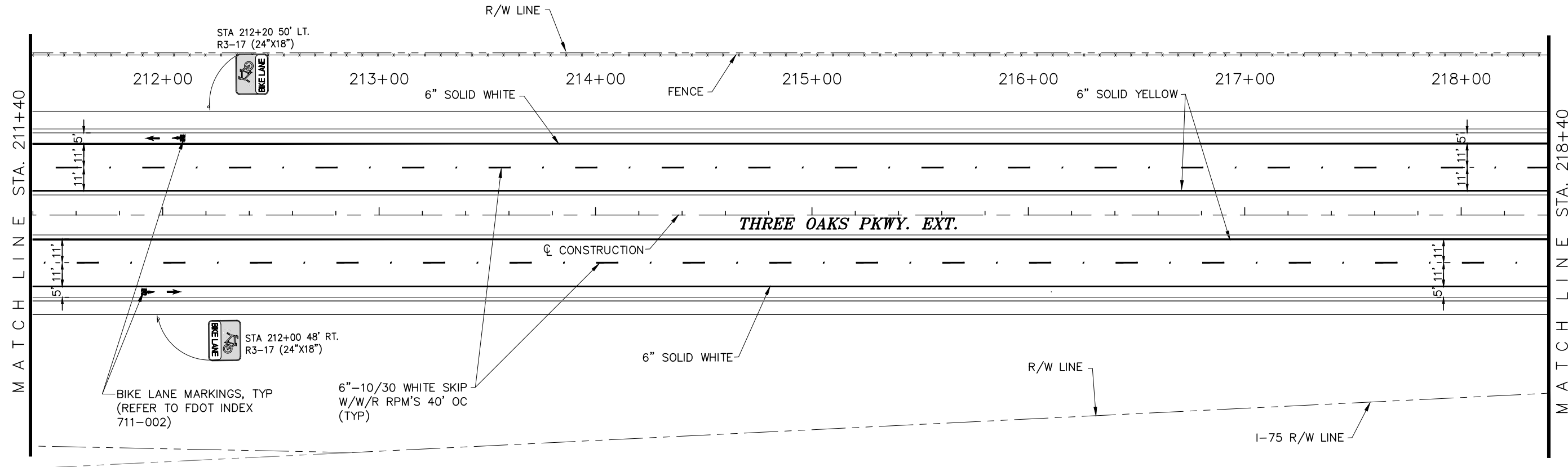

THE OFFICIAL RECORD OF THIS SHEET IS THE ELECTRONIC FILE DIGITALLY SIGNED AND SEALED UNDER RULE 61G15-23.004FAC, ON 01/26/2023

PRINTED COPIES OF THIS DOCUMENT ARE NOT CONSIDERED SIGNED AND SEALED AND THE SIGNATURE MUST BE VERIFIED ON ANY ELECTRONIC COPIES

| DATE     | BY | REVISION DESCRIPTION |
|----------|----|----------------------|
| 01/26/23 | NV | ADDENDUM #1          |

**BID SET PLANS**

AVALON PROJECT: 17-372  
 PROJ. MGR. Noelle M. Vilim, P.E.  
 LEE COUNTY DOT PROJECT: CN160642/ANB  
 LDOT PROJ. MGR. VINCENT MILLER

**AVALON ENGINEERING, INC.**  
 2503 DEL PRADO BLVD, SUITE 200  
 CAPE CORAL, FLORIDA 33904  
 FBPE#3128 (239) 573-2077

**LEE COUNTY DEPARTMENT OF TRANSPORTATION**  
 (239) 533-8580

**THREE OAKS PARKWAY EXTENSION**  
 PHASE 1: FIDDLESTICKS CANAL TO STA 288+36.50  
 LEE COUNTY, FLORIDA

**SIGNING AND PAVEMENT MARKING PLANS**  
 THREE OAKS PKWY EXT.

SHEET  
 S10 of 16

P:\CAD\2017\17-372\3-Oaks-Plan\PILOT\_PHASE\ISPM\_PHASE\ISPM\_3-OAKS\_1.dwg, S11 SIGNING AND PAVEMENT MARKING PLANS - 1/26/2023 1:44:17 PM, Avalon Engineering, Inc.

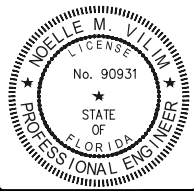
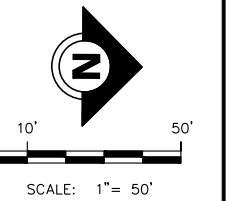
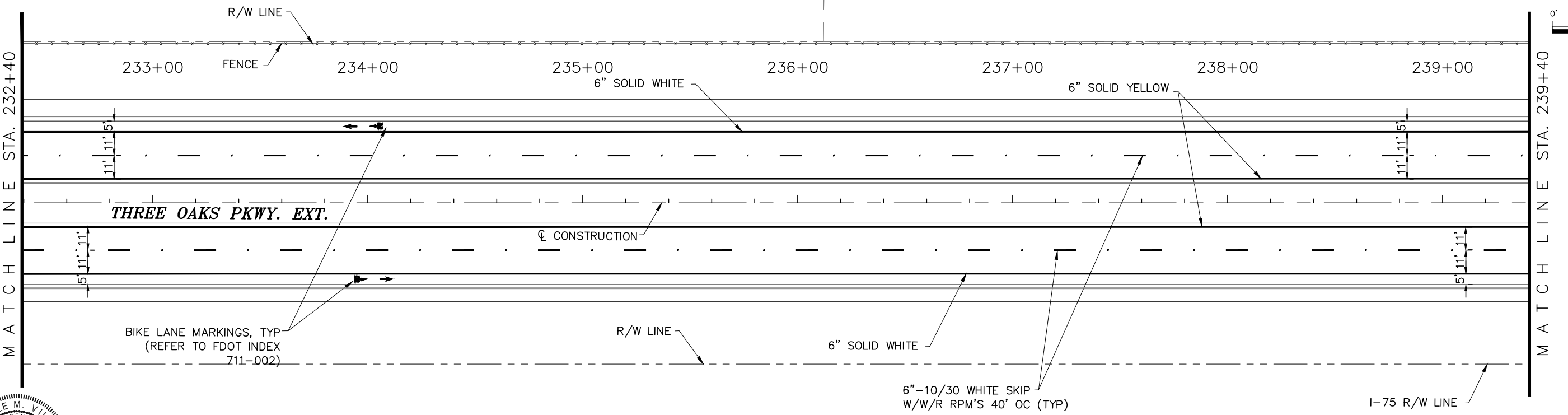
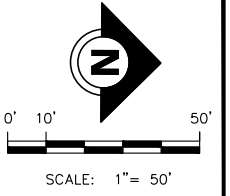
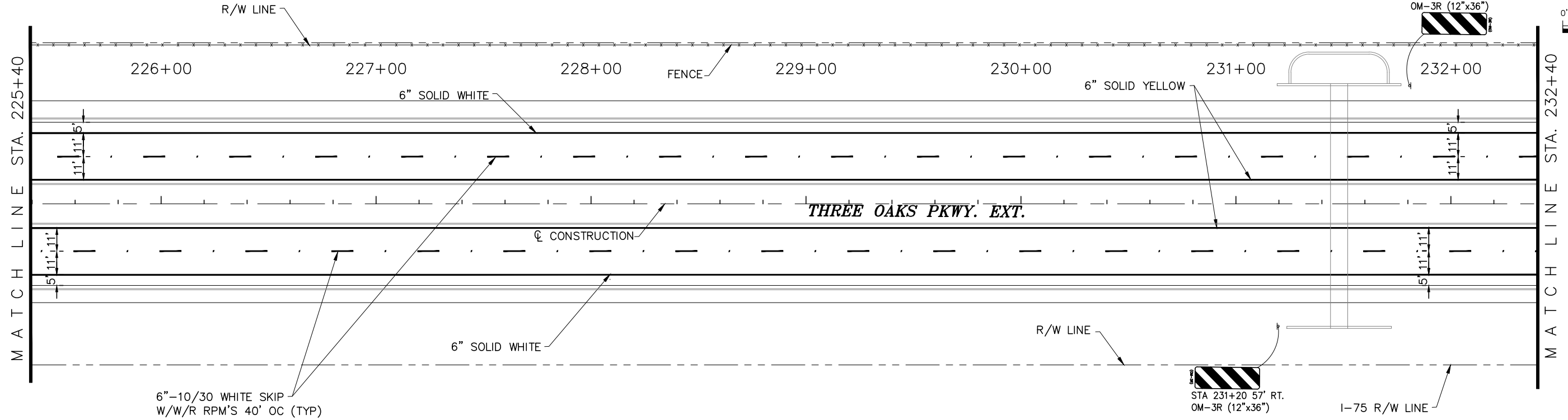

|  |    |  |  |
|--|----|--|--|
| THE OFFICIAL RECORD OF THIS SHEET IS THE ELECTRONIC FILE DIGITALLY SIGNED AND SEALED UNDER RULE 61G15-23.004FAC, ON 01/26/2023 |    | PRINTED COPIES OF THIS DOCUMENT ARE NOT CONSIDERED SIGNED AND SEALED AND THE SIGNATURE MUST BE VERIFIED ON ANY ELECTRONIC COPIES |  |
| DATE   | BY | REVISION DESCRIPTION   |  |
| 01/26/23   | NV | ADDENDUM #1  |  |

**BID SET PLANS**

AVALON PROJECT: 17-372  
 PROJ. MGR. Noelle M. Vilim, P.E.  
 LEE COUNTY DOT PROJECT: CN160642/ANB  
 LDOT PROJ. MGR. VINCENT MILLER

**AVALON ENGINEERING, INC.**  
 2503 DEL PRADO BLVD, SUITE 200  
 CAPE CORAL, FLORIDA 33904  
 FBPE#3128 (239) 573-2077

**LEE COUNTY DEPARTMENT OF TRANSPORTATION**  
 (239) 533-8580

**THREE OAKS PARKWAY EXTENSION**  
 PHASE 1: FIDDLESTICKS CANAL TO STA 288+36.50  
 LEE COUNTY, FLORIDA

**SIGNING AND PAVEMENT MARKING PLANS**  
 THREE OAKS PKWY EXT.

SHEET  
 S11 of 16

P:\CAD\2017\17-372\3-Oaks-Plan\PILOT\_PHASE\ISPM\_PHASE\ISPM\_3-OAKS\_1.dwg, STA. SIGNING AND PAVEMENT MARKING PLANS - 1/26/2023 1:44:22 PM, Avalon Engineering, Inc.

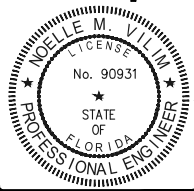
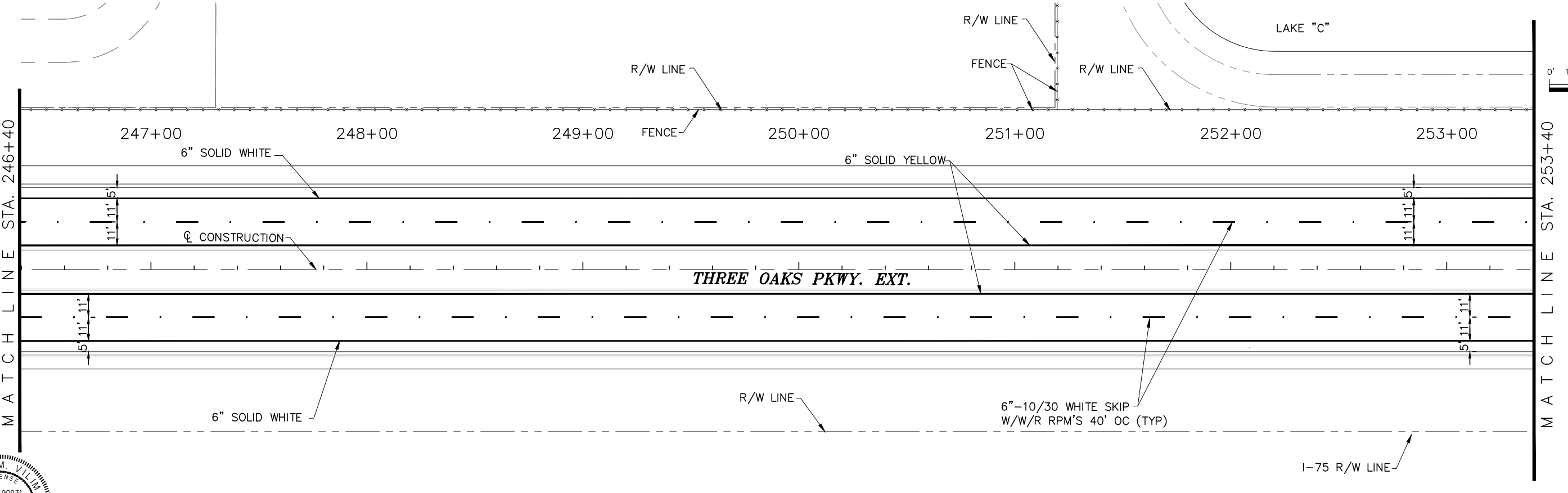
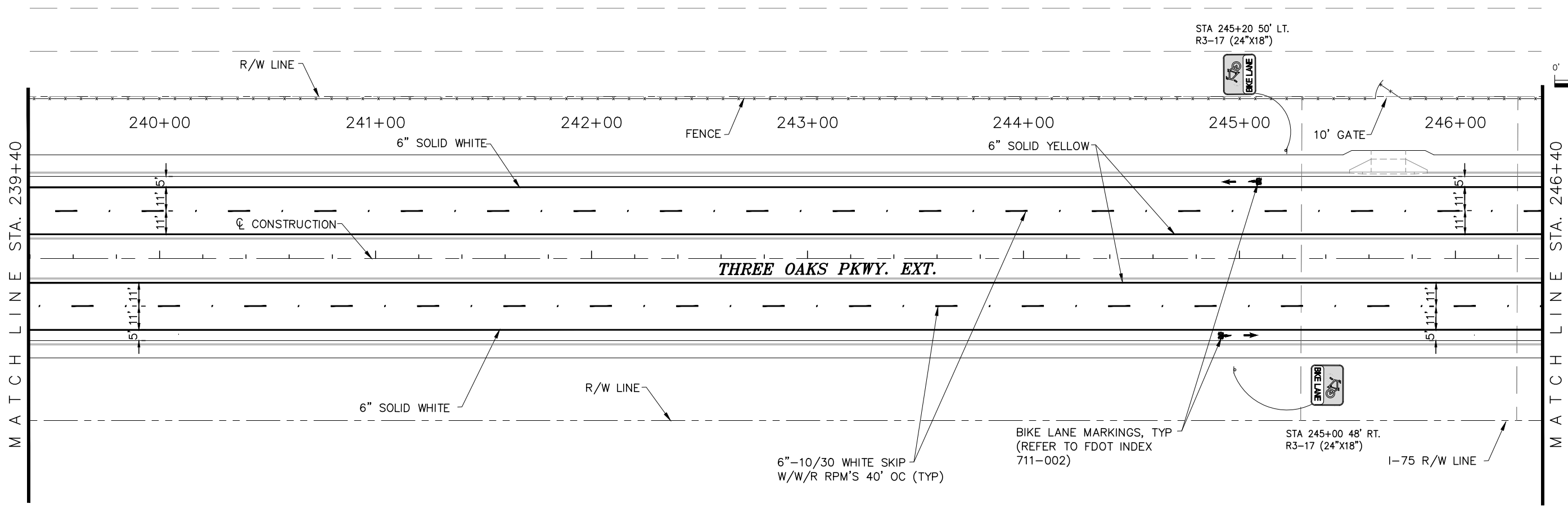

THE OFFICIAL RECORD OF THIS SHEET IS THE ELECTRONIC FILE DIGITALLY SIGNED AND SEALED UNDER RULE 61G15-23.004 FAC, ON 01/26/2023

PRINTED COPIES OF THIS DOCUMENT ARE NOT CONSIDERED SIGNED AND SEALED AND THE SIGNATURE MUST BE VERIFIED ON ANY ELECTRONIC COPIES

| DATE     | BY | REVISION DESCRIPTION |
|----------|----|----------------------|
| 01/26/23 | NV | ADDENDUM #1          |

BID SET PLANS

AVALON PROJECT: 17-372  
 PROJ. MGR. Noelle M. Vilim, P.E.  
 LEE COUNTY DOT PROJECT: CN160642/ANB  
 LDOT PROJ. MGR. VINCENT MILLER

**AVALON ENGINEERING, INC.**  
 2503 DEL PRADO BLVD, SUITE 200  
 CAPE CORAL, FLORIDA 33904  
 FBPE#3128 (239) 573-2077

**LEE COUNTY DEPARTMENT OF TRANSPORTATION**  
 (239) 533-8580

**THREE OAKS PARKWAY EXTENSION**  
 PHASE 1: FIDDLESTICKS CANAL TO STA 288+36.50  
 LEE COUNTY, FLORIDA

SIGNING AND PAVEMENT MARKING PLANS  
 THREE OAKS PKWY EXT.

SHEET  
 S12 of 16

P:\CAD\2017\17-372\3-Oaks-Pkwy\PILOT\_PHASE\ISPM\_3-OAKS\_1.dwg, STA. SIGNING AND PAVEMENT MARKING PLANS - 1/26/2023 1:44:26 PM, Avalon Engineering, Inc.

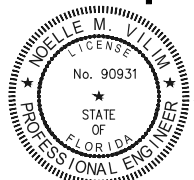
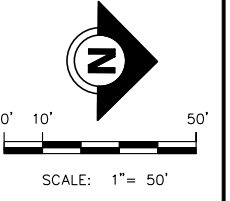
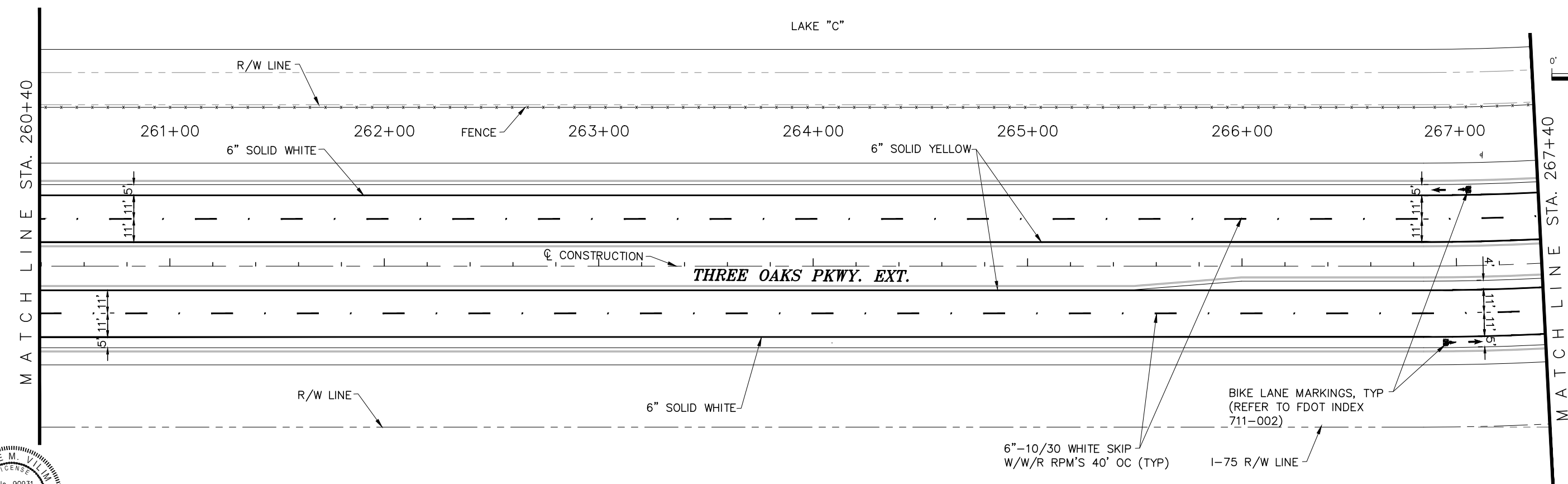
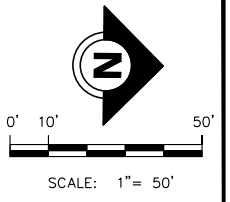
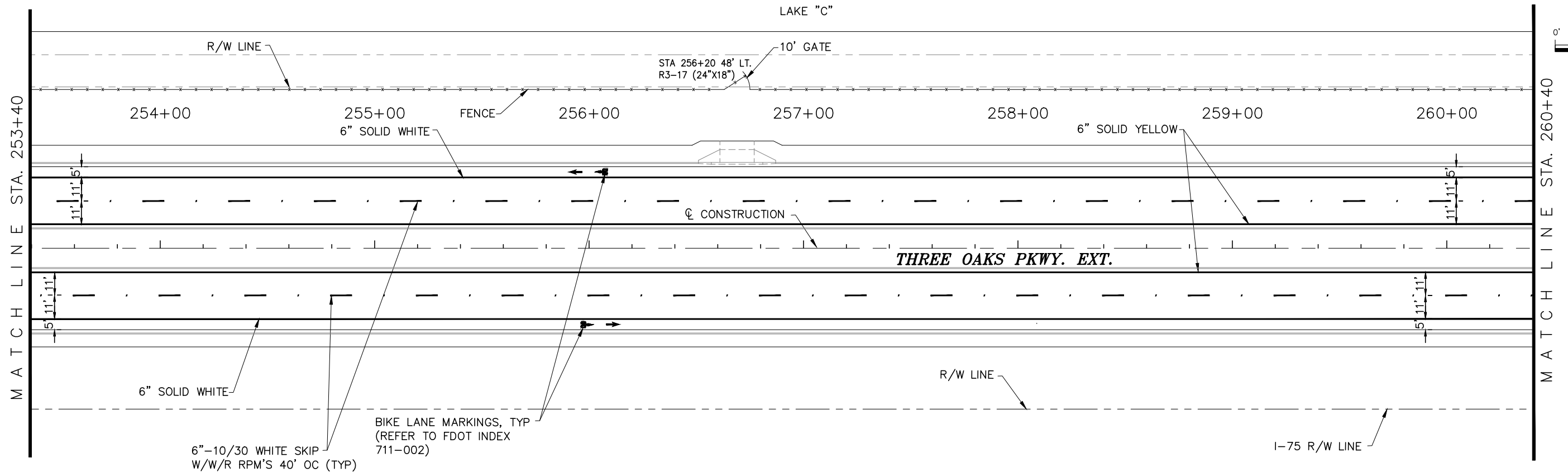

THE OFFICIAL RECORD OF THIS SHEET IS THE ELECTRONIC FILE DIGITALLY SIGNED AND SEALED UNDER RULE 61G15-23.004 FAC, ON 01/26/2023

PRINTED COPIES OF THIS DOCUMENT ARE NOT CONSIDERED SIGNED AND SEALED AND THE SIGNATURE MUST BE VERIFIED ON ANY ELECTRONIC COPIES

| DATE     | BY | REVISION DESCRIPTION |
|----------|----|----------------------|
| 01/26/23 | NV | ADDENDUM #1          |

**BID SET PLANS**

AVALON PROJECT: 17-372  
 PROJ. MGR. Noelle M. Vilim, P.E.  
 LEE COUNTY DOT PROJECT: CN160642/ANB  
 LDOT PROJ. MGR. VINCENT MILLER

**AVALON ENGINEERING, INC.**  
 2503 DEL PRADO BLVD, SUITE 200  
 CAPE CORAL, FLORIDA 33904  
 FBPE#3128 (239) 573-2077

**LEE COUNTY DEPARTMENT OF TRANSPORTATION**  
 (239) 533-8580

**THREE OAKS PARKWAY EXTENSION**  
 PHASE 1: FIDDLESTICKS CANAL TO STA 288+36.50  
 LEE COUNTY, FLORIDA

**SIGNING AND PAVEMENT MARKING PLANS**  
 THREE OAKS PKWY EXT.

SHEET  
 S13 of 16

P:\CAD\2017\17-372\3-Oaks-Pkwy\PILOT\_PHASE\ISPM\_3-OAKS\_1.dwg, STA. S14 SIGNING AND PAVEMENT MARKING PLANS - 1/26/2023 1:44:32 PM, Avalon Engineering, Inc.

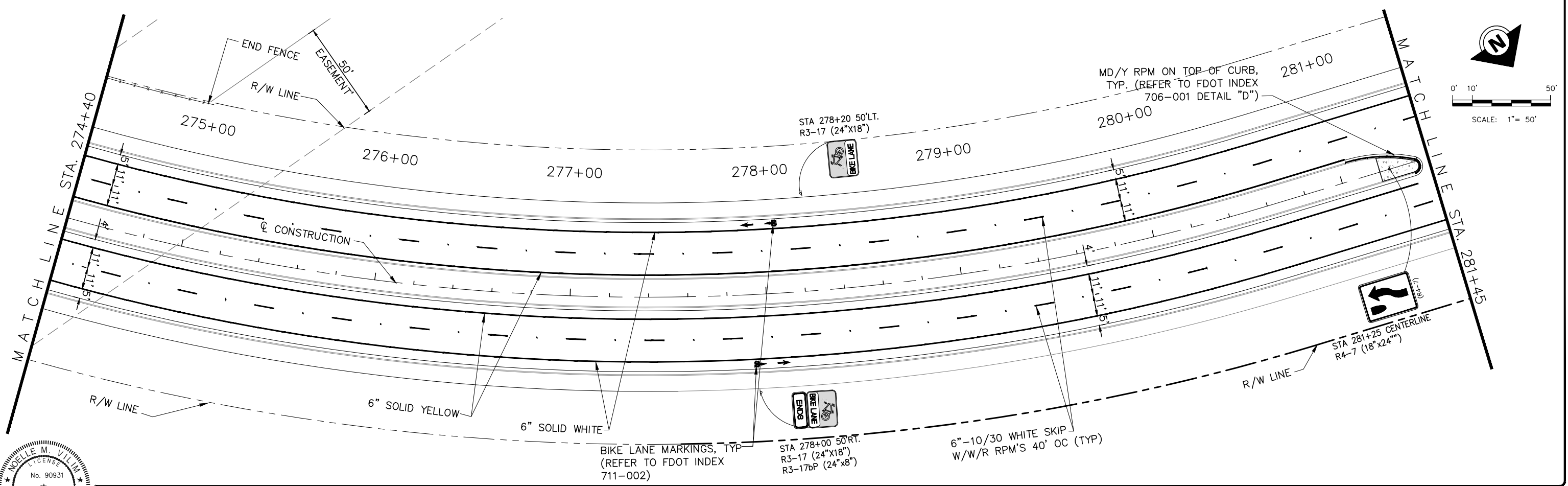
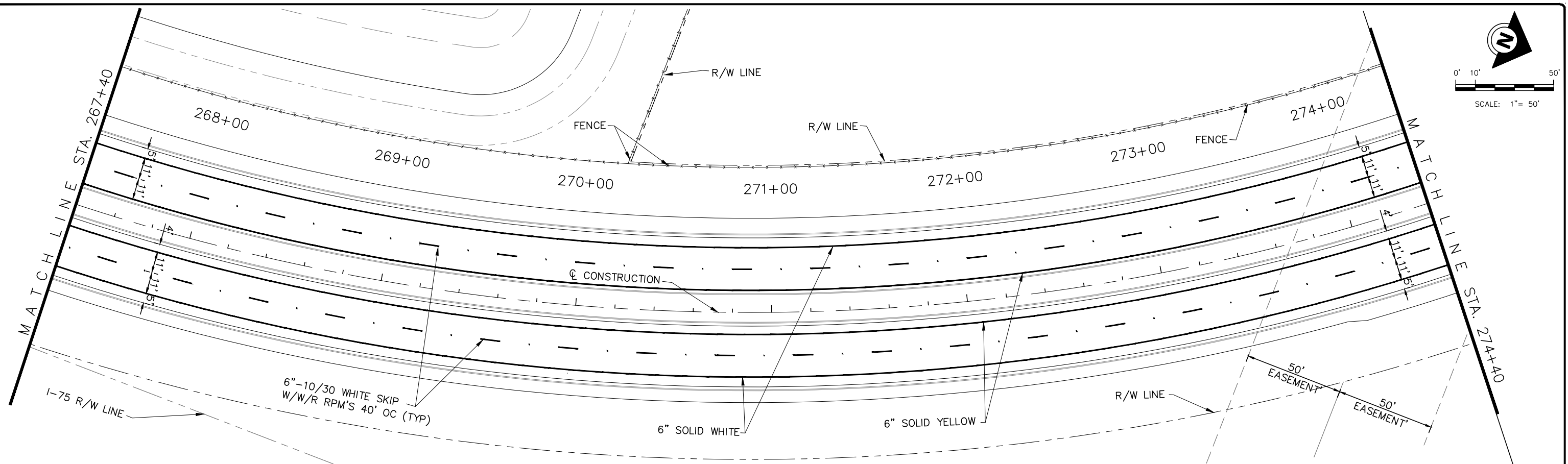

|  |    |  |  |
|--|----|--|--|
| THE OFFICIAL RECORD OF THIS SHEET IS THE ELECTRONIC FILE DIGITALLY SIGNED AND SEALED UNDER RULE 61G15-23.004FAC, ON 01/26/2023 |    | PRINTED COPIES OF THIS DOCUMENT ARE NOT CONSIDERED SIGNED AND SEALED AND THE SIGNATURE MUST BE VERIFIED ON ANY ELECTRONIC COPIES |  |
| DATE   | BY | REVISION DESCRIPTION   |  |
| 01/26/23   | NV | ADDENDUM #1  |  |

**BID SET PLANS**

AVALON PROJECT: 17-372  
 PROJ. MGR. Noelle M. Vilim, P.E.  
 LEE COUNTY DOT PROJECT: CN160642/ANB  
 LDOT PROJ. MGR. VINCENT MILLER

**AVALON ENGINEERING, INC.**  
 2503 DEL PRADO BLVD, SUITE 200  
 CAPE CORAL, FLORIDA 33904  
 FBPE #3128 (239) 573-2077

**LEE COUNTY DEPARTMENT OF TRANSPORTATION**  
 (239) 533-8580

**THREE OAKS PARKWAY EXTENSION**  
 PHASE 1: FIDDLESTICKS CANAL TO STA 288+36.50  
 LEE COUNTY, FLORIDA

**SIGNING AND PAVEMENT MARKING PLANS**  
 THREE OAKS PKWY EXT.

SHEET  
 S14 of 16

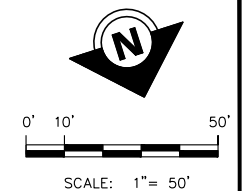

P:\CAD\2017\17-372\8-Oaks-Ph1\PILOT\_PHASE1\SPM\_3-OAKS\_1.dwg - STA 5 SIGNING AND PAVEMENT MARKING PLANS - 1/26/2023 1:44:36 PM - Avalon Engineering, Inc.

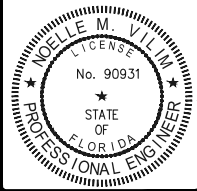
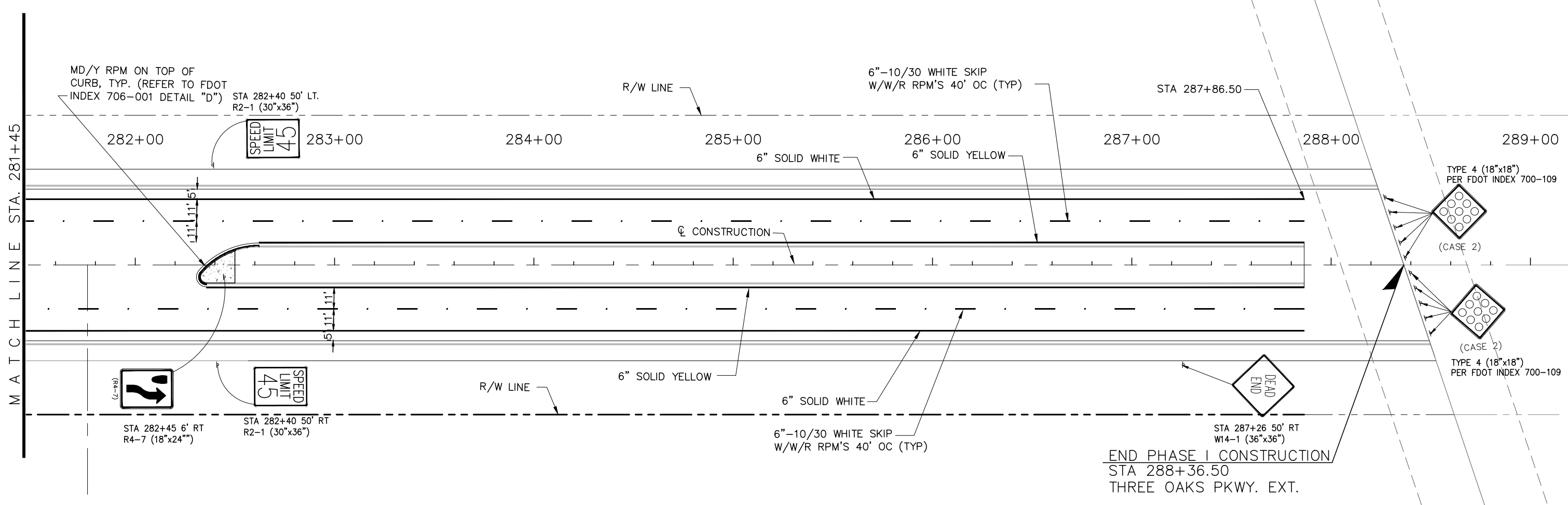

THE OFFICIAL RECORD OF THIS SHEET IS THE ELECTRONIC FILE DIGITALLY SIGNED AND SEALED UNDER RULE 61G15-23.004FAC, ON 01/26/2023

PRINTED COPIES OF THIS DOCUMENT ARE NOT CONSIDERED SIGNED AND SEALED AND THE SIGNATURE MUST BE VERIFIED ON ANY ELECTRONIC COPIES

| DATE     | BY | REVISION DESCRIPTION |
|----------|----|----------------------|
| 01/26/23 | NV | ADDENDUM #1          |

*BID SET PLANS*

AVALON PROJECT: 17-372  
 PROJ. MGR. Noelle M. Vilim, P.E.  
 LEE COUNTY DOT PROJECT: CN160642/ANB  
 LDOT PROJ. MGR. VINCENT MILLER

**AVALON ENGINEERING, INC.**  
 2503 DEL PRADO BLVD, SUITE 200  
 CAPE CORAL, FLORIDA 33904  
 FBPE #3128 (239) 573-2077

**LEE COUNTY DEPARTMENT OF TRANSPORTATION**  
 (239) 633-8580

**THREE OAKS PARKWAY EXTENSION**  
 PHASE I: FIDDLESTICKS CANAL TO STA 288+36.50  
 LEE COUNTY, FLORIDA

**SIGNING AND PAVEMENT MARKING PLANS**  
 THREE OAKS PKWY EXT.

SHEET  
 S15 of 16

P:\CAD\2017\17-372\3-Oaks-Pkwy\PILOT PHASE\ISPM\_3-Oaks\_1.TL.dwg, STA 6 SIGNING AND PAVEMENT MARKING PLANS, 1/26/2023 1:44:46 PM, Avalon Engineering, Inc.

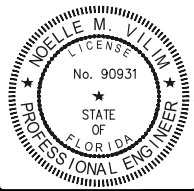
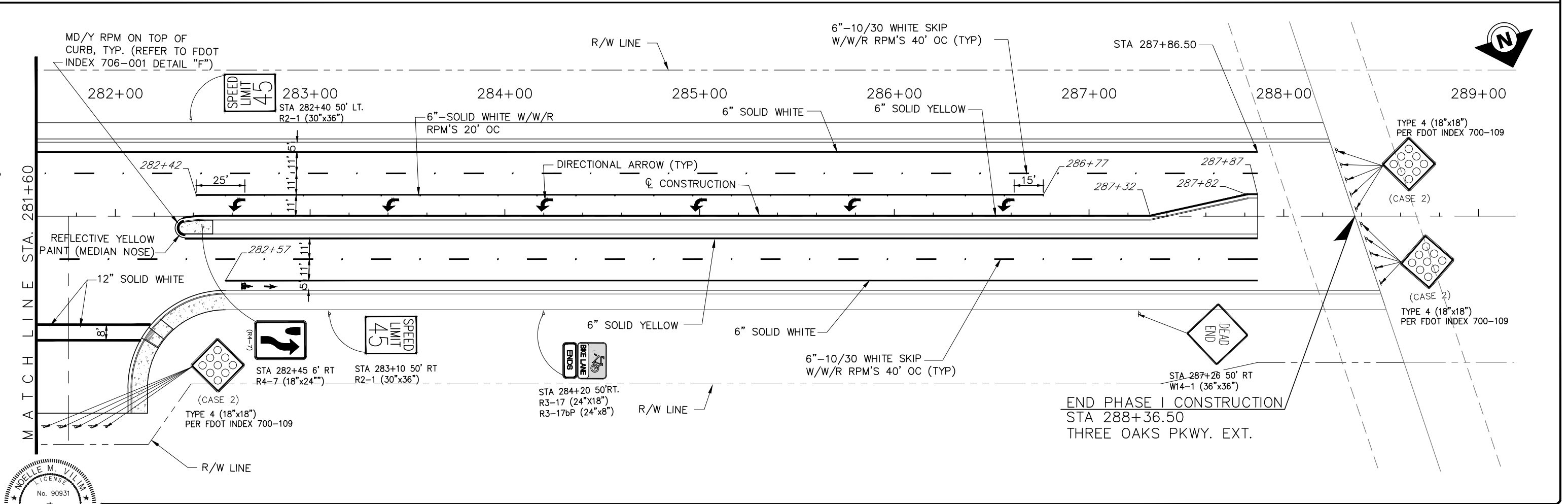
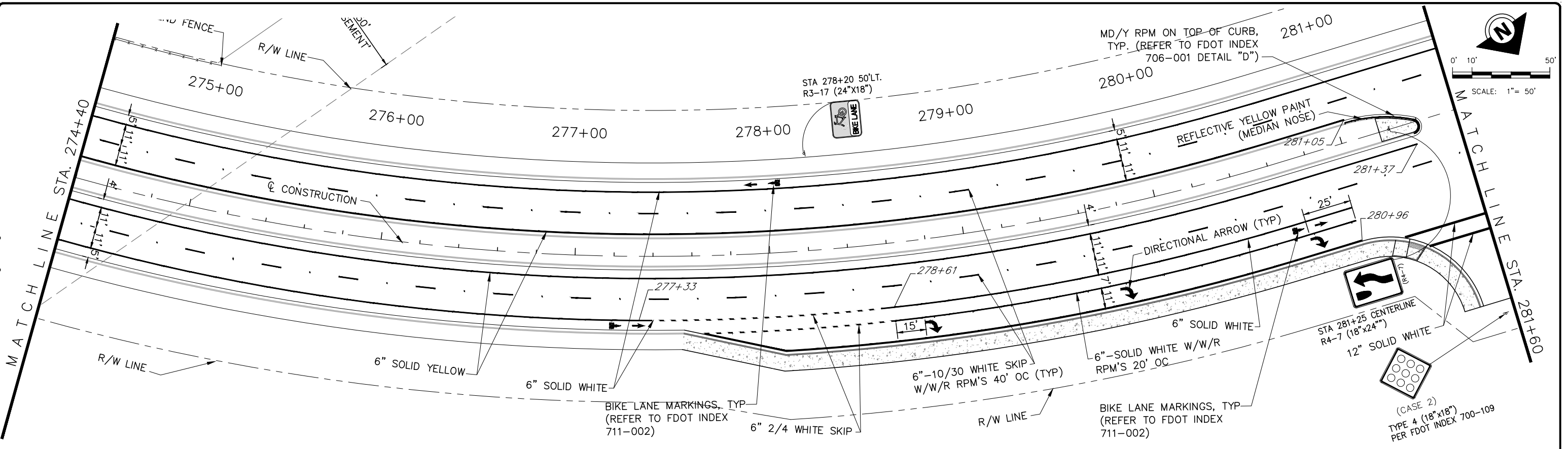

|   |    |   |  |
|---|----|---|--|
| <p>THE OFFICIAL RECORD OF THIS SHEET IS THE ELECTRONIC FILE DIGITALLY SIGNED AND SEALED UNDER RULE 61G15-23.004FAC, ON 01/26/2023</p> |    | <p>PRINTED COPIES OF THIS DOCUMENT ARE NOT CONSIDERED SIGNED AND SEALED AND THE SIGNATURE MUST BE VERIFIED ON ANY ELECTRONIC COPIES</p> |  |
| DATE  | BY | REVISION DESCRIPTION  |  |
| 01/26/23  | NV | ADDENDUM #1   |  |

BID SET PLANS

AVALON PROJECT: 17-372  
 PROJ. MGR. Noelle M. Vilim, P.E.  
 LEE COUNTY DOT PROJECT: CN160642/ANB  
 LDOT PROJ. MGR. VINCENT MILLER

**AVALON ENGINEERING, INC.**  
 2503 DEL PRADO BLVD, SUITE 200  
 CAPE CORAL, FLORIDA 33904  
 FBPE#3128 (239) 573-2077

**LEE COUNTY DEPARTMENT OF TRANSPORTATION**  
 (239) 533-8580

**THREE OAKS PARKWAY EXTENSION**  
 PHASE I: FIDDLSTICKS CANAL TO STA 288+36.50  
 LEE COUNTY, FLORIDA

**SIGNING AND PAVEMENT MARKING PLANS**  
 (TURN LANE ALTERNATE)

SHEET  
 S16 of 16