

# LEE COUNTY BOARD OF COUNTY COMMISSIONERS

Public Works Administration  
 Department of Transportation  
 Plans of Proposed

## COUNTYWIDE RESURFACING ROADWAY IMPROVEMENT

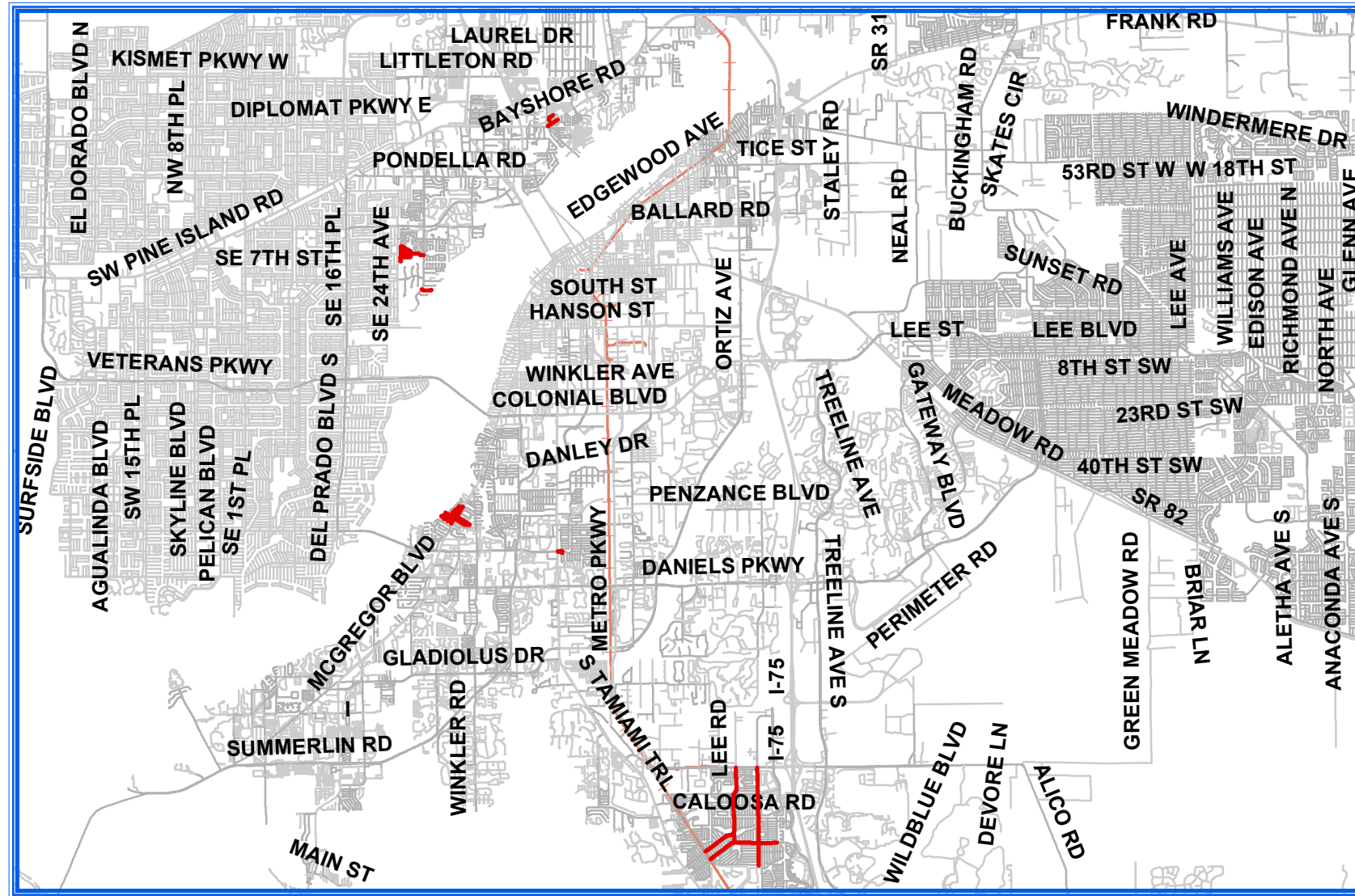

INDEX

- 1..... Coversheet
- 2..... Typical & Notes
- 3 - 7..... County Wide Art / Coll

Location Map  
 LEE COUNTY, FLORIDA

March 10, 2022



3/FY2022

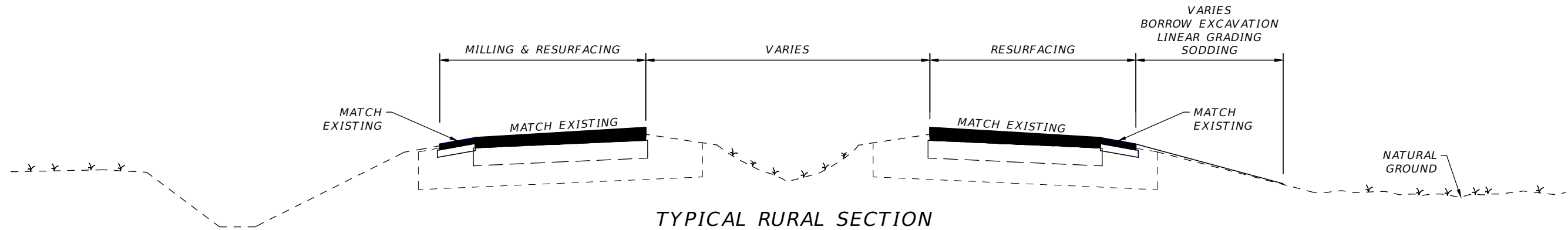

TYPICAL RURAL SECTION

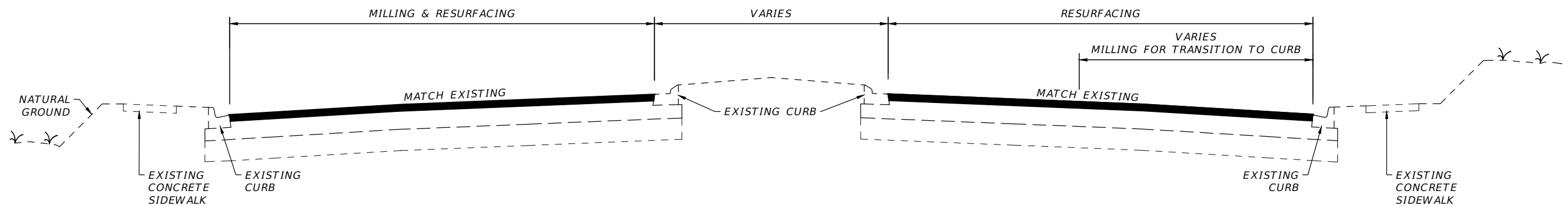

TYPICAL URBAN SECTION

MILLING & RESURFACING NOTES

1. Allowable work hours shall be as designated In Exhibit J-Special Provisions. Scheduling of all work is subject to the prior approval of the Project Manager, The Contractor's attention is directed to the highly seasonal nature of traffic volumes and the Engineer's application of discretion to minimize disruption during high volume times.
2. Where connecting to an existing driveway is necessary, a smooth transition to edge of pavement shall be established to the satisfaction of the Project Manager. No feathered joints.
3. The Contractor shall protect private property. Any damage caused by the Contractor in the performance of this work shall be corrected to the satisfaction of the Project Manager and property owner at the Contractor's expense. No direct payment will be made.
4. Any damage to state, county , or local roads caused by the Contractor's hauling activities shall be repaired by The Contractor to the satisfaction of the Project Manager at the Contractor's expense , no direct payment will be made.
5. Texas swale locations and elevations will be established and laid out by the County. The Contractor is responsible for all other stakeout of the project and establishment of any necessary lines, grades, slope stakes, utility locations or any other stakeout necessary to complete the work. The cost of staking shall be subsidiary to other items of work, no direct payment will be made.
6. The Slate of Florida does not require a project specific National Pollutant Discharge Elimination System (NPDES) permit for construction activities that disturb less than one acre of land. However, the Contractor is responsible for Installation, maintenance, and removal of any necessary best management practices devices necessary to prevent sediment from leaving the project site. The cost of this work is subsidiary to other Items, no direct payment will be made,
7. Exact limits of milling and resurfacing work within each specific segment will be established by the Project Manager or Designee prior to commencement of work. No payment will be made for work outside the authorized limits of resurfacing.
8. Milling and/or resurfacing shall be performed such that the original cross-slopes of the roadway are maintained to the extent practical . Any deviations shall be subject to prior authorization of the Project Manager.
9. Milling for transition of resurfacing to meet curb and gutter in urban section will be paid under Item 327 -70 -6 Milling Exist Asphalt Pavt, 1.5 " Avg Depth.
10. Shoulders shall be restored to the satisfaction of the Engineer prior to Final Acceptance of the work. Payment for all shoulder restoration shall be included in the following items :
  - 570 -9 -AA Sodding, Square Yard will be paid for sodding of any areas authorized by the Engineer to be sodded. AA designates the sod variety used at the discretion of the Engineer. All work necessary for shoulder restoration shall be included in these three items of work, any other activities necessary shall be subsidiary to these items, no other direct payment will be made.
11. Clean-up of the project shall be accomplished by the Contractor to the Satisfaction of the Project Manager. Cleanup shall be subsidiary to other items of work, no direct payment will be made.
12. MOT to be in compliance with FDOT 102 -600 series.

REVISIONS			
DATE	DESCRIPTION	DATE	DESCRIPTION
----	----	----	----



LEE COUNTY DEPARTMENT OF TRANSPORTATION		
ROAD NAME	COUNTY	PROJECT ID
	LEE	

TYPICAL SECTION

SHEET NO.  
2

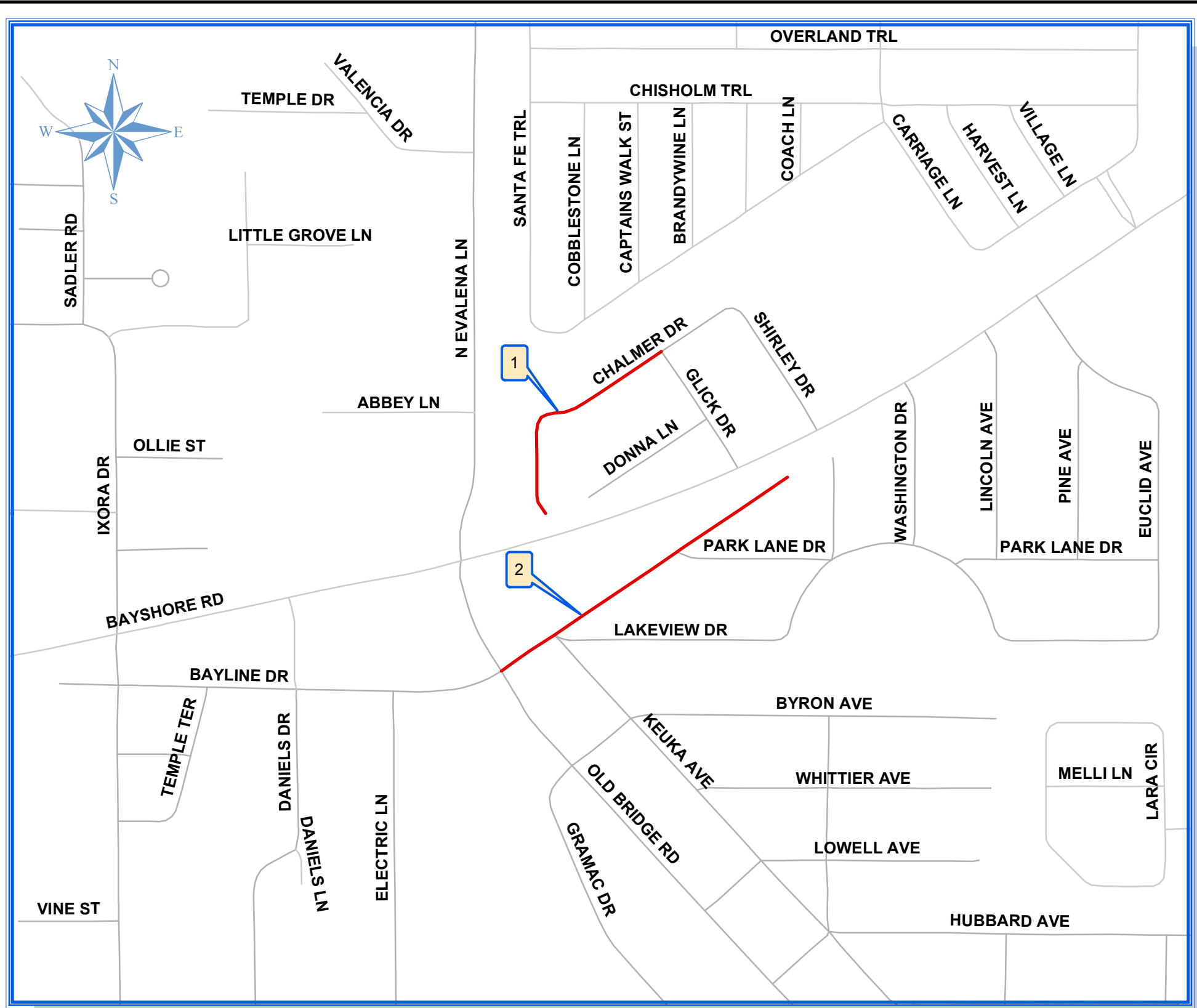

# RESURFACING PROJECT LOCATION MAP

## 3 / F Y - 2022

### COUNTY WIDE ARTERIAL & COLLECTORS

#	STREET	TO	FROM	LENGTH	WIDTH
1	CHALMER DR	GLICK DR	EOP	1000	18
2	BAYLINE DR	OLD BRIDGE RD	EOP	1285	27

**Resurfacing Project  
Location Map  
CW Arterial & Collectors**



Countywide  
Art & Collectors  
3 / F Y 2022

---

Public Works  
South west  
Florida  
(239) 533-8900

Dept of Transportation  
1500 Monroe St  
Ft Myers, Florida, 33901

---

Drawn By: JLN

---

Checked By: FJL

---

Date: 3/10/2022

**COUNTYWIDE**

---

Sheet 3 of 7

# RESURFACING PROJECT LOCATION MAP

## 3 / F Y - 2022

### COUNTY WIDE ARTERIAL & COLLECTORS

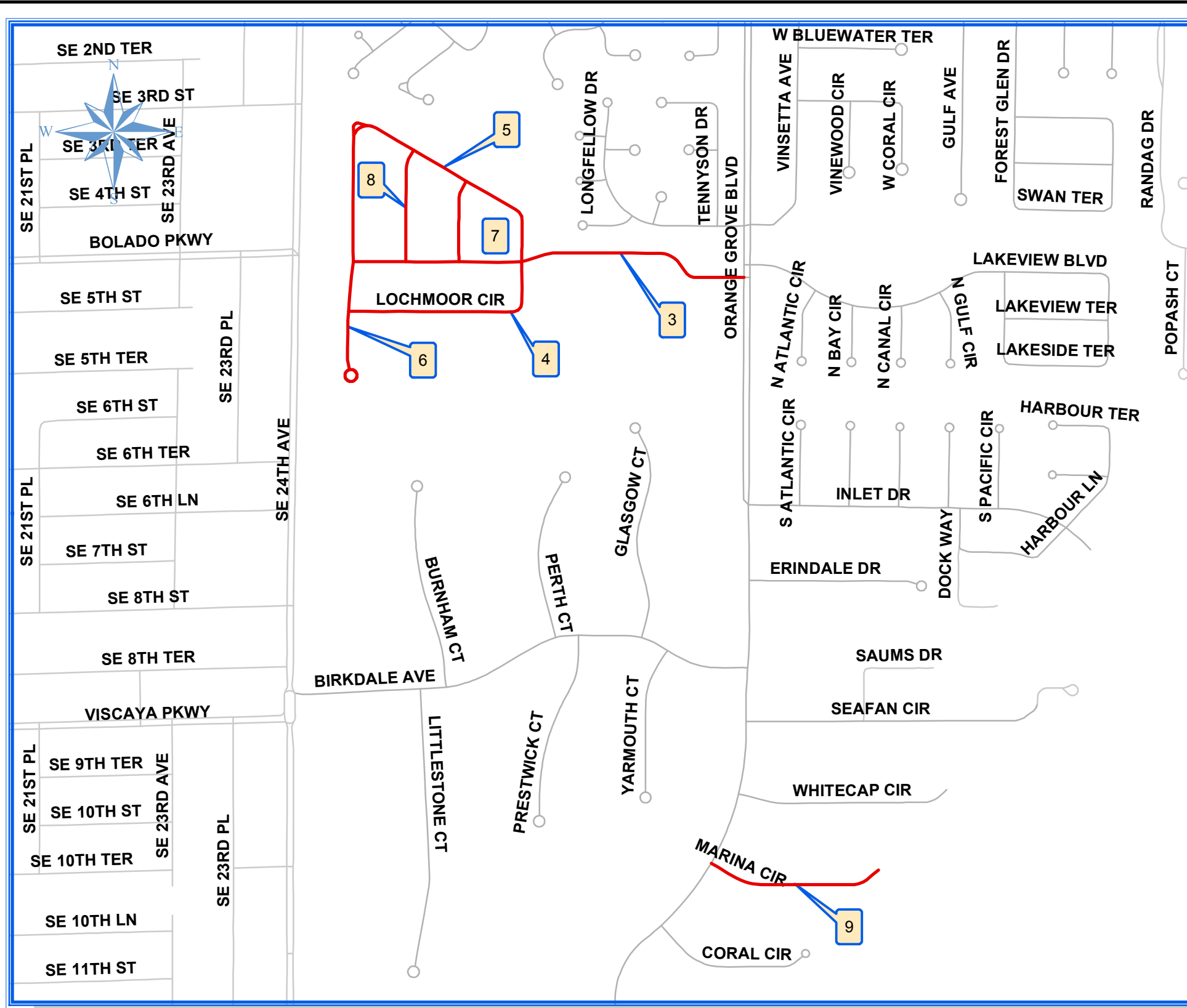

#	STREET	TO	FROM	LENGTH	WIDTH
3	W LAKEVIEW BLVD	ORANGE GROVE BLVD	INVERNESS CIR	2500	21
4	LOCHMOOR CIR	LOCHNESS CT	INVERNESS CIR	1700	21
5	INVERNESS CIR	LOCHMOOR CIR	LOCHNESS CT	2115	21
6	LOCHNESS CT	INVERNESS CIR	EOP	925	21
7	GALLOWAY DR	INVERNESS CIR	W LAKEVIEW BLVD	515	20
8	STONEHAVEN DR	INVERNESS CIR	W LAKEVIEW BLVD	710	21
9	MARINA CIR	ORANGE GROVE BLVD	EOP	1110	21

**Resurfacing Project  
Location Map  
CW Arterial & Collectors**



Countywide  
Art & Collectors  
3 / F Y 2022

Public Works  
South west  
Florida  
(239) 533-8900

Dept of Transportation  
1500 Monroe St  
Ft Myers, Florida, 33901

Drawn By: JLN

Checked By: FJL

Date: 3/10/2022

**COUNTYWIDE**

Sheet 4 of 7

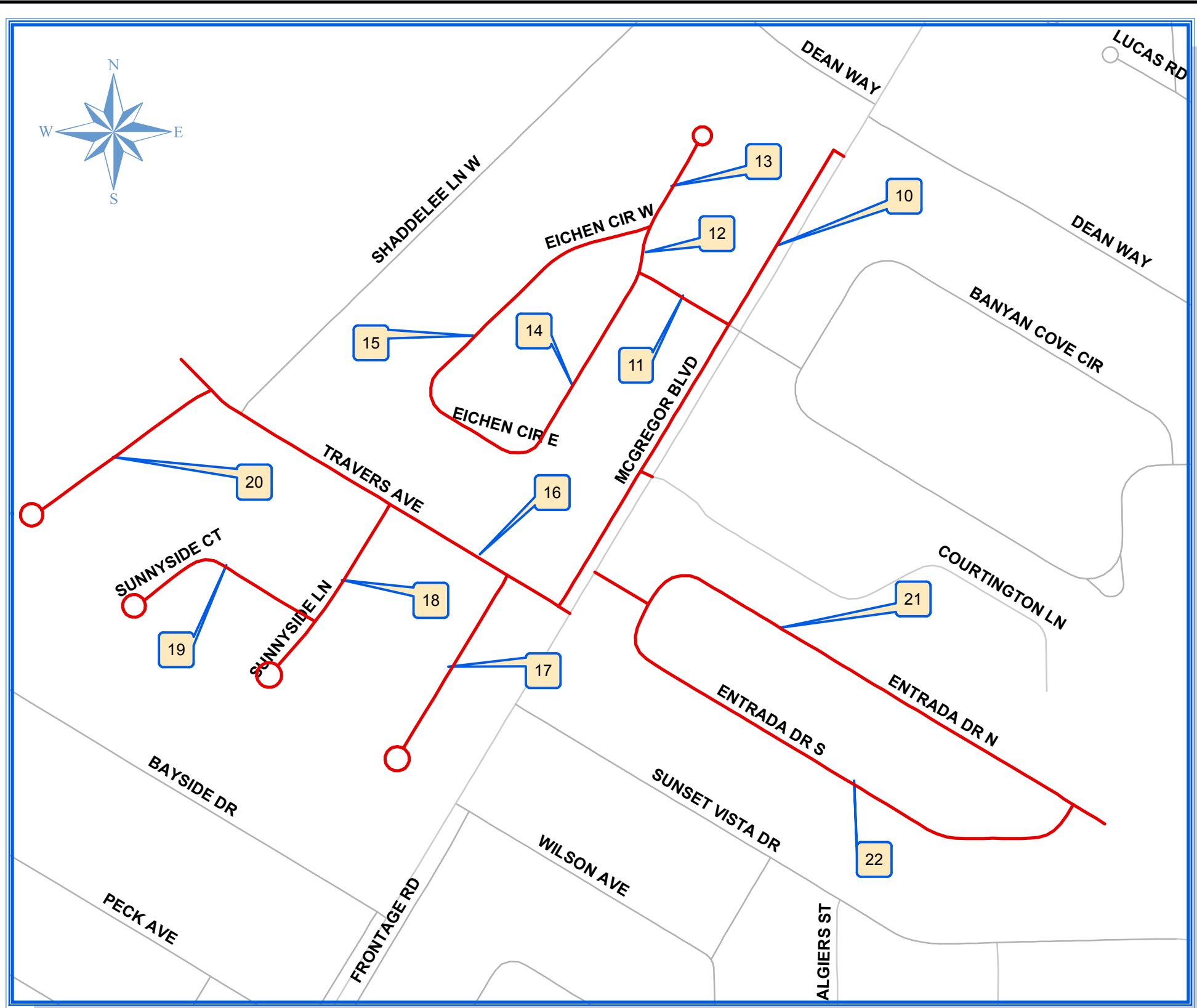

**RESURFACING  
PROJECT LOCATION  
MAP  
3 / FY - 2022  
COUNTY WIDE  
ARTERIAL & COLLECTORS**

#	STREET	TO	FROM	LENGTH	WIDTH
10	MCGREGOR BLVD	EOP	TRAVERS AVE	1575	14
11	EVENTIDE BLVD	MCGREGOR BLVD	EICHEN CIR E	330	35
12	EICHEN CIR	SONNEN CT	EVENTIDE BLVD	150	18
13	SONNEN CT	EICHEN CIR	EOP	400	24
14	EICHEN CIR E	EVENTIDE BLVD	EICHEN CIR W	780	18
15	EICHEN CIR W	EICHEN CIR E	SONNEN CT	960	18
16	TRAVERS AVE	MCGREGOR BLVD	EOP	1320	18
17	SILVERY LN	TRAVERS AVE	EOP	770	18
18	SUNNYSIDE LN	TRAVERS AVE	EOP	770	19
19	SUNNYSIDE CT	TRAVERS AVE	EOP	780	19
20	RIVERSIDE LN	TRAVERS AVE	EOP	770	19
21	ENTRADA DR N	MCGREGOR BLVD	EOP	1690	19
22	ENTRADA DR S	ENTRADA DR N	ENTRADA DR N	1560	18

**Resurfacing Project  
Location Map  
CW Arterial & Collectors**



Countywide  
Art & Collectors  
3 / FY 2022  
  
Public Works  
South west  
Florida  
(239) 533-8900

Dept of Transportation  
1500 Monroe St  
Ft Myers, Florida, 33901  
  
Drawn By: JLN  
Checked By: FJL  
Date: 3/10/2022

**COUNTYWIDE**  
  
**Sheet 5 of 7**

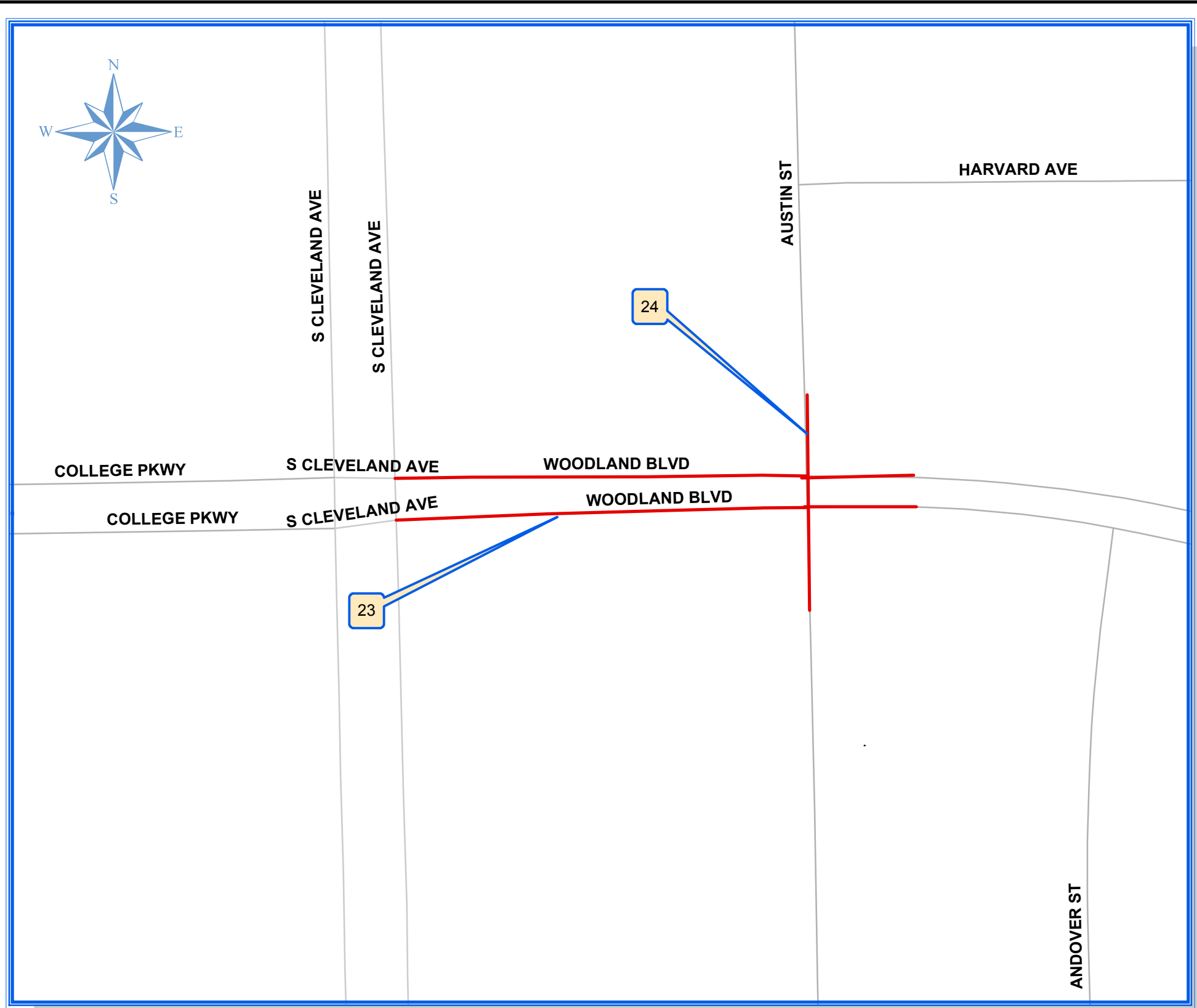
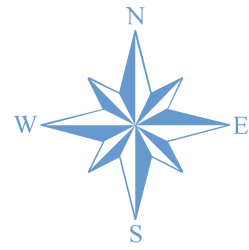

**RESURFACING  
PROJECT LOCATION  
MAP  
3 / F Y - 2022  
COUNTY WIDE  
ARTERIAL & COLLECTORS**

#	STREET	TO	FROM	LENGTH	WIDTH
23	WOODLAND BLVD	S CLEVELAND AVE	ANDOVER ST	580	18
24	AUSTIN ST	JOINT	JOINT	200	18

**Resurfacing Project  
Location Map  
CW Arterial & Collectors**



Countywide  
Art & Collectors  
3 / F Y 2022

Public Works  
South west  
Florida  
(239) 533-8900

Dept of Transportation  
1500 Monroe St  
Ft Myers, Florida, 33901

Drawn By: JLN

Checked By: FJL

Date: 3/10/2022

**COUNTYWIDE**

Sheet 6 of 7

# RESURFACING PROJECT LOCATION MAP

## 3 / FY - 2022

### COUNTY WIDE ARTERIAL & COLLECTORS

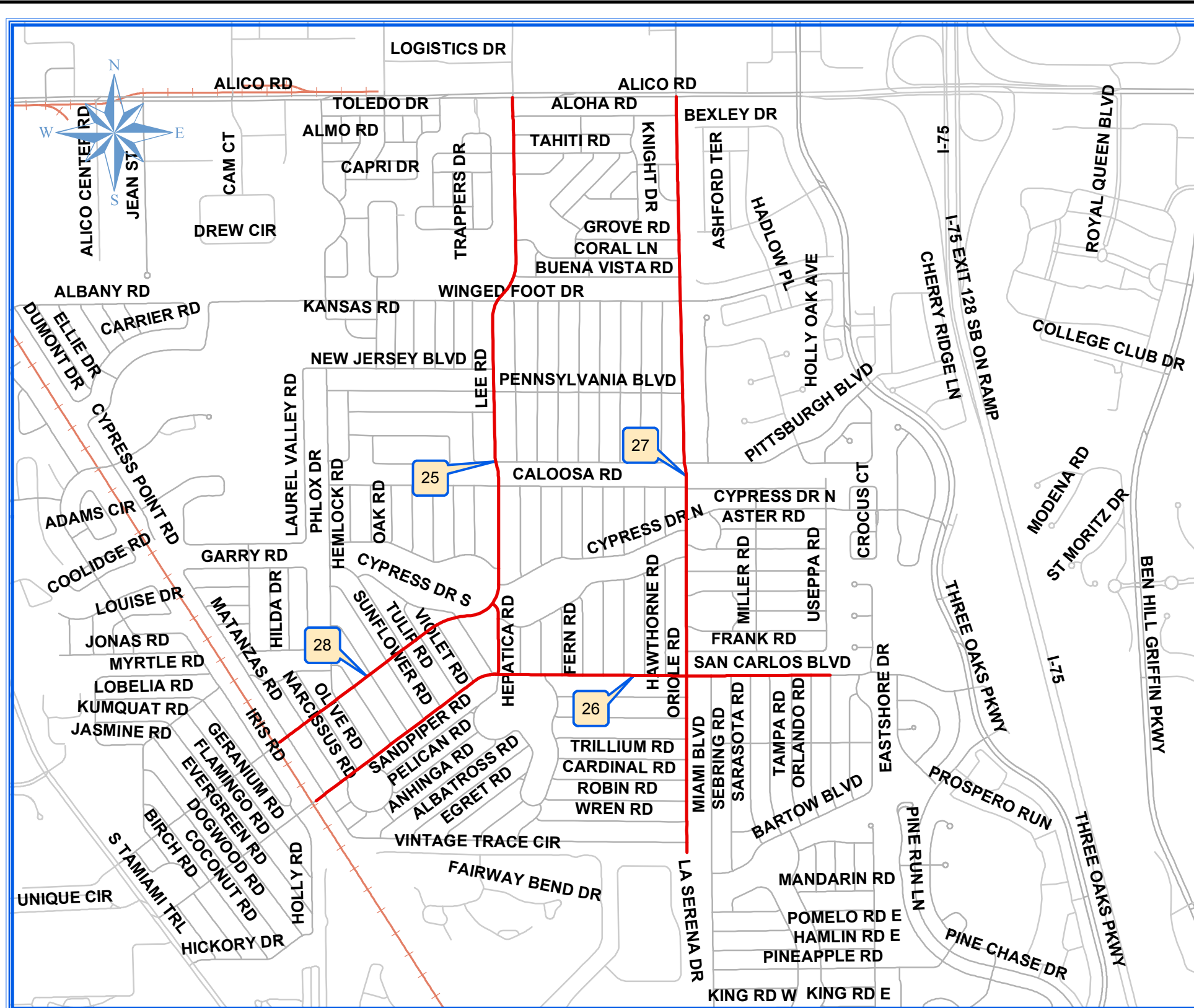

#	STREET	TO	FROM	LENGTH	WIDTH
25	LEE RD	ALICO RD	SAN CARLOS BLVD	8125	32
26	SAN CARLOS BLVD	WINTER HAVEN RD	RAIL RPAD	7750	32
27	ORIOLE RD	ALICO RD	S EOP	10600	32
28	SANIBEL BLVD	LEE RD	RAIL RPAD	3500	32

**Resurfacing Project  
Location Map  
CW Arterial & Collectors**



Countywide  
Art & Collectors  
3 / FY 2022

Public Works  
South west  
Florida  
(239) 533-8900

Dept of Transportation  
1500 Monroe St  
Ft Myers, Florida, 33901

Drawn By: JLN

Checked By: FJL

Date: 3/10/2022

**COUNTYWIDE**

Sheet 7 of 7

LEE COUNTY  
DEPARTMENT OF TRANSPORTATION

CONTRACT PLANS

PROJECT ID 22016  
LEE COUNTY

INDEX OF ROADWAY PLANS

SHEET NO.	SHEET DESCRIPTION
1	KEY SHEET
2	GENERAL NOTES
3	ROADWAY PLAN

WOODLAND BLVD AND AUSTIN ST  
INTERSECTION IMPROVEMENTS

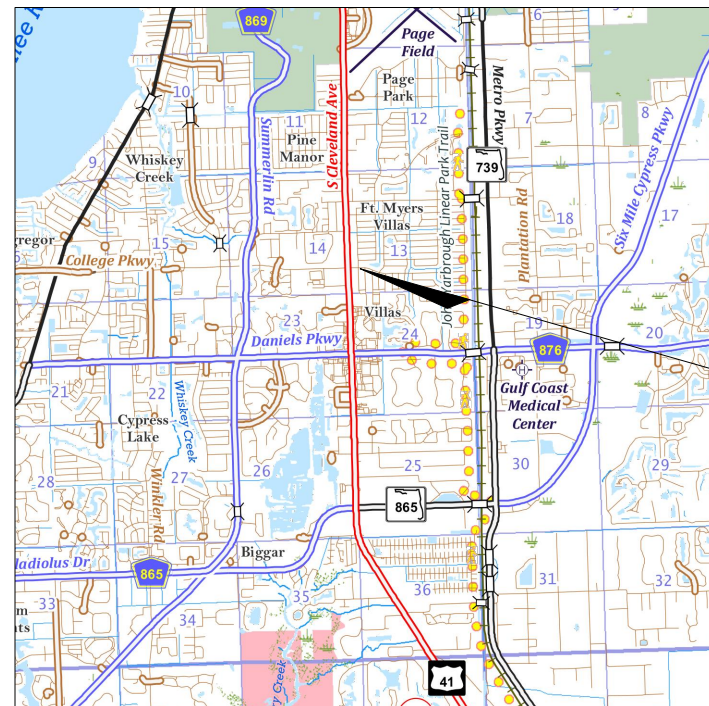
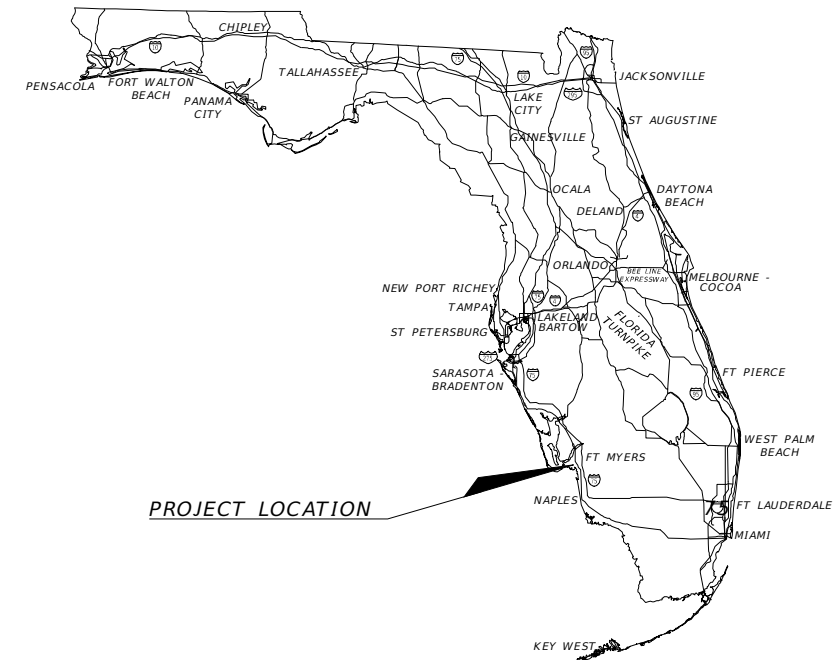

GOVERNING STANDARD PLANS:  
Florida Department of Transportation, FY2021-22 Standard plans for Road and Bridge Construction and applicable Interim Revisions (Irs).

Standard Plans for Road Construction and associated Irs are available at the following website:  
<https://www.fdot.gov/design/standardplans/sprbc.shtm>

APPLICABLE IRs: N/A

Standard Plans for Bridge Construction are included in the Structures Plans Component.

GOVERNING STANDARD SPECIFICATIONS:  
Florida Department of Transportation, January, 2020 Standard Specifications for Road and Bridge Construction at the following website:  
<http://www.fdot.gov/programmanagement/Implemented/SpecBooks>

FISCAL YEAR	SHEET NO.
2022	1

THE OFFICIAL RECORD OF THIS SHEET IS THE ELECTRONIC FILE DIGITALLY SIGNED AND SEALED UNDER RULE 61G15-23.004, F.A.C.



PROJECT GENERAL NOTES:

1. THIS IS NOT A SURVEY. INFORMATION IS BASED ON AERIAL MAPS, PLATS AND FIELD DATA. CONTRACTOR TO VERIFY ACCURACY OF PLAN BEFORE DEMOLITION OF SIDEWALKS.
2. ANY PUBLIC LAND CORNER WITHIN THE LIMITS OF CONSTRUCTION IS TO BE PROTECTED. IF A CORNER MONUMENT IS IN DANGER OF BEING DESTROYED AND HAS NOT BEEN PROPERLY REFERENCED. THE PROJECT ENGINEER SHOULD NOTIFY THE COUNTY PROJECT MANAGER WITHOUT DELAY BY TELEPHONE.
3. THE CONTRACTOR IS TO MAINTAIN AND KEEP STREET NAME IDENTIFICATION VISIBLE DURING CONSTRUCTION OPERATIONS IN ORDER TO FACILITATE EMERGENCY VEHICLE TRAFFIC.
4. COST OF LONGITUDINAL AND PERPENDICULAR SAW CUTS AT PAVEMENT LOCATIONS ARE INCIDENTAL TO THE PAVEMENT CONSTRUCTION.
5. CARE IS TO BE TAKEN NOT TO DISTURB EXISTING TREES AND SHRUBS OUTSIDE OF THE WORK ZONE. THE CONTRACTOR WILL BE RESPONSIBLE FOR THE REPLACEMENT OF ANY OF THESE ITEMS THAT ARE DAMAGED DURING CONSTRUCTION.
6. EXISTING DRAINAGE STRUCTURES WITHIN CONSTRUCTION LIMITS SHALL REMAIN UNLESS OTHERWISE NOTED.
7. EXISTING UTILITIES ARE TO REMAIN IN PLACE UNLESS OTHERWISE NOTED. TWO FULL BUSINESS DAYS PRIOR TO DIGGING THE CONTRACTOR SHALL CALL SUNSHINE STATE ONE CALL AT 800-432-4770, AND THE UTILITY OWNER AND REQUEST UTILITY LOCATIONS.
8. THE CONTRACTOR SHALL BE ADVISED THAT PROPERTIES ADJACENT TO THE PROJECT HAVE ELECTRIC, TELEPHONE, GAS, WATER, AND/OR SEWER SERVICE LATERALS WHICH MAY NOT BE SHOWN IN THE PLANS. THE CONTRACTOR MUST REQUEST THE LOCATION OF THESE LATERAL SERVICES FROM THE UTILITY COMPANIES. THE ADDITIONAL COST OF EXCAVATING, INSTALLING, BACKFILLING AND COMPACTING AROUND THESE LATERAL SERVICES MUST BE INCLUDED IN THE BID RELATED ITEM FOR WORK BEING DONE.
9. THE MAXIMUM VERTICAL DISCONTINUITY (REVEAL) SHALL BE 1/2" IF BEVELED WITH A SLOPE NO STEEPER THAN 50% (1:2). IF IT IS NOT BEVELED THAT MAXIMUM REVEAL SHALL BE 1/4".

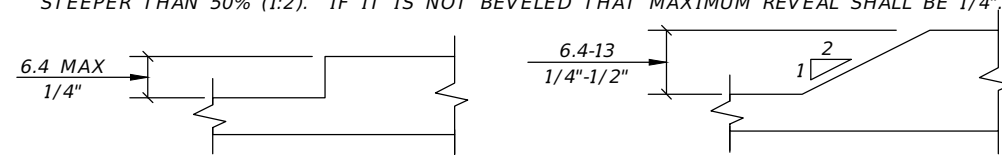

10. IT SHALL BE THE CONTRACTORS RESPONSIBILITY TO MAINTAIN PEDESTRIAN ACCESS WITHIN THE CONSTRUCTION LIMITS. IF NOT FEASIBLE DUE TO SAFETY CONCERNS, AND UPON LEE COUNTY'S APPROVAL, THE CONTRACTOR MAY PROVIDE SIGNAGE AND CONTROLS TO CLOSE LIMITED SIDEWALKS WITH THE RIGHT-OF-WAYS, CLOSURE SHALL BE AT THE COST OF THE CONTRACTOR AND DETOURS MUST BE PROVIDED TO DIRECT AND REDIRECT PEDESTRIAN PATTERNS AT CONTROLLED INTERSECTIONS.
10. REFER TO THE FDOT STANDARD SPECIFICATIONS FOR ROAD AND BRIDGE CONSTRUCTION LATEST EDITION TRAFFIC CONTROLS SIGNALS AND DEVICES.
11. ALL AREAS OF EXPOSED EARTH RESULTING FROM CONSTRUCTION ACTIVITIES SHALL BE SODDED UPON COMPLETION OF CONSTRUCTION.
12. ALL SIDEWALK DAMAGED BY THE CONTRACTOR OR SUBCONTRACTOR SHALL BE REPLACED AT THE EXPENSE OF THE CONTRACTOR, AT THE DIRECTION OF THE ENGINEER.
13. THE CONTRACTOR SHALL SUBMIT FOR APPROVAL TO THE LCDOT PROJECT MANAGER, SHOP DRAWINGS ON ALL PROPOSED DRAINAGE STRUCTURES. FAILURE TO OBTAIN APPROVAL BEFORE INSTALLATION MAY RESULT IN REMOVAL OR REPLACEMENT AT THE CONTRACTORS EXPENSE. ALL SHOP DRAWINGS ARE TO BE REVIEWED AND APPROVED BY THE CONTRACTOR SIGNATURE PRIOR TO SUBMITTAL TO THE LCDOT PROJECT MANAGER.

MAINTENANCE OF TRAFFIC:

1. CONTRACTOR SHALL SUBMIT A MAINTENANCE OF TRAFFIC PLAN TO LEE COUNTY DOT FOR APPROVAL.

GENERAL NOTES:

1. THE HORIZONTAL DATUM IS NAD83 FLORIDA STATE PLANES, WEST ZONE, US FOOT. ELEVATIONS REFER TO NORTH AMERICAN VERTICAL DATUM OF 1988 (NAVD 88) THIS IS NOT A SURVEY.
2. PROPOSED NEW SIDEWALK SHALL BE CONSTRUCTED WITH 6" THICK CONCRETE. SIDEWALKS ARE DESIGNED AND INTENDED FOR PEDESTRIAN TRAFFIC ONLY. ALL SIDEWALK AND CURB CUTS SHALL BE IN ACCORDANCE WITH FDOT STD PLANS INDEX 522-002 AND SHALL INCLUDE INSET DETECTABLE WARNING SURFACES. VALLEY GUTTER ADJACENT TO SIDEWALK CROSSINGS CUTS SHALL DEVIATE FROM STANDARD DETAIL BY NOT EXCEEDING 12:1 SLOPES.
3. THE CONTRACTOR SHALL NOTIFY THE ENGINEER, OWNER REPRESENTATIVE AND APPROPRIATE AGENCY A MINIMUM OF 72 HOURS PRIOR TO ALL INSPECTIONS REQUIRED.
4. THE CONTRACTOR SHALL OBTAIN ANY CLEARING, VEGETATION REMOVAL OR RIGHT-OF-WAY PERMITS REQUIRED FOR THIS PROJECT. ALL DEBRIS SHALL BE REMOVED FROM SITE AND PROPERLY DISPOSED OF.
5. SUBGRADE AND LIMEROCK BASE COURSES (ROADS, DRIVEWAYS, AND SIDEWALK) TO BE COMPACTED 98% MINIMUM OF THE MAXIMUM DENSITY AS SPECIFIED BY AASHTO T-180 TESTING. CONTRACTOR SHALL PROVIDE THE ENGINEER SATISFACTORY DENSITY TESTS FOR SUBGRADE AND LIMEROCK PRIOR TO PAYMENT OR FINAL ACCEPTANCE. EXCESS ROAD BASE AND COMPACTED SOIL SHALL BE REMOVED FROM ALL LANDSCAPING AREAS PRIOR TO FINAL GRADING. UTILITY TRENCHES SHALL BE COMPACTED TO 95% MINIMUM OF THE MAXIMUM DENSITY AS SPECIFIED BY AASHTO-99. ALL GEOTECHNICAL TESTING SHALL BE THE RESPONSIBILITY OF THE CONTRACTOR. NO SEPARATE PAYMENT SHALL BE MADE FOR GEOTECHNICAL TESTING.
6. LIMITS OF CONSTRUCTION SHALL BE CONFINED TO THE EXISTING RIGHTS-OF-WAYS AND EASEMENTS SHOWN ON THE PLANS.

SIGNING AND MARKING NOTES:

1. ANY EXISTING SINGLE-POST AND MULTI-POST SIGNS WITHIN THE PROJECT LIMITS SHALL REMAIN UNLESS OTHERWISE NOTED.
2. ANY EXISTING SIGN TO REMAIN THAT IS DISTURBED DURING CONSTRUCTION OR RELOCATED SHALL BE RESET ACCORDING TO THE FDOT STANDARD PLANS INDEXES 700-010 AND 700-101 FOR HEIGHT, OFFSET AND METHOD OF INSTALLATION.
3. CAUTION SHALL BE EXERCISED WHILE RELOCATING EXISTING SIGNS SO AS TO PREVENT DAMAGE TO THE SIGNS. IF THE SIGNS ARE DAMAGED BEYOND USE, AS DETERMINED BY THE ENGINEER, THEY SHALL BE REPLACED BY THE CONTRACTOR AT HIS/HER EXPENSE.
4. EXISTING PAVEMENT MARKINGS WHICH CONFLICT WITH THE PROPOSED PAVEMENT MARKINGS SHALL BE REMOVED BY HYDROBLASTING.
5. ANY SIGNS MOUNTED OVER A SIDEWALK SHALL HAVE A STANDARD VERTICAL CLEARANCE OF 8 FEET AND HORIZONTAL CLEARANCE OF 2 FEET TO THE POLE.
6. REFER TO THE LATEST EDITION OF LEE COUNTY DOT SIGN INSTALLATION SPECIFICATIONS LOCATED AT [HTTPS://WWW.LEE.GOV.COM/DOT/TRAFFIC/TRAFFICSIGNINSTALLATION](https://www.lee.gov.com/dot/traffic/trafficsigninstallation).

REVISIONS

DATE	DESCRIPTION	DATE	DESCRIPTION
----	----		

<b>LEE COUNTY DEPARTMENT OF TRANSPORTATION</b>		
ROAD NAME	COUNTY	PROJECT ID
WOODLAND BLVD	LEE	22016

GNNTRD01 - 4

SHEET NO.

----

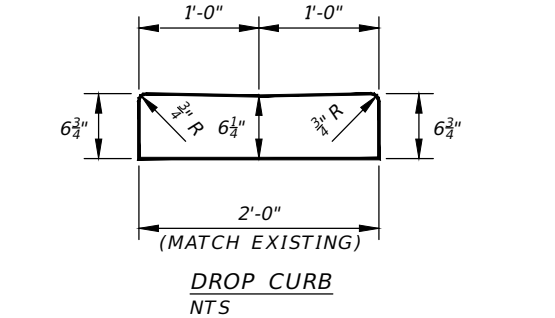
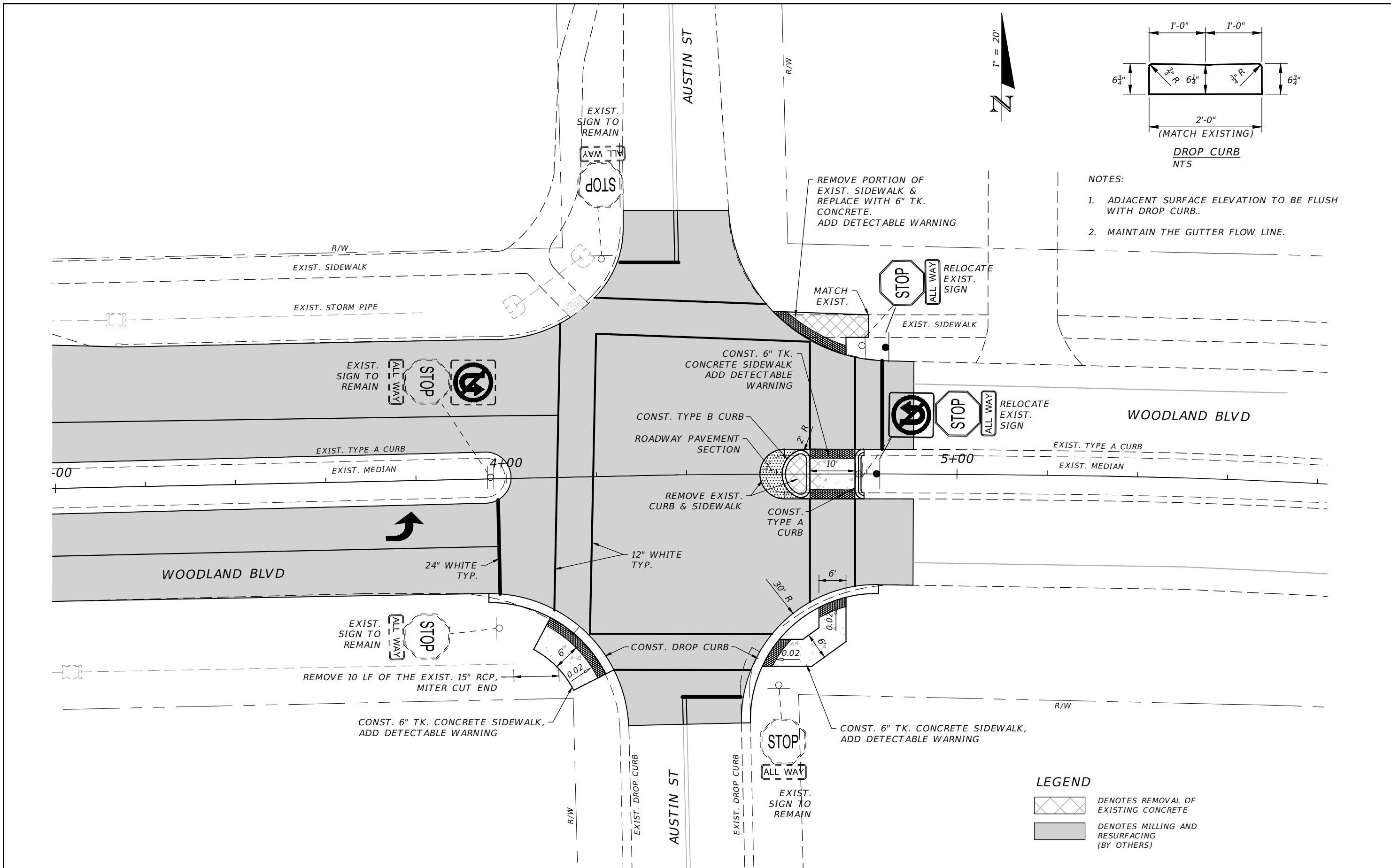

- NOTES:
1. ADJACENT SURFACE ELEVATION TO BE FLUSH WITH DROP CURB..
  2. MAINTAIN THE GUTTER FLOW LINE.

**LEGEND**

	DENOTES REMOVAL OF EXISTING CONCRETE
	DENOTES MILLING AND RESURFACING (BY OTHERS)

REVISIONS			
DATE	DESCRIPTION	DATE	DESCRIPTION

<b>LEE COUNTY DEPARTMENT OF TRANSPORTATION</b>		
ROAD NAME	COUNTY	PROJECT ID
WOODLAND BLVD	LEE	22016

<b>ROADWAY PLAN</b>	SHEET NO.  4
---------------------	--------------------

THE OFFICIAL RECORD OF THIS SHEET IS THE ELECTRONIC FILE DIGITALLY SIGNED AND SEALED UNDER RULE 6G15-23.004, F.A.C.