

DOCK CONSTRUCTION NOTES:

1. PRIOR TO EXCAVATION CONTRACTOR TO FIELD VERIFY LOCATION OF ALL UTILITIES, IRRIGATION AND DRAINS.
2. THE CONTRACTOR SHALL DEMOLISH, REMOVE, AND DISPOSE OF IN AN APPROVED OFF SITE DISPOSAL AREA THE EXISTING TIMBER PILES, DOCK AND ASSOCIATED DEBRIS WITHIN THE LIMITS OF THE PROJECT.
3. BEVEL TOP EDGE OF PILES AND DECKING TO REMOVE SPLINTERS.
4. RECESS ALL OUTBOARD FACING BOLT HEADS FLUSH WITH PILE.
5. ALL FASTENERS AND HARDWARE SHALL BE 304 STAINLESS STEEL.
6. ALL PILES SHALL ACHIEVE A MINIMUM PENETRATION OF 40 PERCENT OF THE OVERALL LENGTH OR A MINIMUM OF 8 FT, WHICHEVER IS GREATER.
7. ALL PILES SHALL BE WRAPPED WITH A 0.30 MIL SHEETING MANUFACTURED BY PERMA PILE OR APPROVED EQUAL. THE SHEETING IS TO PREVENT PRESERVATIVE TREATMENT FROM LEACHING INTO THE ENVIRONMENT AND TO PROHIBIT MARINE BORER ATTACK. THE SHEETING MUST OVERLAP A MINIMUM OF 6 INCHES AT SEAMS AND LAP JOINTS AND PROVIDE A COMPLETE BARRIER TO THE TIMBER. MINIMUM 1 1/4" LONG 304 STAINLESS STEEL ROOFING NAILS, SPACED NO GREATER THAN 3 INCHES APART, SHALL BE USED FOR ATTACHING THE SHEETING. THE SHEETING SHALL EXTEND FROM BOTTOM OF CLAMPS DOWN TO 1 FOOT BELOW THE EXISTING MUDLINE. VERTICAL SEAMS SHALL BE ORIENTATED TOWARD THE UNDERSIDE OF THE PIER.
8. ALL MOORING PILES AND DOCK PILES EXTENDING ABOVE THE DECK SHALL BE FITTED WITH A BLACK POLYETHYLENE CONE PILE CAP MANUFACTURED BY INTERNATIONAL DOCK PRODUCTS, INC. OR APPROVED EQUIVALENT IN ACCORDANCE WITH MANUFACTURER'S SPECIFICATIONS. EACH PILE SHALL BE MEASURED AND FITTED WITH THE CORRECT SIZE CAP. CAPS SHOULD FIT SNUG, BUT NOT CAUSE DEFORMATION. GAPS BETWEEN THE PILE AND CAP SHALL NOT EXCEED 1/2".
9. DECKING SHALL BE 2"x6" TANDECK (BY TANGENT TECHNOLOGIES, LLC) OR APPROVED EQUIVALENT. COLOR TO BE DETERMINED BY COUNTY. DECKING SHALL BE FLUSH WITH TOP OF CAP BEAM.
10. STRINGER SPLICES SHALL BE STAGGERED.
11. FIRE EXTINGUISHERS SHALL BE INSTALLED IN ACCORDANCE WITH NFPA 303.

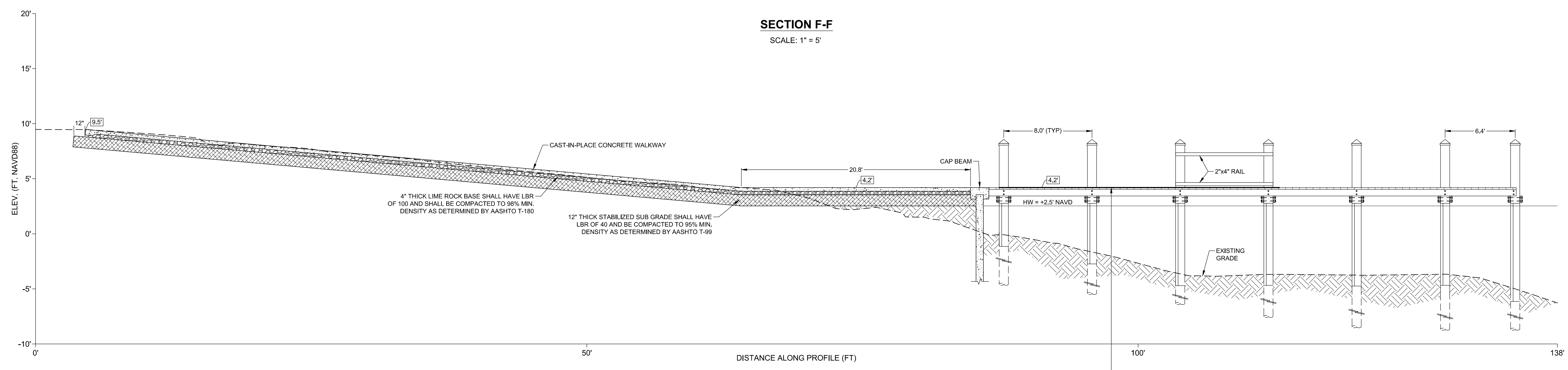
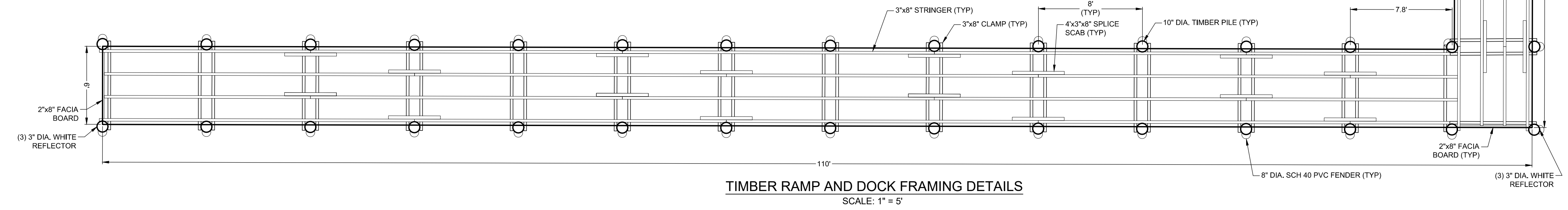
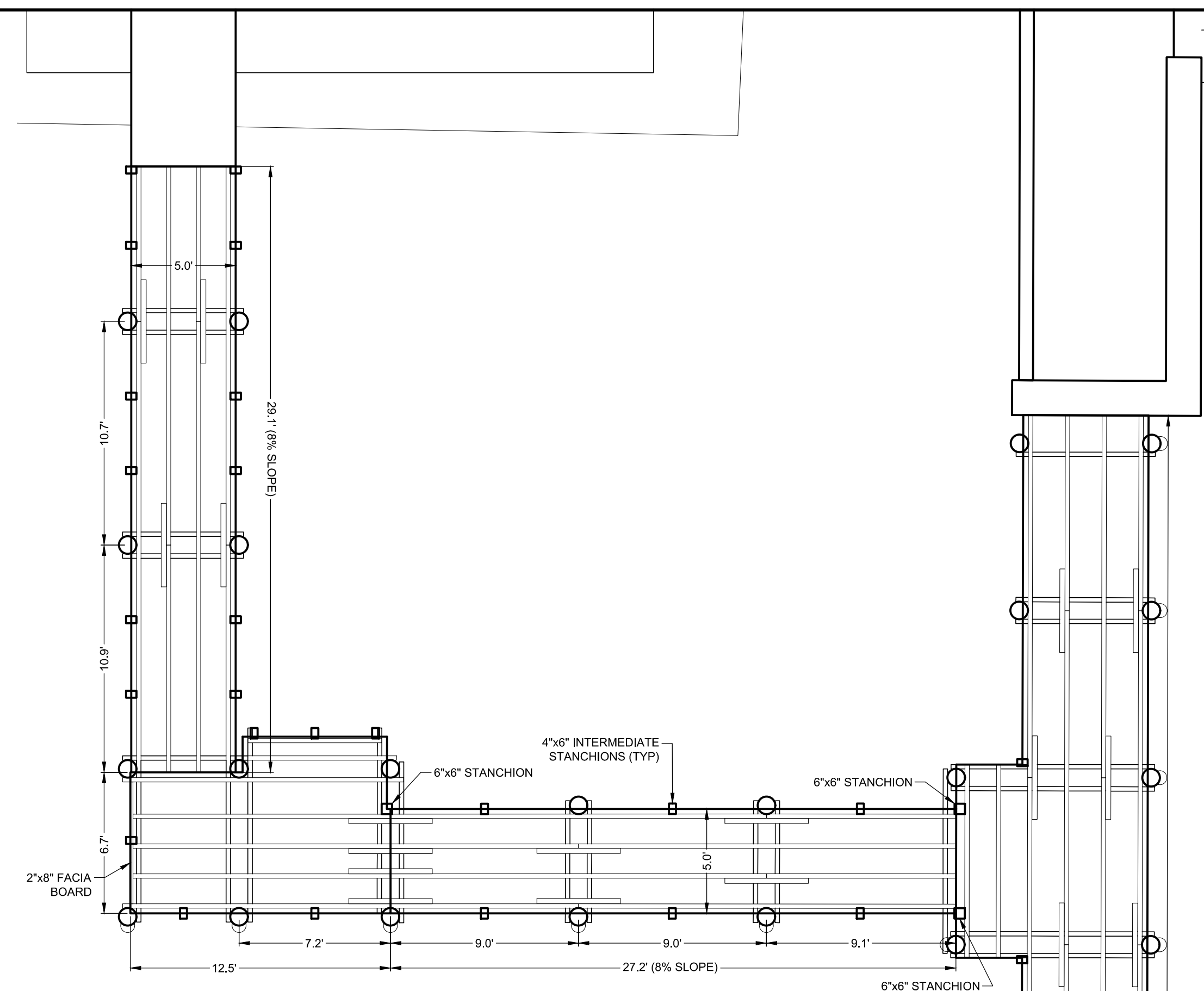
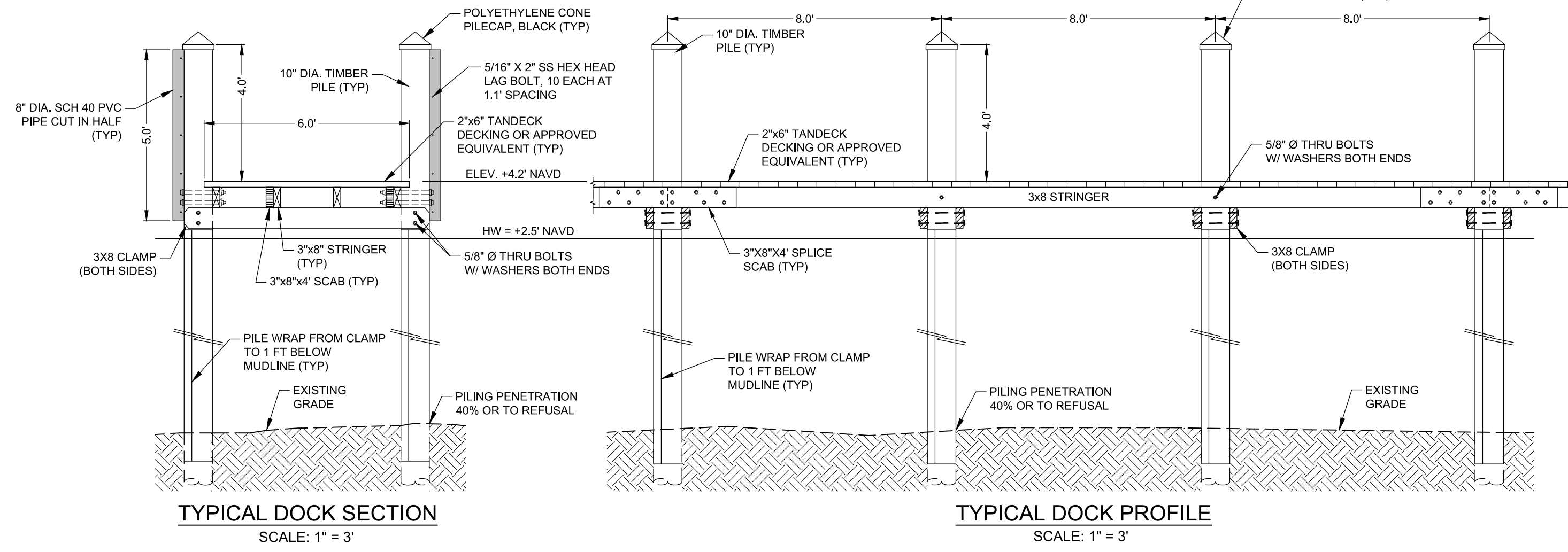

DATE: 6/4/2019
SCALE: AS NOTED
DRAWN: SDB
CHECKED: MAK
SEC: TWP.
ACAD NO: 13029-C.dwg
REF. NO: 13.029

CLIENT: LEE COUNTY BOARD OF COMMISSIONERS
TITLE: ALVA BOAT RAMP RENOVATION DOCK REPLACEMENT DETAILS

CIVIL ENGINEERING SURVEY & MAPPING COASTAL ENGINEERING ENVIRONMENTAL PLANNING SERVICES
PHONE: (239)643-2324
FAX: (239)643-1143
www.coastal-engineering.com
E-Mail: info@cecivil.com

COASTAL ENGINEERING CONSULTANTS INC.
A CECI GROUP COMPANY
Serving Florida Since 1977
3105 SOUTH HORSESHOE DRIVE
NAPLES, FLORIDA 34104

STATE OF FLORIDA PROFESSIONAL ENGINEERS LICENSE No. 58654

SHEET 7
FILE NO.: 13029-C-7