

SUMMERLIN TURN LANES LANDSCAPE PLANS

SHEET INDEX

L-1 TO L-3 LANDSCAPE PLANS



NO.	DATE	BY	REVISIONS - DESCRIPTION

APPROVED BY:
GREGORY J. DISERIO, RLA
REGISTERED LANDSCAPE ARCHITECT
FLORIDA CERTIFICATE NO. **840**

 PUBLIC WORKS
LEE COUNTY
SOUTHWEST
FLORIDA
1500 MONROE STREET
(239) 479-8900

DEPARTMENT
of
TRANSPORTATION
FORT MYERS, FLORIDA 33901

SUMMERLIN TURN LANES
LANDSCAPE PLANS

SHEET NO.
COVER

\$USER\$

\$DATE\$

\$TIME\$

\$FILE\$

EXISTING R.O.W.

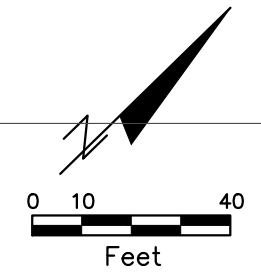

£ SURVEY
SUMMERLIN ROAD

BEGIN PROJECT
BEGIN CONSTRUCTION
STA. 308+04.94
56.94 RT.

POT STA. 306+22.00

TYPICAL LOCATION OF EXISTING TREES PREVIOUSLY
REMOVED DUE TO HURRICANE IRMA. LOCATE
REMOVE AND CAP ALL IRRIGATION LINES IN
CONFLICT WITH CONSTRUCTION. COORDINATE WITH
LCDOT FOR LOCATION OF CROSSINGS

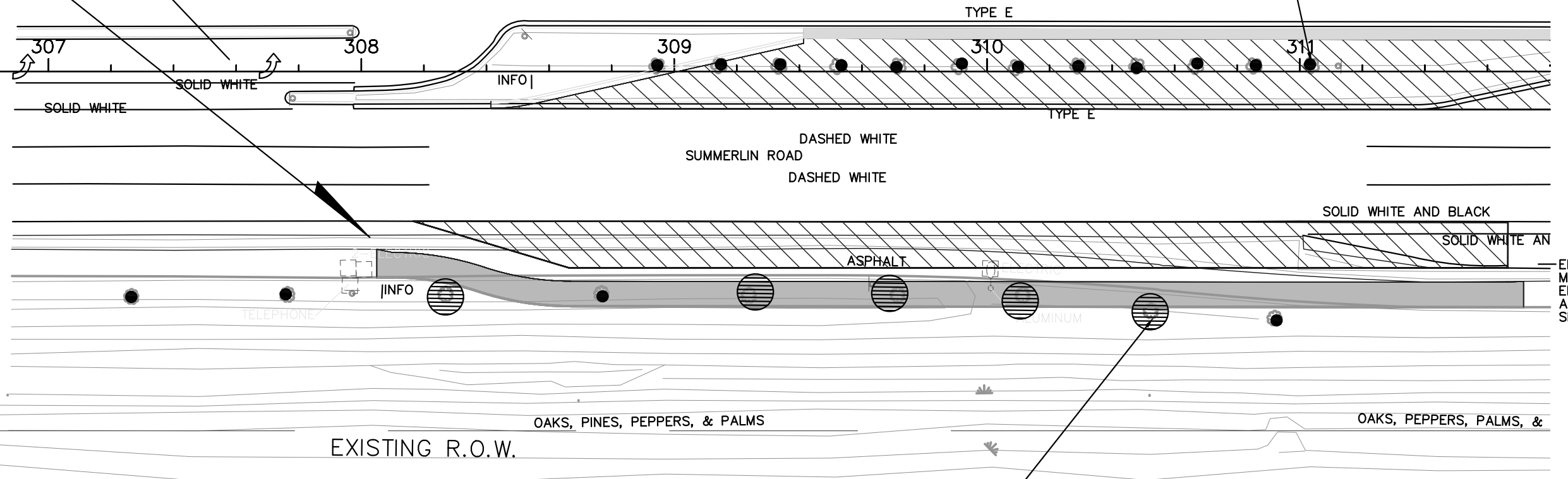



END WIDENING
MATCH EXIST.
ELEV.
AND CROSS
SLOPE

REMOVE 5 EXISTING TREES FOR RELOCATION OR
REPLACEMENT ON COUNTY ROADWAYS PER LCDOT
DIRECTIONS. LOCATE REMOVE AND CAP ALL
IRRIGATION LINES IN CONFLICT WITH CONSTRUCTION.

PROTECT AND MAINTAIN EXISTING MAINLINE IN
OPERATION THROUGHOUT CONSTRUCTION.
COORDINATE LOCATIONS WITH LCDOT.

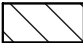
LEGEND

-  PROPOSED WIDENING
-  PROPOSED ASPH. SHARED USE PATH
-  PROPOSED CONC. TRAFFIC SEPARATOR



NO.	DATE	BY	REVISIONS - DESCRIPTION
	6/5/18		CONSTRUCTION DOCUMENTS

APPROVED BY:
GREGORY J. DISERIO, RLA
REGISTERED LANDSCAPE ARCHITECT
FLORIDA CERTIFICATE NO. 840



PUBLIC WORKS
LEE COUNTY
SOUTHWEST
FLORIDA
1500 MONROE STREET
(239) 479-8900

DEPARTMENT
of
TRANSPORTATION
FORT MYERS, FLORIDA 33901

\$USER\$

\$DATE\$

\$TIME\$

\$FILE\$

SUMMERLIN TURN LANES
LANDSCAPE PLANS

SHEET NO.

L-1

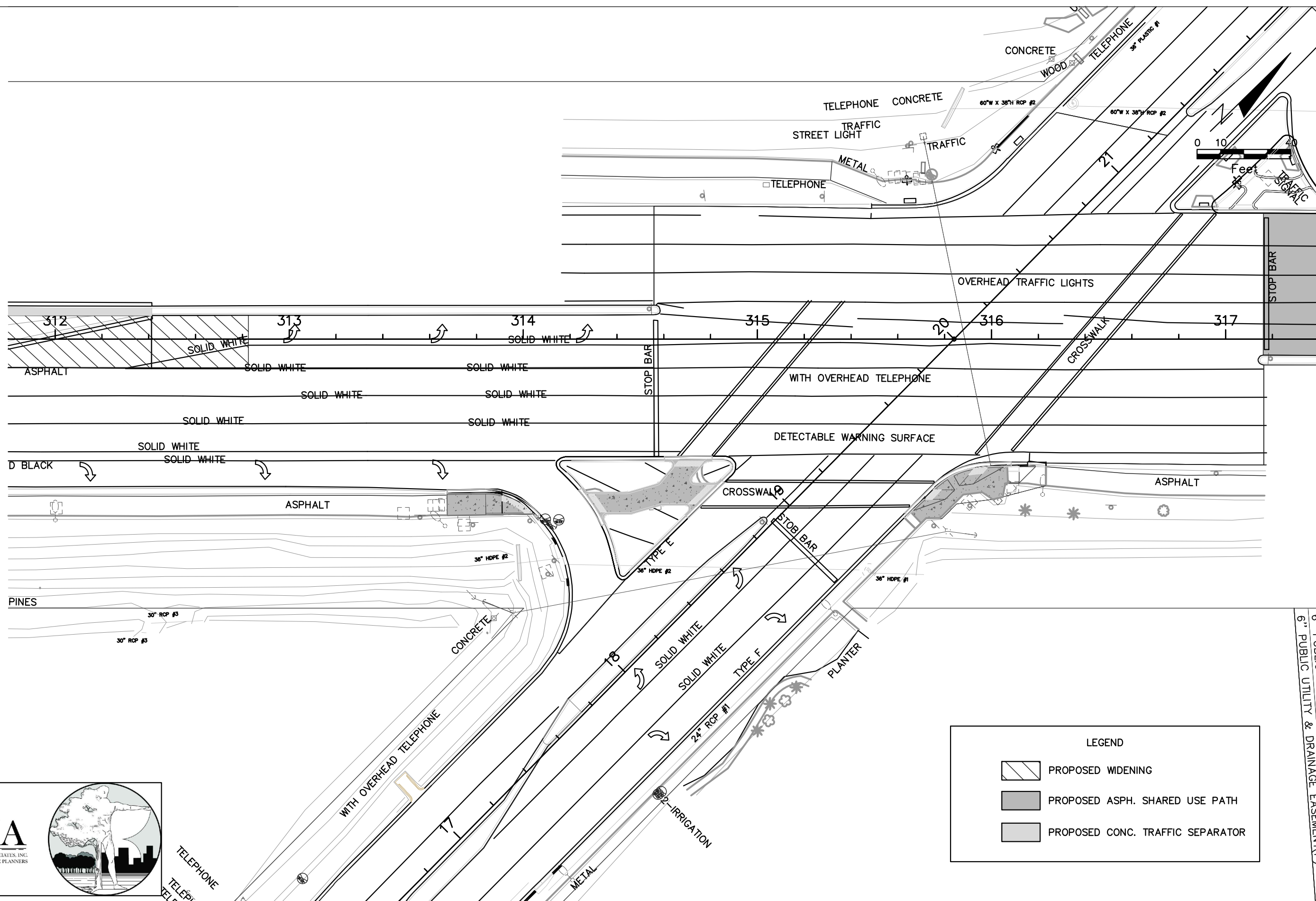

LEGEND

- PROPOSED WIDENING
- PROPOSED ASPH. SHARED USE PATH
- PROPOSED CONC. TRAFFIC SEPARATOR



NO.	DATE	BY	REVISIONS - DESCRIPTION
	6/5/18		CONSTRUCTION DOCUMENTS

APPROVED BY:
GREGORY J. DISERIO, RLA
REGISTERED LANDSCAPE ARCHITECT
 FLORIDA CERTIFICATE NO. 840

PUBLIC WORKS
LEE COUNTY
SOUTHWEST
FLORIDA
 1500 MONROE STREET
 FORT MYERS, FLORIDA 33901
 (239) 478-8900

SUMMERLIN TURN LANES
LANDSCAPE PLANS

SHEET NO.
L-2

\$USERS\$ \$DATES\$ \$TIMES\$ \$FILES\$

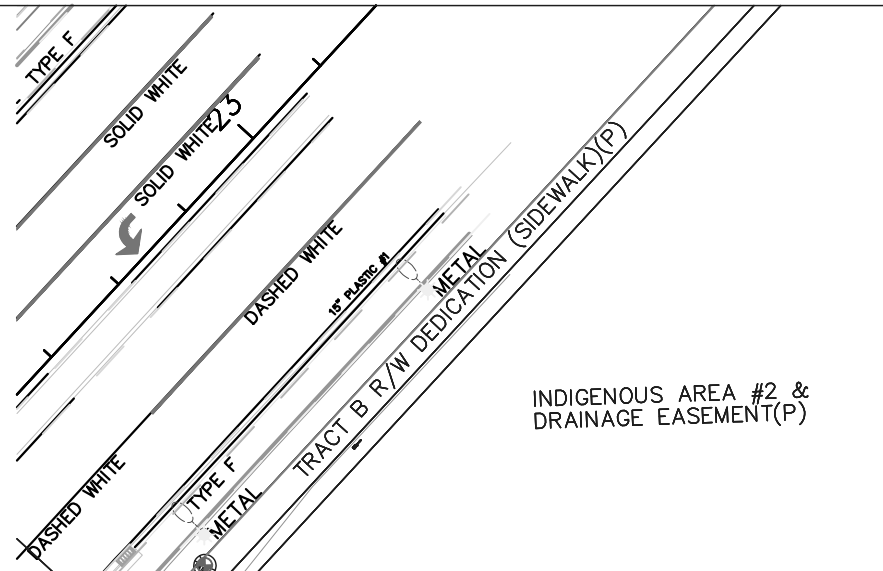
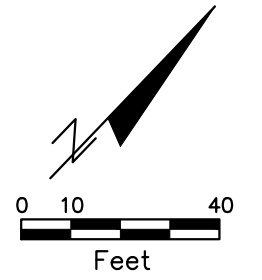

TYPICAL LOCATION OF EXISTING TREES PREVIOUSLY REMOVED DUE TO HURRICANE IRMA. LOCATE REMOVE AND CAP ALL IRRIGATION LINES IN CONFLICT WITH CONSTRUCTION. COORDINATE WITH LCDOT FOR LOCATION OF CROSSINGS

REMOVE 3 EXISTING TREES FOR RELOCATION OR REPLACEMENT ON COUNTY ROADWAYS PER LCDOT DIRECTIONS. LOCATE REMOVE AND CAP ALL IRRIGATION LINES IN CONFLICT WITH CONSTRUCTION.

INDIGENOUS AREA #2 & DRAINAGE EASEMENT(P)

10' PUBLIC UTILITY EASEMENT(P)

END PROJECT
END CONSTRUCTION
END MILLING & RESURFACING
STA. 322+11.31

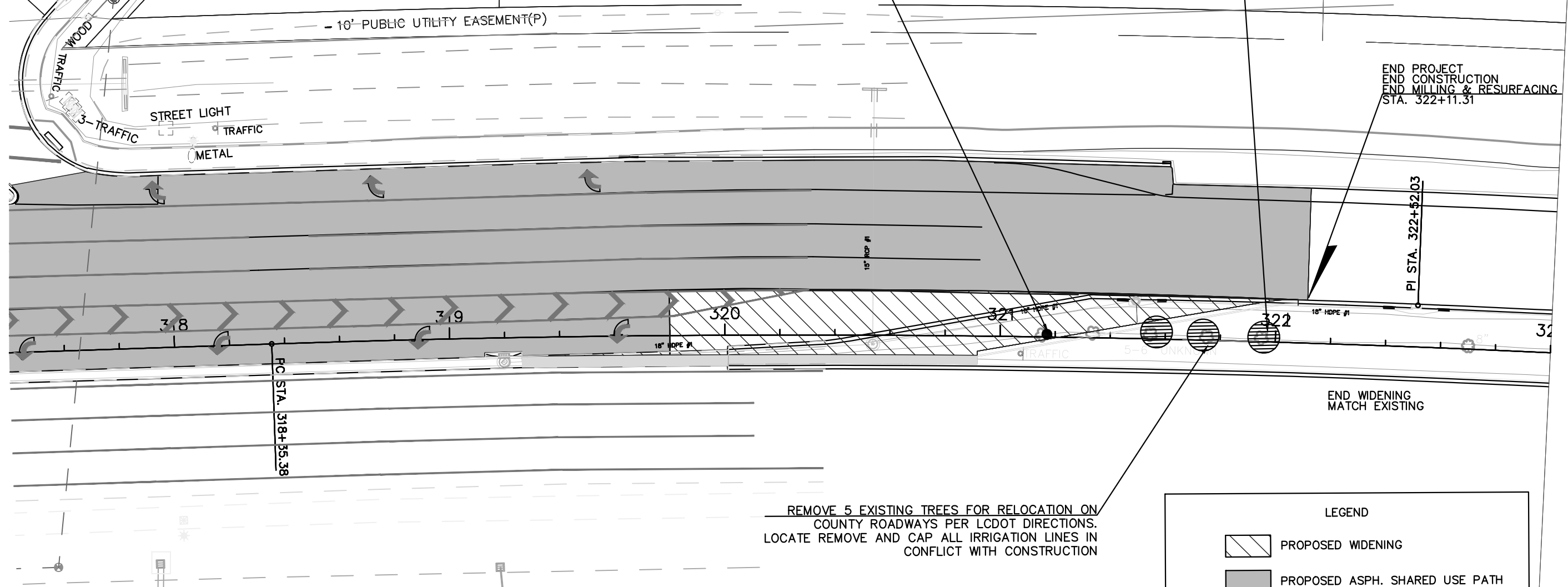

REMOVE 5 EXISTING TREES FOR RELOCATION ON COUNTY ROADWAYS PER LCDOT DIRECTIONS. LOCATE REMOVE AND CAP ALL IRRIGATION LINES IN CONFLICT WITH CONSTRUCTION

LEGEND

- PROPOSED WIDENING
- PROPOSED ASPH. SHARED USE PATH
- PROPOSED CONC. TRAFFIC SEPARATOR



6" PUBLIC UTILITY

6" PUBLIC UTILITY

6" PUBLIC UTILITY

NO.	DATE	BY	REVISIONS - DESCRIPTION
	6/5/18		CONSTRUCTION DOCUMENTS

APPROVED BY:
GREGORY J. DISERIO, RLA
REGISTERED LANDSCAPE ARCHITECT
FLORIDA CERTIFICATE NO. 840

PUBLIC WORKS
LEE COUNTY
SOUTHWEST
FLORIDA
1500 MONROE STREET
(239) 479-8900

DEPARTMENT
of
TRANSPORTATION
FORT MYERS, FLORIDA 33901

SUMMERLIN TURN LANES
LANDSCAPE PLANS

SHEET NO.
L-3

\$USER\$ \$DATE\$ \$TIME\$ \$FILE\$