

ROADWAY LANDSCAPE ADVISORY COMMITTEE

Appointed by Lee County Board of County Commissioners

LEE COUNTY ROADWAY LANDSCAPE
ADVISORY COMMITTEE MEETING OF
March 5, 2013
FIRST FLOOR CONFERENCE ROOM
COMMUNITY DEVELOPMENT/PUBLIC WORKS CENTER
1500 MONROE STREET, FORT MYERS, FLORIDA
6:00 – 7:30 P.M.
AGENDA PACKAGE ACCESS
<http://www.leegov.com/gov/dept/dot/rlac/Pages/default.aspx>

1. Call to Order 6:00 P.M. (Debbie Hughes)
2. *Approval of the December 4, 2012 Regular Meeting Minutes (Debbie Hughes, 5 min.)
3. New Business:
 - a. *Siesta Isles HOA grant request. (Jonathan Romine 30 min.)
 - b. Organizational changes. (Ehab Guirguis 10 min.)
4. Old Business:
 - a. Project Status Update (Bob DeBrock 5 min.)
5. Other Business:
6. Adjourn by 7:30 P.M.
 - Committee action items

NOTE: The Roadway Landscape Advisory Committee (RLAC) consists of members appointed by the Lee County Board of County Commissioners to advise on matters related to roadway landscaping activities in Lee County. The committee meets regularly each month and meetings are open to the public. For more information, please contact Pat Moore at (239) 533-9418.

C/O Lee County Department of Transportation, 5560 Zip Drive, Ft. Myers, FL 33905 (239) 533-9400

ROADWAY LANDSCAPE ADVISORY COMMITTEE (RLAC)

DATE: December 4, 2012
TIME: 6:00 P.M.
PLACE: 2115 Second Street, Fort Myers, Florida

MEMBERS PRESENT:

John Sibley, District 2
Al O'Donnell, District 3
Barbara Niland, District 5
David Salko, Horizon Council
Jennifer Evans, Florida Native Plant Society
Stephen Brown, Horticultural Extension Agent
Debbie Hughes, Fort Myers/Lee County
Garden Council

OTHERS PRESENT:

Bob Mitchell, Weston & Sampson
George Brinson, Pitman Hartenstein

MEMBERS EXCUSED ABSENT:

Winston Church, Keep Lee County Beautiful
Beth Workman, LC Community Development
Michael Weston, Urban Forester

MEMBERS ABSENT:

Gail Archer-Dearie, District 1
Esta Rubinstein, District 4

STAFF PRESENT:

Ehab Guirguis, LCDOT
Doraine Wetzell, LCDOT
Robert DeBrock, LCDOT
Sarah Clarke, LCDOT

Quorum Confirmed with 7 members present.

Debbie Hughes called the regular monthly meeting of the Roadway Landscape Advisory Committee (RLAC) to order at 6:00 pm.

Approval of the September 4, 2012 Regular Meeting Minutes:

Debbie Hughes asked for a motion to approve the September 4, 2012 RLAC meeting minutes, a motion was made by John Sibley to approve the minutes, seconded by David Salko; the motion was called and carried.

NEW BUSINESS

Appointment of Committee Secretary by Chairwoman Debbie Hughes.

Bill Prys has resigned from the Roadway Landscape Advisory Committee therefore another Committee Secretary needs to be appointed. Debbie selected Barbara Niland who accepted the offer to fill the position as Committee Secretary.

Bonita Beach Rd. Ph. 2 from Old 41 to Line St. 60% Landscape Plans

Bob Mitchell from Weston & Sampson presented the 60% Landscape Plans for Bonita Beach Rd. Phase 2 from Old 41 to Line St. Bob explained that these are the same plans that were approved when presented at 30% along with Phase 1. The planting area is minimal however the improvements are to provide a more aesthetic look to the corridor leading to Fort Myers Beach. The plant pallet includes core level plants. There are several sight line issues throughout the area of design that restricts height. Jenny Evans asked about the areas where there is no mulch, Bob said the non-mulched areas will have Bahia grass. Steven Brown questioned the Satin Leaf as a mid tier plant; Bob explained that in this design the Satin Leaf will stay under the Royal's. John Sibley voiced his concerns on the use of Satin Leaf under the Royals; Bob stated that concentrating on the roots is the key to the longevity of this plant.

Al O'Donnell made a motion to approve the 60% design plans of Bonita Beach Rd. Ph. 2 from Old 41 to Line St. as presented, seconded by Barbara Niland, the motion was called and carried.

Beth Stacey Blvd. @ Business Way Cul-de-sac 60% Landscape Plan

Bob Mitchell of Weston & Sampson presented the 60% Landscape Plans for the Cul-de-sac on Beth Stacey Blvd. at Business Way. Bob stated that the roundabout creates a more focused intersection concentrating on the safety of both pedestrians and traffic since the flow of traffic is constant, always moving to the right. Bob stated that he has already met with County staff and have gone through the FHWA material to come up with this design. The purpose of the roundabout is to enhance traffic safety, maintain clear site lines and clearances. Bob showed an example of a roundabout at Coconut Point. The FHWA recommendations are to use landscape as an integral part of the roadway design to alert drivers there is something ahead. The small islands which are hardscape have been added to funnel traffic in the correct direction. These sections will not be planted to prevent potential hazards. The plant pallet chosen for this design is; Sabal Palms in the center for clear view to alert oncoming traffic, Yaupon Holly, Coontie, Crown of Thorns, Natal Plum and Golden Creeper. David Salko asked about the size, Bob stated the diameter of the roundabout is 66'. Dave said that the roundabouts on Hill Ave. are similar in size and vehicles drive right through the medians. Sarah Clarke added that this area is larger than the one at Hill Ave. and those on Hill Ave. do not hit the deflection angle. If the roundabouts are designed properly they will work. Debbie mentioned there is one in Cape Coral which is not landscaped however it works well. Al O'Donnell stated that in a 4 way intersection there are 32 potential accident possibilities where the probability of fatalities is high. A roundabout has 8 with very low possibilities of fatalities. Bob stated that the north and south traffic is high with little traffic coming from the east and west directions. Sarah explained that the funding for this project will come from money that is set aside for hazardous areas. This intersection has been studied and warrants a traffic signal. The decision to design a roundabout was to cut cost over time. The initial cost is higher than installing a traffic signal but over time will be compensated by the savings in maintenance and operation cost. David Salko asked about the sides of the road as you approach the intersection. Bob stated this is private property and the roundabout takes up all of the right-of-way. Al O'Donnell suggested adding more canopy trees like Oaks or Shady Lady Black Olives. Steven Brown disagrees with adding more trees which would limit the ability

to see through the median. Bob stated the inner circle is about 20' to 22' diameter. David Salko also stated that large trucks will have problems making the turn; Sarah noted that the berms around the cul-de-sac are all mountable giving additional room. David also added that more canopy trees could be added keeping a cluster of Sabals behind them creating more symmetry. Jenny asked if the canopy is going to grow over the roadway which will impact traffic, Bob stated that there will be some maintenance issues but it will be minimal.

John Sibley made a motion to approve the 60% Landscape Plans for the roundabout at Beth Stacey Blvd. and Business Way as presented, seconded by Barbara Niland, the motion was called and carried with 4 votes yay and 3 votes nay.

OLD BUSINESS:

Alico Road @ I-75 – Interactive Discussion of Proposed Interchange Improvements

Al O'Donnell stated he is still waiting on Base Sheets to use for brainstorming. Bob checked the spacing of the existing Royals, there are 35 at each quadrant which are spaced on 50 ft centers. Sarah added that the Port Authority is currently working on an airport interchange that will be changing this interchange. She advises to check their plans before proceeding with any additional landscape plans. Al stated that we are just working on conceptual plans and by the time we would get a design in place the changes may already be completed. David Salko stated his concern for the Royals being that far out there is a possibility they could be impacted by the cold weather also prior to doing any designing we need to get the State regulations.

The committee addressed the possibility of picking a different location or waiting until they receive the rules and regulations and stay with the Alico exchange.

Project Status Update by Bob DeBrock

- Plantation Extension, Idlewild to Colonial - In contract maintenance. Final Completion 1/23/13
- US 41, Littleton to Charlotte County line - In Contract Maintenance. Final Completion 2/27/13
- Three Oaks, Corkscrew to Alico - In Contract Maintenance. Final Completion 6/4/14
- Estero Pkwy Ext, Three Oaks to Ben Hill Griffin - In contract maintenance. Final completion 7/13/13
- Three Oaks Pkwy, Bonita Bill to E. Terry - Pre-bid meeting scheduled for 12/13/12. Bid opening scheduled for 1/9/12
- Gladiolus/Bass, Winkler to San Carlos – contract documents sent to Juniper. Hoping to have NTP 12/15/12
- Colonial, Six Mile Slough to SR 82 – Pre-bid meeting scheduled for 12/6/12. Bid opening scheduled for 12/19/12.
- Six Mile Cypress, Daniels to Colonial – Waiting for final plans from Consultant. (JEI)

- Bonita Beach Rd., Old 41 to Lime – Waiting for plans from Sarah.
- Summerlin, Boy Scout to Cypress Lake – Irrigation plans being worked on by OPI.

Debbie inquired about the status of the problem with the Spiraling White Fly on Hickory Island. Bob stated that he is working on getting quotes from contractors to get them treated.

John Sibley asked why the bids were rejected on the Three Oaks project. Ehab explained that they have changed the language in the contract. The contract was changed from having 5 years experience to 3 years.

Meeting Adjourn at 7:15 pm
Respectfully submitted,



Doraine Wetzel
Administrative Assistant

Chairman

Date

Secretary

Date

Attachment: Attendance Record

**Lee County Roadway Landscape Advisory Committee
12 Month Meeting Attendance Record
A = Absent, EA = Excused Absence, V = Vacant**

	2012 Jan.	2012 Feb.	2012 Mar.	2012 Apr.	2012 May	2012 Jun.	2012 Jul.	2012 Aug.	2012 Sept.	2012 Oct.	2012 Nov.	Total
Voting Members												
Al O'Donnell District 3	NO MEETING	NO MEETING	A	NO MEETING	NO MEETING		NO MEETING	NO MEETING		NO MEETING	NO MEETING	1
Barbara Niland District 5									0			
Vacant District 4			A						3			
Vacant American Society of Landscape Architects	NO MEETING	NO MEETING		NO MEETING	NO MEETING		NO MEETING	NO MEETING		NO MEETING	NO MEETING	0
David Salko Horizon Council												
Vacant Florida Nursery, Growers & Landscape Association			V						3			
Debbie Hughes Ft. Myers/Lee County Garden Council	NO MEETING	NO MEETING		NO MEETING	NO MEETING		NO MEETING	NO MEETING	EA	NO MEETING	NO MEETING	1
Gail Annette Archer-Dearie District 1			A						1			
John Sibley District 2			A						1			
Michael Weston Urban Forester	NO MEETING	NO MEETING	A	NO MEETING	NO MEETING	A	NO MEETING	NO MEETING		NO MEETING	NO MEETING	2
Jenny Evans Florida Native Plant Society									1			
Vacant International Society of Arboriculture, Certified Arborist												
* Stephen Brown Horticultural Extension Agent	NO MEETING	NO MEETING		NO MEETING	NO MEETING	EA	NO MEETING	NO MEETING	EA	NO MEETING	NO MEETING	2
Winston Church Keep Lee County Beautiful			EA			EA			2			
Non-voting Members (Staff)												
Beth Workman Community Development	NO MEETING	NO MEETING		NO MEETING	NO MEETING		NO MEETING	NO MEETING	EA	NO MEETING	NO MEETING	1
Pat Moore Department of Transportation			EA						1			
* See above Parks & Recreation			EA						2			

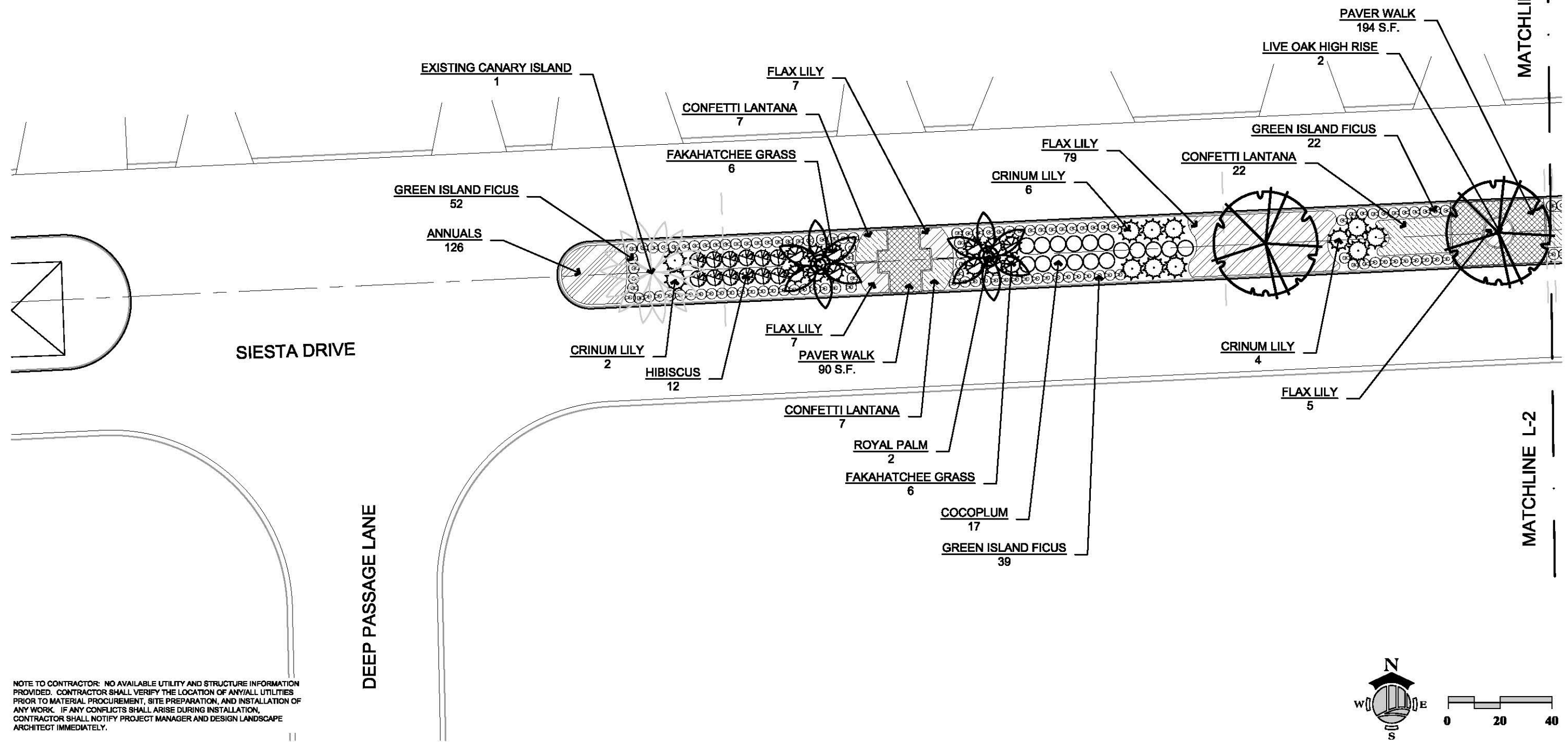

NOTE TO CONTRACTOR: NO AVAILABLE UTILITY AND STRUCTURE INFORMATION PROVIDED. CONTRACTOR SHALL VERIFY THE LOCATION OF ANY/ALL UTILITIES PRIOR TO MATERIAL PROCUREMENT, SITE PREPARATION, AND INSTALLATION OF ANY WORK. IF ANY CONFLICTS SHALL ARISE DURING INSTALLATION, CONTRACTOR SHALL NOTIFY PROJECT MANAGER AND DESIGN LANDSCAPE ARCHITECT IMMEDIATELY.

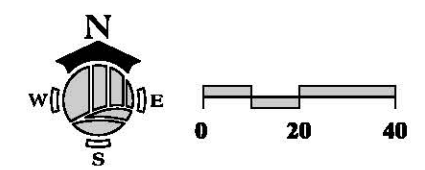

ensite
 2401 FIRST STREET, SUITE 201
 FORT MYERS, FLORIDA 33901
 PH: (239)-226-0034
 FX: (239)-226-0094
 EB-26544 CA-LC26000374

LEE COUNTY
 SOUTHWEST FLORIDA
 DEPARTMENT of TRANSPORTATION
 PUBLIC WORKS ADMINISTRATION

Project Manager:	JLR
Drawn By:	BRS
Project Number:	1210-01
Cad File:	1210-01-LA01
Scale:	1" = 40'
Date:	1-16-13
Issued:	TBD
Status:	60% PLANS

PROJECT:
SIESTA DRIVE
LANDSCAPE & IRRIGATION PROJECT
 San Carlos Boulevard to Guard House

REVISION:	PLAN REVISIONS:	DATE:
	DESCRIPTION:	

Jonathan L. Romine, RLA
 LA6666881

LANDSCAPE PLAN
 90% SUBMITTAL

L-1
 Sheet Number:

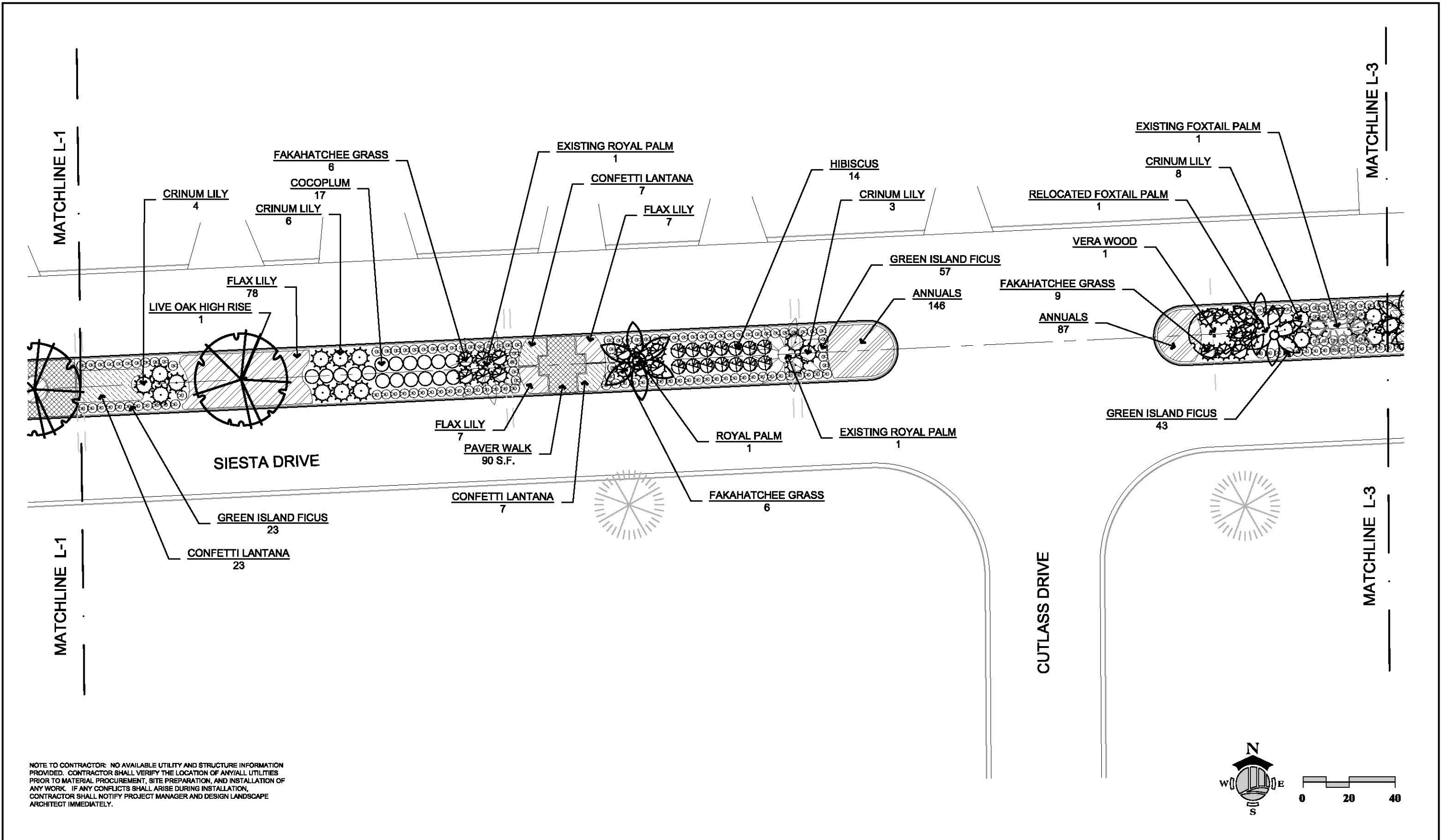

NOTE TO CONTRACTOR: NO AVAILABLE UTILITY AND STRUCTURE INFORMATION PROVIDED. CONTRACTOR SHALL VERIFY THE LOCATION OF ANY/ALL UTILITIES PRIOR TO MATERIAL PROCUREMENT, SITE PREPARATION, AND INSTALLATION OF ANY WORK. IF ANY CONFLICTS SHALL ARISE DURING INSTALLATION, CONTRACTOR SHALL NOTIFY PROJECT MANAGER AND DESIGN LANDSCAPE ARCHITECT IMMEDIATELY.

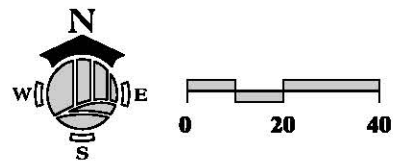

ensite
 2401 FIRST STREET, SUITE 201
 FORT MYERS, FLORIDA 33901
 PH: (239)-226-0034
 FX: (239)-226-0094
 EB-26544 CA4C26000374

LEE COUNTY
 SOUTHWEST FLORIDA
 DEPARTMENT of TRANSPORTATION
 PUBLIC WORKS ADMINISTRATION

Project Manager:	JLR
Drawn By:	BRS
Project Number:	1210-01
Cad File:	1210-01-LA01
Scale:	1" = 40'
Date:	1-16-13
Issued:	TBD
Status:	60% PLANS

PROJECT:
SIESTA DRIVE
LANDSCAPE & IRRIGATION PROJECT
 San Carlos Boulevard to Guard House

REVISION:	PLAN REVISIONS:	DATE:
	DESCRIPTION:	

Jonathan L. Romine, RLA
 LA6666881

LANDSCAPE PLAN
 90% SUBMITTAL

L-2
 Sheet Number:

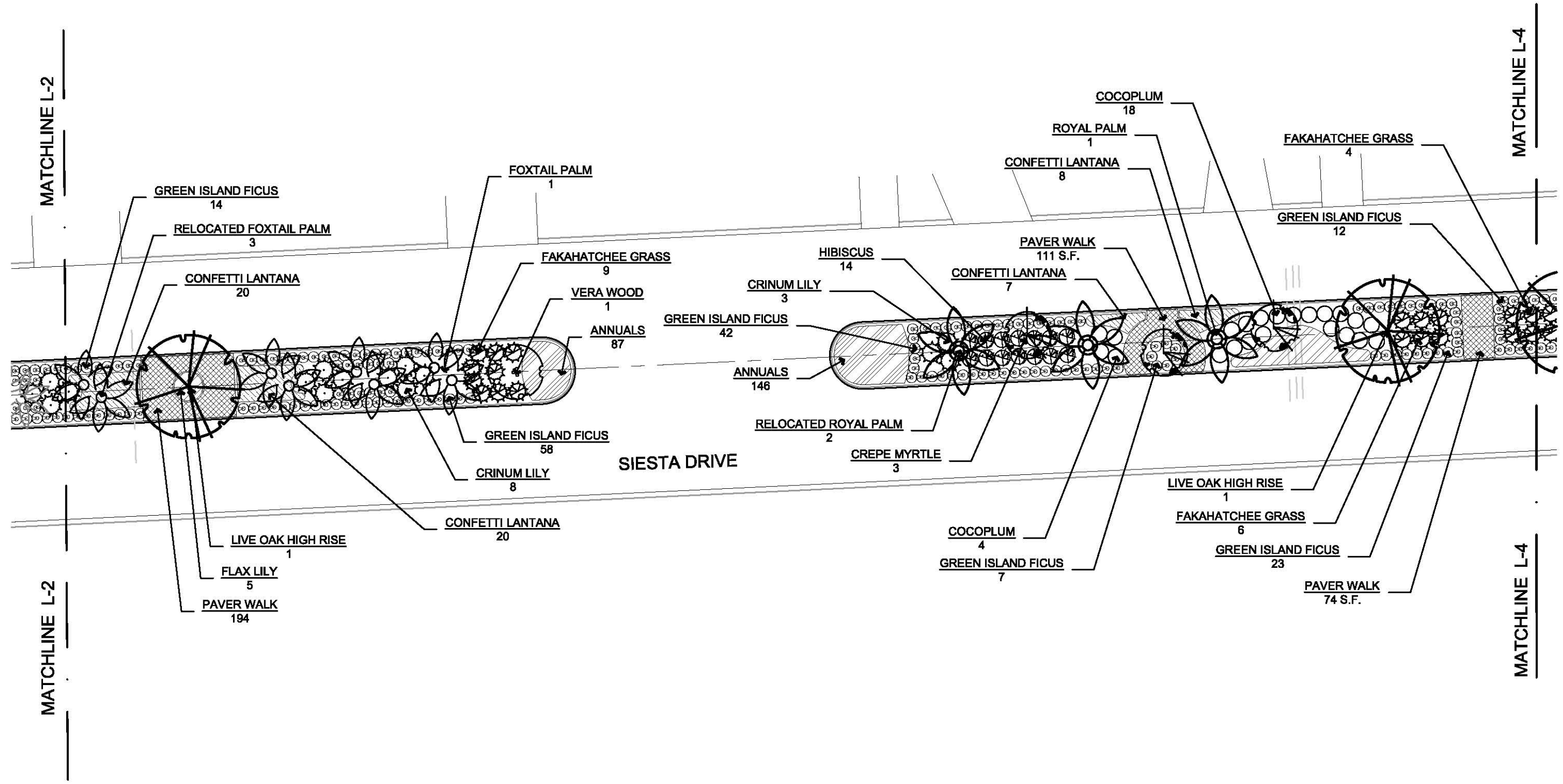

NOTE TO CONTRACTOR: NO AVAILABLE UTILITY AND STRUCTURE INFORMATION PROVIDED. CONTRACTOR SHALL VERIFY THE LOCATION OF ANY/ALL UTILITIES PRIOR TO MATERIAL PROCUREMENT, SITE PREPARATION, AND INSTALLATION OF ANY WORK. IF ANY CONFLICTS SHALL ARISE DURING INSTALLATION, CONTRACTOR SHALL NOTIFY PROJECT MANAGER AND DESIGN LANDSCAPE ARCHITECT IMMEDIATELY.

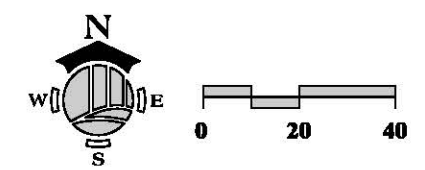

ensite
 2401 FIRST STREET, SUITE 201
 FORT MYERS, FLORIDA 33901
 PH: (239)-226-0034
 FX: (239)-226-0094
 EB-26544 CALC26000374

LEE COUNTY
 SOUTHWEST FLORIDA
 DEPARTMENT of TRANSPORTATION
 PUBLIC WORKS ADMINISTRATION

Project Manager:	JLR
Drawn By:	BRS
Project Number:	1210-01
Cad File:	1210-01-LA01
Scale:	1" = 40'
Date:	1-16-13
Issued:	TBD
Status:	60% PLANS

PROJECT:
SIESTA DRIVE
LANDSCAPE & IRRIGATION PROJECT
 San Carlos Boulevard to Guard House

REVISION:	PLAN REVISIONS:	DATE:
	DESCRIPTION:	

Jonathan L. Romine, RLA
 LA6666881

LANDSCAPE PLAN
 90% SUBMITTAL

L-3
 Sheet Number:

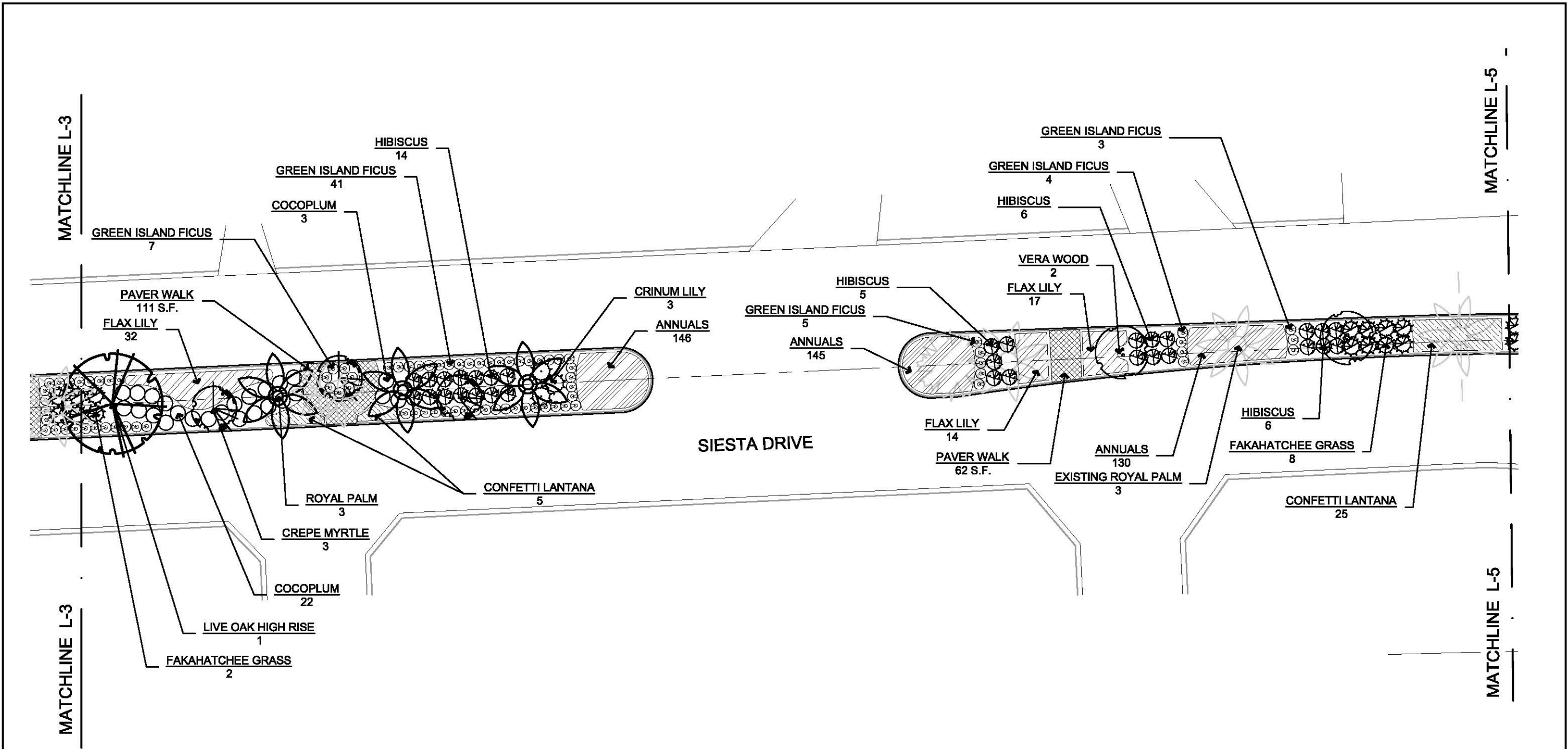

NOTE TO CONTRACTOR: NO AVAILABLE UTILITY AND STRUCTURE INFORMATION PROVIDED. CONTRACTOR SHALL VERIFY THE LOCATION OF ANY/ALL UTILITIES PRIOR TO MATERIAL PROCUREMENT, SITE PREPARATION, AND INSTALLATION OF ANY WORK. IF ANY CONFLICTS SHALL ARISE DURING INSTALLATION, CONTRACTOR SHALL NOTIFY PROJECT MANAGER AND DESIGN LANDSCAPE ARCHITECT IMMEDIATELY.

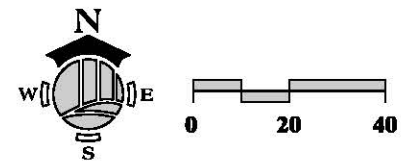

ensite
 2401 FIRST STREET, SUITE 201
 FORT MYERS, FLORIDA 33901
 PH: (239)-226-0034
 FX: (239)-226-0094
 EB-26544 CA-LC26000374

LEE COUNTY
 SOUTHWEST FLORIDA
 DEPARTMENT of TRANSPORTATION
 PUBLIC WORKS ADMINISTRATION

Project Manager:	JLR
Drawn By:	BRS
Project Number:	1210-01
Cad File:	1210-01-LA01
Scale:	1" = 40'
Date:	1-16-13
Issued:	TBD
Status:	60% PLANS

PROJECT:
SIESTA DRIVE
LANDSCAPE & IRRIGATION PROJECT
 San Carlos Boulevard to Guard House

REVISION:	PLAN REVISIONS:	DATE:
	DESCRIPTION:	

Jonathan L. Romine, RLA
 LA6666881

LANDSCAPE PLAN
 90% SUBMITTAL

L-4
 Sheet Number:

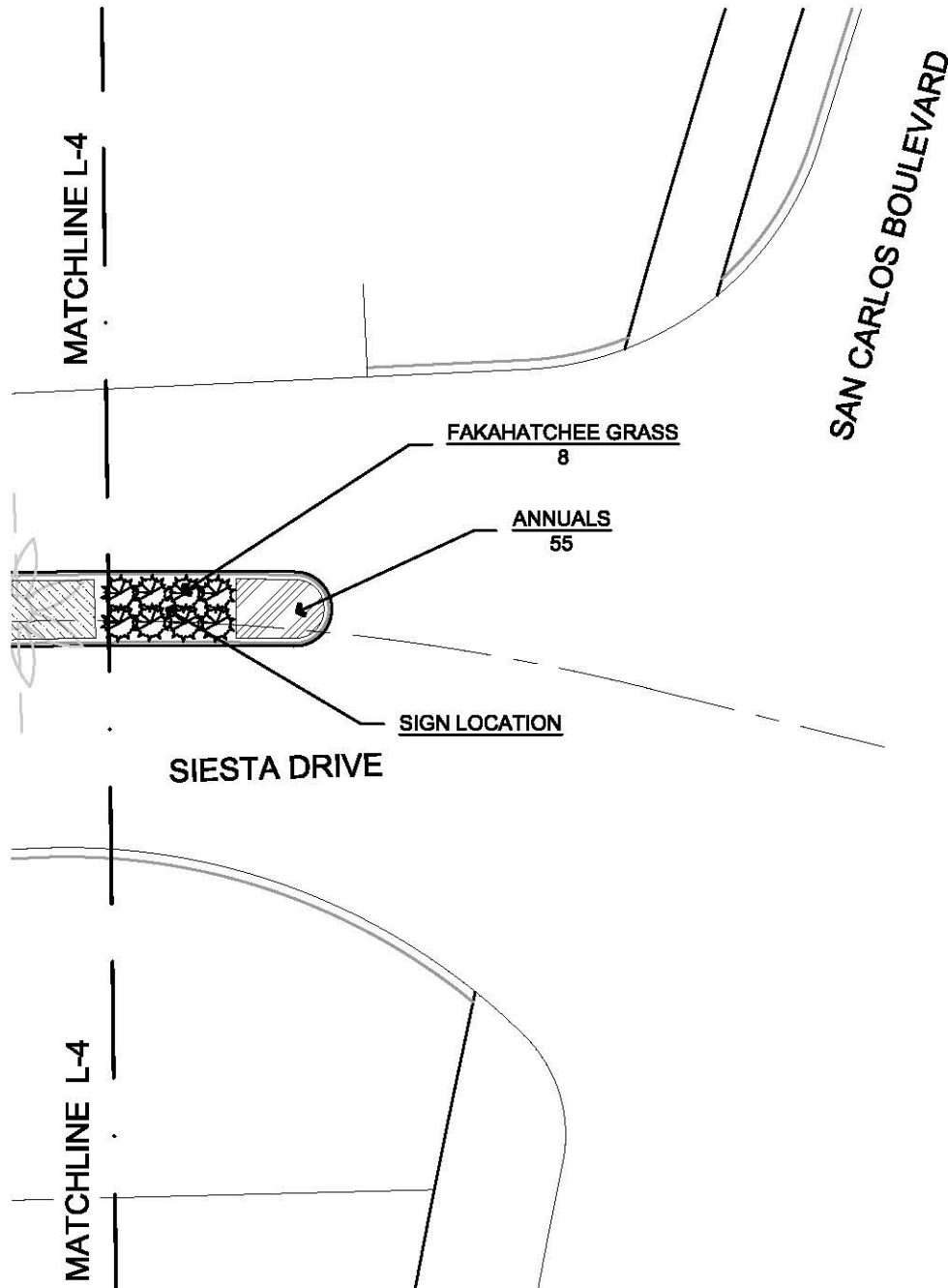

MASTER PLANT SCHEDULE

	QTY	BOTANICAL NAME	COMMON NAME	SPECIFICATIONS
TREES / PALMS	7	ROYSTONIA REGIA	FLORIDA ROYAL PALM	6' GW, MATCHED, FULL
	6	LAGERSTROEMIA INDICA 'MUSKOGEE'	CRAPE MYRTLE	FG. 12' HT, 5' SPR
	6	QUERCUS VIRGINIANA 'MILLENNIUM'	LIVE OAK	FG. 16'-18' HT, 4" CAL.
	1	WODYETIA BIFURCATA	FOXTAIL PALM	FG. 10' HT, DOUBLE
SHRUBS, GROUNDCOVERS, AND MISCELLANEOUS	47	CRINUM ASIATICUM 'QUEEN EMMA'	QUEEN EMMA CRINUM LILY	7 GAL., FULL
	81	CHRYSOBALANUS ICACO	RED TIP COCOPLUM	3 GAL, FULL
	70	TRIPSACUM DACTYLOIDES	FAKAHATCHEE GRASS	3 GAL., FULL
	71	HIBISCUS	RED HIBISCUS	3 GAL., FULL
	499	FICUS MACROCARPA	GREEN ISLAND FICUS	3 GAL, FULL
	124	LANTANA CAMARA 'CONFETTI'	CONFETTI LANTANA	1 GAL, 24" O.C.
	258	DIANELLA TASMANICA	FLAX LILY	1 GAL, 24" O.C.
	1,068	SEASONAL ANNUALS		4" POTS
	621 s.f.	DECORATIVE PAVERS		
	4	RELOCATED FOXTAIL PALMS (DOUBLE)		
2	RELOCATED ROYAL PALMS			

NOTE TO CONTRACTOR: NO AVAILABLE UTILITY AND STRUCTURE INFORMATION PROVIDED. CONTRACTOR SHALL VERIFY THE LOCATION OF ANY/ALL UTILITIES PRIOR TO MATERIAL PROCUREMENT, SITE PREPARATION, AND INSTALLATION OF ANY WORK. IF ANY CONFLICTS SHALL ARISE DURING INSTALLATION, CONTRACTOR SHALL NOTIFY PROJECT MANAGER AND DESIGN LANDSCAPE ARCHITECT IMMEDIATELY.

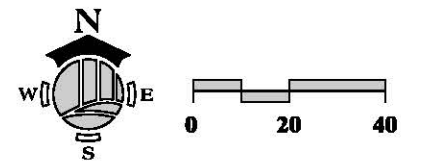

ensite
 2401 FIRST STREET, SUITE 201
 FORT MYERS, FLORIDA 33901
 PH: (239)-226-0034
 FX: (239)-226-0054
 EB-26544 CALC26000374

LEE COUNTY
 SOUTHWEST FLORIDA
 DEPARTMENT of TRANSPORTATION
 PUBLIC WORKS ADMINISTRATION

Project Manager: JLR
 Drawn By: BRS
 Project Number: 1210-01
 Cad File: 1210-01-LA01
 Scale: 1" = 40'
 Date: 1-16-13
 Issued: TBD
 Status: 60% PLANS

PROJECT:
**SIESTA DRIVE
 LANDSCAPE & IRRIGATION PROJECT**
 San Carlos Boulevard to Guard House

REVISION:	PLAN REVISIONS: DESCRIPTION:	DATE:

Jonathan L. Romine, RLA
 LA6666881

LANDSCAPE PLAN
 90% SUBMITTAL

L-5
 Sheet Number: