

### THREE OAKS PARKWAY DESIGNATED ACCESS POINTS

ADOPTED SEPTEMBER 18, 2007 PER RESOLUTION #07-09-30





23

M 1000N

M 1100E

NORTHBOUND LEFT/OUT  
RIGHT IN/RIGHT OUT  
STA. 220+00  
RIGHT IN/RIGHT OUT  
STA. 224+00

ALL MOVEMENTS  
STA. 174+17

I-75

24

### THREE OAKS PARKWAY DESIGNATED ACCESS POINTS

ADOPTED SEPTEMBER 18, 2007 PER RESOLUTION #07-09-30



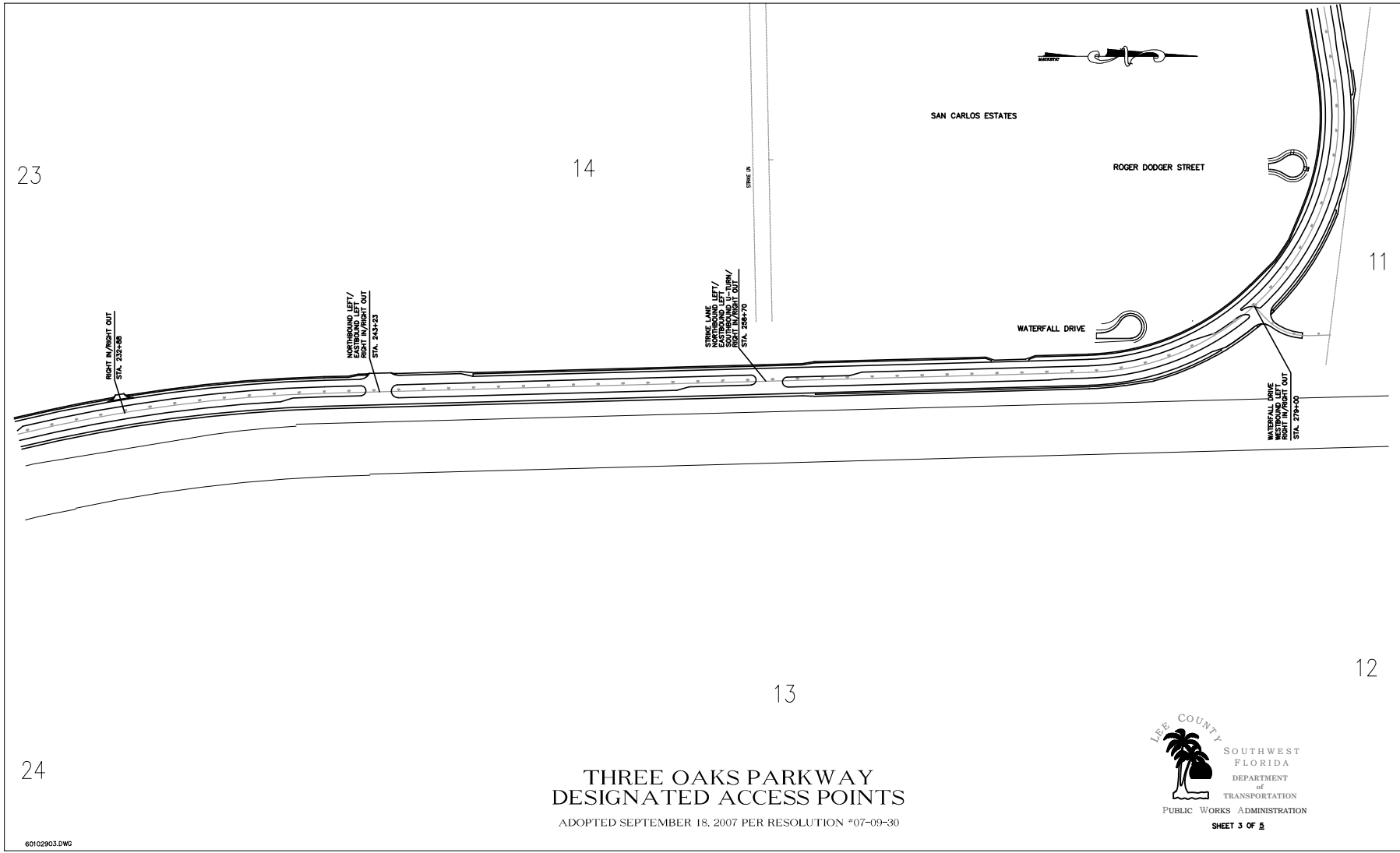

**THREE OAKS PARKWAY  
DESIGNATED ACCESS POINTS**

ADOPTED SEPTEMBER 18, 2007 PER RESOLUTION \*07-09-30

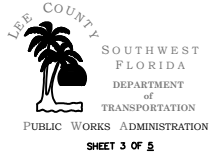

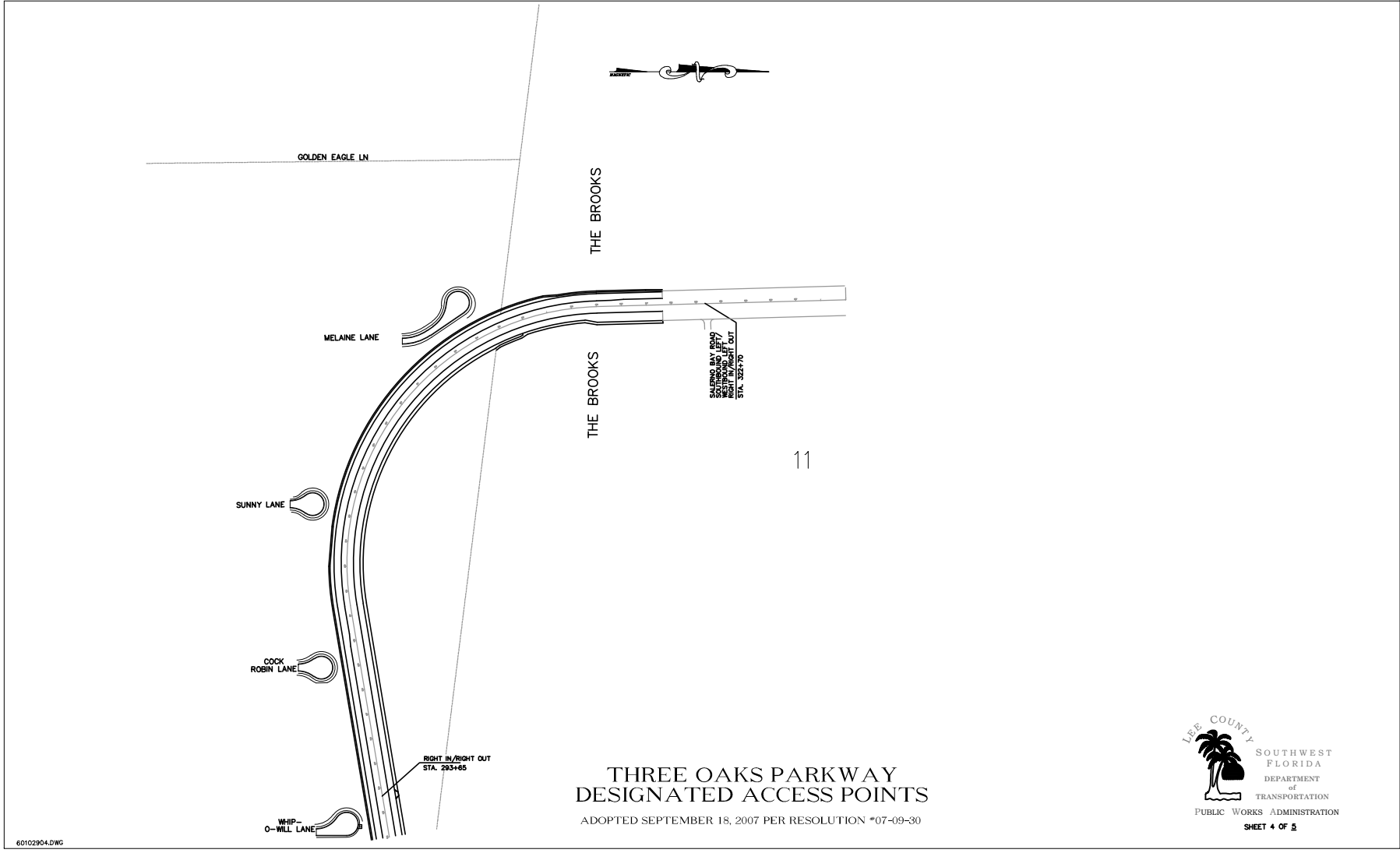

**THREE OAKS PARKWAY  
DESIGNATED ACCESS POINTS**

ADOPTED SEPTEMBER 18, 2007 PER RESOLUTION \*07-09-30

