

Follows Conditional Case No.: 16-04-5800R



Federal Emergency Management Agency

Washington, D.C. 20472

LETTER OF MAP REVISION DETERMINATION DOCUMENT

COMMUNITY AND REVISION INFORMATION		PROJECT DESCRIPTION	BASIS OF REQUEST
COMMUNITY	Lee County Florida (Unincorporated Areas)	EXCAVATION FILL	HYDRAULIC ANALYSIS HYDROLOGIC ANALYSIS FLOODWAY UPDATED TOPOGRAPHIC DATA
	COMMUNITY NO.: 125124		
IDENTIFIER	Babcock Ranch Community LOMR	APPROXIMATE LATITUDE AND LONGITUDE: 26.782, -81.748 SOURCE: Precision Mapping Streets DATUM: NAD 83	
ANNOTATED MAPPING ENCLOSURES		ANNOTATED STUDY ENCLOSURES	
TYPE: FIRM* NO.: 12071C0138F DATE: August 28, 2008 TYPE: FIRM* NO.: 12071C0139F DATE: August 28, 2008		DATE OF EFFECTIVE FLOOD INSURANCE STUDY: December 7, 2018 PROFILE: 89P FLOODWAY DATA TABLE: 11 SUMMARY OF DISCHARGES TABLE: 8	

Enclosures reflect changes to flooding sources affected by this revision.

* FIRM - Flood Insurance Rate Map

FLOODING SOURCE AND REVISED REACH

Trout Creek/Curry Lake Canal - from approximately 1,150 feet upstream of the confluence with Stricklin Gully to the county boundary

SUMMARY OF REVISIONS

Flooding Source	Effective Flooding	Revised Flooding	Increases	Decreases
Trout Creek/Curry Lake Canal	Zone AE	Zone AE	YES	YES
	Zone X (shaded)	Zone X (shaded)	YES	YES
	Zone X (unshaded)	Zone X (shaded)	YES	NONE
	Floodway	Floodway	YES	YES

* BFEs - Base Flood Elevations

DETERMINATION

This document provides the determination from the Department of Homeland Security's Federal Emergency Management Agency (FEMA) regarding a request for a Letter of Map Revision (LOMR) for the area described above. Using the information submitted, we have determined that a revision to the flood hazards depicted in the Flood Insurance Study (FIS) report and National Flood Insurance Program (NFIP) map is warranted. This document revises the effective NFIP map, as indicated in the attached documentation. Please use the enclosed annotated map panels revised by this LOMR for floodplain management purposes and for all flood insurance policies and renewals in your community.

This determination is based on the flood data presently available. The enclosed documents provide additional information regarding this determination. If you have any questions about this document, please contact the FEMA Map Information eXchange toll free at 1-877-336-2627 (1-877-FEMA MAP) or by letter addressed to the LOMC Clearinghouse, 3601 Eisenhower Avenue, Suite 500, Alexandria, VA 22304-6426. Additional information about the NFIP is available on our website at <https://www.fema.gov/national-flood-insurance-program>.

Patrick "Rick" F. Sacbibit, P.E., Branch Chief
Engineering Services Branch
Federal Insurance and Mitigation Administration

18-04-3990P

102-I-A-C



Federal Emergency Management Agency

Washington, D.C. 20472

LETTER OF MAP REVISION DETERMINATION DOCUMENT (CONTINUED)

OTHER FLOODING SOURCES AFFECTED BY THIS REVISION

FLOODING SOURCE AND REVISED REACH

Trout Creek/Curry Lake Canal - from approximately 1,150 feet upstream of the confluence with Stricklin Gully to the county boundary

SUMMARY OF REVISIONS

Flooding Source	Effective Flooding	Revised Flooding	Increases	Decreases
Trout Creek/Curry Lake Canal	BFEs*	BFEs	NONE	YES
	Zone A	Zone X (shaded)	NONE	YES

* BFEs - Base Flood Elevations

This determination is based on the flood data presently available. The enclosed documents provide additional information regarding this determination. If you have any questions about this document, please contact the FEMA Map Information eXchange toll free at 1-877-336-2627 (1-877-FEMA MAP) or by letter addressed to the LOMC Clearinghouse, 3601 Eisenhower Avenue, Suite 500, Alexandria, VA 22304-6426. Additional information about the NFIP is available on our website at <https://www.fema.gov/national-flood-insurance-program>.

Patrick "Rick" F. Sacbibit, P.E., Branch Chief
Engineering Services Branch
Federal Insurance and Mitigation Administration

18-04-3990P

102-I-A-C



Federal Emergency Management Agency
Washington, D.C. 20472

**LETTER OF MAP REVISION
DETERMINATION DOCUMENT (CONTINUED)**

OTHER COMMUNITIES AFFECTED BY THIS REVISION

CID Number: 120061 **Name:** Charlotte County, Florida

AFFECTED MAP PANELS

TYPE: FIRM* NO.: 12015C0475F DATE: May 5, 2003
TYPE: FIRM* NO.: 12015C0500F DATE: May 5, 2003

AFFECTED PORTIONS OF THE FLOOD INSURANCE STUDY REPORT

DATE OF EFFECTIVE FLOOD INSURANCE STUDY REPORT : May 5, 2003
PROFILES: 50P and 51P
FLOODWAY DATA TABLE: 9
SUMMARY OF DISCHARGES TABLE: 4

This determination is based on the flood data presently available. The enclosed documents provide additional information regarding this determination. If you have any questions about this document, please contact the FEMA Map Information eXchange toll free at 1-877-336-2627 (1-877-FEMA MAP) or by letter addressed to the LOMC Clearinghouse, 3601 Eisenhower Avenue, Suite 500, Alexandria, VA 22304-6426. Additional information about the NFIP is available on our website at <https://www.fema.gov/national-flood-insurance-program>.

Patrick "Rick" F. Sacbibit, P.E., Branch Chief
Engineering Services Branch
Federal Insurance and Mitigation Administration

18-04-3990P

102-I-A-C



Federal Emergency Management Agency

Washington, D.C. 20472

LETTER OF MAP REVISION DETERMINATION DOCUMENT (CONTINUED)

COMMUNITY INFORMATION

APPLICABLE NFIP REGULATIONS/COMMUNITY OBLIGATION

We have made this determination pursuant to Section 206 of the Flood Disaster Protection Act of 1973 (P.L. 93-234) and in accordance with the National Flood Insurance Act of 1968, as amended (Title XIII of the Housing and Urban Development Act of 1968, P.L. 90-448), 42 U.S.C. 4001-4128, and 44 CFR Part 65. Pursuant to Section 1361 of the National Flood Insurance Act of 1968, as amended, communities participating in the NFIP are required to adopt and enforce floodplain management regulations that meet or exceed NFIP criteria. These criteria, including adoption of the FIS report and FIRM, and the modifications made by this LOMR, are the minimum requirements for continued NFIP participation and do not supersede more stringent State/Commonwealth or local requirements to which the regulations apply.

We provide the floodway designation to your community as a tool to regulate floodplain development. Therefore, the floodway revision we have described in this letter, while acceptable to us, must also be acceptable to your community and adopted by appropriate community action, as specified in Paragraph 60.3(d) of the NFIP regulations.

NFIP regulations Subparagraph 60.3(b)(7) requires communities to ensure that the flood-carrying capacity within the altered or relocated portion of any watercourse is maintained. This provision is incorporated into your community's existing floodplain management ordinances; therefore, responsibility for maintenance of the altered or relocated watercourse, including any related appurtenances such as bridges, culverts, and other drainage structures, rests with your community. We may request that your community submit a description and schedule of maintenance activities necessary to ensure this requirement.

COMMUNITY REMINDERS

We based this determination on the 1-percent-annual-chance discharges computed in the submitted hydrologic model. Future development of projects upstream could cause increased discharges, which could cause increased flood hazards. A comprehensive restudy of your community's flood hazards would consider the cumulative effects of development on discharges and could, therefore, indicate that greater flood hazards exist in this area.

Your community must regulate all proposed floodplain development and ensure that permits required by Federal and/or State/Commonwealth law have been obtained. State/Commonwealth or community officials, based on knowledge of local conditions and in the interest of safety, may set higher standards for construction or may limit development in floodplain areas. If your State/Commonwealth or community has adopted more restrictive or comprehensive floodplain management criteria, those criteria take precedence over the minimum NFIP requirements.

We will not print and distribute this LOMR to primary users, such as local insurance agents or mortgage lenders; instead, the community will serve as a repository for the new data. We encourage you to disseminate the information in this LOMR by preparing a news release for publication in your community's newspaper that describes the revision and explains how your community will provide the data and help interpret the NFIP maps. In that way, interested persons, such as property owners, insurance agents, and mortgage lenders, can benefit from the information.

This determination is based on the flood data presently available. The enclosed documents provide additional information regarding this determination. If you have any questions about this document, please contact the FEMA Map Information eXchange toll free at 1-877-336-2627 (1-877-FEMA MAP) or by letter addressed to the LOMC Clearinghouse, 3601 Eisenhower Avenue, Suite 500, Alexandria, VA 22304-6426. Additional information about the NFIP is available on our website at <https://www.fema.gov/national-flood-insurance-program>.

Patrick "Rick" F. Sacbibit, P.E., Branch Chief
Engineering Services Branch
Federal Insurance and Mitigation Administration

18-04-3990P

102-I-A-C



Federal Emergency Management Agency

Washington, D.C. 20472

LETTER OF MAP REVISION DETERMINATION DOCUMENT (CONTINUED)

This revision has met our criteria for removing an area from the 1-percent-annual-chance floodplain to reflect the placement of fill. However, we encourage you to require that the lowest adjacent grade and lowest floor (including basement) of any structure placed within the subject area be elevated to or above the Base (1-percent-annual-chance) Flood Elevation.

We have designated a Consultation Coordination Officer (CCO) to assist your community. The CCO will be the primary liaison between your community and FEMA. For information regarding your CCO, please contact:

Mr. Jesse Munoz
Director, Mitigation Division
Federal Emergency Management Agency, Region IV
Koger Center - Rutgers Building, 3003 Chamblee Tucker Road
Atlanta, GA 30341
(770)-220-5406

STATUS OF THE COMMUNITY NFIP MAPS

We will not physically revise and republish the FIRM and FIS report for your community to reflect the modifications made by this LOMR at this time. When changes to the previously cited FIRM panels and FIS report warrant physical revision and republication in the future, we will incorporate the modifications made by this LOMR at that time.

This determination is based on the flood data presently available. The enclosed documents provide additional information regarding this determination. If you have any questions about this document, please contact the FEMA Map Information eXchange toll free at 1-877-336-2627 (1-877-FEMA MAP) or by letter addressed to the LOMC Clearinghouse, 3601 Eisenhower Avenue, Suite 500, Alexandria, VA 22304-6426. Additional information about the NFIP is available on our website at <https://www.fema.gov/national-flood-insurance-program>.

A handwritten signature in black ink, appearing to read "Rick F. Sacbibit".

Patrick "Rick" F. Sacbibit, P.E., Branch Chief
Engineering Services Branch
Federal Insurance and Mitigation Administration



Federal Emergency Management Agency

Washington, D.C. 20472

LETTER OF MAP REVISION DETERMINATION DOCUMENT (CONTINUED)

PUBLIC NOTIFICATION OF REVISION

A notice of changes will be published in the *Federal Register*. This information also will be published in your local newspaper on or about the dates listed below, and through FEMA's Flood Hazard Mapping website at

https://www.floodmaps.fema.gov/fhm/bfe_status/bfe_main.asp

LOCAL NEWSPAPER

Name: *The News-Press*

Dates: August 26, 2019 and September 2, 2019

Within 90 days of the second publication in the local newspaper, any interested party may request that we reconsider this determination. Any request for reconsideration must be based on scientific or technical data. Therefore, this letter will be effective only after the 90-day appeal period has elapsed and we have resolved any appeals that we receive during this appeal period. Until this LOMR is effective, the revised flood hazard determination presented in this LOMR may be changed.

This determination is based on the flood data presently available. The enclosed documents provide additional information regarding this determination. If you have any questions about this document, please contact the FEMA Map Information eXchange toll free at 1-877-336-2627 (1-877-FEMA MAP) or by letter addressed to the LOMC Clearinghouse, 3601 Eisenhower Avenue, Suite 500, Alexandria, VA 22304-6426. Additional information about the NFIP is available on our website at <https://www.fema.gov/national-flood-insurance-program>.

A handwritten signature in black ink, appearing to read "Rick F. Sacbibit".

Patrick "Rick" F. Sacbibit, P.E., Branch Chief
Engineering Services Branch
Federal Insurance and Mitigation Administration

Table 8 – Summary of Discharges (continued)

<u>Flooding Source and Location</u>	<u>Drainage Area (Square Miles)</u>	<u>PEAK DISCHARGES (cfs)</u>			
		<u>10-Percent- Annual-Chance</u>	<u>4-Percent-Annual- Chance</u>	<u>1-Percent- Annual-Chance</u>	<u>0.2-Percent- Annual-Chance</u>
SIX MILE CYPRESS SLOUGH					
At mouth	34.4	2,578	3,588	5,026	6,521
At Daniels Parkway	26.47	2,086	2,880	4,079	5,420
At I-75	5.14	993	1,334	1,834	2,384
SOUTH BRANCH					
At mouth	14.24	356	421	586	698
At I-75	11.85	252	337	468	560
SPANISH CANAL					
At mouth	0.56	123	167	235	314
SPANISH CREEK					
At mouth	7.44	1,124	1,603	2,243	2,669
At River Road	7.15	1,018	1,438	2,018	2,620
SPRING CREEK					
At mouth	11.7	1,692	2,143	2,872	3,746
At South Tamiami Trail	5.34	1,303	1,646	2,178	2,861
STRICKLIN GULLY					
At mouth	2.62	625	839	1,167	1,549
STROUD CREEK					
At mouth	8.35	975	1,254	1,584	2,044
At Bayshore Road	7.94	999	1,308	1,771	2,307
TELEGRAPH CREEK					
At mouth	81.17	5,117	7,125	10,637	14,778
TEN MILE CANAL					
At mouth	70.4	2,260	3,290	4,190	5,205
At Daniels Parkway	11	1,410	1,700	1,990	2,270
At Colonial Boulevard	3.9	495	545	615	620
TROUT CREEK/CURRY LAKE CANAL					
At mouth	29.42	2,469	3,788	5,475	7,723
At River Road	28.08	3,023	4,223	6,000	7,731
Just upstream of Stricklin Gully	16.36	1,107	1,317	1,605	2,142
WINKLER CANAL					
At mouth	1.34	325	365	463	574
Just downstream of Cleveland Avenue	0.56	141	168	209	245

FLOODING SOURCE		FLOODWAY			BASE FLOOD WATER SURFACE ELEVATION (FEET NAVD)			
CROSS SECTION	DISTANCE ¹	WIDTH (FEET)	SECTION AREA (SQUARE FEET)	MEAN VELOCITY (FEET PER SECOND)	REGULATORY	WITHOUT FLOODWAY	WITH FLOODWAY	INCREASE
TROUT CREEK/CURRY LAKE CANAL								
A	2,944	1,503	6,713	0.9	6.8 ²	5.1 ³	5.2	0.1
B	5,344	3,372	9,355	0.6	6.8 ²	5.6 ³	6.0	0.4
C	6,709	3,326	9,900	0.6	6.8 ²	5.9 ³	6.4	0.5
D	9,347	3,338	8,297	0.7	6.8 ²	6.6 ³	7.3	0.7
E	10,800	860	2,610	2.3	9.2	9.2	9.3	0.1
F	15,216	1,191	4,019	1.1	11.7	11.7	12.7	1.0
G	16,366	654	2,445	1.8	12.9	12.9	13.8	0.9
H	18,151	1,053	2,817	0.6	14.4	14.4	14.9	0.5
I	19,839	1,090	1,276	1.2	16.3	16.3	17.0	0.7
J	20,799	2,580	1,558	0.7	17.9	17.9	18.3	0.4
K	21,708	2,575	2,449	0.4	19.0	19.0	19.3	0.3
L	23,137	1,703	1,528	0.7	20.3	20.3	21.0	0.7

← REVISED REACH

¹Feet above mouth.

²Elevation computed without consideration of wave effects.

³Elevation computed without consideration of backwater effects from Caloosahatchee River.

TABLE 11	FEDERAL EMERGENCY MANAGEMENT AGENCY LEE COUNTY, FL AND INCORPORATED AREAS	FLOODWAY DATA	REVISED TO REFLECT LOMR EFFECTIVE: December 31, 2019
		TROUT CREEK/CURRY LAKE CANAL	

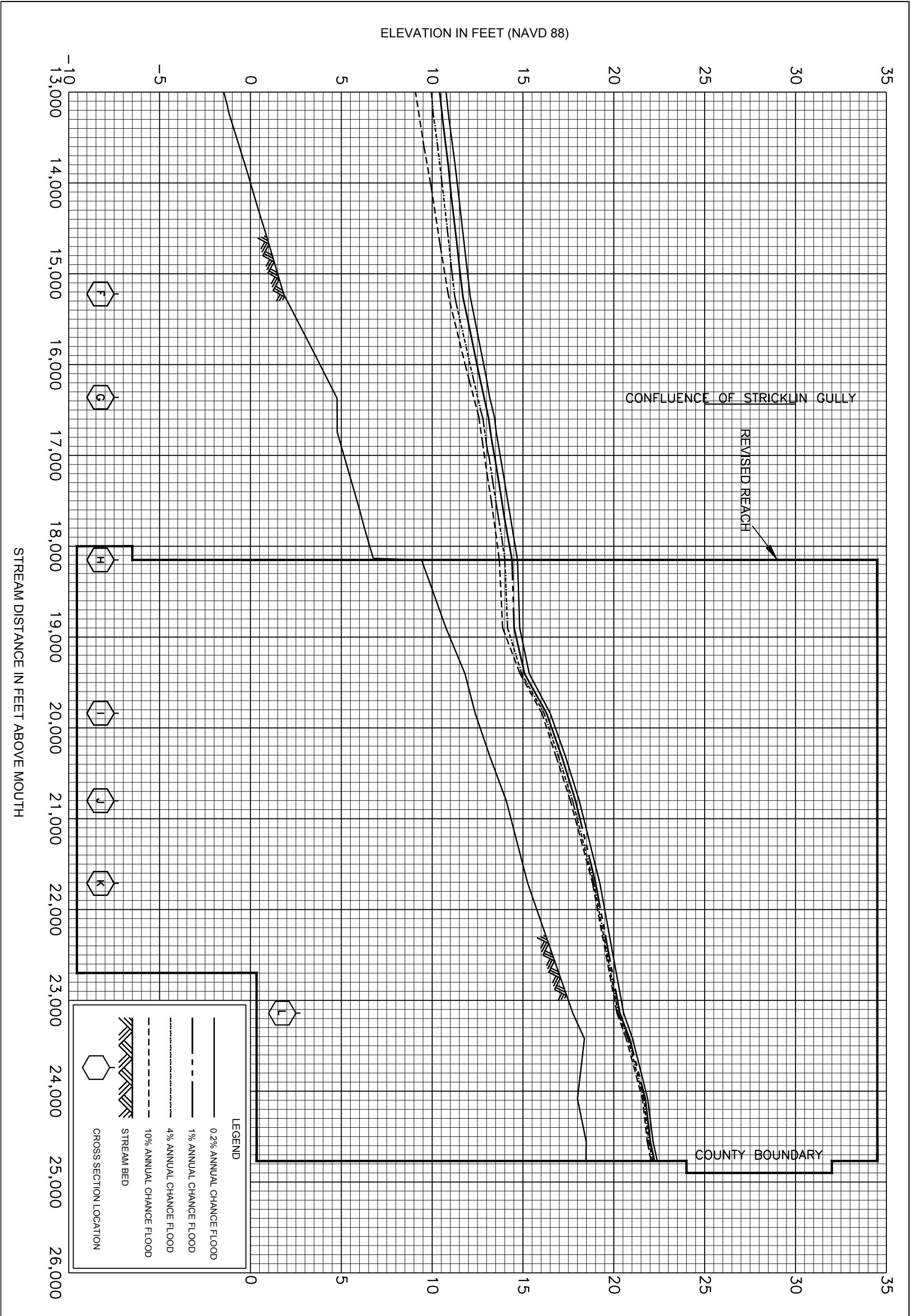

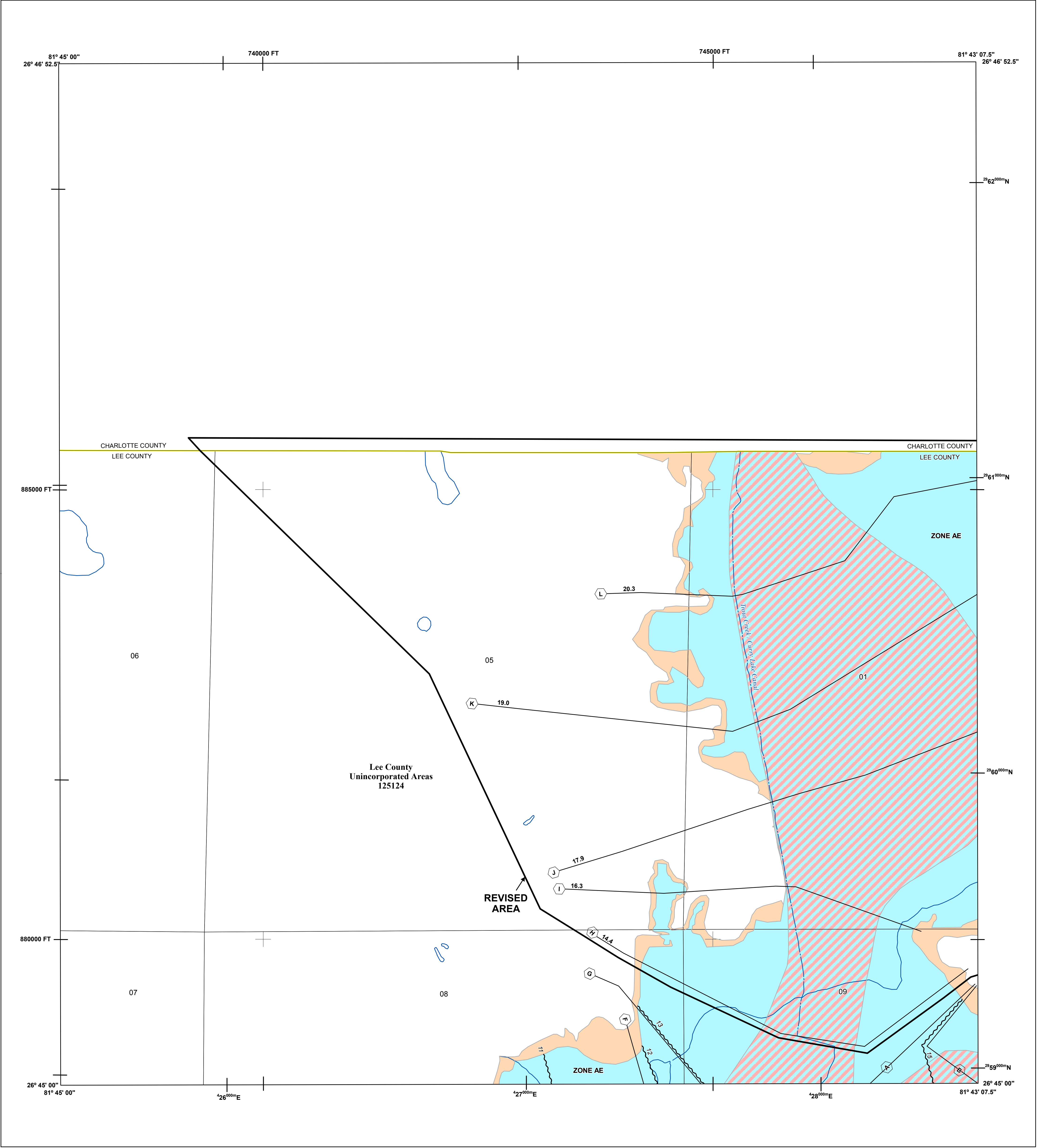

FLOOD HAZARD INFORMATION

SEE FIS REPORT FOR ZONE DESCRIPTIONS AND INDEX MAP THE INFORMATION DEPICTED ON THIS MAP AND SUPPORTING DOCUMENTATION ARE ALSO AVAILABLE IN DIGITAL FORMAT AT HTTPS://MSC.FEMA.GOV	
SPECIAL FLOOD HAZARD AREAS	Without Base Flood Elevation (BFE) Zone A, V, A99
	With BFE or Depth Zone AE, AO, AH, VE, AR
OTHER AREAS OF FLOOD HAZARD	Regulatory Floodway
	0.2% Annual Chance Flood Hazard, Areas of 1% annual chance flood with average depth less than one foot or with drainage areas of less than one square mile Zone X
	Future Conditions 1% Annual Chance Flood Hazard Zone X
OTHER AREAS	Area with Reduced Flood Risk due to Levee See Notes. Zone X
	NO SCREEN Areas Determined to be Outside the 0.2% Annual Chance Floodplain Zone X
GENERAL STRUCTURES	Area of Undetermined Flood Hazard Zone D
	Channel, Culvert, or Storm Sewer
OTHER FEATURES	Levee, Dike, or Floodwall
	Cross Sections with 1% Annual Chance Water Surface Elevation (BFE)
OTHER FEATURES	Coastal Transect
	Coastal Transect Baseline
OTHER FEATURES	Profile Baseline
	Hydrographic Feature
OTHER FEATURES	Base Flood Elevation Line (BFE)
	Limit of Study
OTHER FEATURES	Jurisdiction Boundary

NOTES TO USERS

For information and questions about this Flood Insurance Rate Map (FIRM), available products associated with this FIRM, including historic versions, the current map date for each FIRM panel, how to order products, or the National Flood Insurance Program (NFIP) in general, please call the FEMA Map Information eXchange at 1-877-FEMA-MAP (1-877-336-2627) or visit the FEMA Flood Map Service Center website at <http://mmsc.fema.gov>. Available products may include previously issued Letters of Map Change, a Flood Insurance Study Report, and/or digital versions of this map. Many of these products can be ordered or obtained directly from the website.

Communities annexing land on adjacent FIRM panels must obtain a current copy of the adjacent panel as well as the current FIRM Index. These may be ordered directly from the Flood Map Service Center at the number listed above.

For community and countywide map dates refer to the Flood Insurance Study report for this jurisdiction.

To determine if flood insurance is available in the community, contact your insurance agent or call the National Flood Insurance Program at 1-800-638-6620.

Base map information shown on this FIRM was provided in digital format by the Lee County GIS Department. The Road centerline information was constructed based on orthophotography produced at a scale of 1"=100' from aerial imagery flown in 1998 and updated using orthophotography dated 2002 and 2005. The surface water features were also constructed based on orthophotography produced at a scale of 1"=100' from aerial imagery flown in 1998.

SCALE

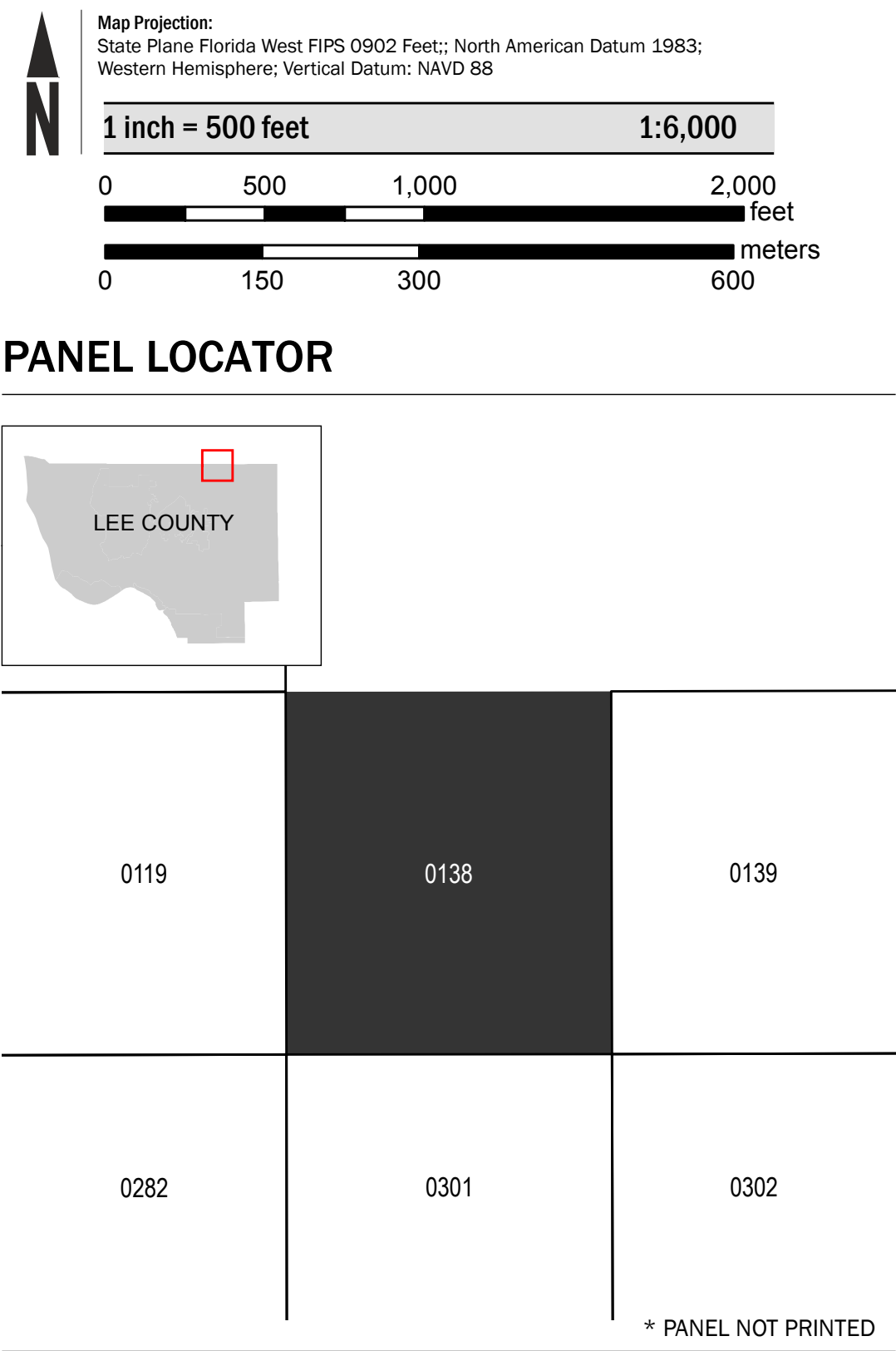



National Flood Insurance Program

NATIONAL FLOOD INSURANCE PROGRAM
FLOOD INSURANCE RATE MAP

LEE COUNTY, FLORIDA
and Incorporated Areas

PANEL 138 of 685

Panel Contains:

COMMUNITY	NUMBER	PANEL	SUFFIX
LEE COUNTY	125124	0138	F

REVISED TO REFLECT LOMR
EFFECTIVE: December 31, 2019

VERSION NUMBER
2.1.3.0

MAP NUMBER
12071C0138F

EFFECTIVE DATE
AUGUST 28, 2008

T. 42 S. CHARLOTTE COUNTY

T. 43 S.

LEE COUNTY

885000 FT

20.3



20

ZONE AE

19

19.0



04

03

JOINS PANEL 0138

17.9

ZONE AE

Lee County
Unincorporated Areas
125124

880000 FT

09

REVISED
AREA



10

ZONE AE

SPECIAL FLOOD HAZARD AREAS		Without Base Flood Elevation (BFE) Zone A, V, A99
		With BFE or Depth Zone AE, AO, AH, VE, AR
		Regulatory Floodway

OTHER AREAS OF FLOOD HAZARD		0.2% Annual Chance Flood Hazard, Areas of 1% annual chance flood with average depth less than one foot or with drainage areas of less than one square mile Zone X
		Future Conditions 1% Annual Chance Flood Hazard Zone X
		Area with Reduced Flood Risk due to Levee See Notes. Zone X

SCALE

Map Projection:
NAD 1983 StatePlane Florida West FIPS 0902 Feet;
Western Hemisphere; Vertical Datum: NAVD 88

1 inch = 500 feet 1:6,000

0 250 500 1,000 Feet
0 75 150 300 Meters

National Flood Insurance Program

NATIONAL FLOOD INSURANCE PROGRAM
FLOOD INSURANCE RATE MAP

LEE COUNTY, FLORIDA
and Incorporated Areas

PANEL 139 OF 685

Panel Contains:

COMMUNITY	NUMBER	PANEL	SUFFIX
LEE COUNTY	125124	0139	F

REVISED TO
REFLECT LOMR
EFFECTIVE: December 31, 2019



VERSION NUMBER
2.1.3.0
MAP NUMBER
12071C0139F
EFFECTIVE DATE
AUGUST 28, 2008