



# EVENT PERMIT

Ordinance 17-08



## Publix Spanish Heritage

**PERMIT NUMBER:** TMP2025-00223

**Date(s) of Event:** September 30, 2025

**Property Owner:** LEE COUNTY

**Applicant:** Jacob Lawton  
3238640350

**Description:** Celebrating Spanish Heritage month for guest of Wa-Ke Hatchee Park September 30, 2025, from 11:00AM until 5:00PM Free activities and snacks.

**Location of event:** 16760 BASS RD, FORT MYERS, FL 33908

Will the event be attended by 1000 or more people ? Yes

Will the event be held on County Owned Property ? Yes

Will there be alcohol consumed or sold at the event ? No

Will a bond be posted for this event ? No

### Permit Conditions:

- \* Applicant must meet all event application requirements, including requirements of the sign-off agencies.
- \* The premises is to be left in the same condition as it was prior to the event.
- \* The permit is to be readily available for inspection during the entire event.
- \* If this approval includes the sale or consumption of alcoholic beverages, no alcoholic beverages may be consumed 1 1/2 hours prior to the conclusion of the event and vacating the facility/property.

Board of County Commissioners  
Lee County, Florida

 7/29/25  
County Manager Date



Lee County  
*Southwest Florida*

# Event Application

Special Event

Use of  
County  
Property

Alcohol  
within Lee  
County  
Facilities

Film, Video  
&  
Photography

*Publix Spanish Heritage*

*TMP2025 - 00223*



# Lee County Event Permit Application



## Event Application

Check the appropriate box(es) below:

- ☒ SPECIAL EVENT PERMIT  
☒ USE OF COUNTY PROPERTY PERMIT  
☐ PERMIT TO SELL AND CONSUME ALCHOLIC BEVERAGES WITHIN LEE COUNTY FACILITIES  
☐ FILM PERMIT

### Section I - GENERAL INFORMATION (All Permit Types)

<b>Title of Event / Name of Production</b>	PUBLIX SPANISH HERITAGE
<b>Date(s) of Event / Production:</b>	SEPT 30TH, 2025
<b>Location(s) of Event:</b>	Wa-Ke Hatchee Park parking lot
<b>Name of Applicant:</b>	Jacob Lawton
<b>Applicant Address:</b>	10951 W. Pico Blvd. Los Angeles, CA 90064
<b>Applicant Phone Number:</b>	323-864-0350
<b>Contact Person:</b> (If different from applicant)	
<b>Contact Phone Number:</b> (If different from applicant)	
<b>Email Address:</b>	jake@rmng.co
<b>Estimated Attendance:</b>	500-1000
<b>Event Description:</b> Include each activity, when activities take place, etc.	Publix is celebrating Spanish Heritage month by bringing the celebration to the guests of Wa-Ke Hatchee park. Guests are invited for free activites like creating their own free flower bouquet, creating their own free custom hat, and free snacks. This is a giveback program from Publix and everyone is ivited to come celebrate.
<b>Hours of Operation:</b>	11A-5P
<b>STRAP # of Parcel:</b>	
<b>Owner of Premises*:</b>	

\*Notarized statement from the property owner specifically consenting to the proposed use required.

## Lee County Event Permit Application



What is the Zoning Classification of the premises? Park

Are any temporary structures to be installed for the event? ☒ Yes ☐ No Type: Archway truss structure

Do you have the appropriate permits for the temporary structures? ☒ Yes ☐ No

\* For a 'Special Event' and 'Use of County Property' permit, submit a site plan with all proposed facilities and activities identified, including all parking areas.

Insurance Company Insuring the Event: Alliant Insurance Services, Inc  
32 Old Slin 29th Fl

Note: Certificate of Insurance must be submitted at time of application

Surety Company Bonding this Event (Name and Address): \_\_\_\_\_

Will Vehicles be Used as Part of This Event?

☒ Yes ☐ No

If yes, automobile coverage must be included on the certificate of insurance.

Will Food be Available at this Event?

☒ Yes ☐ No

If yes, products liability coverage must be included on the certificate of insurance.

Will Alcoholic Beverages be served/consumed at this Event?

☐ Yes ☒ No

If yes, liquor liability coverage must be included on the certificate of insurance.

Name & Address of Organization Providing Food: Publix Super Markets

Type of Food being Served: Lemonade, Coffee, Sample size sandwiches

### Section II - USE OF COUNTY PROPERTY PERMIT

Organization Sponsoring the Event: \_\_\_\_\_

### Section III - SALE/CONSUMPTION OF ALCHOLIC BEVERAGES PERMIT

Is alcohol being sold/consumed on County Property? Yes ☒ No

If Yes, then a "Lee County Alcohol Permit" is required. Only non-profit organizations can sell alcohol on County Property.

Non-profit certificate/registration number: \_\_\_\_\_

(Required if alcohol is to be **SOLD** at the event)

**Please note:** A permit from the State of Florida Division of Alcoholic Beverages and Tobacco may also be required; please call (239) 344-0885 for further details



## Lee County Event Permit Application



Type of Production (choose all that apply):

<input type="checkbox"/> TV Movie or Special	<input type="checkbox"/> TV Series / Pilot	<input type="checkbox"/> TV Commercial	<input type="checkbox"/> Still Photos
<input type="checkbox"/> Public Service Announcement	<input type="checkbox"/> Industrial / Documentary	<input checked="" type="checkbox"/> Other: <u>Brand Promotion</u>	

Will any of the following be needed or included\*?

Street Closure	<input type="checkbox"/> Yes	<input checked="" type="checkbox"/> No
Traffic / Crowd Control	<input type="checkbox"/> Yes	<input checked="" type="checkbox"/> No
Fire or Burning	<input type="checkbox"/> Yes	<input checked="" type="checkbox"/> No
Explosives or Pyrotechnics	<input type="checkbox"/> Yes	<input checked="" type="checkbox"/> No
Animals, Large or Small	<input type="checkbox"/> Yes	<input checked="" type="checkbox"/> No
Construction of Any Kind	<input checked="" type="checkbox"/> Yes	<input type="checkbox"/> No
Large and/or Numerous Vehicles	<input checked="" type="checkbox"/> Yes	<input type="checkbox"/> No
Helicopters, Boats, etc.	<input type="checkbox"/> Yes	<input checked="" type="checkbox"/> No
Stunts	<input type="checkbox"/> Yes	<input checked="" type="checkbox"/> No
Other	<input type="checkbox"/> Yes	<input checked="" type="checkbox"/> No

\* For any marked Yes, provide further details below:

The footprint will need to be constructed. The setup takes approx 3-4 hours with minimal equipment being used. All items in the foot print are prefabricated and just need to be setup. We have 3 box trucks that will be bringing all the set items. These are standard 24' box trucks.

Special Parking Requirements:

N/A

City or County Services Required: (Personnel, equipment, facilities, etc.)

N/A

The following information is required for local and state records on production in Florida to track the economic impact of the industry. If exact figures are not available, please estimate as closely as possible.

Number in Cast: <u>N/A</u>	Number in Crew: _____	Number of locals hired: _____
Total budget: _____	Estimate amount spent in Lee County: _____	
Hotel room nights: _____	Number of shooting days: _____	
number of rooms x number of nights		



## **SECTION I - SAFETY**

The Applicant agrees to provide adequate traffic and crowd control, emergency medical services and any other items, at the Applicant's expense, required by Lee County to protect the health, safety and welfare of the public. Lee County shall have the power to review the proposal and require, as necessary, detailed plans, diagrams, and explanations to clearly outline to Lee County, exactly what the Applicant is proposing.

## **SECTION II - INSURANCE**

The Applicant, at its sole expense, agrees to procure and maintain in force during the entire term of the application, liability insurance in the amounts determined by Lee County Risk Management to protect against damages or other claims arising from use of County property by the applicant or its guests. Other limits may also be established by Lee County Risk Management for events which will be serving or consuming alcoholic beverages at approved County property. The insurance policy must also include coverage for Applicant's contingent liability on damages, claims or losses. "Lee County Board of County Commissioners" must be named as "additional insured" on the Certificate of Insurance, and the Certificate must be delivered to Lee County prior to Applicant's use of the property. The Insurance may not be canceled during the term of the event, if this occurs, the County has the right to revoke approvals related to use of the County property for the event, without recourse by the applicant.

## **SECTION III - INDEMNIFICATION**

The Applicant agrees to indemnify, release and save harmless Lee County against any and all claims, costs, demands, damages, judgments or injuries of any nature arising from the conduct or management of, or from any work or thing whatsoever done in or about said Lee County property or any building or structure appurtenant thereto or equipment thereof during the term of this Permit, or arising during such term from any act of negligence of the Applicant, Applicant's agents, contractors, or employees, or arising from any accident, injury, or damage whatsoever, however caused, to any person or persons, or to any property of any person, persons, corporation or corporations, occurring during the term of this agreement on, in, or about said Lee County property, and from and against all costs, attorney's fees, expenses and liabilities occurring in connection with any such claim or any action or proceeding brought thereon.

For film permit applicants: The permittee shall have on-site a responsible representative empowered with authority over the filming director, filming crews, participants and filming operation. Permittee shall indemnify, defend and hold harmless the county, its officers, agents and employees from and against all claims, suits, actions, damages, liabilities, expenditures or causes of action of any kind arising out of or occurring during the activities of the permittee, and resulting or occurring from any negligent act, omission or error of permittee, resulting in or relating to injuries to body, life, limb or property sustained in, about or upon the permitted premises or improvement thereto, or arising from the use of the premises.

## **SECTION IV - DELIVERY, ACCEPTANCE AND SURRENDER OF PREMISES**

The Applicant agrees to accept the County property on possession as being in a satisfactory state of repair and in sanitary condition.

The Applicant must surrender the premises to Lee County in the same condition as when Applicant takes possession, allowing for reasonable use and wear, and damage by acts of God. Applicant agrees to remove all business signs or symbols placed on the premises by the Applicant before redelivery of the premises to Lee County, and restore the premises to the condition in which it existed before their placement. Any signs and markings created or used in connection with this event must be temporary and removable; painting roadways, trees or any other fixed object is strictly prohibited. Applicant agrees to clear the Lee County property of litter at the close of the event.



## Lee County Event Permit Application



### SECTION V - AGREEMENT

The Applicant agrees that Lee County can, at its sole discretion, terminate and cancel its permit to use Lee County property at any time without prejudice. Applicant further agrees to waive, release, save and hold harmless Lee County from any and all claims, demands or cause of actions based upon Lee County's cancellation or termination of said permit.

The Applicant agrees that the Lee County permit does not provide Applicant with any property rights in the County property in question or in the permit itself.

The applicant does acknowledge and hereby affirms that any and all information is accurate to the best of his/her knowledge.

A handwritten signature in black ink, appearing to read 'J. Lawton', is written over a horizontal line.

Signature of Applicant

Jacob Lawton

Print Name of Applicant and Title

5/28/25

Date

A handwritten signature in black ink, appearing to read 'DJ Steinburg', is written over a horizontal line.

Witness

DJ Steinburg

Print Name of Witness

7/24/25

Date

Lee County Event Permit Application



LEE COUNTY SHERIFF'S DEPARTMENT  
14750 SIX MILE CYPRESS PARKWAY  
FORT MYERS, FLORIDA 33912  
(239) 477-1199

Check the appropriate box(es) below:

- ☐ SPECIAL EVENT PERMIT  
☒ USE OF COUNTY PROPERTY PERMIT  
☐ PERMIT TO SELL AND CONSUME ALCOHOLIC BEVERAGES WITHIN LEE COUNTY FACILITIES  
☐ FILM PERMIT

AFTER REVIEWING THE APPLICATION, PLEASE INDICATE BELOW WHAT ARRANGEMENTS YOUR ORGANIZATION WILL REQUIRE THE APPLICANT TO COMPLY WITH FOR THEIR EVENT.

Parking:

All parking for event will be on site and in authorized areas only.

Deputies (How Many?):

None required

Fee for Services:

None required

Special Arrangements:

If there will be any amplified sound, it must adhere to the Lee County Noise ordinance. It is understood that this a free event being advertised by Publix.

Print Name:

P. Cummins

Signature:

*[Handwritten Signature]*

Title:

Support Services

Date:

6.11.25



## Lee County Event Permit Application



### FIRE DEPARTMENT

*The Fire Department serving the area where the event is to be held signs this form.*

*Please see User's Guide for contact information and Fire District Map.*

*Check the appropriate box(es) below:*

- ☐ SPECIAL EVENT PERMIT
- ☒ USE OF COUNTY PROPERTY PERMIT
- ☐ PERMIT TO SELL AND CONSUME ALCOHOLIC BEVERAGES WITHIN LEE COUNTY FACILITIES
- ☐ FILM PERMIT

AFTER REVIEWING THE APPLICATION, PLEASE INDICATE BELOW WHAT ARRANGEMENTS YOUR ORGANIZATION WILL REQUIRE THE APPLICANT TO COMPLY WITH FOR THEIR EVENT.

Fire Guards (How Many?)	NA
Fee for Services:	NA
Flammable Vegetation:	10' clearance to any combustible
First Aid Equipment:	First Aid kit and Staff will be instructed to call 911 if any health issues arise.
Fire Extinguishing:	Fire extinguishers shall be serviced/tagged within previous 12 months. Trucks and trailer will have up to date fire Extinguishing
Special Arrangements:	Call 911 in the event of an emergency

Print Name: Jackielou Mozes

Signature: fmazes

Title: Fire Marshal

Date: 7/2/2025

## Lee County Event Permit Application



## EMERGENCY MEDICAL SERVICES / PUBLIC SAFETY

2000 Main St., Suite #100

FORT MYERS, FL 33901

(239) 533-3911

Check the appropriate box(es) below:

- ☒ SPECIAL EVENT PERMIT
- ☒ USE OF COUNTY PROPERTY PERMIT
- ☐ PERMIT TO SELL AND CONSUME ALCOHOLIC BEVERAGES WITHIN LEE COUNTY FACILITIES
- FILM PERMIT

AFTER REVIEWING THE APPLICATION, PLEASE INDICATE BELOW WHAT ARRANGEMENTS YOUR ORGANIZATION WILL REQUIRE THE APPLICANT TO COMPLY WITH FOR THEIR EVENT.

Treatment Facilities:	None necessary.
Medical Personnel:	None necessary.
Medical Supplies / Equipment:	None necessary.
Safety Requirements:	Applicants shall follow all CDC and FDOH directives, and the Florida Governor's Executive Orders concerning health and safety.
Fee for Services	Not applicable.
Special Arrangements:	Please call 911 in the event of an emergency. To arrange special event coverage, contact our office at EMSDetail@leegov.com.

Print Name: Douglas B. Higgins

Signature: Douglas B. Higgins

Digitally signed by Douglas B. Higgins  
Date: 2025.06.23 17:28:41 -04'00'

Title: Captain, EMS Operations

Date: June 23, 2025



## Lee County Event Permit Application



DEPARTMENT OF TRANSPORTATION  
1500 MONROE STREET  
FORT MYERS, FL 33901  
(239) 533-8580

*Check the appropriate box(es) below:*

- ☒ SPECIAL EVENT PERMIT  
☒ USE OF COUNTY PROPERTY PERMIT  
☐ PERMIT TO SELL AND CONSUME ALCOHOLIC BEVERAGES WITHIN LEE COUNTY FACILITIES  
☐ FILM PERMIT

AFTER REVIEWING THE APPLICATION, PLEASE INDICATE BELOW WHAT ARRANGEMENTS YOUR ORGANIZATION WILL REQUIRE THE APPLICANT TO COMPLY WITH FOR THEIR EVENT.

Parking:

No event parking is permitted in Lee County maintained road right of ways.

Ingress and Egress:

Please use all established means of ingress and egress.

Special Arrangements:

Shall use Lee County Sheriff's Office for assistance with traffic control as needed. Emergency vehicle access and public vehicular access shall be maintained on all surrounding Lee County maintained roads.

Print Name: Nathan Thoman

Signature: Nathaniel C. Thoman

Digitally signed by Nathaniel C. Thoman  
Date: 2025.06.10 07:42:27 -04'00'

Title: Project Manager

Date: 06/10/2025

Lee County Event Permit Application



LEE COUNTY PARKS AND RECREATION  
3410 PALM BEACH BOULEVARD  
FORT MYERS, FLORIDA 33916  
(239) 533-7275

Check the appropriate box(es) below:

- ☒ SPECIAL EVENT PERMIT  
☒ USE OF COUNTY PROPERTY PERMIT  
☐ PERMIT TO SELL AND CONSUME ALCOHOLIC BEVERAGES WITHIN LEE COUNTY FACILITIES  
☐ FILM PERMIT

AFTER REVIEWING THE APPLICATION, PLEASE INDICATE BELOW WHAT ARRANGEMENTS YOUR ORGANIZATION WILL REQUIRE THE APPLICANT TO COMPLY WITH FOR THEIR EVENT.

Illumination:

Facility does not have any additional lighting. Any lighting needs would be the responsibility of the event organizer.

Parking Areas:

All vehicles must use designated parking areas. Work with site supervisor for any additional parking needs.

Special Arrangements:

Work with on site supervisor and staff for setup and breakdown or any other event need. No staking of tents or inflatables. Please use buckets or sand bags.

Event organizer must clean up all debris after the event. Participants must disperse and leave the park area to seek safe shelter during lightning alerts or threatening weather.

Event organizer must comply with all terms as stated and adhere to Lee County Ordinances No. 93-15 (noise) and 18-12 (as amended).

Print Name: Trever Snearley

Signature:

Title: County Wide Services Manager

Date: 6/16/2025

JA-KE HATCHEE - Publix SPANISH HERITAGE  
9/30/2025



## Lee County Event Permit Application



LEE COUNTY RISK MANAGEMENT  
COUNTY ADMINISTRATION BUILDING - 4<sup>TH</sup> FLOOR  
2115 SECOND STREET  
FORT MYERS, FLORIDA 33901  
(239) 533-2221

Check the appropriate box(es) below:

- ☒ SPECIAL EVENT PERMIT
- ☒ USE OF COUNTY PROPERTY PERMIT
- ☐ PERMIT TO SELL AND CONSUME ALCOHOLIC BEVERAGES WITHIN LEE COUNTY FACILITIES
- ☐ FILM PERMIT

AFTER REVIEWING THE APPLICATION, PLEASE INDICATE BELOW WHAT ARRANGEMENTS YOUR ORGANIZATION WILL REQUIRE THE APPLICANT TO COMPLY WITH FOR THEIR EVENT.

Insurance Requirements:

Commercial general liability insurance with minimum limits of One Million Dollars (\$1,000,000) per occurrence to protect against bodily injury and/or property damage relative to applicants use of aforementioned event within Lee County.

Certificate Must Read As:

Lee County, a political subdivision and Charter County of the State of Florida, its agents, employees, and public officials are automatic additional insureds and includes an automatic waiver of subrogation with regard to general liability. The certificate holder is an additional insured on a primary and noncontributory basis with regards to general liability.

Special Arrangements:

A Certificate of Insurance shall be submitted as evidence of the required coverage listing Lee County, a political subdivision and Charter County of the State of Florida, P.O. Box 398, Fort Myers, FL 33902 as the certificate holder and as an additional insured as listed above.

Subject to proof of insurance.

Print Name: Valerie Miller

Signature: Valerie Miller

Digitally signed by Valerie Miller  
Date: 2025.07.23 07:46:26 -04'00'

Title: Risk Management Analyst

Date:



# CERTIFICATE OF LIABILITY INSURANCE

DATE (MM/DD/YYYY)

7/22/2025

THIS CERTIFICATE IS ISSUED AS A MATTER OF INFORMATION ONLY AND CONFERS NO RIGHTS UPON THE CERTIFICATE HOLDER. THIS CERTIFICATE DOES NOT AFFIRMATIVELY OR NEGATIVELY AMEND, EXTEND OR ALTER THE COVERAGE AFFORDED BY THE POLICIES BELOW. THIS CERTIFICATE OF INSURANCE DOES NOT CONSTITUTE A CONTRACT BETWEEN THE ISSUING INSURER(S), AUTHORIZED REPRESENTATIVE OR PRODUCER, AND THE CERTIFICATE HOLDER.

**IMPORTANT:** If the certificate holder is an ADDITIONAL INSURED, the policy(ies) must have ADDITIONAL INSURED provisions or be endorsed. If SUBROGATION IS WAIVED, subject to the terms and conditions of the policy, certain policies may require an endorsement. A statement on this certificate does not confer rights to the certificate holder in lieu of such endorsement(s).

<b>PRODUCER</b> Alliant Insurance Services, Inc 32 Old Slip 29th Fl New York NY 10005	<b>CONTACT NAME:</b> Matthew Leyva <b>PHONE (A/C, No, Ext):</b> <b>FAX (A/C, No):</b> <b>E-MAIL ADDRESS:</b> Matthew.Leyva@alliant.com
<b>INSURED</b> SCP Roaming Innovations, LLC Roaming Hunger, LLC Acacia NPU Inc DBA cater2.me 10951 Pico Boulevard Suite 300 Los Angeles CA 90064	<b>INSURER(S) AFFORDING COVERAGE</b> <b>INSURER A:</b> TBD <b>INSURER B:</b> TBD <b>INSURER C:</b> <b>INSURER D:</b> <b>INSURER E:</b> <b>INSURER F:</b>

**COVERAGES****CERTIFICATE NUMBER:** 123700148**REVISION NUMBER:**

THIS IS TO CERTIFY THAT THE POLICIES OF INSURANCE LISTED BELOW HAVE BEEN ISSUED TO THE INSURED NAMED ABOVE FOR THE POLICY PERIOD INDICATED. NOTWITHSTANDING ANY REQUIREMENT, TERM OR CONDITION OF ANY CONTRACT OR OTHER DOCUMENT WITH RESPECT TO WHICH THIS CERTIFICATE MAY BE ISSUED OR MAY PERTAIN, THE INSURANCE AFFORDED BY THE POLICIES DESCRIBED HEREIN IS SUBJECT TO ALL THE TERMS, EXCLUSIONS AND CONDITIONS OF SUCH POLICIES. LIMITS SHOWN MAY HAVE BEEN REDUCED BY PAID CLAIMS.

INSR LTR	TYPE OF INSURANCE	ADDL INSD	SUBR WVD	POLICY NUMBER	POLICY EFF (MM/DD/YYYY)	POLICY EXP (MM/DD/YYYY)	LIMITS
A	<input checked="" type="checkbox"/> <b>COMMERCIAL GENERAL LIABILITY</b> <input type="checkbox"/> CLAIMS-MADE <input checked="" type="checkbox"/> OCCUR  GEN'L AGGREGATE LIMIT APPLIES PER: <input checked="" type="checkbox"/> POLICY <input type="checkbox"/> PRO-JECT <input type="checkbox"/> LOC <input type="checkbox"/> OTHER:	Y	Y	TBD	8/1/2025	8/1/2026	EACH OCCURRENCE \$ 1,000,000 DAMAGE TO RENTED PREMISES (Ea occurrence) \$ 1,000,000 MED EXP (Any one person) \$ 15,000 PERSONAL & ADV INJURY \$ 1,000,000 GENERAL AGGREGATE \$ 2,000,000 PRODUCTS - COMP/OP AGG \$ 2,000,000 \$
A	<input checked="" type="checkbox"/> <b>AUTOMOBILE LIABILITY</b> <input checked="" type="checkbox"/> ANY AUTO <input type="checkbox"/> OWNED AUTOS ONLY <input type="checkbox"/> SCHEDULED AUTOS <input checked="" type="checkbox"/> HIRED AUTOS ONLY <input checked="" type="checkbox"/> NON-OWNED AUTOS ONLY			TBD	8/1/2025	8/1/2026	COMBINED SINGLE LIMIT (Ea accident) \$ 1,000,000 BODILY INJURY (Per person) \$ BODILY INJURY (Per accident) \$ PROPERTY DAMAGE (Per accident) \$ \$
B	<input checked="" type="checkbox"/> <b>UMBRELLA LIAB</b> <input checked="" type="checkbox"/> OCCUR <input type="checkbox"/> EXCESS LIAB <input type="checkbox"/> CLAIMS-MADE <input type="checkbox"/> DED <input checked="" type="checkbox"/> RETENTION \$ 10,000			TBD	8/1/2025	8/1/2026	EACH OCCURRENCE \$ 5,000,000 AGGREGATE \$ 5,000,000 \$
A	<input checked="" type="checkbox"/> <b>WORKERS COMPENSATION AND EMPLOYERS' LIABILITY</b> ANY PROPRIETOR/PARTNER/EXECUTIVE OFFICER/MEMBER EXCLUDED? <input type="checkbox"/> Y/N <input checked="" type="checkbox"/> N/A If yes, describe under DESCRIPTION OF OPERATIONS below			TBD	8/1/2025	8/1/2026	<input checked="" type="checkbox"/> PER STATUTE <input type="checkbox"/> OTH-ER E.L. EACH ACCIDENT \$ 1,000,000 E.L. DISEASE - EA EMPLOYEE \$ 1,000,000 E.L. DISEASE - POLICY LIMIT \$ 1,000,000

DESCRIPTION OF OPERATIONS / LOCATIONS / VEHICLES (ACORD 101, Additional Remarks Schedule, may be attached if more space is required)

Lee County, a political subdivision and Charter County of the State of Florida, its agents, employees, and public officials are included as Additional Insured with regards to the General Liability as required by written contract subject to the policy terms and conditions. Coverage is Primary and Non-Contributory with regards to the General Liability as required by written contract subject to the policy terms and conditions. Waiver of Subrogation applies with regards to the General Liability as required by written contract subject to the policy terms and conditions.

Ins. approved 07.23.25

**CERTIFICATE HOLDER****CANCELLATION**

Lee County, a political subdivision  
and Charter County of the State of Florida  
P.O. Box 398  
Fort Myers, Florida 33902

SHOULD ANY OF THE ABOVE DESCRIBED POLICIES BE CANCELLED BEFORE THE EXPIRATION DATE THEREOF, NOTICE WILL BE DELIVERED IN ACCORDANCE WITH THE POLICY PROVISIONS.

AUTHORIZED REPRESENTATIVE

© 1988-2015 ACORD CORPORATION. All rights reserved.



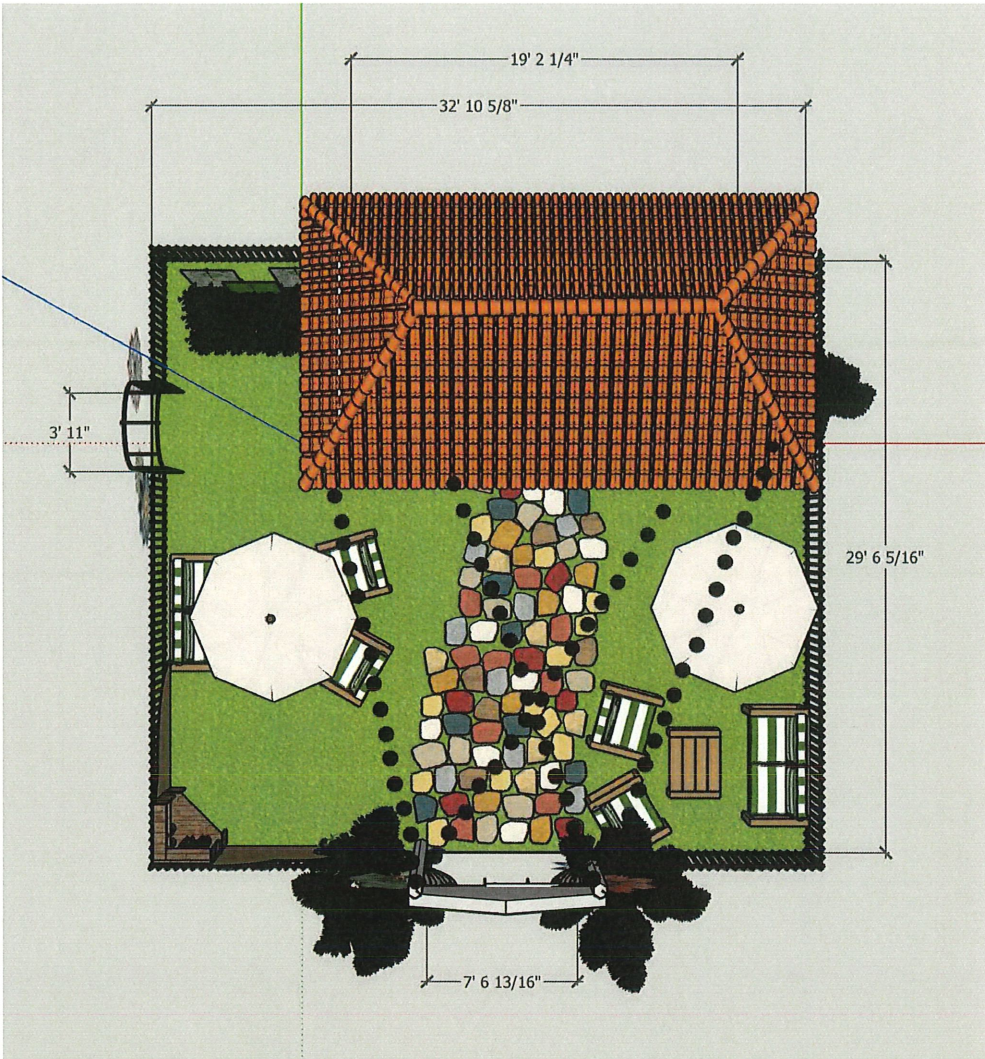





**JAKE LAWTON**

**EXECUTIVE PRODUCER**



[jake@rmng.co](mailto:jake@rmng.co) // 323-864-0350



---

Receive updates from Lee County Government by [subscribing to our newsletter](#)

Please note: Florida has a very broad public records law. Most written communications to or from County Employees and officials regarding County business are public records available to the public and media upon request. Your email communication may be subject to public disclosure.

Under Florida law, email addresses are public records. If you do not want your email address released in response to a public records request, do not send electronic mail to this entity. Instead, contact this office by phone or in writing.



Lee Health  
Gastroenterology



Wa-Ke Hatchee Park



Wa-Ke Hatchee Park

