



EVENT PERMIT

Ordinance 17-08



NO ONE LEFT BEHIND TOUR

PERMIT NUMBER: TMP2017-00345

Date(s) of Event: December 17, 2017 from 4:00pm until 10:30pm

Property Owner: FISCHER FL PROPERTIES I LLC

Applicant: MORGAN RENEE LIVE. INC

Contact: R.E. CARRILLO

Description: Country Music Concert

Location of event: 9510 THUNDER RD FORT MYERS 33913
TOP ROCKER FIELD/SIX BENDS HARLEY DAVIDSON/***561-506-4218

Will the event be attended by 1000 or more people ? Yes

Will the event be held on County Owned Property ? No

Will there be alcohol consumed or sold at the event ? Yes

Will a bond be posted for this event ? No

Permit Conditions:

- * Applicant must meet all event application requirements, including requirements of the sign-off agencies.
- * The premises is to be left in the same condition as it was prior to the event.
- * The permit is to be readily available for inspection during the entire event.
- * If this approval includes the sale or consumption of alcoholic beverages, no alcoholic beverages may be consumed 1 1/2 hours prior to the conclusion of the event and vacating the facility/property.

Board of County Commissioners
Lee County, Florida

 11-30-17

County Manager Date



Lee County
Southwest Florida

Event Application

Special Event

Use of
County
Property

Alcohol
within Lee
County
Facilities

Film, Video
&
Photography

Lee County Event Permit Application



Event Application

Check the appropriate box(es) below:

- ☒ SPECIAL EVENT PERMIT
☐ USE OF COUNTY PROPERTY PERMIT
☐ PERMIT TO SELL AND CONSUME ALCHOLIC BEVERAGES WITHIN LEE COUNTY FACILITIES
☐ FILM PERMIT

Section I - GENERAL INFORMATION (All Permit Types)	
Title of Event / Name of Production	"No One Left Behind Tour" - Multi-Platinum Nashville Recording Artist, Josh Turner Concert with Nashville Recording Artists: A Thousand Horses and Brooke Eden
Date(s) of Event / Production:	12/17/2017
Location(s) of Event:	Top Rocker Field, Six Bends Harley Davidson, 9510 Thunder Road, Ft. Myers, FL 33913
Name of Applicant:	Morgan Renee Live, Inc.
Applicant Address:	P.O. Box 2273, Jupiter, FL 33468
Applicant Phone Number:	561-506-4218 or 239-834-7660
Contact Person: (If different from applicant)	R.E. Carrillo, President/CEO Anne Stebbins, Executive Assistant
Contact Phone Number: (If different from applicant)	R.E. Carrillo 561-506-4218 - Anne Stebbins 239-834-7660
Email Address:	morganreneelive01@gmail.com
Estimated Attendance:	3,500 TL
Event Description: Include each activity, when activities take place, etc.	Country Music Concert. Stage load in 8 AM, Saturday, December 16, 2017, Sound and Production Load-In Sunday, 12/17/17 beginning at 8:00 AM. Sound Checks begin at 11 AM. Gates open at 4 PM Show begins at approx. 6 PM. Tear down and load out begin at 10:30 PM until complete. Stage, etc. removal will be Monday at approximately 9 AM. Detailed Itinerary attached.
Hours of Operation:	4:00 PM to 10:30 PM
STRAP # of Parcel:	224525L3240000030 / 20 / 10
Owner of Premises*:	Fischer Florida Properties I, LLC

*Notarized statement from the property owner specifically consenting to the proposed use required.

Lee County Event Permit Application



Fill out the following questions for all permit types:

What is the Zoning Classification of the premises? _____

Are any temporary structures to be installed for the event? ☒ Yes ☐ No Type: Tents & Porta-Potties

Do you have the appropriate permits for the temporary structures? ☒ Yes ☐ No

* For a 'Special Event' and 'Use of County Property' permit, submit a site plan with all proposed facilities and activities identified, including all parking areas.

Insurance Company Insuring the Event: Event Insurance Now a division of JD Fulwiler & Co. Insurance, Inc.

Note: Certificate of Insurance must be submitted at time of application

Surety Company Bonding this Event (Name and Address): _____

Will Vehicles be Used as Part of This Event?

☐ Yes ☒ No

If yes, automobile coverage must be included on the certificate of insurance.

Will Food be Available at this Event?

☒ Yes ☐ No

If yes, products liability coverage must be included on the certificate of insurance.

Will Alcoholic Beverages be served/consumed at this Event?

☒ Yes ☐ No

If yes, liquor liability coverage must be included on the certificate of insurance.

Name & Address of Organization
Providing Food:

What's Cooking Inc. dba Gourmet Truck Expo, 200 SW 32nd. Ave. Deerfield Bch, FL 33442

Type of Food being Served: Various

Section II - USE OF COUNTY PROPERTY PERMIT

Organization Sponsoring the Event: N/A

Fill out this portion for applications for Solicitation in the County Rights-of-Way:

Name of Charity: _____

Address of Charity: _____

Phone Number: _____

Non-profit certificate/registration number: _____

(Proof of registration with the Dept. of Agriculture & Consumer Services \$496.405 or proof the organization is exempt from this requirement. §316.2045)

Section III - SALE/CONSUMPTION OF ALCHOLIC BEVERAGES PERMIT

Is alcohol being sold/consumed on County Property?

☒ Yes ☐ No

If Yes, then a "Lee County Alcohol Permit" is required. Only non-profit organizations can sell alcohol on County Property.

Non-profit certificate/registration number: 59-6134931 Rotary Club of Ft. Myers, Inc.

(Required if alcohol is to be SOLD at the event)

Please note: A permit from the State of Florida Division of Alcoholic Beverages and Tobacco may also be required; please call (239) 344-0885 for further details

Lee County Event Permit Application



Section IV - FILM / VIDEO / PHOTOGRAPHY PERMIT

Type of Production (choose all that apply):

- ☐ TV Movie or Special ☐ TV Series / Pilot ☐ TV Commercial ☐ Still Photos
☐ Public Service Announcement ☐ Industrial / Documentary ☐ Other: _____

Will any of the following be needed or included*?

- | | | |
|--------------------------------|------------------------------|-----------------------------|
| Street Closure | <input type="checkbox"/> Yes | <input type="checkbox"/> No |
| Traffic / Crowd Control | <input type="checkbox"/> Yes | <input type="checkbox"/> No |
| Fire or Burning | <input type="checkbox"/> Yes | <input type="checkbox"/> No |
| Explosives or Pyrotechnics | <input type="checkbox"/> Yes | <input type="checkbox"/> No |
| Animals, Large or Small | <input type="checkbox"/> Yes | <input type="checkbox"/> No |
| Construction of Any Kind | <input type="checkbox"/> Yes | <input type="checkbox"/> No |
| Large and/or Numerous Vehicles | <input type="checkbox"/> Yes | <input type="checkbox"/> No |
| Helicopters, Boats, etc. | <input type="checkbox"/> Yes | <input type="checkbox"/> No |
| Stunts | <input type="checkbox"/> Yes | <input type="checkbox"/> No |
| Other | <input type="checkbox"/> Yes | <input type="checkbox"/> No |

* For any marked Yes, provide further details below:

Special Parking Requirements:

City or County Services Required: (Personnel, equipment, facilities, etc.)

The following information is required for local and state records on production in Florida to track the economic impact of the industry. If exact figures are not available, please estimate as closely as possible.

Number in Cast: _____ Number in Crew: _____ Number of locals hired: _____

Total budget: _____ Estimate amount spent in Lee County: _____

Hotel room nights: _____ Number of shooting days: _____
number of rooms x number of nights

Applicant Agreement - Signature Required



SECTION I - SAFETY

The Applicant agrees to provide adequate traffic and crowd control, emergency medical services and any other items, at the Applicant's expense, required by Lee County to protect the health, safety and welfare of the public. Lee County shall have the power to review the proposal and require, as necessary, detailed plans, diagrams, and explanations to clearly outline to Lee County, exactly what the Applicant is proposing.

SECTION II - INSURANCE

The Applicant, at its sole expense, agrees to procure and maintain in force during the entire term of the application, liability insurance in the amounts determined by Lee County Risk Management to protect against damages or other claims arising from use of County property by the applicant or its guests. Other limits may also be established by Lee County Risk Management for events which will be serving or consuming alcoholic beverages at approved County property. The insurance policy must also include coverage for Applicant's contingent liability on damages, claims or losses. "Lee County Board of County Commissioners" must be named as "additional insured" on the Certificate of Insurance, and the Certificate must be delivered to Lee County prior to Applicant's use of the property. The Insurance may not be canceled during the term of the event, if this occurs, the County has the right to revoke approvals related to use of the County property for the event, without recourse by the applicant.

SECTION III - INDEMNIFICATION

The Applicant agrees to indemnify, release and save harmless Lee County against any and all claims, costs, demands, damages, judgments or injuries of any nature arising from the conduct or management of, or from any work or thing whatsoever done in or about said Lee County property or any building or structure appurtenant thereto or equipment thereof during the term of this Permit, or arising during such term from any act of negligence of the Applicant, Applicant's agents, contractors, or employees, or arising from any accident, injury, or damage whatsoever, however caused, to any person or persons, or to any property of any person, persons, corporation or corporations, occurring during the term of this agreement on, in, or about said Lee County property, and from and against all costs, attorney's fees, expenses and liabilities occurring in connection with any such claim or any action or proceeding brought thereon.

For film permit applicants: The permittee shall have on-site a responsible representative empowered with authority over the filming director, filming crews, participants and filming operation. Permittee shall indemnify, defend and hold harmless the county, its officers, agents and employees from and against all claims, suits, actions, damages, liabilities, expenditures or causes of action of any kind arising out of or occurring during the activities of the permittee, and resulting or occurring from any negligent act, omission or error of permittee, resulting in or relating to injuries to body, life, limb or property sustained in, about or upon the permitted premises or improvement thereto, or arising from the use of the premises.

SECTION IV - DELIVERY, ACCEPTANCE AND SURRENDER OF PREMISES

The Applicant agrees to accept the County property on possession as being in a satisfactory state of repair and in sanitary condition.

The Applicant must surrender the premises to Lee County in the same condition as when Applicant takes possession, allowing for reasonable use and wear, and damage by acts of God. Applicant agrees to remove all business signs or symbols placed on the premises by the Applicant before redelivery of the premises to Lee County, and restore the premises to the condition in which it existed before their placement. Any signs and markings created or used in connection with this event must be temporary and removable; painting roadways, trees or any other fixed object is strictly prohibited. Applicant agrees to clear the Lee County property of litter at the close of the event.

Applicant Agreement - Signature Required



SECTION V - AGREEMENT

The Applicant agrees that Lee County can, at its sole discretion, terminate and cancel its permit to use Lee County property at any time without prejudice. Applicant further agrees to waive, release, save and hold harmless Lee County from any and all claims, demands or cause of actions based upon Lee County's cancellation or termination of said permit.

The Applicant agrees that the Lee County permit does not provide Applicant with any property rights in the County property in question or in the permit itself.

The applicant does acknowledge and hereby affirms that any and all information is accurate to the best of his/her knowledge.

R. E. Carrillo

Signature of Applicant

R.E. Carrillo, President/CEO

Print Name of Applicant and Title

11/15/17

Date

Anne Stebbins

Witness

Anne Stebbins

Print Name of Witness

11/15/17

Date

Lee County Event Permit Application



LEE COUNTY SHERIFF'S DEPARTMENT
14750 SIX MILE CYPRESS PARKWAY
FORT MYERS, FLORIDA 33912
(239) 477-1199

Check the appropriate box(es) below:

- ☒ SPECIAL EVENT PERMIT
☐ USE OF COUNTY PROPERTY PERMIT
☐ PERMIT TO SELL AND CONSUME ALCOHOLIC BEVERAGES WITHIN LEE COUNTY FACILITIES
☐ FILM PERMIT

AFTER REVIEWING THE APPLICATION, PLEASE INDICATE BELOW WHAT ARRANGEMENTS YOUR ORGANIZATION WILL REQUIRE THE APPLICANT TO COMPLY WITH FOR THEIR EVENT.

Parking:

PER THE ORGANIZER: Parking in on-site lot and overflow lot which will be manned by the Rotary Club of Ft. Myers. Transportation from overflow lot to be provided by Dolphin Transportation. Parking lot volunteers are not permitted to be in the roadway directing guests into parking areas without all proper safety equipment including but not limited to reflective safety vests, flashlight cones, proper lighting. Signage directing guests to the parking would be more appropriate.

Deputies (How Many?):

There will be One (1) Traffic Supervisor & six (6) traffic deputies for traffic presence & control throughout the area to ensure that traffic moves in & out safely with minimal back-ups. There will be One (1) Security Supervisor & eight (8) security deputies for security & presence inside the venue. Deputies will not perform bag searches or wand guests; vendor will have to contract with unarmed private security for those functions.

Fee for Services:

All costs for the deputies for the traffic control and security will be at the vendor's cost. Vendor may contact the LCSO Details Unit for further information. All arrangements must be paid for in advance. Any overages will be at the vendor's expense.

Special Arrangements:

Vendor must hire a company for the MOT, cones and/or barricades to be used to block off Jetport Commerce Pkwy & Daniels Pkwy as part of the LCSO traffic plan. Vendor will also want the company to put out a message board directing concert guests to off site parking. The message board will need to be placed in the area between Jetport Commerce Pkwy & Treeline Ave. A copy of the MOT plan from the hired company will need to be sent to LCSO Details Unit for review. All amplified music must be in compliance with Lee County, Florida Noise Ordinance Chapter 24 1/4 to include but not be limited to the monitoring of all noise levels throughout the event, especially at night. Event coordinator will need to pay special attention to the time and the noise levels at that time as not to exceed what is allowed by law. Any complaints regarding noise will be evaluated and handled accordingly by the detail deputies and may result in the event being shut down if the sound levels are violated.

Print Name: Captain J. Loethen

Signature:

Capt J Loethen 72149

Title:

Special Operations Commander

Date:

11-28-17

Lee County Event Permit Application



FIRE DEPARTMENT

*The Fire Department serving the area where the event is to be held signs this form.
Please see User's Guide for contact information and Fire District Map.*

Check the appropriate box(es) below:

Permit Number: Josh Turner 12-17-2017

- ☒ SPECIAL EVENT PERMIT
☐ USE OF COUNTY PROPERTY PERMIT
☐ FILM PERMIT

AFTER REVIEWING THE APPLICATION, PLEASE INDICATE BELOW WHAT ARRANGEMENTS YOUR ORGANIZATION WILL REQUIRE THE APPLICANT TO COMPLY WITH FOR THEIR EVENT.

Fire Guards (How Many?)

12 Certified Crowd Managers

Fee for Services:

\$55.00 inspection fee for each tents over 900 sq ft.

Flammable Vegetation:

Cleared from around tents.

First Aid Equipment:

Provided by South Trail Fire Rescue.

Fire Extinguishing:

Minimum 2A10BC extinguishers at all tent(s), cooking tents and trailers must be NFPA 96 complaint, all propane tanks must be kept 10 feet away from tents and secured as to not tip over.

Special Arrangements:

ALS non-transport medical coverage provided by South Trail Fire Rescue.

Print Name: Gene Rogers

Signature: Gene Rogers

Digitally signed by Gene Rogers
DN: cn=Gene Rogers, o=ou, email=rogers@southtrailfire.org, c=US
Date: 2017.11.22 11:27:43 -05'00'

Title: Division Chief

Date: 11-22-2017

Lee County Event Permit Application



EMERGENCY MEDICAL SERVICES / PUBLIC SAFETY
14752 SIX MILE CYPRESS PARKWAY
FORT MYERS, FL 33912
(239) 533-3911

Check the appropriate box(es) below:

- ☒ SPECIAL EVENT PERMIT
☐ USE OF COUNTY PROPERTY PERMIT
☐ FILM PERMIT

AFTER REVIEWING THE APPLICATION, PLEASE INDICATE BELOW WHAT ARRANGEMENTS YOUR ORGANIZATION WILL REQUIRE THE APPLICANT TO COMPLY WITH FOR THEIR EVENT.

Treatment Facilities: None necessary.

Medical Personnel: See below.

Medical Supplies /
Equipment: None necessary.

Safety Requirements: No additional precautions necessary.

Fee for Services: Not applicable.

Special Arrangements: Due to the size of the event, we recommend a fire or EMS crew on site to provide medical coverage for the event.

To arrange special event coverage from EMS, contact our office at 239 533-3911.

Print Name: Benjamin Abes

Signature: Benjamin Abes

Digitally signed by Benjamin Abes
Date: 2017.11.17 14:37:42 -05'00'

Title: Chief

Date: 11/17/2017

Lee County Event Permit Application



DEPARTMENT OF TRANSPORTATION
1500 MONROE STREET
FORT MYERS, FL 33901
(239) 533-8580

Check the appropriate box(es) below:

- ☒ SPECIAL EVENT PERMIT
☐ USE OF COUNTY PROPERTY PERMIT
☐ PERMIT TO SELL AND CONSUME ALCOHOLIC BEVERAGES WITHIN LEE COUNTY FACILITIES
☐ FILM PERMIT

AFTER REVIEWING THE APPLICATION, PLEASE INDICATE BELOW WHAT ARRANGEMENTS YOUR ORGANIZATION WILL REQUIRE THE APPLICANT TO COMPLY WITH FOR THEIR EVENT.

Parking:

No event parking permitted on Lee County maintained road rights-of-way.

Ingress and Egress:

Use all established means of ingress and egress.

Special Arrangements:

Use Lee County Sheriff's Office for assistance with traffic control as needed.

Print Name: Bryan Miller

Signature: Bryan D. Miller

Digitally signed by Bryan D. Miller
Date: 2017.11.21 08:28:56 -05'00'

Title: Senior Project Manager

Date: November 21, 2017

Lee County Event Permit Application



LEE COUNTY PARKS AND RECREATION
3410 PALM BEACH BOULEVARD
FORT MYERS, FLORIDA 33916
(239) 533-7275

Check the appropriate box(es) below:

- ☒ SPECIAL EVENT PERMIT
☐ USE OF COUNTY PROPERTY PERMIT
☐ PERMIT TO SELL AND CONSUME ALCOHOLIC BEVERAGES WITHIN LEE COUNTY FACILITIES
☐ FILM PERMIT

AFTER REVIEWING THE APPLICATION, PLEASE INDICATE BELOW WHAT ARRANGEMENTS YOUR ORGANIZATION WILL REQUIRE THE APPLICANT TO COMPLY WITH FOR THEIR EVENT.

Illumination:

N/A

Parking Areas:

N/A

Special Arrangements:

Event will not affect Parks & Recreation programs or operations.

Print Name:

Alise Flanjack

Signature:

Alise Flanjack

Title:

Deputy Director

Date:

Nov. 20, 2017

6 Buels

Dec 17, 2017

NB one left behind tour

Lee County Event Permit Application



LEE COUNTY RISK MANAGEMENT
COUNTY ADMINISTRATION BUILDING - 4TH FLOOR
2115 SECOND STREET
FORT MYERS, FLORIDA 33901
(239) 533-2221

Check the appropriate box(es) below:

- ☒ SPECIAL EVENT PERMIT
☐ USE OF COUNTY PROPERTY PERMIT
☐ PERMIT TO SELL AND CONSUME ALCOHOLIC BEVERAGES WITHIN LEE COUNTY FACILITIES
☐ FILM PERMIT

AFTER REVIEWING THE APPLICATION, PLEASE INDICATE BELOW WHAT ARRANGEMENTS YOUR ORGANIZATION WILL REQUIRE THE APPLICANT TO COMPLY WITH FOR THEIR EVENT.

Insurance Requirements: Commercial general liability insurance with minimum limits of One Million Dollars (\$1,000,000) per occurrence to protect against bodily injury and/or property damage relative to applicants use of aforementioned event within Lee County.

Special Arrangements: A Certificate of Insurance shall be submitted as evidence of the required coverage listing Lee County Board of County Commissioners, P.O. Box 398, Fort Myers, FL 33902 as the certificate holder and as an additional insured.

Subject to proof of insurance.

Print Name: Mike Figueroa

Signature:

Title:

Risk Program Manager

Date:

November 17, 2017



CERTIFICATE OF LIABILITY INSURANCE

DATE (MM/DD/YYYY)
10/27/2017

THIS CERTIFICATE IS ISSUED AS A MATTER OF INFORMATION ONLY AND CONFERS NO RIGHTS UPON THE CERTIFICATE HOLDER. THIS CERTIFICATE DOES NOT AFFIRMATIVELY OR NEGATIVELY AMEND, EXTEND OR ALTER THE COVERAGE AFFORDED BY THE POLICIES BELOW. THIS CERTIFICATE OF INSURANCE DOES NOT CONSTITUTE A CONTRACT BETWEEN THE ISSUING INSURER(S), AUTHORIZED REPRESENTATIVE OR PRODUCER, AND THE CERTIFICATE HOLDER.

IMPORTANT: If the certificate holder is an ADDITIONAL INSURED, the policy(ies) must be endorsed. If SUBROGATION IS WAIVED, subject to the terms and conditions of the policy, certain policies may require an endorsement. A statement on this certificate does not confer rights to the certificate holder in lieu of such endorsement(s).

PRODUCER EventInsuranceNow a division of JD Fulwiler & Co. Insurance, Inc. 5727 SW Macadam Ave Portland OR 97239	CONTACT Brigitt Whitescarver PHONE (A/C, No, Ext): 503-977-5648 FAX (A/C, No): 503-977-5845 E-MAIL ADDRESS: events@eventinsurancenow.com
INSURED Morgan Renee Live Inc PO Box 2273 Jupiter, FL 33468	INSURER(S) AFFORDING COVERAGE INSURER A: Starr Indemnity & Liability Company INSURER B: INSURER C: INSURER D: INSURER E: INSURER F:

COVERAGES

CERTIFICATE NUMBER:

REVISION NUMBER:

THIS IS TO CERTIFY THAT THE POLICIES OF INSURANCE LISTED BELOW HAVE BEEN ISSUED TO THE INSURED NAMED ABOVE FOR THE POLICY PERIOD INDICATED. NOTWITHSTANDING ANY REQUIREMENT, TERM OR CONDITION OF ANY CONTRACT OR OTHER DOCUMENT WITH RESPECT TO WHICH THIS CERTIFICATE MAY BE ISSUED OR MAY PERTAIN, THE INSURANCE AFFORDED BY THE POLICIES DESCRIBED HEREIN IS SUBJECT TO ALL THE TERMS, EXCLUSIONS AND CONDITIONS OF SUCH POLICIES. LIMITS SHOWN MAY HAVE BEEN REDUCED BY PAID CLAIMS.

INSR LTR	TYPE OF INSURANCE	ADDL SUBR INSD WVD	POLICY NUMBER	POLICY EFF (MM/DD/YYYY)	POLICY EXP (MM/DD/YYYY)	LIMITS
A	<input checked="" type="checkbox"/> COMMERCIAL GENERAL LIABILITY <input type="checkbox"/> CLAIMS-MADE <input checked="" type="checkbox"/> OCCUR GEN'L AGGREGATE LIMIT APPLIES PER: <input checked="" type="checkbox"/> POLICY <input type="checkbox"/> PRO-JECT <input type="checkbox"/> LOC OTHER:	X	1000109800	12/16/2017 12:01 AM	12/18/2017 12:01 AM	EACH OCCURRENCE \$ 1,000,000
	FIRE DAMAGE TO RENTED PREMISES (Ea occurrence) \$ 300,000					
	MED EXP (Any one person) \$ 5,000					
	PERSONAL & ADV INJURY \$ 1,000,000					
						GENERAL AGGREGATE \$ 2,000,000
						PRODUCTS - COMP/OP AGG \$ 2,000,000
						Employee Benefits \$
	AUTOMOBILE LIABILITY <input type="checkbox"/> ANY AUTO <input type="checkbox"/> ALL OWNED AUTOS <input type="checkbox"/> HIRED AUTOS <input type="checkbox"/> SCHEDULED AUTOS <input type="checkbox"/> NON-OWNED AUTOS					COMBINED SINGLE LIMIT (Ea accident) \$
						BODILY INJURY (Per person) \$
						BODILY INJURY (Per accident) \$
						PROPERTY DAMAGE (Per accident) \$
						\$
	UMBRELLA LIAB <input type="checkbox"/> OCCUR EXCESS LIAB <input type="checkbox"/> CLAIMS-MADE					EACH OCCURRENCE \$
						AGGREGATE \$
						\$
	DED <input type="checkbox"/> RETENTION \$ none					PER STATUTE <input type="checkbox"/> OTH-ER <input type="checkbox"/>
	WORKERS COMPENSATION AND EMPLOYERS' LIABILITY ANY PROPRIETOR/PARTNER/EXECUTIVE OFFICER/MEMBER EXCLUDED? (Mandatory in NH) If yes, describe under DESCRIPTION OF OPERATIONS below	Y/N <input type="checkbox"/>	N/A			E.L. EACH ACCIDENT \$
						E.L. DISEASE - EA EMPLOYEE \$
						E.L. DISEASE - POLICY LIMIT \$

DESCRIPTION OF OPERATIONS / LOCATIONS / VEHICLES (ACORD 101, Additional Remarks Schedule, may be attached if more space is required)

The certificate holder below are named as additional insureds with respect to the liability arising out of the operations of the named insured during the policy period.

OK MF 11/17/17

CERTIFICATE HOLDER Lee County Board of Commissioners 1500 Monroe St Ft. Myers, FL 33901	CANCELLATION SHOULD ANY OF THE ABOVE DESCRIBED POLICIES BE CANCELLED BEFORE THE EXPIRATION DATE THEREOF, NOTICE WILL BE DELIVERED IN ACCORDANCE WITH THE POLICY PROVISIONS. AUTHORIZED REPRESENTATIVE Brigitt Whitescarver <i>Brigitt J. Whitescarver</i>
---	---

© 1988-2014 ACORD CORPORATION. All rights reserved.

Lee County Event Permit Application



LEE COUNTY VISITOR & CONVENTION BUREAU
2201 SECOND STREET, SUITE 600
FORT MYERS, FLORIDA 33901
(239) 338-3500

Check the appropriate box(es) below:

☐ FILM PERMIT ONLY

AFTER REVIEWING THE APPLICATION, PLEASE INDICATE BELOW WHAT ARRANGEMENTS YOUR ORGANIZATION WILL REQUIRE THE APPLICANT TO COMPLY WITH FOR THEIR EVENT.

Special Arrangements:

--

Other:

--

Print Name: _____

Signature: _____

Title: _____

Date: _____

FISCHER FLORIDA PROPERTIES, LLC

9510 THUNDER ROAD

FORT MYERS, FL 33913

844-749-2363

November 16, 2017

Re: Lee County Event Application

I am the property owner for Six Bends and Top Rocker Field located at 9510 Thunder Road, Fort Myers, FL 33913. Morgan Renee Live will be holding the Josh Turner Concert on Sunday, December 17, 2017.

This event will be held on Top Rocker Field at Six Bends. Restroom facilities and security will be provided by the event organizer. The expected attendance is 3,500.

I have given my permission for this event.

Sincerely,

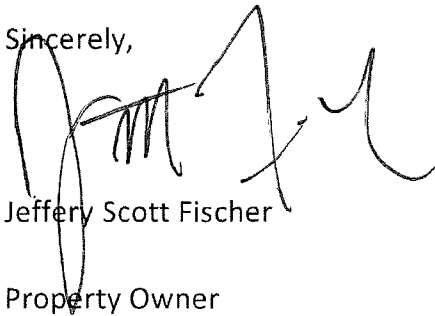
A handwritten signature in black ink, appearing to read 'Jeffery Scott Fischer', written over a horizontal line.

Jeffery Scott Fischer

Property Owner

Sworn and subscribed before me this _____, by Jeffery Scott Fischer, who is personally known to me.

Lucia Sherman

Notary Public

State of Florida

Top Rocker Field

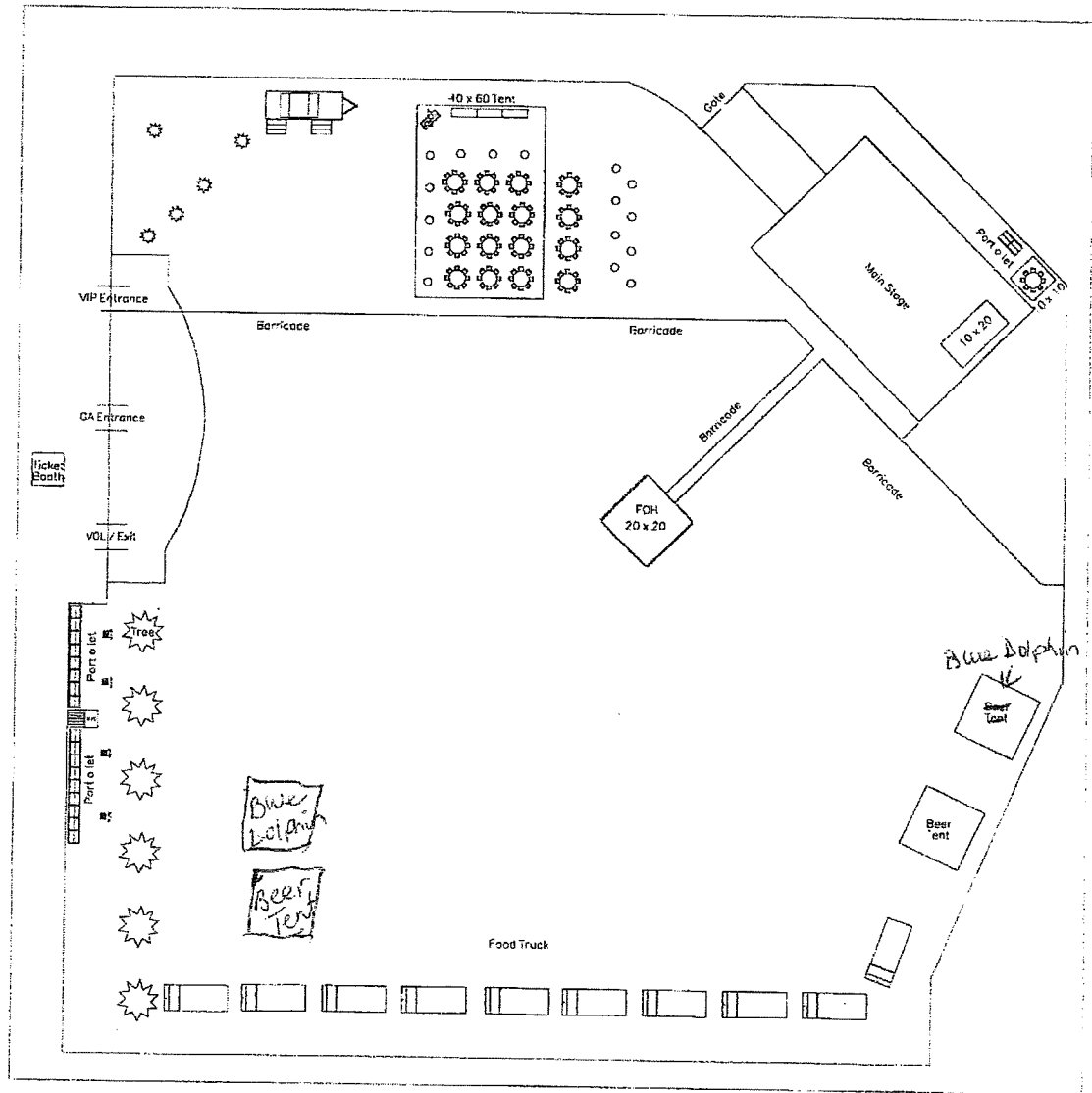

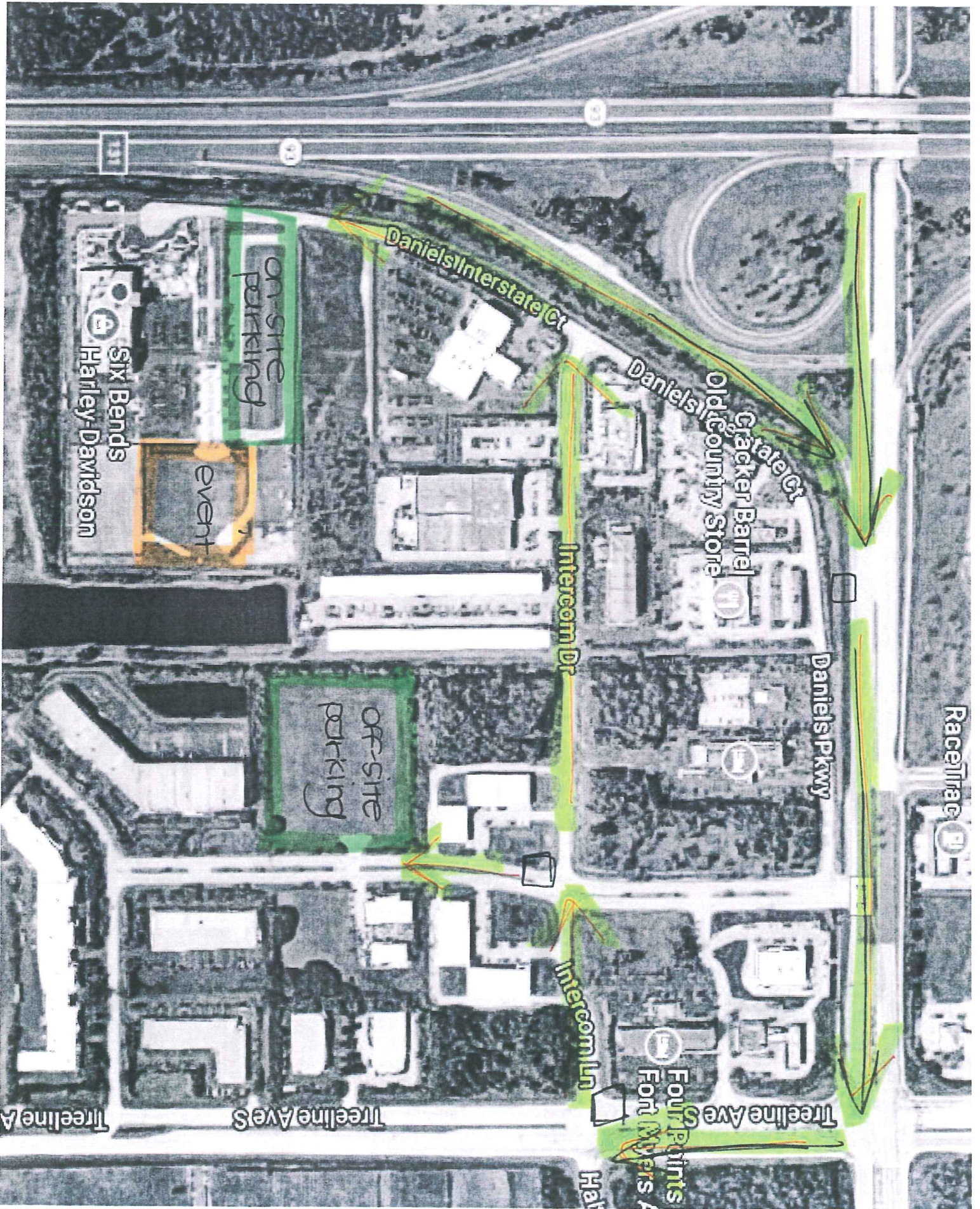



MORGAN RENEE LIVE, INC.

P.O. BOX 2273 JUPITER, FL 33468

CELL: 561-506-4218

WWW.MORGANRENEELIVE.COM

WWW.FACEBOOK.COM/MORGANRENEELIVE

DATE: DECEMBER 17, 2017 (SUNDAY)
 TO: JIM MAYO - TOUR MANAGER
 PHONE: 615-289-4079 (CELL) EMAIL: mavomgmt@gmail.com
 EVENT: JOSH TURNER CONCERT
 LOCATION: TOP ROCKER FIELD, FORT MYERS, FL
 FROM: ANNE STEBBINS / MORGAN RENEE LIVE, INC.
 PHONE: 239-834-7660 EMAIL: morganreeneelive03@gmail.com

ITINERARY JOSH TURNER

SUNDAY, DECEMBER 17th 2017 DRAFT!

7:00 AM SATURDAY	LOAD-IN STAGE (SANDERFORD SOUND)
6:00 AM SUNDAY	PRODUCTION LOAD IN – SANDERFORD SOUND
7:00 AM	BREAKFAST – ALL PERSONNEL
8:00 AM	JOSH TURNER – LOAD IN
12:00 NOON	LUNCH ALL PERSONNEL
12:30 PM	BROOKE EDEN – LOAD IN
1:00 PM - 2:00 PM	JOSH TURNER – SOUND CHECK
2:00 PM – 3:00 PM	A THOUSAND HORSES – LOAD IN / SOUND CHECK
3:00 PM – 4:00 PM	BROOKE EDEN – LOAD IN / SOUND CHECK
4:00 PM	GATES OPEN / HOUSE MUSIC / EMCEE / ANNOUNCEMENTS
5:00 PM	DINNER – ALL PERSONNEL
5:30 PM -6:25 PM	OPENING ACT - BROOKE EDEN – 55 MINUTE PERFORMANCE
6:00 PM – 7:00 PM	MEET & GREET – A THOUSAND HORSES
6:30 PM – 7:00 PM	CHANGE OVER
7:00 PM – 8:00 PM	A THOUSAND HORSES – 60 MINUTE PERFORMANCE
7:30 PM – 8:00 PM	MEET & GREET – JOSH TURNER - 30 PEOPLE 30 MIN.
8:00 PM – 8:30 PM	CHANGE OVER
8:30 PM – 10:00 PM	JOSH TURNER – 75 MINUTE PERFORMANCE
10:30 PM	LOAD OUT – SANDERFORD SOUND

NEED TO GET MEET & GREET IN FOR BROOKE OR WILL THAT BE AT THE SAME TIME AS ONE OF THE OTHERS??

Contacts:

Randy Carrillo / President & C.E.O. Morgan Renee Live, Inc. Florida – Tel: 561-506-4218 / morganreneelive01@gmail.com
Soffia Jonsdottir / VP & Admin Morgan Renee Live, Inc. Los Angeles – Tel: 917-972-9446 / morganreneelive02@gmail.com
Anne Stebbins / Event Coord/Exec Assist., Morgan Renee Live, Inc./FL – Tel: 239-834-7660/morganreneelive03@gmail.com
Michael Begleiter/Assoc. Producer, Booking. Morgan Renee Live/ FL Tel. 914-552-7865 / morganreneelive07@gmail.com
Eric Stebbins / Event Coordinator / Tel. 239-896-6222 / estebbins77@gmail.com
Tom Landy / Box Office Manager / Tel. 561-512-1329 / tomlandy07@comcast.net
Frank Eagar / Website Designer / Tel. 561-972-1143 / fcagar@comcast.net
John Hertling / MC / Tel.561-351-6005 / johnhertling@gmail.com
Janet McDavid / Merchandise /
Breezy /
Bubba Sanderford / Owner / Sanderford Sound / Tel: 561-723-9046 / bubsand@sanderfordsound.com
Ronnie Palmer / Tour Manager – A Thousand Horses / 615-970-9895 lcronnvp@gmail.com
Ryan Cain / Tour Manager – Brooke Eden / 859-327-1711 ryancairnmc@gmail.com
Mark Humenik / Sales Director / Gator Country Radio / 239-444-4212
Kendra Sutton / WINK-TV / 239-
Mike Tyler / Program Director / CAT Country 107.1 – iHeart Media / 386-804-0323 / miketyler@iheartmedia.com
Taylor Lothen / Facility Manager / Top Rocker Events / Tel: 239-284-0301 / taylorl@sfe-us.com
Cia Sherman / Project Manager / Top Rocker Events / Tel. 239-247-7140 / lucias@sfe-us.com
John Green / Manager/ Six Bends Top Rocker Field / Tel: 970-331-3600 / johnng@sfe-us.com

HOTEL: Holiday Inn Ft. Myers Airport @ Town Center / Joe Nugent / 9931 Interstate Commerce Drive, Ft. Myers, FL 33913 / Main Hotel Tel. (239) 561-1550 Joe Nugent / 239-322-1361 jnugent@hiftdmyersairport.com

VENUE ADDRESS: Top Rocker Field – Six Bends Harley Davidson
Address: 9501 Thunder Road, Fort Myers, FL 33912 / Tel. 239-275-4647

JOSH TURNER - FRONT OF HOUSE AUDIO SYSTEM

A. Front of house sound system shall be an active four-way stereo system, capable of producing

an unequalized frequency response of +/- 3db 50Hz - 18KHz, at an undistorted signal of 110 dB SPL at the front of house console in any venue. For outdoor events, delay stacks should be made available.

B. The FOH (Line Array Only) enclosures will be MEYER, EAW, MARTIN, V-DOSC, d&b audiotechnik, NEXO or JBL VERTEC. Any proprietary enclosures must be approved by Producer/Artist's Production Manager.

C. The FOH speaker enclosures must be properly positioned and capable of producing a flat response for all sold seating areas. This includes front filled position (in front of stage) driven by a matrix or auxiliary send. Sub speaker enclosures to be set-up in a cardioid pattern.

D. The FOH speaker enclosures are to be powered adequately and accordingly to speaker and driver requirements.

E. Power Amps are to be CROWN, LAB GRUPPEN, QSC or Crest.

Ex: Crown IT-8000 to power subs.

Crown IT-6000 to power Mids.

Crown IT-6000 to power mid-high and highs.

G. Cross Overs/Systems Processors accepted are LAKE CONTOUR, XTA, KT, or BSS. (Located at FOH)

4. FRONT OF HOUSE CONSOLE & PROCESSING (Fly Dates Only)

SOUNDCRAFT Vi3000 or other acceptable FOH console with a minimum of Forty-Eight (48) channels, per advance. Console will be configured according to Artist-supplied show file.
Other

consoles may be acceptable only upon prior approval of Artist's Production Manager. Please note

that analog mixing consoles will require extensive outboard processing in addition to what is listed

here and are not advised.

5. MONITOR CONSOLE & PROCESSING (Fly Dates Only)

A. DiGiCo SD8, SD10 or other acceptable monitor console with a minimum of forty-eight (48) input

channels and (32) output channels, per advance. We will bring artist show file.

B. Monitor processing equipment is to consist of:

1. Eight (8) Shure PSM 900 IEM units with appropriate helical antenna and antenna combiner.
2. Three (3) Shure PSM 600 hard wire units.
3. All necessary cabling for IEM systems and spare belt packs.
4. One (1) Subwoofer or Throne Thumper with appropriate power and cabling for the drummer.

6. MICROPHONE & MIC-STAND PACKAGE (Fly Dates Only)

A. Six (6) Radial J-48 direct boxes

B. Four (4) Shure SM-58

C. Two (2) Shure KSM-32

D. Three (3) Shure Beta 98

E. Two (2) Shure SM 57

F. One (1) Shure SM 7

G. One (1) Shure Beta 52

H. One (1) Shure SM 91

I. Three (3) Shure KSM-137

J. Two (2) Shure VP88 stereo mic

K. Six (6) tall tripod mic stands with two-piece boom arms (K&M, AKG or equivalent). Eight (8) short tripod stands with two-piece boom arm. (2) Tall round-base (Atlas MS 20 or MS 25) mic stands with two-piece boom arm.

L. Two (2) Z Bars

JOSH TURNER 2017 Page 14 of 15 Updated Nov 21, 2016

ANY AND ALL SUPPORT ACTS ARE REQUIRED TO USE SEPARATE CONSOLES AND PROCESSING EQUIPMENT OTHER THAN WHAT IS PROVIDED FOR JOSH TURNER.

7. LIGHTING REQUIREMENTS

A. 120K Par 64's on pre-rig front and rear truss. Colored/gelled, and lamped as per plot.

(narrow spot upstage and medium flood, very narrow, and narrow spot downstage)

B. One flown mid stage 12" truss or baton, (40') feet long for tours moving lights.

C. Twelve (12) intelligent fixtures VL-3500 or Mac Viper Profile. (Fly Dates Only)

D. Two (2) Mole Fay fixtures. Two (2) hanging from downstage truss for audience light.

E. Three (3) ACL bars. Three (3) hanging from upstage truss.

F. Four (4) Xenon or HMI Lamp spotlights powerful enough to cover two hundred (200') to three

hundred (300') feet. Quartz or Incandescent Lamp spotlights are not acceptable.

G. Lighting consoles accepted are to be High End Systems Hog 3 or Hog 4 consoles that include

Road Hog 3, Road Hog 3 Full Boar, Full Size Hog 3. Road Hog 4, Road Hog 4 Full Boar, Full Size Hog 4. (Fly Dates Only)

H. Dimmers are to consist of ninety-six (96) channels of dimming capability. Dimmers accepted

are: C.A.E., ETC Sensor, or NSI. (All dimmers are to be DMX protocol)

I. Black back drop to hang from upstage truss.

J. Clear-Comm communications with double muff head sets and 1 single muff head set for lighting

console, all spot operators, dimmer world, video world and venue house light position. This is to be separate from audio communications.

K. Haze Machine.Water based haze machines are preferred. A haze machine shall be provided.

Acceptable types must equally compare to a DF-50 or better. LeMaitre Radiance Hazer and Hazebase machines are preferred. No F-100 or other timed type smoke machines or powder methods are acceptable.

JOSH TURNER BACKLINE:

Drums (TAMA Maple Star Classic drums & hardware).

All drums must have new Aquarian Coated heads

1. One (1) 22" Kick Drum
2. One (1) 12" Rack Tom
3. One (1) 16" Floor Tom with legs
4. Two (2) Snare Drums 14" X 5.5"
5. One (1) TAMA Speed Cobra kick pedal (chain drive)
6. One (1) Snare stand
7. One (1) Hi-Hat stand
8. One (1) Tom bracket
9. Three (3) Cymbal stands with booms
10. One (1) Roc-n-Soc drum throne
11. Cymbals – Paiste Cymbals

One (1) set of fourteen (14") inch "Dark Energy" Hi-Hats, One twenty (21") inch "Dark Energy" Ride cymbal, One (1) eighteen (18") inch "602" Thin Crash cymbal, One twenty

(20") inch "602" Thin Crash cymbal

B. Bass

1. One (1) Ampeg SVT 3 Pro OR 4 Pro
2. One (1) Ampeg 4x10 cabinet

C. Electric Guitar

1. In order of preference: One (1) VOX AC-30 OR One (1) Fender Deluxe Reverb
2. Ten (10) guitar stands
3. Four (4) Fiddle/Mando Stands
4. Ten (10) ¼" guitar cables 30' long

D. Steel Guitar

1. In order of preference:

Two (2) Peavey Nashville 112 or Nashville 400 Amps, OR

Two (2) Fender Twin Reverb Blackface or Deluxe Reverb Blackface amps

2. One Pak-a-Seat steel guitar seat or drum throne

E. Slide Guitar

1. One (1) Fender Blues Jr. or Deluxe Reverb Blackface

F. Miscellaneous

1. 6-High Quality Instrument Wireless transmitters/receivers (Shure UR Series Preferred) Please provide make,

model and band in advance for frequency coordination purposes.

2. 1-Shure UR4D series handheld wireless microphone/receiver with a KSM9 capsule

3. 1-ALESIS ADAT-HD24 (HARD DISC RECORDER) with 8 TRS Male-to-XLR Male cables for connection to snake.

A THOUSAND HORSES FRONTLINE:

Digital FOH console with minimum of 48 input/18 output snake at stage (18 outputs are

for monitor usage)

- Preferred Consoles: Midas Pro 2/Pro 2c

- Acceptable Consoles: Avid SC48 or Profile

- o (8) Sennheiser G3 (or better) wireless in ear systems with bodypacks

- o (4) Sennheiser ew500 G3 935 capsule wireless microphones with receivers

- o (5) Sennheiser ew500 G3 wireless guitar packs with receivers

- Need to be individual units NOT in a rack that can be placed on stage by guitar amps

- o All necessary antennas, combiners, bnc cables for wireless

- o All backline per list provided when advancing with the tour

- o All microphone stands and XLR cables per stage plot and input list

- o Stage power per the stage plot

- o (3) sub snakes with (12) inputs each

- (2) Upstage Center

- 1 Upstage Left

- o 2 foot (rolling preferable) 8' x 8' stage riser for drummer if available and if stage size allows

for the space

- o (2) 1 foot (rolling preferable) 8' x 8' stage risers for keys and BGVs if stage space allows

for it

Acoustic Full Band

- **What We Bring**

- o Midas Pro 2c to run FOH and Monitors

- o In Ear wireless systems

- o All Microphones and DI Boxes

- o Digital Stage rack

- o 300' snake – loom of (2) cat 5 and (2) xlr

- o All backline

- o Mic stands, sub snakes, xlr, etc.

- **What We Need**

- o Stage power per the stage plot

- o 1 or 2 foot either 8' x 8' or 6' x 6' stage riser for drummer

A THOUSAND HORSES BACKLINE REQUIREMENTS:

FOH sound system shall be an active four-way stereo system capable of producing a flat frequency response from 30Hz to 18kHz at an undistorted signal of 115 dB SPL to all seats in the venue. System is to be set up as a Left, Right, Sub configuration for console connection.

- The PA must be a professional, state-of-the-art sound system. Acceptable speaker manufacturers

are: D&B, L'Acoustics, Meyer Sound Labs, JBL Vertec, Martin, and Nexo.

- ARTIST Production Manager must approve any other speaker system prior to day of show.
- The PA system must be powered adequately and according to speaker Manufacture and driver requirements. It also must be properly positioned, and capable of producing a flat response for all sold seating areas.
- The System Tech should be familiar with modern tools and tricks of the trade to properly deploy and tune said PA system. This means bringing the proper amount of PA for the room size and type of show, rigging and aiming it safely and precisely, using smaart or sim to properly align the components in the array. There is plenty of training available for these industry standard duties.

This training should be done prior to this performance. In other words, the Artist's touring crew would like your A team, if your A team does not know how to properly deploy and tune a modern

PA system, please pass on this show.

- FRONT FILLS and any other fills needed should be deployed in order to ensure that all sold audience areas are covered properly by the PA system.
- ARTIST Production Mgr. or Representative has full control and authority to re-configure speaker placement or position if deemed necessary.
- Sound company must provide ARTIST sound engineer with inputs directly into FOH Processing unit or crossover. NO EXCEPTIONS.
- All FOH Processing shall be made assessable to ARTIST Production Manager or representative
- Any and all support acts must use separate consoles and processing equipment from what is designated for use by ARTIST.
- All PA should be flown at every show unless it is structurally impossible.
 - o Midas Pro 2c (x2) for FOH and Monitors
 - o All wireless for ears
 - o All Microphones and DI Boxes

- o Digital stage rack
- o 300' snake – loom of (2) cat 5 and (2) xlr
- o All backline
- o Mic stands, subsnakes, XLR, etc.

Brooke Eden Backline Requirements:

Backline Rider:

RYAN CAIN (BASS)

- AMP
 - o Orange AD200B or Ampeg SVT CL
- All tubes tested before delivery / please bring backup head

- CAB
 - o Orange OBC810 or Ampeg SVT810
- All speakers tested before delivery

• GUITAR BOAT

- o One guitar boat

CORBIN CAGLE (DRUMS)

- DRUMS
 - o Mapex Maple Kit 1st
 - o Drum Workshop - Maple 2nd
- 22"x18" kick
- 9x13 tom
- 14x14 floor
- 16x16
- 2 SNARES
 - 14x6.5" black beauty or/and superphonic
- CYMBALS
 - o Sabian – AAX Series (bigger the better)
- 20" Crash
- 19" Crash

- 22" Ride
- 16" hats or 15" hats AAX
- HARDWARE - DW - ALL DOUBLE BRACED – ALL TESTED

BEFORE DELIVERY!

- o THREE Snare Stands
- o FOUR Boom Stands
- o REMO Coated Emperors on Toms
- o Powerstroke 3 on Kick
- o REMO CS Dot Coated on Snares

Page 12 of 14

Brooke Eden 2016

- o Stand for Roland SPDs drum pad
- o DW 9000 or 5000 Hihat stand
- Two Hi-Hat Clutches!
- o Drum Throne
- o DW 9000 - Double kick pedal

BRAD SAMPLE (GUITAR)

- AMPS
- o 2 VOX AC-30
- Tested before delivery
- GUITAR BOAT
- o One guitar boat for 5 guitars

BROOKE EDEN (KEYBOARD)

- KEYBOARDS
- o 88 key weighted Nord or Yamaha Keyboard

o double braced X fold stand

o sustain pedal



Payton Investigations, PLLC
937 SW 18th St
Fort Lauderdale, FL 33315 US
(786) 529-8936
Justin@paytoninvestigations.com

BILL TO

Randy Carrillo
Morgan Renee Live

INVOICE 1084

DATE 11/17/2017 TERMS Due on receipt

DUE DATE 11/17/2017

ACTIVITY	AMOUNT
Executive Protection J. Payton @ \$100.00hr Estimated Hours: 10 *This includes a discount from the standard rate of \$175.00hr	1,000.00
Executive Protection C. Gillman @ \$100.00hr Estimated Hours: 10 *This includes a discount from the standard rate of \$175.00hr	1,000.00
Executive Protection Additional Professional Driver Flat Rate	400.00
Rental Car Suburban 1 Rate for 12/17/17-12/18/17	125.00
Rental Car Suburban 2 Rate for 12/17/17-12/18/17	125.00
Mileage 2 Suburbans @ \$.50 per mile West Palm Beach - Ft Myers - Ft Lauderdale x2 vehicles: 560 miles Artist and Crew Shuttle-Misc. Distances: \$50 *This is in lieu of fuel & tolls	330.00
Administrative Misc. Admin Fee	100.00
Hotel Holiday Inn Ft Myers 12/17/18	110.00
Josh Turner Concert Top Rocker Six Bends Executive Protection 12/17/18	

TOTAL DUE

\$3,190.00