

**Lee County Board Of County Commissioners  
Agenda Item Summary**

**Blue Sheet No. 20060922**

- 1. ACTION REQUESTED/PURPOSE:** Approve an amendment to the Veteran's Memorial Parkway Limited Access Resolution to relocate the approved connection point for SW 2<sup>nd</sup> Court approximately 131 feet to the west.
- 2. WHAT ACTION ACCOMPLISHES:** Relocation of the access will increase the separation between intersections and thereby enhance safety and preserve the traffic capacity of the roadway.
- 3. MANAGEMENT RECOMMENDATION:** Approve the amendment relocating the access.

**4. Departmental Category:** 9:35 AM PH I **5. Meeting Date:** 9-26-06

<b>6. Agenda:</b>		<b>7. Requirement/Purpose: (specify)</b>		<b>8. Request Initiated:</b>	
<input type="checkbox"/> Consent	<input checked="" type="checkbox"/> Statute	338.01		Commissioner _____	
<input type="checkbox"/> Administrative	<input type="checkbox"/> Ordinance	_____		Department <u>Transportation</u>	
<input type="checkbox"/> Appeals	<input checked="" type="checkbox"/> Admin. Code	11-10		Division _____	
<input checked="" type="checkbox"/> Public @9:35 a.m.	<input type="checkbox"/> Other	_____		By: <u>DMC for SC</u>	
<input type="checkbox"/> Walk-On				Scott Gilbertson, Director	

**Time:** 9:35 a.m. or as soon thereafter as may be heard.

**9. Background:**

On January 28, 2003, the Board adopted a resolution designating the Midpoint Memorial Bridge and Veteran's Memorial Parkway as a limited access facility in accordance with Florida Statutes, Chapter 338 (Resolution No. 03-01-37). The resolution has been amended once since then to add a new access point east of Del Prado Parkway.

Recently, the City Council of the City of Cape Coral, Florida, has approved the realignment of SW 2<sup>nd</sup> Court in Cape Coral in connection with the development approval granted for Lowe's Home Centers, Inc. (Cape Coral Ordinance 37-06, Section III.m.) A condition of the development approval requires Lowe's Home Centers, Inc., to vacate the existing SW 2<sup>nd</sup> Court and realign its connection with the Veteran's Memorial Parkway approximately 131 feet to the west. The relocation will increase the separation between intersections on Veteran's Memorial Parkway. The relocation of the access point will improve traffic circulation and will not present a threat to the public's health, safety, and welfare. The cost of the work associated with the relocation of the access point will be borne by Lowe's Home Centers, Inc.

A resolution has been prepared for the Board's consideration in connection with this request. Staff recommends that the Board reaffirm the designation of the road corridor as a limited access facility and all previous amendments. Staff further recommends the approval of the proposed amendment relocating the access as it conforms with the standard set forth in Lee County Administrative Code 11-10 and the spirit of Lee County Resolution 03-01-37.

**10. Review for Scheduling:**

Department Director	Purchasing or Contracts	Human Resources	Other	County Attorney	Budget Services				County Manager/P.W. Director
					Analyst	Risk	Grants	Mgr.	
<u>8/27/06</u>	n/a	n/a	n/a	<u>DMC 8-25-06</u>	<u>RK 8/25</u>	<u>8/25</u>	<u>8/25/06</u>	<u>8/25/06</u>	<u>8-29-06</u>

**11. Commission Action:**

- Approved
- Deferred
- Denied
- Other

RECEIVED BY COUNTY ADMIN: RK

8-25-06 11:35 mp.

COUNTY ADMIN FORWARDED TO: MC

8/25/06 12:50

Rec. by CoAtty

Date: 8/24/06

Time: 3:40pm

Forwarded To: DMC

8/25/06 10:50

LEE COUNTY RESOLUTION NO. 06-\_\_-\_\_

A RESOLUTION OF THE BOARD OF COUNTY COMMISSIONERS OF LEE COUNTY, FLORIDA, AMENDING RESOLUTION NO. 03-01-37, WHICH DESIGNATED THE MIDPOINT MEMORIAL BRIDGE AND VETERAN'S MEMORIAL PARKWAY AS A LIMITED ACCESS FACILITY IN ACCORDANCE WITH FLORIDA STATUTES, CHAPTER 338, AND ESTABLISHED PERMANENT ACCESS POINTS.

WHEREAS, the Board of County Commissioners (Board) is considered the transportation authority in Lee County by virtue of the authority granted in Florida Statutes, Section 125.01(m), to provide and regulate roads; and,

WHEREAS, the Board, as transportation authority, has the power to establish, designate, and regulate limited access facilities in accordance with Florida Statutes, Section 338.01; and,

WHEREAS, the Board designated and established the Veteran's Parkway Corridor from the Caloosahatchee River to Pine Island Road as a limited access facility with fixed access points in accordance with Florida Statutes, Section 338.01, pursuant to Resolution No. 03-01-37; and,

WHEREAS, the Board designated the roadway as a limited access facility in order to allow for the safe and relatively unimpeded movement of large volumes of traffic; and,

WHEREAS, at the request of the City Council of the City of Cape Coral, Florida (the "Cape"), the Board added a new access point to Veteran's Memorial Parkway east of Del Prado Boulevard at SE 26<sup>th</sup> Street within the City of Cape Coral (Resolution No. 03-09-95); and,

WHEREAS, Lee County Administrative Code 11-10 sets forth the technical requirements for relocating designated access points on controlled access roadways and its criteria is used to determine whether the public interest would be served by altering the access plan on limited access facilities; and,

WHEREAS, the Cape recently approved the realignment of SW 2<sup>nd</sup> Court by Lowe's Home Centers, Inc., in connection with Cape Coral Ordinance No. 37-06, Section III.m.;

and,

WHEREAS, the road realignment necessitates the relocation of the access point for SW 2<sup>nd</sup> Court to the west of its current location; and,

WHEREAS, the Board finds that the relocation of the access point for SW 2<sup>nd</sup> Court will preserve safety and traffic capacity and is, therefore, in the best interest of the public;

and,

WHEREAS, the Board desires to reaffirm the designation of Veteran's Memorial Parkway as a limited access facility, all previous amendments as well as the relocation of the access point for SW 2<sup>nd</sup> Court.

NOW THEREFORE, BE IT RESOLVED BY THE BOARD OF COUNTY COMMISSIONERS that:

1. The designation of the Veteran's Memorial Parkway corridor from the Caloosahatchee River to Pine Island Road as a limited access facility with fixed access points in accordance with Section 338.01, F.S. is hereby affirmed including the access point added east of Del Prado Boulevard at SE 26<sup>th</sup> Street within the City of Cape Coral. (Map attached as Exhibit 1.)
2. The access to SW 2<sup>nd</sup> Court is hereby relocated approximately 131± feet to the west of its current location, from Highway Station 891+58.26 to Highway Station 890+27, as reflected in Exhibits 1 and 2 attached hereto.
3. The relocation of the SW 2<sup>nd</sup> Court access does not present a threat to public health, safety, and welfare. The relocation will serve the public interest because it will improve traffic circulation.
4. The design attached as Exhibit 1 supercedes all prior depictions of the limited access facility.
5. This resolution was adopted by an affirmative vote of a super majority of the Board of County Commissioners.

The foregoing Resolution was offered by Commissioner \_\_\_\_\_, who moved its adoption. The motion was seconded by Commissioner \_\_\_\_\_ and, being put to a vote, the vote was as follows:

Robert P. Janes

Douglas R. St. Cerny

Ray Judah

Tammara Hall

John E. Albion

DULY PASSED AND ADOPTED this \_\_\_\_ day of \_\_\_\_\_ 2006.

ATTEST:  
CHARLIE GREEN, CLERK

BOARD OF COUNTY COMMISSIONERS  
OF LEE COUNTY, FLORIDA

By: \_\_\_\_\_  
Deputy Clerk

By: \_\_\_\_\_  
Tammara Hall, Chairwoman

APPROVED AS TO FORM:

By: \_\_\_\_\_  
Donna Marie Collins  
Office of the County Attorney

Exhibit 1: Veteran's Memorial Parkway Access Map  
Exhibit 2: Sketch C-10A

SHEET 1 OF 4

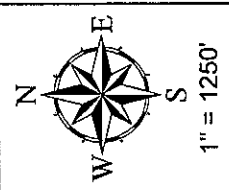
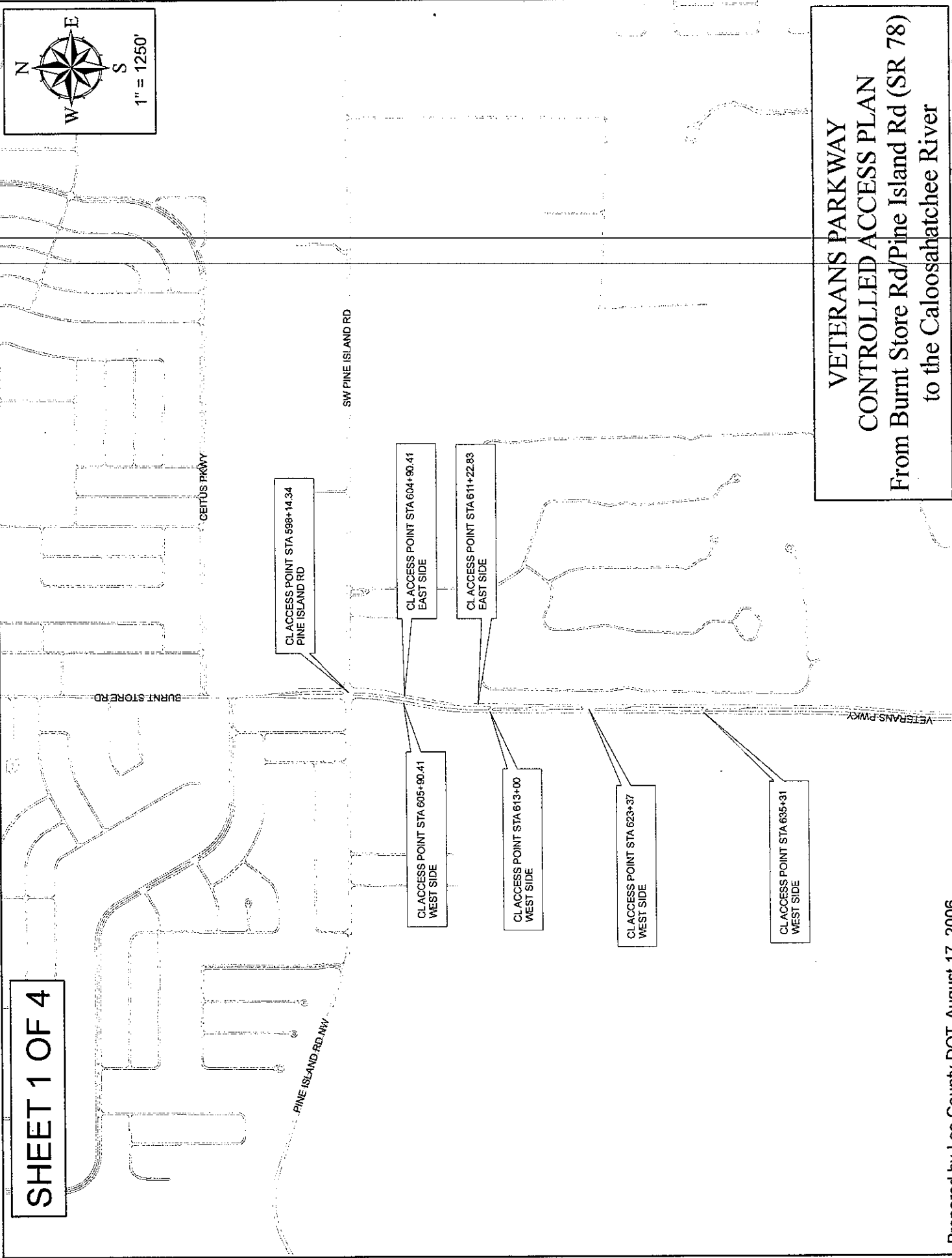

**VETERANS PARKWAY  
CONTROLLED ACCESS PLAN**  
From Burnt Store Rd/Pine Island Rd (SR 78)  
to the Caloosahatchee River

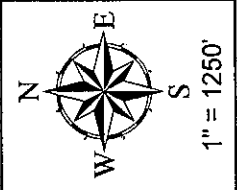

TRAFALGAR PKWY

SURFSIDE BLVD

CHIQUITA BLVD S

VETERANS PARKWAY

SHEET 2 OF 4

CL ACCESS POINT STA 667+90 WEST SIDE

CL ACCESS POINT STA 665+00 EAST SIDE

CL ACCESS POINT STA 718+50 NORTH SIDE

CL ACCESS POINT STA 734+00 NORTH SIDE

STATION EQUATION 772+43.64 BACK STATION EQUATION 772+44.37 AHEAD

CL ACCESS POINT STA 748+04.02 SURFSIDE BLVD - NORTH & SOUTH SIDES

CL ACCESS POINT STA 751+27.40 SW 22ND PL - SOUTH SIDE

CL ACCESS POINT STA 774+70.77 SW 20TH AVE - NORTH & SOUTH SIDES

CL ACCESS POINT STA 801+09.19 CHIQUITA BLVD - NORTH & SOUTH SIDES

CL ACCESS POINT STA 789+45.65 SW 17TH AVE - NORTH SIDE

VETERANS PARKWAY CONTROLLED ACCESS PLAN From Burnt Store Rd/Pine Island Rd (SR 78) to the Caloosahatchee River

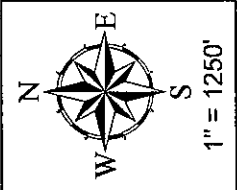

SHEET 3 OF 4

CL ACCESS POINT STA 834+67.57  
SW 11TH AVE - NORTH SIDE

CL ACCESS POINT STA 821+67.50  
SW 12TH PL - SOUTH SIDE

CL CONSTRUCTION STA 854+07.68  
SKYLINE BLVD - NORTH & SOUTH SIDE

PROPOSED  
CL ACCESS POINT STA 890+27  
SW 2ND CT - NORTH SIDE  
(RELOCATED FROM STA 891+58.28)

CL ACCESS POINT STA 894+61.47  
SW 2ND PL - SOUTH SIDE

CL ACCESS POINT STA 897+78.31  
KAMAL PKWY - SOUTH SIDE

CL ACCESS POINT STA 910+07.33  
SANTA BARBARA BLVD - NORTH & SOUTH SIDE

SANTA BARBARA BLVD

VETERANS PKWY

SKYLINE BLVD

KAMAL PKWY

GLEASON PKY

VETERANS PARKWAY  
CONTROLLED ACCESS PLAN  
From Burnt Store Rd/Pine Island Rd (SR 78)  
to the Caloosahatchee River

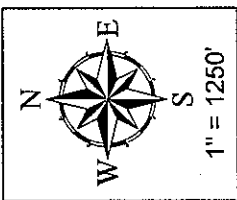

SHEET 4 OF 4

**VETERANS PARKWAY  
CONTROLLED ACCESS PLAN**  
From Burnt Store Rd/Pine Island Rd (SR 78)  
to the Caloosahatchee River

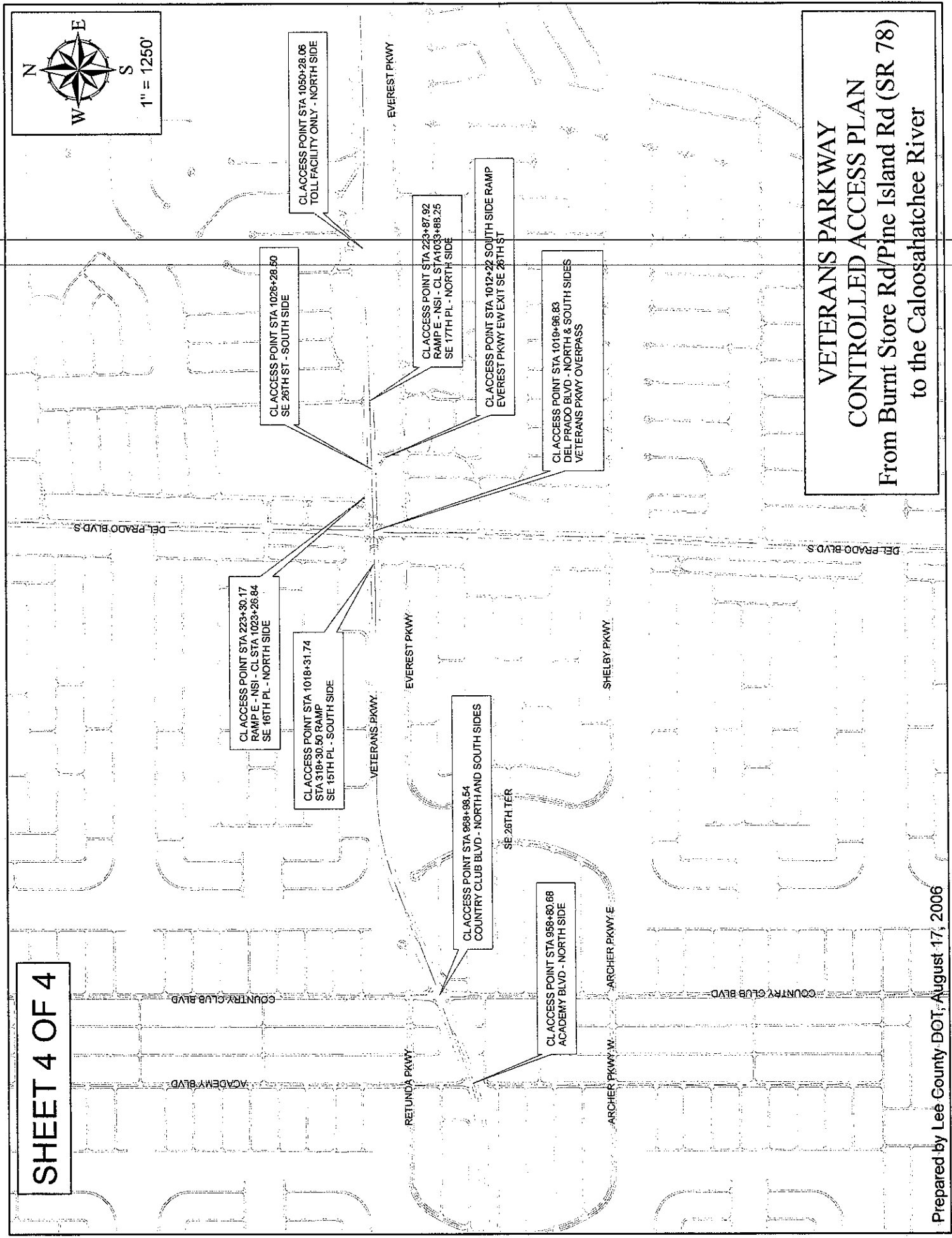

CL ACCESS POINT STA 1026+28.50  
SE 26TH ST - SOUTH SIDE

CL ACCESS POINT STA 1050+28.06  
TOLL FACILITY ONLY - NORTH SIDE

CL ACCESS POINT STA 223+87.92  
RAMP E - NSI - CL STA 1033+88.25  
SE 17TH PL - NORTH SIDE

CL ACCESS POINT STA 1012+22  
SOUTH SIDE RAMP  
EVEREST PKWY EXIT SE 26TH ST

CL ACCESS POINT STA 1019+66.83  
DEL PRADO BLVD - NORTH & SOUTH SIDES  
VETERANS PKWY OVERPASS

CL ACCESS POINT STA 223+30.17  
RAMP E - NSI - CL STA 1023+26.84  
SE 16TH PL - NORTH SIDE

CL ACCESS POINT STA 1018+31.74  
STA 318+30.50 RAMP  
SE 15TH PL - SOUTH SIDE

CL ACCESS POINT STA 989+88.54  
COUNTRY CLUB BLVD - NORTH AND SOUTH SIDES

CL ACCESS POINT STA 958+80.68  
ACADEMY BLVD - NORTH SIDE



