

COMPONENTS OF CONTRACT PLANS SET
 ROADWAY PLANS
 UTILITY WORK BY HIGHWAY CONTRACTOR PLANS - LEE COUNTY UTILITIES

LEE COUNTY

CONTRACT PLANS

BEACON MANOR DRIVE SIDEWALK IMPROVEMENTS

US 41 TO DANLEY DRIVE

COUNTY PROJECT No.: 6002
 LEE COUNTY, FLORIDA

A DETAILED INDEX APPEARS ON THE
 KEY SHEET OF EACH COMPONENT

INDEX OF ROADWAY PLANS

SHEET NO.	SHEET DESCRIPTION
1	KEY SHEET
2	SUMMARY OF PAY ITEMS
3	TYPICAL SECTIONS
4-6	SUMMARY OF QUANTITIES
7	GENERAL NOTES
8	PROJECT LAYOUT
9-13	PLANS
14-23	GRADING PLANS
24-27	CROSS SECTIONS

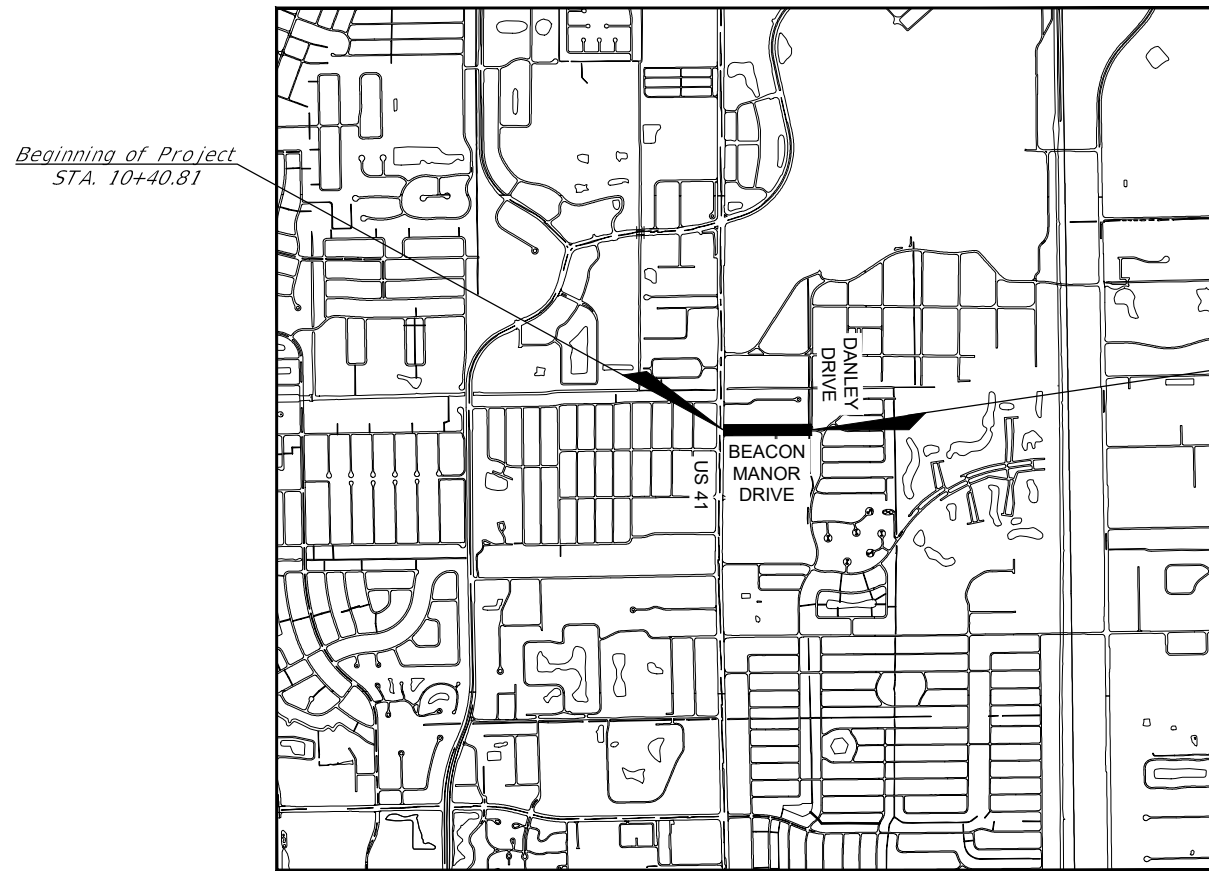
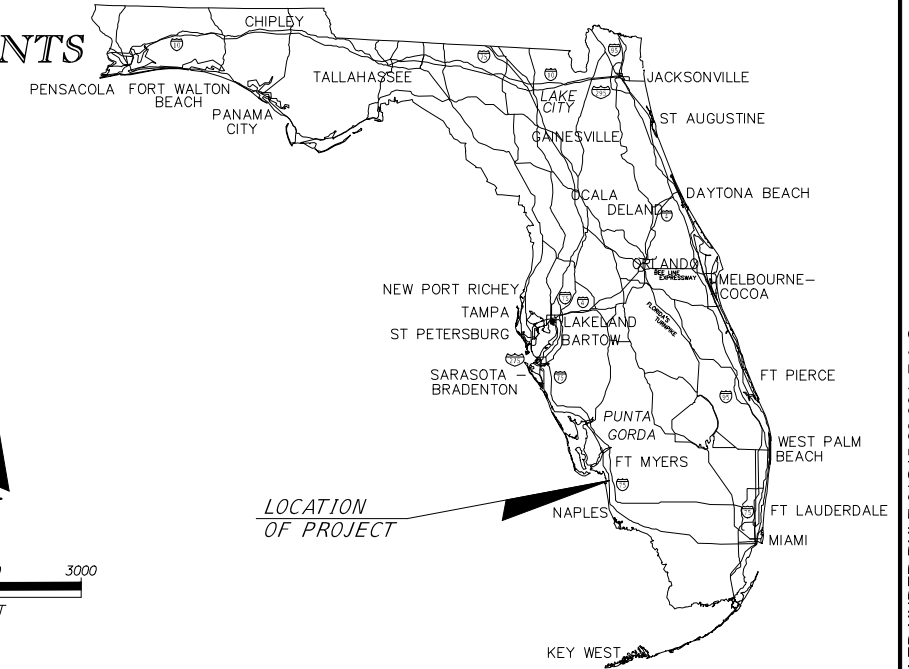

Beginning of Project
 STA. 10+40.81

Ending of Project
 STA. 24+75.92

THIS DOCUMENT HAS BEEN
 DIGITALLY SIGNED AND SEALED BY:

PLANS PREPARED
 BY:



6200 Whiskey Creek Dr.
 Fort Myers, FL. 33919
 Phone: (239) 985-1200
 Florida Certificate of
 Authorization No.1772

PRINTED COPIES OF THIS DOCUMENT ARE
 NOT CONSIDERED SIGNED AND SEALED.
 THE SIGNATURE MUST BE VERIFIED ON
 THE ELECTRONIC DOCUMENTS.

NOTE: THE SCALE OF THESE PLANS MAY
 HAVE CHANGED DUE TO REPRODUCTION.

THE ABOVE NAMED PROFESSIONAL ENGINEER SHALL BE RESPONSIBLE FOR
 THE FOLLOWING SHEETS IN ACCORDANCE WITH RULE 61G15-23.004, F.A.C.

GOVERNING DESIGN STANDARDS:
 Florida Department of Transportation, FY2017-18 Design Standards
 eBook (DSeB) and applicable Design Standards Revisions (DSRs) at the
 following website:
<http://www.dot.state.fl.us/rddesign/DesignStandards/Standards.shtm>

APPLICABLE DSRs:

GOVERNING STANDARD SPECIFICATIONS:
 Florida Department of Transportation, Jan. 2018 Standard Specifications
 for Road and Bridge Construction at the following website:
<http://www.dot.state.fl.us/programmanagement/implemented/SpecBooks>

REVISIONS:

ROADWAY PLANS
 ENGINEER OF RECORD: ROBERT L. MURRAY, P.E.
 P.E. NO.: 35826

BID DOCUMENTS
 1/30/2019

FISCAL YEAR	SHEET NO.
18	1

NOTICE: THE OFFICIAL RECORD OF THIS SHEET IS THE ELECTRONIC FILE DIGITALLY SIGNED AND SEALED UNDER RULE 61G15-23.004, F.A.C.

H:\2016\2016072\DW\TR\SHEET FILES\002 -- BEACON MANOR SUMMARY OF PAY ITEMS.dwg Tab: PIS Jan 28, 2019 -- 4:20pm

LEE COUNTY			
PROJECT SUMMARY OF PAY ITEMS			
ITEM NUMBER	ITEM DESCRIPTION	UNITS	QUANTITY
101-1	MOBILIZATION	LS	1
102-1	MAINTENANCE OF TRAFFIC	LS	1
104-12	STAKED TURBIDITY BARRIER	LF	34
104-18	INLET PROTECTION SYSTEM	EA	14
110-1-1	CLEARING AND GRUBBING	LS	1
110-4-10	REMOVAL OF EXISTING CONCRETE	SY	81
120-1	REGULAR EXCAVATION	CY	244
120-6	EMBANKMENT	CY	116
160-4	TYPE B STABILIZATION	SY	661
285-702	OPTIONAL BASE GROUP 02	SY	651
	ASPHALT TYPE S-1	TN	72
425-1-351	INLETS, CURB, TYPE P-5, <10'	EA	2
425-1-501	INLETS, DT BOT, TYPE A, <10'	EA	3
425-1-521	INLETS, DT BOT, TYPE C, <10'	EA	8
425-1-529	INLETS, DT BOT, TYPE C MOD.	EA	1
425-2-61	MANHOLES, P-8, <10'	EA	2
425-6	ADJUSTING VALVE BOXES	EA	2
436-1-1	TRENCH DRAIN, STANDARD	LF	41
430-174-115	PIPE CULVERT, OPTIONAL MATERIAL, ROUND, 15" SD	LF	286
430-174-118	PIPE CULVERT, OPTIONAL MATERIAL, ROUND, 18" SD	LF	464
430-174-124	PIPE CULVERT, OPTIONAL MATERIAL, ROUND, 24" SD	LF	321

LEE COUNTY			
PROJECT SUMMARY OF PAY ITEMS			
ITEM NUMBER	ITEM DESCRIPTION	UNITS	QUANTITY
430-984-129	MITERED END SECTION, OPTIONAL OPTIONAL ROUND, 24" SD	EA	1
515-1-2	PIPE HANDRAIL - GUIDERAIL, ALUMINUM	LF	17
515-2-311	PEDESTRIAN / BICYCLE RAILING, ALUMINUM ONLY, 42" TYPE I	LF	22
520-1-10	CONCRETE CURB & GUTTER, TYPE F	LF	180
520-2-4	CONCRETE CURB, TYPE D MODIFIED	LF	18
522-2	CONCRETE SIDEWALK, 6" THICK	SY	781
527-2	DETECTABLE WARNINGS (INSET/WET SET TYPE)	SF	43
570-1-2	PERFORMANCE TURF, SOD	SY	731
635-2	PULL & SPLICE BOX, ADJUST TO GRADE	EA	3
700-1-50	SINGLE POST SIGN, RELOCATE	AS	3
711-11-123	THERMOPLASTIC, STD, WHITE, SOLID, 12"	LF	78
711-11-125	THERMOPLASTIC, STD, WHITE, SOLID, 24"	LF	11

BID DOCUMENTS 1/30/2019

LETTER	REVISIONS	DATE

**Beacon Manor Drive
Sidewalk Improvements**



ROBERT L. MURRAY, P.E.
P.E. NO.: 35826
HOLE MONTES, INC.
6200 WHISKEY CREEK DRIVE
FORT MYERS, FL. 33919
CERTIFICATE OF AUTHORIZATION No.1772

**BEACON MANOR DRIVE
SUMMARY OF PAY ITEMS**

CAD FILE NAME:	DRAWING NO.:
16072PI	PI
PROJECT NO.:	SHEET NO.:
2016072	2

NOTICE: THE OFFICIAL RECORD OF THIS SHEET IS THE ELECTRONIC FILE DIGITALLY SIGNED AND SEALED UNDER RULE 61G15-23.004, F.A.C.

H:\2016\2016072\DW\TR\SHEET FILES\003 - BEACON MANOR TYPICALS.dwg Tab: TYPICAL 1 Jan 28, 2019 - 4:22pm

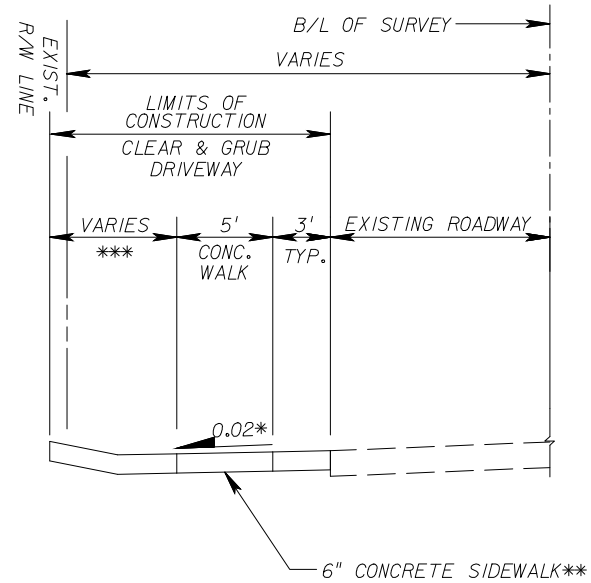

TYPICAL SECTION
BEACON MANOR DRIVE

* = SIDEWALK CROSS SLOPE 0.02 MAX.

**= 6" DEPTH CONCRETE SIDEWALK TYPICAL ALL LOCATIONS

***= FOR DRIVEWAY DETAILS SEE GRADING PLAN AND CROSS SECTIONS

STATION 16+34.31 - 16+69.77
STATION 17+03.36 - 19+56.49
STATION 20+05.18 - 20+36.41
STATION 20+87.80 - 21+51.74
STATION 22+73.56 - 23+32.21

DRIVEWAY PAVEMENT SECTION
S-I ASPHALT (2")
OPTIONAL BASE GROUP 2
TYPE B STABILIZATION LBR 40 (12")

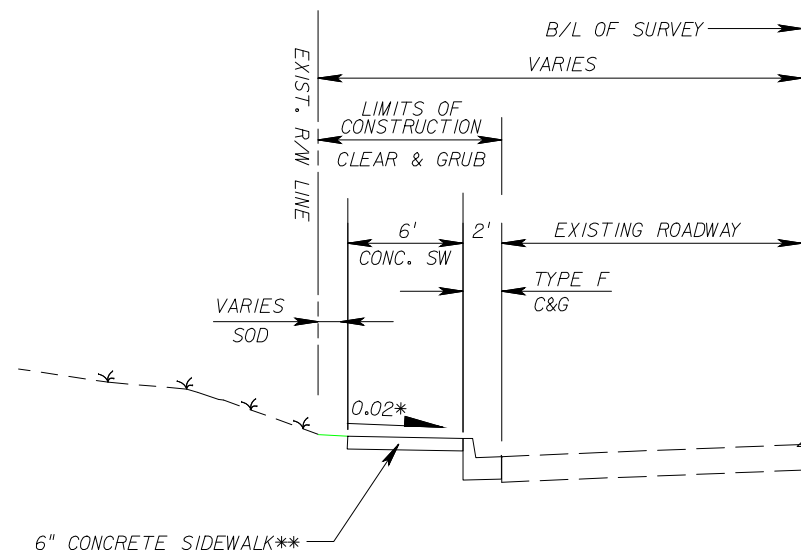

TYPICAL SECTION
BEACON MANOR DRIVE

* = SIDEWALK CROSS SLOPE 0.02 MAX.

**= 6" DEPTH CONCRETE SIDEWALK TYPICAL ALL LOCATIONS

STATION 10+84.49 - 12+64.01

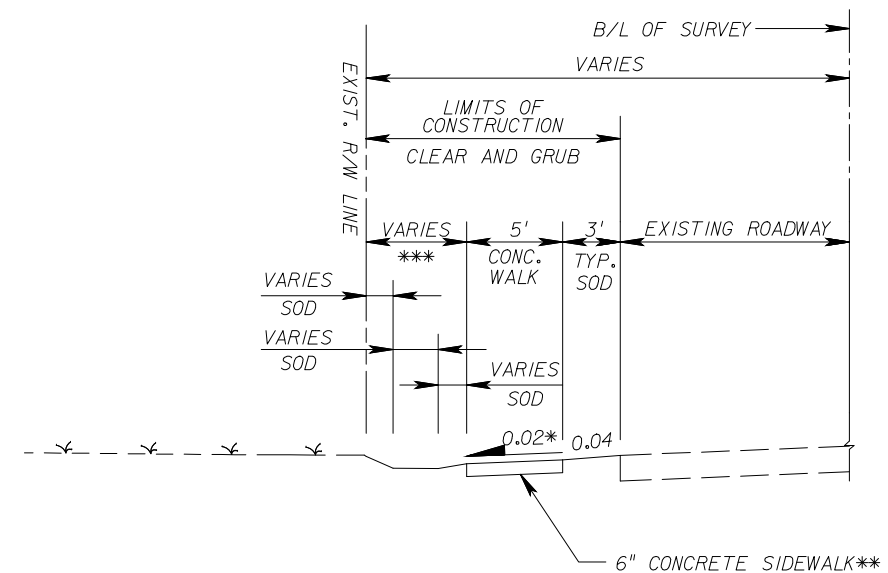

TYPICAL SECTION
BEACON MANOR DRIVE

* = SIDEWALK CROSS SLOPE 0.02 MAX.

**= 6" DEPTH CONCRETE SIDEWALK TYPICAL ALL LOCATIONS

***= FOR SWALE DETAILS SEE GRADING PLAN AND CROSS SECTIONS

STATION 10+40.81 - 10+84.49
STATION 12+64.01 - 16+34.31
STATION 16+69.77 - 17+03.36
STATION 19+56.49 - 20+05.18
STATION 20+36.41 - 20+87.80
STATION 21+51.74 - 22+73.56
STATION 23+32.21 - 24+75.92

BID DOCUMENTS 1/30/2019

LETTER	REVISIONS	DATE

**Beacon Manor Drive
Sidewalk Improvements**



ROBERT L. MURRAY, P.E.
P.E. NO.: 35826
HOLE MONTES, INC.
6200 WHISKEY CREEK DRIVE
FORT MYERS, FL. 33919
CERTIFICATE OF AUTHORIZATION No.1772

**BEACON MANOR DRIVE
TYPICAL SECTIONS**

CAD FILE NAME:	DRAWING NO.:
16072TYP	TYP
PROJECT NO.:	SHEET NO.:
2016072	3

NOTICE: THE OFFICIAL RECORD OF THIS SHEET IS THE ELECTRONIC FILE DIGITALLY SIGNED AND SEALED UNDER RULE 61G15-23.004, F.A.C.

H:\2016\2016072\DW\TR\SHEET FILES\004 - BEACON MANOR SUMMARY OF QUANTITIES.dwg Tab: SQ1 Jan 28, 2019 - 4:26pm

SUMMARY OF EROSION AND SEDIMENT CONTROL DEVICES								
LOCATION	SIDE	AREA ID	STAKED TURBIDITY BARRIER		INLET PROTECTION SYSTEM		DESIGN NOTES	CONSTRUCTION REMARKS
STA. TO STA.			0104 12		0104 18			
			LF		EA			
	P	F	P	F				
10+81.87 TO 10+90.75	LT				1		S-1	
11+62.06 TO 11+66.81	LT				1		S-3	
12+03.04 TO 12+07.79	LT				1		S-4	
13+91.79 TO 14+04.14	LT				1		S-5	
14+59.89 TO 14+64.55	LT				1		S-6	
15+28.07 TO 15+32.68	LT				1		S-7	
15+97.19 TO 16+02.81	LT				1		S-8	
16+82.23 TO 16+87.86	LT				1		S-9	
17+65.61 TO 17+71.24	LT				1		S-10	
18+31.90 TO 18+37.52	LT				1		S-11	
18+93.75 TO 18+99.37	LT				1		S-12	
19+65.12 TO 19+69.49	LT				1		S-13	
20+61.72 TO 20+67.34	LT				1		S-14	
22+60.04 TO 22+65.66	LT				1		S-15	
23+71.70 TO 24+05.46	LT		34					
TOTAL:			34		14			

SUMMARY OF CLEARING AND GRUBBING & REMOVAL ITEMS											
PAY ITEM NO.	PAY ITEM DESCRIPTION	LOCATION	SIDE	AREA ID	UNITS	QUANTITY		TOTAL		DESIGN NOTES	CONSTRUCTION REMARKS
		STA. TO STA.				P	F	P	F		
0110 4 10	REMOVAL OF EXISTING CONCRETE	11+36.29 TO 11+51.94	LT		SY	14		81		DRIVEWAY	
		12+63.74 TO 13+06.73	LT		SY	40				DRIVEWAY	
		24+48.72 TO 24+75.82	LT		SY	27				SIDEWALK	

BID DOCUMENTS 1/30/2019

LETTER	REVISIONS	DATE

**Beacon Manor Drive
Sidewalk Improvements**



ROBERT L. MURRAY, P.E.
P.E. NO.: 35826
HOLE MONTES, INC.
6200 WHISKEY CREEK DRIVE
FORT MYERS, FL. 33919
CERTIFICATE OF AUTHORIZATION No.1772

**BEACON MANOR DRIVE
SUMMARY OF QUANTITIES**

CAD FILE NAME: 16072SQ	DRAWING NO.: SQ
PROJECT NO.: 2016072	SHEET NO.: 4

NOTICE: THE OFFICIAL RECORD OF THIS SHEET IS THE ELECTRONIC FILE DIGITALLY SIGNED AND SEALED UNDER RULE 61G15-23.004, F.A.C.

H:\2016\2016072\DW\TR\SHEET FILES\004 -- BEACON MANOR SUMMARY OF QUANTITIES.dwg Tab: SQ2 Jan 28, 2019 -- 4:27pm

SUMMARY OF SIDE DRAIN, INLETS, MANHOLES & MITERED END SECTIONS												
LOCATION STA. TO STA.	SIDE	PIPE LENGTH			MES	INLETS (<10')				MAN HOLE (<10')	STRUCTURE NO.	DESIGN NOTES
		LF			EA	EA				EA		
		15"	18"	24"	24"	A	C	C-MOD	TYPE 5	P-8		
10+86.34 TO 10+96.98	LT	12						1		1	S-1, S-2	
10+96.98 TO 11+64.30	LT	68							1		S-3	
11+64.30 TO 12+05.55	LT	41*							1		S-4	TRENCH DRAIN
13+94.12 TO 14+62.22	LT	68					2				S-5, S-6	
14+62.22 TO 15+30.34	LT	68					1				S-7	
15+30.34 TO 16+00.00	LT	70					1				S-8	
16+00.00 TO 16+85.04	LT		85				1				S-9	
16+85.04 TO 17+68.43	LT		83			1					S-10	
17+68.43 TO 18+34.71	LT		66			1					S-11	
18+34.71 TO 18+96.56	LT		62			1					S-12	
18+96.56 TO 19+67.32	LT		71				1				S-13	
19+67.32 TO 20+64.53	LT		97				1				S-14	
20+64.53 TO 22+62.85	LT			198			1				S-15	
22+62.85 TO 23+70.40	LT			108						1	S-16	
23+70.40 TO 23+79.87	LT			15	1						S-17	
TOTAL:		286	464	321	1	3	8	1	2	2		

* Pipe length is included under the pay item for trench drain.

SUMMARY OF EARTHWORK			
PAY ITEM NO.	PAY ITEM DESCRIPTION	CY	
		P	F
120-1	REGULAR EXCAVATION	244	
120-6	EMBANKMENT	116	

Earthwork has been calculated by using limerock base option.
If another option is constructed, there shall be no revision to the earthwork quantities for which payment is made by Plan Quantity.

BID DOCUMENTS 1/30/2019

LETTER	REVISIONS	DATE

**Beacon Manor Drive
Sidewalk Improvements**



ROBERT L. MURRAY, P.E.
P.E. NO.: 35826
HOLE MONTES, INC.
6200 WHISKEY CREEK DRIVE
FORT MYERS, FL. 33919
CERTIFICATE OF AUTHORIZATION No.1772

**BEACON MANOR DRIVE
SUMMARY OF QUANTITIES**

CAD FILE NAME:	DRAWING NO.:
16072SQ	SQ
PROJECT NO.:	SHEET NO.:
2016072	5

NOTICE: THE OFFICIAL RECORD OF THIS SHEET IS THE ELECTRONIC FILE DIGITALLY SIGNED AND SEALED UNDER RULE 61G15-23.004, F.A.C.

H:\2016\2016072\DW\TR\SHEET FILES\004 -- BEACON MANOR SUMMARY OF QUANTITIES.dwg Tab: SQ3 Jan 28, 2019 -- 4:27pm

SUMMARY OF PERFORMANCE TURF								
LOCATION	SIDE	AREA ID	LENGTH	WIDTH	PERFORMANCE TURF (SOD)		DESIGN NOTES	CONSTRUCTION REMARKS
					0570	1 2		
STA. TO STA.					SY			
					P	F		
10+40.81 TO 10+61.08	LT		20	4	9			
10+61.08 TO 11+38.21	LT		77	12	102			
11+38.34 TO 11+48.06	LT		10	1	2			
11+48.06 TO 12+68.19	LT		120	4	53			
12+68.20 TO 13+03.10	LT		35	2	8			
13+02.05 TO 16+38.93	LT		336	6	224			
16+65.13 TO 17+04.16	LT		39	7	30			
19+53.30 TO 20+09.56	LT		56	9	56			
20+30.27 TO 20+94.93	LT		65	9	65			
21+43.37 TO 22+79.94	LT		136	9	136			
23+28.30 TO 24+15.71	LT		87	3	29			
24+42.19 TO 24+48.67	LT		7	15	12			
24+53.28 TO 24+67.69	LT		14	3	5			
TOTAL:					731			

SUMMARY OF PIPE GUIDERAIL					
LOCATION	SIDE	PIPE GUIDERAIL		DESIGN NOTES	CONSTRUCTION REMARKS
STA. TO STA.		LF			
		P	F		
22+59.37 TO 22+66.37	LT	7			
13+89.08 TO 13+99.08	LT	10			
TOTAL:		17			

SUMMARY OF PEDESTRIAN / BICYCLE RAILING					
LOCATION	SIDE	PED / BIKE RAILING		DESIGN NOTES	CONSTRUCTION REMARKS
STA. TO STA.		LF			
		P	F		
10+41.69 TO 10+61.59	LT	22			
TOTAL:		22			

SUMMARY OF VALVE BOX ADJUSTMENTS			
LOCATION		EA	
STATION	SIDE	P	F
10+82.64	LT	1	
10+82.75	LT	1	
TOTAL:		2	

SUMMARY OF PULL AND SPLICE BOX ADJUSTMENTS			
LOCATION		EA	
STATION	SIDE	P	F
16+23.24	LT	1	
19+25.76	LT	1	
23+59.03	LT	1	
TOTAL:		3	

BID DOCUMENTS 1/30/2019

LETTER	REVISIONS	DATE

**Beacon Manor Drive
Sidewalk Improvements**



ROBERT L. MURRAY, P.E.
P.E. NO.: 35826
HOLE MONTES, INC.
6200 WHISKEY CREEK DRIVE
FORT MYERS, FL. 33919
CERTIFICATE OF AUTHORIZATION No.1772

**BEACON MANOR DRIVE
SUMMARY OF QUANTITIES**

CAD FILE NAME: 16072SQ	DRAWING NO.: SQ
PROJECT NO.: 2016072	SHEET NO.: 6

NOTICE: THE OFFICIAL RECORD OF THIS SHEET IS THE ELECTRONIC FILE DIGITALLY SIGNED AND SEALED UNDER RULE 61G15-23.004, F.A.C.

GENERAL NOTES

1. BENCHMARK ELEVATIONS SHOWN ON THE PLANS ARE NORTH AMERICAN VERTICAL DATUM OF 1988 (NAVD 88).
2. EXISTING DRAINAGE STRUCTURES WITHIN CONSTRUCTION LIMITS SHALL REMAIN UNLESS OTHERWISE NOTED.
3. THE LOCATIONS OF THE UTILITIES SHOWN IN THE PLANS (INCLUDING THOSE DESIGNATED Vv, Vh, AND Vvh) ARE BASED ON LIMITED INVESTIGATION TECHNIQUES AND SHOULD BE CONSIDERED APPROXIMATE ONLY. THE VERIFIED LOCATIONS/ELEVATIONS APPLY ONLY AT THE POINTS SHOWN. INTERPOLATIONS BETWEEN THESE POINTS HAVE NOT BEEN VERIFIED.
4. EXISTING UTILITIES ARE TO REMAIN IN PLACE UNLESS OTHERWISE NOTED.

5. UTILITY / AGENCY OWNERS:

<u>COMPANY</u>	<u>CONTACT</u>	<u>PHONE No.</u>	<u>EMAIL</u>
COMCAST	Mark Cook	239-432-1805	mark_cook@cable.comcast.com
FP&L	Michael Martinez	239-353-6047	michael.martinez@fpl.com
CENTURY LINK	James Nottingham Jr.	239-336-2035	james.L.nottingham.jr@centurylink.com
LEE COUNTY UTILITIES	Victor Gagnon	239-533-8178	vgagnon@leegov.com
TECO Peoples Gas	M.D. Aloï	239-690-5517	mdaloi@tecoenergy.com
Fibernet Direct	Bill Moore	904-355-9742	bill.moore@fibernetdirect.com
City of Fort Myers	Angelo Thomas	239-321-7463	athomas@cityftmyers.com
Summit Broadband	Mike Reber	239-444-0032	mreber@summit-broadband.com
Level 3 Communications	Michael Nunez	720-888-0916	michael.nunez@level3.com
Lee County Signals / ATMS	James Fencil	239-707-4870	jfencil@leegov.com
Lee County Irrigation	Richard Calkins Jr.	239-533-9440	rcalkins@leegov.com

6. IF ANY PUBLIC LAND CORNER WITHIN THE LIMITS OF CONSTRUCTION IS IN DANGER OF BEING DESTROYED AND HAS NOT BEEN PROPERLY REFERENCED, IMMEDIATELY NOTIFY THE ENGINEER IN CONJUNCTION WITH THE DISTRICT LOCATION SURVEYOR.
7. ANY IRRIGATION OR LANDSCAPING CONFLICTS SHALL BE RESOLVED BY THE AFFECTED PROPERTY OWNER.
8. ANY PULL BOXES TO BE ADJUSTED WITHIN THE PROPOSED SIDEWALK ARE TO BE FLUSH AND UNDAMAGED.

PAY ITEM NOTES:

1. PAY ITEM 425-6 IS A CONTINGENCY ITEM TO BE USED AS DIRECTED BY THE ENGINEER.

H:\2016\2016072\DW\TR\SHEET FILES\007 -- BEACON MANOR GENERAL NOTES.dwg Tab: GN Jan 28, 2019 -- 4:29pm

NOTICE: THE OFFICIAL RECORD OF THIS SHEET IS THE ELECTRONIC FILE DIGITALLY SIGNED AND SEALED UNDER RULE 61G15-23.004, F.A.C.

BID DOCUMENTS 1/30/2019

LETTER	REVISIONS	DATE

**Beacon Manor Drive
Sidewalk Improvements**



ROBERT L. MURRAY, P.E.
P.E. NO.: 35826
HOLE MONTES, INC.
6200 WHISKEY CREEK DRIVE
FORT MYERS, FL. 33919
CERTIFICATE OF AUTHORIZATION No.1772

**BEACON MANOR DRIVE
GENERAL NOTES**

CAD FILE NAME:	DRAWING NO.:
16072GN	GN
PROJECT NO.:	SHEET NO.:
2016072	7

H:\2016\2016072\DW\TR\SHEET FILES\008 -- BEACON MANOR LAYOUT.dwg Tab: LAYOUT Jan 28, 2019 -- 4:31pm

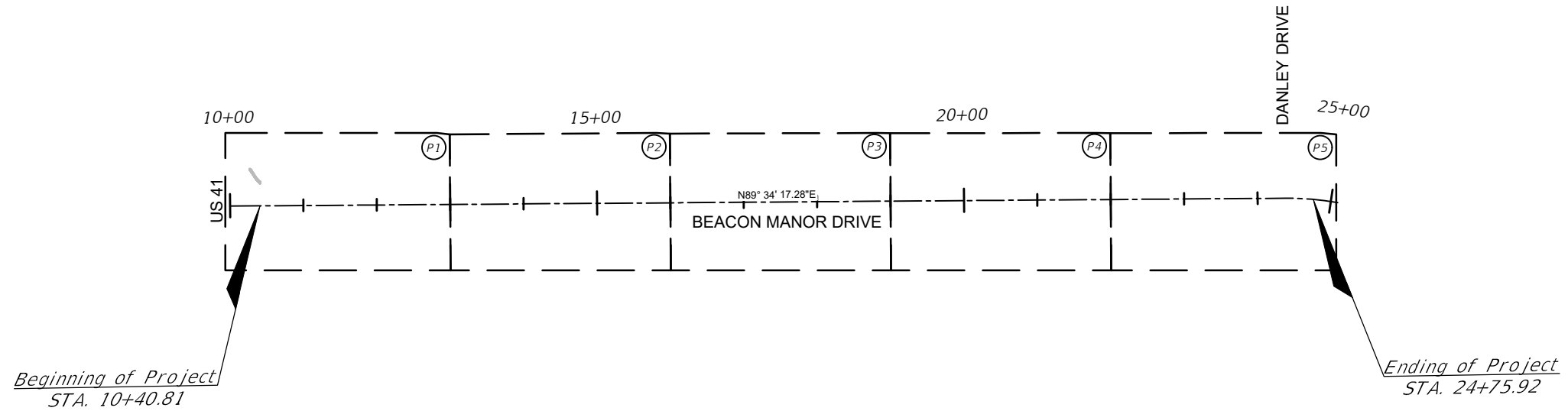
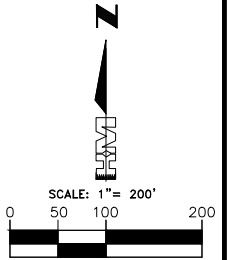

BID DOCUMENTS 1/30/2019

LETTER	REVISIONS	DATE

**Beacon Manor Drive
Sidewalk Improvements**



ROBERT L. MURRAY, P.E.
P.E. NO.: 35826
HOLE MONTES, INC.
6200 WHISKEY CREEK DRIVE
FORT MYERS, FL. 33919
CERTIFICATE OF AUTHORIZATION No.1772

**BEACON MANOR DRIVE
PROJECT LAYOUT**

CAD FILE NAME: 16072PL	DRAWING NO.: PL
PROJECT NO.: 2016072	SHEET NO.: 8

NOTICE: THE OFFICIAL RECORD OF THIS SHEET IS THE ELECTRONIC FILE DIGITALLY SIGNED AND SEALED UNDER RULE 61G15-23.004, F.A.C.

H:\2016\2016072\DW\TR\SHEET FILES\009 -- BEACON MANOR PLAN SHEETS.dwg Tab: P1 Jan 28, 2019 -- 4:40pm

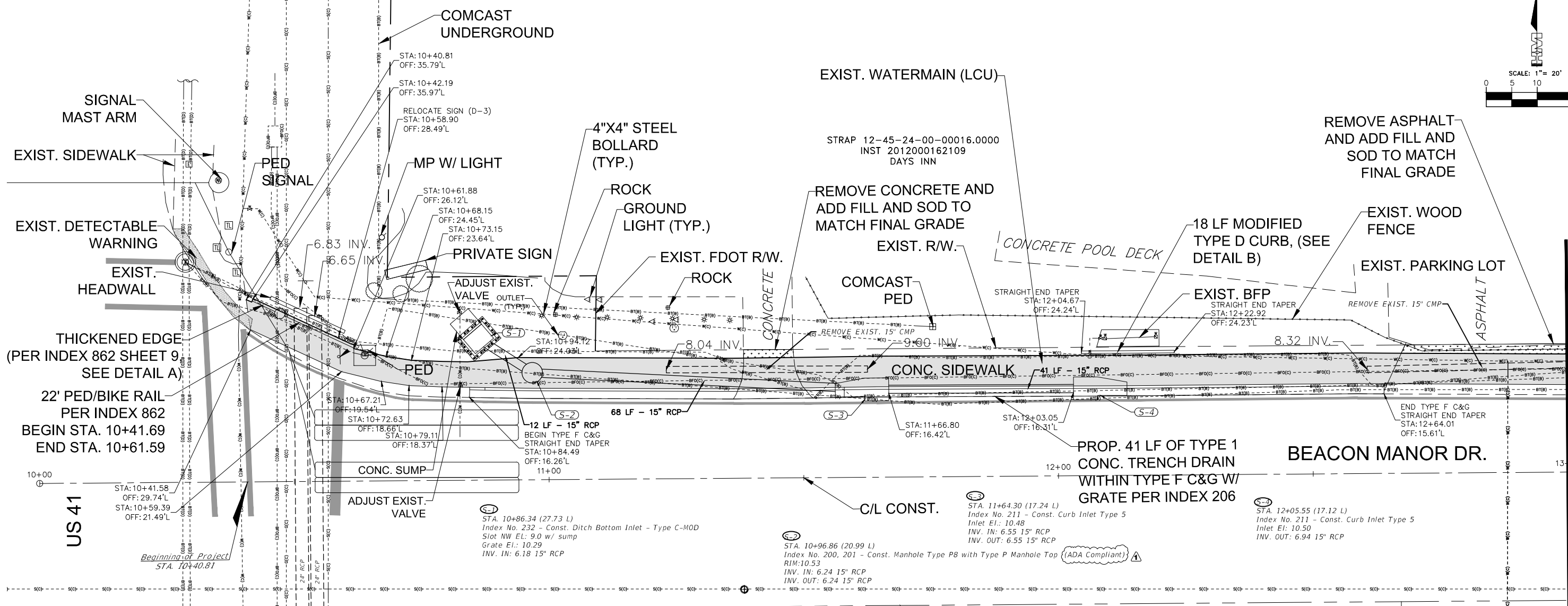
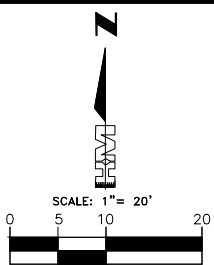

Matchline Sta. 13+00

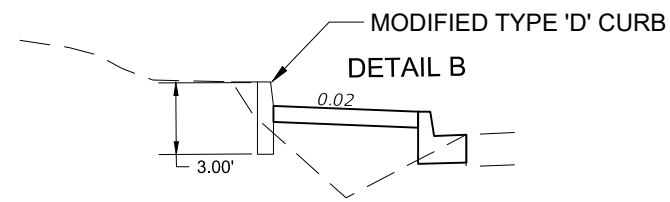
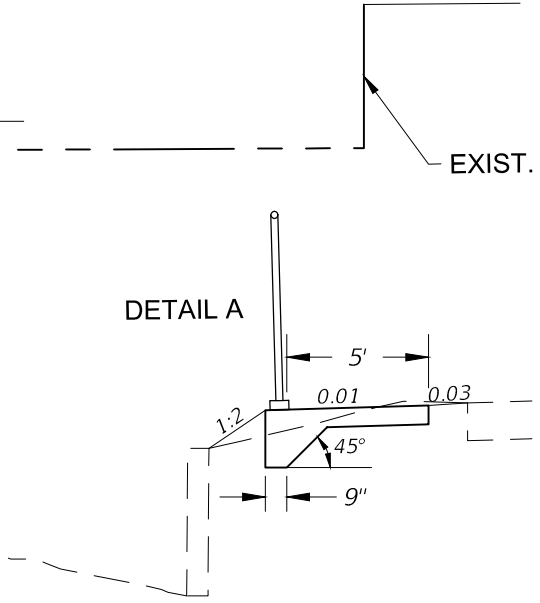

LEGEND

CONCRETE

BID DOCUMENTS 1/30/2019

LETTER	REVISIONS	DATE
	LDO COMMENTS	07/17/18

**Beacon Manor Drive
Sidewalk Improvements**



ROBERT L. MURRAY, P.E.
P.E. NO.: 35826
HOLE MONTES, INC.
6200 WHISKEY CREEK DRIVE
FORT MYERS, FL. 33919
CERTIFICATE OF AUTHORIZATION No.1772

**BEACON MANOR DRIVE
SIDEWALK IMPROVEMENT PLAN**

CAD FILE NAME:	DRAWING NO.:
16072PLAN	P1
PROJECT NO.:	SHEET NO.:
2016072	9

NOTICE: THE OFFICIAL RECORD OF THIS SHEET IS THE ELECTRONIC FILE DIGITALLY SIGNED AND SEALED UNDER RULE 61G15-23.004, F.A.C.

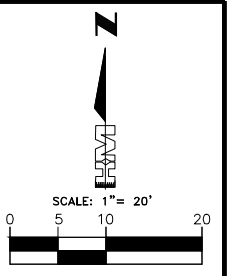

STRAP 12-45-24-00-00016.0000
 INST 2012000162109
 DAYS INN

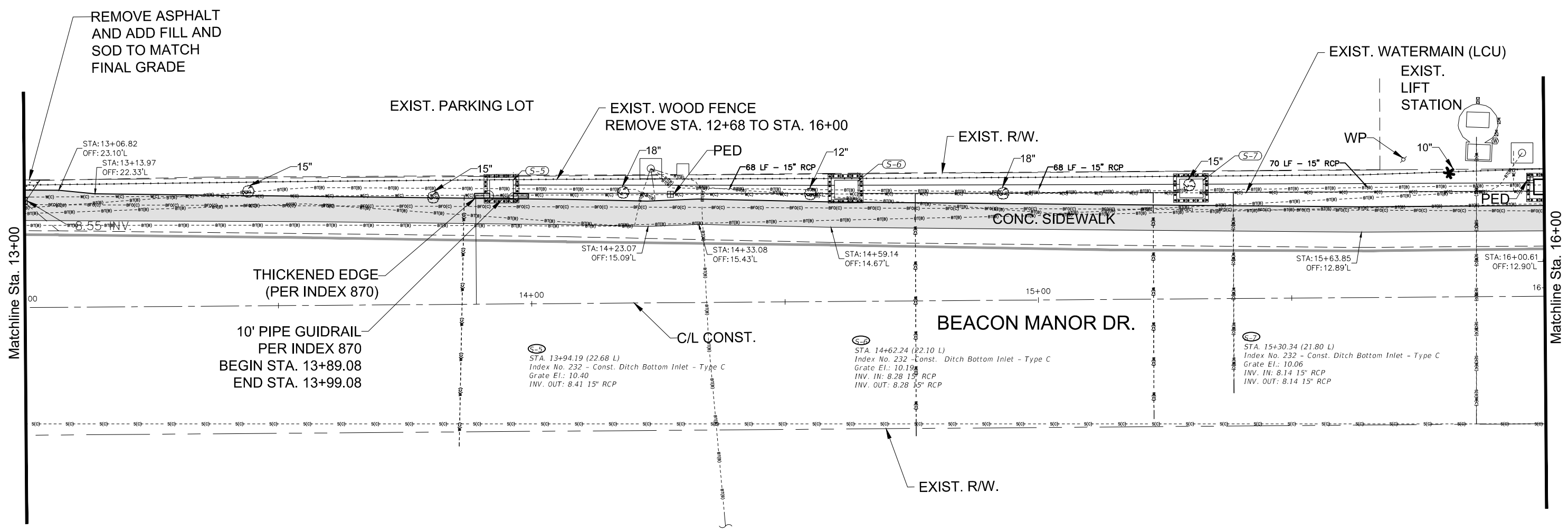

STRAP 12-45-24-00-00013.0000
 INST 2007000250779
 PARCEL 2.1, 2.2 & 2.3
 WAREHOUSING, DISTRIBUTION

LEGEND

CONCRETE

BID DOCUMENTS 1/30/2019

H:\2016\2016072\DW\TR\SHEET FILES\009 - BEACON MANOR PLAN SHEETS.dwg Tab: P2 Jan 28, 2019 - 4:39pm

NOTICE: THE OFFICIAL RECORD OF THIS SHEET IS THE ELECTRONIC FILE DIGITALLY SIGNED AND SEALED UNDER RULE 61G15-23.004, F.A.C.

LETTER	REVISIONS	DATE

*Beacon Manor Drive
 Sidewalk Improvements*



ROBERT L. MURRAY, P.E.
 P.E. NO.: 35826
 HOLE MONTES, INC.
 6200 WHISKEY CREEK DRIVE
 FORT MYERS, FL. 33919
 CERTIFICATE OF AUTHORIZATION No.1772

**BEACON MANOR DRIVE
 SIDEWALK IMPROVEMENT PLAN**

CAD FILE NAME: 16072PLAN	DRAWING NO.: P2
PROJECT NO.: 2016072	SHEET NO.: 10

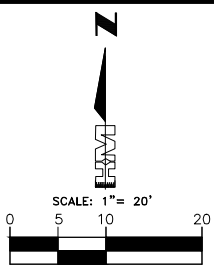

STRAP 12-45-24-00-00016.0010
O.R. 1370 PG. 1187
WAREHOUSING, DISTRIBUTION

STRAP 12-45-24-00-00016.0050
INST 2007000250779
PARCEL 3.1 & 3.2
WAREHOUSING, DISTRIBUTION

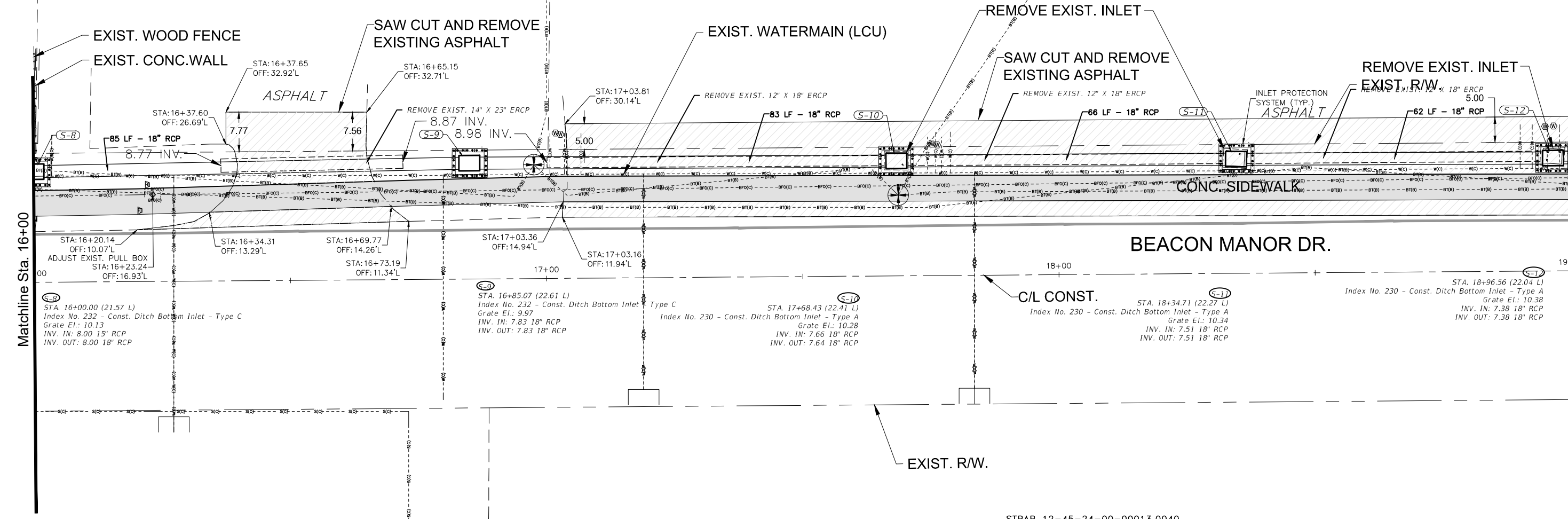

STRAP 12-45-24-00-00013.0000
INST 2007000250779
PARCEL 2.1, 2.2 & 2.3
WAREHOUSING, DISTRIBUTION

STRAP 12-45-24-00-00013.0040
INST 2007000250779
PARCEL 4
WAREHOUSING, DISTRIBUTION

LEGEND

- CONCRETE
- ASPHALT DRIVE

BID DOCUMENTS 1/30/2019

H:\2016\2016072\DW\TR\SHEET FILES\009 - BEACON MANOR PLAN SHEETS.dwg Tab: P3 Jan 28, 2019 - 4:41pm

NOTICE: THE OFFICIAL RECORD OF THIS SHEET IS THE ELECTRONIC FILE DIGITALLY SIGNED AND SEALED UNDER RULE 61G15-23.004, F.A.C.

LETTER	REVISIONS	DATE

**Beacon Manor Drive
Sidewalk Improvements**



ROBERT L. MURRAY, P.E.
P.E. NO.: 35826
HOLE MONTES, INC.
6200 WHISKEY CREEK DRIVE
FORT MYERS, FL. 33919
CERTIFICATE OF AUTHORIZATION No.1772

**BEACON MANOR DRIVE
SIDEWALK IMPROVEMENT PLAN**

CAD FILE NAME: 16072PLAN	DRAWING NO.: P3
PROJECT NO.: 2016072	SHEET NO.: 11

H:\2016\2016072\DW\TR\SHEET FILES\009 -- BEACON MANOR PLAN SHEETS.dwg Tab: P4 Jan 28, 2019 -- 4:42pm

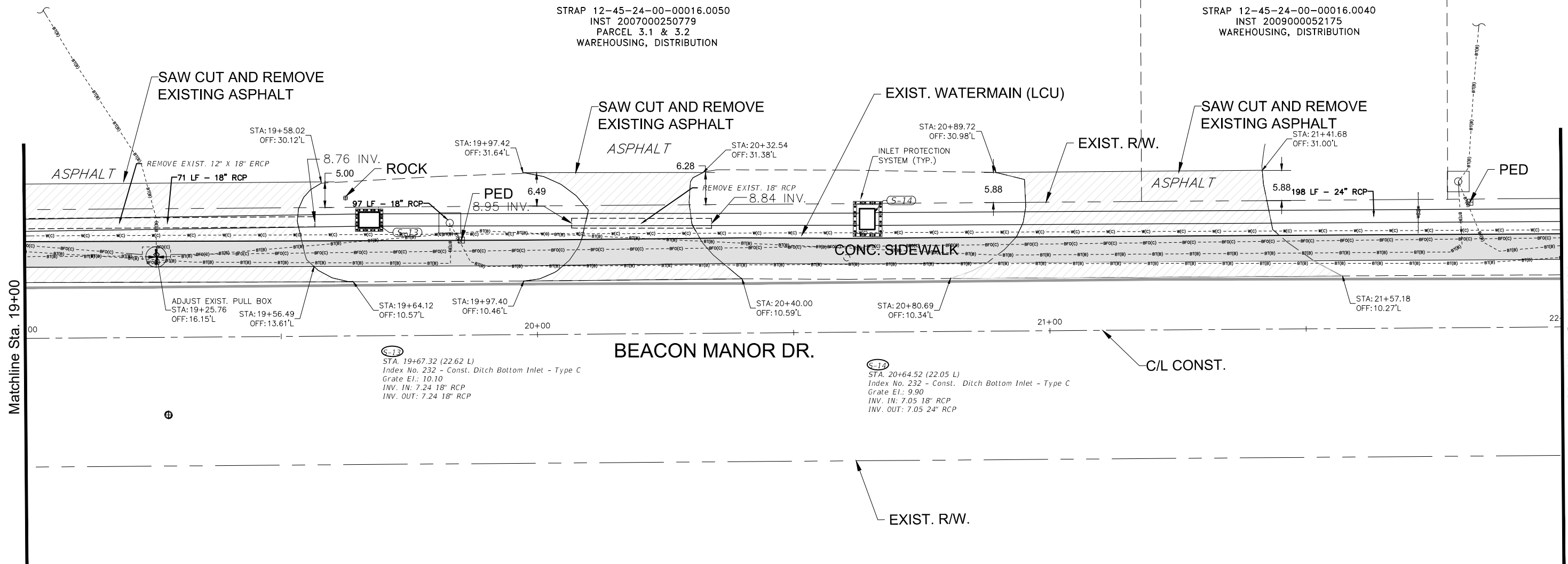
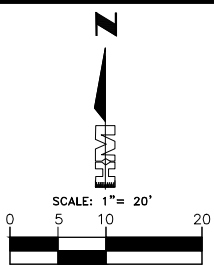

STRAP 12-45-24-00-00016.0050
INST 2007000250779
PARCEL 3.1 & 3.2
WAREHOUSING, DISTRIBUTION

STRAP 12-45-24-00-00016.0040
INST 2009000052175
WAREHOUSING, DISTRIBUTION

BEACON MANOR DR.

STRAP 12-45-24-00-00013.0040
INST 2007000250779
PARCEL 4
WAREHOUSING, DISTRIBUTION

LEGEND

- CONCRETE
- ASPHALT DRIVE

BID DOCUMENTS 1/30/2019

LETTER	REVISIONS	DATE

*Beacon Manor Drive
Sidewalk Improvements*



ROBERT L. MURRAY, P.E.
P.E. NO.: 35826
HOLE MONTES, INC.
6200 WHISKEY CREEK DRIVE
FORT MYERS, FL. 33919
CERTIFICATE OF AUTHORIZATION No.1772

**BEACON MANOR DRIVE
SIDEWALK IMPROVEMENT PLAN**

CAD FILE NAME: 16072PLAN	DRAWING NO.: P4
PROJECT NO.: 2016072	SHEET NO.: 12

NOTICE: THE OFFICIAL RECORD OF THIS SHEET IS THE ELECTRONIC FILE DIGITALLY SIGNED AND SEALED UNDER RULE 61G15-23.004, F.A.C.

H:\2016\2016072\DW\TR\SHEET FILES\009 - BEACON MANOR PLAN SHEETS.dwg Tab: P5 Jan 28, 2019 - 4:43pm

Matchline Sta. 22+00

STRAP 12-45-24-00-00016.0030
INST 2008000150636
WAREHOUSING, DISTRIBUTION

7 LF PIPE GUIDRAIL
THICKENED EDGE
(PER INDEX 870)
BEGIN STA. 22+59.37
END STA. 22+66.37

EXIST. WATERMAIN (LCU)
SAW CUT AND REMOVE
EXISTING ASPHALT

ASPHALT
108 LF - 24" RCP

34 LF STAKED
TURBIDITY BARRIER

15 LF - 24" RCP

12" WHITE
711-11-123

24" WHITE
711-11-125

DETECTABLE
WARNING (527-2)
TYP.

REMOVE EXIST. STOPBAR
AND CONFLICTING STRIPING

PED

BEACON MANOR DR.

C/L CONST.

EXIST. R.W.

S-15
STA: 22+62.25 (21.73 L)
Index No. 232 - Const. Ditch Bottom Inlet - Type C
Grate El.: 10.24
INV. IN: 5.61 24" RCP
INV. OUT: 5.61 24" RCP

S-16
STA: 23+70.40 OFF: -24.12L
Index No. 200, 201 - Const. Type P Manhole With Type P Manhole Top
RIM El.: 9.70
INV. IN: 5.07 24"
INV. OUT: 5.07 24"

S-17
STA: 23+79.87 (35.35 L)
Index No. 273 - Side Drain MES - Single Round Conc. Pipe
INV. IN: 5.00 24" RCP

STRAP 12-45-24-00-00013.0040
INST 2007000250779
PARCEL 4
WAREHOUSING, DISTRIBUTION

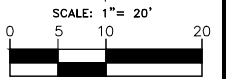

LEGEND

- REMOVE ASPH./CONC.
REPLACE W/ SOD
- CONCRETE
- ASPHALT DRIVE

BID DOCUMENTS 1/30/2019

LETTER	REVISIONS	DATE

**Beacon Manor Drive
Sidewalk Improvements**



ROBERT L. MURRAY, P.E.
P.E. NO.: 35826
HOLE MONTES, INC.
6200 WHISKEY CREEK DRIVE
FORT MYERS, FL. 33919
CERTIFICATE OF AUTHORIZATION No.1772

**BEACON MANOR DRIVE
SIDEWALK IMPROVEMENT PLAN**

CAD FILE NAME: 16072PLAN	DRAWING NO.: P5
PROJECT NO.: 2016072	SHEET NO.: 13

NOTICE: THE OFFICIAL RECORD OF THIS SHEET IS THE ELECTRONIC FILE DIGITALLY SIGNED AND SEALED UNDER RULE 61G15-23.004, F.A.C.

H:\2016\2016072\DW\TR\SHEET FILES\014 - BEACON MANOR GRADING SHEETS.dwg Tab: GR1 Jan 28, 2019 -- 4:48pm

EXIST. SIDEWALK
EXIST. DETECTABLE
WARNING

EXIST. FDOT R/W.

EXIST. R/W.

CONCRETE

US 41

BEACON MANOR DR.

11+00

C/L CONST.

*Beginning of Project
STA. 10+40.81*

EXIST. R/W.

EXIST. FDOT R/W.

LEGEND

CONCRETE SIDEWALK

BID DOCUMENTS 1/30/2019

CAD FILE NAME:	DRAWING NO.:
16072GRADING	GR1
PROJECT NO.:	SHEET NO.:
2016072	14

**Beacon Manor Drive
Sidewalk Improvements**



ROBERT L. MURRAY, P.E.
P.E. NO.: 35826
HOLE MONTES, INC.
6200 WHISKEY CREEK DRIVE
FORT MYERS, FL. 33919
CERTIFICATE OF AUTHORIZATION No.1772

**BEACON MANOR DRIVE
GRADING PLAN**

Matchline Sta. 11+50

NOTICE: THE OFFICIAL RECORD OF THIS SHEET IS THE ELECTRONIC FILE DIGITALLY SIGNED AND SEALED UNDER RULE 61G15-23.004, F.A.C.

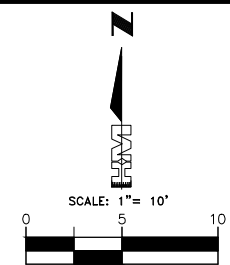

LETTER	REVISIONS	DATE

H:\2016\2016072\DW\TR\SHEET FILES\014 - BEACON MANOR GRADING SHEETS.dwg Tab: GR2 Jan 28, 2019 -- 4:48pm

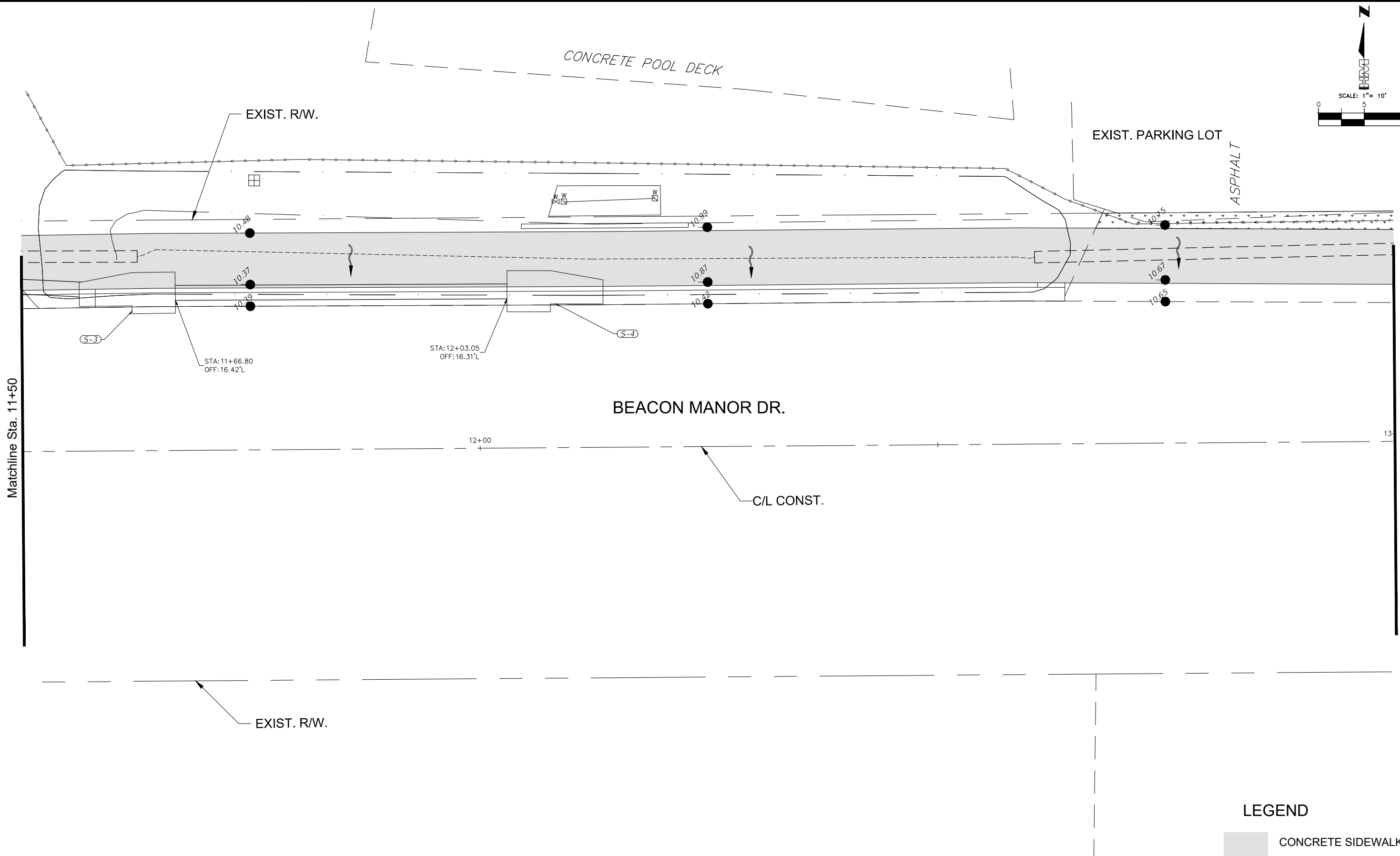
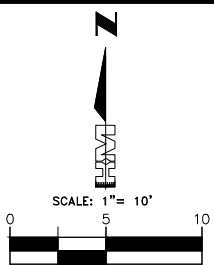

LEGEND

 CONCRETE SIDEWALK

BID DOCUMENTS 1/30/2019

LETTER	REVISIONS	DATE

*Beacon Manor Drive
Sidewalk Improvements*



ROBERT L. MURRAY, P.E.
P.E. NO.: 35826
HOLE MONTES, INC.
6200 WHISKEY CREEK DRIVE
FORT MYERS, FL. 33919
CERTIFICATE OF AUTHORIZATION No.1772

**BEACON MANOR DRIVE
GRADING PLAN**

CAD FILE NAME: 16072GRADING	DRAWING NO.: GR2
PROJECT NO.: 2016072	SHEET NO.: 15

NOTICE: THE OFFICIAL RECORD OF THIS SHEET IS THE ELECTRONIC FILE DIGITALLY SIGNED AND SEALED UNDER RULE 61G15-23.004, F.A.C.

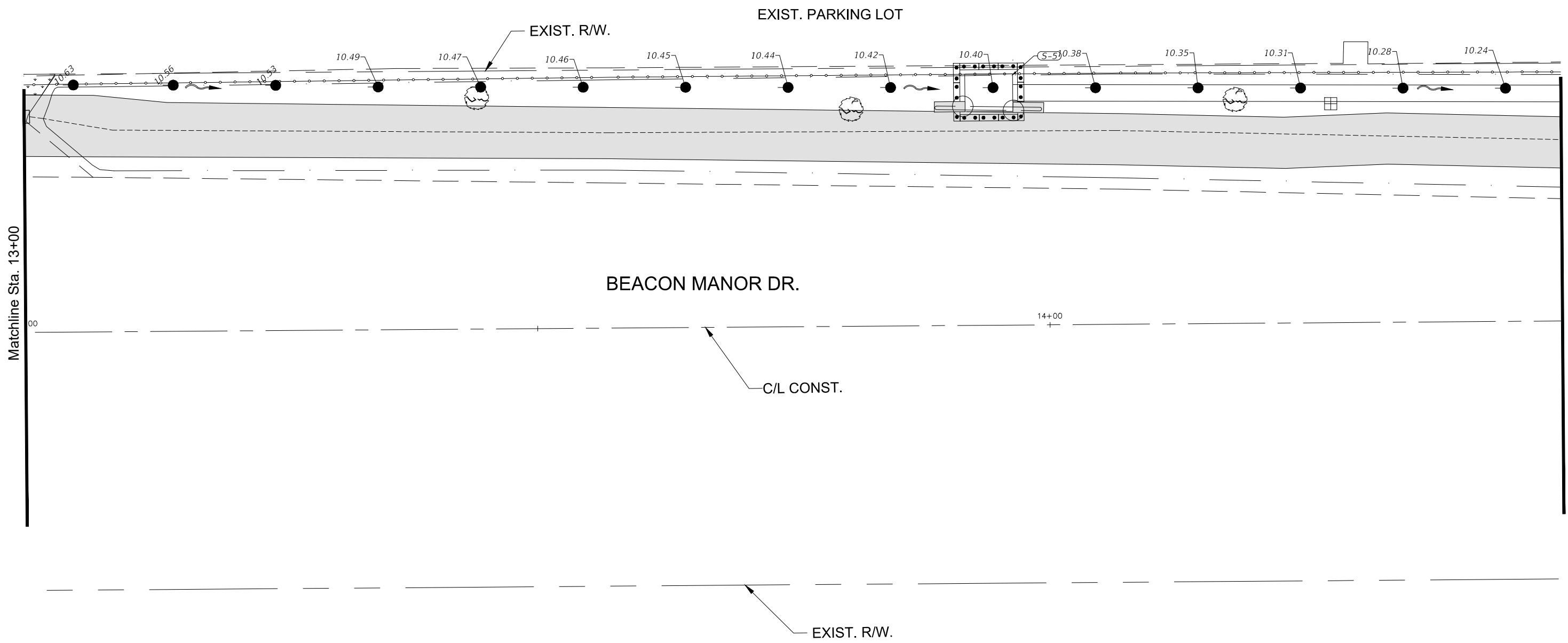
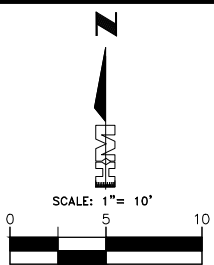

LEGEND

CONCRETE SIDEWALK

BID DOCUMENTS 1/30/2019

H:\2016\2016072\DW\TR\SHEET FILES\014 - BEACON MANOR GRADING SHEETS.dwg Tab: GR3 Jan 28, 2019 -- 4:49pm

NOTICE: THE OFFICIAL RECORD OF THIS SHEET IS THE ELECTRONIC FILE DIGITALLY SIGNED AND SEALED UNDER RULE 61G15-23.004, F.A.C.

LETTER	REVISIONS	DATE

*Beacon Manor Drive
Sidewalk Improvements*



ROBERT L. MURRAY, P.E.
P.E. NO.: 35826
HOLE MONTES, INC.
6200 WHISKEY CREEK DRIVE
FORT MYERS, FL. 33919
CERTIFICATE OF AUTHORIZATION No.1772

**BEACON MANOR DRIVE
GRADING PLAN**

CAD FILE NAME: 16072GRADING	DRAWING NO.: GR3
PROJECT NO.: 2016072	SHEET NO.: 16

H:\2016\2016072\DW\TR\SHEET FILES\014 - BEACON MANOR GRADING SHEETS.dwg Tab: GR4 Jan 28, 2019 -- 4:49pm

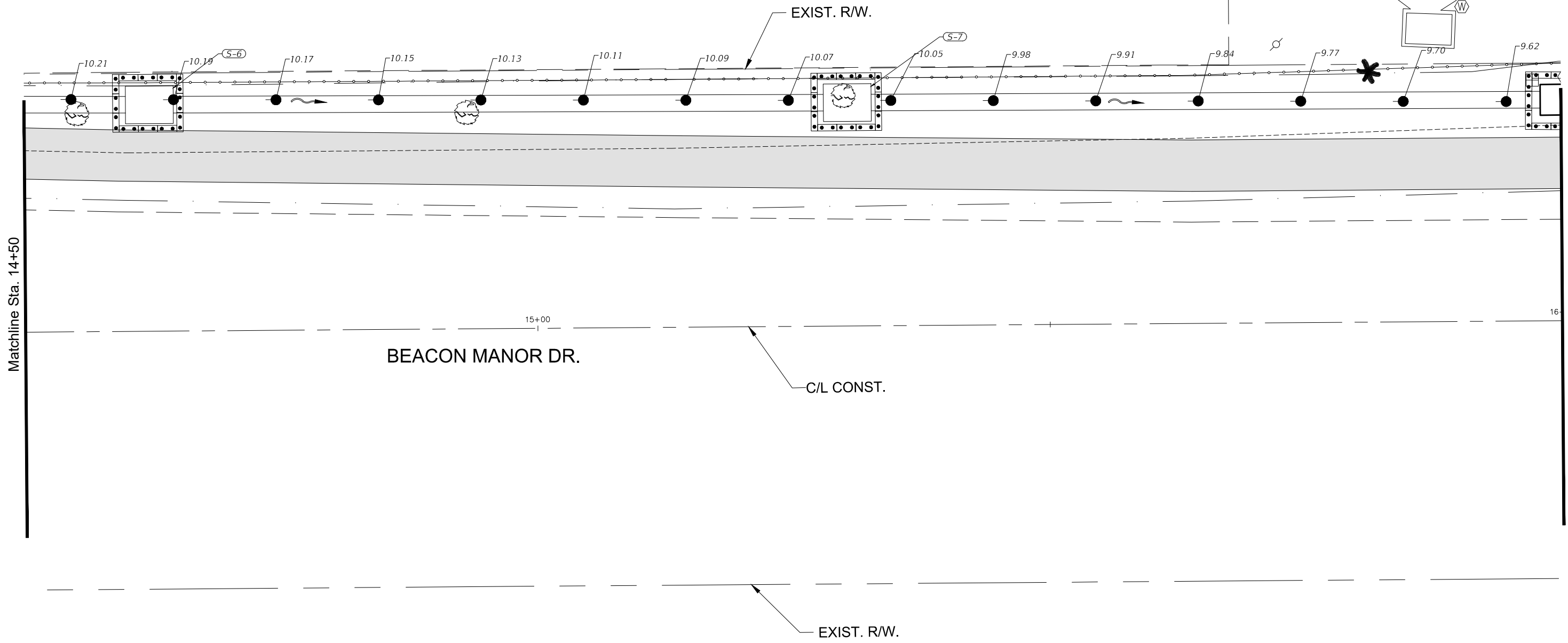
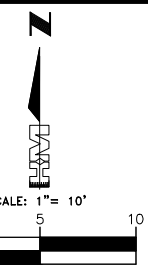

Matchline Sta. 14+50

Matchline Sta. 16+00

LEGEND

CONCRETE SIDEWALK

BID DOCUMENTS 1/30/2019

LETTER	REVISIONS	DATE

*Beacon Manor Drive
Sidewalk Improvements*



ROBERT L. MURRAY, P.E.
P.E. NO.: 35826
HOLE MONTES, INC.
6200 WHISKEY CREEK DRIVE
FORT MYERS, FL. 33919
CERTIFICATE OF AUTHORIZATION No.1772

**BEACON MANOR DRIVE
GRADING PLAN**



CAD FILE NAME: 16072GRADING	DRAWING NO.: GR4
PROJECT NO.: 2016072	SHEET NO.: 17

NOTICE: THE OFFICIAL RECORD OF THIS SHEET IS THE ELECTRONIC FILE DIGITALLY SIGNED AND SEALED UNDER RULE 61G15-23.004, F.A.C.

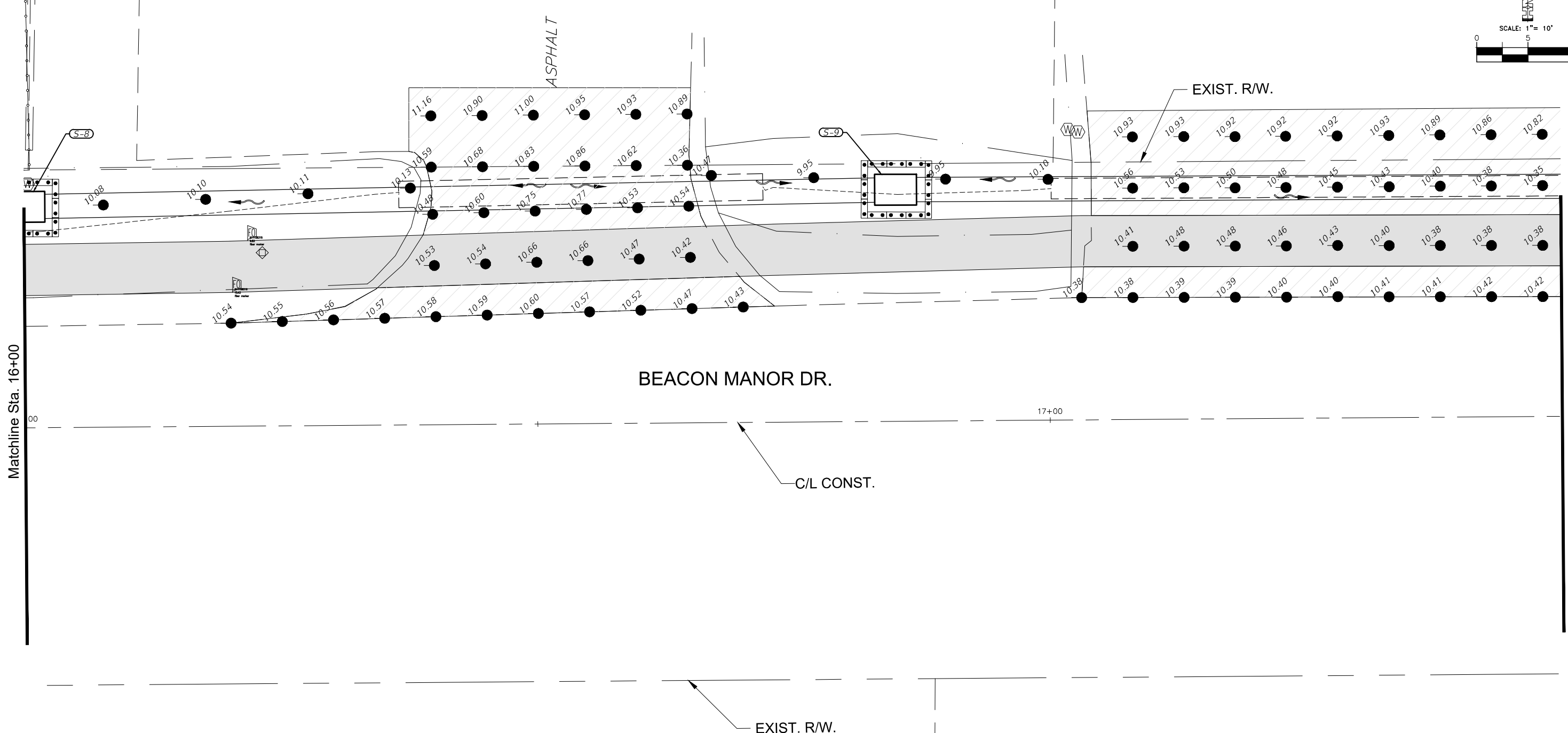
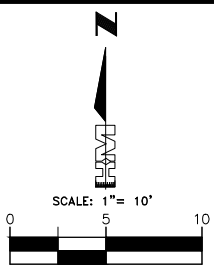
H:\2016\2016072\DW\TR\SHEET FILES\014 - BEACON MANOR GRADING SHEETS.dwg Tab: GR5 Jan 28, 2019 -- 4:50pm

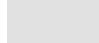

LEGEND

-  CONCRETE SIDEWALK
-  ASPHALT DRIVE

BID DOCUMENTS 1/30/2019

LETTER	REVISIONS	DATE

*Beacon Manor Drive
Sidewalk Improvements*



ROBERT L. MURRAY, P.E.
P.E. NO.: 35826
HOLE MONTES, INC.
6200 WHISKEY CREEK DRIVE
FORT MYERS, FL. 33919
CERTIFICATE OF AUTHORIZATION No.1772

**BEACON MANOR DRIVE
GRADING PLAN**



CAD FILE NAME: 16072GRADING	DRAWING NO.: GR5
PROJECT NO.: 2016072	SHEET NO.: 18

NOTICE: THE OFFICIAL RECORD OF THIS SHEET IS THE ELECTRONIC FILE DIGITALLY SIGNED AND SEALED UNDER RULE 61G15-23.004, F.A.C.

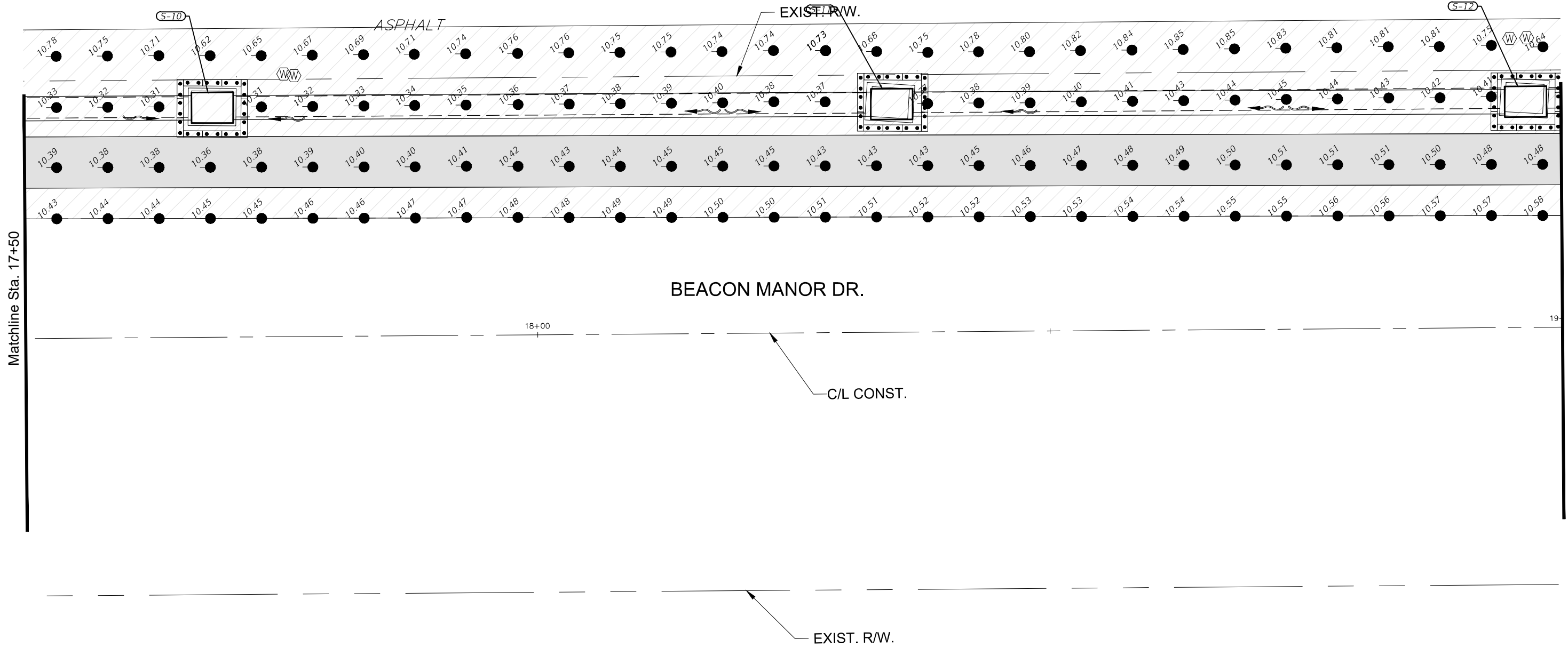
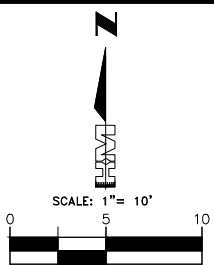
H:\2016\2016072\DW\TR\SHEET FILES\014 -- BEACON MANOR GRADING SHEETS.dwg Tab: GR6 Jan 28, 2019 -- 4:51pm



LEGEND

	CONCRETE SIDEWALK
	ASPHALT DRIVE

BID DOCUMENTS 1/30/2019

LETTER	REVISIONS	DATE

*Beacon Manor Drive
Sidewalk Improvements*



ROBERT L. MURRAY, P.E.
P.E. NO.: 35826
HOLE MONTES, INC.
6200 WHISKEY CREEK DRIVE
FORT MYERS, FL. 33919
CERTIFICATE OF AUTHORIZATION No.1772

**BEACON MANOR DRIVE
GRADING PLAN**

CAD FILE NAME: 16072GRADING	DRAWING NO.: GR6
PROJECT NO.: 2016072	SHEET NO.: 19

NOTICE: THE OFFICIAL RECORD OF THIS SHEET IS THE ELECTRONIC FILE DIGITALLY SIGNED AND SEALED UNDER RULE 61G15-23.004, F.A.C.

H:\2016\2016072\DW\TR\SHEET FILES\014 - BEACON MANOR GRADING SHEETS.dwg Tab: GR7 Jan 28, 2019 -- 4:51pm

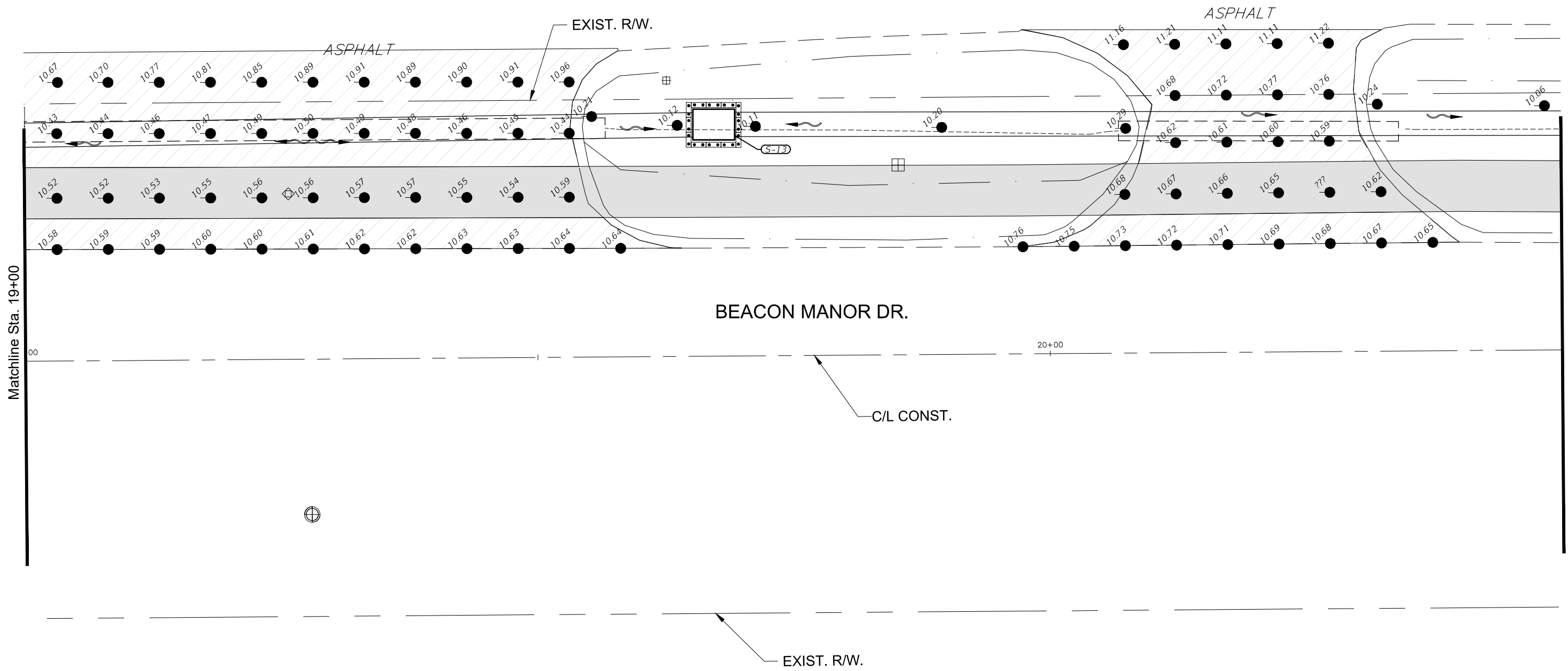
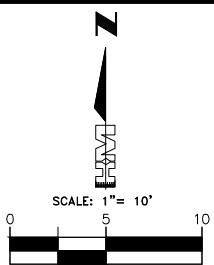

LEGEND

	CONCRETE SIDEWALK
	ASPHALT DRIVE

BID DOCUMENTS 1/30/2019

LETTER	REVISIONS	DATE

*Beacon Manor Drive
Sidewalk Improvements*



ROBERT L. MURRAY, P.E.
P.E. NO.: 35826
HOLE MONTES, INC.
6200 WHISKEY CREEK DRIVE
FORT MYERS, FL. 33919
CERTIFICATE OF AUTHORIZATION No.1772

**BEACON MANOR DRIVE
GRADING PLAN**

CAD FILE NAME: 16072GRADING	DRAWING NO.: GR7
PROJECT NO.: 2016072	SHEET NO.: 20

NOTICE: THE OFFICIAL RECORD OF THIS SHEET IS THE ELECTRONIC FILE DIGITALLY SIGNED AND SEALED UNDER RULE 61G15-23.004, F.A.C.

H:\2016\2016072\DW\TR\SHEET FILES\014 - BEACON MANOR GRADING SHEETS.dwg Tab: GR8 Jan 28, 2019 -- 4:52pm

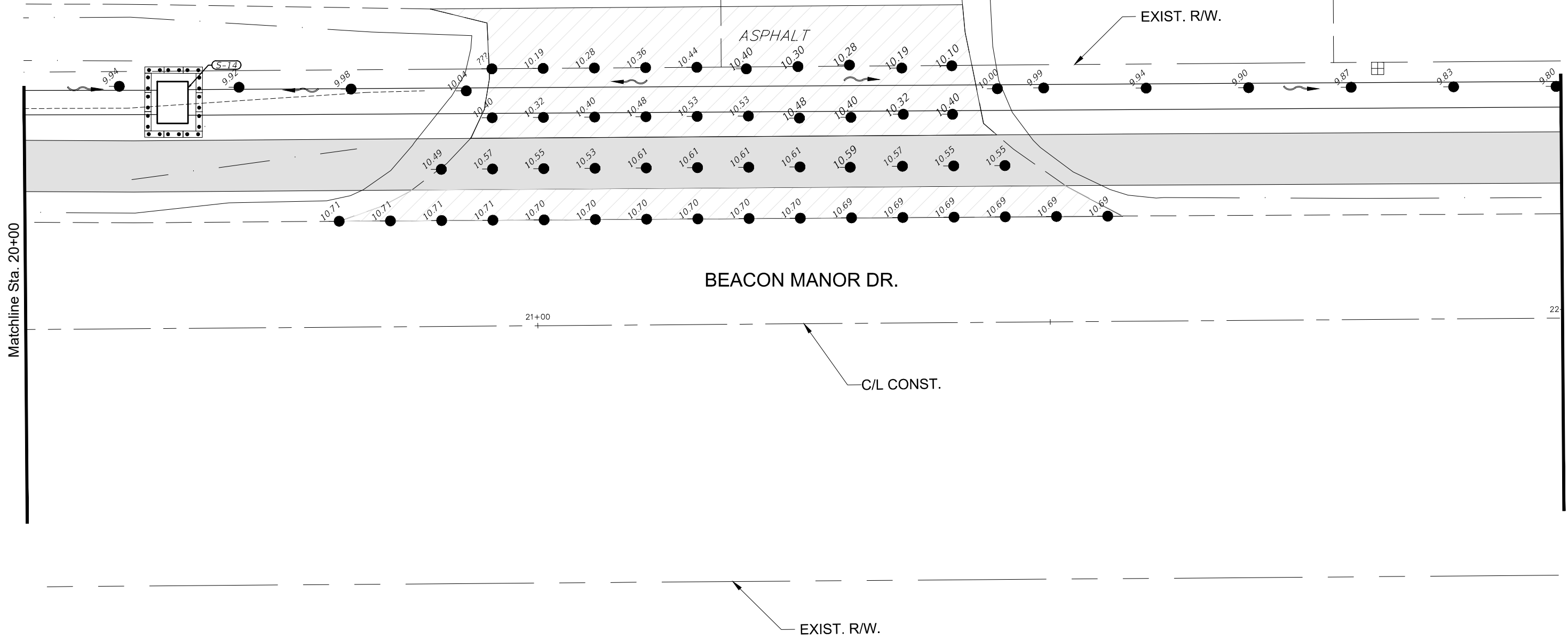
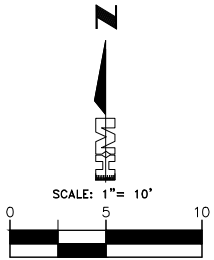

LEGEND

- CONCRETE SIDEWALK
- ASPHALT DRIVE

BID DOCUMENTS 1/30/2019

LETTER	REVISIONS	DATE

*Beacon Manor Drive
Sidewalk Improvements*



ROBERT L. MURRAY, P.E.
P.E. NO.: 35826
HOLE MONTES, INC.
6200 WHISKEY CREEK DRIVE
FORT MYERS, FL. 33919
CERTIFICATE OF AUTHORIZATION No.1772

**BEACON MANOR DRIVE
GRADING PLAN**

CAD FILE NAME: 16072GRADING	DRAWING NO.: GR8
PROJECT NO.: 2016072	SHEET NO.: 21

NOTICE: THE OFFICIAL RECORD OF THIS SHEET IS THE ELECTRONIC FILE DIGITALLY SIGNED AND SEALED UNDER RULE 61G15-23.004, F.A.C.

H:\2016\2016072\DW\TR\SHEET FILES\014 - BEACON MANOR GRADING SHEETS.dwg Tab: GR9 Jan 28, 2019 -- 4:52pm

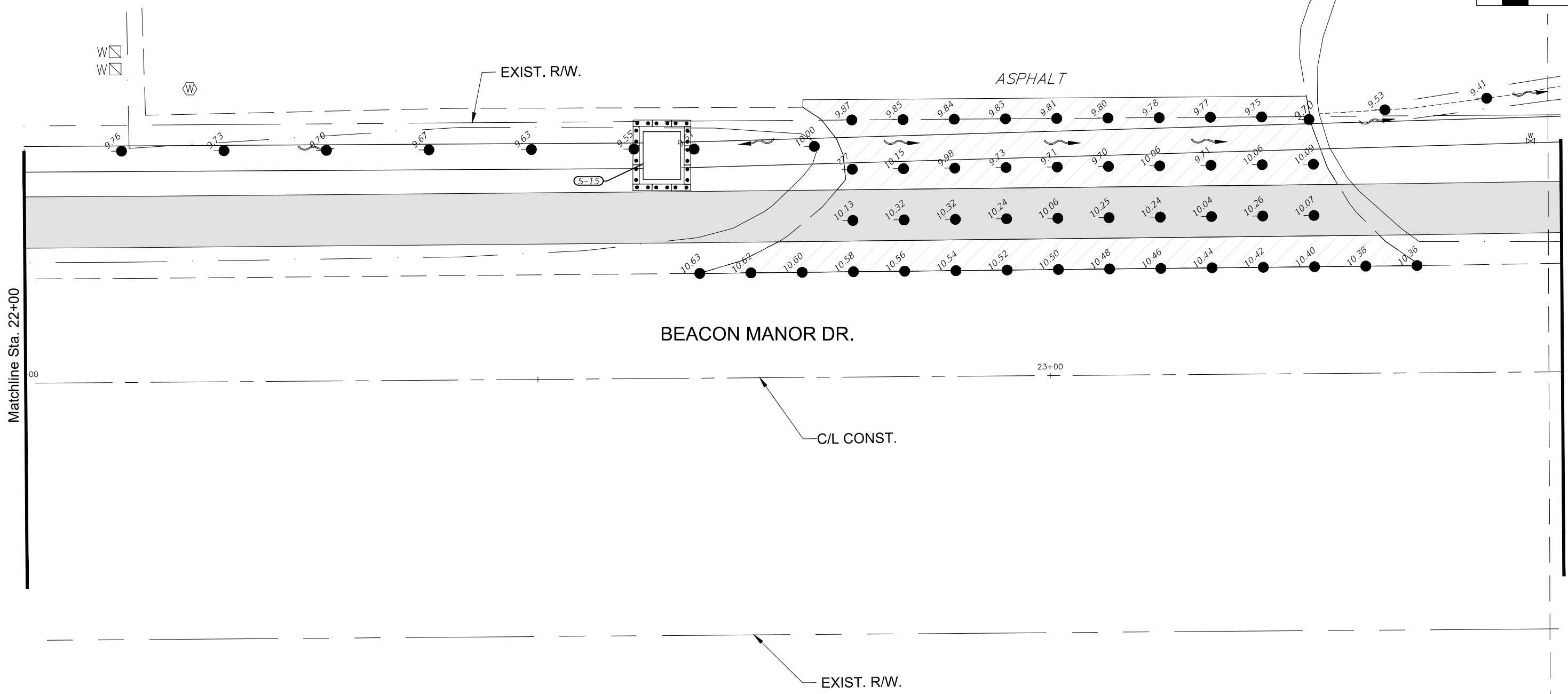
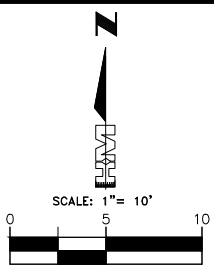

LEGEND

	CONCRETE SIDEWALK
	ASPHALT DRIVE

BID DOCUMENTS 1/30/2019

LETTER	REVISIONS	DATE

*Beacon Manor Drive
Sidewalk Improvements*



ROBERT L. MURRAY, P.E.
P.E. NO.: 35826
HOLE MONTES, INC.
6200 WHISKEY CREEK DRIVE
FORT MYERS, FL. 33919
CERTIFICATE OF AUTHORIZATION No.1772

**BEACON MANOR DRIVE
GRADING PLAN**



CAD FILE NAME: 16072GRADING	DRAWING NO.: GR9
PROJECT NO.: 2016072	SHEET NO.: 22

NOTICE: THE OFFICIAL RECORD OF THIS SHEET IS THE ELECTRONIC FILE DIGITALLY SIGNED AND SEALED UNDER RULE 61G15-23.004, F.A.C.

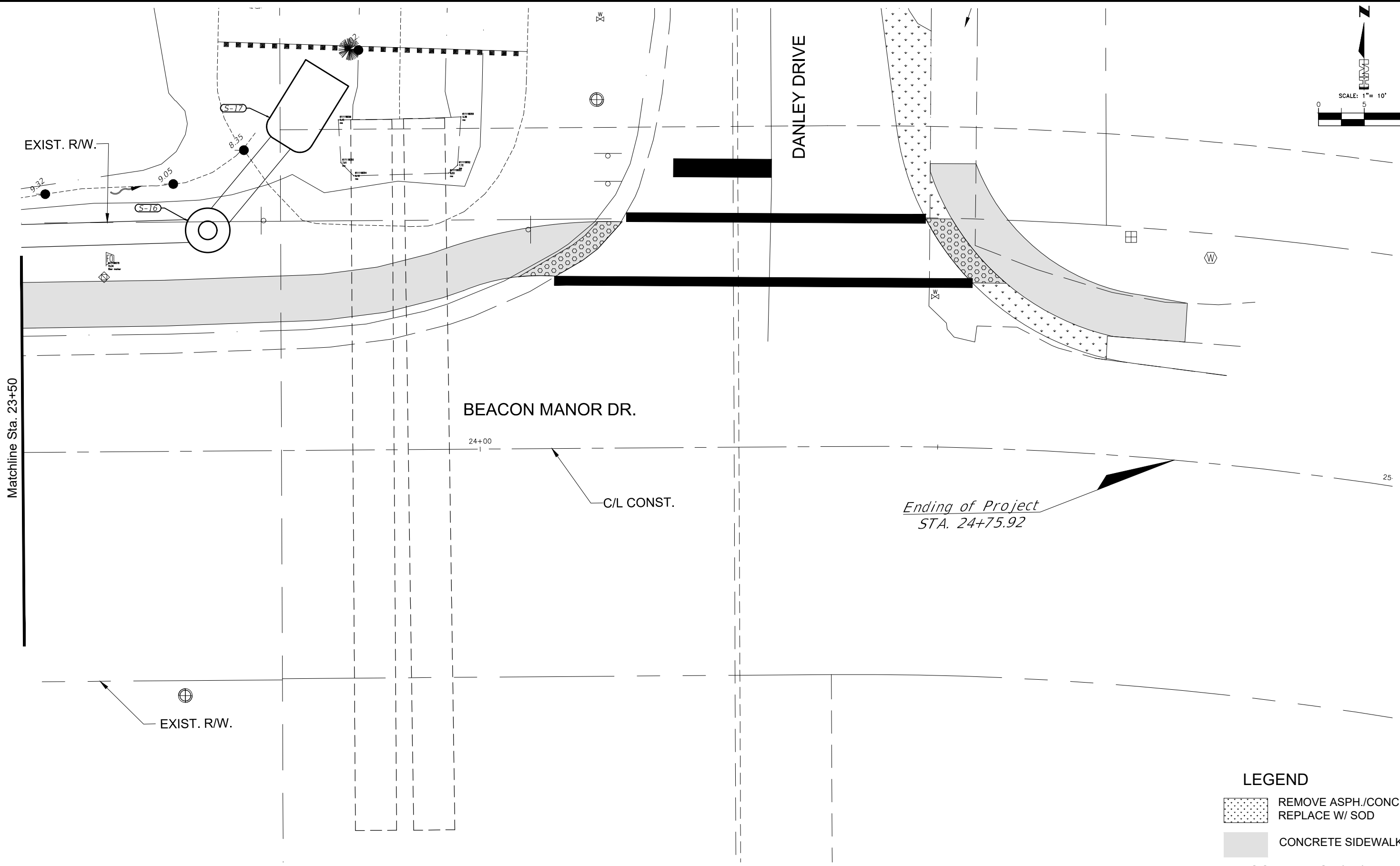
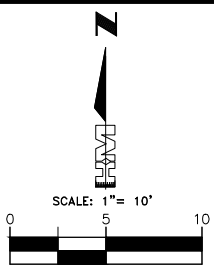
H:\2016\2016072\DW\TR\SHEET FILES\014 - BEACON MANOR GRADING SHEETS.dwg Tab: GR10 Jan 28, 2019 - 4:53pm

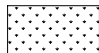

LEGEND

-  REMOVE ASPH./CONC.
REPLACE W/ SOD
-  CONCRETE SIDEWALK

BID DOCUMENTS 1/30/2019

LETTER	REVISIONS	DATE

*Beacon Manor Drive
Sidewalk Improvements*



ROBERT L. MURRAY, P.E.
P.E. NO.: 35826
HOLE MONTES, INC.
6200 WHISKEY CREEK DRIVE
FORT MYERS, FL. 33919
CERTIFICATE OF AUTHORIZATION No.1772

**BEACON MANOR DRIVE
GRADING PLAN**

CAD FILE NAME: 16072GRADING	DRAWING NO.: GR10
PROJECT NO.: 2016072	SHEET NO.: 23

NOTICE: THE OFFICIAL RECORD OF THIS SHEET IS THE ELECTRONIC FILE DIGITALLY SIGNED AND SEALED UNDER RULE 61G15-23.004, F.A.C.

H:\2016\2016072\DW\TR\SHEET FILES\024 - BEACON MANOR CROSS SECTIONS.dwg Tab: BEACON XS 1 Jan 28, 2019 - 4:56pm Plotted by: Kevin Payne

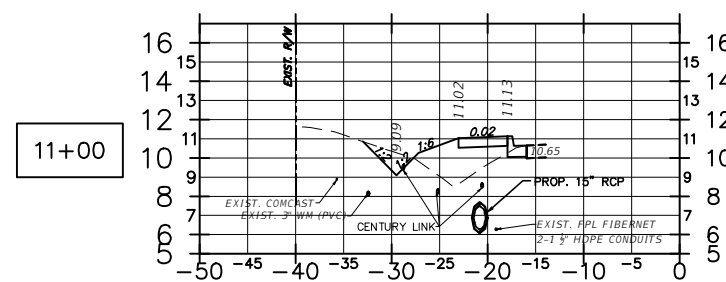
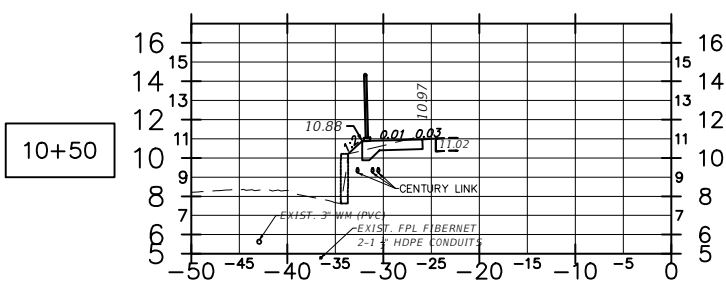
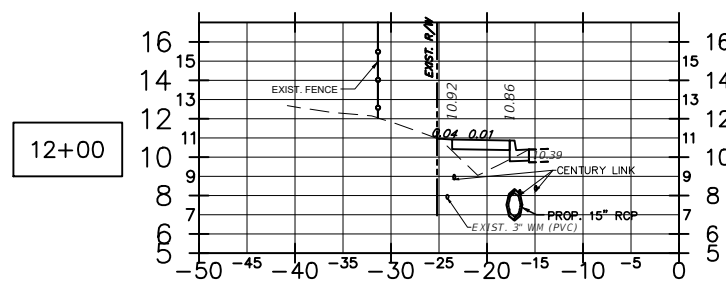
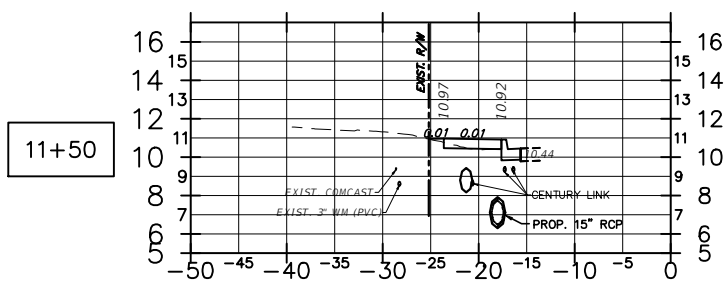
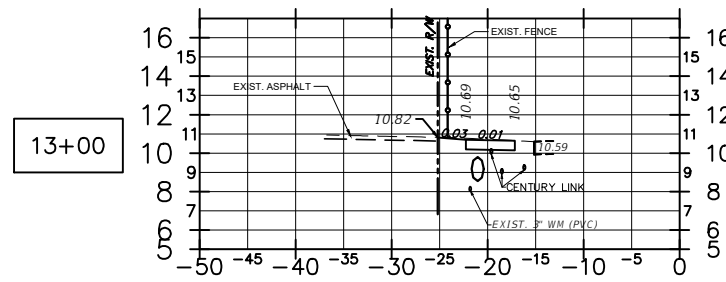
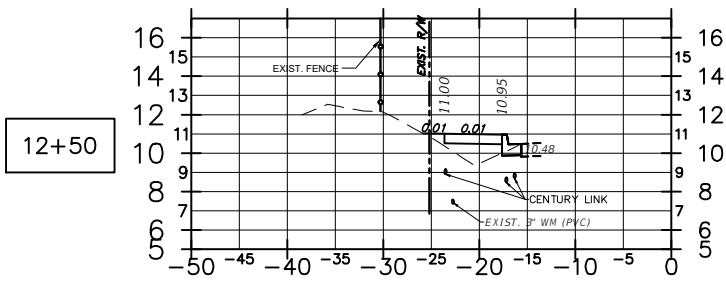
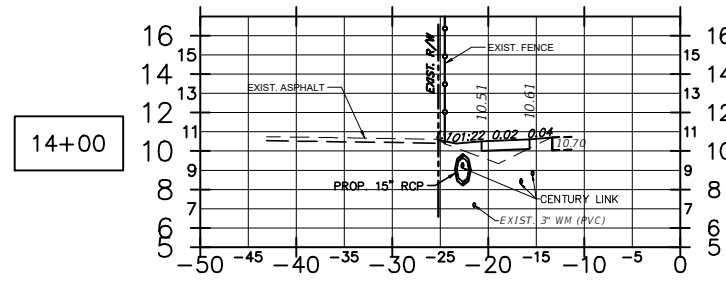
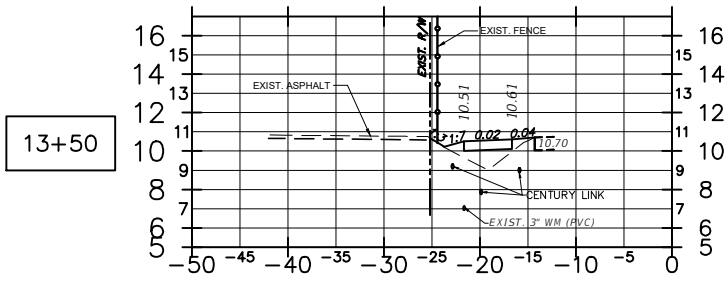

MATERIAL TYPE			
CUT		FILL	
A	V	A	V
0		4	
0	0	8	
0	5	5	
3		5	
3	0		
4		5	
1	5		
2	9		
1	5		
3	5		
2	1		
6	12		
4	12		
7	12		
4	1		
SHEET TOTAL		25	56

NOTICE: THE OFFICIAL RECORD OF THIS SHEET IS THE ELECTRONIC FILE DIGITALLY SIGNED AND SEALED UNDER RULE 61G15-23.004, F.A.C.

BID DOCUMENTS 1/30/2019

NUMBER	REVISIONS	DATE

Beacon Manor Drive
Sidewalk Improvements



SCALE: 1"=20' Horiz.
1"=10' Vert.



ROBERT L. MURRAY, P.E.
P.E. NO.: 35826
HOLE MONTES, INC.
6200 WHISKEY CREEK DRIVE
FORT MYERS, FL. 33919
CERTIFICATE OF AUTHORIZATION NO.1772

BEACON MANOR DRIVE
CROSS SECTIONS
STATION 10+50 TO 14+00

REFERENCE NO. 16072XS	DRAWING NO. XS
PROJECT NO. 2016072	SHEET NO. 24

H:\2016\2016072\DW\TR\SHEET FILES\024 - BEACON MANOR CROSS SECTIONS.dwg Tab: BEACON XS 2 Jan 28, 2019 - 4:57pm Plotted by: Kevin Payne

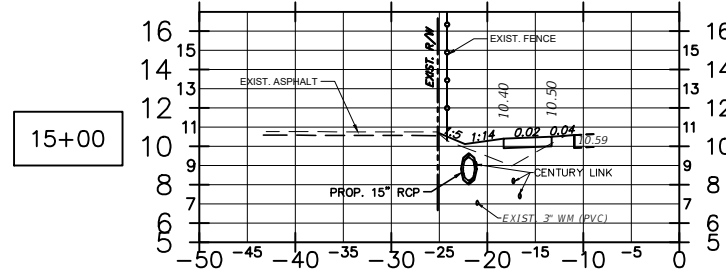
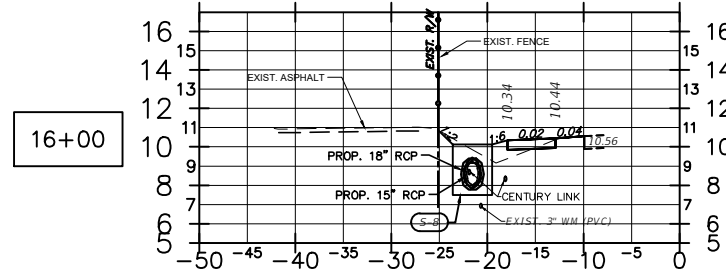
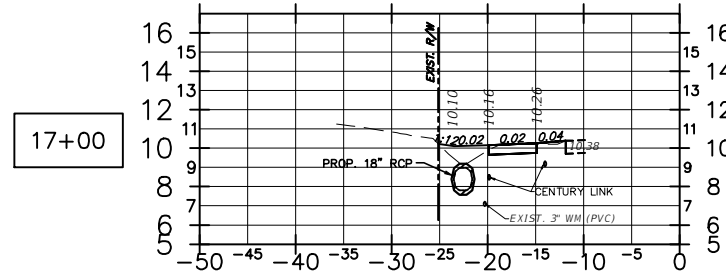
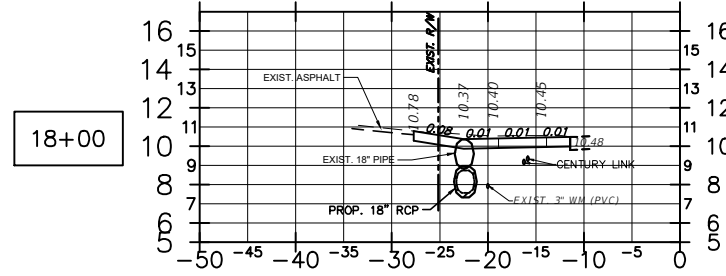
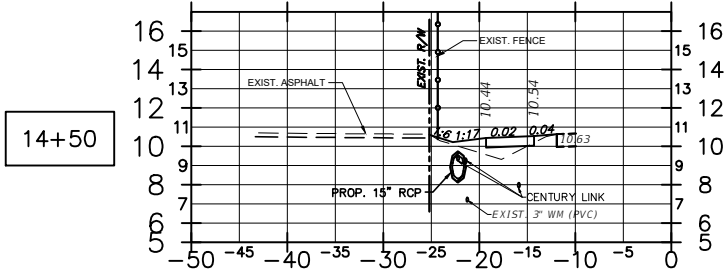
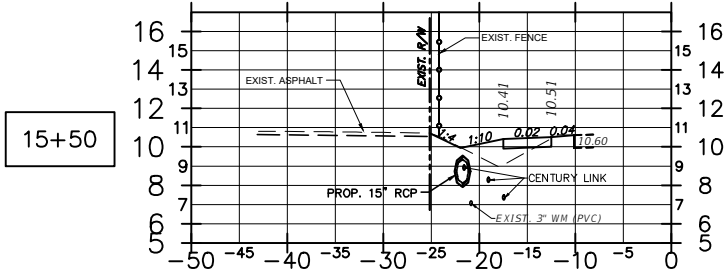
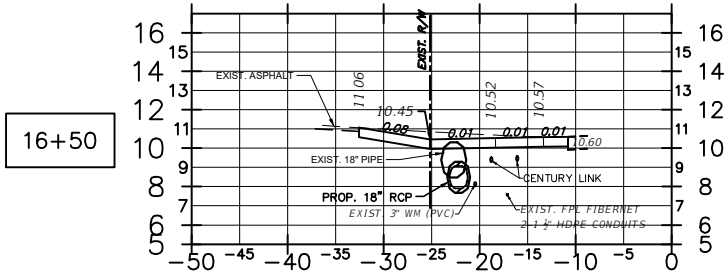
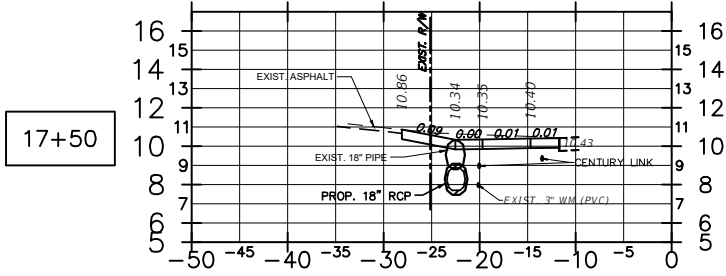

MATERIAL TYPE			
CUT		FILL	
A	V	A	V
10		0	
	19	0	
11		0	
	13	4	
3		4	
	17	4	
15		0	
	15	3	
1		3	
	2	7	
1		5	
	2	10	
1		6	
	2	9	
1		4	
	1	7	
SHEET TOTAL		71	44

NOTICE: THE OFFICIAL RECORD OF THIS SHEET IS THE ELECTRONIC FILE DIGITALLY SIGNED AND SEALED UNDER RULE 61G15-23.004, F.A.C.

NUMBER	REVISIONS	DATE

Beacon Manor Drive
Sidewalk Improvements



SCALE: 1"=20' Horiz.
1"=10' Vert.



ROBERT L. MURRAY, P.E.
P.E. NO.: 35826
HOLE MONTES, INC.
6200 WHISKEY CREEK DRIVE
FORT MYERS, FL. 33919
CERTIFICATE OF AUTHORIZATION NO.1772

BID DOCUMENTS 1/30/2019

BEACON MANOR DRIVE
CROSS SECTIONS
STATION 14+50 TO 18+00

REFERENCE NO. 16072XS	DRAWING NO. XS
PROJECT NO. 2016072	SHEET NO. 25

H:\2016\2016072\DW\TR\SHEET FILES\024 - BEACON MANOR CROSS SECTIONS.dwg Tab: BEACON XS 3 Jan 28, 2019 - 4:58pm Plotted by: Kevin Payne

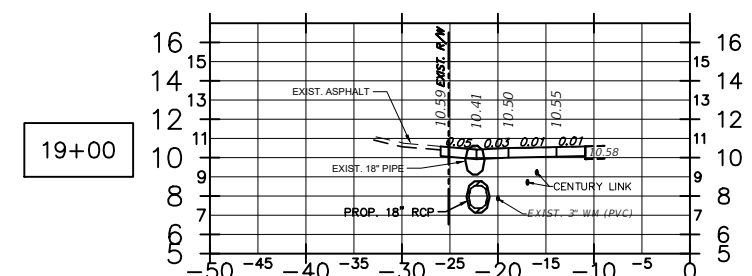
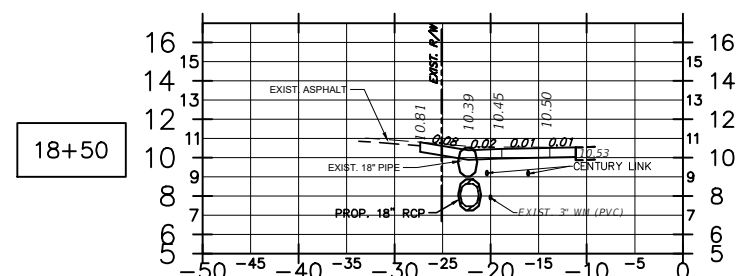
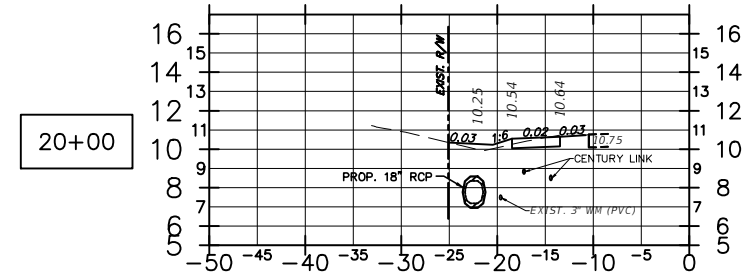
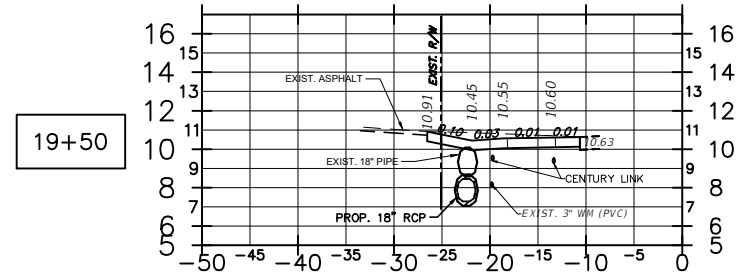
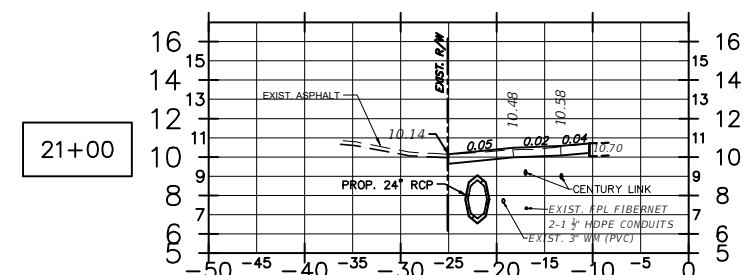
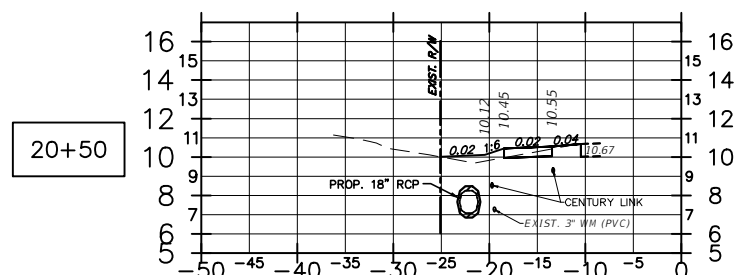
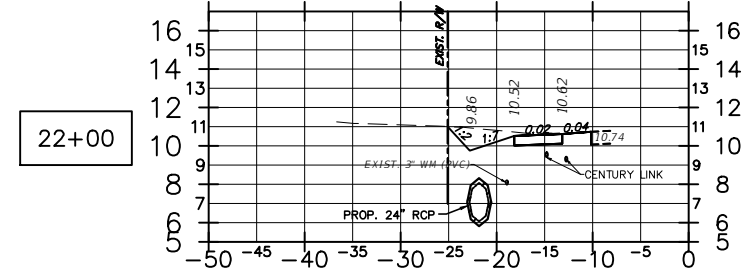
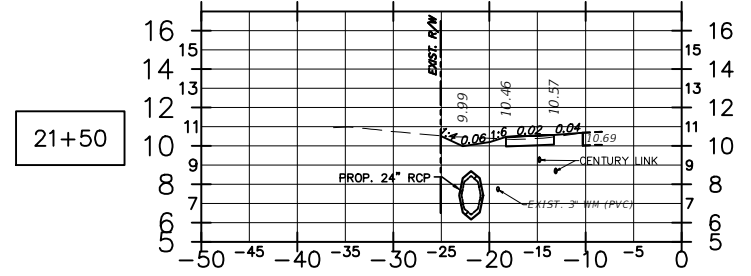

MATERIAL TYPE			
CUT		FILL	
A	V	A	V
8	0	0	0
4	11	1	1
9	1	1	1
6	0	0	0
1	6	3	3
4	1	3	3
3	4	5	5
11	3	2	2
18	13	2	2
8	11	0	0
10	18	0	0
19	8	0	0
19	10	0	0
97	19	0	0
12	12	0	0

SHEET TOTAL

NUMBER	REVISIONS	DATE

Beacon Manor Drive
Sidewalk Improvements



SCALE: 1"=20' Horiz.
1"=10' Vert.



ROBERT L. MURRAY, P.E.
P.E. NO.: 35826
HOLE MONTES, INC.
6200 WHISKEY CREEK DRIVE
FORT MYERS, FL. 33919
CERTIFICATE OF AUTHORIZATION NO.1772

BEACON MANOR DRIVE
CROSS SECTIONS
STATION 18+50 TO 22+00

REFERENCE NO. 16072XS	DRAWING NO. XS
PROJECT NO. 2016072	SHEET NO. 26

BID DOCUMENTS 1/30/2019

NOTICE: THE OFFICIAL RECORD OF THIS SHEET IS THE ELECTRONIC FILE DIGITALLY SIGNED AND SEALED UNDER RULE 61G15-23.004, F.A.C.

