

*LEE COUNTY*  
*DEPARTMENT OF TRANSPORTATION*

*ORTIZ AVENUE WIDENING*

FROM SR 884 TO SR 82

LEE COUNTY  
COUNTY ROAD NO. 865

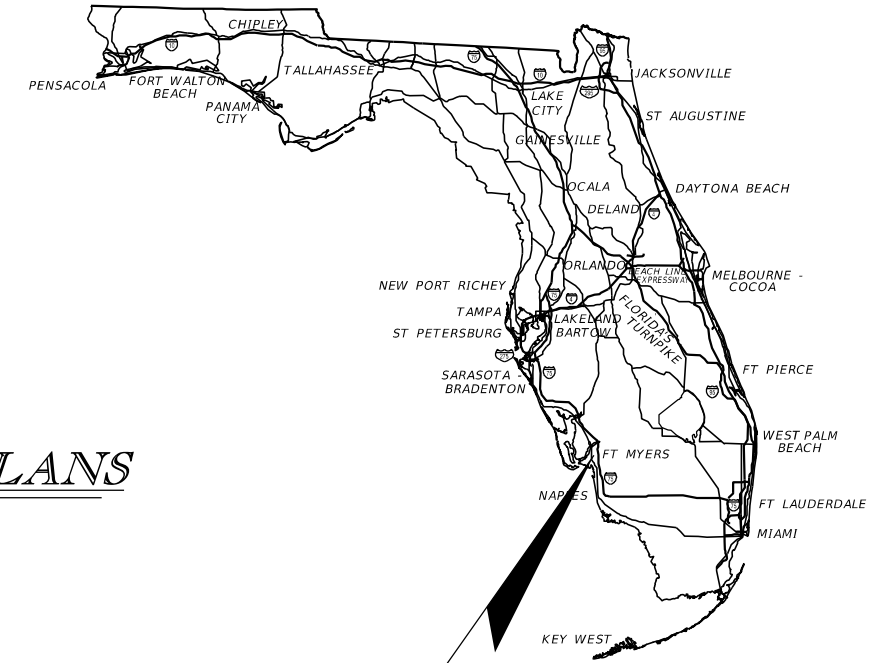

**PROJECT LOCATION**  
<https://goo.gl/maps/pkUqGrXMQNMU8KZv7>

**INDEX OF ITS PLANS**

SHEET NO.	SHEET DESCRIPTION
IT-1	KEY SHEET
IT-2 - IT-4	TABULATION OF QUANTITIES
IT-5	GENERAL NOTES
IT-6 - IT-22	ITS PLANS

*INTELLIGENT TRANSPORTATION SYSTEMS PLANS*

**60% SUBMITTAL**  
**OCTOBER 2020**



**ITS PLANS**  
**ENGINEER OF RECORD:**  
BURAK KONUK, P.E.  
P.E. NO.: 81581  
KISINGER CAMPO & ASSOCIATES CORP.  
CONSULTING ENGINEERS & PLANNERS  
201 N. FRANKLIN STREET, SUITE 400  
TAMPA, FL 33602  
PHONE: (813) 871-5331  
CONTRACT NO.: CN18-8479

**LDOT PROJECT MANAGER:**  
ROBERT K. PHELAN, P.E.

SHEET  
NO.

IT-1

THE OFFICIAL RECORD OF THIS SHEET IS THE ELECTRONIC FILE DIGITALLY SIGNED AND SEALED UNDER RULE 61G15-23.004, F.A.C.















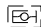

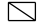
GENERAL NOTES:

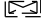
1. AT LEAST TWO (2) FULL BUSINESS DAYS PRIOR TO BEGINNING THE TRAFFIC SIGNAL INSTALLATION, CONTRACTOR SHALL CONTACT THE LEE COUNTY TRAFFIC ENGINEERING SIGNAL SHOP.
2. THE UTILITIES SHOWN ON THE PLANS ARE FOR INFORMATIONAL PURPOSES ONLY AND DO NOT REPRESENT THE EXTENT OF UTILITIES ON THIS PROJECT. THE CONTRACTOR IS FULLY RESPONSIBLE FOR LOCATING AND AVOIDING EXISTING UNDERGROUND AND ABOVEGROUND STRUCTURES AND FACILITIES.
3. THE CONTRACTOR SHALL BE RESPONSIBLE FOR CONTACTING ANY UTILITY OWNER(S) THAT ARE NOT A MEMBER OF SUNSHINE ONE. A CONTRACTOR'S REPRESENTATIVE SHALL BE PRESENT WHEN THE UTILITY COMPANIES LOCATE THEIR FACILITIES. THE LOCATION OF EXISTING UTILITIES SHALL BE DETERMINED BY THE CONTRACTOR AND THE UTILITY REPRESENTATIVE WHEN NECESSARY DURING CONSTRUCTION.
4. NO TEST BORINGS WERE MADE FOR CONDUIT RUNS THAT ARE TO BE INSTALLED BY DIRECTIONAL BORING OR TRENCHING. IT SHALL BE THE CONTRACTOR'S RESPONSIBILITY TO EXAMINE JOB SITE CONDITIONS IN ACCORDANCE WITH THE FDOT SPECIFICATIONS BEFORE CONSTRUCTION ACTIVITIES BEGIN.
5. SOIL RESULTING FROM DRILLING AND/OR UNCLASSIFIED EXCAVATION SHALL BECOME THE PROPERTY OF THE CONTRACTOR AND SHALL BE DISPOSED OF BY THE CONTRACTOR IN ACCORDANCE WITH LOCAL CODE.
6. FOR ALL CONDUIT INSTALLATIONS, IT IS THE RESPONSIBILITY OF THE CONTRACTOR TO VERIFY VERTICAL ELEVATION AND HORIZONTAL LOCATION (VVH) FOR EXISTING INFRASTRUCTURE IN THE CONDUIT INSTALLATION PATH. THE COSTS FOR THE VVHs SHALL BE INCLUDED IN THE COST OF THE CONDUIT INSTALLATIONS.
7. ALL SALVAGE MATERIAL SHALL BE THE PROPERTY OF THE COUNTY AND DELIVERED TO THE LEE COUNTY TRAFFIC ENGINEERING SIGN SHOP.
8. EXISTING FIBER AND ITS FACILITIES SHALL BE PROTECTED AND REMAIN ON-LINE WITH NO INTERRUPTIONS TO THE LEE COUNTY EMERGENCY OPERATIONS CENTER (EOC) THROUGH CONSTRUCTION.

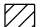
PAY ITEM NOTES:

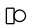
- 630-2-11 AND 630-2-12  
 SHALL BE 1-4" OUTERDUCT WITH 3-1.25" INNERDUCT,  
 288-COUNT BACKBONE FIBER IN BLUE CONDUIT,  
 LOCATE WIRE IN ORANGE CONDUIT.
- 633-1-12X:  
 SHALL BE 288-COUNT FIBER OPTIC CABLE.
- 635-2-13:  
 SHALL BE 30" X 48" SPLICE BOX.
- 684-1-1:  
 MANAGED FIELD ETHERNET SWITCH (MFES) HARDWARE AND  
 SOFTWARE SHALL BE COMPATIBLE WITH LEE COUNTY'S  
 EXISTING CENTRAL CONTROL SOFTWARE. CONTACT MAINTAINING  
 AGENCY PRIOR TO ORDERING MFES TO CONFIRM COMPATIBILITY.

LEGEND	
	EXISTING FIBER OPTIC SPLICE BOX
	NEW FIBER OPTIC SPLICE BOX
	EXISTING FIBER OPTIC PULL BOX
	NEW FIBER OPTIC PULL BOX
	EXISTING TRAFFIC SIGNAL CABINET
BFOC(B) - - - - -	EXISTING FOC
— ● —	OPEN TRENCH CONDUIT
— ●● —	DIRECTIONAL BORE CONDUIT
	NEW MICROWAVE VEHICLE DETECTION SYSTEM (MVDS)
	MVDS DETECTION ZONE
	ITS CABINET (POLE MOUNTED)
	ELECTRIC POWER SERVICE (OVERHEAD)
	POLE MOUNTED TRANSFORMER

REVISIONS				 201 N. Franklin Street, Suite 400 Tampa, Florida 33602 Engineer of Record: Burak Konuk, P.E. KISINGER CAMPO & ASSOCIATES P.E. No.: 81581	LEE COUNTY DEPARTMENT OF TRANSPORTATION			GENERAL NOTES	SHEET NO.
DATE	DESCRIPTION	DATE	DESCRIPTION		ROAD	COUNTY	CONTRACT NO.		IT-5
				CR 865 (ORTIZ AVE.)	LEE COUNTY	CN18-8479			

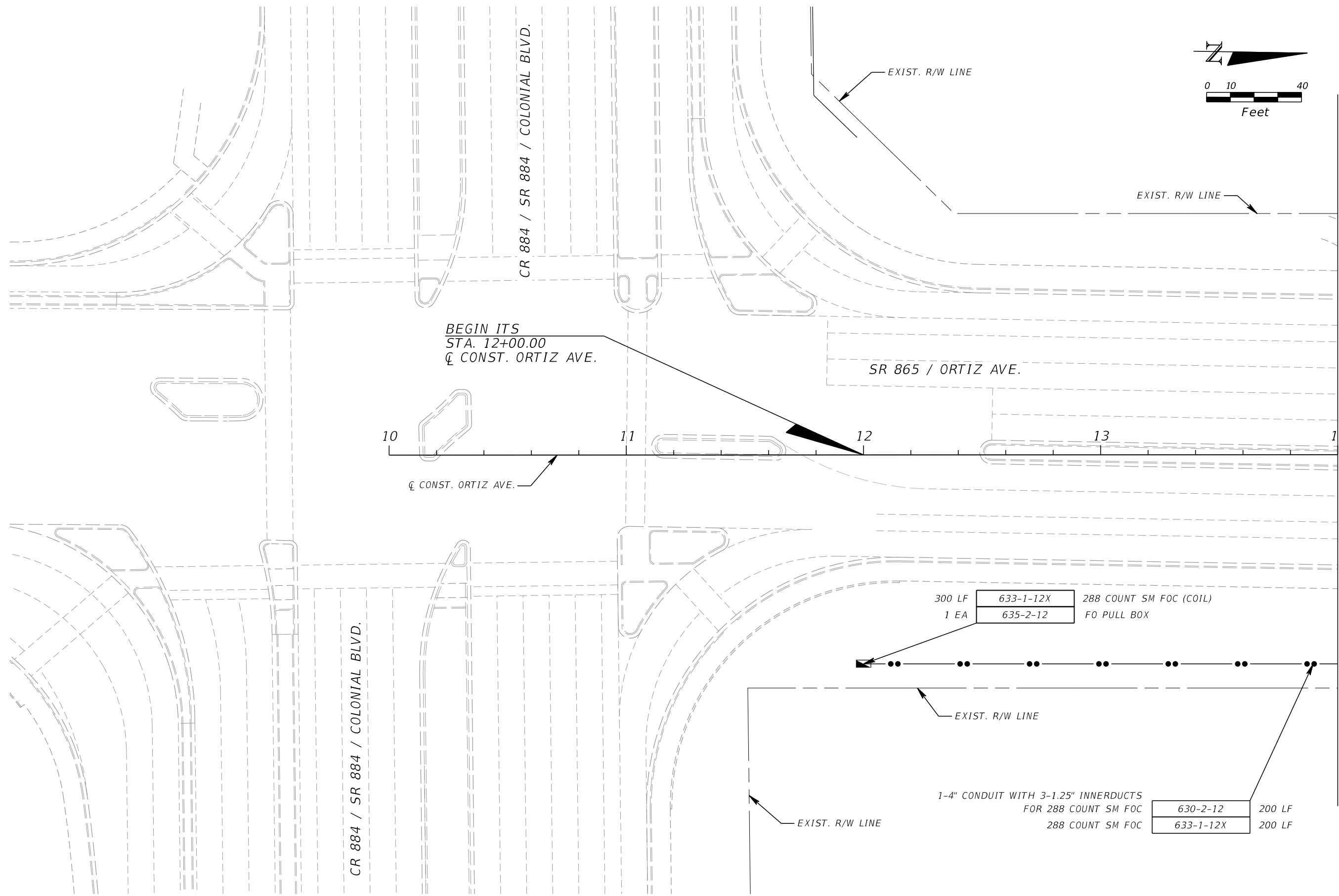
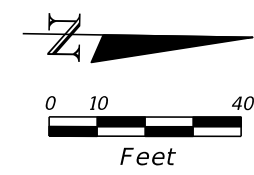

BEGIN ITS  
STA. 12+00.00  
☉ CONST. ORTIZ AVE.

SR 865 / ORTIZ AVE.

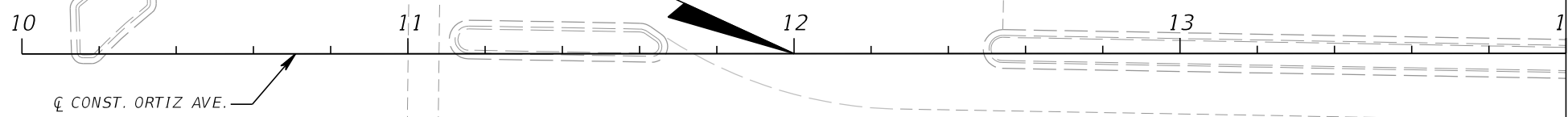

300 LF 633-1-12X 288 COUNT SM FOC (COIL)  
1 EA 635-2-12 FO PULL BOX

1-4" CONDUIT WITH 3-1.25" INNERDUCTS  
FOR 288 COUNT SM FOC 630-2-12 200 LF  
288 COUNT SM FOC 633-1-12X 200 LF

MATCH LINE STA. 14+00

REVISIONS			
DATE	DESCRIPTION	DATE	DESCRIPTION

**KCA**  
KISINGER CAMPO & ASSOCIATES P.E. No.: 81581

201 N. Franklin Street, Suite 400  
Tampa, Florida 33602  
Engineer of Record: Burak Konuk, P.E.

LEE COUNTY DEPARTMENT OF TRANSPORTATION		
ROAD	COUNTY	CONTRACT NO.
CR 865 (ORTIZ AVE.)	LEE COUNTY	CN18-8479

**ITS PLAN (1)**

SHEET NO.  
**IT-6**

THE OFFICIAL RECORD OF THIS SHEET IS THE ELECTRONIC FILE DIGITALLY SIGNED AND SEALED UNDER RULE 61G15-23.004, F.A.C.

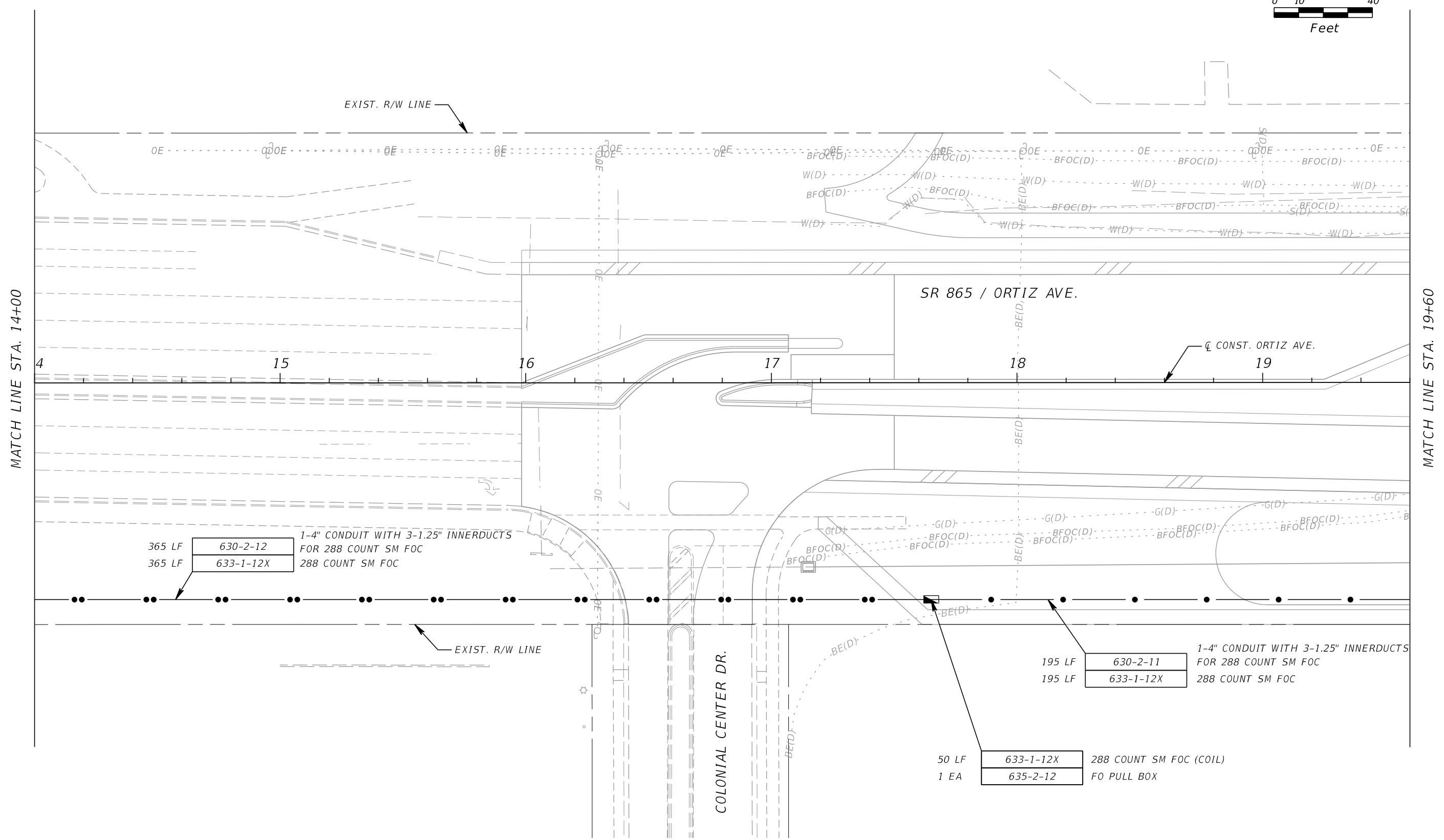
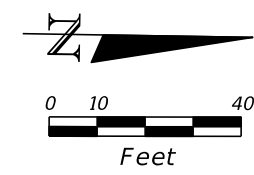

365 LF 630-2-12  
 365 LF 633-1-12X  
 1-4" CONDUIT WITH 3-1.25" INNERDUCTS  
 FOR 288 COUNT SM FOC

195 LF 630-2-11  
 195 LF 633-1-12X  
 1-4" CONDUIT WITH 3-1.25" INNERDUCTS  
 FOR 288 COUNT SM FOC

50 LF 633-1-12X 288 COUNT SM FOC (COIL)  
 1 EA 635-2-12 FO PULL BOX

REVISIONS			
DATE	DESCRIPTION	DATE	DESCRIPTION

**KCA**  
 KISINGER CAMPO & ASSOCIATES P.E. No.: 81581  
 201 N. Franklin Street, Suite 400  
 Tampa, Florida 33602  
 Engineer of Record: Burak Konuk, P.E.

LEE COUNTY DEPARTMENT OF TRANSPORTATION		
ROAD	COUNTY	CONTRACT NO.
CR 865 (ORTIZ AVE.)	LEE COUNTY	CN18-8479

**ITS PLAN (2)**

SHEET NO.  
IT-7

THE OFFICIAL RECORD OF THIS SHEET IS THE ELECTRONIC FILE DIGITALLY SIGNED AND SEALED UNDER RULE 61G15-23.004, F.A.C.

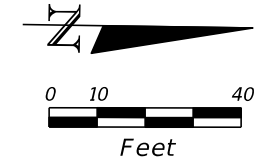

CALUSA NATURE CENTER ENTRANCE

EXIST. R/W LINE

SR 865 / ORTIZ AVE.

CONST. ORTIZ AVE.

EXIST. R/W LINE

MATCH LINE STA. 19+60

MATCH LINE STA. 25+20

440 LF 630-2-11 1-4" CONDUIT WITH 3-1.25" INNERDUCTS FOR 288 COUNT SM FOC  
 440 LF 633-1-12X 288 COUNT SM FOC

288 COUNT SM FOC (COIL) 633-1-12X 50 LF  
 FO PULL BOX 635-2-12 1 EA

1-4" CONDUIT WITH 3-1.25" INNERDUCTS FOR 288 COUNT SM FOC 630-2-12 120 LF  
 288 COUNT SM FOC 633-1-12X 120 LF

REVISIONS			
DATE	DESCRIPTION	DATE	DESCRIPTION

**KCA**  
 KISINGER CAMPO & ASSOCIATES P.E. No.: 81581  
 201 N. Franklin Street, Suite 400  
 Tampa, Florida 33602  
 Engineer of Record: Burak Konuk, P.E.

LEE COUNTY DEPARTMENT OF TRANSPORTATION		
ROAD	COUNTY	CONTRACT NO.
CR 865 (ORTIZ AVE.)	LEE COUNTY	CN18-8479

ITS PLAN (3)

SHEET NO.  
IT-8

THE OFFICIAL RECORD OF THIS SHEET IS THE ELECTRONIC FILE DIGITALLY SIGNED AND SEALED UNDER RULE 61G15-23.004, F.A.C.



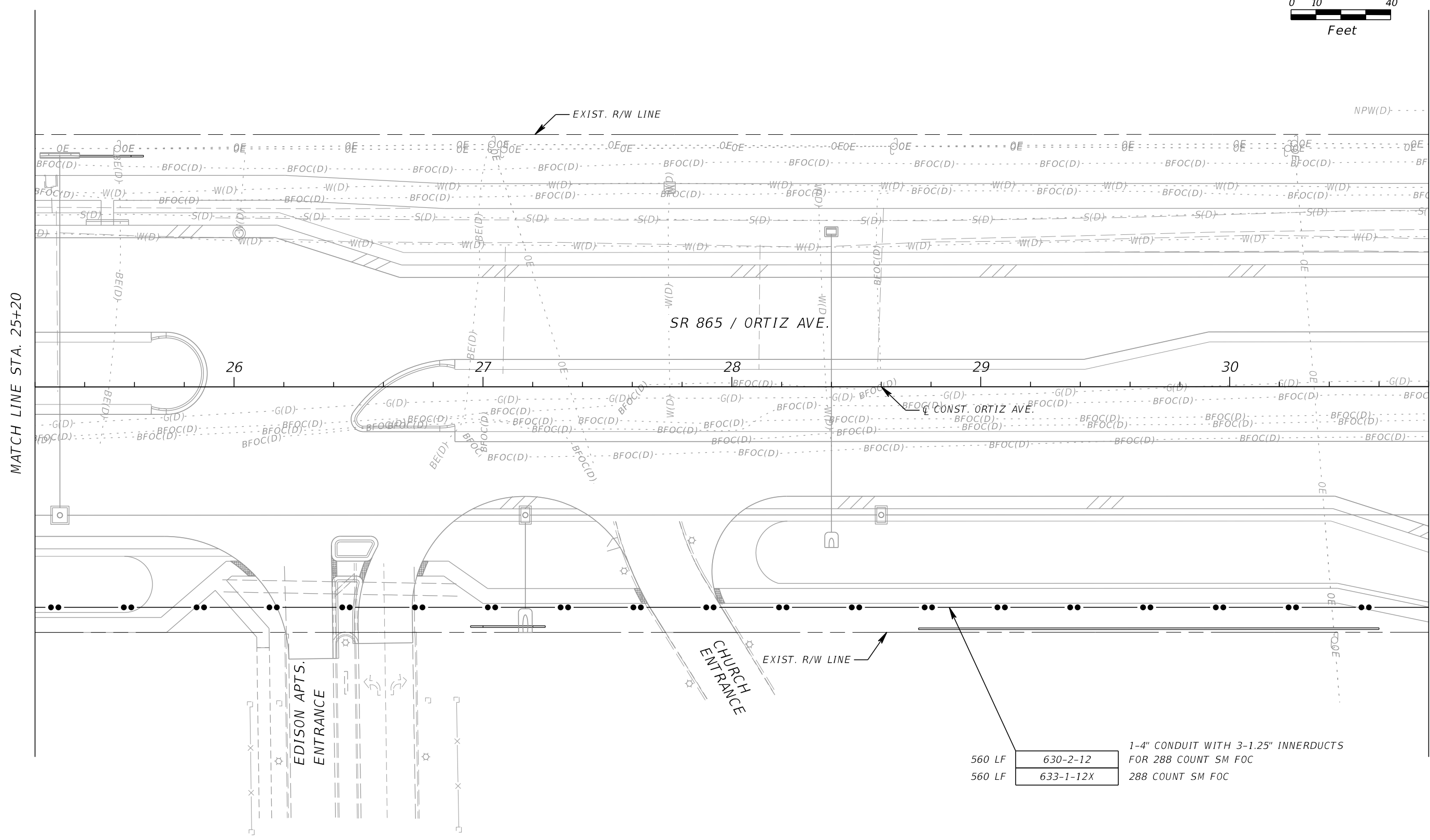
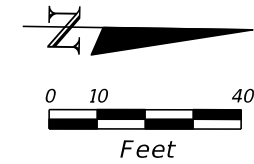

560 LF	630-2-12	1-4" CONDUIT WITH 3-1.25" INNERDUCTS FOR 288 COUNT SM FOC
560 LF	633-1-12X	288 COUNT SM FOC

REVISIONS			
DATE	DESCRIPTION	DATE	DESCRIPTION

**KCA**  
 KISINGER CAMPO & ASSOCIATES P.E. No.: 81581  
 201 N. Franklin Street, Suite 400  
 Tampa, Florida 33602  
 Engineer of Record: Burak Konuk, P.E.

LEE COUNTY DEPARTMENT OF TRANSPORTATION		
ROAD	COUNTY	CONTRACT NO.
CR 865 (ORTIZ AVE.)	LEE COUNTY	CN18-8479

ITS PLAN (4)

SHEET NO.  
IT-9

THE OFFICIAL RECORD OF THIS SHEET IS THE ELECTRONIC FILE DIGITALLY SIGNED AND SEALED UNDER RULE 61G15-23.004, F.A.C.

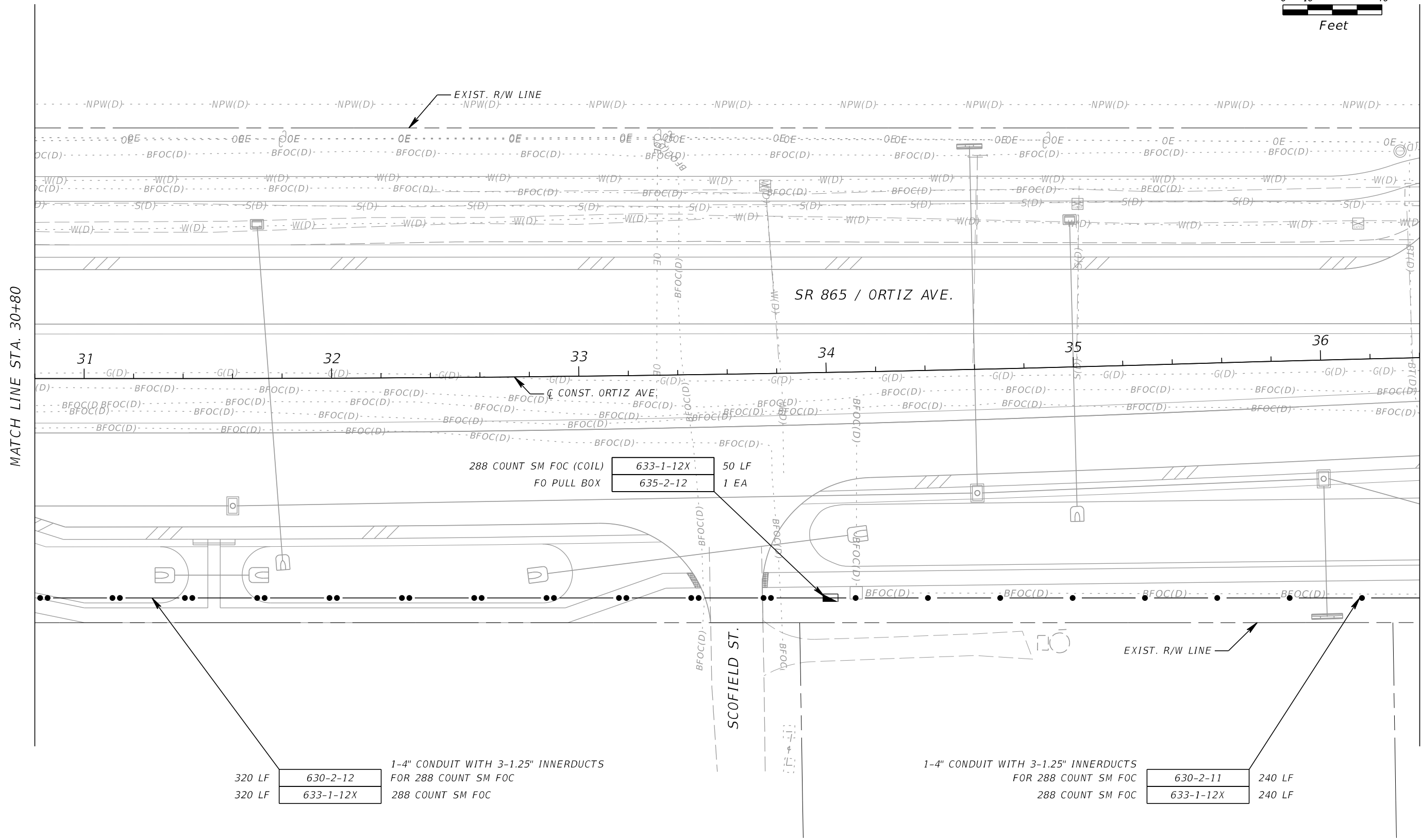
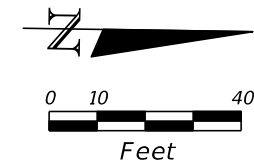

MATCH LINE STA. 30+80

MATCH LINE STA. 36+40

288 COUNT SM FOC (COIL) 633-1-12X 50 LF  
FO PULL BOX 635-2-12 1 EA

320 LF 630-2-12 1-4" CONDUIT WITH 3-1.25" INNERDUCTS FOR 288 COUNT SM FOC  
320 LF 633-1-12X 288 COUNT SM FOC

1-4" CONDUIT WITH 3-1.25" INNERDUCTS FOR 288 COUNT SM FOC 630-2-11 240 LF  
288 COUNT SM FOC 633-1-12X 240 LF

REVISIONS			
DATE	DESCRIPTION	DATE	DESCRIPTION

**KCA**  
KISINGER CAMPO & ASSOCIATES P.E. No.: 81581  
201 N. Franklin Street, Suite 400  
Tampa, Florida 33602  
Engineer of Record: Burak Konuk, P.E.

LEE COUNTY DEPARTMENT OF TRANSPORTATION		
ROAD	COUNTY	CONTRACT NO.
CR 865 (ORTIZ AVE.)	LEE COUNTY	CN18-8479

ITS PLAN (5)

SHEET NO.  
IT-10

THE OFFICIAL RECORD OF THIS SHEET IS THE ELECTRONIC FILE DIGITALLY SIGNED AND SEALED UNDER RULE 61G15-23.004, F.A.C.

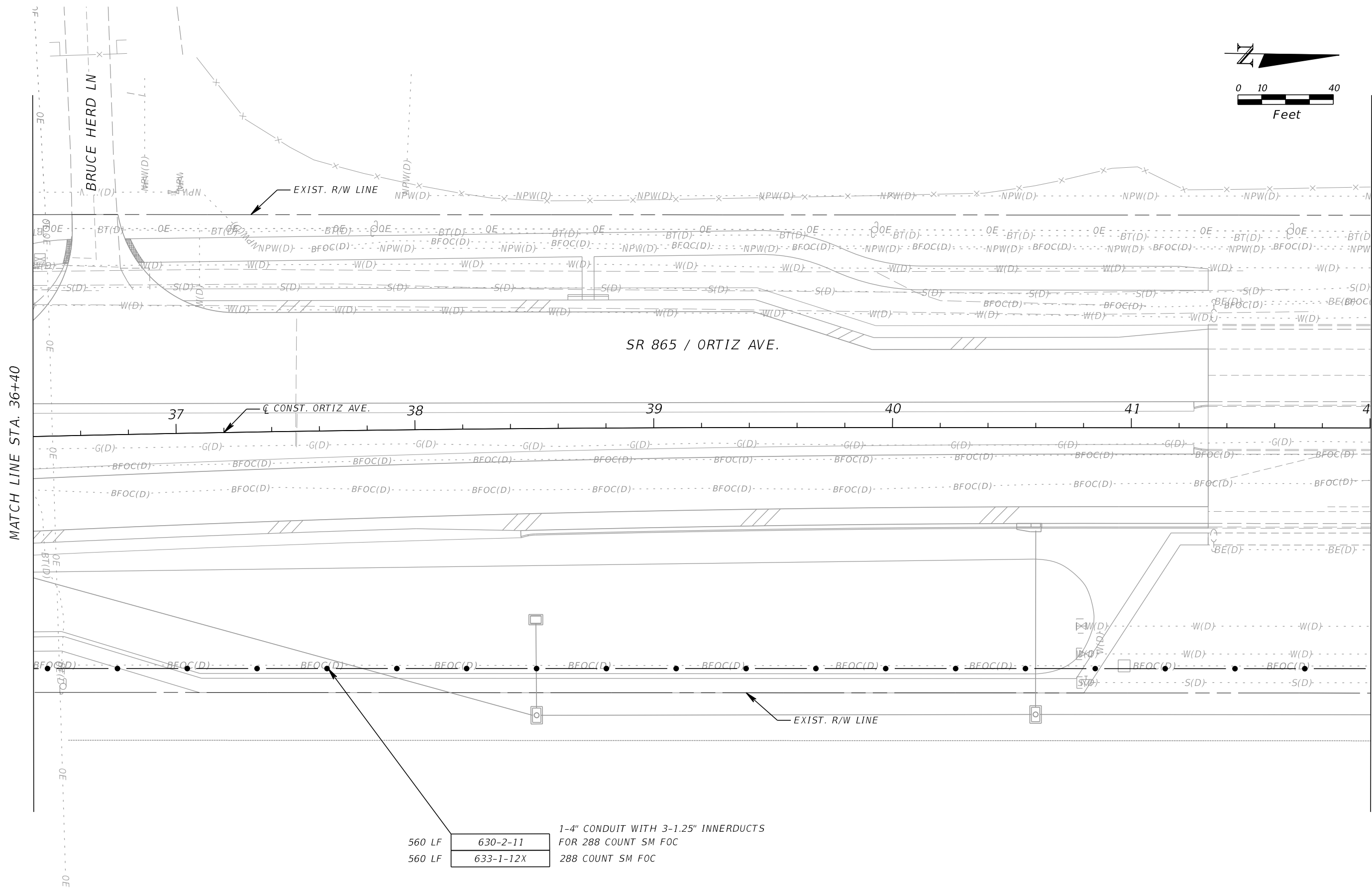
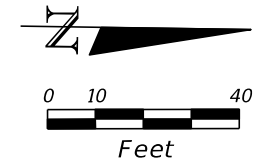

REVISIONS			
DATE	DESCRIPTION	DATE	DESCRIPTION

**KCA**  
KISINGER CAMPO & ASSOCIATES P.E. No.: 81581

201 N. Franklin Street, Suite 400  
Tampa, Florida 33602  
Engineer of Record: Burak Konuk, P.E.

LEE COUNTY DEPARTMENT OF TRANSPORTATION		
ROAD	COUNTY	CONTRACT NO.
CR 865 (ORTIZ AVE.)	LEE COUNTY	CN18-8479

**ITS PLAN (6)**

SHEET NO.  
**IT-11**

THE OFFICIAL RECORD OF THIS SHEET IS THE ELECTRONIC FILE DIGITALLY SIGNED AND SEALED UNDER RULE 61G15-23.004, F.A.C.

1-1" ABOVEGROUND	630-2-14	30 LF
12 COUNT SM FOC (COIL) IN CABINET	633-1-121	20 LF
12 COUNT SM FOC (COIL) IN FO PULL BOX	633-1-121	100 LF
FO CONNECTION (TERMINATION)	633-2-32	12 EA
FAN OUT	633-3-14	1 EA
FIELD TERMINATED PATCH PANEL	633-3-16	1 EA
ELECTRICAL PULL BOX	635-2-11	1 EA
FO PULL BOX	635-2-12	1 EA
POWER SERVICE DISCONNECT	639-3-11	1 EA
CONCRETE TYPE P-III POLE (30')	641-2-13	1 EA
MVDS CABINET EQUIPMENT	660-3-11	1 EA
MVDS ABOVEGROUND EQUIPMENT	660-3-12	1 EA
TYPE 336S POLE MOUNTED CABINET	676-2-122	1 EA
MFES	684-1-1	1 EA
DEVICE SERVER	684-2-1	1 EA
UPS	685-1-11	1 EA

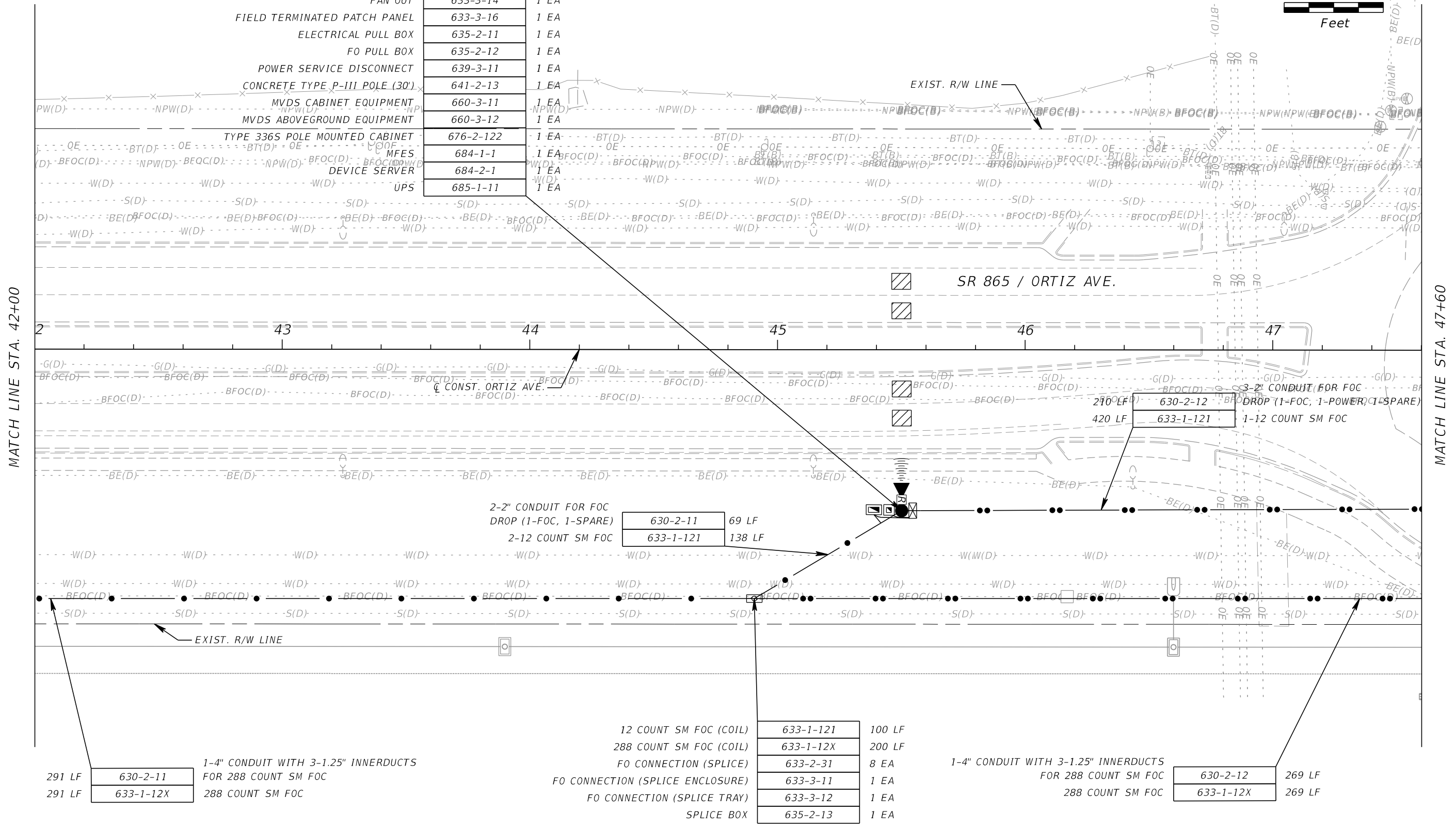
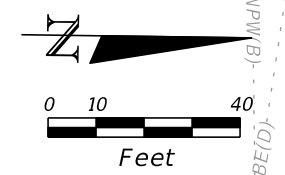

291 LF	630-2-11	1-4" CONDUIT WITH 3-1.25" INNERDUCTS FOR 288 COUNT SM FOC
291 LF	633-1-12X	288 COUNT SM FOC

12 COUNT SM FOC (COIL)	633-1-121	100 LF
288 COUNT SM FOC (COIL)	633-1-12X	200 LF
FO CONNECTION (SPLICE)	633-2-31	8 EA
FO CONNECTION (SPLICE ENCLOSURE)	633-3-11	1 EA
FO CONNECTION (SPLICE TRAY)	633-3-12	1 EA
SPLICE BOX	635-2-13	1 EA

1-4" CONDUIT WITH 3-1.25" INNERDUCTS FOR 288 COUNT SM FOC	630-2-12	269 LF
288 COUNT SM FOC	633-1-12X	269 LF

REVISIONS				 <b>KCA</b> KISINGER CAMPO & ASSOCIATES P.E. No.: 81581	LEE COUNTY DEPARTMENT OF TRANSPORTATION			<b>ITS PLAN (7)</b>	SHEET NO.
DATE	DESCRIPTION	DATE	DESCRIPTION		ROAD	COUNTY	CONTRACT NO.		
					CR 865 (ORTIZ AVE.)	LEE COUNTY	CN18-8479		IT-12

THE OFFICIAL RECORD OF THIS SHEET IS THE ELECTRONIC FILE DIGITALLY SIGNED AND SEALED UNDER RULE 61G15-23.004, F.A.C.

30 LF	630-2-14	1-1" ABOVEGROUND
20 LF	633-1-121	12 COUNT SM FOC (COIL) IN CABINET
50 LF	633-1-121	12 COUNT SM FOC (COIL) IN FO PULL BOX
12 EA	633-2-32	FO CONNECTION (TERMINATION)
1 EA	633-3-14	FAN OUT
1 EA	633-3-16	FIELD TERMINATED PATCH PANEL
1 EA	635-2-11	ELECTRICAL PULL BOX
1 EA	635-2-12	FO PULL BOX
1 EA	639-3-11	POWER SERVICE DISCONNECT
1 EA	641-2-13	CONCRETE TYPE P-III POLE (30')
1 EA	660-3-11	MVDS CABINET EQUIPMENT
1 EA	660-3-12	MVDS ABOVEGROUND EQUIPMENT
1 EA	676-2-122	TYPE 336S POLE MOUNTED CABINET
1 EA	684-1-1	MFES
1 EA	684-2-1	DEVICE SERVER
1 EA	685-1-11	UPS

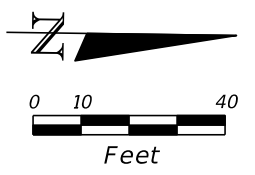

LOCATION OF NEW POLE & 120/240V POLE-MOUNTED TRANSFORMER BY POWER COMPANY

FURNISH & INSTALL ELECTRIC POWER SERVICE (OVERHEAD) 639-1-112 1 AS

1-2" CONDUIT FOR POWER 630-2-12 135 LF

3-2" CONDUIT FOR FOC DROP (1-FOC, 1-POWER, 1-SPARE) 630-2-12W(D) 286 LF  
 1-12 COUNT SM FOC 633-1-121 572 LF

1-4" CONDUIT WITH 3-1.25" INNERDUCTS FOR 288 COUNT SM FOC 630-2-12 560 LF  
 288 COUNT SM FOC 633-1-12X 560 LF

MATCH LINE STA. 47+60

MATCH LINE STA. 53+20

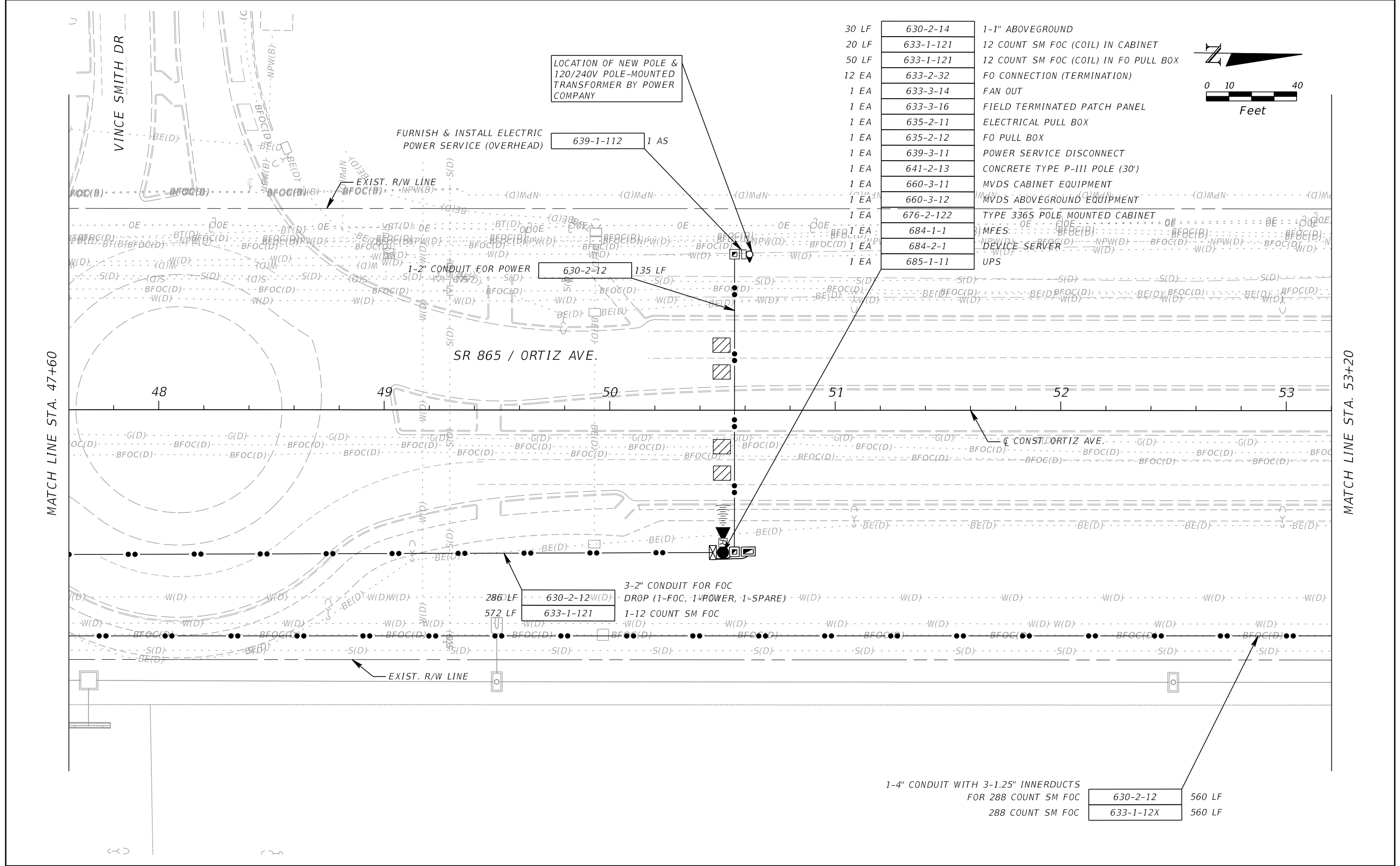

REVISIONS			
DATE	DESCRIPTION	DATE	DESCRIPTION

**KCA**  
 KISINGER CAMPO & ASSOCIATES P.E. No.: 81581

201 N. Franklin Street, Suite 400  
 Tampa, Florida 33602  
 Engineer of Record: Burak Konuk, P.E.

LEE COUNTY DEPARTMENT OF TRANSPORTATION		
ROAD	COUNTY	CONTRACT NO.
CR 865 (ORTIZ AVE.)	LEE COUNTY	CN18-8479

**ITS PLAN (8)**

SHEET NO. IT-13

THE OFFICIAL RECORD OF THIS SHEET IS THE ELECTRONIC FILE DIGITALLY SIGNED AND SEALED UNDER RULE 61G15-23.004, F.A.C.

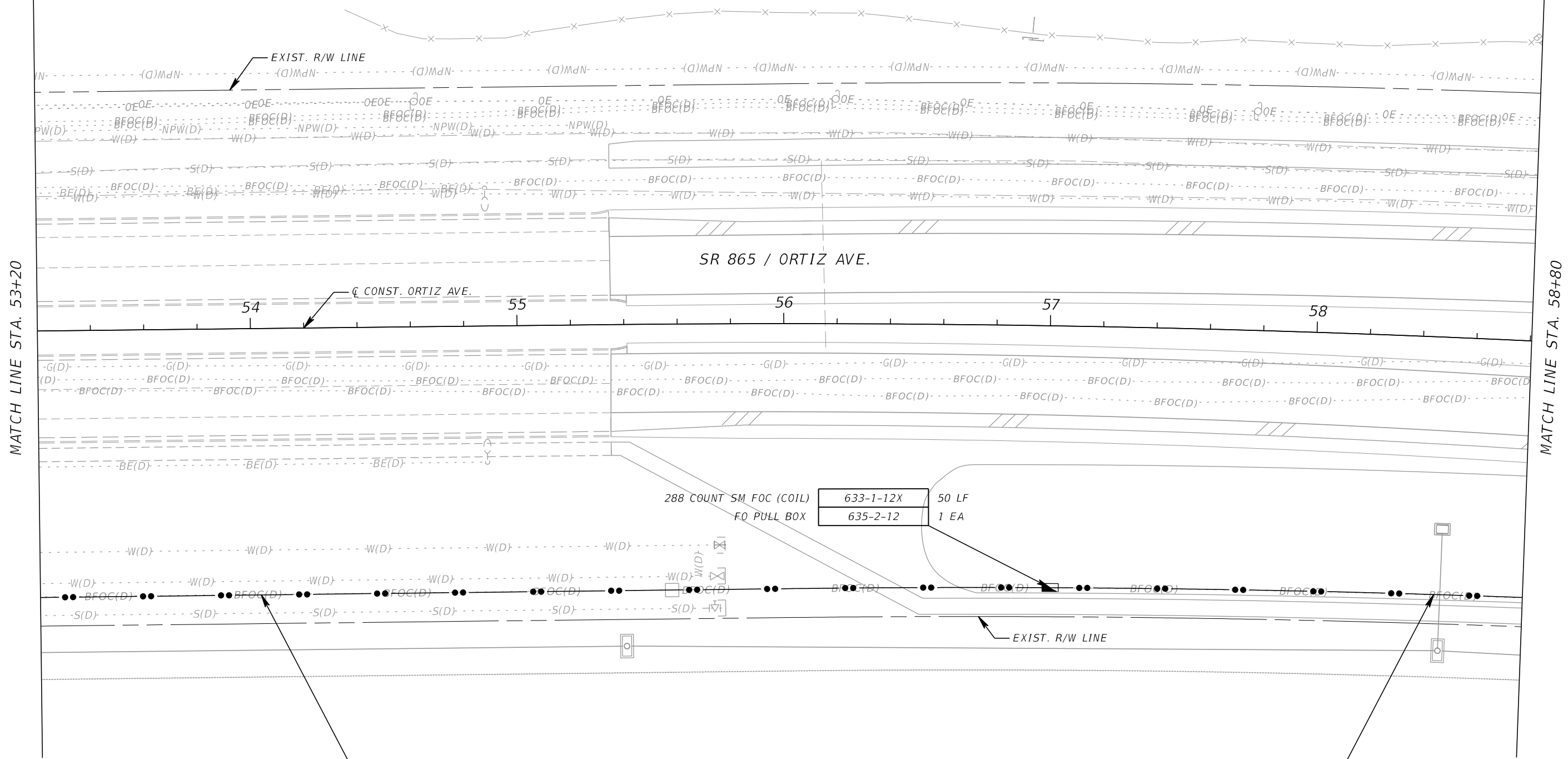
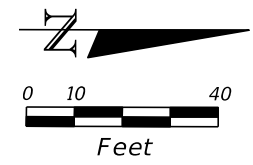

MATCH LINE STA. 53+20

MATCH LINE STA. 58+80

379 LF	630-2-12	1-4" CONDUIT WITH 3-1.25" INNERDUCTS FOR 288 COUNT SM FOC
379 LF	633-1-12X	288 COUNT SM FOC

633-1-12X	50 LF
635-2-12	1 EA

1-4" CONDUIT WITH 3-1.25" INNERDUCTS FOR 288 COUNT SM FOC	630-2-12	177 LF
288 COUNT SM FOC	633-1-12X	177 LF

REVISIONS			
DATE	DESCRIPTION	DATE	DESCRIPTION

**KCA**  
KISINGER CAMPO & ASSOCIATES P.E. No.: 81581

201 N. Franklin Street, Suite 400  
Tampa, Florida 33602  
Engineer of Record: Burak Konuk, P.E.

LEE COUNTY DEPARTMENT OF TRANSPORTATION		
ROAD	COUNTY	CONTRACT NO.
CR 865 (ORTIZ AVE.)	LEE COUNTY	CN18-8479

**ITS PLAN (9)**

SHEET NO.  
**IT-14**

THE OFFICIAL RECORD OF THIS SHEET IS THE ELECTRONIC FILE DIGITALLY SIGNED AND SEALED UNDER RULE 61G15-23.004, F.A.C.

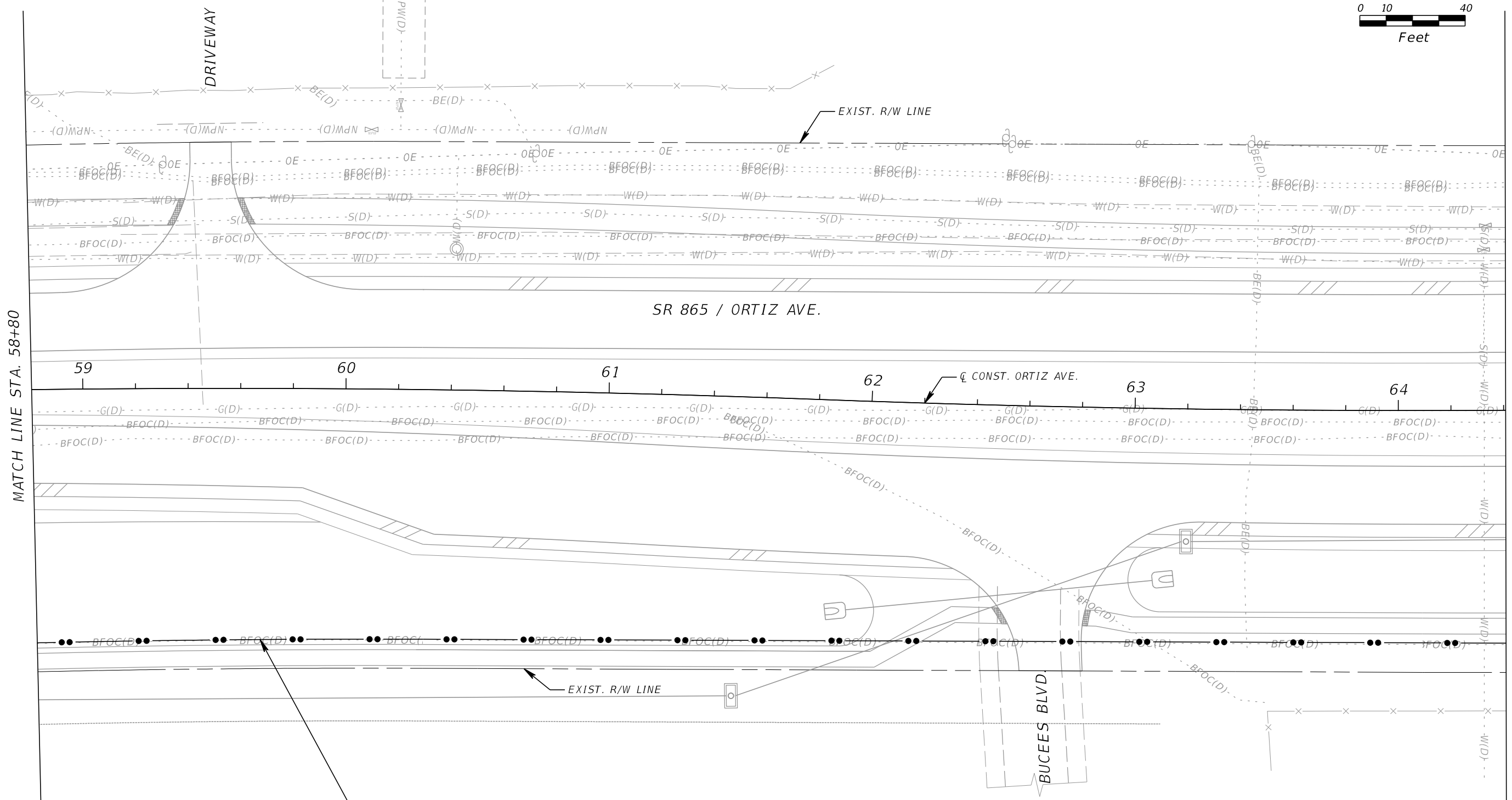
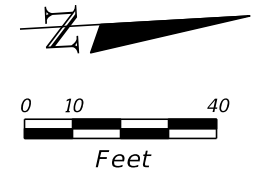

560 LF	630-2-12	1-4" CONDUIT WITH 3-1.25" INNERDUCTS FOR 288 COUNT SM FOC
560 LF	633-1-12X	288 COUNT SM FOC

REVISIONS			
DATE	DESCRIPTION	DATE	DESCRIPTION

**KCA**  
 KISINGER CAMPO & ASSOCIATES P.E. No.: 81581  
 201 N. Franklin Street, Suite 400  
 Tampa, Florida 33602  
 Engineer of Record: Burak Konuk, P.E.

LEE COUNTY DEPARTMENT OF TRANSPORTATION		
ROAD	COUNTY	CONTRACT NO.
CR 865 (ORTIZ AVE.)	LEE COUNTY	CN18-8479

**ITS PLAN (10)**

SHEET NO.  
**IT-15**

THE OFFICIAL RECORD OF THIS SHEET IS THE ELECTRONIC FILE DIGITALLY SIGNED AND SEALED UNDER RULE 61G15-23.004, F.A.C.

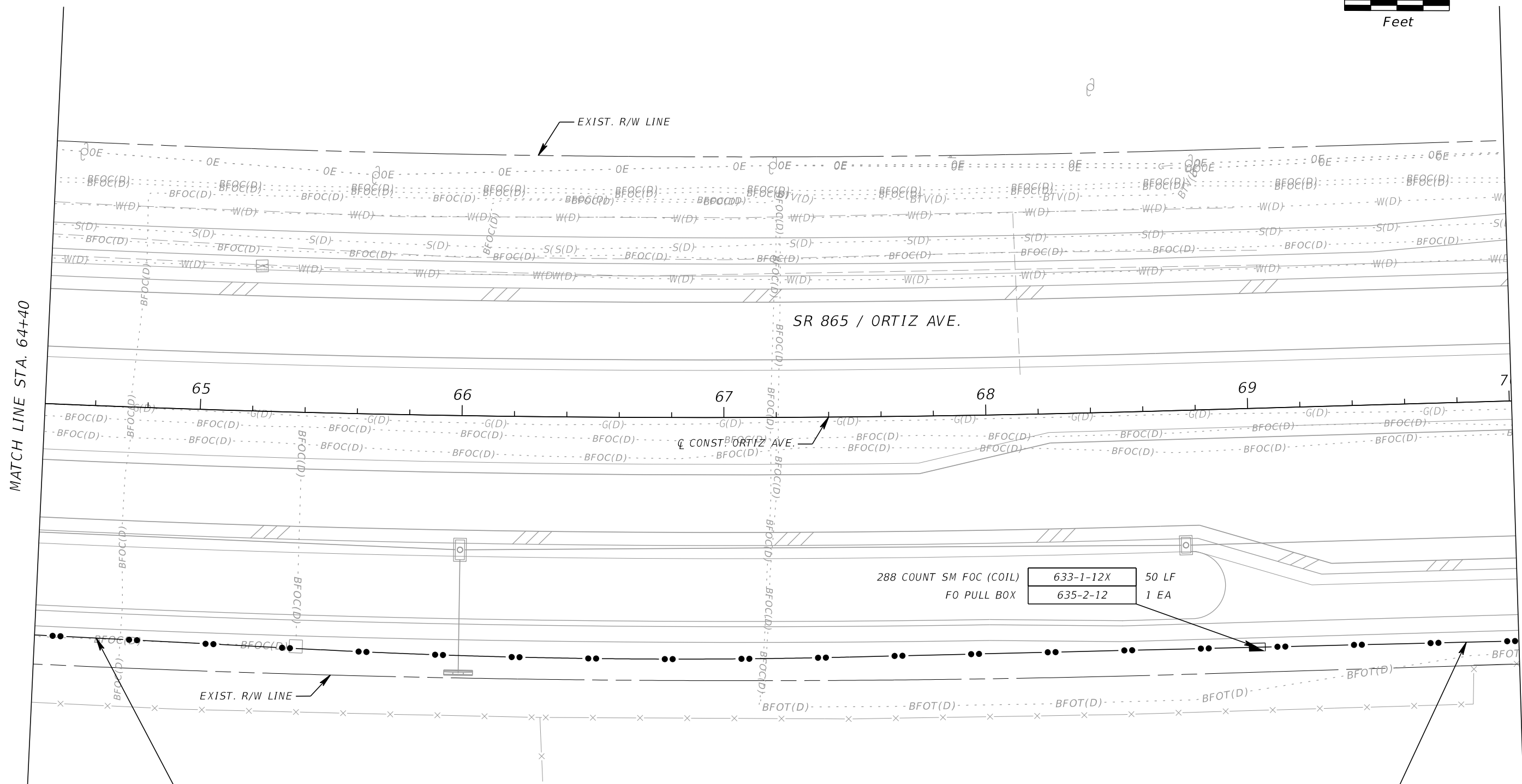
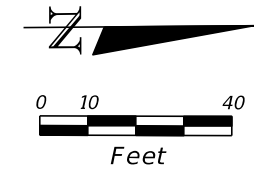

MATCH LINE STA. 64+40

MATCH LINE STA. 70+00

468 LF	630-2-12	1-4" CONDUIT WITH 3-1.25" INNERDUCTS FOR 288 COUNT SM FOC
468 LF	633-1-12X	288 COUNT SM FOC

100 LF	630-2-12	1-4" CONDUIT WITH 3-1.25" INNERDUCTS FOR 288 COUNT SM FOC
100 LF	633-1-12X	288 COUNT SM FOC

288 COUNT SM FOC (COIL)	633-1-12X	50 LF
FO PULL BOX	635-2-12	1 EA

REVISIONS			
DATE	DESCRIPTION	DATE	DESCRIPTION

**KCA**  
KISINGER CAMPO & ASSOCIATES P.E. No.: 81581

201 N. Franklin Street, Suite 400  
Tampa, Florida 33602  
Engineer of Record: Burak Konuk, P.E.

LEE COUNTY DEPARTMENT OF TRANSPORTATION		
ROAD	COUNTY	CONTRACT NO.
CR 865 (ORTIZ AVE.)	LEE COUNTY	CN18-8479

**ITS PLAN (11)**

SHEET NO.  
**IT-16**

THE OFFICIAL RECORD OF THIS SHEET IS THE ELECTRONIC FILE DIGITALLY SIGNED AND SEALED UNDER RULE 61G15-23.004, F.A.C.



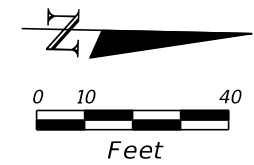

MATCH LINE STA. 70+00

MATCH LINE STA. 75+60

NORSTAR APTS.  
ENTRANCE

SR 865 / ORTIZ AVE.

EXIST. R/W LINE

EXIST. R/W LINE

LEE COUNTY  
EMERGENCY  
MANAGEMENT

1-4" CONDUIT WITH 3-1.25" INNERDUCTS  
FOR 288 COUNT SM FOC  
288 COUNT SM FOC

630-2-12	560 LF
633-1-12X	560 LF

REVISIONS			
DATE	DESCRIPTION	DATE	DESCRIPTION

**KCA**  
KISINGER CAMPO & ASSOCIATES P.E. No.: 81581

201 N. Franklin Street, Suite 400  
Tampa, Florida 33602  
Engineer of Record: Burak Konuk, P.E.

LEE COUNTY DEPARTMENT OF TRANSPORTATION		
ROAD	COUNTY	CONTRACT NO.
CR 865 (ORTIZ AVE.)	LEE COUNTY	CN18-8479

ITS PLAN (12)

SHEET NO.  
IT-17

THE OFFICIAL RECORD OF THIS SHEET IS THE ELECTRONIC FILE DIGITALLY SIGNED AND SEALED UNDER RULE 61G15-23.004, F.A.C.

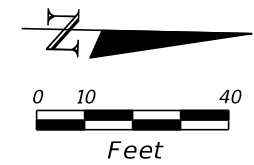

MATCH LINE STA. 75+60

MATCH LINE STA. 81+20

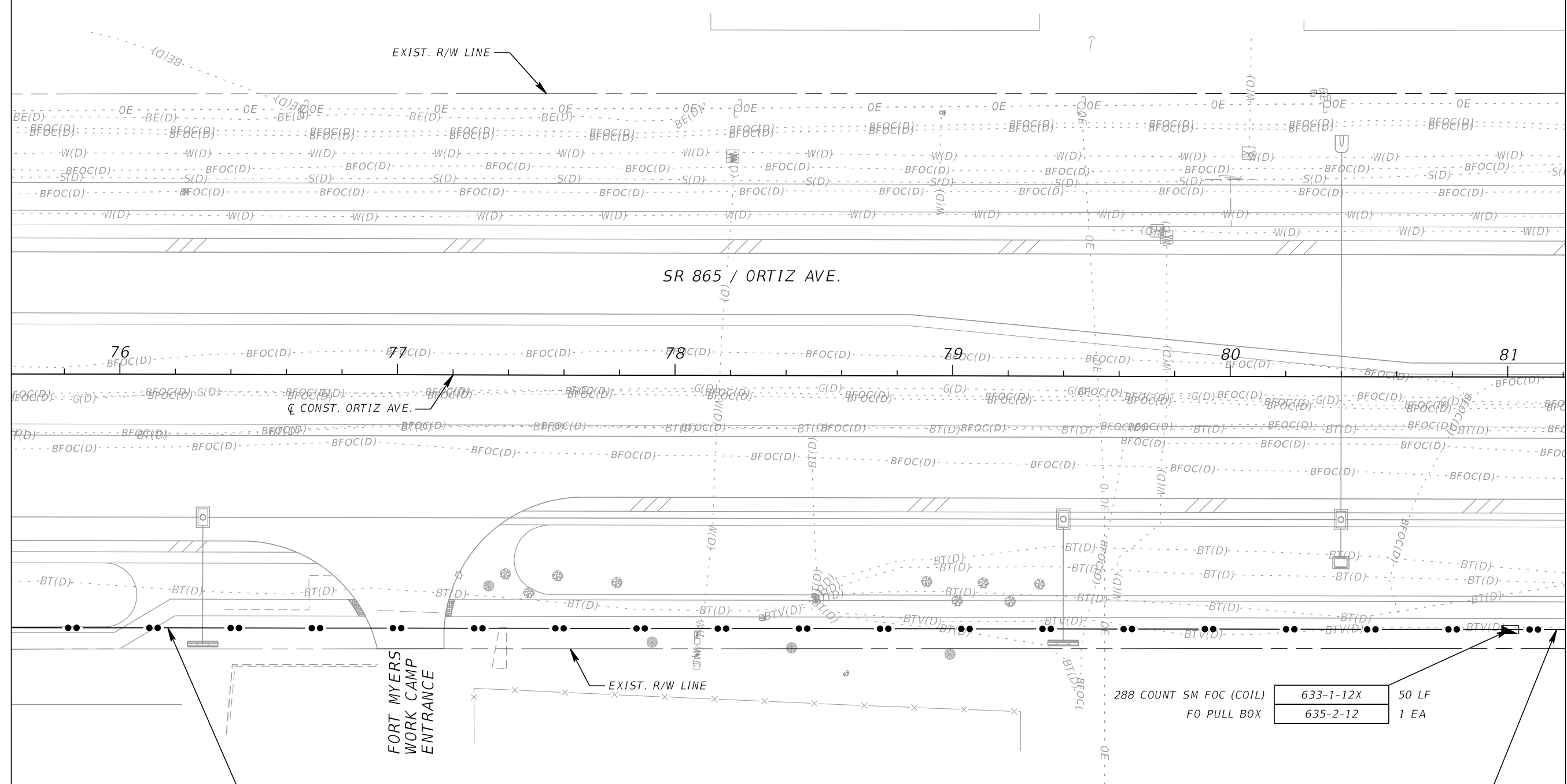

540 LF	630-2-12	1-4" CONDUIT WITH 3-1.25" INNERDUCTS FOR 288 COUNT SM FOC
540 LF	633-1-12X	288 COUNT SM FOC

288 COUNT SM FOC (COIL)	633-1-12X	50 LF
FO PULL BOX	635-2-12	1 EA

1-4" CONDUIT WITH 3-1.25" INNERDUCTS FOR 288 COUNT SM FOC	630-2-12	20 LF
288 COUNT SM FOC	633-1-12X	20 LF

REVISIONS			
DATE	DESCRIPTION	DATE	DESCRIPTION

**KCA**  
KISINGER CAMPO & ASSOCIATES P.E. No.: 81581

201 N. Franklin Street, Suite 400  
Tampa, Florida 33602  
Engineer of Record: Burak Konuk, P.E.

LEE COUNTY DEPARTMENT OF TRANSPORTATION		
ROAD	COUNTY	CONTRACT NO.
CR 865 (ORTIZ AVE.)	LEE COUNTY	CN18-8479

ITS PLAN (13)

SHEET NO.  
**IT-18**

THE OFFICIAL RECORD OF THIS SHEET IS THE ELECTRONIC FILE DIGITALLY SIGNED AND SEALED UNDER RULE 61G15-23.004, F.A.C.

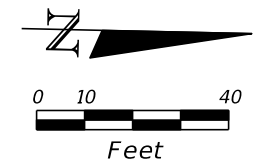

MATCH LINE STA. 81+20

MATCH LINE STA. 86+80

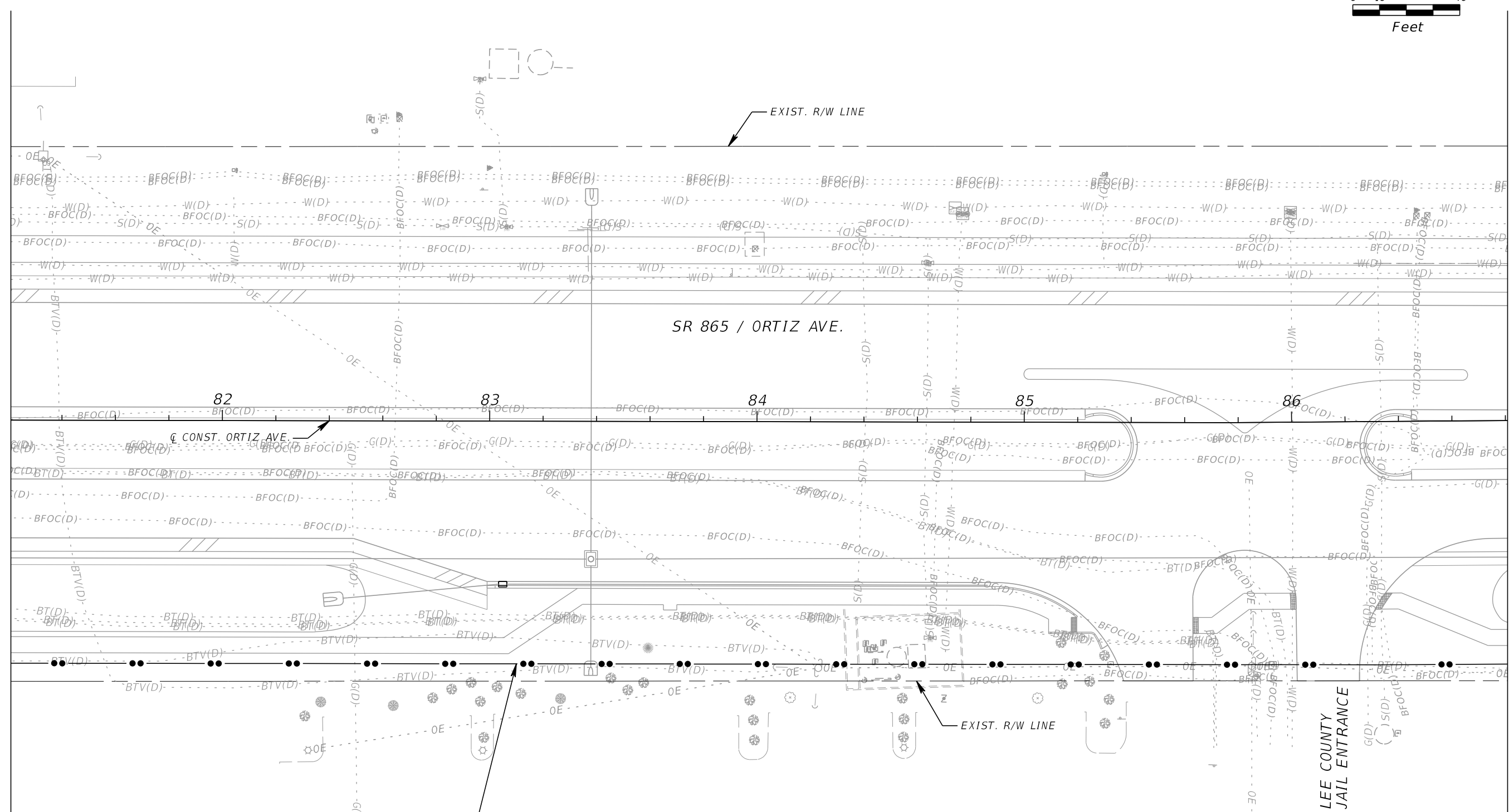

1-4" CONDUIT WITH 3-1.25" INNERDUCTS  
FOR 288 COUNT SM FOC

630-2-12	560 LF
633-1-12X	560 LF

REVISIONS			
DATE	DESCRIPTION	DATE	DESCRIPTION

**KCA**  
KISINGER CAMPO & ASSOCIATES P.E. No.: 81581

201 N. Franklin Street, Suite 400  
Tampa, Florida 33602  
Engineer of Record: Burak Konuk, P.E.

LEE COUNTY DEPARTMENT OF TRANSPORTATION		
ROAD	COUNTY	CONTRACT NO.
CR 865 (ORTIZ AVE.)	LEE COUNTY	CN18-8479

*ITS PLAN (14)*

SHEET NO.  
**IT-19**

THE OFFICIAL RECORD OF THIS SHEET IS THE ELECTRONIC FILE DIGITALLY SIGNED AND SEALED UNDER RULE 61G15-23.004, F.A.C.

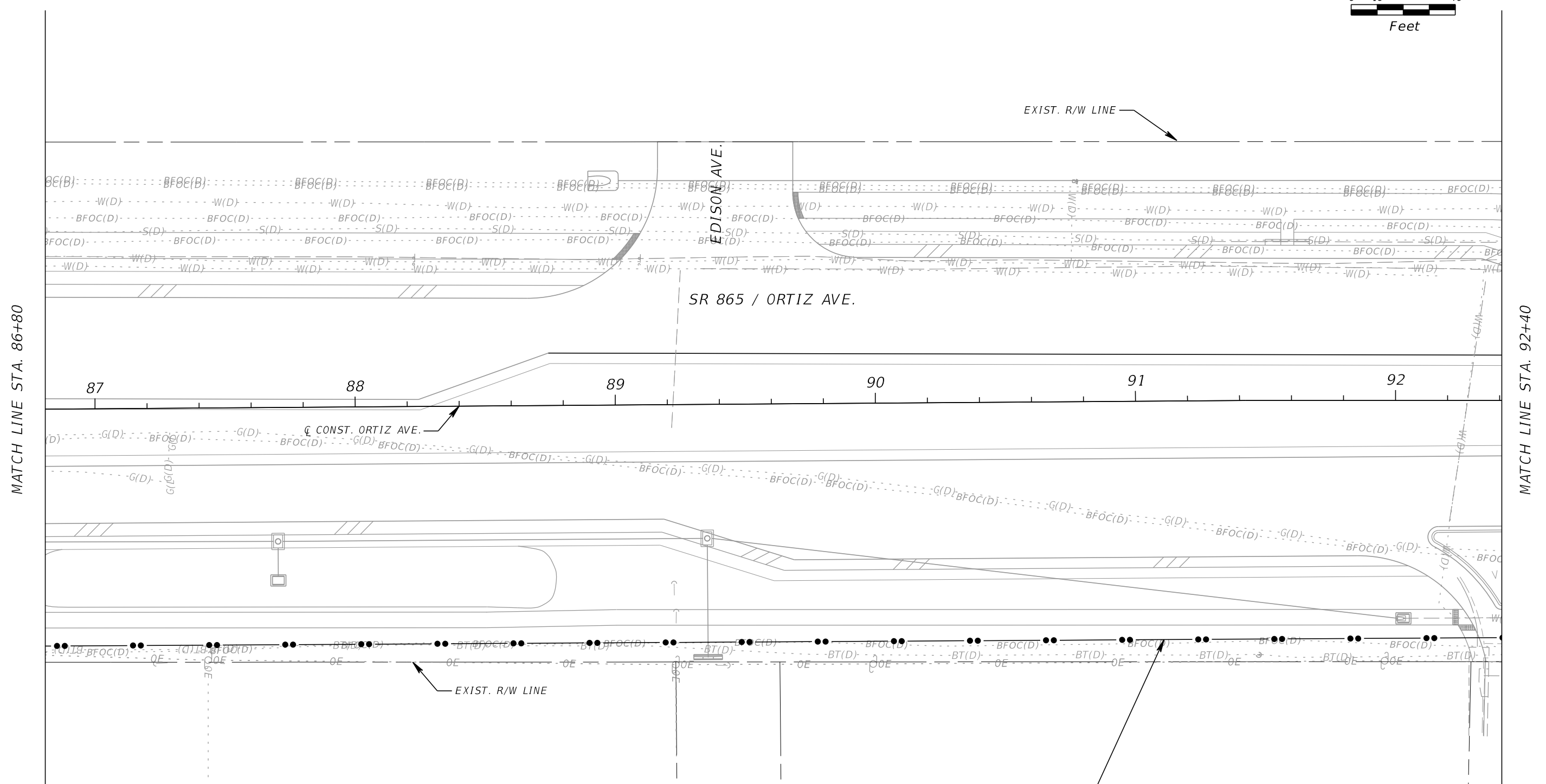
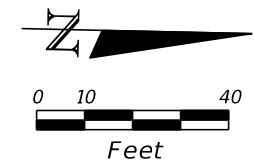

MATCH LINE STA. 86+80

MATCH LINE STA. 92+40

REVISIONS			
DATE	DESCRIPTION	DATE	DESCRIPTION

**KCA**  
 KISINGER CAMPO & ASSOCIATES P.E. No.: 81581

201 N. Franklin Street, Suite 400  
 Tampa, Florida 33602  
 Engineer of Record: Burak Konuk, P.E.

LEE COUNTY DEPARTMENT OF TRANSPORTATION		
ROAD	COUNTY	CONTRACT NO.
CR 865 (ORTIZ AVE.)	LEE COUNTY	CN18-8479

**ITS PLAN (15)**

SHEET NO.  
**IT-20**

THE OFFICIAL RECORD OF THIS SHEET IS THE ELECTRONIC FILE DIGITALLY SIGNED AND SEALED UNDER RULE 61G15-23.004, F.A.C.

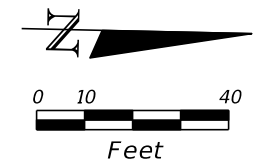

MATCH LINE STA. 92+40

MATCH LINE STA. 98+00

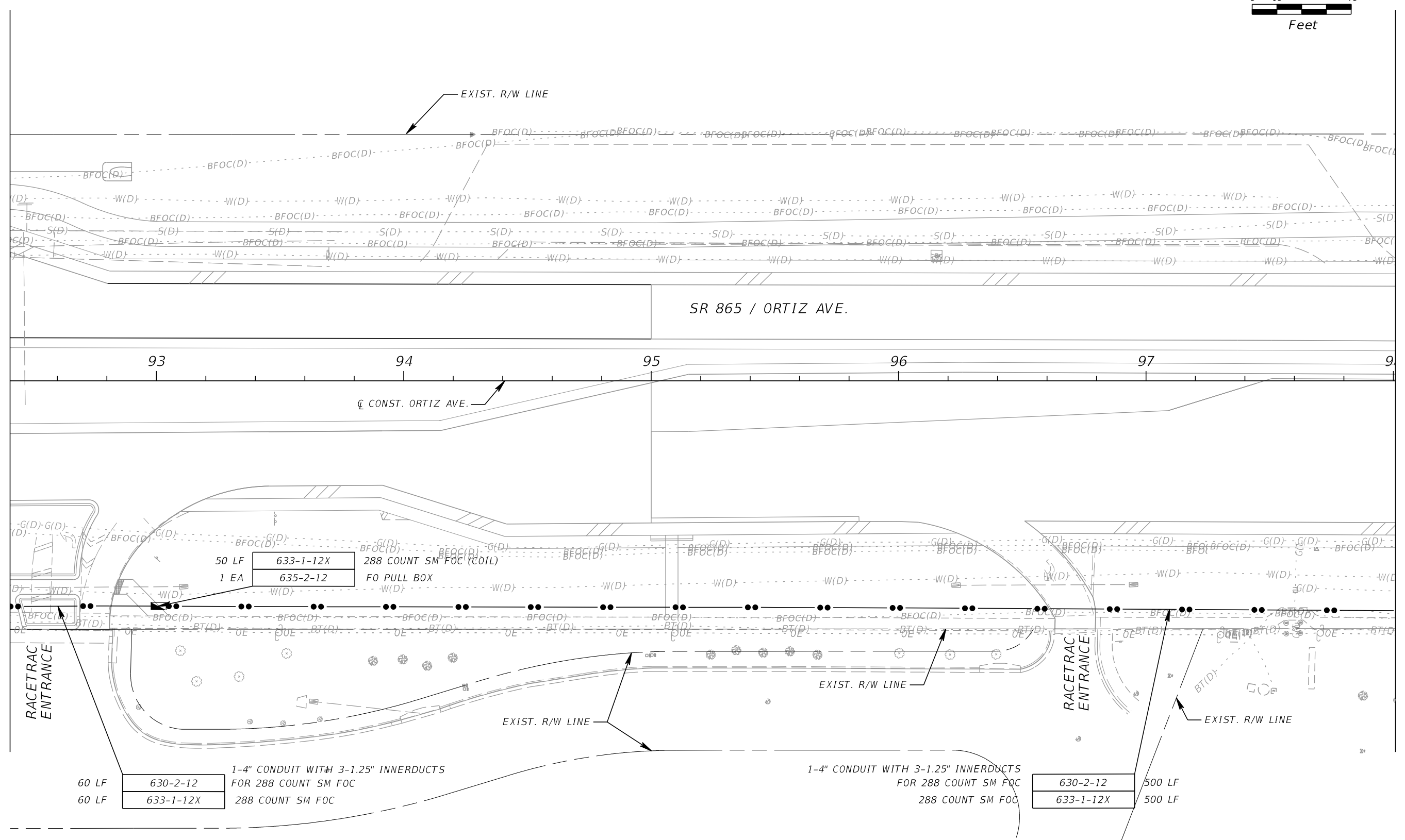

50 LF	633-1-12X	288 COUNT SM FOC (COIL)
1 EA	635-2-12	FO PULL BOX

60 LF	630-2-12	1-4" CONDUIT WITH 3-1.25" INNERDUCTS FOR 288 COUNT SM FOC
60 LF	633-1-12X	288 COUNT SM FOC

1-4" CONDUIT WITH 3-1.25" INNERDUCTS FOR 288 COUNT SM FOC
288 COUNT SM FOC

630-2-12	500 LF
633-1-12X	500 LF

REVISIONS			
DATE	DESCRIPTION	DATE	DESCRIPTION

**KCA**  
KISINGER CAMPO & ASSOCIATES P.E. No.: 81581

201 N. Franklin Street, Suite 400  
Tampa, Florida 33602  
Engineer of Record: Burak Konuk, P.E.

LEE COUNTY DEPARTMENT OF TRANSPORTATION		
ROAD	COUNTY	CONTRACT NO.
CR 865 (ORTIZ AVE.)	LEE COUNTY	CN18-8479

**ITS PLAN (16)**

SHEET NO.  
**IT-21**

THE OFFICIAL RECORD OF THIS SHEET IS THE ELECTRONIC FILE DIGITALLY SIGNED AND SEALED UNDER RULE 61G15-23.004, F.A.C.

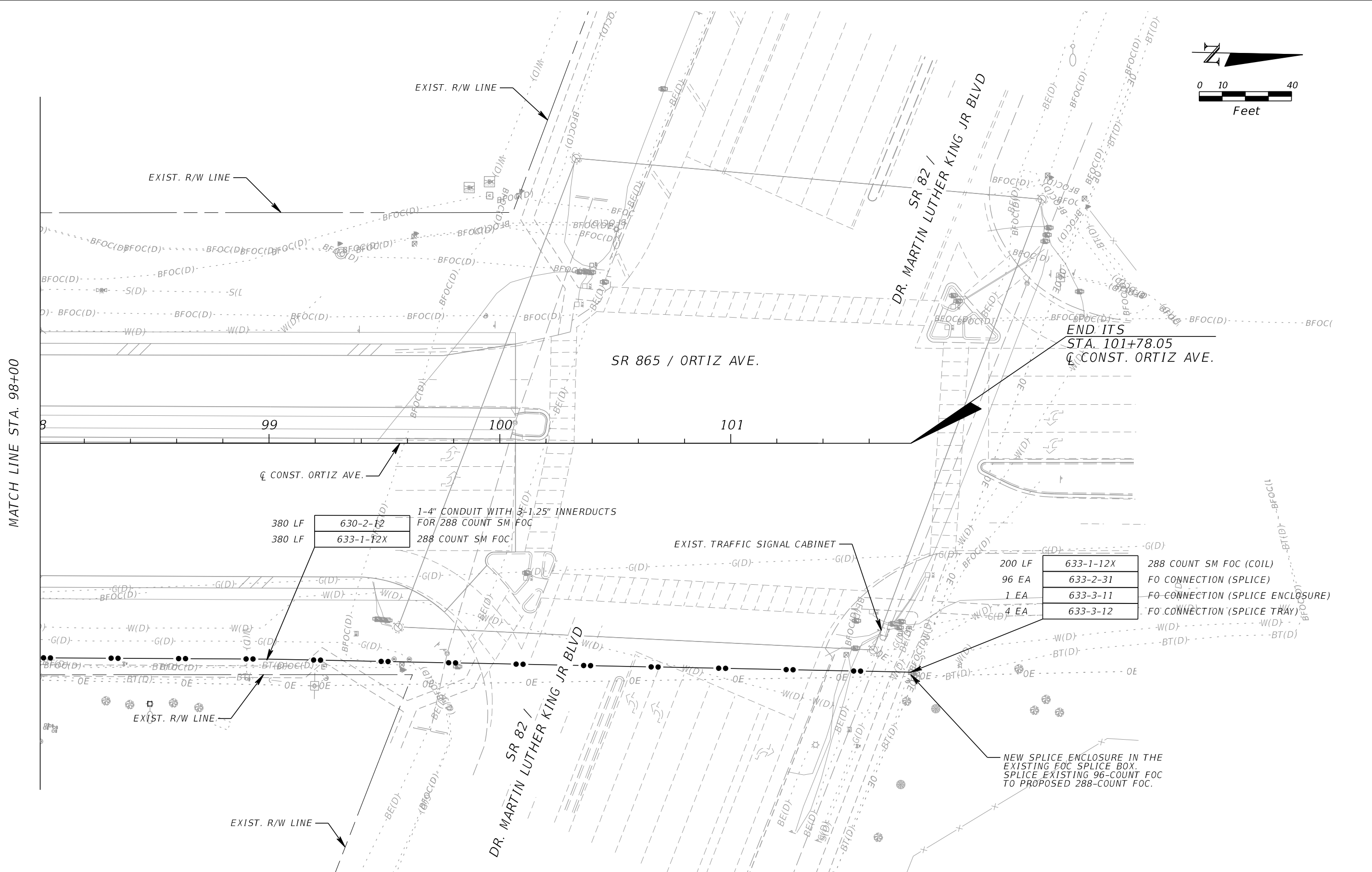
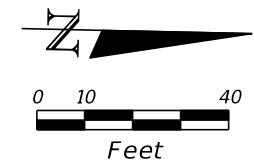

380 LF 630-2-12 1-4" CONDUIT WITH 3 1.25" INNERDUCTS FOR 288 COUNT SM FOC  
 380 LF 633-1-12X 288 COUNT SM FOC

200 LF 633-1-12X 288 COUNT SM FOC (COIL)  
 96 EA 633-2-31 FO CONNECTION (SPICE)  
 1 EA 633-3-11 FO CONNECTION (SPICE ENCLOSURE)  
 4 EA 633-3-12 FO CONNECTION (SPICE TRAY)

NEW SPICE ENCLOSURE IN THE EXISTING FOC SPICE BOX. SPICE EXISTING 96-COUNT FOC TO PROPOSED 288-COUNT FOC.

REVISIONS			
DATE	DESCRIPTION	DATE	DESCRIPTION

**KCA**  
 KISINGER CAMPO & ASSOCIATES P.E. No.: 81581  
 201 N. Franklin Street, Suite 400  
 Tampa, Florida 33602  
 Engineer of Record: Burak Konuk, P.E.

LEE COUNTY DEPARTMENT OF TRANSPORTATION		
ROAD	COUNTY	CONTRACT NO.
CR 865 (ORTIZ AVE.)	LEE COUNTY	CN18-8479

ITS PLAN (17)

SHEET NO.  
IT-22

THE OFFICIAL RECORD OF THIS SHEET IS THE ELECTRONIC FILE DIGITALLY SIGNED AND SEALED UNDER RULE 61G15-23.004, F.A.C.