

LEE COUNTY  
DEPARTMENT OF TRANSPORTATION

CONTRACT PLANS

FINANCIAL PROJECT ID 442123-1-58-01  
(FEDERAL FUNDS)

BUCKINGHAM RD AND GUNNERY RD ROUNDABOUT - LAP

LANDSCAPE PLANS

INDEX OF LANDSCAPING PLANS

SHEET NO.	SHEET DESCRIPTION
LD-1	KEY SHEET
LD-2	PROJECT LAYOUT
LD-3	GENERAL NOTES & MAINTENANCE NOTES
LD-4	LANDSCAPE PLAN (1)
LD-5	LANDSCAPE PLAN (2)
LD-6	LANDSCAPE PLAN (3)
LD-7	LANDSCAPE PLAN (4)
LD-8	LANDSCAPE DETAILS (1)
LD-9	LANDSCAPE DETAILS (2)
LD-10	TABULATION OF QUANTITIES AND PLANT SCHEDULE

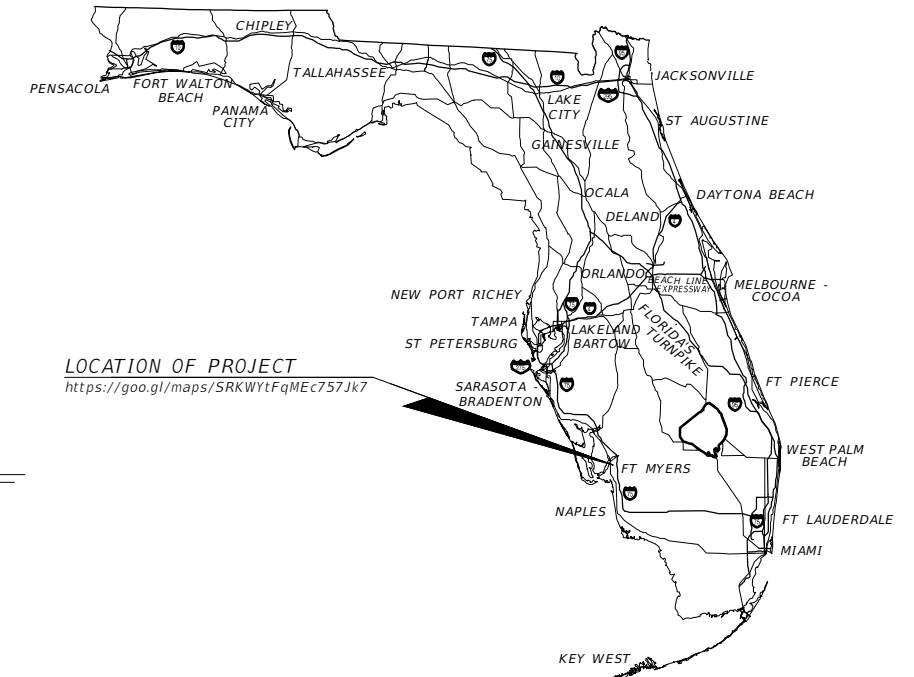

THE SEAL APPEARING ON THIS DOCUMENT  
WAS AUTHORIZED BY:

CHRIS JOHN SILEWSKI, LA. 6667396  
ON 2021.03.22

PRINTED COPIES OF THIS DOCUMENT ARE  
NOT CONSIDERED SIGNED AND SEALED  
AND THE SIGNATURE MUST BE VERIFIED  
ON ANY ELECTRONIC COPIES.

LANDSCAPING PLANS  
LANDSCAPE ARCHITECT OF RECORD:

CHRIS JOHN SILEWSKI, PLA.  
L.A. LICENSE NUMBER 6667396  
AYRES ASSOCIATES  
8875 HIDDEN RIVER PKWY., SUITE 200  
TAMPA, FL 33637  
813-978-8688

100 PERCENT PLANS  
MARCH 2021

LCDOT PROJECT MANAGER:

ALEJANDRO J. SLAIBE, P.E. \_\_\_\_\_

CONSTRUCTION CONTRACT NO.	FISCAL YEAR	SHEET NO.
-----	24	LD-1

1" = 100'

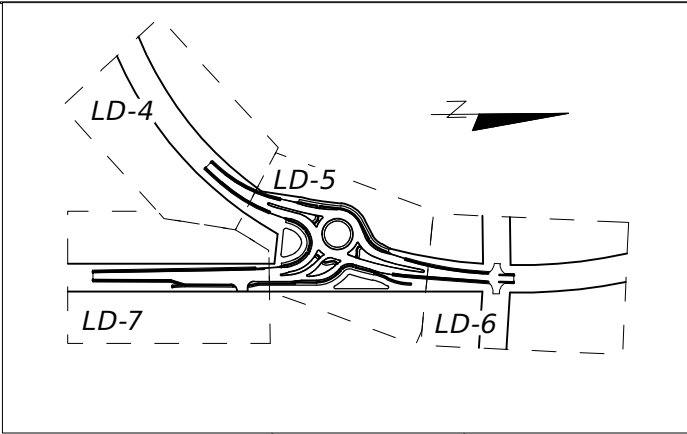

SHEET KEY | NTS

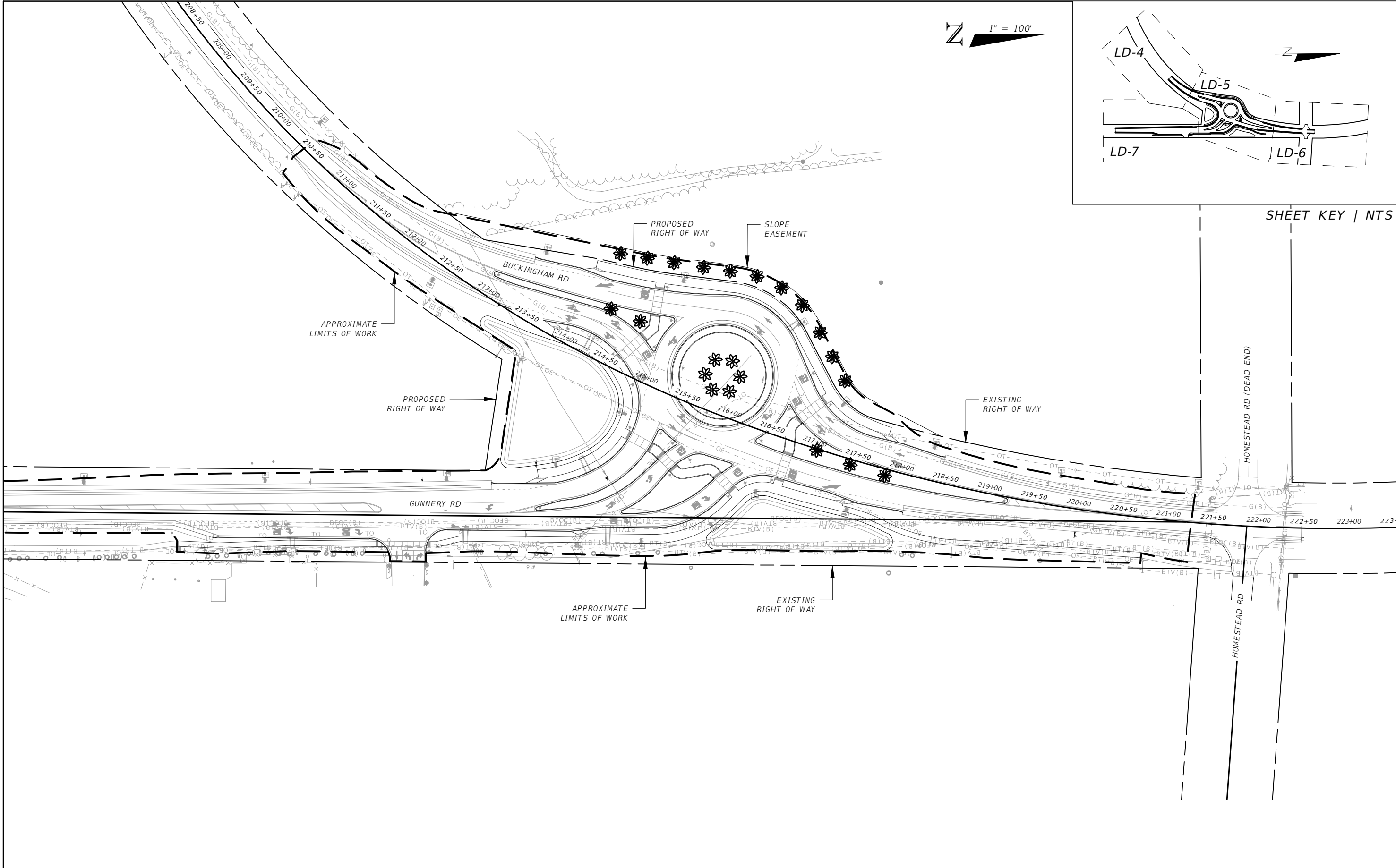

THE OFFICIAL RECORD OF THIS SHEET IS THE ELECTRONIC FILE DIGITALLY SIGNED AND SEALED UNDER RULE 61G10-11.011, F.A.C.

REVISIONS				CHRIS JOHN SILEWSKI, PLA L.A. LICENSE NUMBER 6667396 AYRES 8875 HIDDEN RIVER PKWY, SUITE 200 TAMPA, FL 33637		BUCKINGHAM RD AND GUNNERY RD ROUNDABOUT FINANCIAL PROJECT ID 442123-1-58-01	PROJECT LAYOUT BUCKINGHAM RD AND GUNNERY RD ROUNDABOUT		SHEET NO.
DATE	DESCRIPTION	DATE	DESCRIPTION						LD-2
---	---	---	---						

**GENERAL LANDSCAPE NOTES**

1. Roadway design speed planting limits are based on existing project design speed and required setbacks as found in FDOT Design Manual and FDOT Standard Plans:
2. FDOT Standard index numbers 506, 544, 600, 613, and 616 will be used for the earthwork, setbacks, clear zones, and maintenance of traffic for landscaping work, as well as the FDOT STANDARD PLANS 2020-2021
3. Criteria based on the FDOT 2020-2021 design manual in the 2011 AASHTO "Green Book".
4. No vegetation shall be placed in a manner where by official departmental traffic control signing would be discerned as being screened.
5. Prior to submission of bid, the contractor shall visit the site and fully inform themselves of the conditions, under which the work is to be accomplished.
6. The contractor to verify all utility locations, paving, and elevations, prior to start of work. Notify Lee County, in writing, of unsatisfactory conditions prior to start of work. Start of work will indicate acceptance of conditions and full responsibility for completing work.
7. Verify underground and above ground utility locations prior to any excavation. If underground utilities or obstructions maybe and/or are encountered during excavation of planting areas or pits, immediately inform Lee County. Alternate locations will be selected by Lee County. Such changes in location should be made by the contractor without additional compensation.
8. The contractor will bear sole responsibility for any and all damages that results from activities or work due to improper verification of utilities and/or operator error.
9. No plant material substitution should be made on this project without explicit written approval from FDOT, followed by the approval of Lee County.
10. Installation of palms and plants must not screen the vision of drivers and pedestrians, see FDOT 2020-2021 Standard Plans and 2020 Design Manual for Clear Site Limits or site visibility triangles at intersections. Coordinate so as not to obstruct the visibility of directional, informational, or traffic control signs as well as traffic signals. Field adjust Palms and Palm locations with Lee County construction representative as required to avoid conflict with light poles, sign supports, utility poles, walls and fences, etc.
11. Lee County construction representatives reserve the right to make minor adjustments, in the field, to the locations of palms and shrubs in ground covers. All areas with in the drip line of a protected tree should maintain their original grade and soil compaction.
12. The contractor shall be responsible for providing proper drainage for all palms and plant materials. Palms set too high or too low may be rejected. Verify proposed finish grades with Lee County and set palms accordingly. See FDOT palm planting details for planting, staking, and guying.
13. The contractor shall be responsible for properly securing all palms and large shrubs immediately after planting. All guy wires shall be flagged, and all stakes shall be driven flush with surrounding grade for Public Safety.
14. Landscape contractor shall be responsible for maintaining and watering required for the establishment and proper maintenance of plant materials from the date of installation to the date of final warranty.
15. Bed lines shall have well-defined trench edges to contain mulch. Bed lines shall be laid out with string line for straight lines, curved bed edges are to be smooth and continues per plan layout. Palms or shrubs shown in a line on the plans shall have the trunks/canopies in proper alignment upon visual inspection after installation.
16. At the time of substantial approval the contractor shall provide Lee County, with a maintenance manual containing instructions for the proper care of all material specified to the job, and any pertinent manufactures literature to Lee County.
17. All landscape materials must be installed and maintained in accordance with FDOT Standard Plans, FDOT Design Manual and all other applicable 2020-2021 department standards, plans and regulations.
18. Application of herbicides shall be performed by a person possessing a current Florida Restricted Use Pesticide License in the Core Curriculum, right of way and aquatic categories.
19. Pursuant to section 2.10 of the departments "Roadway in roadside maintenance" procedure (topic number 850-0 00-015-1 of 01/01/2014), all contractors who contract the application of fertilizer shall ensure that they are licensed commercial applicator's who have been trained through the green industry BMP program, and have obtained a limited certification for Urban commercial fertilizer application under section 482. 1562. The contractor shall furnish the FDOT current copies of license/certifications belonging to the personnel that will be involved in the application or fertilizer on the FDOT right of way prior to start of work.

**MAINTENANCE NOTES**

1. As per 2020-2021 FDOT design manual chapter 212
  - 1.0.1. When vegetation extends over a travel lane, a minimum vertical clearance of 14.5 feet to the bottom of the tree canopy from the finish grade of the travel lane, this shall be maintained at all times
  - 1.0.2. A minimum vertical clearance of 8.5 feet between the bottom canopy of all foliage and the finish grade of sidewalks and medians shall be maintained at all times.
  - 1.0.3. All Ground covers and shrubs shall be at all times maintained in a manner where by they do not grow within the outside or inside edges of the curb.

All shrubs shall be maintained so they are never taller than 2'-0" measured from surface of travel lane to the center portions of the median

2. The project falls within the USDA Zone 10a, with minimum temps between 30-35 degrees F. It would be prudent to recommend plants that will be able to endure low temperatures such as 9b (25-30 degrees). Summers are typically very hot and humid with frequent rainfalls. Intense temperatures in the man-made environment of the the Buckingham Rd and Gunnery Rd medians will be excessive, as it is surrounded by concrete. The evening temps will have the tendency to be very warm for late into the evenings. This will have the result of the soils drying out and being much drier than the surrounding soils in a more cohesive greenspace. Supplemental truck watering irrigation will be required to establish the plantings and during the dry spring months, as well as dry fall months. This shall be provided on an annual basis by Lee County, if plantings are to thrive.
3. Litter Pickup:
 

Litter shall be removed before mowing any area. This shall be the responsibility of Lee County. The landscape has the ability to capture trash from blowing winds and it will accumulate trash more regularly than short mowed sod. Litter will be removed weekly or semi-weekly as required to keep the landscape tidy and trash free.
4. Mowing:
 

Bahia sod is only used outside of the shoulders within the approximate limits of work and in the drainage ponds. These areas should still be mowed to assist in minimizing large weed growth. This shall be done at least five times a year, twice in summer (July and September), once in mid-winter (December) and once in spring (March) and again in early summer (May). The mowing shall be to a height of 3". This is to remove the seed heads from weeds and help control invasive weeds.
5. Weeding:
 

Use of herbicides is encouraged only within plant beds, to minimize hand pulling of weeds in the medians of the busy roadway. Read manufacturer's directions before applying herbicide to any of the beds. Care should be taken not to over spray onto the leaves of the desired landscape plantings. Weeding shall be every other week, for the first 6 months, then monthly in Summer (June-September) and then bi-monthly from October through May.

6. Mulch:

Frequent observation and replacement of Pine Bark Mulch as required, to maintain a minimum 3" cover will help reduce invasive weeds. This should be considered at least once a year for a full mulching and annual spot mulching. Mulch has proven to be effective at reestablishing soil fungus and helping plantings thrive.

7. Pruning:

Plants were selected for their small size and pruning should not be required other than an annual trimming of overhanging or dead fronds. Dead palm fronds need to be removed as soon as they are seen. Frond and date (flower) removal should take place in early Spring (March) when the Palms first show signs of setting flowers. Pruning should take place again in late summer before the palm dates are set, if any got missed in spring which is after the growing season (November) (See Maintenance Calendar)

Maintain all shrubs to a height of 18" or less. Maintain all Palms to a single trunk.

8. Fertilization:

Palms, shrubs and groundcovers shall be fertilized annually in March. Use a Time-release Osmocote™ or equal, and according to manufacturer's recommendations based on plant material. No fertilization will be allowed in Summer as per local water regulations. Boron deficiency is common in the landscape with Palms. Heavy watering during establishment, high pH water, soil conditions or the genetics of the trees provided by the grower are among possible causes. Another important issue with all palms is quality, frequency and amount of fertilizer used. An 8-2-12-4 product with a coated Boron which is a 3-4-month mix is recommended. Contractor to provide a submittal with the fertilizer information for approval.

9. Watering:

Water trucks will be used to water plants after the 12-month warranty period is completed by the contractor. This will need to be accompanied by a MOT plan for the trucks during the watering period. Watering frequency will vary based on the time of year. The spring months of March through June will require almost weekly watering until the plantings are established. Monitor watering in summer for periods of low rainfall and high temps. Water as needed based on weather conditions and any signs of wilt in the more tender plantings. October will probably require supplemental watering because of warm temperatures and little rainfall. Little watering will be needed from November through February

THE OFFICIAL RECORD OF THIS SHEET IS THE ELECTRONIC FILE DIGITALLY SIGNED AND SEALED UNDER RULE 61G10-11.011, F.A.C.

R E V I S I O N S				CHRIS JOHN SILEWSKI, PLA L.A. LICENSE NUMBER 6667396 AYRES 8875 HIDDEN RIVER PKWY, SUITE 200 TAMPA, FL 33637		BUCKINGHAM RD AND GUNNERY RD ROUNDABOUT	<b>GENERAL NOTES &amp; MAINTENANCE NOTES BUCKINGHAM RD AND GUNNERY RD ROUNDABOUT</b>	SHEET NO.
DATE	DESCRIPTION	DATE	DESCRIPTION			FINANCIAL PROJECT ID		LD-3
---	---					442123-1-58-01		

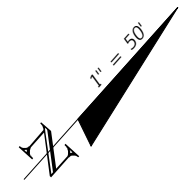
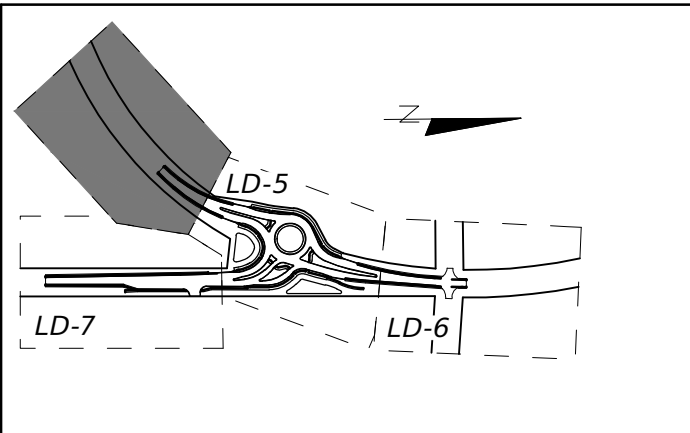

SHEET KEY | NTS

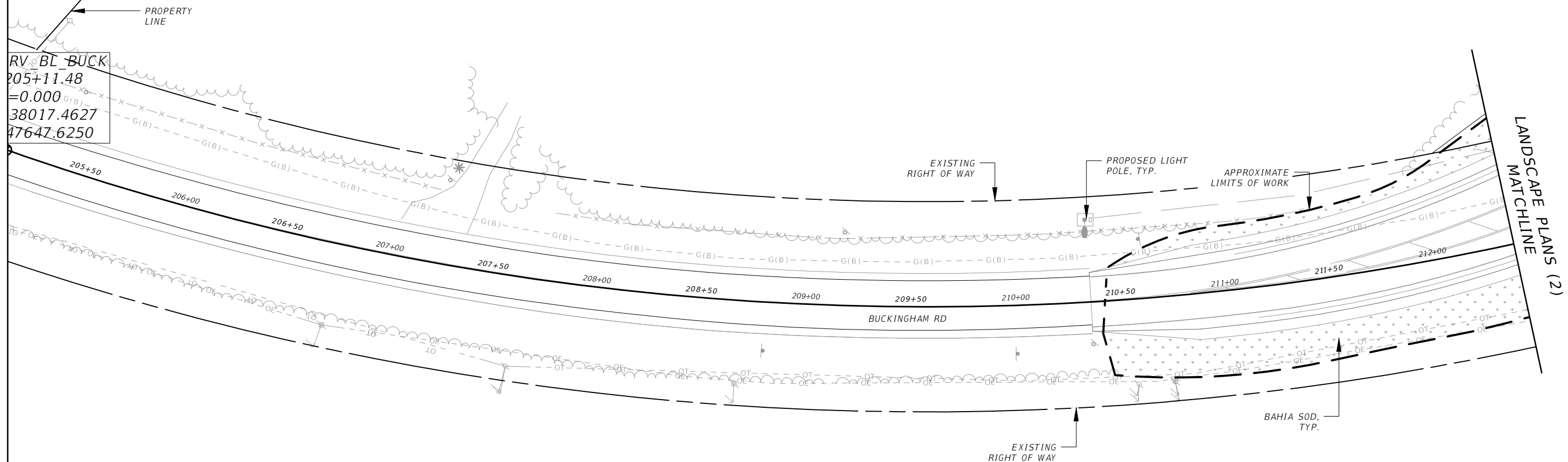

LANDSCAPE PLANS (2)  
MATCHLINE

RV BL BUCK  
205+11.48  
=0.000 G(B)  
38017.4627  
47647.6250

TREE SCHEDULE	
PALM TREES	BOTANICAL / COMMON NAME
PS	PHOENIX SYLVESTRIS / WILD DATE PALM
SP	SABAL PALMETTO / CABBAGE PALMETTO
SHRUB SCHEDULE	
SHRUBS	BOTANICAL / COMMON NAME
MUC	MUHLENBERGIA CAPILLARIS / PINK MUHLY GRASS
ZAP	ZAMIA PUMILA / COONTIE
PLANT SCHEDULE	
GROUND COVERS	BOTANICAL / COMMON NAME
	BAHIA SOD

LEGEND	
EXISTING RIGHT-OF-WAY	---
PROPOSED RIGHT-OF-WAY	---
APPROX. LIMITS OF WORK	---
EXISTING WATER MAIN	---W(D)---
EXISTING SANITARY	---S(D)---
EXISTING GAS	---G(D)---
EXISTING OVERHEAD TELEPHONE	---OT---
EXISTING BURIED TELEPHONE	---BT(D)---
EXISTING OVERHEAD ELECTRIC	---OE---
EXISTING BURIED ELECTRIC	---BE---
EXISTING BURIED FIBER OPTIC	---BF(D)---
EXISTING BURIED CABLE TV	---BTV(D)---
PINE BARK MULCH	[Symbol]

REVISIONS			
DATE	DESCRIPTION	DATE	DESCRIPTION
---	---	---	---

CHRIS JOHN SILEWSKI, PLA  
L.A. LICENSE NUMBER 6667396  
AYRES  
8875 HIDDEN RIVER PKWY,  
SUITE 200  
TAMPA, FL 33637



BUCKINGHAM RD AND GUNNERY RD  
ROUNDAABOUT  
FINANCIAL PROJECT ID  
442123-1-58-01

LANDSCAPE PLANS (1)  
BUCKINGHAM RD AND  
GUNNERY RD ROUNDAABOUT

SHEET NO.  
LD-4

THE OFFICIAL RECORD OF THIS SHEET IS THE ELECTRONIC FILE DIGITALLY SIGNED AND SEALED UNDER RULE 61G10-11.011, F.A.C.

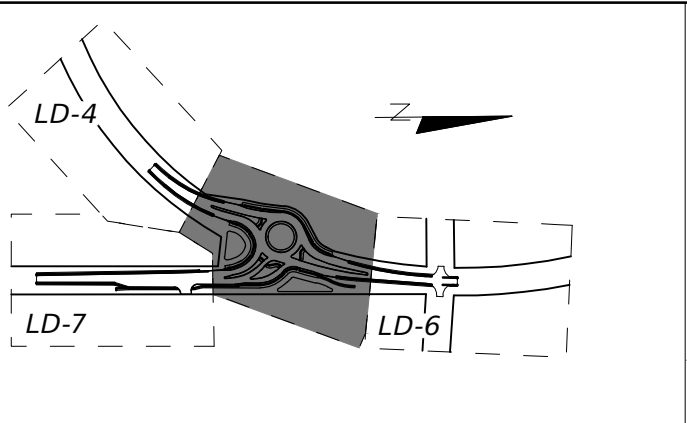

TREE SCHEDULE	
PALM TREES	BOTANICAL / COMMON NAME
PS	PHOENIX SYLVESTRIS / WILD DATE PALM
SP	SABAL PALMETTO / CABBAGE PALMETTO

SHRUB SCHEDULE	
SHRUBS	BOTANICAL / COMMON NAME
MUC	MUHLENBERGIA CAPILLARIS / PINK MUHLY GRASS
ZAP	ZAMIA PUMILA / COONTIE

PLANT SCHEDULE	
GROUND COVERS	BOTANICAL / COMMON NAME
	BAHIA SOD

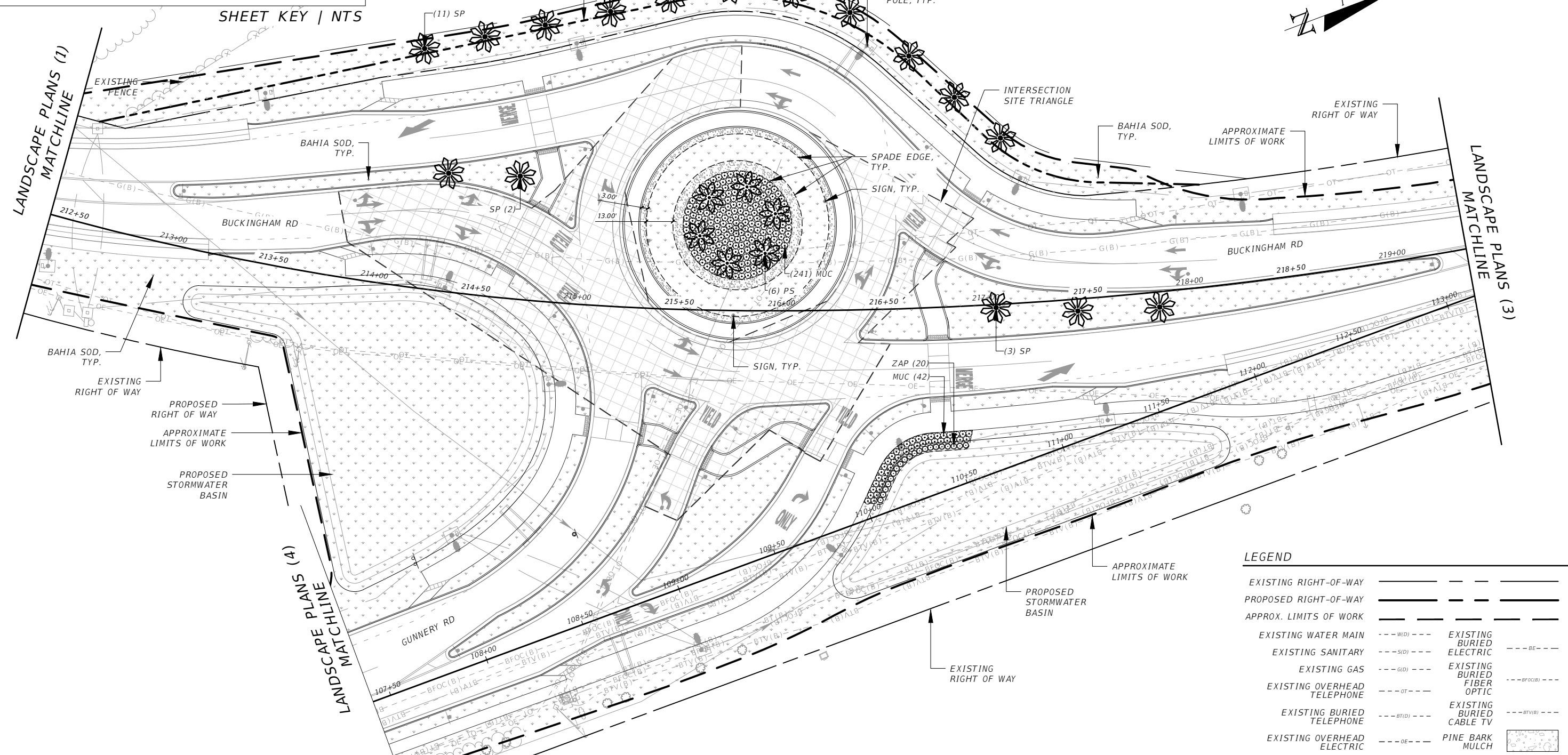

LEGEND	
EXISTING RIGHT-OF-WAY	---
PROPOSED RIGHT-OF-WAY	---
APPROX. LIMITS OF WORK	---
EXISTING WATER MAIN	---(W(D))---
EXISTING SANITARY	---(S(D))---
EXISTING GAS	---(G(D))---
EXISTING OVERHEAD TELEPHONE	---(OT)---
EXISTING BURIED TELEPHONE	---(BT(D))---
EXISTING OVERHEAD ELECTRIC	---(OE)---
EXISTING BURIED ELECTRIC	---(BE)---
EXISTING BURIED FIBER OPTIC	---(BFOC(B))---
EXISTING BURIED CABLE TV	---(BTV(B))---
PINE BARK MULCH	[Symbol]

REVISIONS			
DATE	DESCRIPTION	DATE	DESCRIPTION

CHRIS JOHN SILEWSKI, PLA  
 L.A. LICENSE NUMBER 6667396  
 AYRES  
 8875 HIDDEN RIVER PKWY,  
 SUITE 200  
 TAMPA, FL 33637



BUCKINGHAM RD AND GUNNERY RD  
 ROUNDABOUT  
 FINANCIAL PROJECT ID  
 442123-1-58-01

**LANDSCAPE PLANS (2)**  
**BUCKINGHAM RD AND**  
**GUNNERY RD ROUNDABOUT**

SHEET NO.  
 LD-5

THE OFFICIAL RECORD OF THIS SHEET IS THE ELECTRONIC FILE DIGITALLY SIGNED AND SEALED UNDER RULE 61G10-11.011, F.A.C.

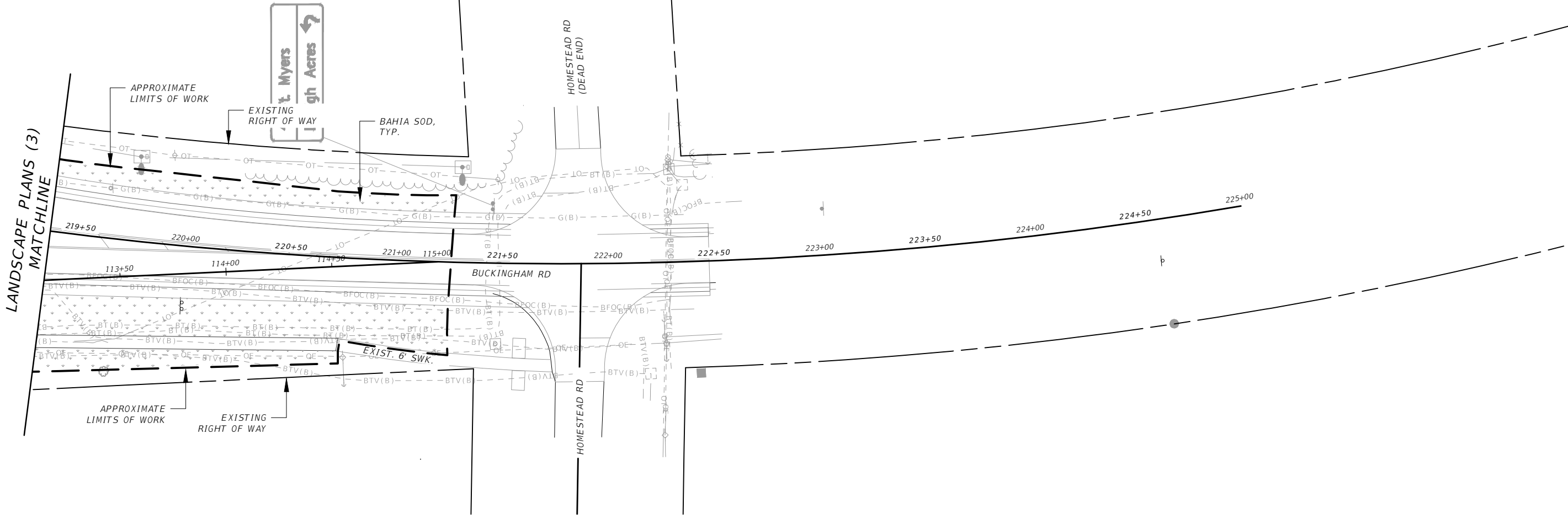
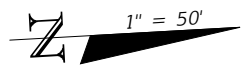
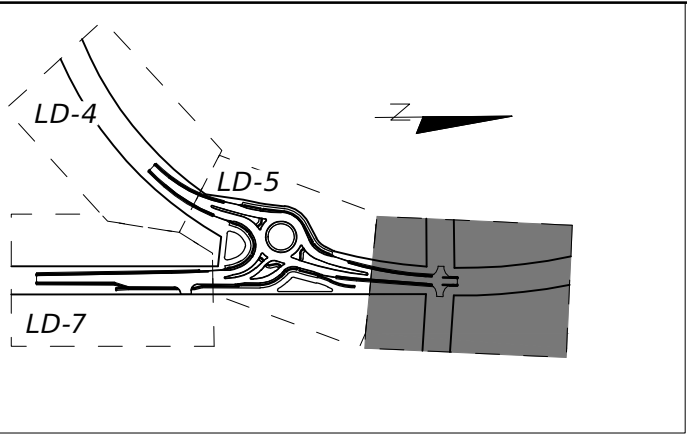

TREE SCHEDULE	
PALM TREES	BOTANICAL / COMMON NAME
PS	PHOENIX SYLVESTRIS / WILD DATE PALM
SP	SABAL PALMETTO / CABBAGE PALMETTO

SHRUB SCHEDULE	
SHRUBS	BOTANICAL / COMMON NAME
MUC	MUHLENBERGIA CAPILLARIS / PINK MUHLY GRASS
ZAP	ZAMIA PUMILA / COONTIE

PLANT SCHEDULE	
GROUND COVERS	BOTANICAL / COMMON NAME
[Symbol]	BAHIA SOD

LEGEND	
EXISTING RIGHT-OF-WAY	[Symbol]
PROPOSED RIGHT-OF-WAY	[Symbol]
APPROX. LIMITS OF WORK	[Symbol]
EXISTING WATER MAIN	[Symbol] EXISTING BURIED ELECTRIC
EXISTING SANITARY	[Symbol] EXISTING BURIED FIBER OPTIC
EXISTING GAS	[Symbol] EXISTING BURIED CABLE TV
EXISTING OVERHEAD TELEPHONE	[Symbol] EXISTING OVERHEAD ELECTRIC
EXISTING BURIED TELEPHONE	[Symbol] PINE BARK MULCH

REVISIONS			
DATE	DESCRIPTION	DATE	DESCRIPTION
---	---	---	---

CHRIS JOHN SILEWSKI, PLA  
 L.A. LICENSE NUMBER 6667396  
 AYRES  
 8875 HIDDEN RIVER PKWY,  
 SUITE 200  
 TAMPA, FL 33637



BUCKINGHAM RD AND GUNNERY RD  
 ROUNDABOUT  
 FINANCIAL PROJECT ID  
 442123-1-58-01

**LANDSCAPE PLANS (3)  
 BUCKINGHAM RD AND  
 GUNNERY RD ROUNDABOUT**

SHEET NO.  
 LD-6

THE OFFICIAL RECORD OF THIS SHEET IS THE ELECTRONIC FILE DIGITALLY SIGNED AND SEALED UNDER RULE 61G10-11.011, F.A.C.

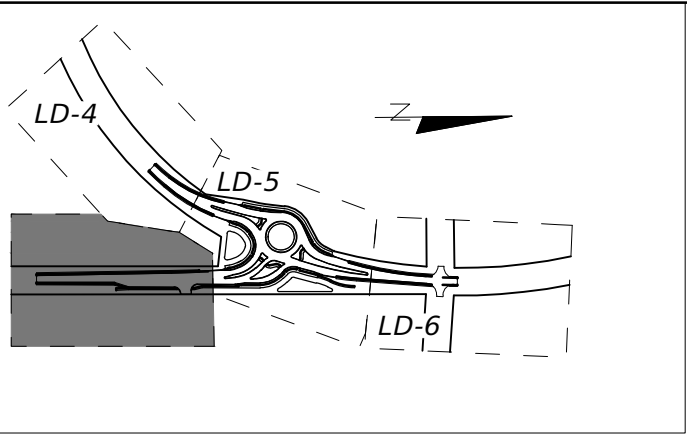

SHEET KEY | NTS

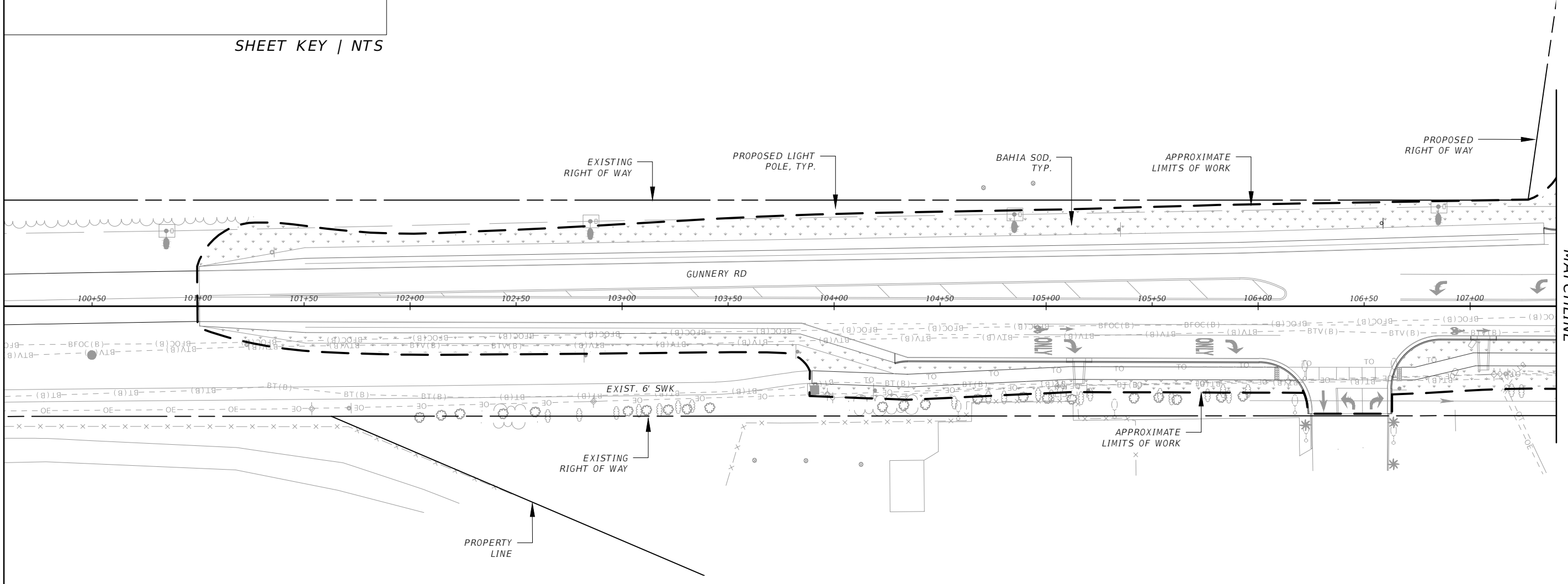
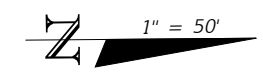

LANDSCAPE PLANS (2)  
MATCHLINE

TREE SCHEDULE	
PALM TREES	BOTANICAL / COMMON NAME
PS	PHOENIX SYLVESTRIS / WILD DATE PALM
SP	SABAL PALMETTO / CABBAGE PALMETTO

SHRUB SCHEDULE	
SHRUBS	BOTANICAL / COMMON NAME
MUC	MUHLENBERGIA CAPILLARIS / PINK MUHLY GRASS
ZAP	ZAMIA PUMILA / COONTIE

PLANT SCHEDULE	
GROUND COVERS	BOTANICAL / COMMON NAME
[Symbol]	BAHIA SOD

LEGEND	
EXISTING RIGHT-OF-WAY	[Symbol]
PROPOSED RIGHT-OF-WAY	[Symbol]
APPROX. LIMITS OF WORK	[Symbol]
EXISTING WATER MAIN	[Symbol] EXISTING BURIED ELECTRIC
EXISTING SANITARY	[Symbol] EXISTING BURIED FIBER OPTIC
EXISTING GAS	[Symbol] EXISTING BURIED CABLE TV
EXISTING OVERHEAD TELEPHONE	[Symbol] EXISTING OVERHEAD ELECTRIC
EXISTING BURIED TELEPHONE	[Symbol] PINE BARK MULCH

REVISIONS			
DATE	DESCRIPTION	DATE	DESCRIPTION
---	---	---	---

CHRIS JOHN SILEWSKI, PLA  
L.A. LICENSE NUMBER 6667396  
AYRES  
8875 HIDDEN RIVER PKWY,  
SUITE 200  
TAMPA, FL 33637



BUCKINGHAM RD AND GUNNERY RD  
ROUNDBOUT  
FINANCIAL PROJECT ID  
442123-1-58-01

LANDSCAPE PLANS (4)  
BUCKINGHAM RD AND  
GUNNERY RD ROUNDBOUT

SHEET NO.  
LD-7

THE OFFICIAL RECORD OF THIS SHEET IS THE ELECTRONIC FILE DIGITALLY SIGNED AND SEALED UNDER RULE 61G10-11.011, F.A.C.

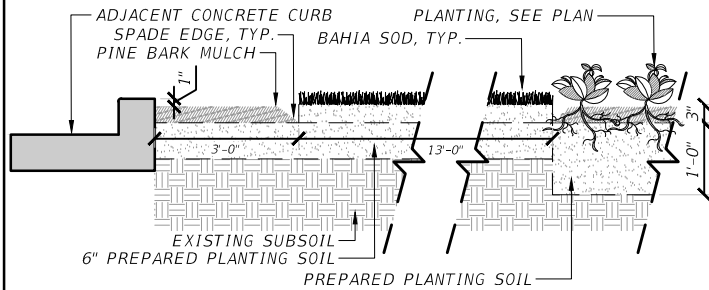

**A ROAD ISLAND EDGE CONDITIONS**  
NTS P-BU-03

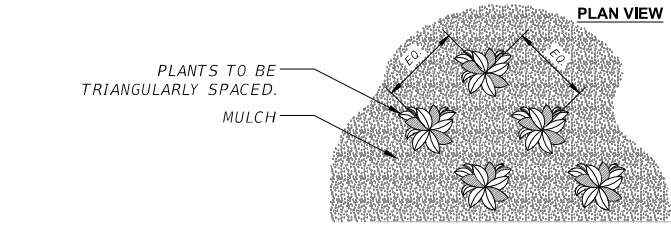
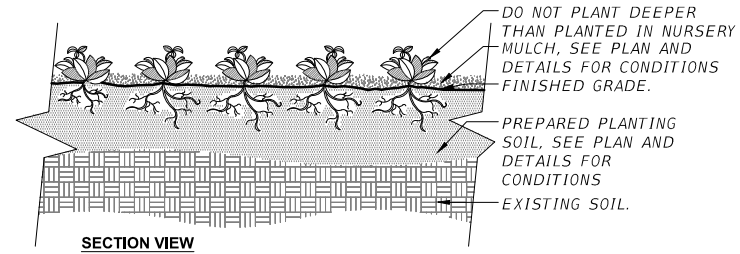

**NOTES:**  
 1- SEE PLANTING SCHEDULE FOR PLANT SPECIES, SIZE, AND SPACING DIMENSION.  
 2- SMALL ROOTS (1/4" OR LESS) THAT GROW AROUND, UP, OR DOWN THE ROOT BALL PERIPHERY ARE CONSIDERED A NORMAL CONDITION IN CONTAINER PRODUCTION AND ARE ACCEPTABLE HOWEVER THEY SHOULD BE ELIMINATED AT THE TIME OF PLANTING. ROOTS ON THE PERIPHERY CAN BE REMOVED AT THE TIME OF PLANTING.  
 3- SETTLE SOIL AROUND ROOT BALL OF EACH PLANT PRIOR TO MULCHING.

**B SHRUB AND PERENNIAL CONTAINER PLANTING**  
3/4" = 1'-0"

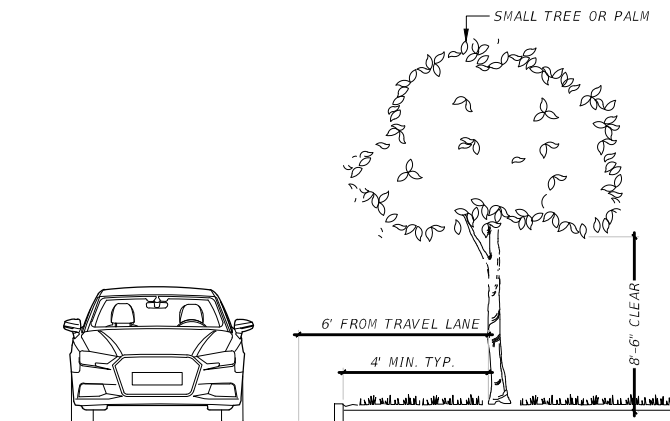

**C LATERAL OFFSET TO TREES IN MEDIAN**  
NTS P-BU-08

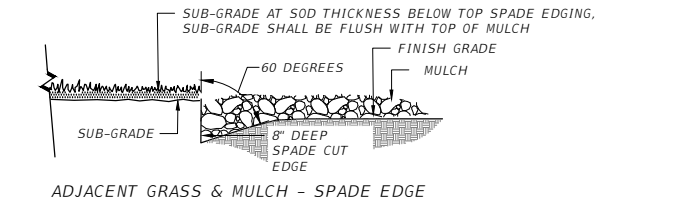

**D SPADE EDGE CONDITION**  
NTS P-BU-07



**E VERTICAL CLEARANCE FOR PALMS**  
1/4" = 1'-0" P-BU-11

REVISIONS				CHRIS JOHN SILEWSKI, PLA L.A. LICENSE NUMBER 6667396 AYRES 8875 HIDDEN RIVER PKWY, SUITE 200 TAMPA, FL 33637		BUCKINGHAM RD AND GUNNERY RD ROUNDAABOUT FINANCIAL PROJECT ID 442123-1-58-01	<b>LANDSCAPE DETAILS (1)</b> <b>BUCKINGHAM RD AND</b> <b>GUNNERY RD ROUNDAABOUT</b>	SHEET NO.
DATE	DESCRIPTION	DATE	DESCRIPTION					LD-8
---	---	---	---					



**GENERAL NOTES:**

1. Staking guidelines are based on standard horticultural requirements and are provided for plant establishment purposes only. Details not intended to apply when bracing is intended to address safety considerations. When bracing for safety, refer to Designer generated signed and sealed details. These guidelines are not intended to apply when the tree or palm is within falling distance of a roadway, pedestrian or bicycle route, under extreme wind loads, non-standard soil properties, non-standard plant dimensions, or when rootball is anticipated to be greater than 4 feet diameter and planted on 1:3 slope or steeper.
2. All dimensions 6" and less are exaggerated for illustrative purposes only. Dimensions shown for wood materials are nominal. Slopes shown are Vertical:Horizontal.
3. Remove plant containers prior to planting. Remove a minimum of the top 1/3 of burlap, fabric, or wire mesh for plants not grown in containers.
4. Allow no more than 1" of soil to cover the uppermost root on all trees. Set the top of rootball 1"-2" above finish grade after settling and set plumb to the horizon.
5. Backfill with loosened existing soil or as shown in the plans. Remove rocks, sticks, or other deleterious material greater than 1" in any direction prior to backfilling. Water and tamp to remove air pockets. Contact the Engineer prior to planting if existing soils contain excessive sand, clay, or other material not conducive to proper plant growth.
6. Construct soil rings at the outer edge of the planting pit with a height of 3" and gently sloping sides unless a permanent, subsurface or drip irrigation system is provided. Do not pile soil on top of rootball.
7. Construct a 3" deep layer of mulch placed 2" off the edge of the trunk flare, around the base of shrub, or solidly around ground cover. Never pile mulch against the tree trunk.
8. Install guying with minimum 1" wide nylon or polypropylene straps with a minimum 600 lb. break strength. Check straps monthly and adjust as required to eliminate girdling of tree. Locate all wood stakes beyond the edge of soil ring in existing soil and embed a minimum of 18" below finished grade unless otherwise specified. Alternate tree bracing and guying systems specified or approved by the Engineer may be used in lieu of the tree bracing and guying methods detailed on the Index.
9. Relocated Trees and Palms: Brace relocated trees and palms in accordance with the Contract Documents. Remove bracing at the conclusion of the contract or as directed by the Engineer. Bracing or straps must not damage or become embedded in the tree bark.
10. Use 2" x 2" minimum wood stakes unless otherwise shown in the Plans or directed by the Engineer. Use wood meeting #2 Common or better in accordance with the Standard Grading Rules for Southern Pine.
11. Drive stakes into existing, undisturbed soil. Localized compaction may be provided to prevent displacement of the stakes for previously disturbed existing soils that do not provide sufficient stability.

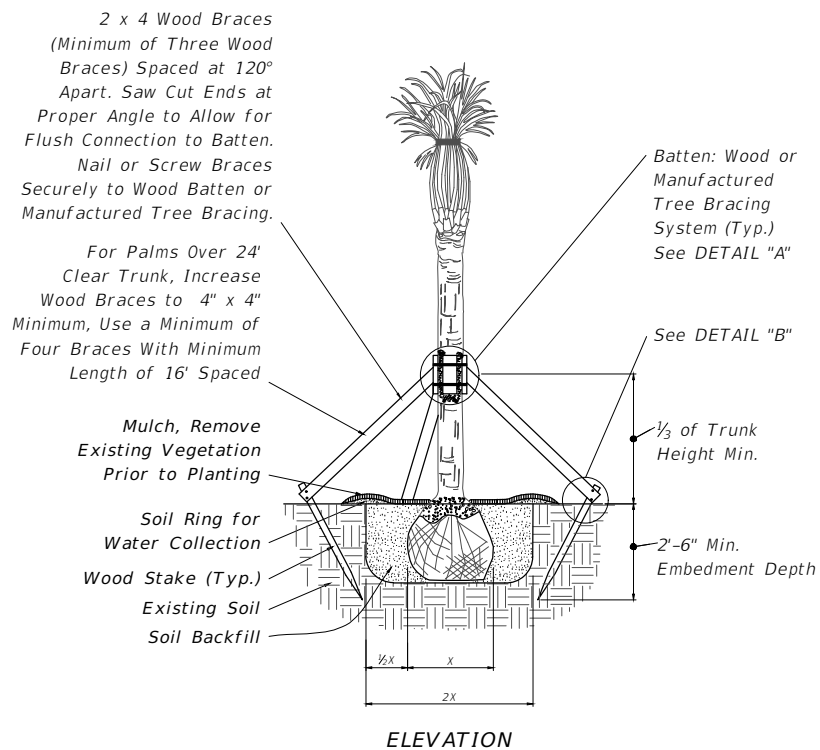

ELEVATION

NOTE: May be used on large caliper canopy trees, adjust banding every 6 months or as needed (for fast growing species) to prevent girdling.

PALM PLANTING

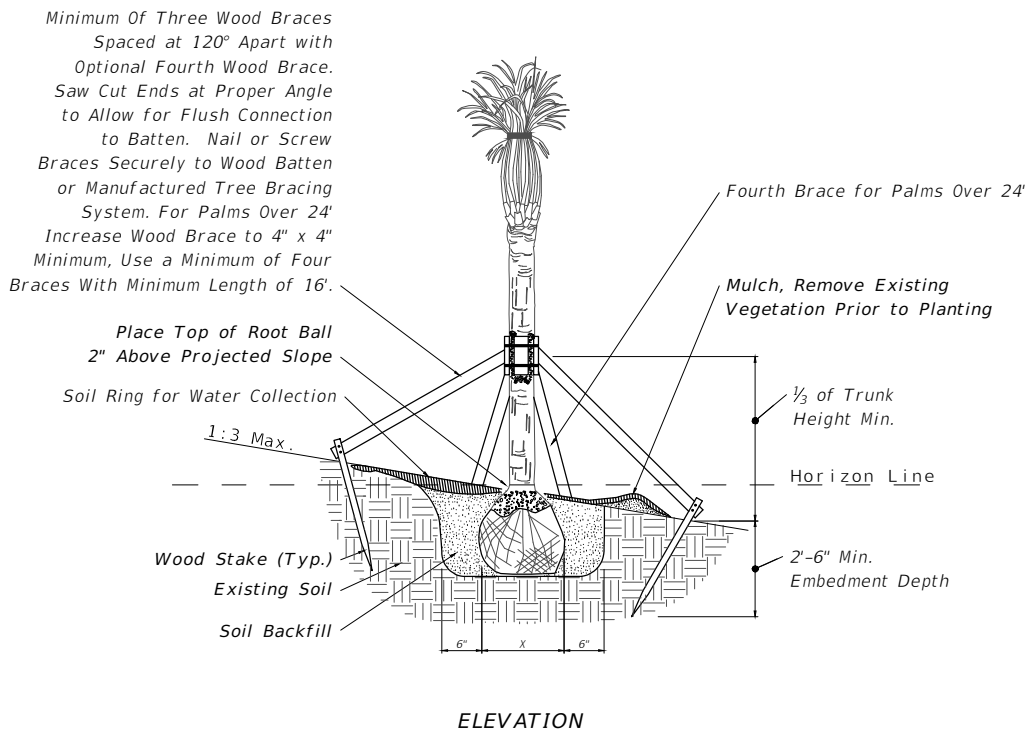

ELEVATION

NOTE: May be used on large caliper canopy trees pending slope and rootball width, adjust banding every 6 months or as needed (for fast growing species) to prevent girdling.

PALM PLANTING ON SLOPE

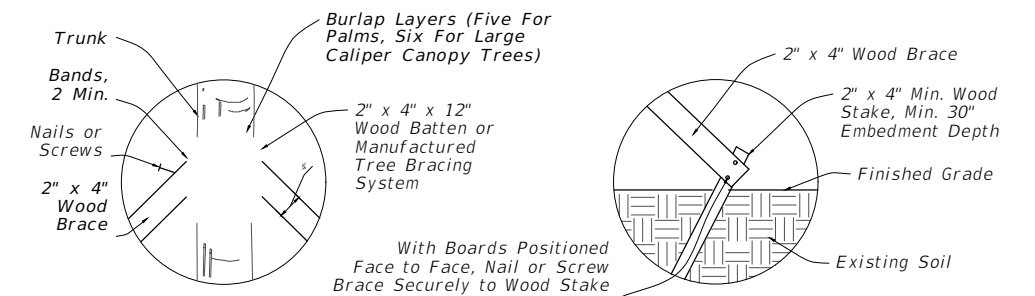

NOTE: Install bands and couplings that are rated a min. 900 lb. tensile strength, and are corrosion and UV resistant.

NOTE: Stake Into Firm, Existing Soil.

DETAIL "A"

DETAIL "B"

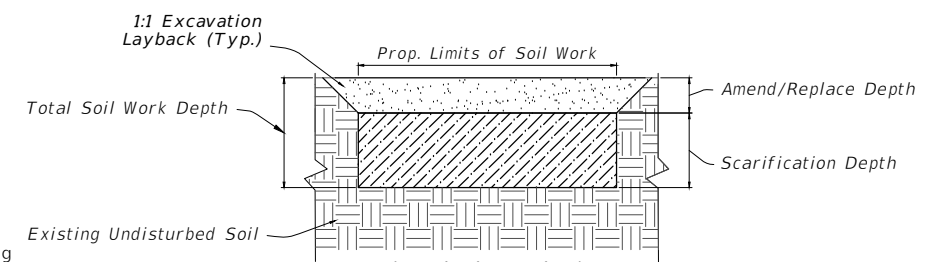

(Typical Section)

LANDSCAPE SOIL WORK

REVISIONS				CHRIS JOHN SILEWSKI, PLA L.A. LICENSE NUMBER 6667396 AYRES 8875 HIDDEN RIVER PKWY, SUITE 200 TAMPA, FL 33637		BUCKINGHAM RD AND GUNNERY RD ROUNDAABOUT FINANCIAL PROJECT ID 442123-1-58-01	<b>LANDSCAPE DETAILS (2)</b> <b>BUCKINGHAM RD AND</b> <b>GUNNERY RD ROUNDAABOUT</b>	SHEET NO.
DATE	DESCRIPTION	DATE	DESCRIPTION					LD-9
---	---	---	---					

**GENERAL BID ITEMS**

PAY ITEM NO.	Description	NOTES	UNIT	TOTAL
0570 1 2	Prepared Planting Soils	SEE PLANS, DETAILS AND SPECIFICATIONS	CY	<b>1150</b>
	Spade Edge	SEE PLANS, DETAILS AND SPECIFICATIONS	LF	<b>552</b>
0580 12 10	Pine Bark Mulch (3" Depth)	SEE PLANS, DETAILS AND SPECIFICATIONS	CY	<b>43</b>

**TABULATION OF QUANTITIES FOR PLANT MATERIAL**

PAY ITEM NO.	SYM.	BOTANICAL NAME	COMMON NAME	INSTALLED SIZE	MAX. MAINTAINED SIZE	SPACING	REMARKS	UNIT	TOTAL	SHEET NUMBERS							
										LD-4		LD-5		LD-6		LD-7	
										PLAN	FINAL	PLAN	FINAL	PLAN	FINAL	PLAN	FINAL
0570 1 2	PLAN	ARGENTINE BAHIA	BAHIA SOD	SOD	N/A	SOD	SOD	SY	<b>SEE ROADWAY</b>	-	-	-	-	-	-	-	-
0580 1 1	MUC	MUHLENBERGIA CAPILLARIS	PINK MUHLY GRASS	18" HT MIN.	N/A	3' O.C.	7 GAL.	EA	<b>283</b>	-	-	283	-	-	-	-	-
0580 1 2	ZAP	ZAMIA PUMILA	COONTIE PALM	18" HT MIN.	N/A	3' O.C.	7 GAL.	EA	<b>20</b>	-	-	20	-	-	-	-	-
0580 4223	PS	PHOENIX SYLVESTRIS	WILD DATE PALM	28' CT., 12' SPRD MIN.	50' H.T. 25' SPRD	SEE PLAN	16" CAL. MIN., FG, Maintain to single trunk	EA	<b>6</b>	-	-	6	-	-	-	-	-
0580 4215	SP	SABAL PALMETTO	CABBAGE PALM	28' CT., 12' SPREAD MIN.	50' H.T. 25' SPRD	SEE PLAN	16" CAL. MIN., FG, Maintain to single trunk	EA	<b>16</b>	-	-	16	-	-	-	-	-

THE OFFICIAL RECORD OF THIS SHEET IS THE ELECTRONIC FILE DIGITALLY SIGNED AND SEALED UNDER RULE 61G15-23.004, F.A.C.

REVISIONS				CHRIS JOHN SILEWSKI, PLA L.A. LICENSE NUMBER 6667396 AYRES 8875 HIDDEN RIVER PKWY, SUITE 200 TAMPA, FL 33637		BUCKINGHAM RD AND GUNNERY RD ROUNDABOUT FINANCIAL PROJECT ID 442123-1-58-01	<b>TABULATION OF QUANTITIES                  AND PLANT SCHEDULE                  BUCKINGHAM RD AND                  GUNNERY RD ROUNDABOUT</b>	SHEET NO.
DATE	DESCRIPTION	DATE	DESCRIPTION					LD-10
---	---	---	---					