

LEE COUNTY BOARD OF COUNTY COMMISSIONERS
 LEE COUNTY DEPARTMENT OF TRANSPORTATION
 CONTRACT NO. 7240

SANIBEL OVERHEAD SIGN STRUCTURES
 SIGNING PLANS

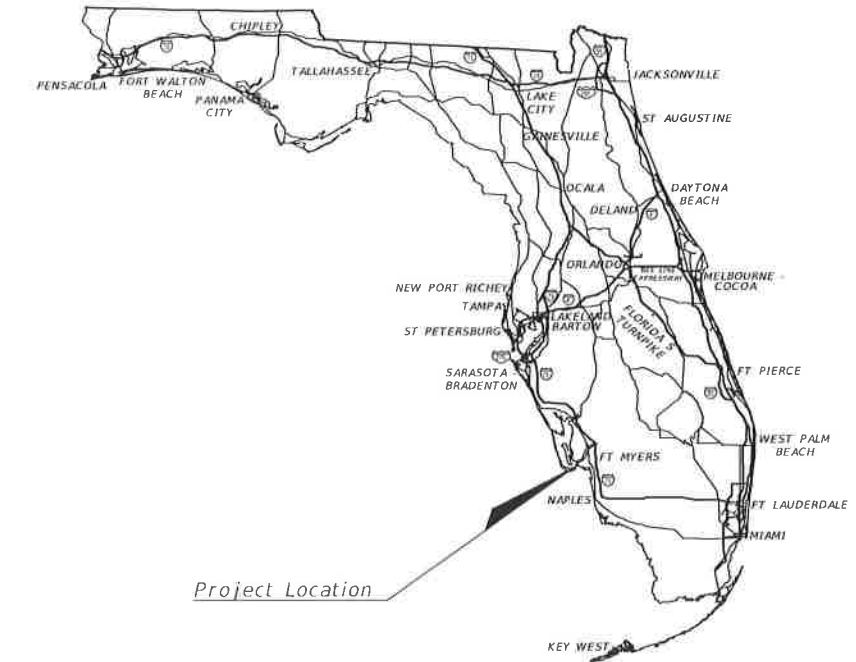

INDEX OF SIGNING PLANS

SHEET NO.	SHEET DESCRIPTION
1	KEY SHEET
2	TABULATION OF QUANTITIES
3	GENERAL NOTES
4-6	SIGNING PLANS
7-8	GUIDE SIGN WORKSHEETS
9-11	OVERHEAD SIGN CROSS SECTION SHEETS
12-13	UTILITY ADJUSTMENTS
14	CANTILEVER STRUCTURES DATA TABLE
15-17	REPORT OF CORE BORINGS

LIST OF REVISED INDEX DRAWINGS
 OF SIGNING PLANS

SHEET NO.	SHEET DESCRIPTION
OVERHEAD SIGN STRUCTURE 1	0.5 MILE MARKER
OVERHEAD SIGN STRUCTURE 2	1.0 MILE MARKER
OVERHEAD SIGN STRUCTURE 3	1.5 MILE MARKER

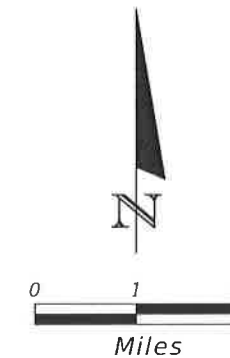
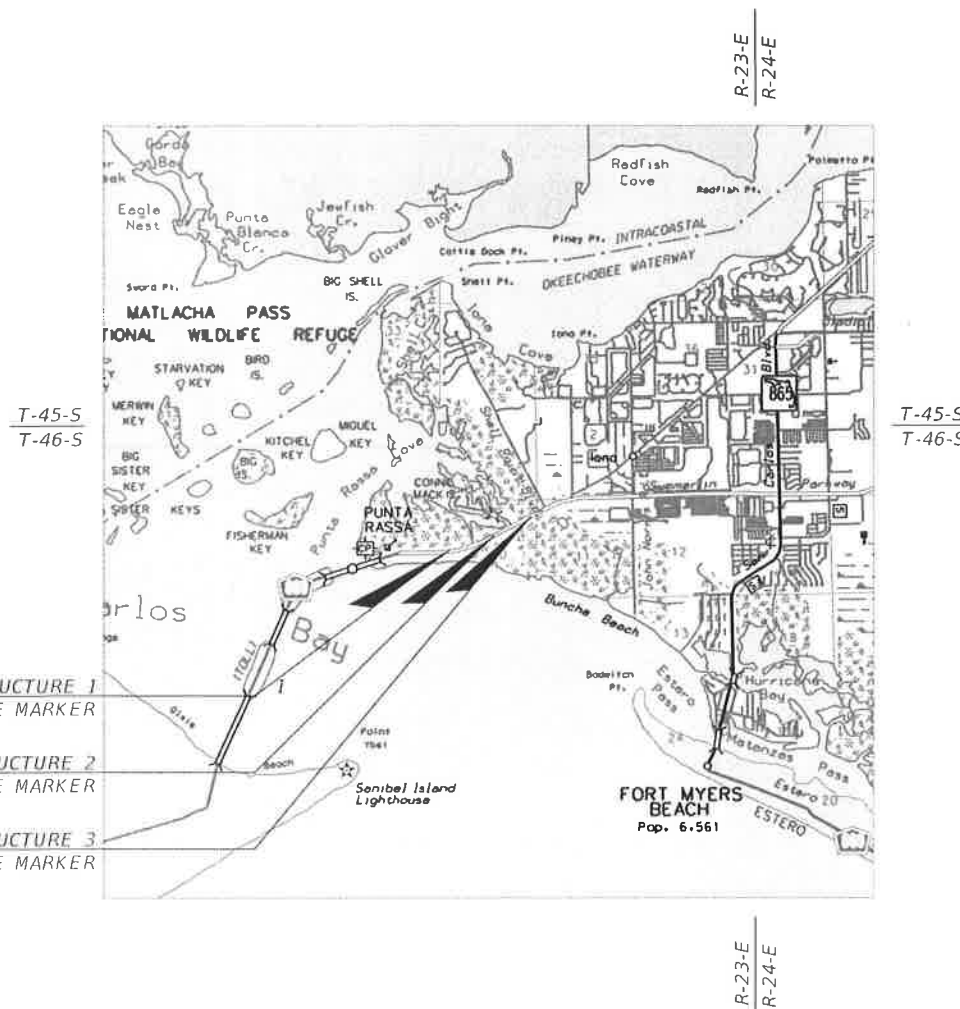

PLANS PREPARED BY:
 KISINGER CAMPO & ASSOCIATES, CORP.
 ONE TAMPA CITY CENTER
 201 N. FRANKLIN STREET, SUITE 400
 TAMPA, FL 33602
 PHONE: (813) 871-5331
 CERTIFICATE OF AUTHORIZATION NO. 02317

NOTE: THE SCALE OF THESE PLANS MAY
 HAVE CHANGED DUE TO REPRODUCTION.



SIGNING PLANS
 ENGINEER OF RECORD: FATHY ABDALLA, P.E.
 P.E. NO. : 63914

GOVERNING STANDARDS AND SPECIFICATIONS:
 Florida Department of Transportation, 2018
 Design Standards and revised Index Drawings
 as appended herein, and 2018
 Standard Specifications for Road and Bridge
 Construction, as amended by Contract Documents

For Design Standards click on the "Design
 Standards" link at the following web site:
<http://www.dot.state.fl.us/iddesign/>

For the Standard Specifications for Road and
 Bridge Construction click on the "Specifications"
 link at the following web site:
<http://www.dot.state.fl.us/specificationsoffice/>

LEE COUNTY, FLORIDA
 PROJECT MANAGER: MICHAEL PADGETT

FISCAL YEAR	SHEET NO.
18	1

TABULATION OF QUANTITIES

PAY ITEM NO.	DESCRIPTION	UNIT	SHEET NUMBERS																TOTAL THIS SHEET		GRAND TOTAL	
			4		5		6															
			PLAN	FINAL	PLAN	FINAL	PLAN	FINAL	PLAN	FINAL	PLAN	FINAL	PLAN	FINAL	PLAN	FINAL	PLAN	FINAL	PLAN	FINAL		
101-1	MOBILIZATION	LS																		1		
102-1	MAINTENANCE OF TRAFFIC	LS																		1		
110-1-1	CLEARING AND GRUBBING	LS																		1		
536-1-1	GUARDRAIL	LF	147		88			191												426		
536-1-3	GUARDRAIL, DOUBLE FACE	LF			296															296		
536-73	GUARDRAIL REMOVAL	LF	359		282			362												1003		
700-1-11	SINGLE POST SIGN, F&I, GROUND MOUNT, UP TO 12 SF	AS	1					1												2		
700-1-60	SINGLE POST SIGN, REMOVE	AS	1					1												2		
700-3-207	SIGN PANEL, F&I OM, 201-300 SF	EA						1												1		
700-3-208	SIGN PANEL, F&I OM, 301-400 SF	EA	1		1															2		
700-3-606	SIGN PANEL, REMOVE, 101-200 SF	EA	1		1			1												3		
700-4-114	OH STATIC SIGN STR, F&I, C 41-50 FT	EA	1		1			1												3		
700-4-620	OH STATIC SIGN STR, REMOVE, SPAN	EA	1		1			1												3		

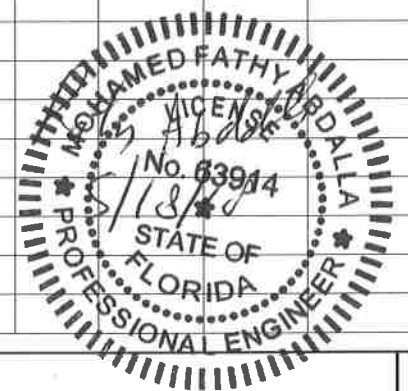

REVISIONS			
DATE	DESCRIPTION	DATE	DESCRIPTION

KISINGER CAMPO, & ASSOCIATES
 201 N. Franklin Street, Suite 400
 Tampa, Florida 33602
 Board of Professional Engineers
 Certificate of Authorization No. 02317
 Engineer of Record: Fathy Abdalla, P.E.
 P.E. No. 63914

LEE COUNTY DEPARTMENT OF TRANSPORTATION
 SOUTHWEST FLORIDA
 1500 Monroe St., Fort Myers, FL 33901

PLANS OF PROPOSED	PROJECT NO.
SANIBEL OVERHEAD SIGN STRUCTURE	7240

TABULATION OF QUANTITIES

SHEET NO.
2

SIGNING GENERAL NOTES

1. THE MAINTAINING AGENCY IS THE LEE COUNTY DEPARTMENT OF TRANSPORTATION. THE CONTRACTOR SHALL NOTIFY THE MAINTAINING AGENCY AT LEAST 48 HOURS BEFORE BEGINNING SIGN INSTALLATION.
2. AT THE TIME OF FINAL PROJECT INSPECTION, THE CONTRACTOR SHALL FURNISH THE ENGINEER THREE COMPLETE SETS OF AS-BUILT PLANS, ONE SET FOR LEE COUNTY AND ONE SET SHALL BE LEFT IN THE CABINET.
3. THE CONTRACTOR SHALL NOTIFY ALL UTILITY COMPANIES FORTY EIGHT (48) HOURS IN ADVANCE OF WORK COMMENCING.
4. THE LOCATIONS OF EXISTING UTILITIES SHOWN ON THE PLAN ARE APPROXIMATE ONLY. THE EXACT LOCATION OF UTILITIES SHALL BE DETERMINED BY THE CONTRACTOR DURING CONSTRUCTION. OTHER UTILITIES MAY EXIST.
5. THE CONTRACTOR SHALL BE RESPONSIBLE TO VERIFY IF OTHER UTILITIES (NOT SHOWN ON THE PLANS) EXIST WITHIN THE AREA OF CONSTRUCTION, SHOULD THERE BE OTHER UTILITIES, THE CONTRACTOR SHALL NOTIFY THE ENGINEER TO CONTACT THE RESPECTIVE UTILITY OWNER TO RESOLVE UTILITY CONFLICTS AND UTILITY ADJUSTMENTS, AS REQUIRED. THE CONTRACTOR IS RESPONSIBLE FOR THE PROTECTION OF ALL UTILITIES TO REMAIN IN PLACE.
6. ALL STAKING OF PROPOSED CONSTRUCTION TO ALLOW FOR THE PROPER INSTALLATION/RELOCATION OF UTILITY FACILITIES AS INDICATED ON THE UTILITY RELOCATION SCHEDULES SHALL BE PERFORMED BY THE CONTRACTOR. THE CONTRACTOR SHALL COORDINATE WITH THE IMPACTED UTILITIES AND STAKE THE ITEMS REQUESTED. THE STAKING SHALL BE SEPARATE AND IN ADDITION TO THE NORMAL STAKING OF THE PROJECT. THE COST OF THIS STAKING SHALL BE INCIDENTAL TO AND INCLUDED IN THE COST OF THE PROJECT.
7. THE CONTRACTOR SHALL BE AWARE THAT EXISTING UNDERGROUND STRUCTURES AND FACILITIES WITHIN THE LIMITS OF WORK SHOWN IN THE PLANS ARE NOT LOCATED IN THE PLANS. THE CONTRACTOR IS FULLY RESPONSIBLE FOR LOCATING AND AVOIDING EXISTING UNDERGROUND AND ABOVE GROUND STRUCTURES AND FACILITIES.
8. THE CONTRACTOR SHALL BE RESPONSIBLE FOR COORDINATING AND MEETING WITH ALL UTILITIES HAVING OVERHEAD OR UNDERGROUND FACILITIES IN CLOSE PROXIMITY OR IN POSSIBLE CONFLICT WITH THE CONTRACTOR'S WORK.
9. IT SHALL BE THE CONTRACTOR'S RESPONSIBILITY FOR HAVING UNDERGROUND CABLE AND UTILITIES LOCATED AND IDENTIFIED BY PROPER AUTHORITIES AT ALL CONSTRUCTION SITES. NO UTILITY INVESTIGATION HAS BEEN CONDUCTED AT THE MEDIAN FOR SIGN STRUCTURE OH-S2.
10. SECT. 611-4 FIELD TESTS: SCHEDULING OF THE CONDITIONAL ACCEPTANCE INSPECTION SHALL BE COORDINATED WITH JAMES FENCIL, LEE COUNTY DEPARTMENT OF TRANSPORTATION, TRAFFIC SECTION (PH: 239-634-4087) WITH A MINIMUM OF 48 HOURS. RESULTS OF FIELD TESTS, IE, SECT. 611-4 SHALL BE MADE AVAILABLE TO THE ENGINEER IN WRITTEN FORM. A QUALIFIED CONTRACTOR'S REPRESENTATIVE SHALL BE PRESENT AT THE CONDITIONAL ACCEPTANCE INSPECTION OF THE CONTROLLER ASSEMBLY.
11. CONTRACTOR SHALL CONTACT SUNSHINE ONE-CALL LOCATES, 48 HOURS PRIOR TO START OF WORK.
12. ALL CRITICAL ELEVATIONS SHOWN ON THE PLANS SHALL BE FIELD VERIFIED BY THE CONTRACTOR PRIOR TO ORDERING POLES.
13. CONTRACTOR SHALL UTILIZE LOW-PROFILE EQUIPMENT WHEN OPERATING NEAR OVERHEAD ELECTRIC LINES IN ORDER TO MAINTAIN THE SETBACK REQUIREMENTS PER CURRENT OCCUPATIONAL SAFETY AND HEALTH ADMINISTRATION (OSHA) GUIDELINES.
14. EXISTING LIGHT FIXTURES ATTACHED TO EXISTING SIGN STRUCTURES ALONG WITH ALL CABLES, CONDUITS, AND ELECTRICAL CONNECTIONS SHALL BE REMOVED WITH NO ADDITIONAL COMPENSATION.
15. EXISTING SIGN STRUCTURES TO BE REMOVED PRIOR TO EXISTING GUARDRAIL REMOVAL. NEW GUARDRAIL TO BE CONSTRUCTED PRIOR TO NEW SIGN STRUCTURE CONSTRUCTION.
16. CONTRACTOR SHALL CONTACT SUSAN HOPWOOD WITH LEE COUNTY DEPARTMENT OF TRANSPORTATION BEFORE ORDERING OR MANUFACTURING ANY SIGN PANELS OR SIGN STRUCTURES.
17. THE CONTRACTOR SHALL PROVIDE ONE PULL BOX NEAR OH-S3 WITH 2" CONDUIT CONNECTING THIS PULL BOX TO OH-S3. PROVIDE TWO ACCESS WINDOWS FOR THE UPRIGHT OF OH-S3, ONE NEAR THE BOTTOM AND ANOTHER NEAR THE TOP OF UPRIGHT TO FACILITATE WIRING FOR THE FUTURE DMS SIGN. COST SHALL BE CONSIDERED INCIDENTAL TO PROJECT.
18. FOR SIGN STRUCTURE OH-S1, FP&L WILL DE-ENERGIZE THE OVERHEAD POWER LINE DURING INSTALLATION. CONTRACTOR MUST COORDINATE TIMING WITH FP&L; CONTRACTOR MUST PROVIDE AT LEAST 2 WEEKS NOTICE IN ADVANCE OF INSTALLING THE FOUNDATION TO COORDINATE THE DE-ENERGIZING OF THE POWER LINE.

UTILITY OWNERS MAY INCLUDE:

UTILITY AGENCY OWNERS	CONTACT PERSON	ADDRESS	PHONE NUMBER
COMCAST	LEONARD MAXWELL-NEUBOLD	2601 SW 145TH AVE, MIRAMAR, FL 33027	(954) 447-8405
FLORIDA POWER & LIGHT	ERNESTO DOMINGUEZ	2900 CATHERINE ST, PALATKA, FL 32177	(954) 851-3088
LEE COUNTY SIGNAL DEPARTMENT	JAMES FENCIL	5650 ENTERPRISE PKWY, FT MYERS, FL 33905	(239) 533-9500
LEE COUNTY UTILITIES	VICTOR J. GAGNON	1500 MONROE ST, 3RD FL UTILITIES, FT MYERS, FL 33901	(239) 533-8178
CENTURYLINK	CRAIG CLARK	2820 CARGO ST BUILDING A, FT MYERS, FL 33916	(252) 622-9415
TECO PEOPLES GAS	MARILYN ALOI	5901 ENTERPRISE PARKWAY, FORT MYERS, FL 33905	(239)-690-5517 FAX (239)-690-5539

TEMPORARY TRAFFIC CONTROL PLAN:

THE CONTRACTOR SHALL BE RESPONSIBLE FOR DEVELOPING A TEMPORARY TRAFFIC CONTROL PLAN (TTCP) IN ORDER TO FACILITATE PERFORMING THE SCOPE OF WORK. ANY WORK ASSOCIATED WITH THE DESIGN AND IMPLEMENTATION OF THE TTCP SHALL BE COVERED UNDER PAY ITEM 102-1, MAINTENANCE OF TRAFFIC. THE TTCP MUST BE SUBMITTED TO AND APPROVED BY LEE COUNTY PRIOR TO BEGINNING WORK. THE TTCP SHALL BE SIGNED AND SEALED BY A REGISTERED FLORIDA PROFESSIONAL ENGINEER PRE-QUALIFIED IN WORK TYPE 3.1 PER CHAPTER 14 OF THE FLORIDA ADMINISTRATIVE CODE. NO WORK SHALL COMMENCE PRIOR TO THE REVIEW AND APPROVAL OF THE TTCP BY THE ENGINEER. THE TTCP SHALL MEET THE FOLLOWING REQUIREMENTS:

1. THE TTCP SHALL BE DESIGNED PER FDOT STANDARDS AND SPECIFICATIONS.
2. TRAFFIC SHALL BE MAINTAINED IN ACCORDANCE WITH THE 2017 EDITION OF THE FLORIDA DEPARTMENT OF TRANSPORTATION (FDOT) STANDARDS FOR DESIGN, CONSTRUCTION, MAINTENANCE AND UTILITY OPERATIONS ON THE STATE HIGHWAY SYSTEM (600 SERIES). MAINTENANCE OF TRAFFIC SHALL BE IN ACCORDANCE WITH THE FDOT STANDARD SPECIFICATIONS FOR ROAD AND BRIDGE CONSTRUCTION, 2017 EDITION, AND THE LATEST EDITION OF THE MANUAL ON UNIFORM TRAFFIC CONTROL DEVICES.
3. THE CONTRACTOR SHALL OBTAIN ALL REQUIRED PERMITS FROM LEE COUNTY, AND ANY OTHER APPLICABLE MUNICIPALITIES.
4. PEDESTRIAN ACCESS SHALL BE MAINTAINED AT ALL TIMES.
5. EXISTING POSTED SPEED LIMITS SHALL BE MAINTAINED AT ALL TIMES.
6. TEMPORARY TRAVEL LANES SHALL BE MINIMUM 11 FEET IN WIDTH.
7. THE CONTRACTOR SHALL COORDINATE WITH AND HAVE APPROVED, ANY LANE OR ROAD CLOSURES FROM LEE COUNTY.
8. A PORTABLE CHANGEABLE MESSAGE SIGN (PCMS) SHALL BE PROVIDED SEVEN DAYS PRIOR TO ANY LANE CLOSURES FOR EACH DIRECTION TRAVEL.
THE PCMS SHALL HAVE TWO MESSAGES AS FOLLOWS:
1. "NIGHTLY LANE CLOSURES" 2. "DATE TO DATE" (ADJUST WITH APPROPRIATE DATES)

ROADWAY GENERAL NOTES

1. ANY PUBLIC LAND CORNER, BENCH MARK OR CONTROL POINT WITHIN THE LIMITS OF CONSTRUCTION SHALL BE PROTECTED.
2. CLEARING AND GRUBBING (110-1-1) SHALL INCLUDE TREE REMOVAL AND SHALL EXTEND TO INCLUDE 1:10 SHOULDER TRANSITION FROM GUARDRAIL TO NORMAL CROSS SLOPE BREAK PER INDEX 536.
3. CONTRACTOR TO REMOVE ANY VEGETATION, INCLUDING SABAL PALMS, THAT ARE IN CONFLICT WITH THE NEW SIGN STRUCTURE OR AN IMPEDIMENT TO THE CONTRACTOR'S INSTALLATION PLAN. CONFIRM WITH THE CEI PRIOR TO REMOVAL. COST TO BE INCLUDED IN CLEARING AND GRUBBING PAY ITEM (110-1-1).
4. SOD SHALL BE INSTALLED "IN LIKE KIND". IF THERE IS NO EXISTING SOD, THE SOD SHALL BE COASTAL BAHIA. COST SHALL BE CONSIDERED INCIDENTAL TO PROJECT.
5. THE CONTRACTOR SHALL CONTACT LEE COUNTY DEPARTMENT OF TRANSPORTATION OPERATIONS TO LOCATE EXISTING IRRIGATION LINES. CONTRACTOR SHALL RESTORE EXISTING IRRIGATION SYSTEM(S) THAT ARE IMPACTED BY THIS PROJECT WITH NO ADDITIONAL COMPENSATION.
6. GUARDRAIL PAY ITEMS (536-1-1 AND 536-1-3) SHALL INCLUDE END ANCHORAGES, ALL MISCELLANEOUS ASPHALT, EXCAVATION, AND EMBANKMENT.

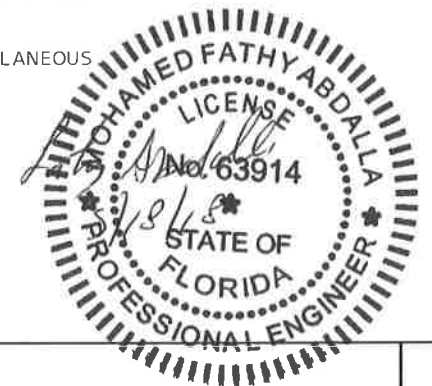

REVISIONS				KISINGER CAMPO & ASSOCIATES 201 N. Franklin Street, Suite 400 Tampa, Florida 33602 Board of Professional Engineers Certificate of Authorization No. 02317 Engineer of Record: Fathy Abdalla, P.E. P.E. No. 63914	LEE COUNTY DEPARTMENT OF TRANSPORTATION SOUTHWEST FLORIDA 1500 Monroe St., Fort Myers, FL 33901		GENERAL NOTES	SHEET NO. 3
DATE	DESCRIPTION	DATE	DESCRIPTION		PLANS OF PROPOSED	PROJECT NO.		
					SANIBEL OVERHEAD SIGN STRUCTURE	7240		

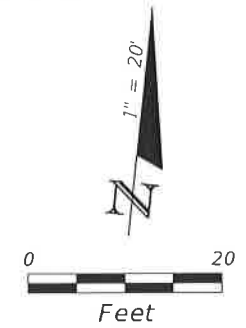

REMOVE EXISTING SIGN STRUCTURE AND SIGN PANEL

- 1 EA 700-3-606
- 1 EA 700-4-620



SIGN STRUCTURE OH-S1
N: 782143.68
E: 656353.47
700-4-114 1 EA

SIGN PANEL 1
23.5' X 14.5'
700-3-20B 1 EA



RELOCATE EXISTING PANEL TO NEW ASSEMBLY
700-1-11 1 AS
700-1-60 1 AS

EXISTING GUARDRAIL TO BE REMOVED.
536-73 77 L.F.

PROPOSED W-BEAM GUARDRAIL WITH POST SPACING @ 6'-3"

END MISC. ASPHALT PAVEMENT
N: 782154.93
E: 656491.56

END GUARDRAIL "PARALLEL END" ANCHORAGE (TL-3) PER INDEX 536-001
N: 782152.27
E: 656480.28
UNK

BEGIN GUARDRAIL TYPE II END ANCHORAGE PER INDEX 536-001
N: 782136.10
E: 656337.44

BEGIN MISC. ASPHALT PAVEMENT
N: 782136.60
E: 656329.52

BEGIN SPECIAL POST SPACING GUARDRAIL WITH POSTS @ 3'-1 1/4" (3' 10" SETBACK)
N: 782138.17
E: 656349.79

SITE BENCHMARK SET NAIL & DISK STAMPED "SSMC TRAV. PT." ELEVATION = 6.16 NORTHING = 782136.62 EASTING = 656440.04

SITE BENCHMARK SET NAIL & DISK STAMPED "SSMC TRAV. PT." ELEVATION = 6.25 NORTHING = 782115.39 EASTING = 656241.32

CR 867/McGREGOR BOULEVARD (SB)

CR 867/McGREGOR BOULEVARD (NB)



- LEGEND:
- LIMITS OF CLEARING, GRUBBING, AND SODDING
 - EXISTING TREES TO BE REMOVED

0.5 MILE ADVANCE GUIDE SIGN

REVISIONS				KCS KISINGER CAMPO & ASSOCIATES 201 N. Franklin Street, Suite 400 Tampa, Florida 33602 Board of Professional Engineers Certificate of Authorization No. 02317 Engineer of Record: Fathy Abdalla, P.E. P.E. No. 63914	LEE COUNTY DEPARTMENT OF TRANSPORTATION SOUTHWEST FLORIDA 1500 Monroe St., Fort Myers, FL 33901		SHEET NO. 4
DATE	DESCRIPTION	DATE	DESCRIPTION		PLANS OF PROPOSED SANIBEL OVERHEAD SIGN STRUCTURE	PROJECT NO. 7240	

SIGNING PLAN (1)

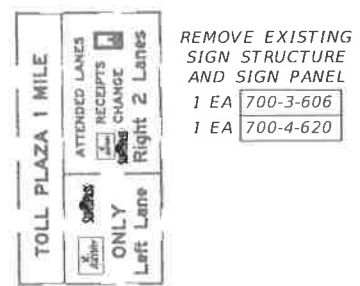
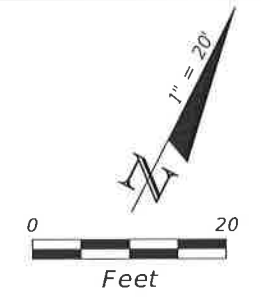
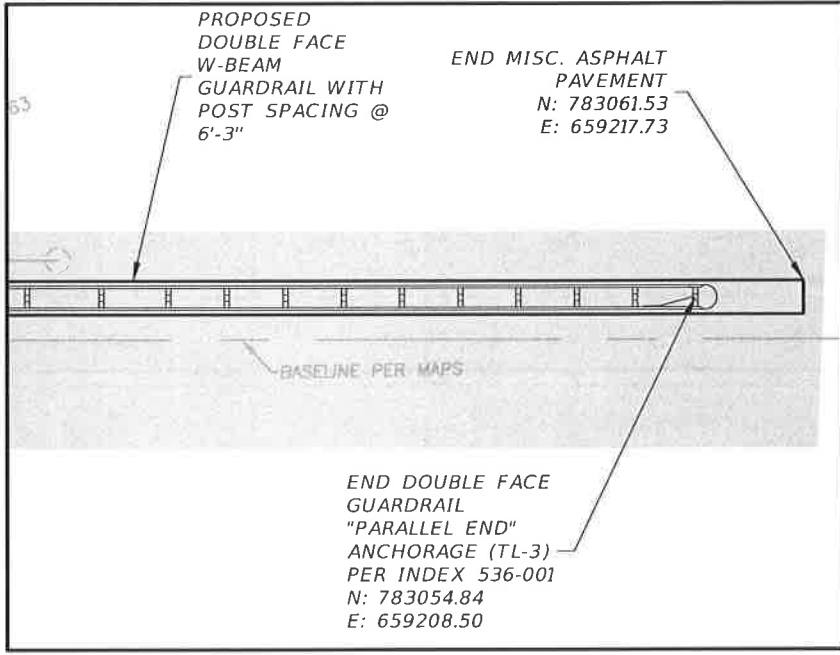

SIGN PANEL 2
23.5'X14.5'
700-3-208 1 EA

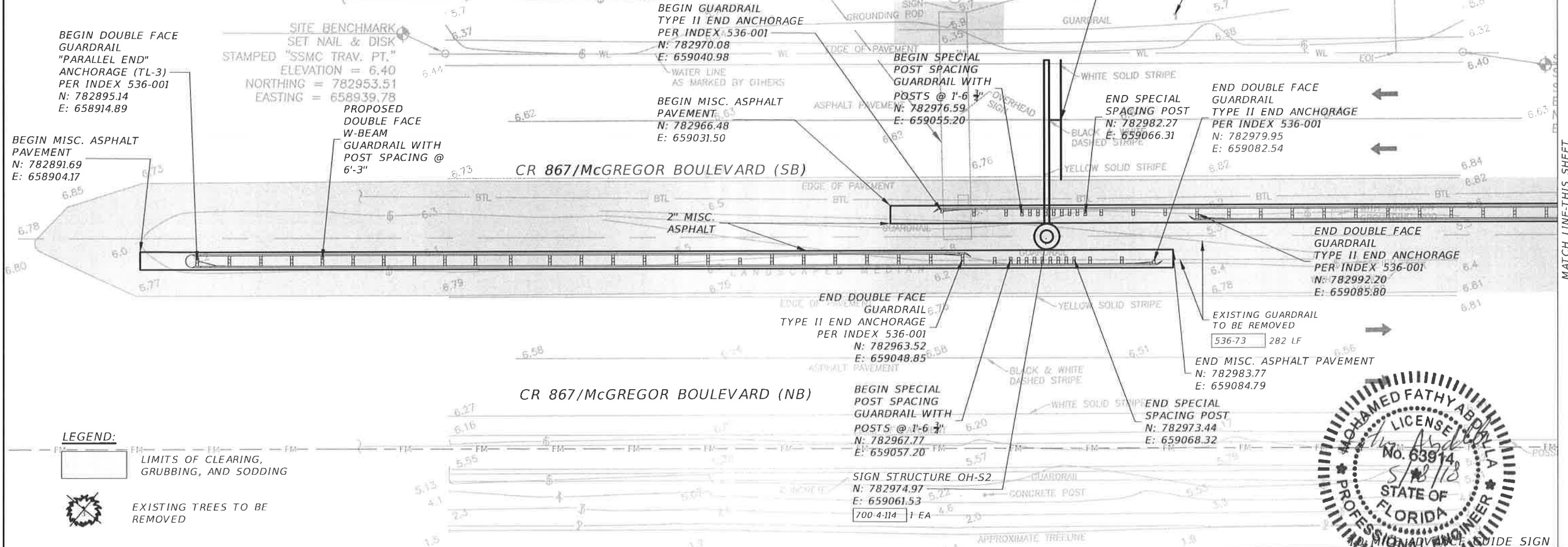

REVISIONS	
DATE	DESCRIPTION

KCA
KISINGER CAMPO, & ASSOCIATES
201 N. Franklin Street, Suite 400
Tampa, Florida 33602
Board of Professional Engineers
Certificate of Authorization No. 02317
Engineer of Record: Fathy Abdalla, P.E.
P.E. No. 63914

LEE COUNTY DEPARTMENT OF TRANSPORTATION SOUTHWEST FLORIDA 1500 Monroe St., Fort Myers, FL 33901	
PLANS OF PROPOSED	PROJECT NO.
SANIBEL OVERHEAD SIGN STRUCTURE	7240

SIGNING PLAN (2)

SHEET NO.	5
-----------	---

REMOVE EXISTING SIGN STRUCTURE AND SIGN PANEL

- 1 EA 700-3-606
- 1 EA 700-4-620

SANIBEL TOLL PLAZA

TWO AXLE VEHICLES	\$ 6.00
MOTORCYCLES	\$ 2.00
ADDITIONAL AXLES	\$ 3.00

SANIBEL TOLL PLAZA

2 AXLES	\$ 6.00
MOTORCYCLES	\$ 2.00
EACH ADD'L AXLE	\$ 3.00

SIGN PANEL 3
19.0'X13.5'
700-3-207 1 EA

- RELOCATE EXISTING PANEL TO NEW ASSEMBLY
- 700-1-11 1 AS
 - 700-1-60 1 AS

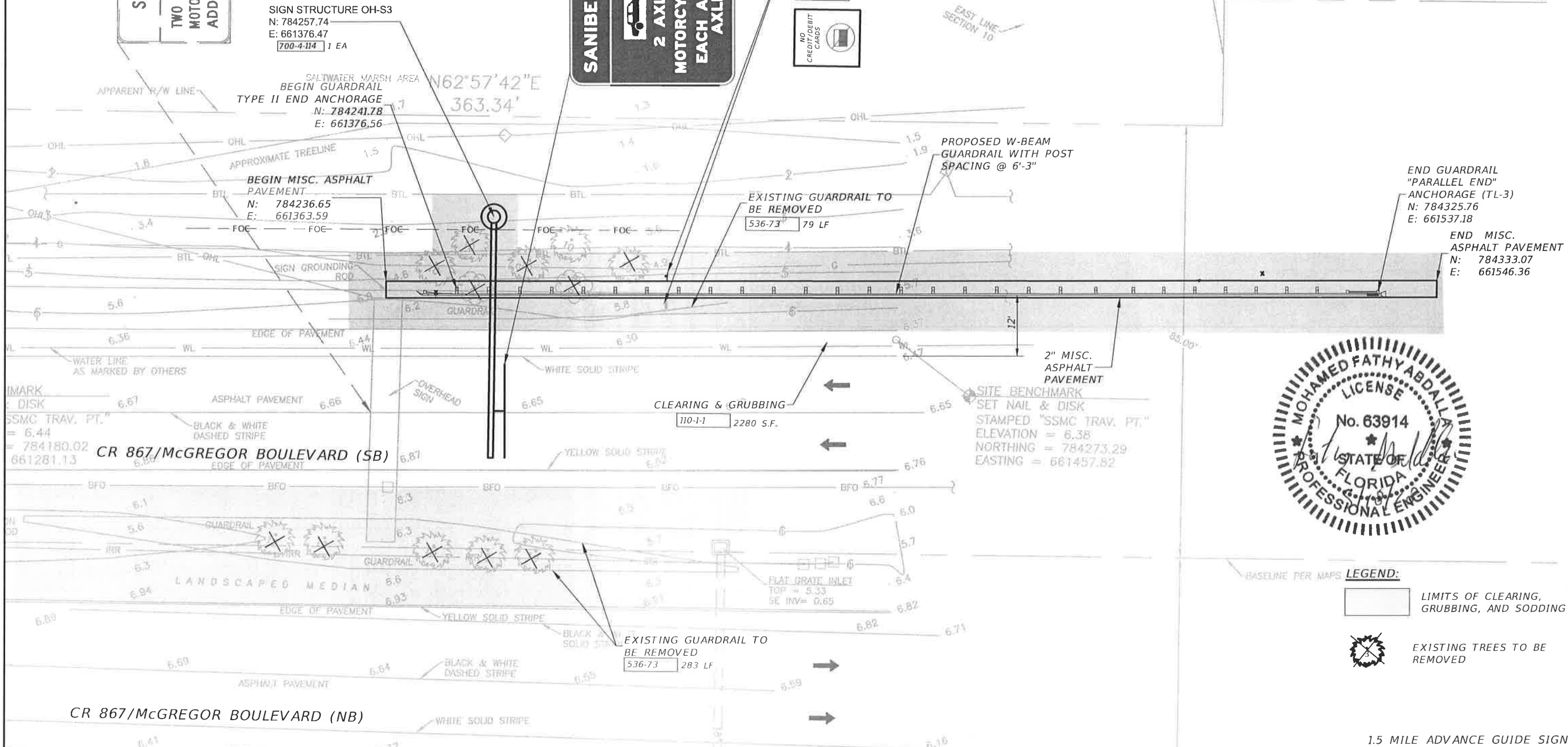
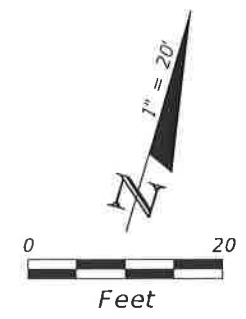
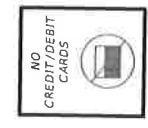

- LEGEND:
- [Shaded Area] LIMITS OF CLEARING, GRUBBING, AND SODDING
 - [Tree Symbol] EXISTING TREES TO BE REMOVED

1.5 MILE ADVANCE GUIDE SIGN

REVISIONS			
DATE	DESCRIPTION	DATE	DESCRIPTION

KCA
KISINGER CAMPO & ASSOCIATES
201 N. Franklin Street, Suite 400
Tampa, Florida 33602
Board of Professional Engineers
Certificate of Authorization No. 02317
Engineer of Record: Fathy Abdalla, P.E.
P.E. No. 63914

LEE COUNTY DEPARTMENT OF TRANSPORTATION
SOUTHWEST FLORIDA
1500 Monroe St., Fort Myers, FL 33901

PLANS OF PROPOSED	PROJECT NO.
SANIBEL OVERHEAD SIGN STRUCTURE	7240

SIGNING PLAN (3)

SHEET NO.	6
-----------	---

SIGN NAME	SP3	QTY	1	SIGN NUMBER	STATION(S)
PANEL	BORDER	none			
WIDTH	19'-0"	WIDTH	2"		
HEIGHT	13'-6"	RADIUS	12"		
LEGEND	White	COLOR	White		
COLOR	Green / Green				
SYMBOL(S)	ANGLE	X	Y	WD	HT
CAR	0	43.4	86.6	54.3	22.1
SIGN NUMBER	NUMBER OF POSTS	CLEARANCE Edge of Lane	COLUMN SIZE	AVERAGE LENGTH	
NO. OF LIGHT FIXTURES	FIXTURE SPACING	WATT			
PHOTOMETRIC CURVE		VOLTAGE			

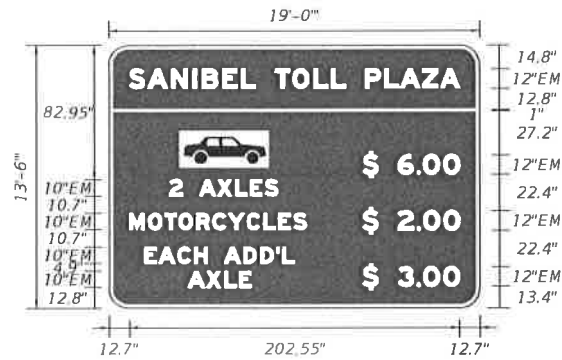

COPY		S	A	N	I	B	E	L	T	O	L	L	P	L	A	Z	A	L			
SPACE	12.7	11.5	14.3	13.1	5.8	12.4	11.4	8.9	12	10.6	13	10.8	8.9	12	11.9	9.6	13.4	11	12.1	12.7	202.6
COPY		\$		6	.	0	0		L												
SPACE	155.5	9.7	12	11.4	4.1	12.5	10.1	12.7	59.8												
COPY		2		A	X	L	E	S		L											
SPACE	37.4	8.1	10	11.2	10.8	9	9.2	8.1	124.2	66.4											
COPY		M	O	T	O	R	C	Y	C	L	E	S		L							
SPACE	12.7	11.7	9.8	8.8	10.8	9.8	9.3	11.5	10.3	9	9.2	8.1	107	108.3							
COPY		\$		2	.	0	0		L												
SPACE	155.4	9.7	12	11.5	4.1	12.5	10.1	12.7	59.9												
COPY		E	A	C	H		A	D	D	*	L		L								
SPACE	22.2	8.5	11.5	10.3	8.1	10	11.9	10.5	9.5	3.8	7.4	114.3	91.5								
COPY		A	X	L	E		L														
SPACE	48.7	11.2	10.8	9	7.4	140.9	38.4														
COPY		\$		3	.	0	0		L												
SPACE	155.4	9.7	12	11.4	4.1	12.5	10.1	12.8	59.8												
COPY																					
SPACE																					
COPY																					
SPACE																					
COPY																					
SPACE																					
COPY																					
SPACE																					
COPY																					
SPACE																					
COPY																					
SPACE																					



REVISIONS			
DATE	DESCRIPTION	DATE	DESCRIPTION

KCA
KISINGER CAMPO & ASSOCIATES
 201 N. Franklin Street, Suite 400
 Tampa, Florida 33602
 Board of Professional Engineers
 Certificate of Authorization No. 02317
 Engineer of Record: Fathy Abdalla, P.E.
 P.E. No. 63914

LEE COUNTY DEPARTMENT OF TRANSPORTATION SOUTHWEST FLORIDA 1500 Monroe St., Fort Myers, FL 33901	
PLANS OF PROPOSED	PROJECT NO.
SANIBEL OVERHEAD SIGN STRUCTURE	7240

GUIDE SIGN WORKSHEET (2)

SHEET NO.
8

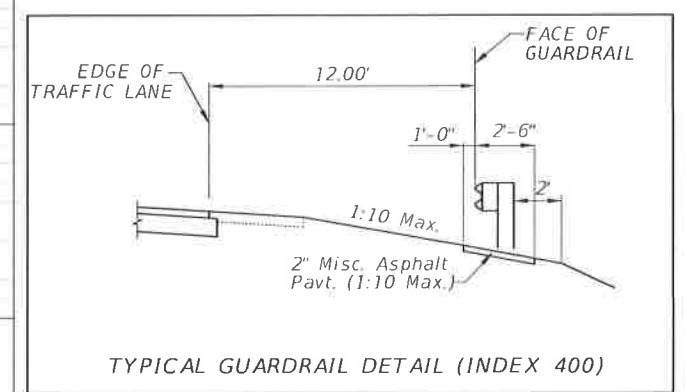
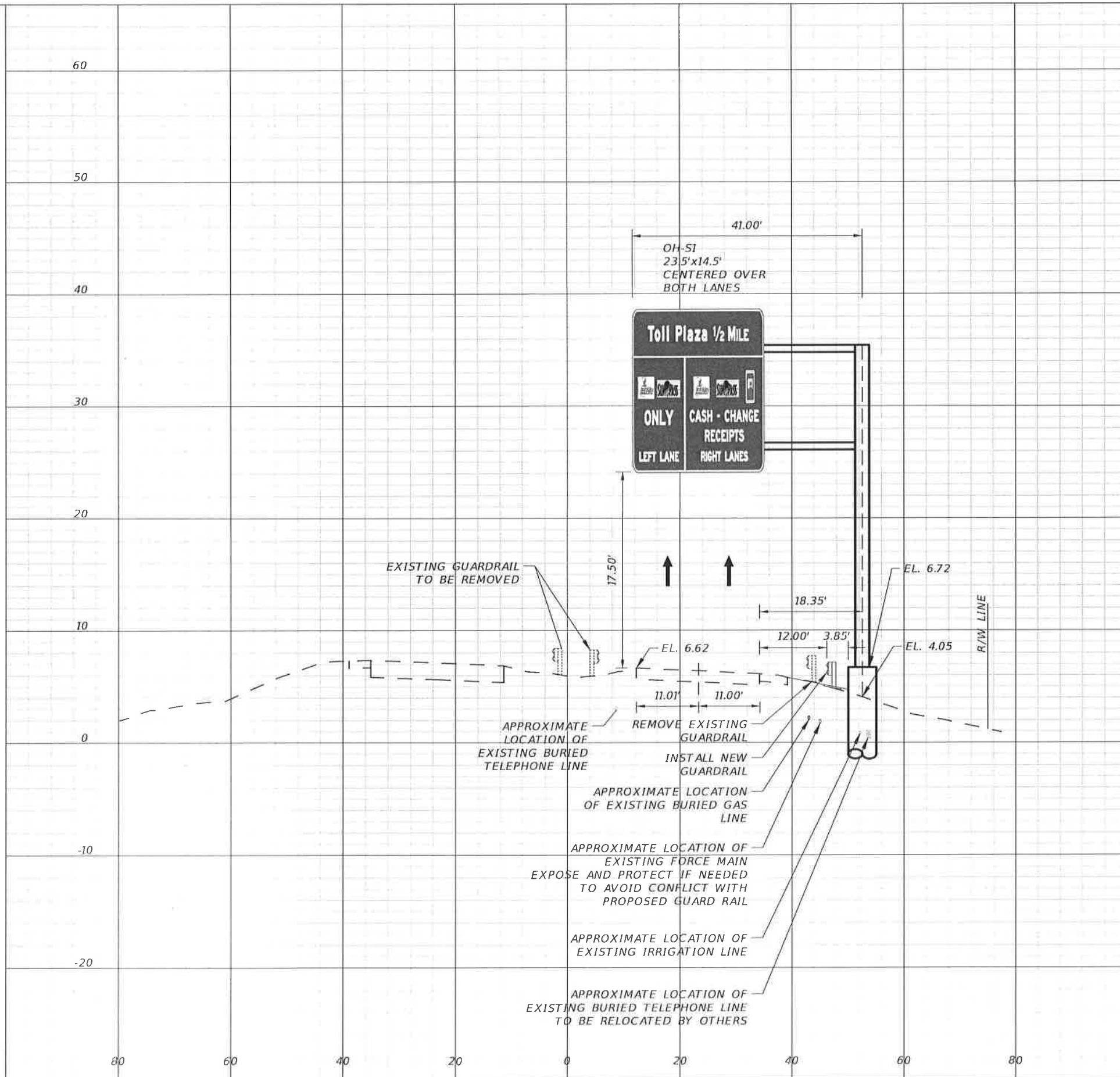

1" = 20' Horizontal
1" = 10' Vertical

REVISIONS			
DATE	DESCRIPTION	DATE	DESCRIPTION

KISINGER CAMPO, & ASSOCIATES
201 N. Franklin Street, Suite 400
Tampa, Florida 33602
Board of Professional Engineers
Certificate of Authorization No. 02317
Engineer of Record: Fathy Abdalla, P.E.
P.E. No. 63914

LEE COUNTY DEPARTMENT OF TRANSPORTATION
SOUTHWEST FLORIDA
1500 Monroe St., Fort Myers, FL 33901

PLANS OF PROPOSED	PROJECT NO.
SANIBEL OVERHEAD SIGN STRUCTURE	7240

**OVERHEAD SIGN
CROSS SECTION SHEET (1)**

SHEET NO.
9

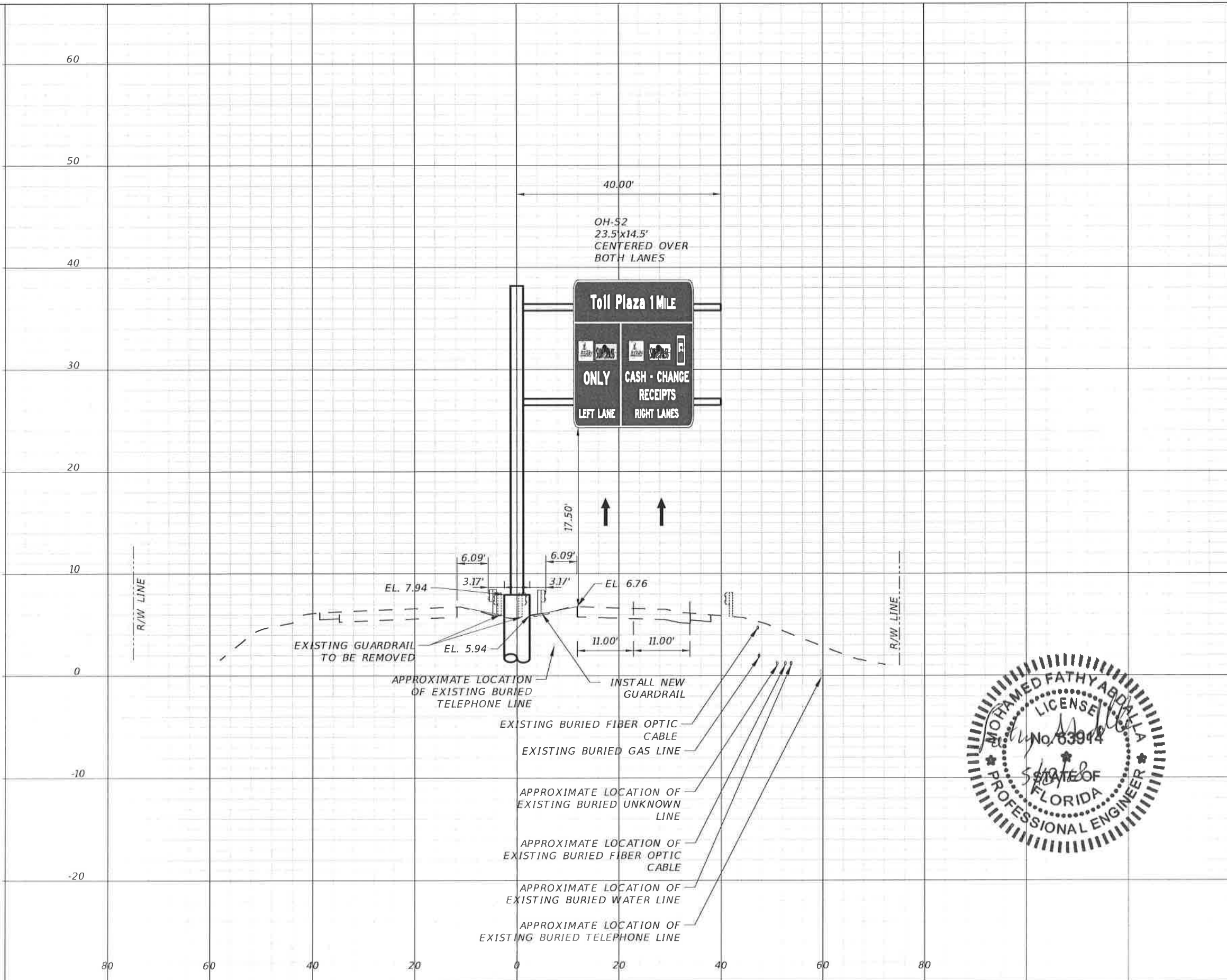

NOTE:
SIGN PANEL MOUNTED ON
BACK SIDE OF TRUSS.

1" = 20' Horizontal
1" = 10' Vertical

REVISIONS			
DATE	DESCRIPTION	DATE	DESCRIPTION

KCA
KISINGER CAMPO & ASSOCIATES
201 N. Franklin Street, Suite 400
Tampa, Florida 33602
Board of Professional Engineers
Certificate of Authorization No. 02317
Engineer of Record: Fathy Abdalla, P.E.
P.E. No. 63914

LEE COUNTY DEPARTMENT OF TRANSPORTATION SOUTHWEST FLORIDA 1500 Monroe St., Fort Myers, FL 33901	
PLANS OF PROPOSED	PROJECT NO.
SANIBEL OVERHEAD SIGN STRUCTURE	7240

**OVERHEAD SIGN
CROSS SECTION SHEET (2)**

SHEET
NO.
10

60
50
40
30
20
10
0
-10
-20

R/W LINE

80 60 40 20 0 20 40 60 80

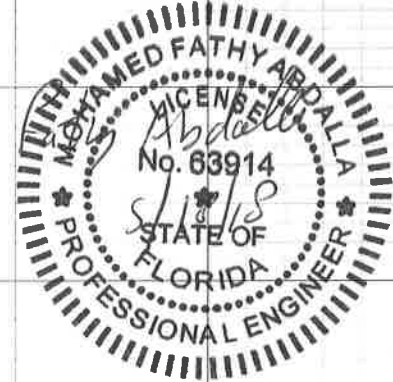
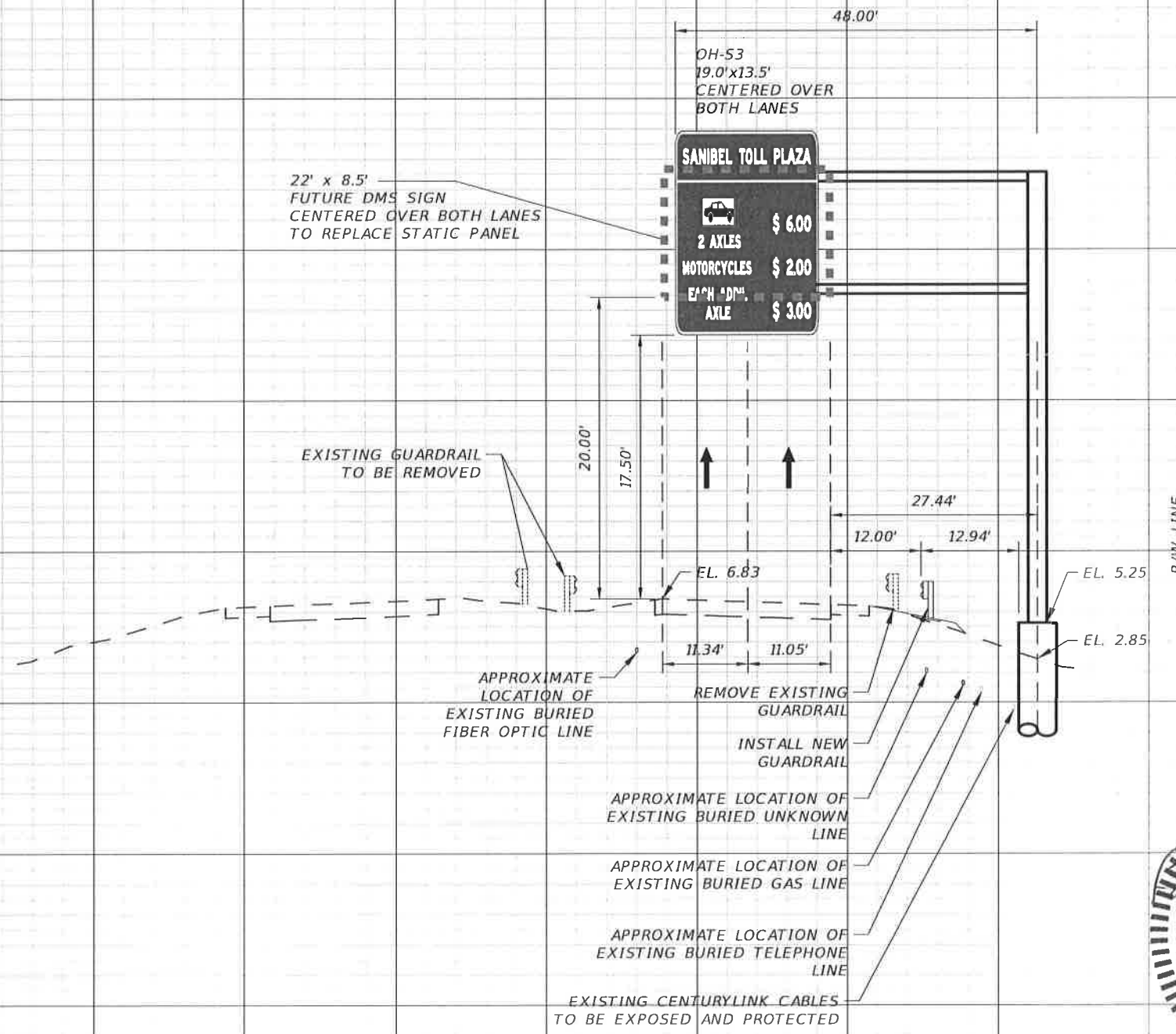

1" = 20' Horizontal
1" = 10' Vertical

REVISIONS

DATE	DESCRIPTION	DATE	DESCRIPTION

KCA
KISINGER CAMPO & ASSOCIATES
201 N. Franklin Street, Suite 400
Tampa, Florida 33602
Board of Professional Engineers
Certificate of Authorization No. 02317
Engineer of Record: Fathy Abdalla, P.E.
P.E. No. 63914

LEE COUNTY DEPARTMENT OF TRANSPORTATION SOUTHWEST FLORIDA 1500 Monroe St., Fort Myers, FL 33901	
PLANS OF PROPOSED	PROJECT NO.
SANIBEL OVERHEAD SIGN STRUCTURE	7240

OVERHEAD SIGN
CROSS SECTION SHEET (3)

SHEET NO.
11

SIGN STRUCTURE OH-S1

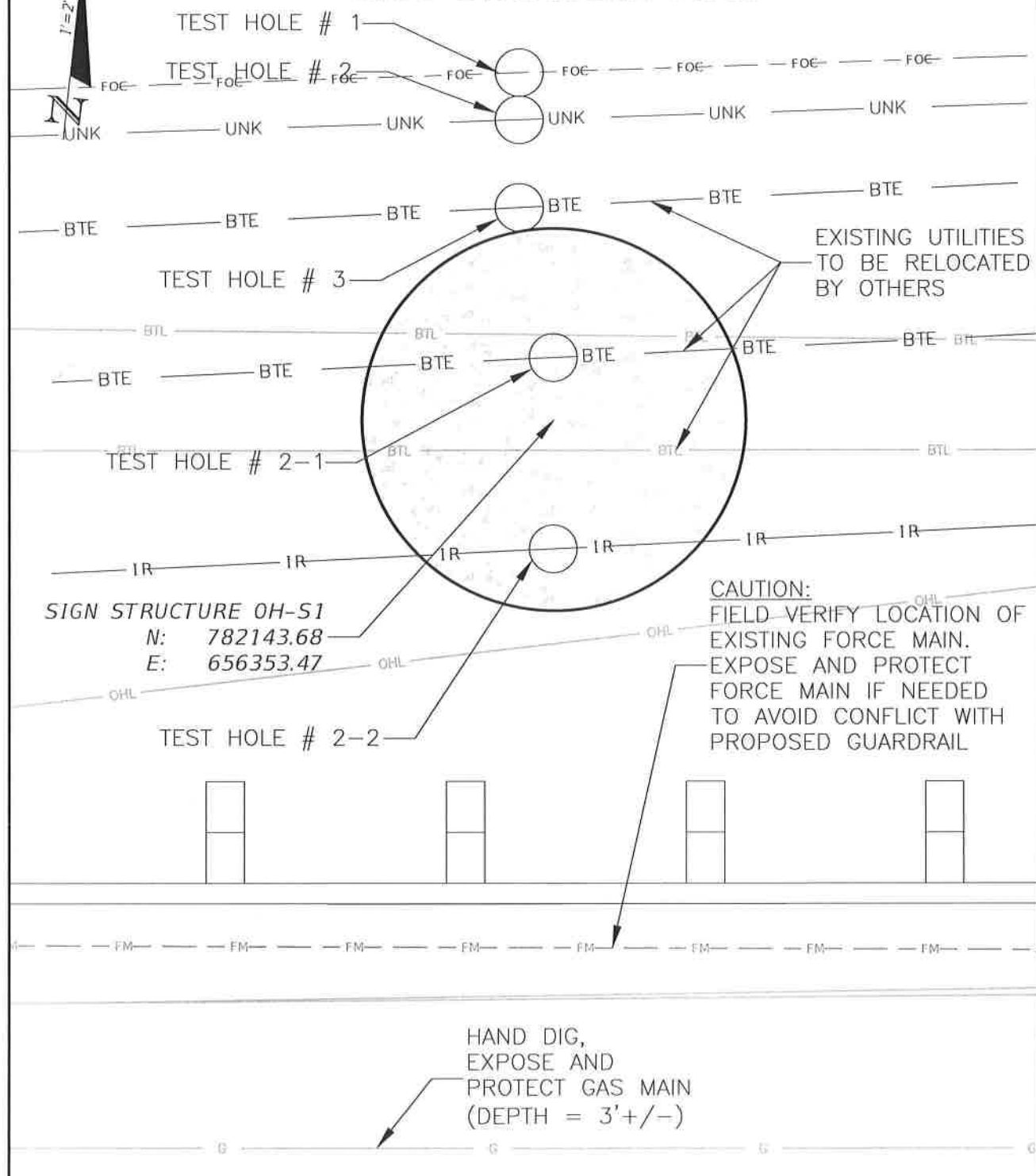

SIGN STRUCTURE OH-S1
 N: 782143.68
 E: 656353.47

CAUTION:
 FIELD VERIFY LOCATION OF
 EXISTING FORCE MAIN.
 EXPOSE AND PROTECT
 FORCE MAIN IF NEEDED
 TO AVOID CONFLICT WITH
 PROPOSED GUARDRAIL

HAND DIG,
 EXPOSE AND
 PROTECT GAS MAIN
 (DEPTH = 3'+/-)

TEST HOLE No.	UTILITY	SIZE	MATERIAL	DEPTH
1	FOC	1"	DBL	-4.10'
2	UNK	3 1/2"	NON METAL	-8.85'
3	BTE	2"	DBC	-2.35'
2-1	BTE	2"	DBC	-3.30'
2-2	IRG	2X1 1/2"	PVC	-0.90'

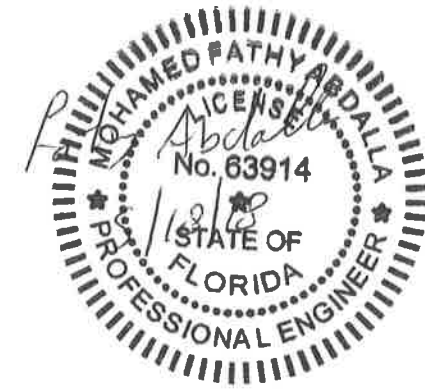

REVISIONS			
DATE	DESCRIPTION	DATE	DESCRIPTION

KCA
KISINGER CAMPO & ASSOCIATES
 201 N. Franklin Street, Suite 400
 Tampa, Florida 33602
 Board of Professional Engineers
 Certificate of Authorization No. 02317
 Engineer of Record: Fathy Abdalla, P.E.
 P.E. No. 63914

LEE COUNTY DEPARTMENT OF TRANSPORTATION
 SOUTHWEST FLORIDA
 1500 Monroe St., Fort Myers, FL 33901

PLANS OF PROPOSED	PROJECT NO.
SANIBEL OVERHEAD SIGN STRUCTURE	7240

UTILITY ADJUSTMENTS (1)

SHEET NO.
 12

SIGN STRUCTURE OH-S3

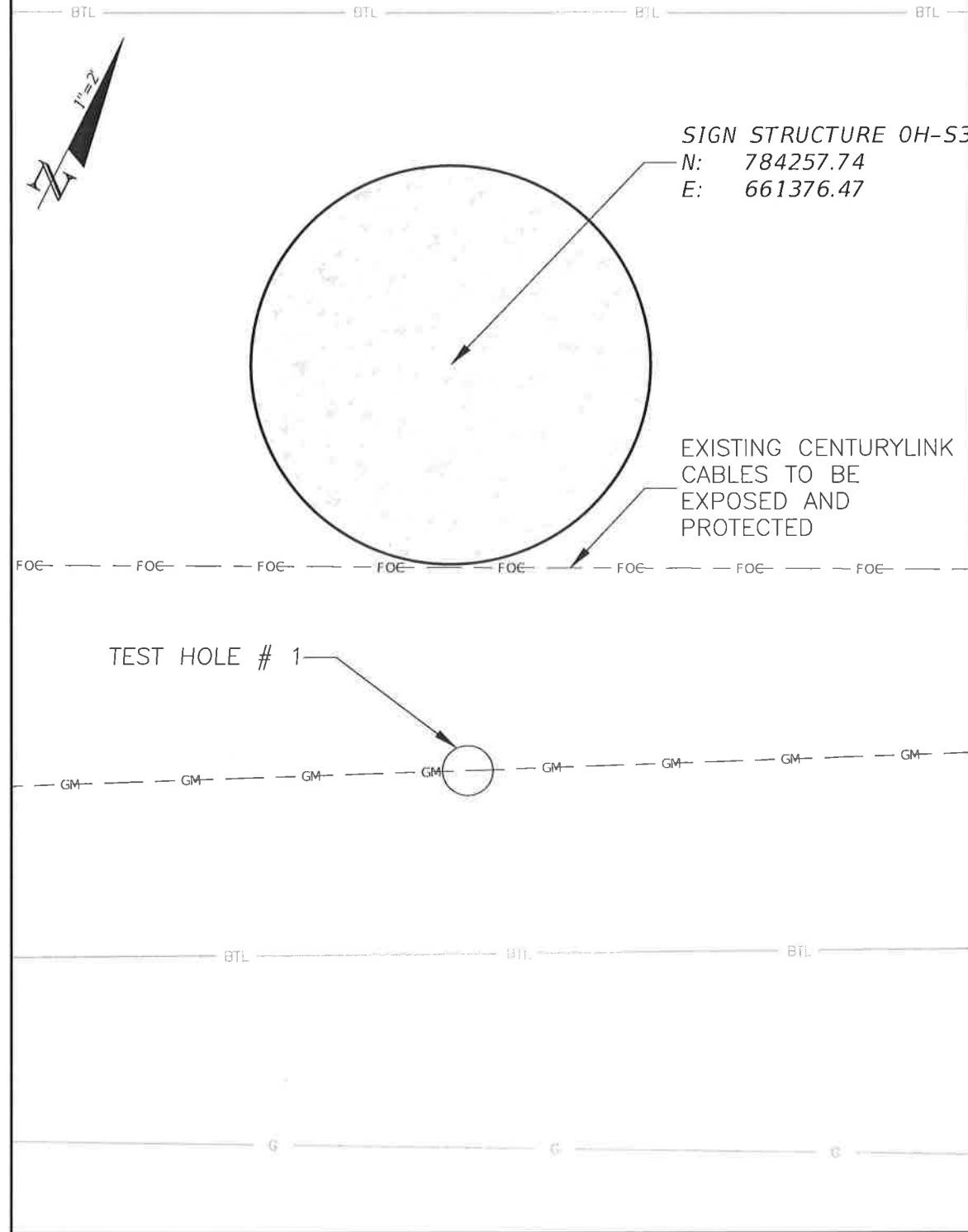

SIGN STRUCTURE OH-S3
 N: 784257.74
 E: 661376.47

EXISTING CENTURYLINK
 CABLES TO BE
 EXPOSED AND
 PROTECTED

TEST HOLE # 1

TEST HOLE No.	UTILITY	SIZE	MATERIAL	DEPTH
1	GM	4 1/4"	HDPE	-4.85'

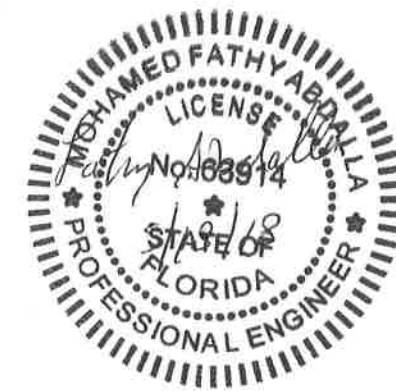

REVISIONS			
DATE	DESCRIPTION	DATE	DESCRIPTION

KCA
KISINGER CAMPO, & ASSOCIATES
 201 N. Franklin Street, Suite 400
 Tampa, Florida 33602
 Board of Professional Engineers
 Certificate of Authorization No. 02317
 Engineer of Record: Fathy Abdalla, P.E.
 P.E. No. 63914

LEE COUNTY DEPARTMENT OF TRANSPORTATION SOUTHWEST FLORIDA 1500 Monroe St., Fort Myers, FL 33901	
PLANS OF PROPOSED	PROJECT NO.
SANIBEL OVERHEAD SIGN STRUCTURE	7240

UTILITY ADJUSTMENTS (2)	
13	

SHEET NO.
13

CANTILEVER SIGN STRUCTURES DATA TABLE										Table Date 07-01-14	
SIGN NO.	STATION	DIMENSIONS				PANELS N #	MEMBER SIZES			BACKRAKE G in	
		A	B		C		D (CHORD)	E (WEB)	F (UPRIGHT)		
		ft	ft	in	in		O. D. x Wall Thk. (in)	Angle (in)	O. D. x Wall Thk. (in)		
OH-S1	0.5 Mile/29.35' LT	24.7500	8	1-1/2	66	5	5.56 x 0.375	3-1/2 x 3-1/2 x 3/8	30.00 x 0.500	3.9182	
OH-S2	1.0 Mile/22.82' RT	23.5700	8	0	72	5	5.56 x 0.375	3-1/2 x 3-1/2 x 3/8	30.00 x 0.500	3.1905	
OH-S3	1.5 Mile/38.5' LT	25.8300	8	2	72	6	6.63 x 0.432	3-1/2 x 3-1/2 x 3/8	30.00 x 0.500	9.8483	

NOTES [Notes Date 7-01-13]:
 1. Work these Data Tables with Index 11310.
 2. Design Wind Speed = 130 mph.
 3. Upright wall thickness given is a minimum dimension.

FOUNDATION NOTES [Notes Date 7-01-12]:
 1. Design based on Borings taken 2/22/2017 & 2/23/2017 sealed by Gary A. Drew, P.E.
 2. Assumptions and Values used in design:
 Soil Type: Cohesionless

	OH-S1	OH-S2	OH-S3
Soil Layer Thickness (ft):	40	28	38
Soil Friction Angle (deg):	29	32	30
Soil Weight (pcf):	45	51	48

Design Water Table is 0 ft. below surface

CANTILEVER SIGN STRUCTURES DATA TABLE (CONT.)																							Table Date 01-01-11									
SIGN NO.	GUSSET PLATES												TRUSS CONNECTION								SPLICE											
	GA	GB	GC		GD		GE		GF	GG	GH	GJ		GK	TA	TB	TC	TD	TE	TF	TG	TH	TJ	SA	SB	SC	SD					
	in	in	ft	in	ft	in	ft	in	ft	in	ft	in	ft	in	in	#	#	in	in	in	in	in	in	in	in	in	in	in				
OH-S1	3/8	7/8	1	5		7-1/2	1	2-1/4		6-1/2		9-1/2		6-3/4		11-1/4	3/16	7/8	10	6	1/2	1/2	3/16	3/16	3/16	3/16	3/16	3/16	5 x 5 x 1/2	6	7/8	3
OH-S2	3/8	7/8	1	4		7-1/2	1	1-1/4		6-1/2		11		7		10-1/2	3/16	7/8	10	6	1/2	1/2	3/16	3/16	3/16	3/16	3/16	3/16	NO SPLICE	N/A	N/A	N/A
OH-S3	3/4	7/8	1	5		7-1/2	1	2-1/4		6-1/2		7-1/2		6-1/2	1	1-1/4	3/16	7/8	10	6	5/8	1/2	3/16	3/16	3/16	3/16	3/16	6 x 6 x 1/2	6	1	3	

CANTILEVER SIGN STRUCTURES DATA TABLE (CONT.)																				Table Date 07-01-15			
SIGN NO.	BASE CONNECTION									ANCHOR		FOOTING - DRILLED SHAFT											
	BA	BB	BC	BD	BE		BF	BG	BH	BJ	BK		FA	FB	FC	FD	FE	FF	FG				
	in	#	in	in	ft	in	in	in	in	in	ft	in	ft	in	ft	in	ft	# / Size	#	in	#	in	
OH-S1	2-1/2	12	1-1/2	1/2	2	10-1/2	5/16	5/16	5/16	3/16	4	2	36	0	5	0	19 / 11	45	5	15	7		
OH-S2	2-1/2	12	1-1/2	1/2	2	10-1/2	5/16	5/16	5/16	3/16	4	2	20	0	5	0	19 / 11	30	5	7	7		
OH-S3	2-1/2	12	1-3/4	1/2	2	10-1/2	5/16	5/16	5/16	3/16	4	2	33	0	5	0	19 / 11	38	5	15	7		

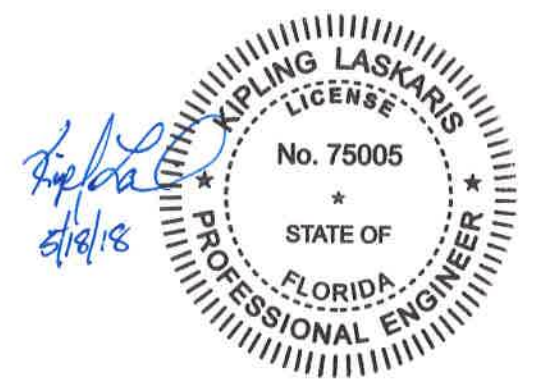

REVISIONS				 KISINGER CAMPO & ASSOCIATES 201 N. Franklin Street, Suite 400 Tampa, Florida 33602 Board of Professional Engineers Certificate of Authorization No. 02317 Engineer of Record: Kipling Laskaris, P.E. P.E. No. 75005	LEE COUNTY DEPARTMENT OF TRANSPORTATION		CANTILEVER SIGN STRUCTURES DATA TABLE	SHEET NO. 14
DATE	DESCRIPTION	DATE	DESCRIPTION		PLANS OF PROPOSED			
					PROJECT NO.			
				SANIBEL OVERHEAD SIGN STRUCTURE		7240		