

FLEET FOCUS

Volume 15, Issue 5

November 2011

YOU CAN IMPROVE YOUR MPG

ANN ARBOR, MI – A new University of Michigan Transportation Research Institute (UMTRI) study evaluated the effectiveness of different methods for reducing light-duty vehicle fuel consumption.

"Driving a light-duty vehicle in the United States is currently more energy-intensive than using a bus or a train and even flying," said Michael Sivak, research professor at UMTRI. "How can we improve on this performance? Vehicle selection has by far the most dominant effect — the best vehicle currently available for sale in the United States is nine times more fuel-efficient than the worst vehicle."

Sivak and colleague Brandon Schoettle studied the effects of decisions that drivers can make to influence on-road fuel economy of light-duty vehicles. The practices they evaluated include vehicle selection and maintenance, route selection, vehicle load, and driver behavior. The researchers said their analysis focused on fuel economy per vehicle, not per occupant. However, the average occupancy of a light-duty vehicle has dropped from 2.0 in 1960 to 1.4 today.

Regardless of vehicle type, vehicles with tuned engines, properly inflated tires, and that use the right

continued on page 2



DID YOU KNOW?

- Drivers who use hand-held devices are four times more likely to get into crashes serious enough to injure themselves. *(Source: Insurance Institute for Highway Safety)*
- In 2009, 5474 people were killed on U.S. roadways and an estimated 448,000 were injured in motor vehicle crashes that were reported to have involved a distracted driver. *(Source: NHTSA)*
- Twenty percent (20%) of injury crashes in 2009 involved reports of distracted driving. *(Source NHTSA)*
- Using a cell phone while driving, whether it's hand-held or hands-free, delays a driver's reactions as much as having a blood alcohol concentration at the 0.08 percent legal limit. *(Source: University of Utah)*
- Personal income spent on gasoline is currently 8.4%. Last year it was 6.7%.

INSIDE THIS ISSUE

- 1 Continuing Articles across Pages
- 1 Did you Know?
- 2 Do I really Need to Know This?
- 3 Tire Pressure Tips
- 4 Trivia and Quotable Quotes

HOW DID "AUTUMN" BECOME "FALL"

Autumn was initially called "fall of the leaf" in Middle English in the 16th Century and was eventually shortened to "fall." The word crossed the Atlantic with early American Colonists and continues to be used in the U.S., but is now obsolete in Great Britain.

kind of engine oil can improve fuel economy by as much as 40 percent.

Choosing to drive on routes that include highways, flat terrain, and less congestion, can cause a fairly dramatic reduction in fuel use. For example, a flat route can yield 15-20 percent better fuel economy than a hilly route. Taking a free-flowing highway route as opposed to a highly congested route can improve fuel economy for that trip by 20-40 percent, the researchers found. In addition, carrying extra cargo (e.g., an additional 100 pounds), can reduce fuel economy by up to 2 percent.

Driving slower and less aggressively can reduce gas usage by 30 percent. Turning off the air conditioner can save up to 25 percent, and using cruise control can save 7 percent at highway speeds.

Source: University of Michigan Transportation Research Institute



TAKE THE PLEDGE:

"I will engage in safe driving practices by avoiding risky behaviors like texting or e-mailing while I am operating a motor vehicle. When I'm behind the wheel, I will keep my focus on driving."

Take this pledge. Share it with your friends and family. Post it as your status on your favorite social-networking sites. You can never over-educate others (or yourself) about the potential dangers of distracted driving.

REALLY COOL WEBSITE

Want to know if your writing is reaching its target audience? Copy and paste a portion of your writing into this website, hit submit and VOILA! You will know immediately. Check it out!

<http://www.writingtester.com/>

(Thanks to Sheldon Kaye in the Library for this tip!)

DO I REALLY NEED TO KNOW THIS?

** In the first Rose Bowl game, in 1902, Stanford University was so overwhelmed by the University of Michigan, that Stanford conceded the game with 8 minutes left to play when the score was 49-0.

** More than 100 descendants of composer Johann Sebastian Bach have been cathedral organists.

** The working section of the piano is called the action. There are about 7,500 parts, all playing a role in the hammers hitting the strings when keys are struck.

** Architect James Horan was awarded \$500 and a parcel of land in Washington, D.C. for his 1792 winning design for the President's House, now known as the White House.

** The words "United States" and "America" are not mentioned in "Star Spangled Banner." The U.S. Congress didn't make the song the official anthem of the U.S. until 1931, 117 years after it was written.

** Built in 1967, the world's only flying saucer launching pad is in St. Paul, Alberta, Canada.

** As a youngster, *Jeopardy!* host Alex Trebek won 7 spelling-bees and 4 science fair championships.

** In 1985 Australian rocker Rick Springfield wrote an autobiographical song entitled "Bruce" about being mistaken for Bruce Springsteen.

** NY Yankee Alex Rodriguez hit the first homerun checked by instant replay in major league baseball history (September 2008 game vs. the Tampa Bay Rays at Tropicana Field). The call was upheld.

** The horseshoe crab uses small pointy spines at the base of its legs on its underside to tear and grind food while moving it upward towards its mouth.

** A sumo wrestling tournament is called a basho.

** Abraham Lincoln's Gettysburg address was ten sentences long.

** Cincinnati Reds catcher Johnny Bench could hold seven baseballs in one hand at one time.

** Cows are identified by nose prints, each of which has a distinct pattern of ridges and grooves.

** A baby porcupine is called a "Porcupette."

** Twenty percent (20%) of the body's oxygen and caloric intake is used by the brain.

** An estimated 63% of the red meat consumed worldwide is goat meat.

** Spuds MacKenzie, the spokesdog known as "the original party animal" in Bud Light beer commercials, was actually a female bullterrier named Honey Tree Evil Eye.

** A dragonfly flies at about 36 miles per hour.

** The Jai Alai ball, known as a pelota, travels at speeds of up to 188 miles per hour.

** There are more plastic flamingoes in the U.S. than real ones.

** A bar in London England sells vaporized vodka which is inhaled instead of sipped.

** Costco is the largest wine retailer in the U.S. with sales of about \$700 million.

** A rat can last longer without water than a camel.

SO LONG, FAREWELL

Two long-term Fleet employees, **Gary Holmes** and **Keith Solomon**, are both retiring after 15 years with Fleet Management. Holmes and Solomon both started with Lee County on the same day in October of 1996. Gary, and his wife Sandy, are relocating to Ocala to enjoy the "cooler" Florida weather and to travel a bit. Keith and his wife Angela plan to enjoy family, friends and "puttering" in Keith's workshop.



Tire Pressure - Improve Safety & Fuel Economy

Checking and maintaining proper air pressure levels in your vehicle's tires is one of the most important and easiest safety steps that you can take. Yet ... consider this. A recent study conducted at a major university concluded that the majority of cars are being operated with tires inflated to only 80% of capacity. You can improve your safety performance and fuel economy by keeping your tires properly inflated. It's quick...it's simple...and it's the right thing to do to protect you and your wallet.

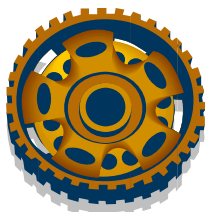

HATS OFF TO THE PARTS ROOM STAFF

Congratulations to the Fleet Management parts room staff, Janet Sherman, Parts Manager; Rick Jones, Senior Supply Specialist; and Jayme Winters, Supply Specialist, for an incredible year-end inventory. All Fleet staff pitched in to help and the inventory was counted in record time. The total year end adjustment was \$ 193.33 or 0.08%.



THE WASHINGTON MONUMENT

During the August earthquake that hit Washington DC, the historic Washington Monument was damaged. This prompted some questions about the origin of the monument itself. So, if you are curious like we were, here's the scoop:

The **Washington Monument** is an obelisk (a tall, four-sided, narrow tapering monument which ends in a pyramid-like shape at the top) near the west end of the National Mall in Washington, D.C., built to commemorate the first U.S. president, General George Washington. The monument, made of marble, granite, and bluestone gneiss, is both the world's tallest stone structure and the world's tallest obelisk, standing 555 feet 5 $\frac{1}{8}$ inches. There are taller monumental columns, but they are neither all stone nor true obelisks. It is also the tallest structure in Washington D.C. and was designed by Robert Mills, an architect of the 1840s. The actual construction of the monument began in 1848 but was not completed until 1884, almost 30 years after the architect's death. A hiatus in construction happened due to a lack of funds, and the intervention of the American Civil War. A difference in shading of the marble, visible approximately 150 feet or 27% up, shows where construction was halted for a number of years. The cornerstone was laid on July 4, 1848; the capstone was set on December 6, 1884, and the completed monument was dedicated on February 21, 1885. It officially opened October 9, 1888. Upon completion, it became the world's tallest structure, a title previously held by the Cologne Cathedral. The monument held this designation until 1889, when the Eiffel Tower was completed in Paris, France. The monument stands due east of the Reflecting Pool and the Lincoln Memorial.

(Source: Wikipedia)

TRIVIA QUESTION

Q: What American literary classic was originally going to be called "The Pathetic Family?"

- A. Swiss Family Robinson
- B. Little Women
- C. Wuthering Heights
- D. Huckleberry Finn

Send your answer to Marilyn Rawlings at Fleet in order to be eligible to win this month's prize!

LAST ISSUE'S TRIVIA QUESTION

Q: How much did the Pony Express charge to carry a half-ounce letter from Missouri to California in 1860, when it went into business?

- A. 5 cents
- B. 25 cents
- C. \$1.00
- D. \$5.00

The correct answer is "D" \$5.00 (about \$90 in today's dollars) for a trip that took 10 days. The price was later cut to \$1.00. **Andrew Miller, Sr. Maintenance Specialist from Parks and Recreation** was this month's trivia winner. Thanks to all who played our trivia game.

QUOTABLE QUOTES:

Sometimes me think, "What is friend?" And then me think... "Friend is what last chocolate chip cookie is for."

Cookie Monster

A friend is one before whom I may think aloud.

Ralph Waldo Emerson (1803 – 1882)
US Essayist, Poet

The most beautiful discovery true friends can make is that they can grow separately without growing apart.

Elizabeth Price Foley (1965 -)
Writer, Educator

When a friend is in trouble, don't annoy him by asking if there is anything you can do. Think up something appropriate and do it.

Edgar Watson Howe (1853 – 1937)
Newspaper Editor

Integrity is keeping my commitments even if the circumstances when I made those commitments have changed.

David Jeremiah
Theologian

Fleet Facts

Here are some facts about Fleet Management as outlined in our 2011 Business Plan.

Largest Customers:

DOT	455 pieces
Parks	425 pieces
Utilities	311 pieces

Largest Equipment Categories

Autos	79
Light / Med Trucks	552
Heavy Trucks	131
Vans	120
Heavy Equipment	273
Trailers	224

of Employees: 31 (two vacant positions)

of Master ASE / EVT Technicians: 7

of Technicians: 22

of Vehicle Miles Traveled Annually: 8.7 million
(reduced almost 25% over last year)

of Hybrid vehicles 11

Before a man can do things, there must be things he will not do.

Mencius (circa 371 B.C)
Philosopher

A man who carries a cat by the tail learns something he can learn in no other way.

Mark Twain (1835 – 1910)
Author, U.S. Humorist

If you care for someone, give them always a safe place to cry and never a reason to need it.

Unknown

There comes a time in your life, when you walk away from the drama and people who create it. You surround yourself with people who make you laugh. Forget the bad and focus on the good. Love the people who treat you right, pray for the ones who don't. Life is too short to be anything but happy. Falling down is a part of life, getting back up is living.

Unknown

I am a deeply superficial person.

Andy Warhol (1928 – 1987)
Artist

