

# Event Permit



**Event Name:**

Pine Island Garden Club 14th Annual Garden Gala

**Applicant:**

John A. Kendall

**Contact:**

John A. Kendall, 239.283.8175

**Location:**

Phillips Community Garden Park, 5675 Sesame Dr. Bokeelia

**Valid only for the Following date(s):**

February 21, 2015

**Valid only for the Following Time(s):**

9:00 am to 2:00 pm

**Permit Number**

15-0221CP

**Permit Type**

- Special Event
- Use of County Property
- Sell & consume Alcohol
- Consume Alcohol only
- Film Permit

**Permit Conditions:**

- Applicant must meet all event application requirements, including requirements of the sign-off agencies.
- The premises is to be left in the same condition as it was prior to the event.
- This permit is to be readily available for inspection during the entire event.
- County-issued alcohol permits: Alcoholic beverages must not be sold/consumed 1½ hours prior to the conclusion of the event & vacating the facility.

Board of County Commissioners  
Lee County, Florida

A handwritten signature in blue ink, appearing to read "A. White".

County Manager

02-27-15

Date

PINE ISLAND GARDEN CLUB  
c/o John A. Kendall  
3331 Franzone Rd.  
St. James City, FL 33956  
(239)283-8175  
[martykendall@gmail.com](mailto:martykendall@gmail.com)

October 22, 2014

Lee County Public Resources Office  
attn: Event Permitting  
2115 Second St.  
Ft. Myers, FL 33901

RE: Pine Island Garden Club 14<sup>th</sup> Annual Garden Gala

Dear Friends:

I am enclosing herewith the Pine Island Garden Club's Event Application concerning our proposed 14<sup>th</sup> Annual Garden Gala scheduled for February 21, 2015. Attached to the Application are the site plans, Certificate of Insurance and the approvals from the six entities as required. I have also included a copy of last year's Permit.

I recognize this is submitted well in advance of the event, however, I wanted to provide you ample opportunity to review our request. Please advise me of any items you may require.

Thank you in advance for your kind assistance.

Yours very truly,



John A. Kendall  
Vice-president, PIGC

rec'd  
10/23/14



**LEE COUNTY**  
SOUTHWEST FLORIDA

PERMIT NUMBER  
140222CP

# PERMIT TO USE COUNTY PROPERTY

THIS PERMIT IS ISSUED TO:

PINE ISLAND GARDEN CLUB

3331 FRANZONE ROAD

ST. JAMES CITY, FL 33956

CONTACT: JOHN A. KENDALL 239.283.8175

TO USE COUNTY PROPERTY FOR:

13TH ANNUAL GARDEN CLUB GALA  
PHILLIPS COMMUNITY GARDEN PARK  
5675 SESAME DRIVE  
BOKEELIA, FL 33922

THIS PERMIT SHALL BE VALID ONLY FOR THE PERIOD:

FEBRUARY 22, 2014  
9:00 AM TO 2:00 PM

THIS PERMIT IS SUBJECT TO THE APPLICANT MEETING ALL REQUIREMENTS CONTAINED IN THE APPLICATION FOR THIS EVENT, DULY SIGNED BY THE APPLICANT, AND COMPLYING WITH THE FOLLOWING REQUIREMENTS:

ALL REQUIREMENTS OF THE SIGN-OFF AGENCIES

BOARD OF COUNTY COMMISSIONERS  
LEE COUNTY, FLORIDA

  
COUNTY MANAGER

12-9-13  
DATE



## Lee County Event Permit Application



### Event Application

Check the appropriate box(es) below:

- SPECIAL EVENT PERMIT
- USE OF COUNTY PROPERTY PERMIT
- PERMIT TO SELL AND CONSUME ALCHOLIC BEVERAGES WITHIN LEE COUNTY FACILITIES
- FILM PERMIT

<b>Section I - GENERAL INFORMATION (All Permit Types)</b>	
<b>Title of Event / Name of Production</b>	Pine Island Garden Club 14th Annual Garden Gala
<b>Date(s) of Event / Production:</b>	February 21, 2015
<b>Location(s) of Event:</b>	Phillips Community Garden Park (Pine Island); property across the street from tennis courts on alleyway.
<b>Name of Applicant:</b>	John A. Kendall
<b>Applicant Address:</b>	3331 Franzone Rd., St. James City, FL 33956
<b>Applicant Phone Number:</b>	(239)283-8175
<b>Contact Person:</b> (If different from applicant)	
<b>Contact Phone Number:</b> (If different from applicant)	
<b>Email Address:</b>	martykendall@gmail.com
<b>Estimated Attendance:</b>	1,500
<b>Event Description:</b> Include each activity, when activities take place, etc.	The Pine Island Garden Club Gala is an annual event/fundraiser, which includes the sale of plants, food and art plus demonstrations on environmental and eco-educational matters.
<b>Hours of Operation:</b>	9am until 2pm
<b>STRAP # of Parcel:</b>	
<b>Owner of Premises*:</b>	Lee County Government (Parks and Recreation)

\*Notarized statement from the property owner specifically consenting to the proposed use required.

## Lee County Event Permit Application



Fill out the following questions for all permit types:

What is the Zoning Classification of the premises? Park

Are any temporary structures to be installed for the event?  Yes  No Type: small tents

Do you have the appropriate permits for the temporary structures?  Yes  No

\* For a 'Special Event' and 'Use of County Property' permit, submit a site plan with all proposed facilities and activities identified, including all parking areas.

Insurance Company Insuring the Event: American States Insurance Co.

Note: Certificate of Insurance must be submitted at time of application

Surety Company Bonding this Event (Name and Address): \_\_\_\_\_

Will Vehicles be Used as Part of This Event?

Yes  No

If yes, automobile coverage must be included on the certificate of insurance.

Will Food be Available at this Event?

Yes  No

If yes, products liability coverage must be included on the certificate of insurance.

Will Alcoholic Beverages be served/consumed at this Event?

Yes  No

If yes, liquor liability coverage must be included on the certificate of insurance.

Name & Address of Organization Providing Food: Little Lilly's Island Deli

Type of Food being Served: Deli sandwiches and soup

### Section II - USE OF COUNTY PROPERTY PERMIT

Organization Sponsoring the Event: Pine Island Garden Club

Fill out this portion for applications for Solicitation in the County Rights-of-Way:

Name of Charity: \_\_\_\_\_

Address of Charity: \_\_\_\_\_

Phone Number: \_\_\_\_\_

Non-profit certificate/registration number: \_\_\_\_\_

(Proof of registration with the Dept. of Agriculture & Consumer Services \$496.405 or proof the organization is exempt from this requirement. \$316.2045)

### Section III - SALE/CONSUMPTION OF ALCHOLIC BEVERAGES PERMIT

Is alcohol being sold/consumed on County Property?  Yes  No

If Yes, then a "Lee County Alcohol Permit" is required. Only non-profit organizations can sell alcohol on County Property.

Non-profit certificate/registration number: \_\_\_\_\_

(Required if alcohol is to be **SOLD** at the event)

Please note: A permit from the State of Florida Division of Alcoholic Beverages and Tobacco may also be required; please call (239) 344-0885 for further details





**SECTION I - SAFETY**

The Applicant agrees to provide adequate traffic and crowd control, emergency medical services and any other items, at the Applicant's expense, required by Lee County to protect the health, safety and welfare of the public. Lee County shall have the power to review the proposal and require, as necessary, detailed plans, diagrams, and explanations to clearly outline to Lee County, exactly what the Applicant is proposing.

**SECTION II - INSURANCE**

The Applicant, at its sole expense, agrees to procure and maintain in force during the entire term of the application, liability insurance in the amounts determined by Lee County Risk Management to protect against damages or other claims arising from use of County property by the applicant or its guests. Other limits may also be established by Lee County Risk Management for events which will be serving or consuming alcoholic beverages at approved County property. The insurance policy must also include coverage for Applicant's contingent liability on damages, claims or losses. "Lee County Board of County Commissioners" must be named as "additional insured" on the Certificate of Insurance, and the Certificate must be delivered to Lee County prior to Applicant's use of the property. The Insurance may not be canceled during the term of the event, if this occurs, the County has the right to revoke approvals related to use of the County property for the event, without recourse by the applicant.

**SECTION III - INDEMNIFICATION**

The Applicant agrees to indemnify, release and save harmless Lee County against any and all claims, costs, demands, damages, judgments or injuries of any nature arising from the conduct or management of, or from any work or thing whatsoever done in or about said Lee County property or any building or structure appurtenant thereto or equipment thereof during the term of this Permit, or arising during such term from any act of negligence of the Applicant, Applicant's agents, contractors, or employees, or arising from any accident, injury, or damage whatsoever, however caused, to any person or persons, or to any property of any person, persons, corporation or corporations, occurring during the term of this agreement on, in, or about said Lee County property, and from and against all costs, attorney's fees, expenses and liabilities occurring in connection with any such claim or any action or proceeding brought thereon.

For film permit applicants: The permittee shall have on-site a responsible representative empowered with authority over the filming director, filming crews, participants and filming operation. Permittee shall indemnify, defend and hold harmless the county, its officers, agents and employees from and against all claims, suits, actions, damages, liabilities, expenditures or causes of action of any kind arising out of or occurring during the activities of the permittee, and resulting or occurring from any negligent act, omission or error of permittee, resulting in or relating to injuries to body, life, limb or property sustained in, about or upon the permitted premises or improvement thereto, or arising from the use of the premises.

**SECTION IV - DELIVERY, ACCEPTANCE AND SURRENDER OF PREMISES**

The Applicant agrees to accept the County property on possession as being in a satisfactory state of repair and in sanitary condition.

The Applicant must surrender the premises to Lee County in the same condition as when Applicant takes possession, allowing for reasonable use and wear, and damage by acts of God. Applicant agrees to remove all business signs or symbols placed on the premises by the Applicant before redelivery of the premises to Lee County, and restore the premises to the condition in which it existed before their placement. Any signs and markings created or used in connection with this event must be temporary and removable; painting roadways, trees or any other fixed object is strictly prohibited. Applicant agrees to clear the Lee County property of litter at the close of the event.

Applicant Agreement - Signature Required



SECTION V - AGREEMENT

The Applicant agrees that Lee County can, at its sole discretion, terminate and cancel its permit to use Lee County property at any time without prejudice. Applicant further agrees to waive, release, save and hold harmless Lee County from any and all claims, demands or cause of actions based upon Lee County's cancellation or termination of said permit.

The Applicant agrees that the Lee County permit does not provide Applicant with any property rights in the County property in question or in the permit itself.

The applicant does acknowledge and hereby affirms that any and all information is accurate to the best of his/her knowledge.

John A. Kendall  
Signature of Applicant

Martha L. Kendall  
Witness

John A. Kendall, PIGC V-Pres  
Print Name of Applicant and Title

Martha L. Kendall  
Print Name of Witness

September 22, 2014  
Date

September 22, 2014  
Date

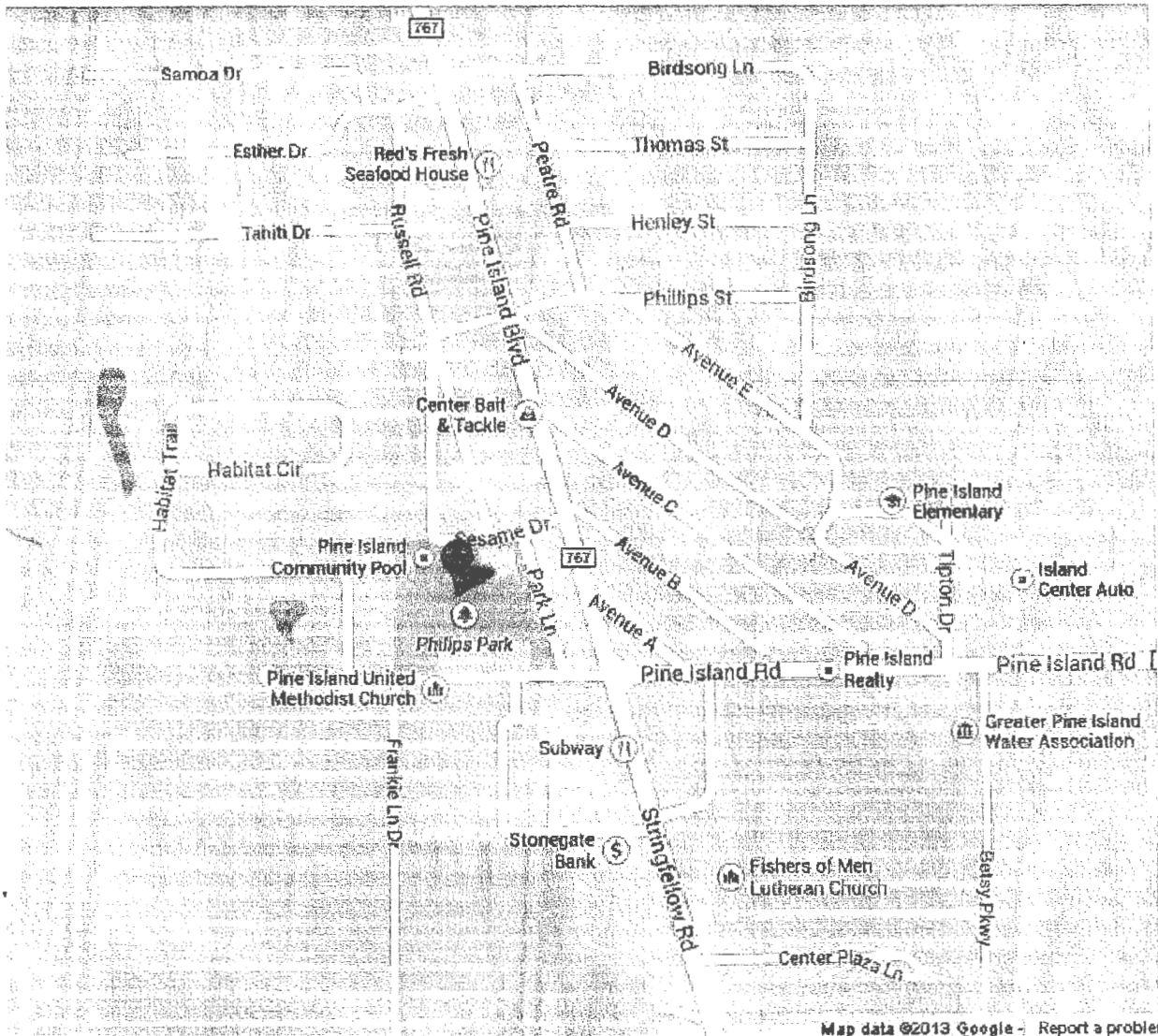





● = parking overs

⊗ Insert

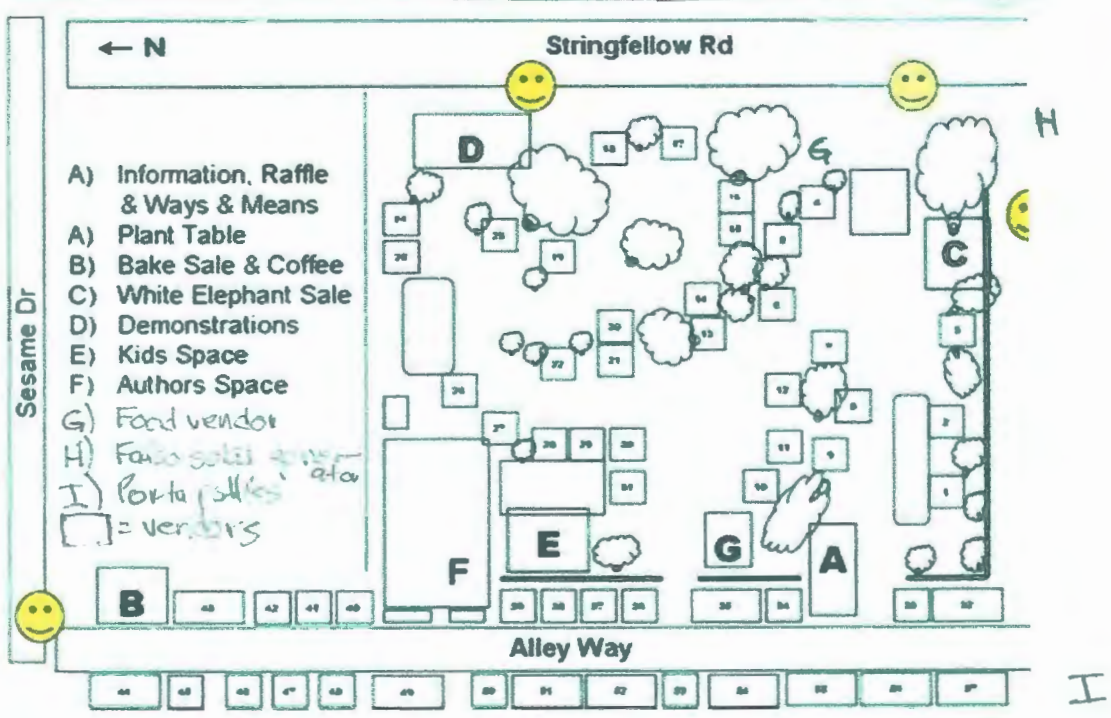

Lee County Event Permit Application



LEE COUNTY RISK MANAGEMENT  
COUNTY ADMINISTRATION BUILDING - 4<sup>TH</sup> FLOOR  
2115 SECOND STREET  
FORT MYERS, FLORIDA 33901  
(239) 533-2221

Check the appropriate box(es) below:

- SPECIAL EVENT PERMIT
- USE OF COUNTY PROPERTY PERMIT
- PERMIT TO SELL AND CONSUME ALCOHOLIC BEVERAGES WITHIN LEE COUNTY FACILITIES
- FILM PERMIT

AFTER REVIEWING THE APPLICATION, PLEASE INDICATE BELOW WHAT ARRANGEMENTS YOUR ORGANIZATION WILL REQUIRE THE APPLICANT TO COMPLY WITH FOR THEIR EVENT.

Insurance Requirements: General liability with a minimum amount of One Hundred Thousand Dollars (\$100,000) per person, Three Hundred Thousand Dollars (\$300,000) per occurrence for bodily injury liability, and Fifty Thousand Dollars (\$50,000) for property damage or whatever other limits may be established by Lee County Government.

Special Arrangements: A Certificate of Insurance shall be submitted as evidence of the required coverage listing Lee County Board of County Commissioners, P.O. Box 398, Fort Myers, FL 33902 as the certificate holder and as an additional insured.

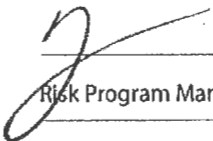
Print Name: Mike Figueroa  
Signature:   
Title: Risk Program Manager  
Date: October 16, 2014



# CERTIFICATE OF LIABILITY INSURANCE

DATE (MM/DD/YYYY)  
10/09/2014

THIS CERTIFICATE IS ISSUED AS A MATTER OF INFORMATION ONLY AND CONFERS NO RIGHTS UPON THE CERTIFICATE HOLDER. THIS CERTIFICATE DOES NOT AFFIRMATIVELY OR NEGATIVELY AMEND, EXTEND OR ALTER THE COVERAGE AFFORDED BY THE POLICIES BELOW. THIS CERTIFICATE OF INSURANCE DOES NOT CONSTITUTE A CONTRACT BETWEEN THE ISSUING INSURER(S), AUTHORIZED REPRESENTATIVE OR PRODUCER, AND THE CERTIFICATE HOLDER.

**IMPORTANT: If the certificate holder is an ADDITIONAL INSURED, the policy(ies) must be endorsed. If SUBROGATION IS WAIVED, subject to the terms and conditions of the policy, certain policies may require an endorsement. A statement on this certificate does not confer rights to the certificate holder in lieu of such endorsement(s).**

<b>PRODUCER</b> Stewart & Sons Insurance, Inc.  P.O. Box 60029 Fort Myers FL 33906		<b>CONTACT NAME:</b> PHONE (AC, No, Ext): 239-936-8844 FAX (AC, No): 239-275-4446 E-MAIL ADDRESS: info@stewartandsonsinsurance.com	
<b>INSURED</b> Pine Island Garden Club  P.O. Box 329 Pineland FL 33945		<b>INSURER(S) AFFORDING COVERAGE</b> INSURER A: American States Insurance Company NAIC # 19704 INSURER B: INSURER C: INSURER D: INSURER E: INSURER F:	

**COVERAGES**                      **CERTIFICATE NUMBER:**                      **REVISION NUMBER:**

THIS IS TO CERTIFY THAT THE POLICIES OF INSURANCE LISTED BELOW HAVE BEEN ISSUED TO THE INSURED NAMED ABOVE FOR THE POLICY PERIOD INDICATED. NOTWITHSTANDING ANY REQUIREMENT, TERM OR CONDITION OF ANY CONTRACT OR OTHER DOCUMENT WITH RESPECT TO WHICH THIS CERTIFICATE MAY BE ISSUED OR MAY PERTAIN, THE INSURANCE AFFORDED BY THE POLICIES DESCRIBED HEREIN IS SUBJECT TO ALL THE TERMS, EXCLUSIONS AND CONDITIONS OF SUCH POLICIES. LIMITS SHOWN MAY HAVE BEEN REDUCED BY PAID CLAIMS.

INSR LTR	TYPE OF INSURANCE	ADDL INSR	SUBR WVD	POLICY NUMBER	POLICY EFF (MM/DD/YYYY)	POLICY EXP (MM/DD/YYYY)	LIMITS	
A	GENERAL LIABILITY <input checked="" type="checkbox"/> COMMERCIAL GENERAL LIABILITY <input type="checkbox"/> CLAIMS-MADE <input checked="" type="checkbox"/> OCCUR GEN'L AGGREGATE LIMIT APPLIES PER: <input type="checkbox"/> POLICY <input type="checkbox"/> PROJ-ECT <input type="checkbox"/> LOC	<input checked="" type="checkbox"/>	<input type="checkbox"/>	01CH9096347	8/4/2014	8/4/2015	EACH OCCURRENCE	\$ 1,000,000
							DAMAGE TO RENTED PREMISES (Ea occurrence)	\$ 100,000
							MED EXP (Any one person)	\$ 10,000
							PERSONAL & ADV INJURY	\$ 1,000,000
							GENERAL AGGREGATE	\$ 2,000,000
							PRODUCTS - COMPIOP AGG	\$ 2,000,000
								\$
	AUTOMOBILE LIABILITY <input type="checkbox"/> ANY AUTO <input type="checkbox"/> ALL OWNED AUTOS <input type="checkbox"/> SCHEDULED AUTOS <input type="checkbox"/> HIRED AUTOS <input type="checkbox"/> NON-OWNED AUTOS	<input type="checkbox"/>	<input type="checkbox"/>				COMBINED SINGLE LIMIT (Ea accident)	\$
							BODILY INJURY (Per person)	\$
							BODILY INJURY (Per accident)	\$
							PROPERTY DAMAGE (Per accident)	\$
								\$
	UMBRELLA LIAB <input type="checkbox"/> OCCUR EXCESS LIAB <input type="checkbox"/> CLAIMS-MADE DED    RETENTION \$	<input type="checkbox"/>	<input type="checkbox"/>				EACH OCCURRENCE	\$
							AGGREGATE	\$
								\$
	WORKERS COMPENSATION AND EMPLOYERS' LIABILITY    Y/N ANY PROPRIETOR/PARTNER/EXECUTIVE OFFICER/MEMBER EXCLUDED? (Mandatory in NH) If yes, describe under DESCRIPTION OF OPERATIONS below	<input type="checkbox"/>	<input type="checkbox"/>	N/A			<input type="checkbox"/> WC STATUTORY LIMITS <input type="checkbox"/> OTHER	
							E.L. EACH ACCIDENT	\$
							E.L. DISEASE - EA EMPLOYEE	\$
							E.L. DISEASE - POLICY LIMIT	\$

DESCRIPTION OF OPERATIONS / LOCATIONS / VEHICLES (Attach ACORD 101, Additional Remarks Schedule, if more space is required)  
 Certificate holder is named additional insured with respects to general liability.RE: Gala February 21,2015

<b>CERTIFICATE HOLDER</b> Lee County BOCC  P.O. Box 398 Fort Myers, FL 33902	<b>CANCELLATION</b> SHOULD ANY OF THE ABOVE DESCRIBED POLICIES BE CANCELLED BEFORE THE EXPIRATION DATE THEREOF, NOTICE WILL BE DELIVERED IN ACCORDANCE WITH THE POLICY PROVISIONS.  AUTHORIZED REPRESENTATIVE 
--	--



Lee County Event Permit Application



FIRE DEPARTMENT

The Fire Department serving the area where the event is to be held signs this form.  
Please see User's Guide for contact information and Fire District Map.

Check the appropriate box(es) below:

- SPECIAL EVENT PERMIT
- USE OF COUNTY PROPERTY PERMIT
- FILM PERMIT

AFTER REVIEWING THE APPLICATION, PLEASE INDICATE BELOW WHAT ARRANGEMENTS YOUR ORGANIZATION WILL REQUIRE THE APPLICANT TO COMPLY WITH FOR THEIR EVENT.

Fire Guards (How Many?)

none

Fee for Services:

none

Flammable Vegetation:

none

First Aid Equipment:

none

Fire Extinguishing:

all tents are under 500 sq feet.  
NO Fire extinguishers required at this time.

Special Arrangements:

none

Print Name:

Christi Roman

Signature:

Christi Roman

Title:

Fire Inspector

Date:

10/10/14

Lee County Event Permit Application



LEE COUNTY SHERIFF'S DEPARTMENT  
14750 SIX MILE CYPRESS PARKWAY  
FORT MYERS, FLORIDA 33912  
(239) 477-1199

Check the appropriate box(es) below:

- SPECIAL EVENT PERMIT
- USE OF COUNTY PROPERTY PERMIT
- PERMIT TO SELL AND CONSUME ALCOHOLIC BEVERAGES WITHIN LEE COUNTY FACILITIES
- FILM PERMIT

AFTER REVIEWING THE APPLICATION, PLEASE INDICATE BELOW WHAT ARRANGEMENTS YOUR ORGANIZATION WILL REQUIRE THE APPLICANT TO COMPLY WITH FOR THEIR EVENT.

Parking:

Parking in authorized parking areas only.

Deputies (How Many?):

None required.

Fee for Services:

Special Arrangements:

None.

Print Name: Capt. Scott Lucia

Signature: 

Title: Detail Unit Commander

Date: 24 September 2014

Lee County Event Permit Application



DEPARTMENT OF TRANSPORTATION  
1500 MONROE STREET  
FORT MYERS, FL 33901  
(239) 533-8580

Check the appropriate box(es) below:

- SPECIAL EVENT PERMIT
- USE OF COUNTY PROPERTY PERMIT
- PERMIT TO SELL AND CONSUME ALCOHOLIC BEVERAGES WITHIN LEE COUNTY FACILITIES
- FILM PERMIT

AFTER REVIEWING THE APPLICATION, PLEASE INDICATE BELOW WHAT ARRANGEMENTS YOUR ORGANIZATION WILL REQUIRE THE APPLICANT TO COMPLY WITH FOR THEIR EVENT.

Parking:

No parking on or within 10 feet of Lee County road rights-of-way.

Ingress and Egress:

Use all established means of ingress and egress.

Special Arrangements:

Use Lee County Sheriff's Office for assistance with traffic control, if necessary.

Print Name: Bryan D. Miller

Signature: Bryan D. Miller

Digitally signed by Bryan D. Miller  
DN: cn=Bryan D. Miller, ou=Traffic, email=mlmiller@leegov.com,  
c=US  
Date: 2014.10.01 09:08:24 -0400

Title: Senior Project Manager

Date: October 1, 2014



Lee County Event Permit Application



**EMERGENCY MEDICAL SERVICES / PUBLIC SAFETY**  
**14752 SIX MILE CYPRESS PARKWAY**  
**FORT MYERS, FL 33912**  
**(239) 533-3911**

Check the appropriate box(es) below:

- SPECIAL EVENT PERMIT
- USE OF COUNTY PROPERTY PERMIT
- FILM PERMIT

AFTER REVIEWING THE APPLICATION, PLEASE INDICATE BELOW WHAT ARRANGEMENTS YOUR ORGANIZATION WILL REQUIRE THE APPLICANT TO COMPLY WITH FOR THEIR EVENT.

Treatment Facilities:

N/A

Medical Personnel:

N/A

Medical Supplies /  
Equipment:

N/A

Safety Requirements:

N/A

Fee for Services

pt. billed @ time of service

Special Arrangements:

call 911 as needed for emergencies

Print Name: SCOTT TRITTE

Signature:

Title: Deputy Director Public Safety

Date: 9/25/14

Lee County Event Permit Application



LEE COUNTY PARKS AND RECREATION  
3410 PALM BEACH BOULEVARD  
FORT MYERS, FLORIDA 33916  
(239) 533-7275

Check the appropriate box(es) below:

- SPECIAL EVENT PERMIT
- USE OF COUNTY PROPERTY PERMIT
- PERMIT TO SELL AND CONSUME ALCOHOLIC BEVERAGES WITHIN LEE COUNTY FACILITIES
- FILM PERMIT

AFTER REVIEWING THE APPLICATION, PLEASE INDICATE BELOW WHAT ARRANGEMENTS YOUR ORGANIZATION WILL REQUIRE THE APPLICANT TO COMPLY WITH FOR THEIR EVENT.

Illumination:

Illumination is not required as the event is held during daylight hours.

Parking Areas:

Parking will be in surrounding businesses. This event is self parking and has had no previous problems.

Special Arrangements:

The Garden Gala is an annual event held by the Pine Island Garden Club. They will be responsible to clean all trash left by any vendor.

Print Name:

DANA KASIOR

Signature:

*[Handwritten Signature]*

Title:

DEPUTY DIRECTOR

Date:

10.20.14



**MEMORANDUM  
FROM  
THE DIVISION OF PUBLIC RESOURCES**

---

**DATE:** October 27, 2014  
**TO:** County Management  
**FROM:** Samantha Westen, Administrative Assistant  
**RE:** **Event Permit for Signature**

Attached is a Special Event application submitted by **John A. Kendall** for the “**Pine Island Garden Club 14<sup>th</sup> Annual Garden Gala**” event which will take place at **Phillips Community Garden Park, 5675 Sesame Drive, Bokeelia** on **February 21, 2015** from **9:00 am to 5:00 pm..**

All needed sign-off sheets are included as well as the insurance certificate and site plan.

Please sign the permit and return to Public Resources after review.

If you have any questions or concerns, please call me at 533-2112.

Thank you,



Samantha Westen

Attachment